

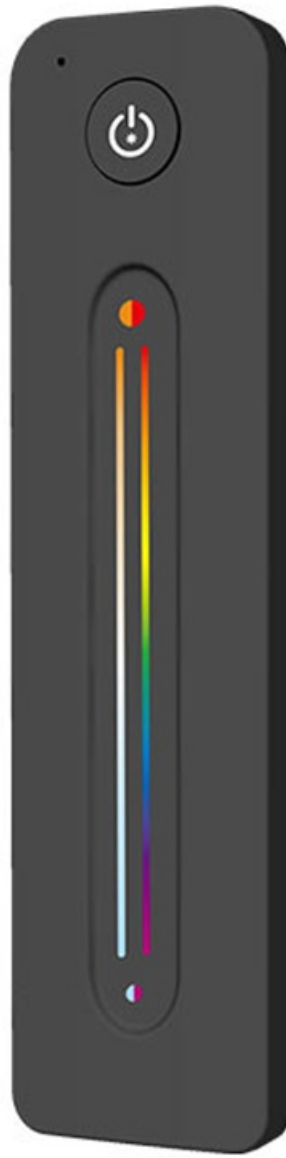

SKYDANCE R Series Ultrathin Touch Slide RF Remote Controller Instruction Manual

[Home](#) » [SKYDANCE](#) » SKYDANCE R Series Ultrathin Touch Slide RF Remote Controller Instruction Manual 

SKYDANCE R Series Ultrathin Touch Slide RF Remote Controller



Contents

[1 Features](#)

[2 Technical Parameters](#)

[3 Mechanical Structures and Installations](#)

[4 Match Remote Control \(two match ways\)](#)

[4.1 Use the controller's Match key](#)

[4.2 Use Power Restart](#)

[4.3 Key function](#)

[5 Safety information](#)

[6 Documents / Resources](#)

[7 Related Posts](#)

Features

- Apply to single color, dual color ,RGB, RGB+W or RGB+CCT LED controller.
- Ultra sensitive color adjustment touch slide.
- Each remote can match one or more receiver.
- CR2032 battery powered.
- Operate with LED indicator light.

- Magnet on the back which can be easily stuck on back holder or any metal surfaces.
- White & Black available



R11
Dimming



R12
CCT



R13
RGB



R14
RGBW

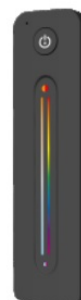

R10
RGB+ CCT

Technical Parameters

Input and Output	
Output signal	RF(2.4GHz)
Working voltage	3VDC(CR2032)
Working current	<5mA
Standby current	<10μA
Standby time	1 year
Remote distance	30m(Barrier-free space)

Safety and EMC	
EMC standard (EMC)	ETSI EN 301 489-1 V2.2.3 ETSI EN 301 489-17 V3.2.4
Safety standard(LVD)	EN 62368-1:2020+A11:2020
Radio Equipment(RED)	ETSI EN 300 328 V2.2.2
Certification	CE,EMC,LVD,RED

Package	
Size	L156 x W48 x H22mm
Gross weight	0.075kg
Environment	
Operation temperature	Ta: -30 OC ~ +55 OC
Warranty	
Warranty	5 years

Mechanical Structures and Installations

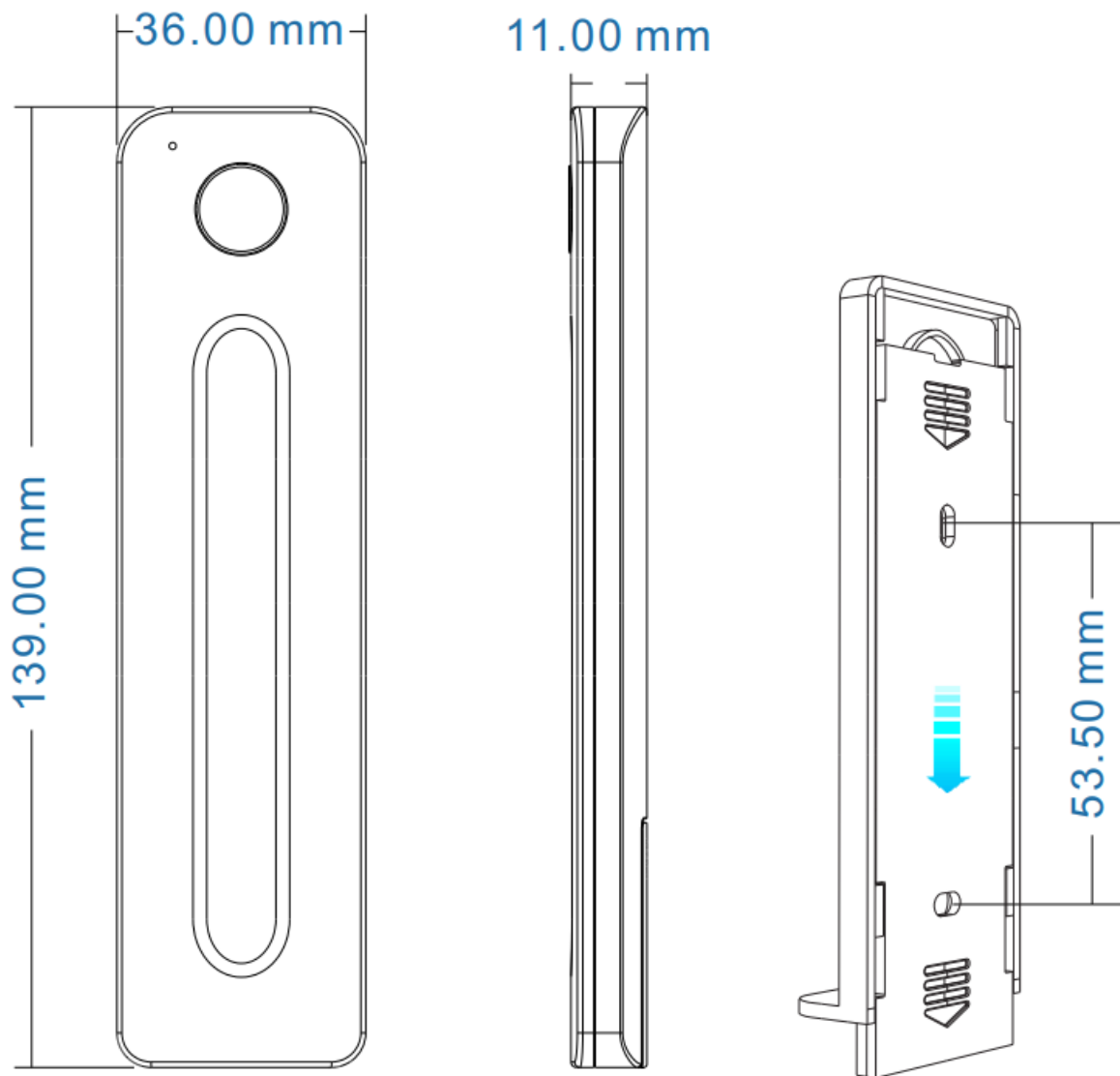

To fix the remote, three options are offered for selection:

Option 1: stuck the remote on any metal surfaces directly.

Option 2: fix the remote' back holder on the wall with two screws.

Option 3: adhere the remote' back holder to the wall with paster.

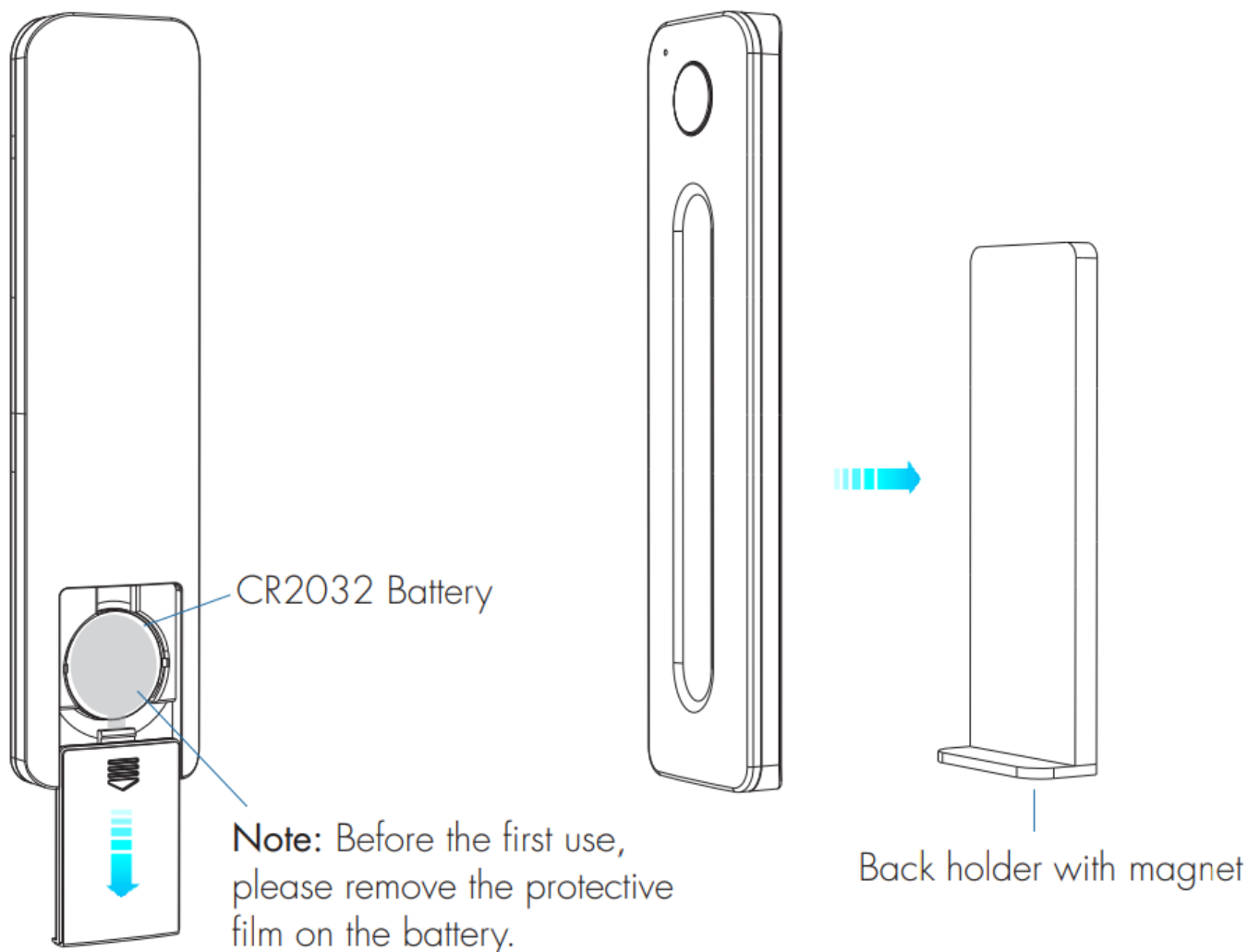

Match Remote Control (two match ways)

End user can choose the suitable match/delete ways. Two options are offered for selection:

Use the controller's Match key

Match:

Short press match key, immediately press on/off key on the remote.
The LED indicator fast flash a few times means match is successful.

Delete:

Press and hold match key for 5s to delete all match,
The LED indicator fast flash a few times means all matched remotes were deleted.

Use Power Restart

Match:

Switch off the power, then switch on power, repeat again.
Immediately short press on/off key 3 times on the remote.
The light blinks 3 times means match is successful.

Delete:

Switch off the power, then switch on power, repeat again.
Immediately short press on/off key 5 times on the remote.
The light blinks 5 times means all matched remotes were deleted.

Key function

- **R11 1 zone dimming remote**

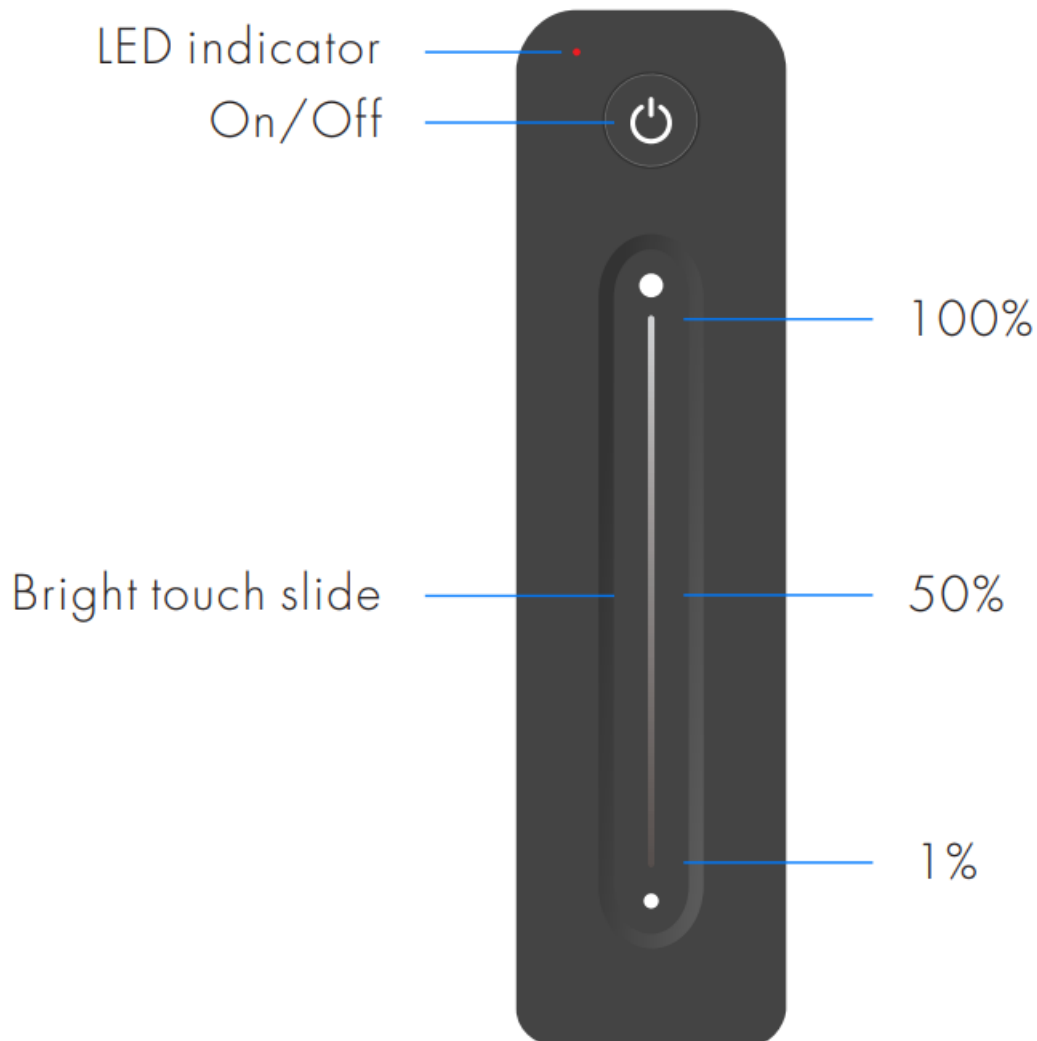

- **R12 1 zone CCT remote**

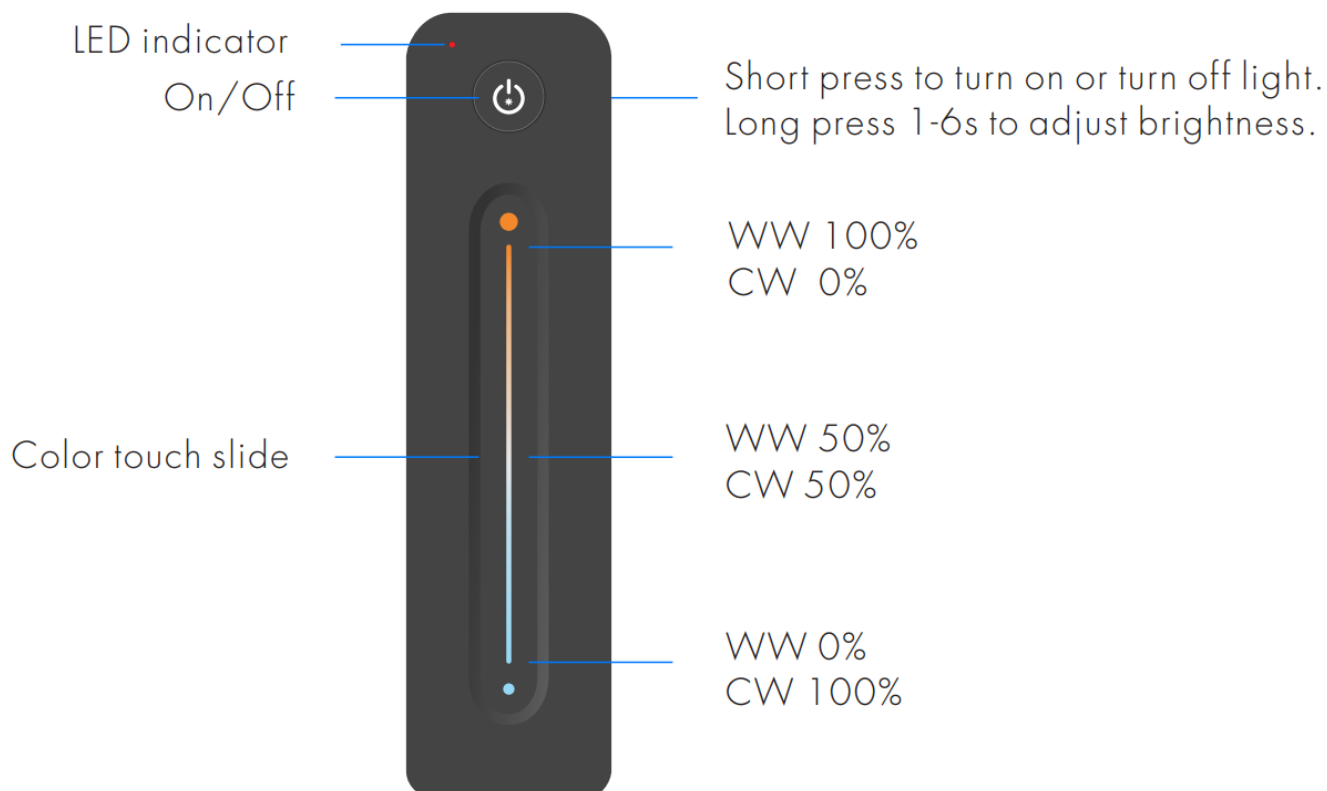

- **R13 1 zone RGB remote**

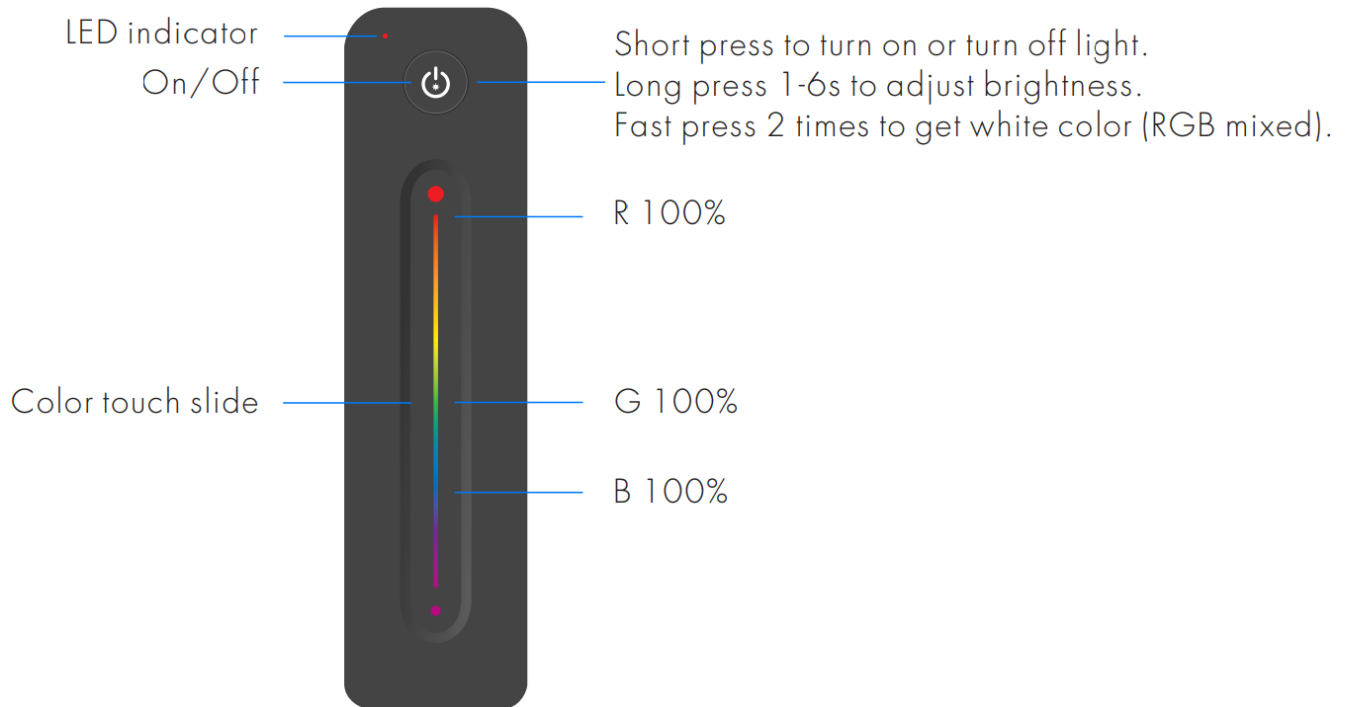

- **R10 1 zone RGB+CCT**

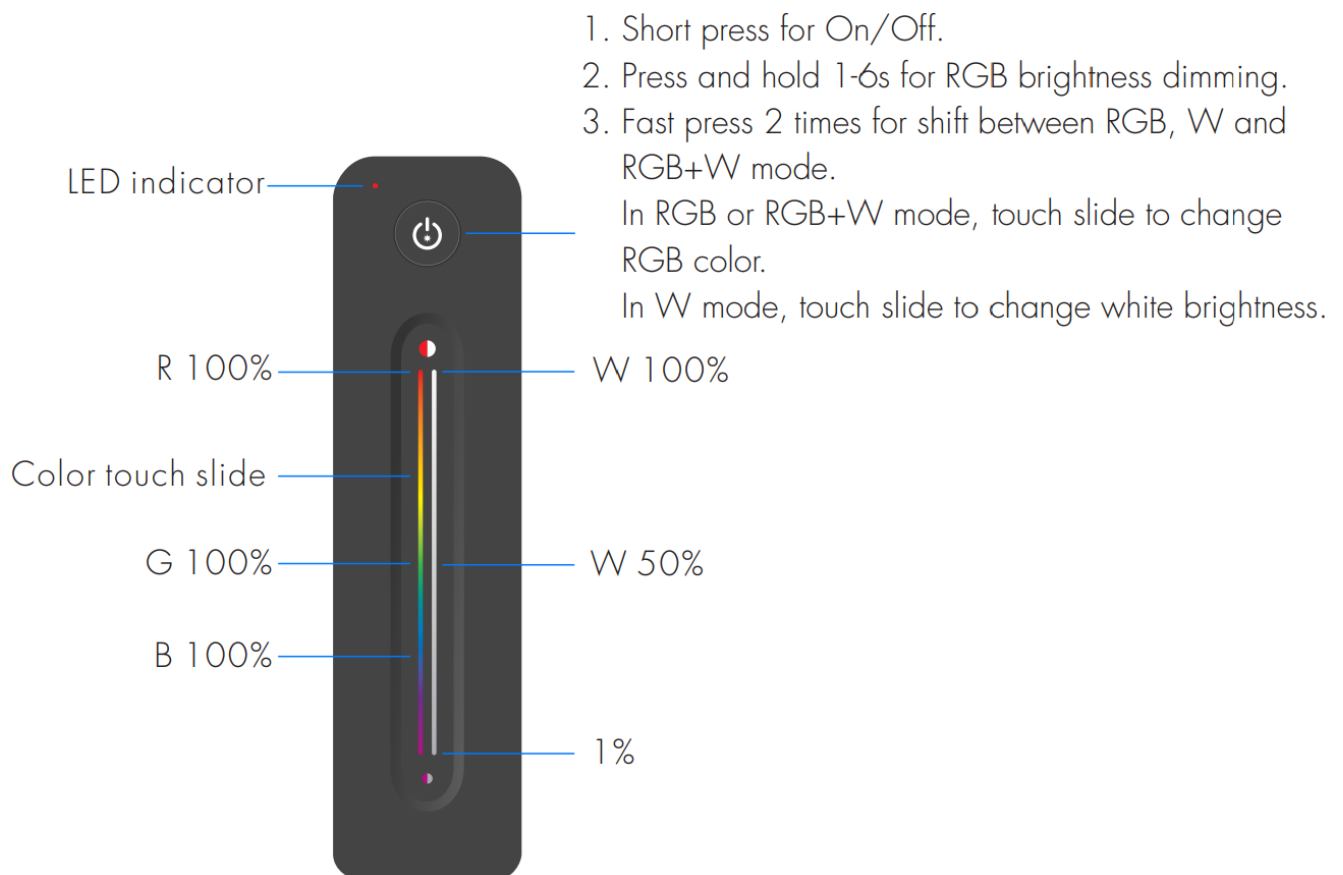

- **R14 1 zone RGBW remote**

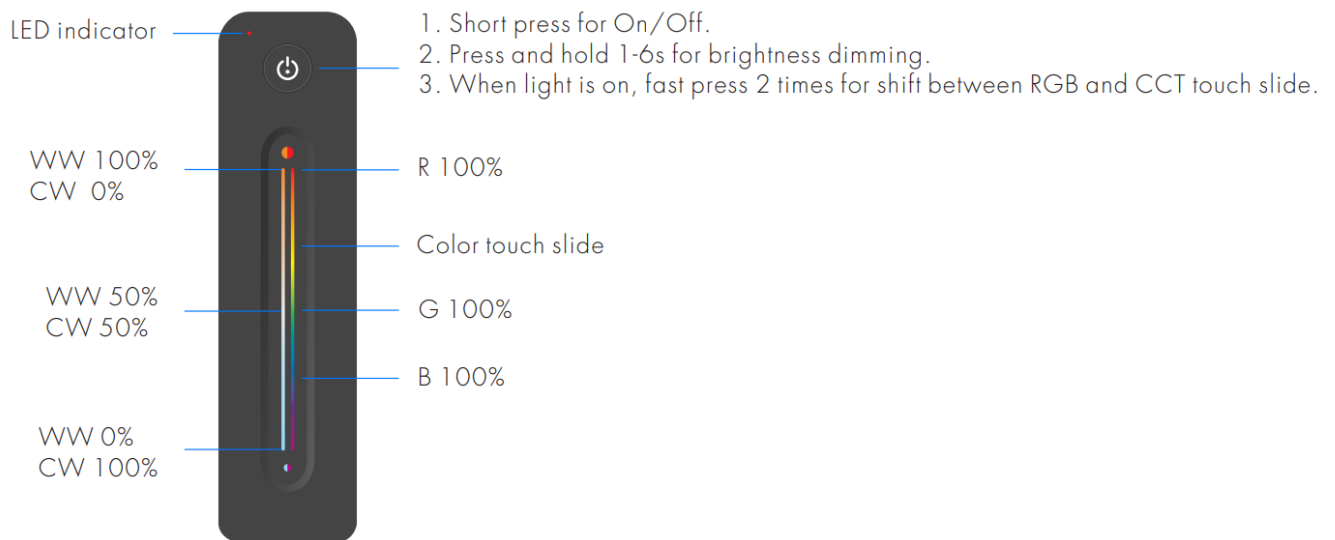

Safety information

1. Read all instructions carefully before you begin this installation.
2. When installing battery, pay attention to the battery positive and negative polarity.
A long time without the remote control, remove the battery.
When remote distance becomes smaller and insensitive, replace the battery.
3. If no response from the receiver, please re-match the remote.
4. Gently handle remote, beware of falling.
5. For indoor and dry location use only

Documents / Resources

	<p>SKYDANCE R Series Ultrathin Touch Slide RF Remote Controller [pdf] Instruction Manual Ultrathin Touch Slide RF Remote Controller, Ultrathin Remote Controller, Touch Slide RF Remote Controller, Remote Controller, R11, R12, R13, R14, R10</p>
---	---