



# Skybasic GNIMB401KH03 Wifi Digital Microscope User Manual

[Home](#) » [Skybasic](#) » Skybasic GNIMB401KH03 Wifi Digital Microscope User Manual 

## Contents

- [1 Wifi Digital Microscope GNIMB401KH03](#)
- [2 Note before use](#)
- [3 Product Introduction](#)
- [4 Product Function Introduction](#)
- [5 Instructions](#)
- [6 Computer users](#)
- [7 Mac users](#)
- [8 Charging](#)
- [9 Product Parameter](#)
- [10 Troubleshooting](#)
- [11 Documents / Resources](#)
- [12 Related Posts](#)

**Wifi Digital Microscope GNIMB401KH03**

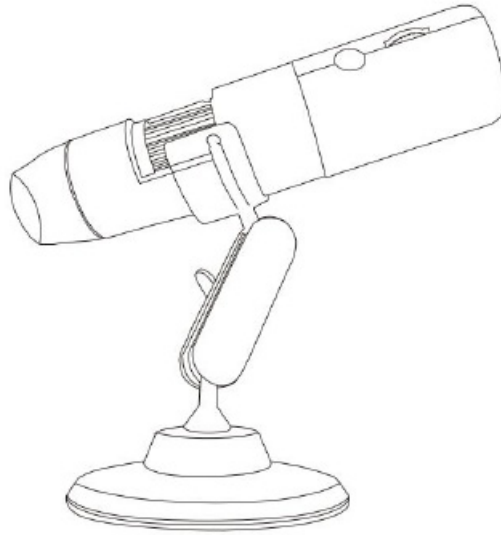

## User Manual

### Note before use

1. Before using the microscope, remove the plastic cover of the LED lamp cover and cover it after use to prevent dust from entering.
2. Do not use the mobile phone network and home wifi during use.
3. Please fully charge the device before using it for the first time. Please do not directly pass the PC. Terminal charging, please choose 5V 1A adapter.
4. The best focal length for microscope imaging is 0-40mm, you need to adjust the focus by adjusting the focus wheel, which has reached the clearest state.
5. WiFi connection is only available for your phone and tablet, not for PC. If you want to use it on a PC, please connect via USB cable and download the correct computer software.
6. Pls shut down the unuseful APP in your phone to make sure our microscope run Smoothly, and won not get stuck, crash.
7. Do not disassemble the digital microscope or change the interior parts,it can cause damage.
8. Do not touch the lens with your fingers.

### Product Introduction

Thank you for purchasing our WiFi digital microscope, this product can be easily used in different fields, including:

1. Textile industrial for textile inspection
2. Printing inspection
3. Industrial inspection:PCB,Precision machinery
4. Educational purpose
5. Hair examination
6. Skin examination
7. Microbiological observation
8. Jewelry&coin(Collections) inspection

## 9. Visual Assistance

## 10. Others

This is a portable WiFi electronic microscope equipped with a WiFi hotspot that can connect to iOS/Android system phones and tablets.

At the same time, the microscope also supports a use interface to connect to the computer. The larger the screen, the better the display and the sharper the image quality. At the same time, the product supports photo, video and file storage.

### Product Function Introduction

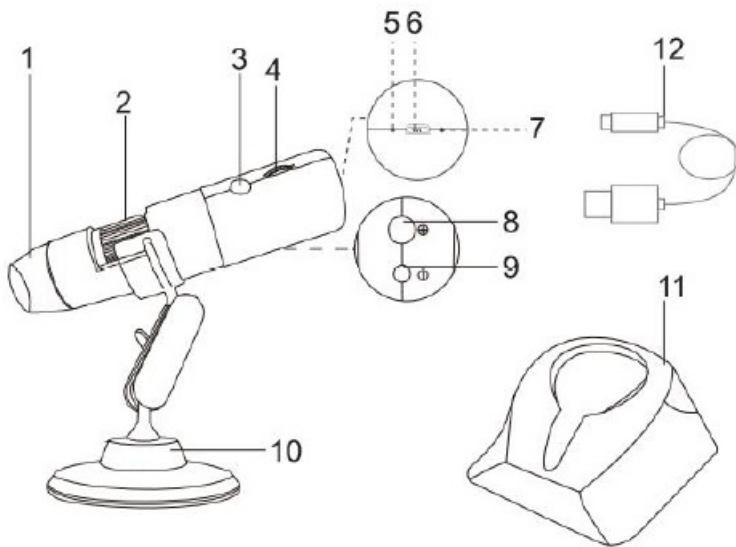

1. Lens protection cover
2. Focusing wheel
3. Power/Photo button
4. LED regulator
5. Charging indicator
6. Charging port
7. WiFi indicator
8. Zoom in button
9. Zoom out button
10. Metal bracket
11. Plastic base
12. Data line

### Instructions

#### Mobile users

##### 1. APP download and installation

Search for “inskam” in App Store to download and install, then use the product.

Android ( International ): Search for “inskam” on Google Play or follow the link below:

([www.inskam.com/download/inskaml.apk](http://www.inskam.com/download/inskaml.apk)) for download and installation.



C. Android ( China ): Use the mobile browser to scan the following QR code to download and install.



## 2. Turn on the device

Long press and hold the camera photo/switch button to see the blue LED flashing. When the wifi connection is successful, it will stop flashing to the steady state.

## 3. WiFi connection

Open the WiFi settings area in your phone settings and find the WiFi hotspot (no password) called inskam314—xxxx. Click on the connection. After the connection is successful, return to inskam to use the product (the WiFi indicator stops flashing after the WiFi connection is successful).

## 4. Focal length and lighting adjustment

In the state of taking pictures or recordings, slowly rotate the focus wheel to adjust the focus, focus on the subject, and adjust the brightness of the LEDs to achieve the clearest viewing state

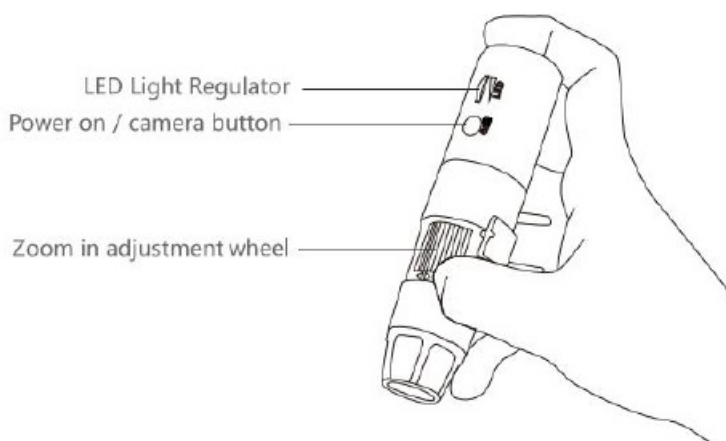

## 5. Introduction and use of mobile APP interface

Open the app, you can take photos, videos, file views, rotation, resolution settings, etc

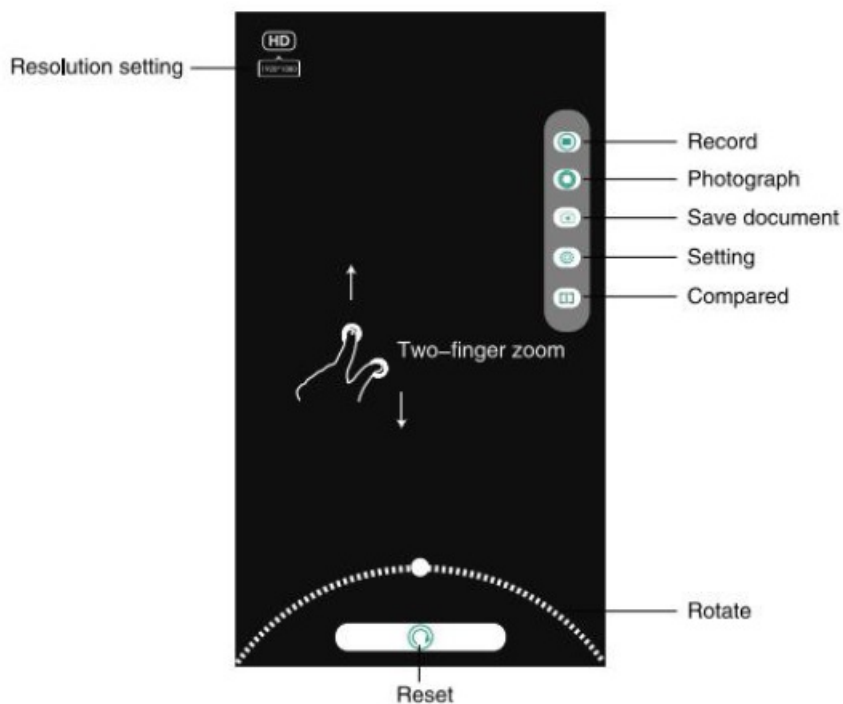

## Computer users

**\*Note:** When using a computer

1. The maximum resolution is 1280' 720P.
2. The device buttons can not be used.

Windows users

### 1. Software downloading

Download and install the software "Smart Camera" from the following [www.inskam.com/downloadcamera.zip](http://www.inskam.com/downloadcamera.zip)

### 2. Connecting device

- a. Press and hold the device to take a photo/switch button, you can see that the WiFi indicator flashes blue.
- b. Use the data cable to connect the device to the computer's USB 2.0 interface and run "Smart Camera" .
- c. Click on the device option in the main interface to switch and select the camera "USB CAMERA" in the device to use.

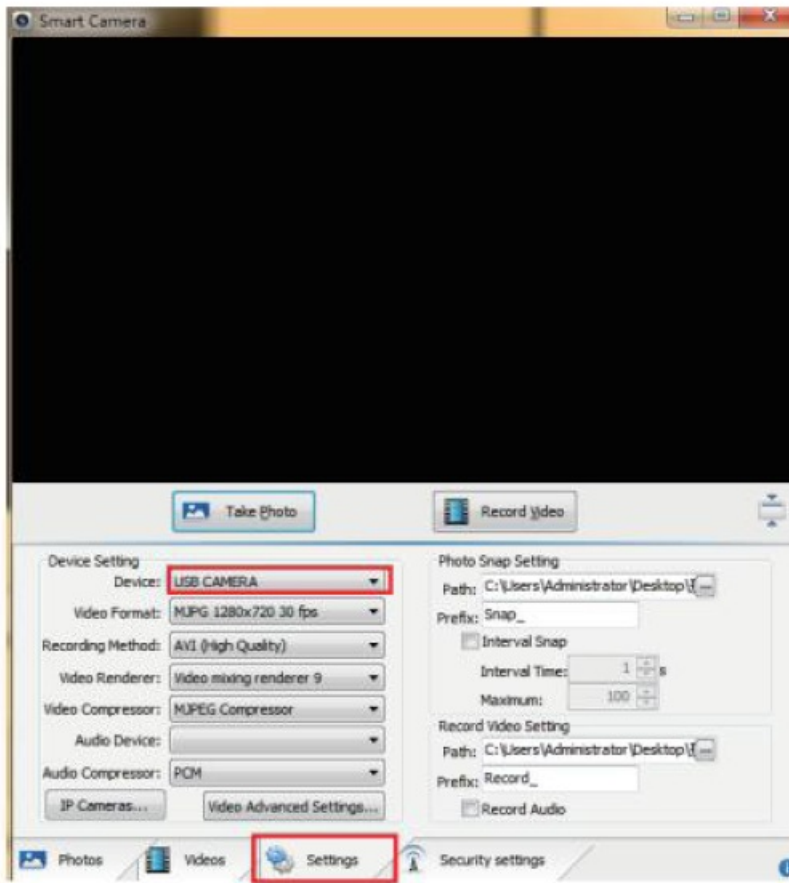

## Mac users

a. In the “Applications” directory of the Finder window, find an app called Photo Booth.



- b. Long press the device to take a photo / switch button, you can see the WiFi light blue light flashes
- c. Use the data cable to connect the device to the computers USB 2.0 interface and run “Photo Booth”
- d. Click Photo Booth and select the camera “USB CAMERA” to use

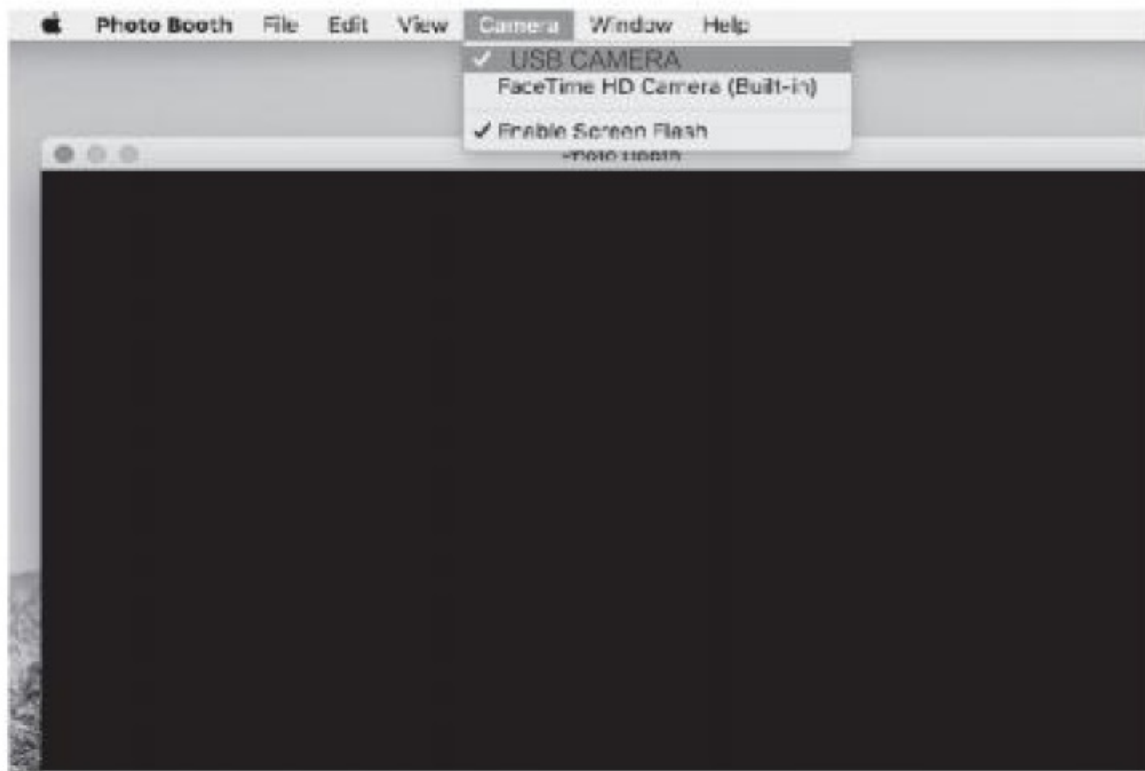

## Charging

When the power is low, you need to use the power adapter to charge. The adapter needs to use the specified 5V/1A.

When the battery is charging, the charging indicator is red.

When the battery is fully charged, the charging indicator lights up red (the entire charging process takes about 3 hours). When the battery is fully charged, the product is used for about 3 hours.

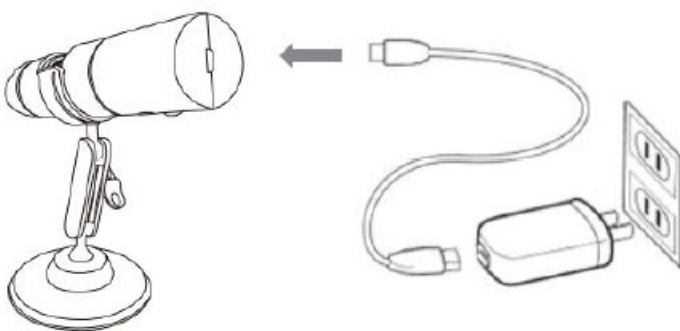

- Do not use a computer to charge this device

## Product Parameter

Pixel	2.0 M pixels
Multiple	50–1000 X
Photo resolution	1920*1080P
Focal length	Manual focus ( 0~40mm )
WiFi transmission distance	5m (Open environment)
Battery parameter	800mAh
Charge time	3h
Battery life	3h
USB interface type	USB 2.0
Support system	Android 4.4 , iOS 9.0 , Windows vista/7/8/10, MacOS X 10.8 or later
Product List	WiFi microscope Metal bracket Plastic base 1m data line User manual Packing box

## Troubleshooting

If the device is not working properly, please read the following to resolve the issue or contact us for a solution



Problem	Solution
No image	<ol style="list-style-type: none"> <li>1. Check the WiFi settings on your phone to confirm that the device is connected successfully.</li> <li>2. Close the app and reopen it.</li> <li>3. Turn off the device and turn it back on.</li> <li>4. Check if the phone allows inskam to connect to the wireless.</li> <li>5. Turn off the data network.</li> </ol>
Blurred image	<ol style="list-style-type: none"> <li>1. Open the dust cover</li> <li>2. Adjust the focus</li> </ol>
LED lights are dim	<ol style="list-style-type: none"> <li>1. Adjust the LED light gear to increase the , brightness.</li> </ol>
Device crash	<ol style="list-style-type: none"> <li>1. Press the power and zoom in buttons simultaneously to restart the device.</li> </ol>
Photo flashback ( iOS device )	<ol style="list-style-type: none"> <li>1. Go to the Settings page and find "inskam" in the Apps section at the bottom to allow "Photos" to be turned on.</li> </ol>

## Documents / Resources

	<a href="#">Skybasic GNIMB401KH03 Wifi Digital Microscope</a> [pdf] User Manual GNIMB401KH03, Wifi Digital Microscope, Microscope
---	--