

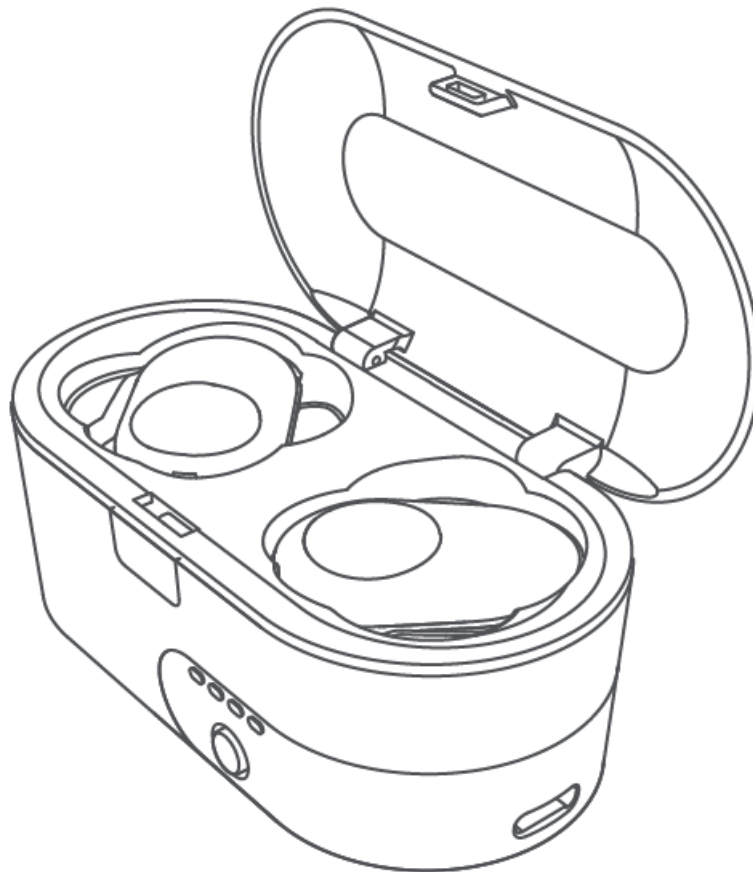

# Skullcandy Push User Manual

[Home](#) » [Skullcandy](#) » Skullcandy Push User Manual 

## USER MANUAL



**Skullcandy Push**

## Contents

- 1 Register Your Product
- 2 Secure in Ear with FitFin™
- 3 Auto Power- On
- 4 Auto Power- Off
- 5 Charge Case
- 6 Charge Earbuds
- 7 Pairing Mode
- 8 Pair New Device
- 9 Power – On/Off
- 10 Volume Up
- 11 Volume Down
- 12 Play/Pause
- 13 Track Forward
- 14 Track Back
- 15 Answer/End
- 16 Activate Voice Assistant
- 17 The FCC Compliance Statement
- 18 Related Posts

## Register Your Product

[Skullcandy.com/product-registration/push](https://skullcandy.com/product-registration/push)

## Secure in Ear with FitFin™

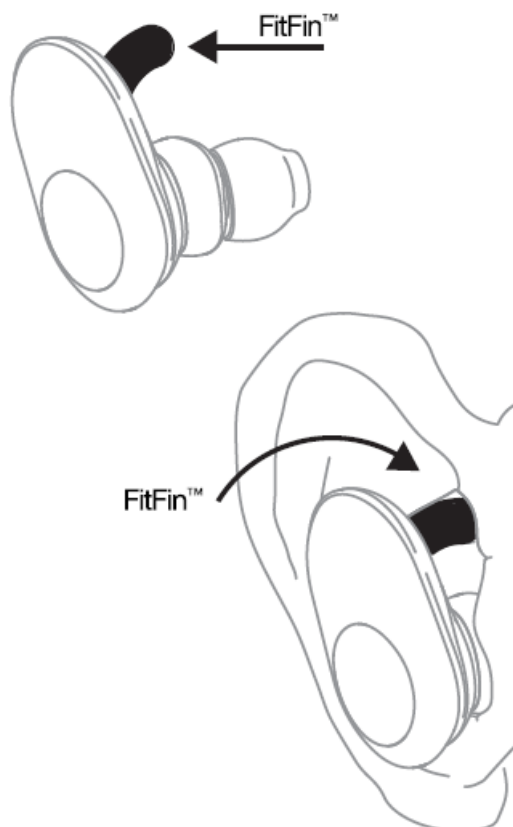

Guide FitFin™ In Ear

## Auto Power- On

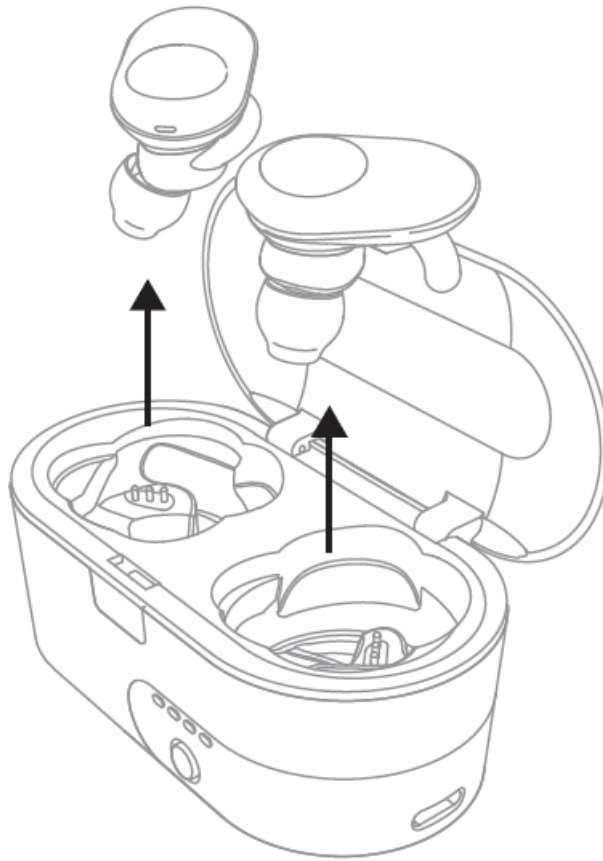

Power-On

## Auto Power- Off

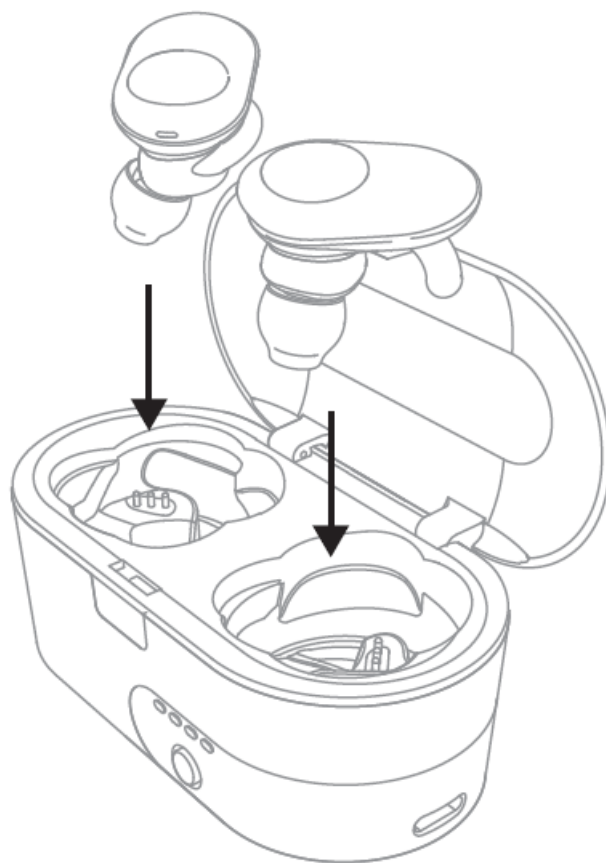

Power-Of!

## Charge Case

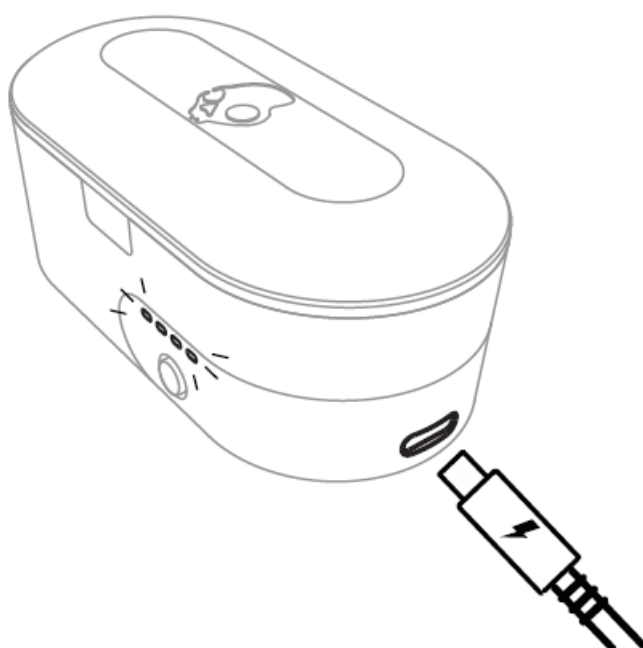

Charge Case

## Charge Earbuds

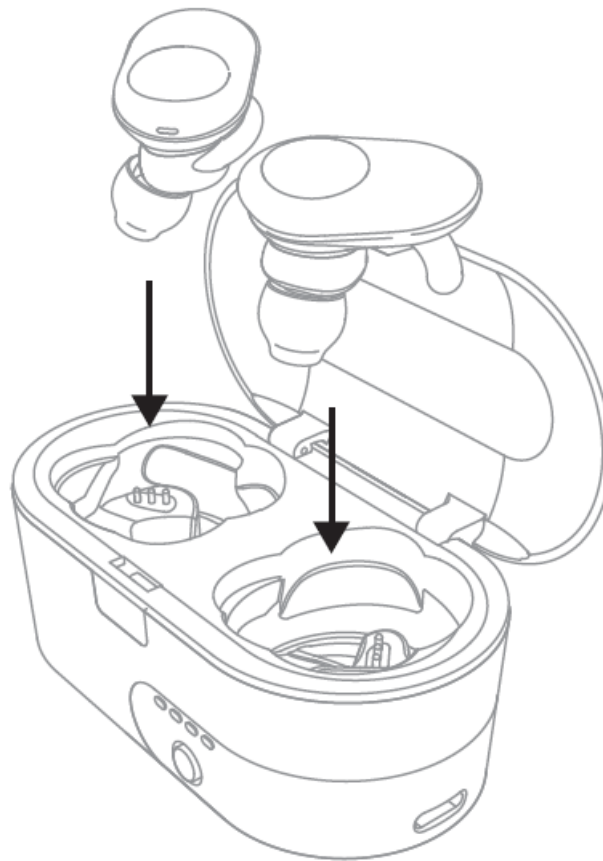

Charge Earbuds

## Pairing Mode

Left Side 01 •Off Mode

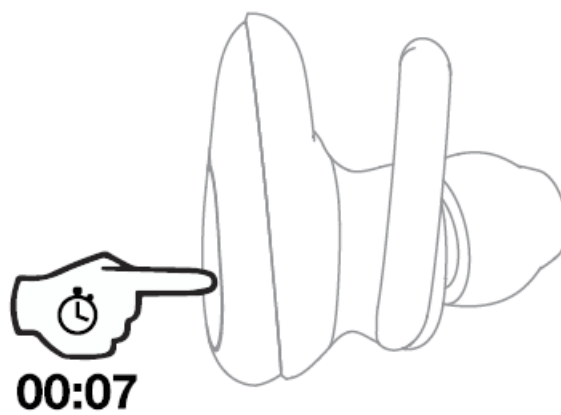

Left Side 01 •Off Mode

## Pair New Device

“Push”

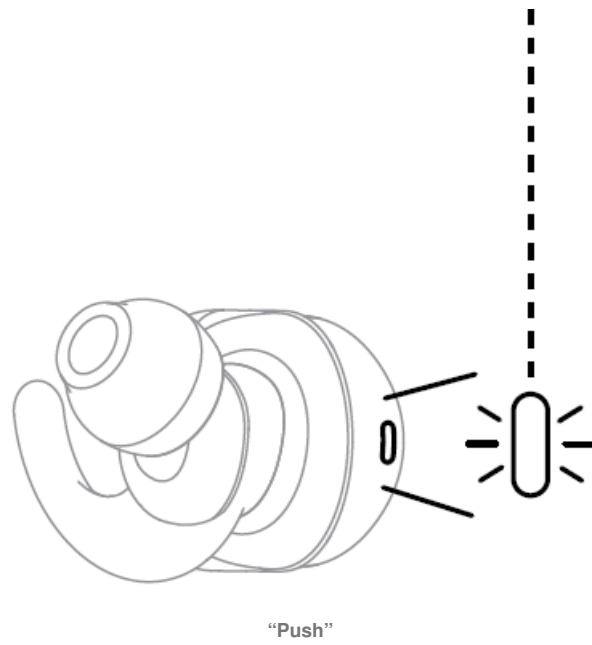

## Power – On/Off

### Left Side 01

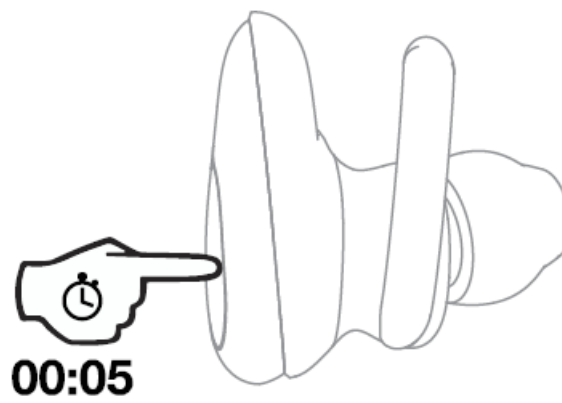

Left Side 01

## Volume Up

### Right Side 02

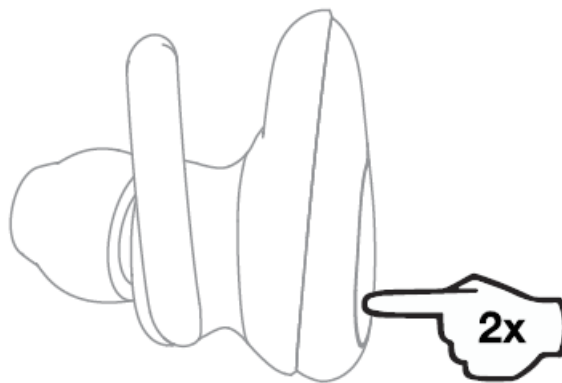

Right Side 02

## Volume Down

Left Side 01

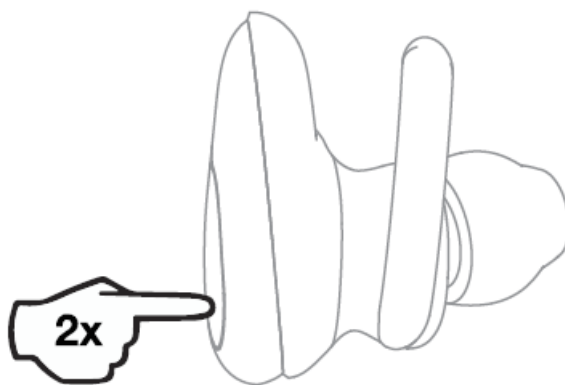

Left Side 01

## Play/Pause

Left 01 or Right 02 Side

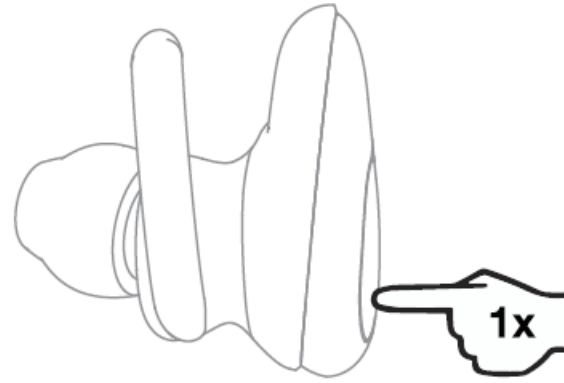
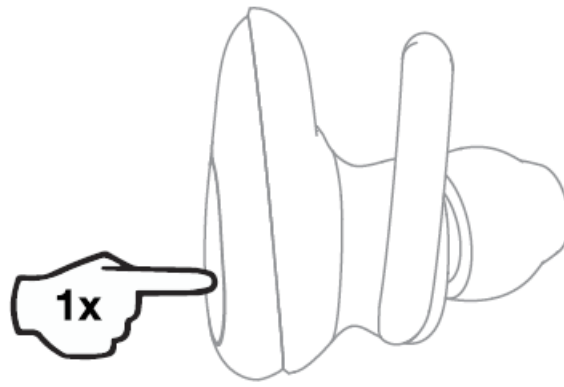

Left 01 or Right 02 Side

## Track Forward

Right Side 02

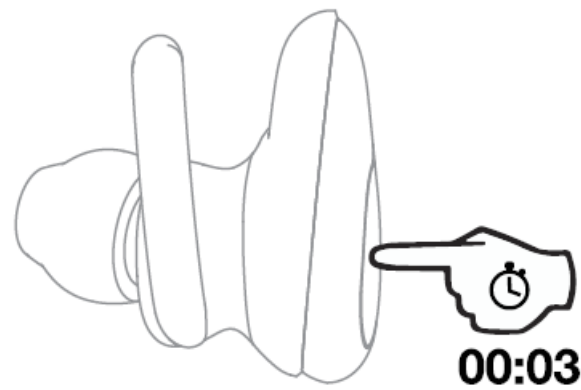

Right Side 02

## Track Back

Left Side 01



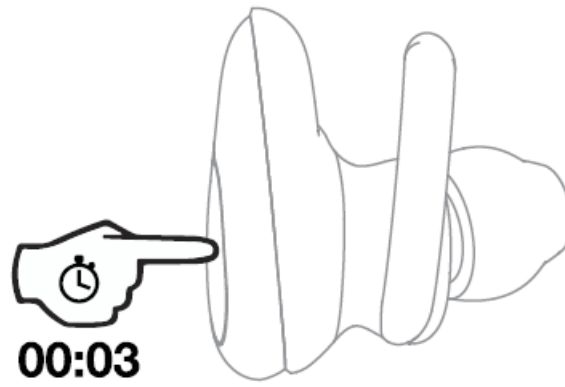

Left Side 01

## Answer/End

Left 01 or Right 02 Side

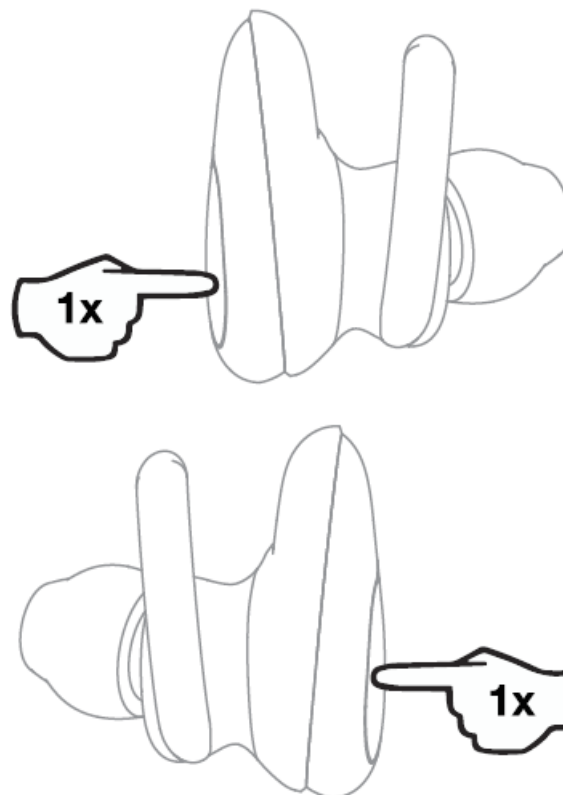

Left 01 or Right 02 Side

## Activate Voice Assistant

Left 0 1 or Right 02 Side

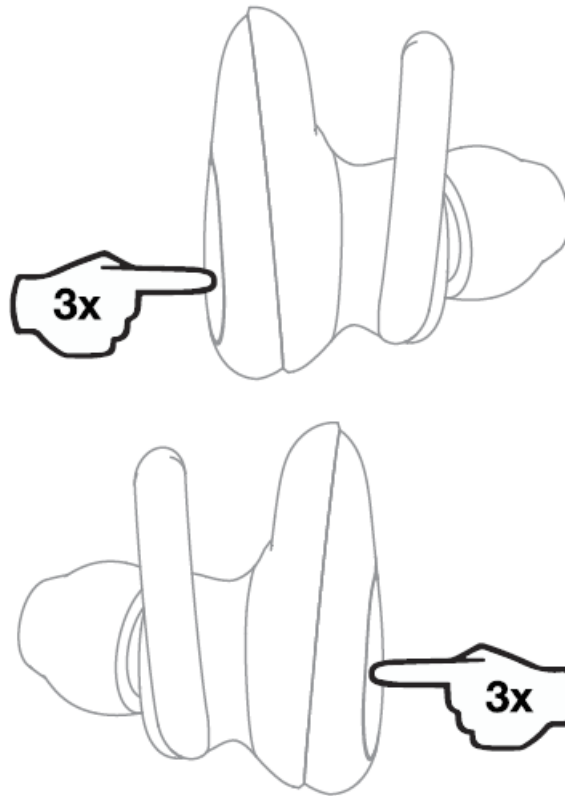

Left 01 or Right 02 Side

**Questions Visit: [www.skullcandy.com](http://www.skullcandy.com)**

#### ISED Statement

This device contains license exempt transmitter / receiver(s) that comply with innovation, Science and Economic Development Canada's license-exempt RSS(s). Operation is subject to the following two conditions:

- (1) This device may not cause interference.
- (2) This device must accept any interference, including interference that may cause undesired operation of the device.

#### ISEC RF Exposure statement

This equipment complies with IC RSS-102 radiation exposure limits set forth for an uncontrolled environment. This transmitter must not be co-located or operating in conjunction with any other antenna or transmitter.

#### The FCC Compliance Statement

This device complies with part 15 of the FCC Rules.  
Operation is subject to the following two conditions:

- (1) This device may not cause harmful interference, and

(2) this device must accept any interference received, including interference that may cause undesired operation. Changes or modifications not expressly approved by the party responsible for compliance could void the user's authority to operate the equipment. This equipment has been tested and found to comply with the limits for a Class B digital device, pursuant to part 15 of the FCC Rules. These limits are designed to provide reasonable protection against harmful interference in a residential installation. This equipment generates, uses and can radiate radio frequency energy and, if not installed and used in accordance with the instructions, may cause harmful interference to radio communication. However, there is no guarantee that interference will not occur in a particular installation. If this equipment does cause harmful interference to radio or television reception, which can be determined by turning the equipment off and on, the user is encouraged to try to correct the interference by

one or more of the following measures:

- Reorient or relocate the receiving antenna.
- Increase the separation between the equipment and receiver
- Connect the equipment into an outlet on a circuit to which the receiver is connected.
- Consult the dealer or an experienced radio /TV technician for help.

[Skullcandy-Push-Manual-Optimized](#)

[Skullcandy-Push-Manual-Original](#)

[Skullcandy-Push-Japanese-Manual](#)

**Questions about your Manual? Post in the comments!**

[Manuals+](#),