

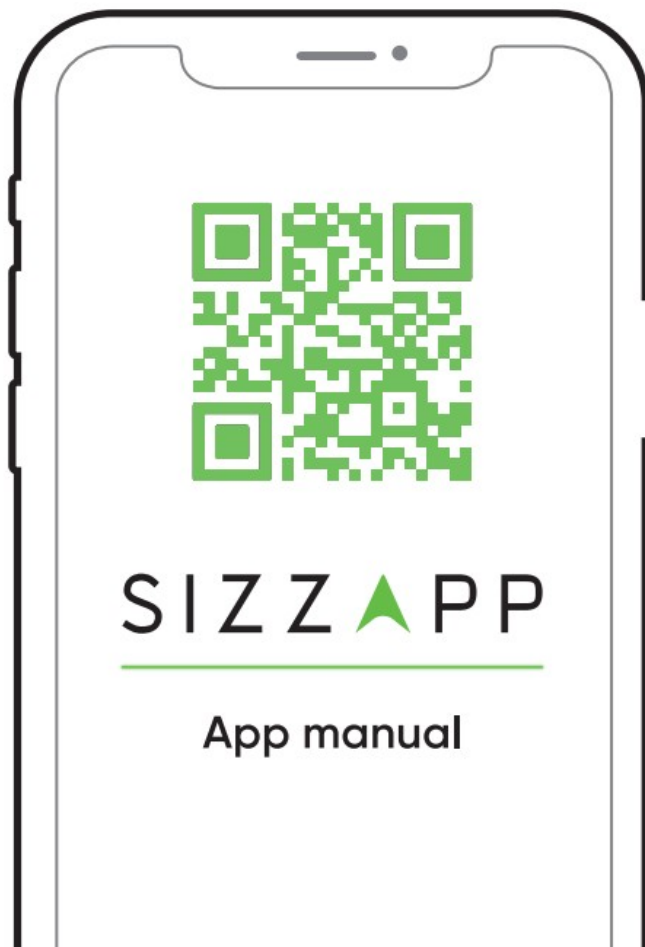

## SIZZAPP Smart Security System App User Guide

[Home](#) » [SIZZAPP](#) » SIZZAPP Smart Security System App User Guide 



[http://l.lead.me/sizzapp\\_app](http://l.lead.me/sizzapp_app)

### Contents

- [1 SIZZAPP APP Manual](#)
- [2 Registration](#)
- [3 Main menu](#)
- [4 Profile](#)
- [5 Device settings](#)
- [6 Map](#)
- [7 Share the trip](#)
- [8 Speed](#)
- [9 Settings](#)
- [10 Organizer](#)
- [11 Settings](#)
- [12 Documents / Resources](#)
- [13 Related Posts](#)

## SIZZAPP APP Manual

SIZZAPP is Smart security system and reliable trip mate for your vehicle.

It is a compact, easy to install monitoring device without contract and monthly fees.

Track your vehicle location, protect it from thefts and receive notifications even if you are not around.

With the help of this document, you will learn everything about working with the SIZZAPP application, from how to register an account to all the features available in the application.

SIZZAPP App Tutorial can be also found in video format:



<http://l.ead.me/bcrJ8L>

## Registration



App language

Field for entering the code received via SMS

User country code



Registration / Authorization Screen

Code Confirmation Screen

1. Sending a request to receive SMS with a 4-digit authorization code
2. Go to code entry screen (code valid for 10 minutes)
  1. Enter the code received via SMS
  2. Authorization and login to the application

## Main menu

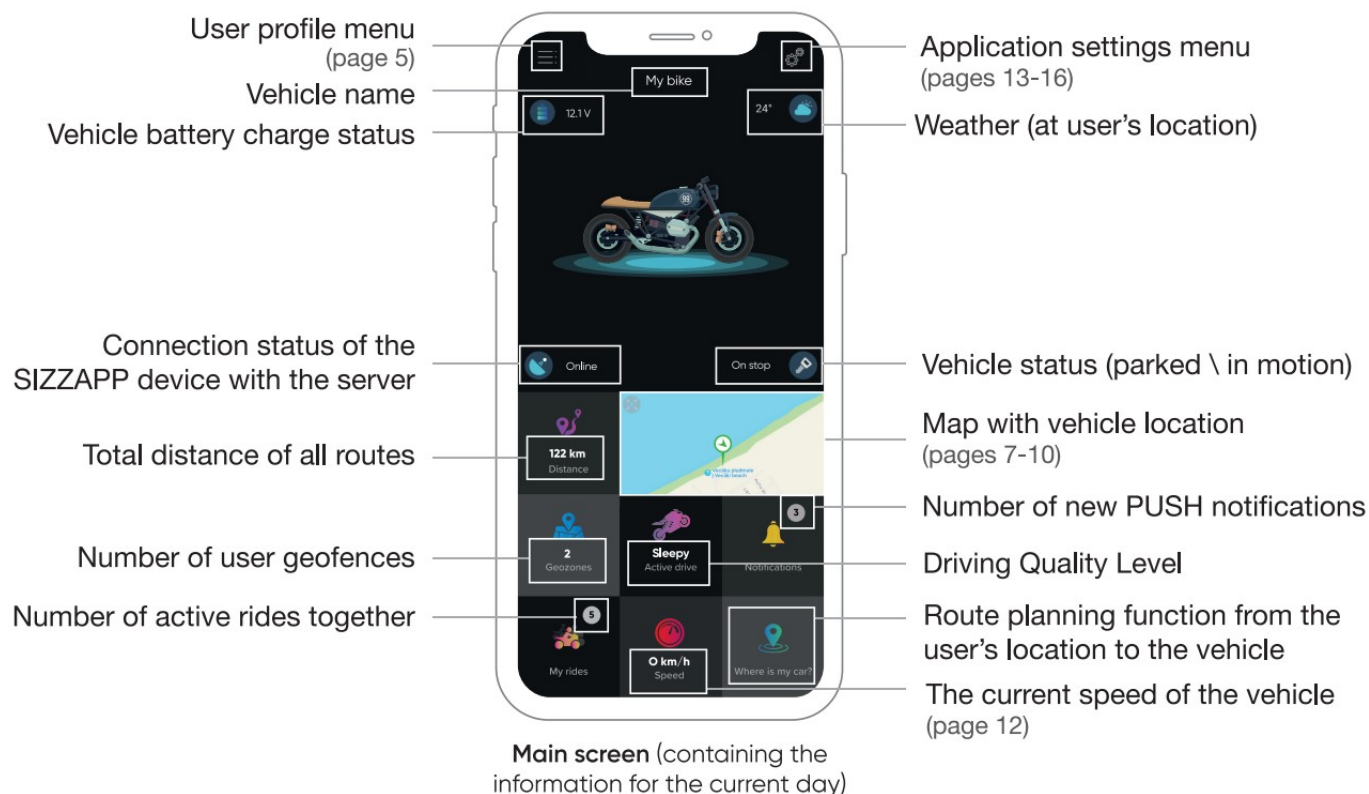

## Profile

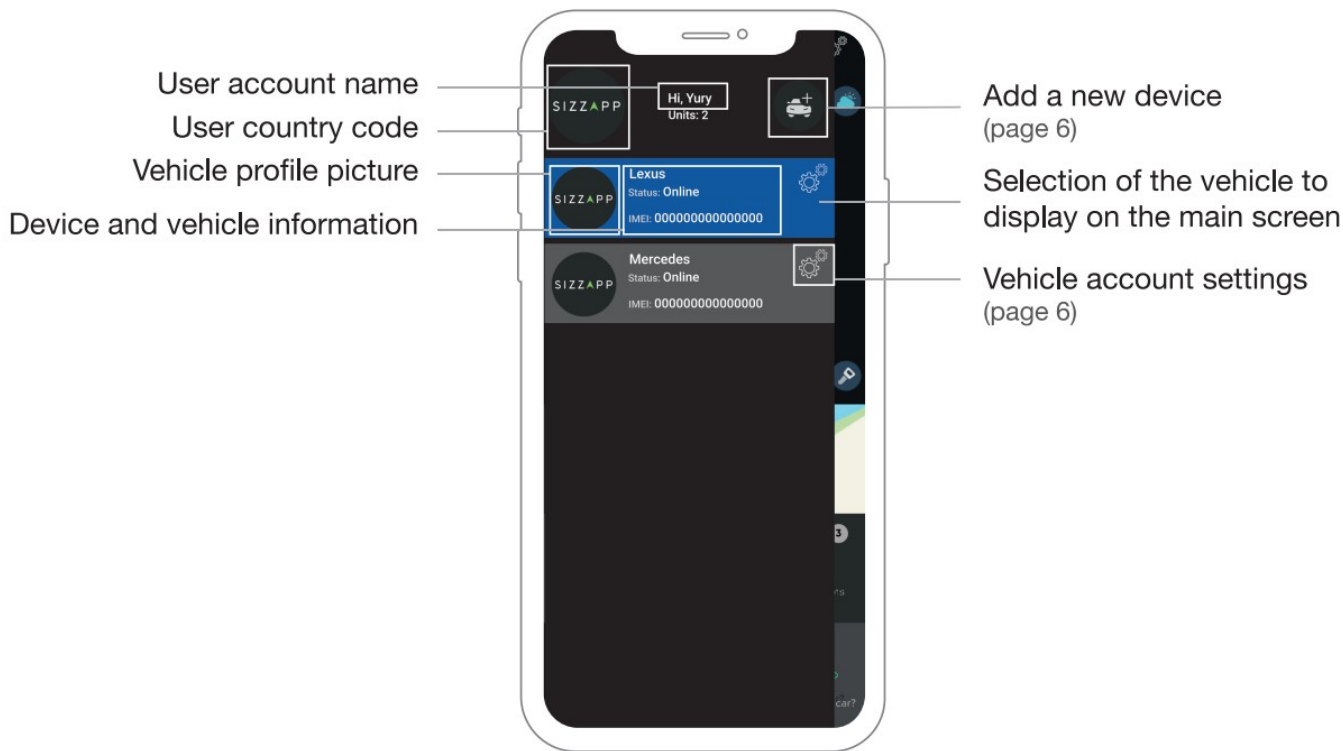

Profile and vehicle management screen

## Device settings

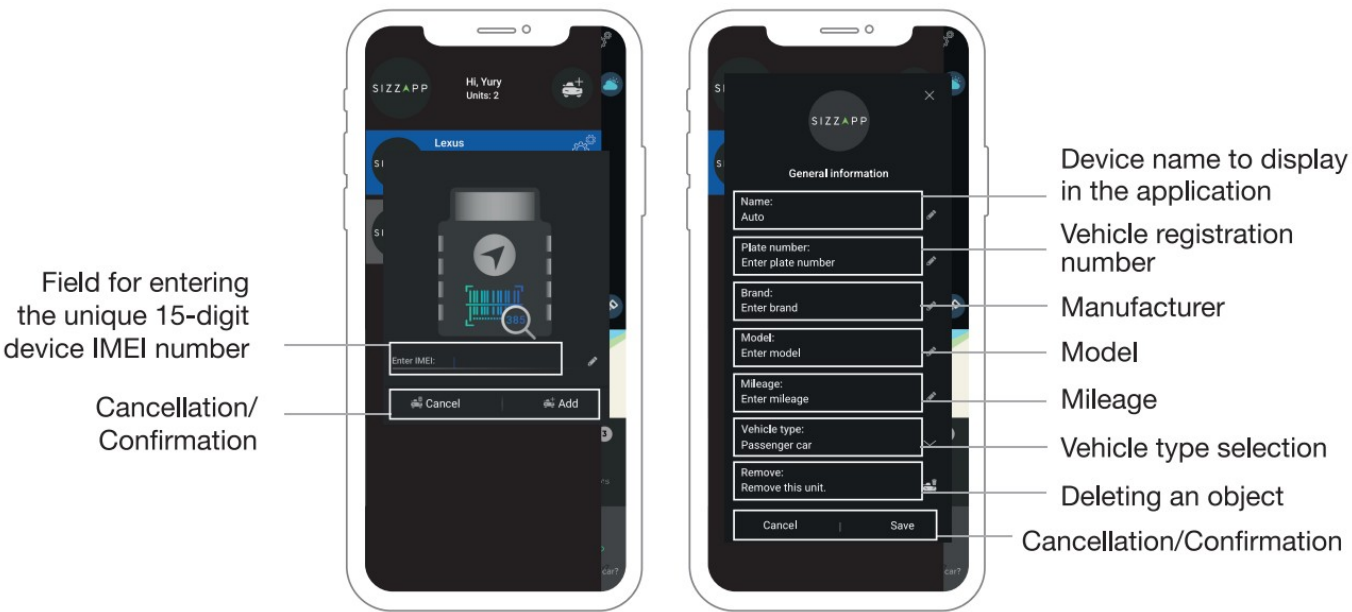

New device account adding screen    Device account settings screen

## Map

## Routes

Field for entering the unique 15-digit device IMEI number

Cancellation/Confirmation

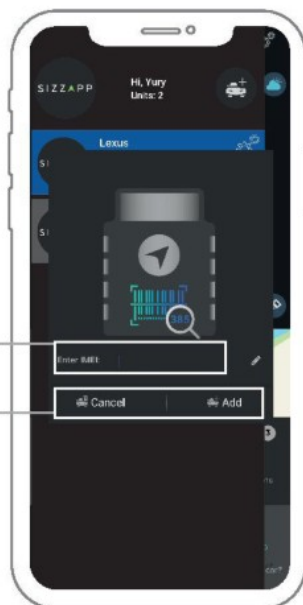

Device name to display in the application

Vehicle registration number

Manufacturer

Model

Mileage

Vehicle type selection

Deleting an object

Cancellation/Confirmation

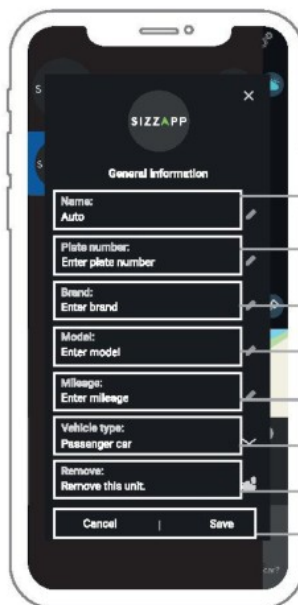

## New device account adding screen Device account settings screen

### Routes

Displaying the current location of the vehicle

Share trips (page 11)

Visual display of routes and stops

Open list of routes and stops

Summary statistics for the selected period

Go to home screen



Route history screen



List of routes and stops screen

Selecting a period

List of routes and stops

### Sleepy

Opening / closing  
the list and calendar



Selecting a period

Showing the  
addresses where the  
maximum values  
have been reached

Driving style screen  
(depending on the type of transport selected)

## Geofences

Opening / closing  
the list and calendar

List of active  
geofences

To delete a geofence,  
drag to the left

Creating a  
new geofence

Geofence  
notifications  
settings

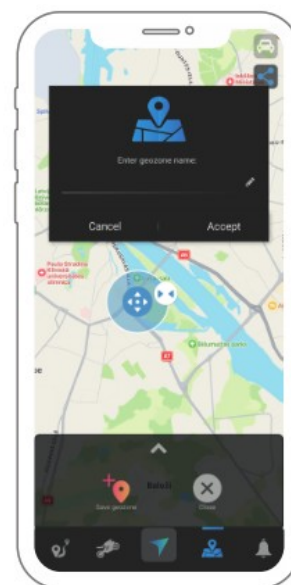

Geofence screens

## Notifications



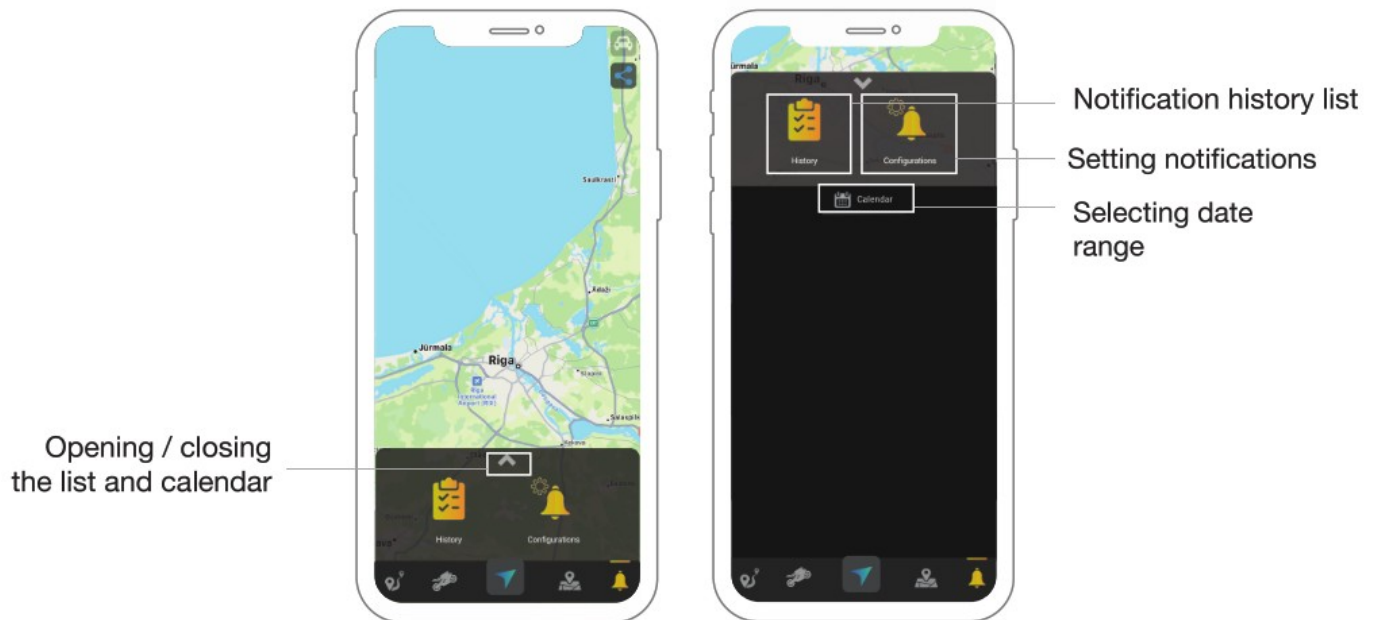

Notifications screens

## Share the trip

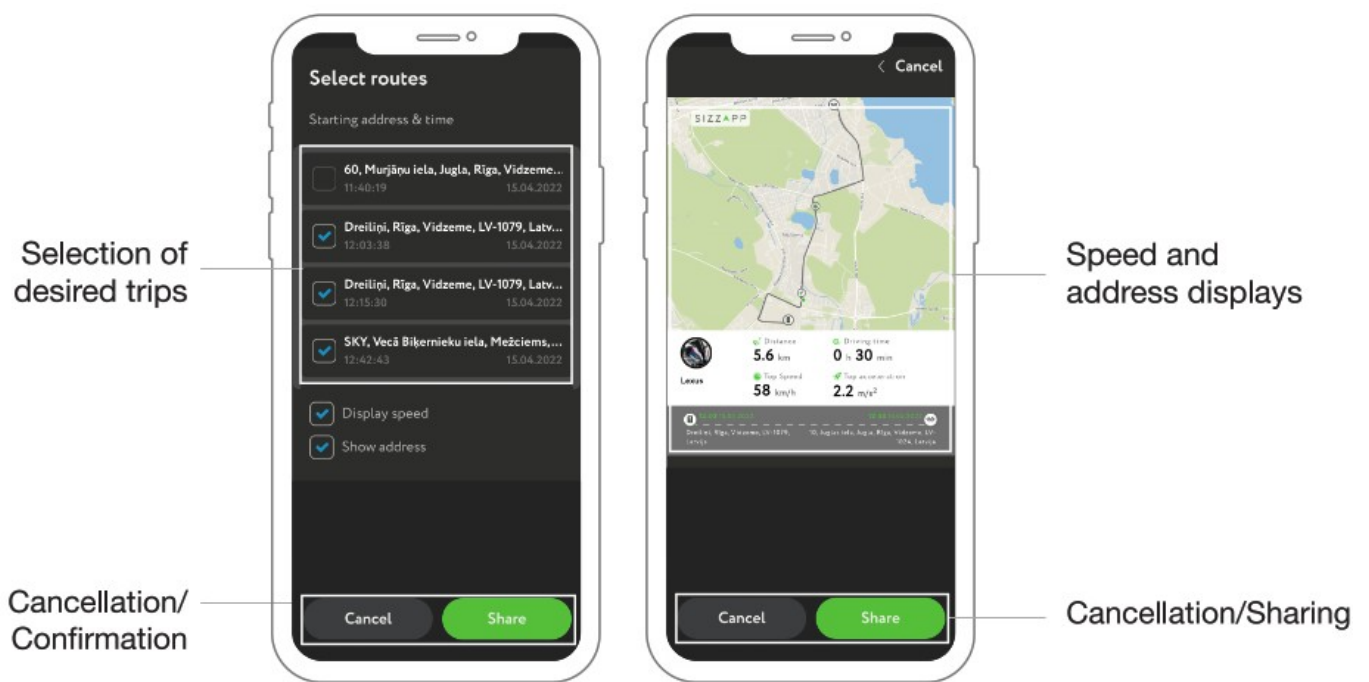

Route Selection screen  
step 1

Sharing Trips screen  
step 2

## Speed

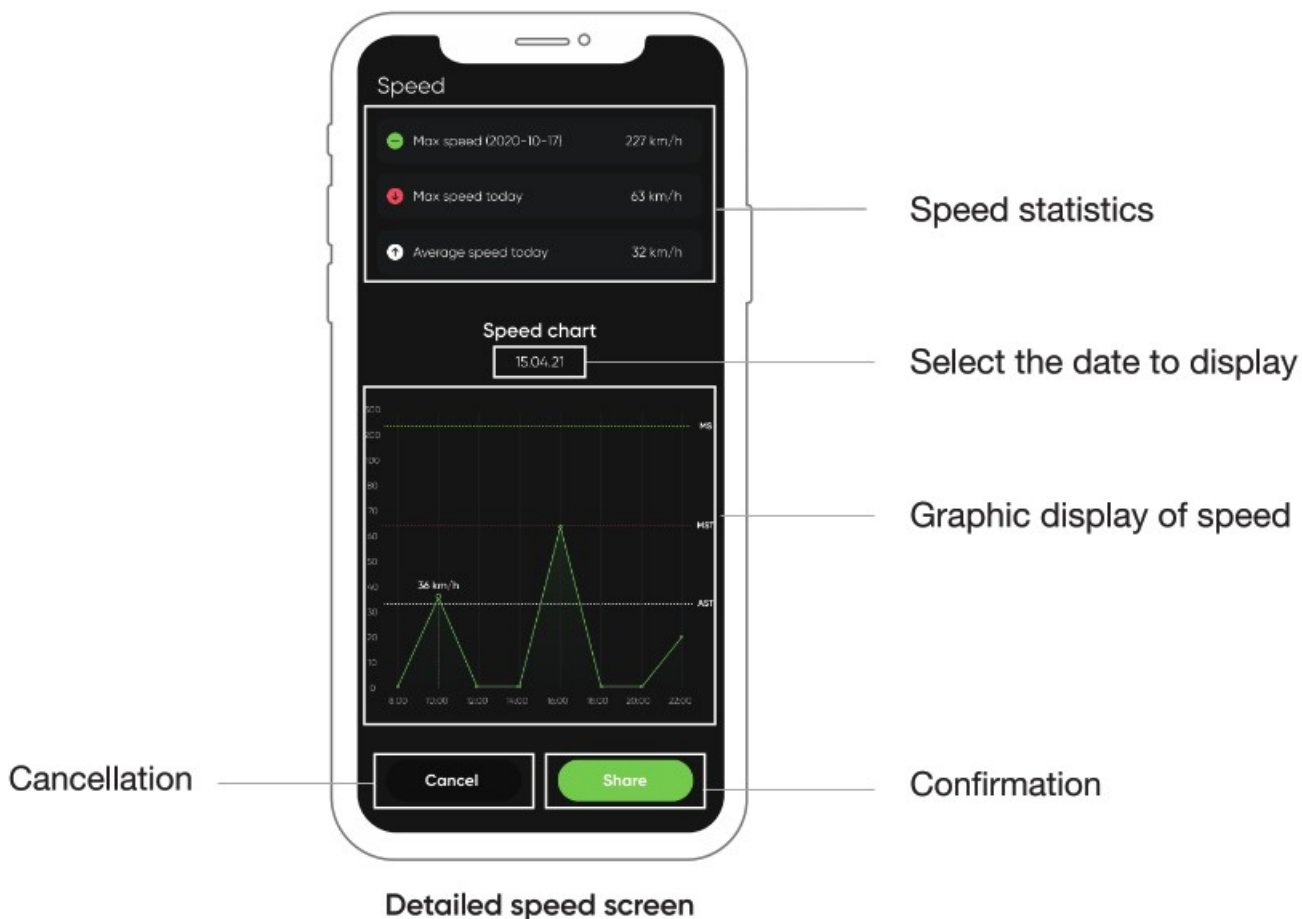

## Settings

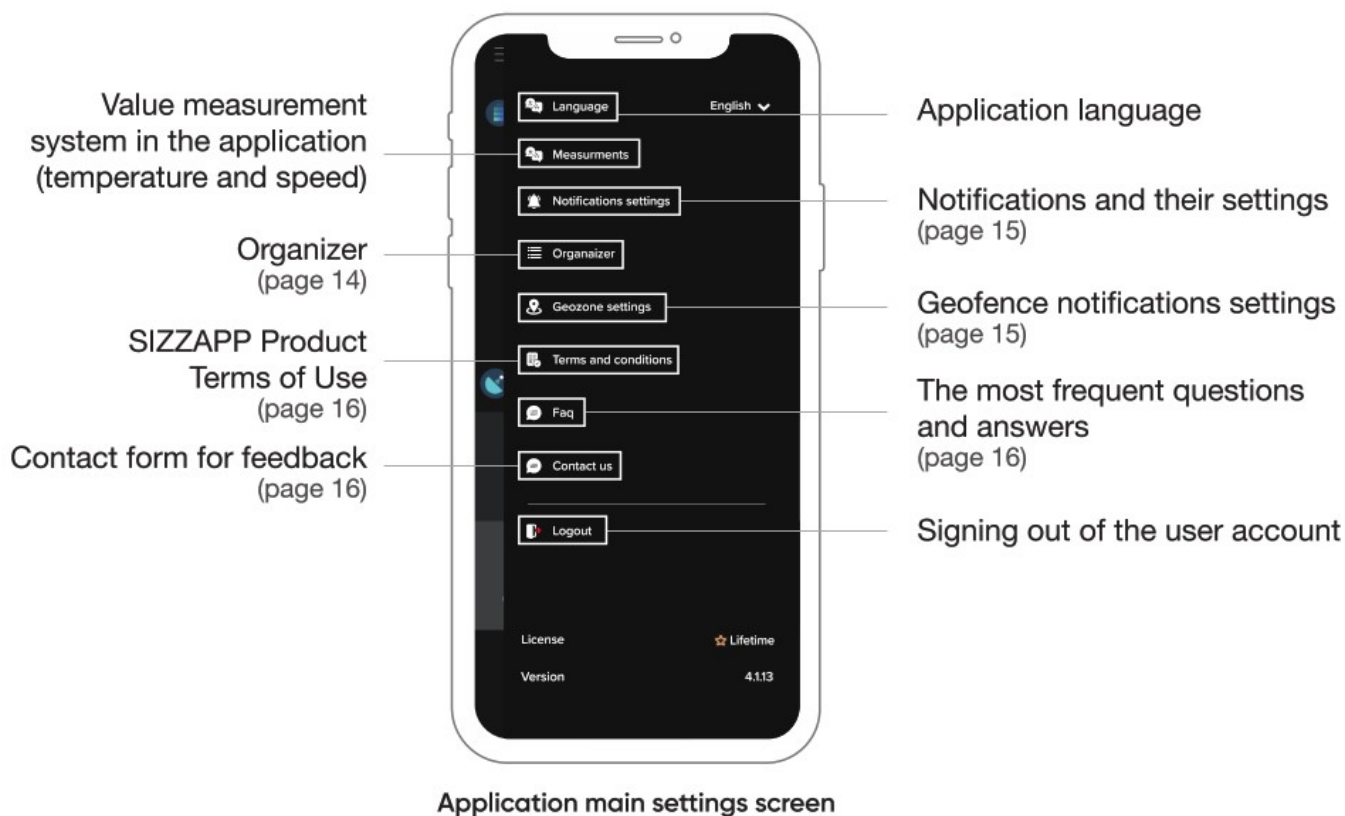

## Organizer



Methods for receiving notifications

Available event types

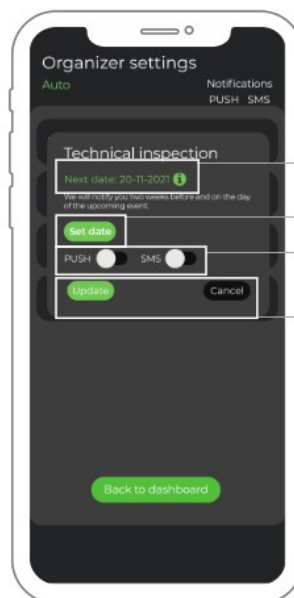
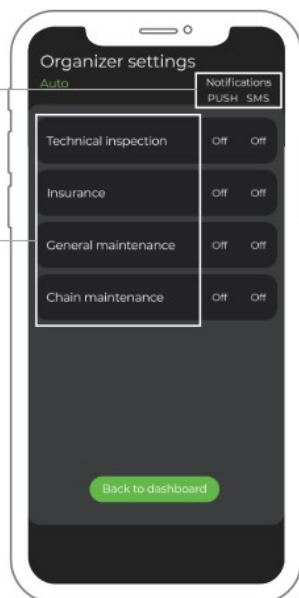

Scheduled date

Selecting a new date

Choosing a notification method

Confirmation/  
Cancellation

Organizer settings screen

Technical inspection event screen

## Settings

Methods for receiving notifications

Types of available notifications

Confirmation

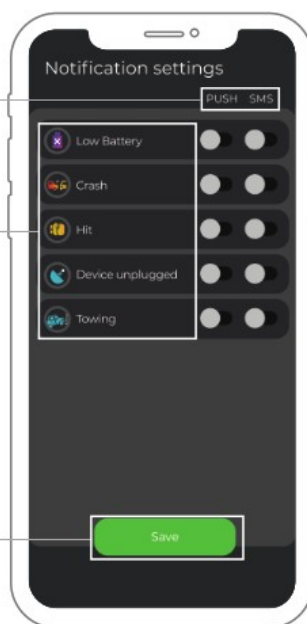

Notification settings screen

Options for sending notifications (when entering or leaving the geofence)

List of created geofences

Confirmation

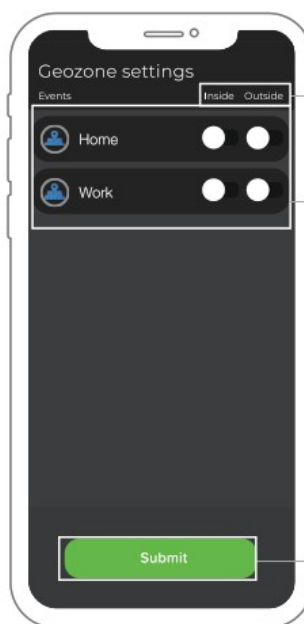

Geofence notifications settings screen

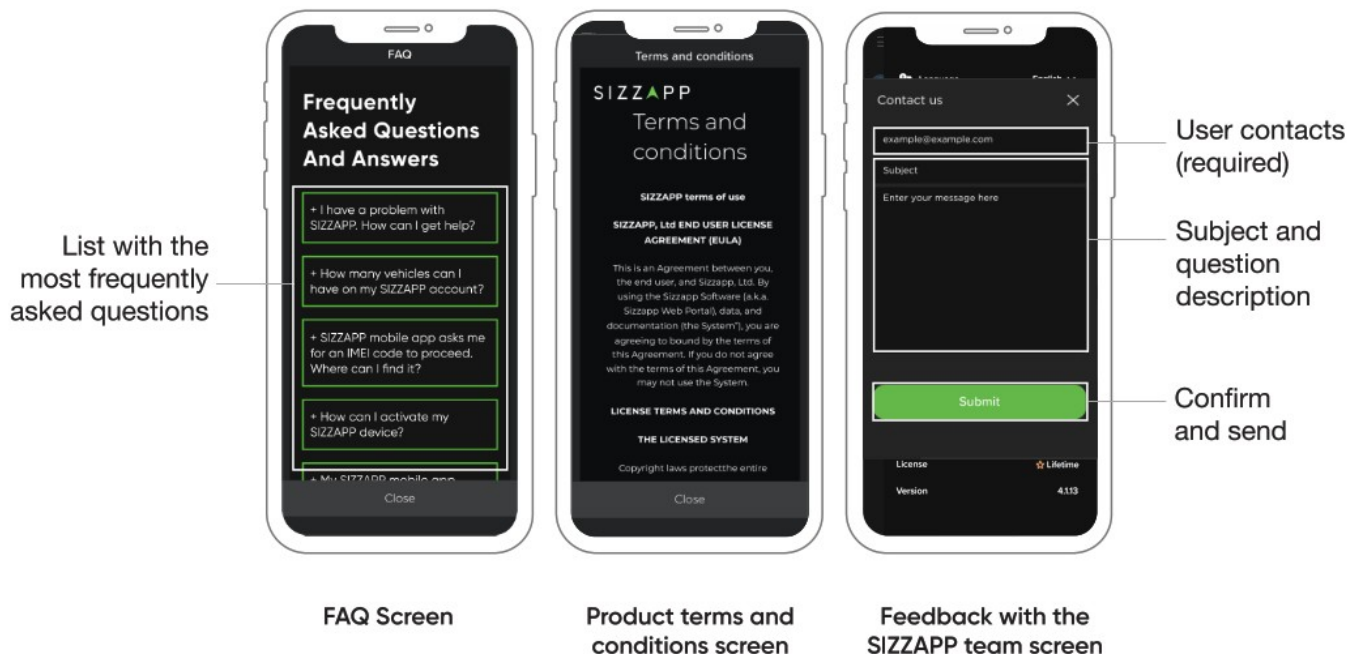

# SIZZAPP

The future of vehicle security

## Documents / Resources

|   |   |
|---|---|
|  | <a href="#">SIZZAPP Smart Security System App [pdf] User Guide</a><br>Smart Security System App, Smart Security System, App |
|---|---|