



# Sistemamt TOUCH 512 DMX Controller User Guide

[Home](#) » [Sistemamt](#) » Sistemamt TOUCH 512 DMX Controller User Guide 

## Contents

- [1 Sistemamt TOUCH 512 DMX Controller](#)
- [2 Product Information](#)
- [3 Product Usage Instructions](#)
- [4 Safety instructions](#)
- [5 Features](#)
- [6 TOUCH mounting](#)
- [7 Panel operation](#)
- [8 Pin Terminal Pinout](#)
- [9 Documents / Resources](#)
- [10 Related Posts](#)

# SISTEMA

## Sistemamt TOUCH 512 DMX Controller



## Product Information

The TOUCH 512 / 1024 is an ultra-thin wall-mounted glass panel and DMX lighting controller. It is intended to

control lighting devices and effects via computer using appropriate software. The device features fine wheel control for RGB colors, CCT, speed, dimmer scenes, up to 8 per zone pages, up to 5 with 8 scenes per page, scene recovery if power cut off/default start scene, clock schedule setup easily per hour, day, week, month, year, and repeat year, crossfade time between scenes, standby panel display animations, auto blackout LED panel after 4 seconds, 16-bit and fine channel management, and master/slave synchronization. Up to 32 devices can be connected for synchronization.

## **Product Usage Instructions**

Before using the TOUCH 512 / 1024, read and follow the safety advice and instructions given in the quick start guide. Ensure that plastic bags, packaging, etc. are disposed of properly and are not within reach of babies and young children to avoid choking hazards. Ensure that children do not detach any small parts from the product as they could swallow the pieces and choke.

To operate the device:

1. Choose the zone or page by tapping on the zone selection or page selection button (depending on the model).
2. Select a scene number (1-8) for the chosen zone or page.
3. Choose a color by picking RGB-AW color for the selected zone (in color mode) or cool to warm white for the selected zone (in CCT mode).
4. Dial the wheel to adjust light intensity (+/-) in dimmer mode.
5. Use the wheel to adjust the brightness for the selected zone (active for 5 seconds) in dimmer mode activation.
6. Use the wheel to pick the RGB-Amber-White color. Hold for 3 seconds to enter cool/warm white mode in color mode activation.
7. Use the wheel to start or stop the selected scene in scene mode activation.
8. Use the wheel to change the current scene speed (active for 5 seconds) in speed mode activation.
9. Dial the wheel to adjust the scene playback speed (+/-) in speed mode.
10. Tap to cancel wheel settings (hold for 3 seconds for blackout) in on/off mode.
11. Use the tactile wheel picker and dial to adjust color temperature, intensity (+/-), speed (+/-), and scenes.

The device can be programmed and played back using appropriate software and connected to other devices for synchronization using the 7-Pin Terminal Pinout or RJ45 Pinout as per the instructions provided in the user manual.

### **Ultra thin wall mountad Glass panel and DMX lighting controller**

This quick start guide contains important information on the safe operation of the product. Read and follow the safety advice and instructions given. Retain the quick start guide for future reference. If you pass the product on to others please include this quick start guide.

## **Safety instructions**

### **Intended use:**

This device is intended to control lighting devices and effects via computer using appropriate software. Any other use or use under other operating conditions is considered to be improper and may result in personal injury or property damage. No liability will be assumed for damages resulting from improper use.

### **General handling:**

- Never use force when handling the product

- Never immerse the product in water
- Just wipe it with a clean dry cloth.
- Do not use liquid cleaners such as benzene, thinners or flammable cleaning agents

## Features

### Hardware features:

512 or 1024 channels DMX output 512 (1 zone), 1024 (5 zones with zone combinations) Fine Control touch wheel Play Scene, Color, Speed, Dimmer, Zones or Pages Internal memory + Micro SD card slot 4 Contacts on 3~5V Real Time Clock and calendar for each scene USB-C (5V. DC, 0.1A), RJ45 (Contacts, Master/Slave) 7 Pin Terminal Block (DMX1, DMX2, DC Power) Power input: 5~36V DC, 0.1A / Output: 5V DC Housing: ABS, glass (panel) Dimensions : H: 144 (5.67) / W: 97 (3.82) / D: 10 (0.39) Operating Temperatures: -40 to +85 C° / -40 to 185 F° International Warranty: 5 years

### Never use the product:

- In direct sunlight
- In conditions of extreme temperature or humidity
- In extremely dusty or dirty areas
- At locations where the unit can become wet
- Near magnetic fields

### Danger for children:

Ensure that plastic bags, packaging... are disposed of properly and are not within reach of babies and young children. Choking hazard! Ensure that children do not detach any small parts from the product. They could swallow the pieces and choke!

### Device options:

Fine wheel control for RGB Colours, CCT, Speed, Dimmer Scenes, up to 8 per Zone Pages, up to 5 with 8 scenes per page Scene Recovery if power cut off / Default start scene Clock schedule setup easily per hour, day, week, month, year and repeat year. Cross Fade time between scenes Standby panel display animations Auto blackout LED panel after 4s 16-bit and fine channel management Master/Slave synchronization, connect up to 32 devices

## TOUCH mounting

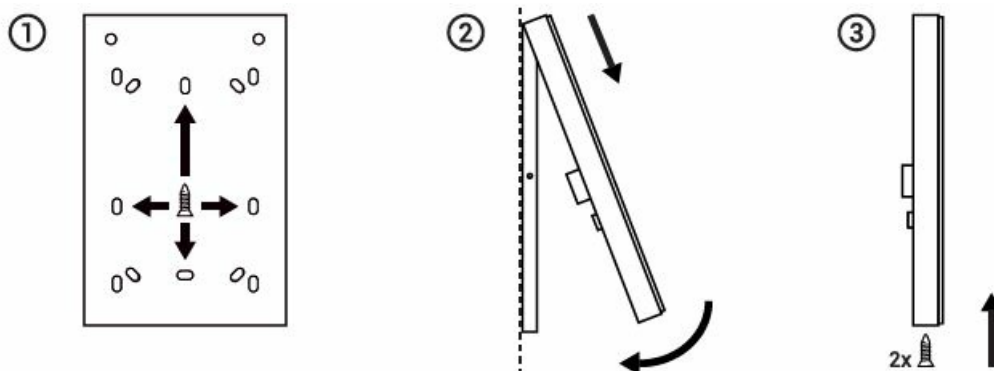

## Panel operation

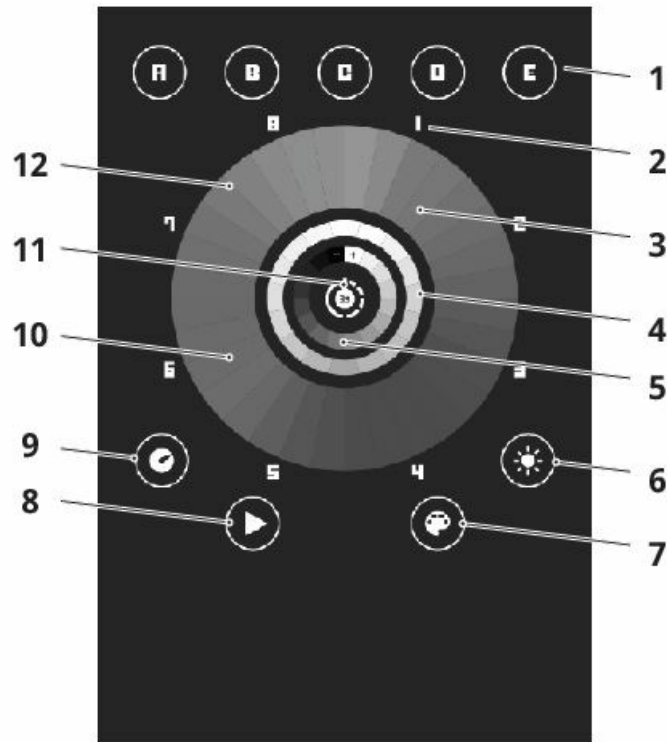

**1. Zone selection (TOUCH 1024) | Page selection (TOUCH 512)**

Tap to select zones/Pages individually. Hold 2s to combine Zones

**2. Scenes #**

Pick 1-8 (8 scenes per Zone or Page)

**3. Colour wheel**

Pick RGB-AW colour for the selected zone (Colour mode selected)

**4. Colour temperature**

Pick cool to warm white for the selected zone (CCT mode selected)

**5. Dimmer intensity**

Dial the wheel to adjust light intensity (+/-) (Dimmer mode selected)

**6. Dimmer mode activation**

Use the wheel to adjust brightness for selected zone (Active for 5s)

**7. Colour mode activation**

Use the wheel to pick RGB-Amber-White colour. Hold 3s to enter cool/warm white mode

**8. Scene mode activation**

Use the wheel to start or stop the selected scene

**9. Speed mode Activation**

Use the wheel to change the current scene speed (Active for 5s)

**10. Scene speed**

Dial the wheel to adjust scene playback speed (+/-) (Speed mode selected)

**11. On / Off**

Tap to cancel wheel settings (Hold 3s for black out)

**12. Tactile wheel picker and dial**

Adjust colour temperature, intensity (+/-) or speed (+/-) and scenes

**Pin Terminal Pinout**

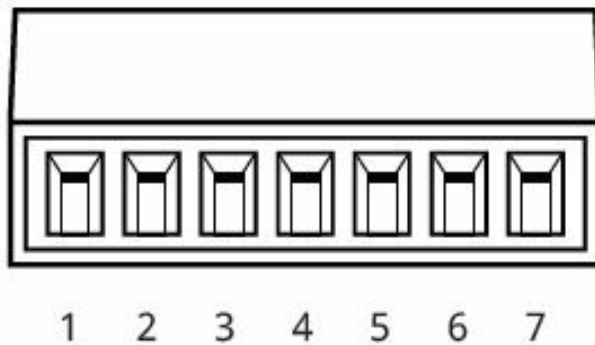

1. DMX1-
2. DMX1+
3. GND (DMX 1+2)
4. DMX2-
5. DMX2+
6. GND (Power Input)
7. DC Power Input (VCC, 5-36V / (0.1A)

#### **RJ45 Pinout**

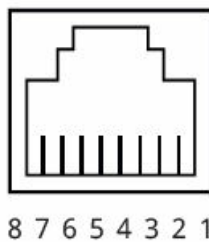

1. GND
2. 5V DC Output – For triggers
3. 6TRIG A, B, C, D – Dry Contact pins
4. M/S DATA – Master/Slave Data
5. M/S CLK – Master/Slave Clock

#### **Programming the device and Playback**

- Download and install the free lighting control software and USB drivers
- Connect your device to your computer via the included USB-C cable
- Start the software (your interface will be detected automatically)
- Configure the software according your DMX lighting fixture setup
- Program scenes and sequences using the lighting control software
- Save the programmed scenes and sequences into the internal memory
- Close the software. Your panel is now ready to operate in standalone mode
- Serial Numbers T00200 and higher

#### **Documents / Resources**

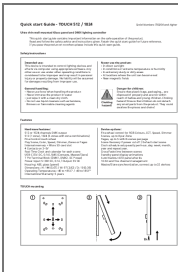

**Sistemamt TOUCH 512 DMX Controller** [pdf] User Guide  
TOUCH 512, TOUCH 1024, TOUCH 512 DMX Controller, DMX Controller, Controller