



SIP INDUSTRIAL 09586 Universal Halogen Heater with Remote User Guide

[Home](#) » [SIP INDUSTRIAL](#) » SIP INDUSTRIAL 09586 Universal Halogen Heater with Remote User Guide

SIP INDUSTRIAL 09586 Universal Halogen Heater with Remote User Guide



Please dispose of packaging for the product in a responsible manner. It is suitable for recycling. Help to protect the environment, take the packaging to the local amenity tip and place into the appropriate recycling bin.



Never dispose of electrical equipment or batteries in with your domestic waste. If your supplier offers a disposal facility please use it or alternatively use a recognised recycling agent. This will allow the recycling of raw materials and help protect the environment.

Contents [[hide](#)

- 1 SAFETY SYMBOLS
- 2 SAFETY INSTRUCTIONS
- 3 SPECIFIC SAFETY INSTRUCTIONS
- 4 WIRING DIAGRAM
- 5 SPECIFIC SAFETY INSTRUCTIONS....cont
- 6 TECHNICAL SPECIFICATIONS
- 7 GUARANTEE
- 8 MAINTENANCE
- 9 OPERATING INSTRUCTIONS
 - 9.1 Manual Operation
 - 9.2 Remote Operation
- 10 ELECTRICAL CONNECTION
- 11 ASSEMBLY INSTRUCTIONS....cont
- 12 Documents / Resources
- 13 Related Posts

SAFETY SYMBOLS



Danger / Caution: Indicates risk of personal injury and/or the possibility of damage.



Warning: Risk of electrical injury or damage!



Note: Supplementary Information.

SAFETY INSTRUCTIONS



IMPORTANT: Please read the following instructions carefully, failure to do so could lead to serious personal injury and / or damage to the heater.

When using your heater, basic safety precautions should always be followed to reduce the risk of fire, electric shock, personal injury and / or damage to the heater. Read all these instructions before operating the heater and save this user manual for future reference.

SIP recommends that this heater should not be modified or used for any application other than that for which it was designed; It was designed for the short term heating of offices etc. If you are unsure of its relative applications do not hesitate to contact us and we will be more than happy to advise you.

- **KNOW YOUR HEATER:** Read and understand the owner's manual and labels affixed to the heater. Learn its applications and limitations, as well as the potential hazards specific to it.
- **DO NOT USE THE HEATER IN DANGEROUS ENVIRONMENTS:** Do not use your heater in damp or wet locations, including bathrooms or similar or expose it to rain. Always provide adequate space around the heater.
- **DO NOT OPERATE THE HEATER IN EXPLOSIVE ATMOSPHERES:** Do not use the heater in the presence of flammable liquids, gases, dust or other combustible sources.
- **KEEP CHILDREN AND UNTRAINED PERSONNEL AWAY FROM THE WORK AREA:** All visitors should be kept at a safe distance from the work area.
- **STORE THE HEATER SAFELY WHEN IT IS NOT IN USE:** The heater should be stored in a dry, locked

cupboard, or similar when not in use wherever possible and out of the reach of children.

- **STAY ALERT:** Always watch what you are doing and use common sense.
- **DISCONNECT THE HEATER FROM THE MAINS SUPPLY:** When not in use.
- **AVOID UNINTENTIONAL STARTING:** Make sure the switch is in the OFF position before connecting the heater to the mains supply.
- **DO NOT ABUSE THE MAINS LEAD:** Never carry the heater by the mains lead or pull it to remove the plug from the mains socket. Keep the mains lead away from heat, oil and sharp edges. If the mains lead is damaged, it must be replaced by the manufacturer or its service agent or a similarly qualified person in order to avoid unwanted hazards.
- **HAVE YOUR HEATER REPAIRED BY A QUALIFIED PERSON:** The heater is in accordance with the relevant safety requirements. Repairs should only be carried out by qualified persons using original spare parts, otherwise this may result in considerable danger to the user.
- **WARNING! RISK OF ELECTRIC SHOCK.** Do not expose the heater to water spray, rain, dripping water or moisture of any kind.
- **WARNING!** Do not direct the front of the heater towards any combustible materials (e.g. wooden items, cloth, plastics, paper, etc).
- **DANGER!** Check that the heater is in sound condition and good working order. Take immediate action to repair or replace damaged parts.
- **WARNING!** Do not use the heater near flammable material, liquids, solids, gases or compressed gas cylinders.
- **NEVER** use this heater where flammable vapours may be present.
- **NEVER** cover the heater, or obstruct the inlet or outlet. It may cause fire risk.
- **NEVER** move or handle heater while still hot.
- **ALWAYS** locate heater on a stable and level surface.
- **ALWAYS** unplug the heater when not in use.
- Use recommended parts only – Unapproved parts may be dangerous and will invalidate the warranty.
- Only operate on a level and stable surface.
- Do not allow untrained persons to operate the heater and do not operate the heater without all covers etc. correctly fitted.
- Do not move or handle the heater when it is running or still hot – always turn it off and allow it to cool.
- Do not leave the heater unattended when in use. Switch the heater off and unplug from the mains supply before leaving the work area.
- Do not obstruct the air inlet (rear) and air outlet (front) of the heater.
- Do not use any form of ducting in front or at the rear of the heater.
- Do not touch the heater outlet or any internal parts when first switched off as these can be hot and will take time to cool.
- Ensure that the heater is correctly turned off when not in use and store in a safe, dry area, out of reach of children.
- Do not unplug the heater to switch it off – always use the on/off switch.
- Do not use this heater in the immediate surroundings of a bath, a shower or a swimming pool.

SPECIFIC SAFETY INSTRUCTIONS

- Keep all combustible materials away from this heater.
- Do not dismantle or tamper with the heater, as this may be dangerous and will invalidate the warranty.
- If the heater is used in a place of work all rules and laws etc. relating to the use of portable electrical appliances should be followed.
- Never stand on the heater.
- Never allow children to 'play' with the heater – It is not a toy.
- Cleaning and maintenance procedures should not be carried out by children without supervision.
- Children under 3 years old should be kept away from the heater unless continuously supervised.
- The heater should not be placed directly below the outlet socket.
- Children aged from 3 years and less than 8 years shall only switch on/off the heater provided that it has been placed or installed as intended normal operating position and they have been given supervision or instruction concerning use of the appliance in a safe way and understand the hazards involved. Children aged from 3 years and less than 8 years shall not plug in, regulate and clean the heater or perform user maintenance.
- Never connect any other electrical appliances to the same socket as the heater.
- Understand the operating environment; Before each use the operator should assess, understand and where possible reduce the specific risks and dangers associated with the operating environment. Bystanders should also be made aware of any risks associated with the operating environment.
- When using the heater for the first time, you may notice a slight emission of smoke, or a slight burning smell. This is normal and will stop after a short time; Some parts of the heater are coated for protection during shipping / storage.
- Use only the electrical power (voltage and frequency) specified on the specification label of the heater.
- Never place hands under the heating elements.
- This heater can be used by children aged from 8 years and above and persons with reduced physical, sensory or mental capabilities or lack of experience and knowledge if they have been given supervision or instruction concerning use of the appliance in a safe way and understand the hazards involved. Children shall not play with the appliance.
- Cleaning and user maintenance shall not be made by children without supervision.
- **WARNING:** Risk of Electric Shock!
If a problem with the heater is experienced, or if the mains lead or plug become damaged, stop operation and contact your distributor for repair.

WIRING DIAGRAM

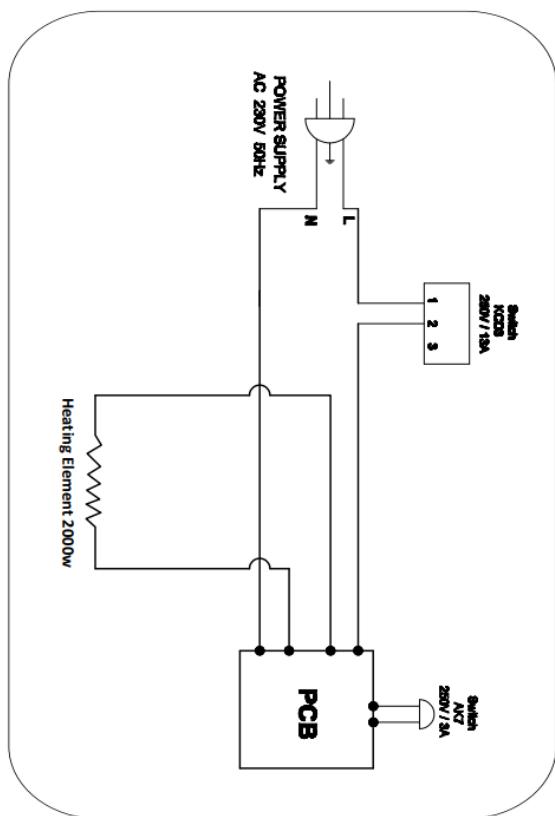

SPECIFIC SAFETY INSTRUCTIONS....cont



CAUTION: The warnings and cautions mentioned in this user manual can not cover all possible conditions and situations that may occur. It must be understood by the operator that common sense and caution are factors which cannot be built into this product, but must be applied.



CAUTION: During normal operation some parts of the heater become very hot and could cause burns. Particular attention should be given where children and vulnerable people are present.



CAUTION: These heaters have multiple fixing applications. They are not fitted with “Safety Tilt Switches”, so extra care should be taken when mounting them on a stand. Always place on a level suitable surface and never leave unattended.

TECHNICAL SPECIFICATIONS

Model	09586 SIP Universal Halogen Heater c/w Remote
Input Voltage	230v ~ 50Hz
Power	2000w
Heat Settings / Source	2 / Halogen Short Wave Infra-Red
IP Rating	IP55
Weight	1.9kg
Packaged Dimensions	675W x 105H x 72D mm

GUARANTEE

This SIP Universal heater is covered by a 12 month parts and labour warranty covering failure due to manufacturers defects. This does not cover failure due to misuse or operating the machine outside the scope of this manual.

In the unlikely event of warranty claims, contact your distributor as soon as possible. Proof of purchase will be required before any warranty can be honoured.



Note: Proof of purchase will be required before any warranty can be honoured.

MAINTENANCE

Before cleaning or maintenance operations always turn the the heater off and remove the plug from the mains supply. Allow it to cool down before any operation.

- Clean the heater with a soft dry cloth only.
- DO NOT use abrasives or solvents.
- Periodically check the heater grill to ensure that it is not blocked.
- Check the main lead and the socket to ensure there are no damage.

DO NOT dismantle or tamper with the heater, as this may be dangerous and will invalidate the warranty.

If a problem with the heater is experienced, or if the mains lead or plug become damaged, contact your distributor for repair.

When you store the heater, let it cool down, ensure that it is dry, cover with a plastic bag, put in a packing box and store it in a dry, ventilated place. Remember to take the batteries out of the remote.

OPERATING INSTRUCTIONS



Manual Operation

1. PLUG the unit into a plug socket, make sure the power supply is the same as rated.
2. SWITCH the power switch to ON, on the side of heater.
3. Press On/Off button, then press the arrows to move up or down the different heat levels.

Color	Description
Red	Red
Green	L1 1000W
Blue	L2 2000W
Blue & Green Flashing	Tip over function / Over heat protection

Remote Operation



Remote Control Function		
Button	Function	Description
	Turns heater On/Off	
	Power on	Increase level L1-L2
	Power on	Decrease level L2-L1

 All heaters and their remote controls have the same frequency, so it is possible to control several heaters with just one remote.

ELECTRICAL CONNECTION

WARNING! It is the responsibility of the owner and the operator to read, understand and comply with the following:

You must check all electrical products, before use, to ensure that they are safe.

You must inspect power cables, plugs, sockets and any other connectors for wear or damage.

You must ensure that the risk of electric shock is minimised by the installation of appropriate safety devices; A residual current circuit Breaker (RCCB) should be incorporated in the main distribution board. We also recommend that a residual current Device (RCD) is used. It is particularly important to use an RCD with portable products that are plugged into a supply which is not protected by an RCCB. If in any doubt consult a qualified electrician.

Connecting to the power supply:

This SIP heater is fitted with a standard 230v ~ 13 amp type plug. Before using the heater, inspect the mains lead and plug to ensure that neither are damaged. If any damage is visible have the heater inspected / repaired by a suitably qualified person. If it is necessary to replace the plug a heavy duty impact resistant plug would be preferable.

The wires for the plug are coloured in the following way:

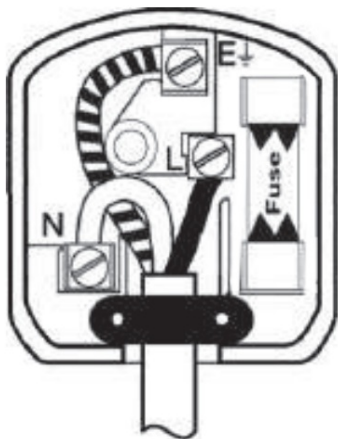

Yellow / green – Earth
 Blue – Neutral
 Brown – Live

As the colours of the wires may not correspond with the markings in your plug, proceed as follows: The wire which is coloured blue, must be connected to the terminal marked with N or coloured black. The wire which is coloured brown, must be connected to the terminal, which is marked L or coloured red. The wire which is coloured yellow / green should be connected to the terminal which is coloured the same or marked.



Always secure the wires in the plug terminal carefully and tightly. Secure the cable in the cord grip carefully.

ELECTRICAL CONNECTION....cont



Warning: Never connect live or neutral wires to the earth terminal of the plug. Only fit an approved plug with the correct rated fuse (13 amp). If in doubt consult a qualified electrician.



Note: Always make sure the mains supply is of the correct voltage and the correct fuse protection is used. In the event of replacing the fuse always use a 13 amp fuse. Do not use other high powered items on the same electrical circuit.



Note: Due to the input current of the heater, an extension lead should not be used to connect the heater to the mains supply; If an extension lead is connected, the correct size and quality must be ensured to avoid any incident.

ASSEMBLY INSTRUCTIONS....cont

Tripod Stand Mounting

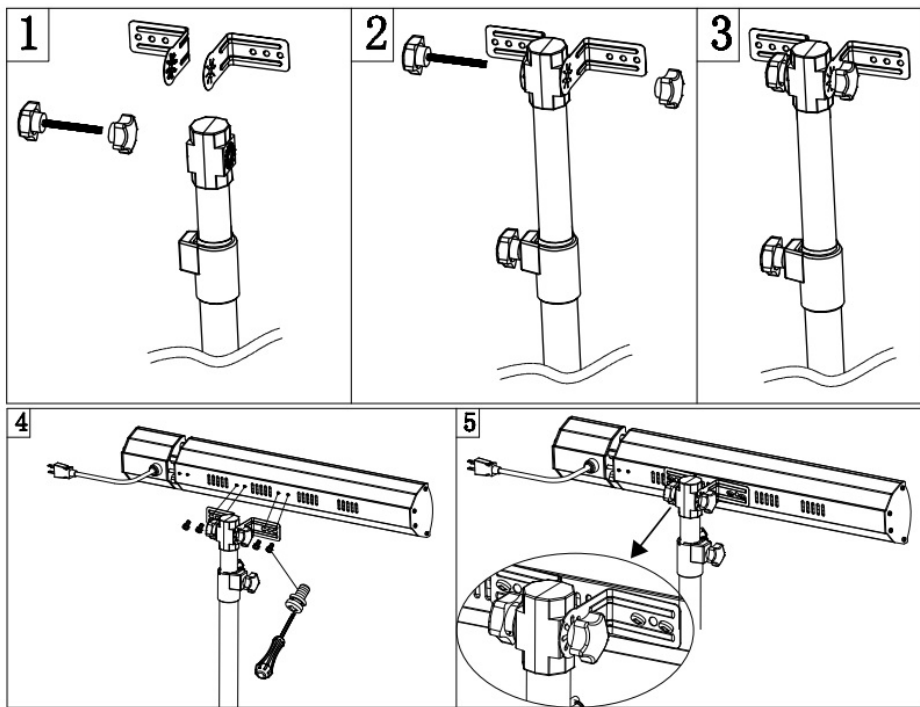

 Do not touch or cover the heater.

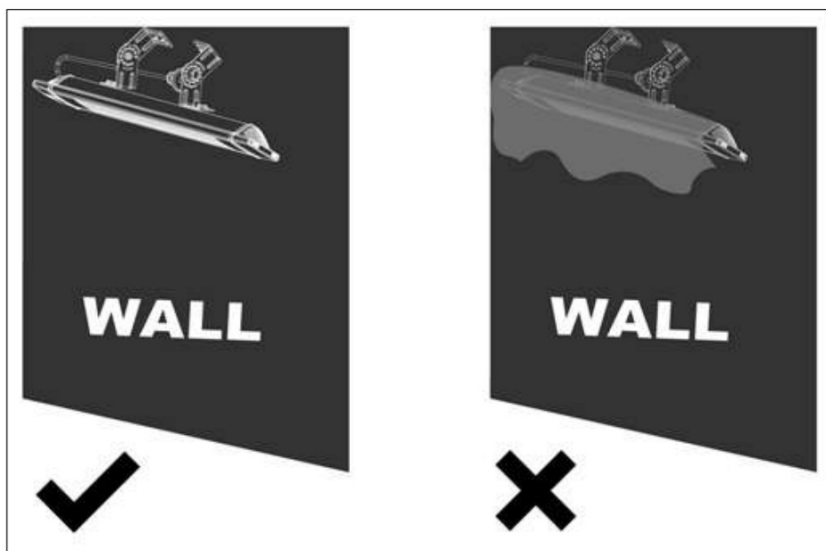



Wall Mounting

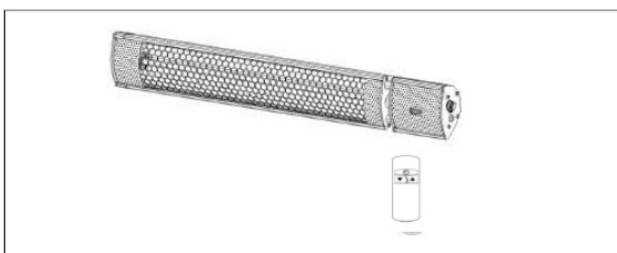
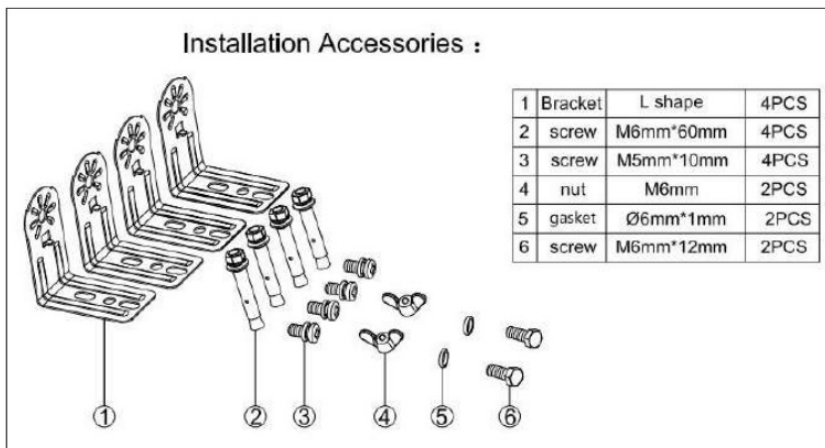

1. Attach the brackets into the heater as it is shown in the picture above.
2. Mark with a pencil the location on holes to drill.
3. Fit the bracket to the wall using the screws provided.

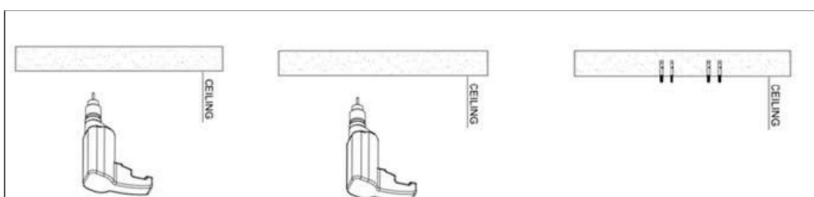

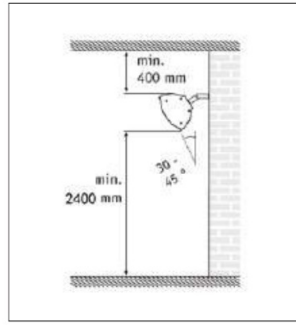
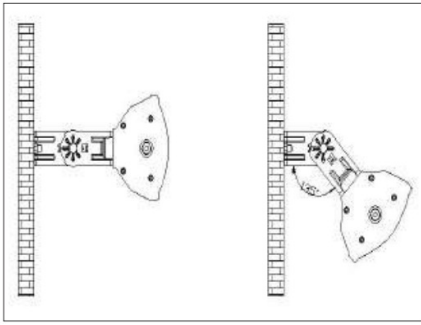

The heater must be installed at least 2.4 m above the floor.



Ensure that the supply cables is well mounted and that it does not come into contact with reflector of the heater or that it does not trail into heated area.

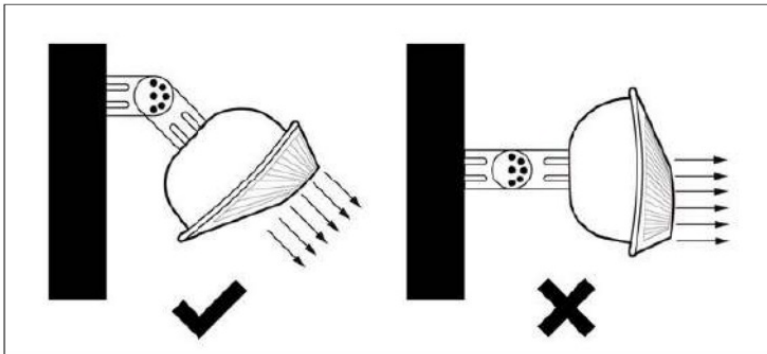
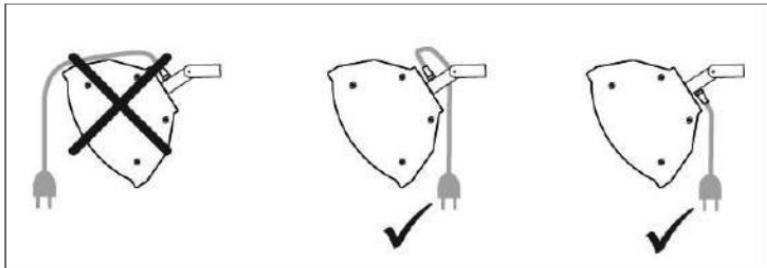

Mounted angle must be between 30° – 45°

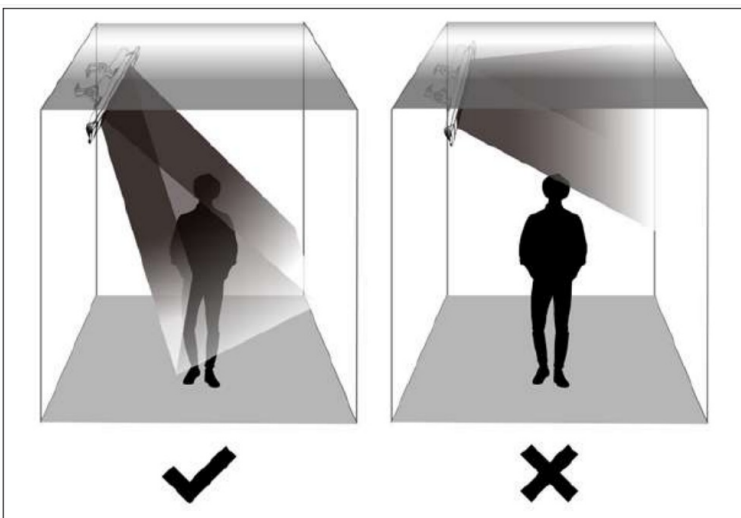

Heater should be wall or ceiling mounted under well protected environments, at least 3 feet (0.9m) away from any combustible objects.

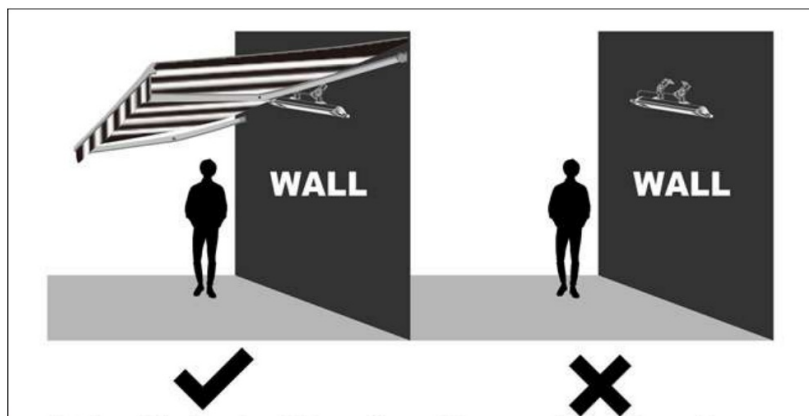

Documents / Resources



[SIP INDUSTRIAL 09586 Universal Halogen Heater with Remote](#) [pdf] User Guide
09586, 09586 Universal Halogen Heater with Remote, Universal Halogen Heater with Remote,
Halogen Heater with Remote, Heater with Remote