

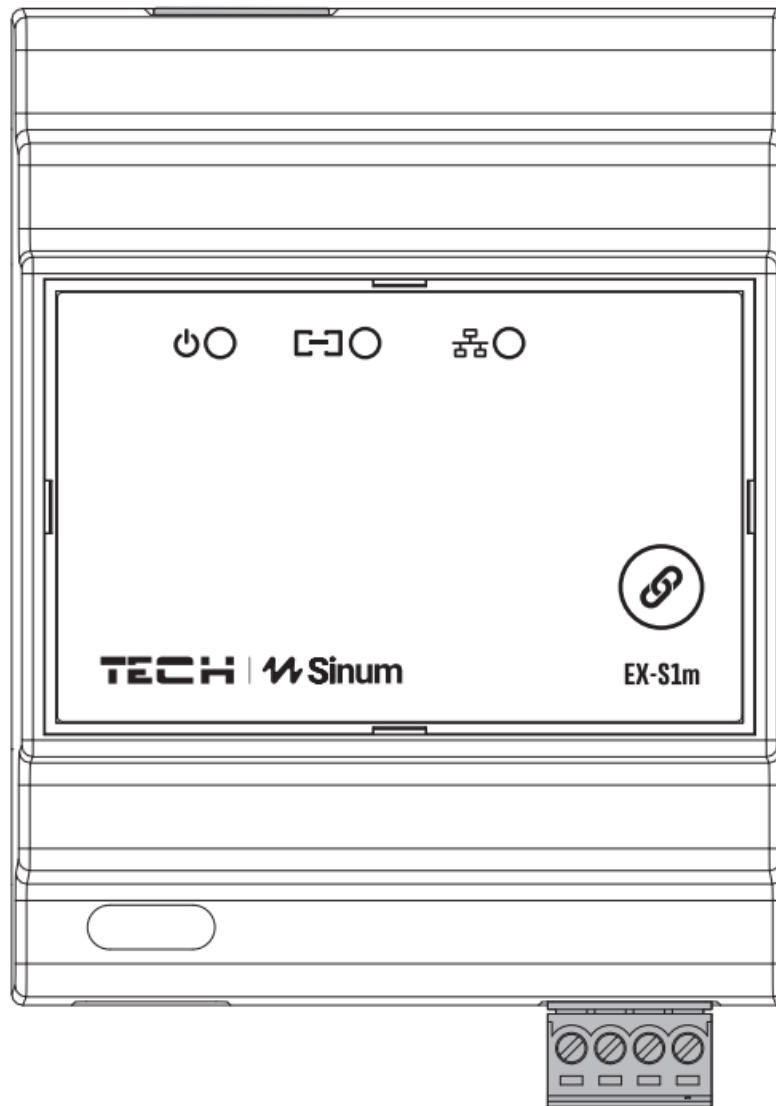

# Sinum EX-S1m Signal Transmitter Instruction Manual

[Home](#) » [Sinum](#) » Sinum EX-S1m Signal Transmitter Instruction Manual 

**Sinum EX-S1m Signal Transmitter**



## Contents



- [1 Introduction](#)
- [2 Description](#)
- [3 How to register the device in the sinum system – LAN](#)
- [4 How to register the device in the sinum system- WiFi](#)
- [5 Technical data](#)
- [6 Notes](#)
- [7 EU Declaration of conformity](#)
- [8 Service](#)
- [9 Documents / Resources](#)
  - [9.1 References](#)
- [10 Related Posts](#)

## Introduction

Extender EX-S1m is a device which enables the user to extend the signal range of peripheral devices to the Sinum central device. It connect's wired devices to system Sinum and send data to the Sinum central device via WiFi/LAN network. It is designed for mounting on a DIN rail.

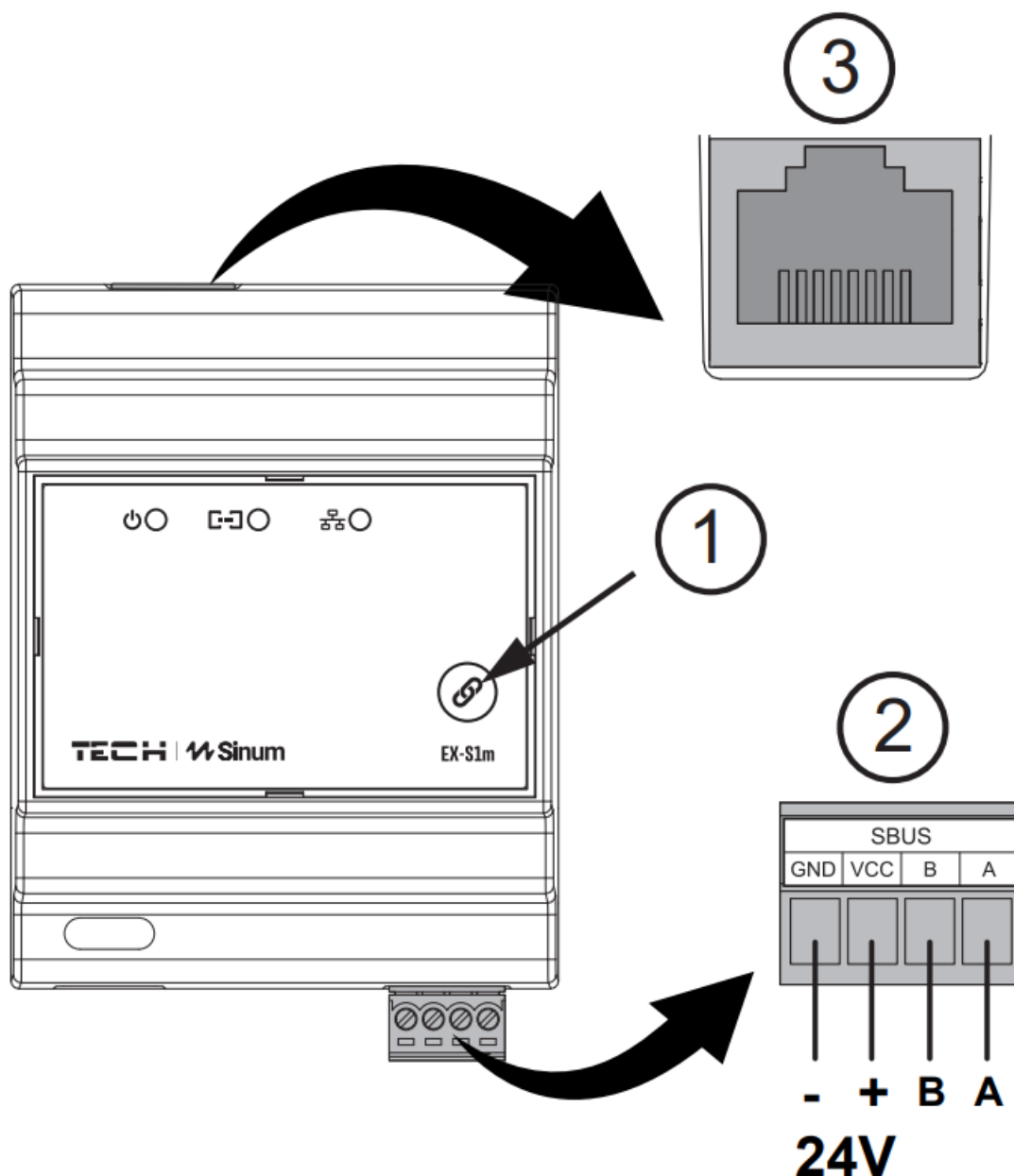

## Description



-  – Power
-  – Ethernet connection
-  – Ethernet connection activity

1. Registration button
2. SBUS communication connector
3. RJ45 port

## How to register the device in the sinum system – LAN

Extender should be connected to the same network as the Sinum central device using LAN wire (RJ45). Then enter the address of the Sinum central device in the browser and log in to the device. In the main panel, click the Settings > Devices > **System modules** >  . Then briefly press the registration button  on the device. After a properly completed registration process, an appropriate message will appear on the screen. Additionally, the user can name the device and assign it to a specific room.

## How to register the device in the sinum system- WiFi

On the extender, press the registration button ① twice, the AccessPoint mode will be activated (the power LED will flash twice cyclically). The extender broadcasts a Wi-Fi network named: TECH\_XXXXXX that you can connect to. When a window with a list of nearby networks appears (if the window does not appear in the browser, enter the extender's IP address: 192.168.4.1), select the network to which the Sinum Central device is connected and enter the password. If the extender successfully connects to the selected network, the power LED will stop blinking. Log in to the same network and enter the IP address of the Sinum Central device in the browser and connect to it.

In the main panel, click the **Settings > Devices > System modules > ⊕**. Then briefly press the registration button ① on the device. After a properly completed registration process, an appropriate message will appear on the screen. Additionally, the user can name the device and assign it to a specific room.

**NOTE: Both devices must be connected to the same WiFi network. The Wifi network has a higher priority than the LAN connection (if the extender was connected in both ways).**

## Technical data

|                                   |                  |
|-----------------------------------|------------------|
| Power supply                      | 24V DC $\pm$ 10% |
| Max. power consumption            | 1W               |
| Operation temperature             | 5°C ÷ 50°C       |
| Wifi: IEEE 802.11 b/g/n (2.4 GHz) |                  |
| LAN: IEEE 802.3 100Mb/s           |                  |

## Notes

TECH Controllers is not responsible for any damages resulting from improper use of the system. The range depends on the conditions in which the device is used and the structure and materials used in the object construction. The manufacturer reserves the right to improve devices, update software and related documentation. The graphics are provided for illustration purposes only and may differ slightly from the actual look. The diagrams serve as examples. All changes are updated on an ongoing basis on the manufacturer's website. Before using the device for the first time, read the following regulations carefully. Not obeying these instructions may lead to personal injuries or controller damage. The device should be installed by a qualified person. It is not intended to be operated by children. It is a live electrical device. Make sure the device is disconnected from the mains before performing any activities involving the power supply (plugging cables, installing the device etc.). The device is not water resistant.



The product may not be disposed of to household waste containers.

The user is obliged to transfer their used equipment to a collection point where all electric and electronic components will be recycled.

## EU Declaration of conformity

Tech Sterowniki II Sp. z o.o. ul. Biała Droga 34, Wieprz (34-122)

Hereby, we declare under our sole responsibility that the extender EX-S1m is compliant with Directive 2014/53/EU.

Wieprz, 01.07.2023

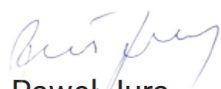
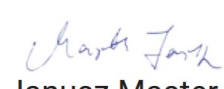
  
Paweł Jura  
  
Janusz Master  
Prezesa firmy

## Service

tel: +48 33 875 93 80 [www.tech-controllers.com](http://www.tech-controllers.com)  
[support.sinum@techsterowniki.pl](mailto:support.sinum@techsterowniki.pl)

The full text of the EU declaration of conformity and the user manual are available after scanning the QR code or at [www.tech-controllers.com/manuals](http://www.tech-controllers.com/manuals)

[www.techsterowniki.pl/manuals](http://www.techsterowniki.pl/manuals)



[www.tech-controllers.com/manuals](http://www.tech-controllers.com/manuals)



UK  
CA EAC

TECH STEROWNIKI II Sp. z o.o.  
ul. Biała Droga 31  
34-122 Wieprz

[www.sinum.eu](http://www.sinum.eu)

**TECH** |  **Sinum**

## Documents / Resources



[Sinum EX-S1m Signal Transmitter](#) [pdf] Instruction Manual  
EX-S1m, EX-S1m Signal Transmitter, Signal Transmitter, Transmitter

## References

- [controllers.com](https://www.controllers.com)
- [Intelligens fűtés-hűtés, fűtési-hűtési megoldások - TECH vezérlők gyártója | TECH vezérlők](#)
- [Intelligent heating, smart heating solutions - manufacturer of controllers | TECH Controllers](#)
- [Manuals - TECH Controllers](#)
- [TECH Controllers - Teplo ve Vašem domě](#)
- [TECH Controllers - Teplo vo Vašom dome](#)
- [Instrukcje - TECH Sterowniki](#)
- [Soluția de acasă de economisire a energiei - producător de controlere I Tech-Controllers](#)
- [User Manual](#)

[Manuals+](#), [Privacy Policy](#)

This website is an independent publication and is neither affiliated with nor endorsed by any of the trademark owners. The "Bluetooth®" word mark and logos are registered trademarks owned by Bluetooth SIG, Inc. The "Wi-Fi®" word mark and logos are registered trademarks owned by the Wi-Fi Alliance. Any use of these marks on this website does not imply any affiliation with or endorsement.