

Sinum
EX-MODBUS
Signal
Amplifier

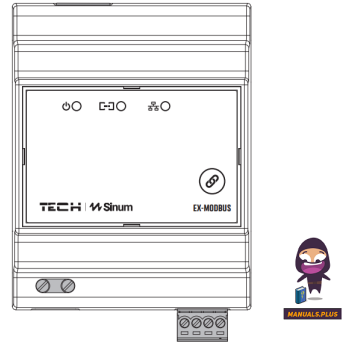

Sinum EX-MODBUS Signal Amplifier Instruction Manual

[Home](#) » [Sinum](#) » Sinum EX-MODBUS Signal Amplifier Instruction Manual 

Contents

- 1 Sinum EX-MODBUS Signal Amplifier
- 2 FAQs
- 3 PRODUCT INFORMATION
- 4 Description
- 5 register the device
- 6 Technical data
- 7 Service
- 8 Documents / Resources
 - 8.1 References



Sinum EX-MODBUS Signal Amplifier

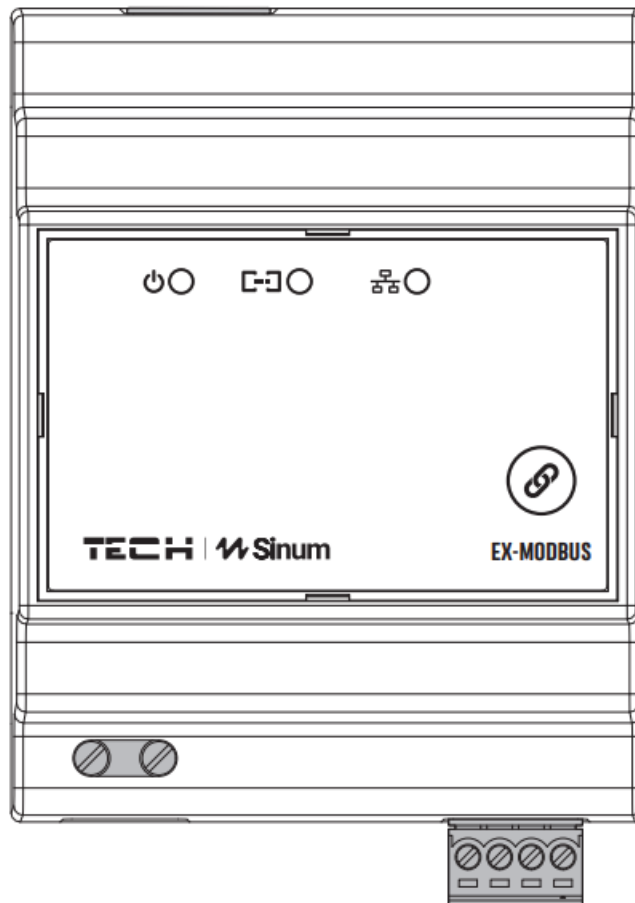

FAQs

Q: Can I dispose of the product in household waste containers?

A: The product should not be disposed of in household waste containers. Please transfer used equipment to a collection point where all electrical and electronic components will be recycled.

Q: How can I access the full EU Declaration of Conformity and user manual?



A: The full documents are available after scanning the QR code or at www.tech-controllers.com/manuals

PRODUCT INFORMATION

Extender EX-MODBUS is a device that enables the user to extend the signal range of peripheral devices to the Sinum central device. It connects wired devices via Modbus communication protocol and send data to the Sinum central device via WiFi/LAN network. It is designed for mounting on a DIN rail.

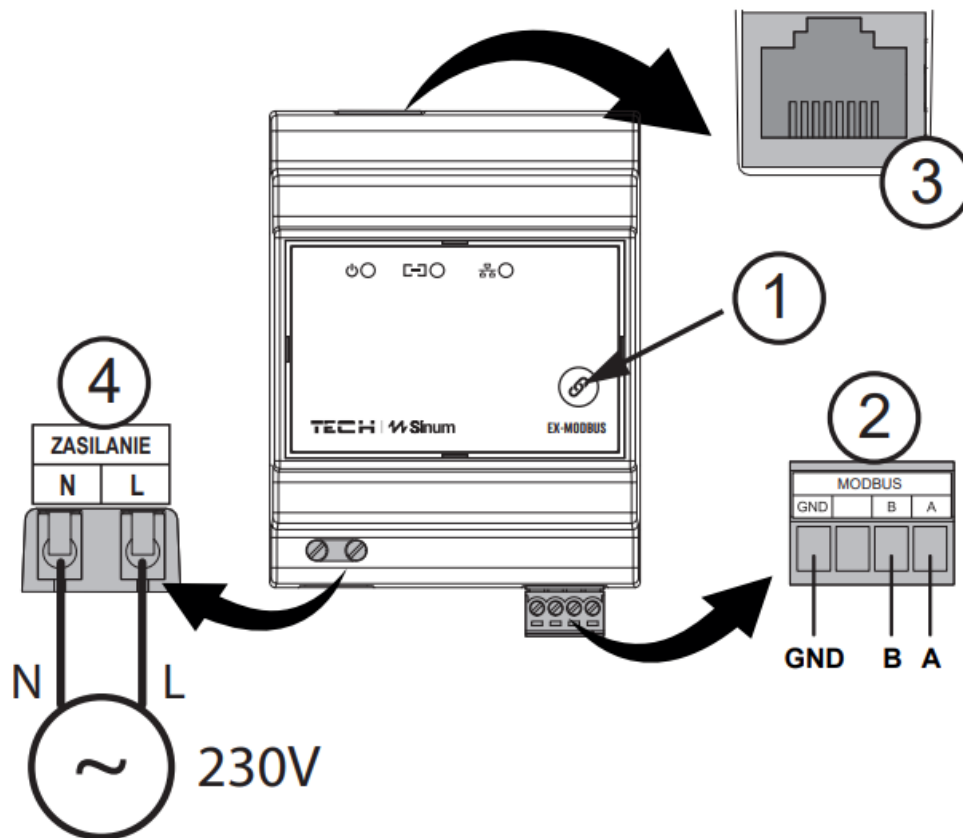
Description



-  Power
-  Ethernet connection
-  Ethernet connection activity

1. Registration button
2. MODBUS communication connector
3. RJ45 port
4. Złącze Tasmania

register the device

How to register the device in the sinus system – LAN

The extender should be connected to the same network as the Sinum central device using LAN wire (RJ45). Then enter the address of the Sinum central device in the browser and log in to the device. In the main panel, click the Settings > Devices > System modules > +. Then briefly press the registration button 1 on the device. After a properly completed registration process, an appropriate message will appear on the screen. Additionally, the user can name the device and assign it to a specific room.

to register the device in the sinus system- WiFi

On the extender, press the registration button 1 twice, the AccessPoint mode will be activated (the power LED will flash twice cyclically). The extender broadcasts a Wi-Fi network named: EX-MODBUS_XXXXXX that you can connect to. Then, in the device settings window, click Network Wifi selection (if the window does not appear in the

browser, enter the extender's IP address: 4.3.2.1), select the network to which the Sinum Central device is connected, and enter the password. If the extender successfully connects to the selected network, the power LED will stop blinking. Log in to the same network and enter the IP address of the Sinum Central device in the browser and connect to it. In the main panel, click the Settings > Devices > System modules > +. Then briefly press the registration button 1 on the device. After a properly completed registration process, an appropriate message will appear on the screen. Additionally, the user can name the device and assign it to a specific room.

NOTE: Both devices must be connected to the same WiFi network. The Wifi network has a higher priority than the LAN connection (if the extender was connected in both ways).

Technical data

Technical data	
Power supply	230V \pm 10% /50Hz
Max. power consumption	2W
Operation temperature	5°C ÷ 50°C
<u>Wifi: IEEE 802.11 b/g/n (2.4 GHz)</u>	
LAN: IEEE 802.3 100Mb/s	

Notes

TECH Controllers is not responsible for any damages resulting from improper use of the system. The range depends on the conditions in which the device is used and the structure and materials used in the object construction. The manufacturer reserves the right to improve devices and update software and related documentation. The graphics are provided for illustration purposes only and may differ slightly from the actual look. The diagrams serve as examples. All changes are updated on an ongoing basis on the manufacturer's website. Before using the device for the first time, read the following regulations carefully. Not obeying these instructions may lead to personal injuries or controller damage. The device should be installed by a qualified person. It is not intended for children to operate it. It is a live electrical device. Make sure the device is disconnected from the mains before performing any activities involving the power supply (plugging cables, installing the device, etc.). The device is not water resistant.

The product may not be disposed of in household waste containers. The user is obliged to transfer the equipment they use to a collection point where all electric and electronic components will be recycled.

EU Declaration of Conformity

Tech Sterowniki II Sp. z o.o. ul. Biała Droga 34, Wieprz (34-122) Hereby, we declare under our sole responsibility that the extender EX-MODBUS is compliant with Directive 2014/53/EU.

Wieprz, 01.06.2024

Paweł Jura

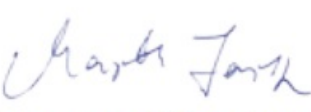
Janusz Master

Prezesi firmy

The full text of the EU Declaration of Conformity and the user manual are available after scanning the QR code or at www.tech-controllers.com/manuals

- www.techsterowniki.pl/manuals Wyprodukowano w Polsce



- www.tech-controllers.com/manuals Made in Poland

Service

- tel: +48 33 875 93 80 www.tech-controllers.com
- support.sinum@techsterowniki.pl

Documents / Resources



[Sinum EX-MODBUS Signal Amplifier](#) [pdf] Instruction Manual
EX-MODBUS Signal Amplifier, EX-MODBUS, Signal Amplifier, Amplifier

References

- controllers.com
- [Intelligens fűtés-hűtés, fűtési-hűtési megoldások - TECH vezérlők gyártója | TECH vezérlők](#)
- [Sinum - TECH Controllers](#)
- [Intelligent heating, smart heating solutions - manufacturer of controllers | TECH Controllers](#)
- [Manuals - TECH Controllers](#)
- [TECH Controllers - Teplo ve Vašem dome](#)
- [TECH Controllers - Teplo vo Vašom dome](#)
- [Soluția de acasă de economisire a energiei - producător de controlere | Tech-Controllers](#)
- [User Manual](#)

[Manuals+](#), [Privacy Policy](#)

This website is an independent publication and is neither affiliated with nor endorsed by any of the trademark owners. The "Bluetooth®" word mark and logos are registered trademarks owned by Bluetooth SIG, Inc. The "Wi-Fi®" word mark and logos are registered trademarks owned by the Wi-Fi Alliance. Any use of these marks on this website does not imply any affiliation with or endorsement.