

**silex**  
RM-100RC  
Industrial  
Multi Camera  
Drive  
Recorder



## simx RM-100RC Industrial Multi Camera Drive Recorder User Guide

[Home](#) » [Simx](#) » [simx RM-100RC Industrial Multi Camera Drive Recorder User Guide](#) 

### Contents

- [1 simx RM-100RC Industrial Multi Camera Drive Recorder](#)
- [2 Package Contents](#)
- [3 Name of Parts](#)
- [4 Necessary Items](#)
- [5 How to Configure](#)
- [6 Checking the Recorded Files](#)
- [7 Factory Default Configuration](#)
- [8 Documents / Resources](#)
  - [8.1 References](#)
- [9 Related Posts](#)

**silex**

**simx RM-100RC Industrial Multi Camera Drive Recorder**



Thank you for purchasing the industrial multi-camera drive recorder,"RM-1 00RC".

RM-1 00RC supports video recording with up to 4 RTP cameras, and the recorded videos can be checked remotely over the network. Also, it has Wi-Fi 6 (IEEE 802, 11 ax) Access Point function. This document describes the initial configuration method and the procedure for checking the recorded videos.

Camera is not contained in the product package. It needs to be purchased separately.

## Package Contents

Following items are contained in the product package.

- RM-1 00RC
- Setup Guide (this document)
- Rubber foot (4pcs)
- Warranty Guide and GPL Inquiry Card
- Declaration of Conformity (EU/UK model only.)

## Name of Parts



1. LAN Port
2. CAMERA Port (PoE supported (\*))
3. DC Connector

4. DCjack
5. Push Switch
6. Digital Input/Output interface
7. POWER LED {Green/Orange/Red}
8. CAMERA LED(Green/Orange/Red)
9. WLAN1 LED(Green/Orange/Red) (1 OJ WLAN2 LED(Green/Orange/Red)
10. APP LED

The camera ports are located on the right of the LAN port (1) in the order of camera 1 > camera 2 > camera 3 > camera 4.

For detailed function of each part, please refer to the user's manual.

## Necessary Items

Following items are required.

- LAN cable
- PC to use for configuration
- Power supply (DC24V to 48V), or RM-1 00RC's optional AC adapter
  - When there is no power supply that supports DC24V to 48V, please use the optional AC adapter.
  - Power supply (DC24V to 48V) and AC adapter cannot be used at the same time.
  - To connect to this connector, please use JST's JFA connector J300 series F32FSS-02V-KX.
  - The pin arrangement for the DC connector of RM-100RC is as follows.

## DC Connector

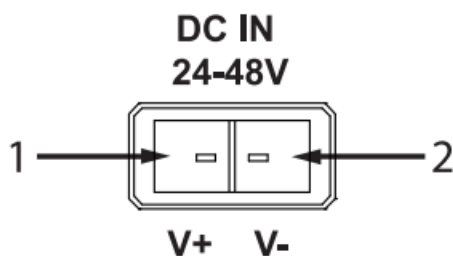

| PIN Number | Signal | Description  |
|------------|--------|--------------|
| 1          | DCIN   | DC 24 to 48V |
| 2          | GND    | GND          |

## Camera

This document describes the initial configuration and video confirmation procedures for using "IP-5324"; which is the standard camera of RM-1 00RC.

For procedures to use a camera other than the standard camera, refer to the user's manual.

IP-5324 (manufactured by MOTHERTOOL CO.,LTD.)

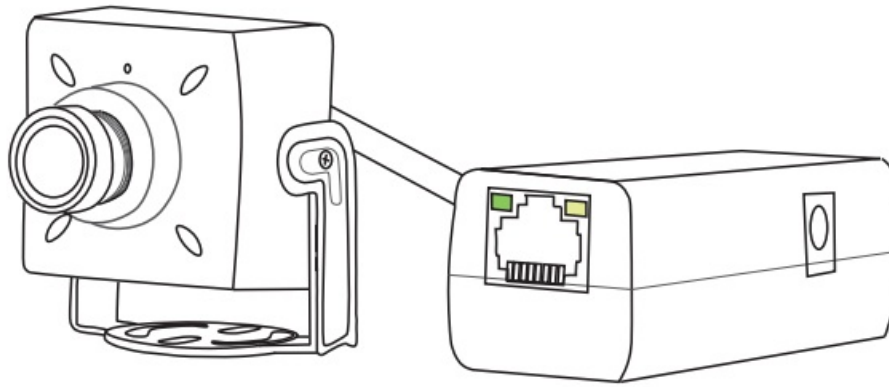

- For the compatible camera information, please visit Silex Technology's website.

## How to Configure

Change the wired LAN network setting of the PC to allow communication with RM-1 00RC.

If the wired LAN network setting of the PC is set to "Obtain an IP address automatically"; you do not have to change it since the DHCP server setting of RM-1 00RC is enabled by default.

### Sample network setting)

When the IP address of RM-100RC is "192.168.1.10"; change the wired LAN network settings of the PC as follows.

IP address : 192.168.1.100

Subnet mask: 255.255.255.0

1. Connect RM-1 00RC and the camera using a LAN cable.

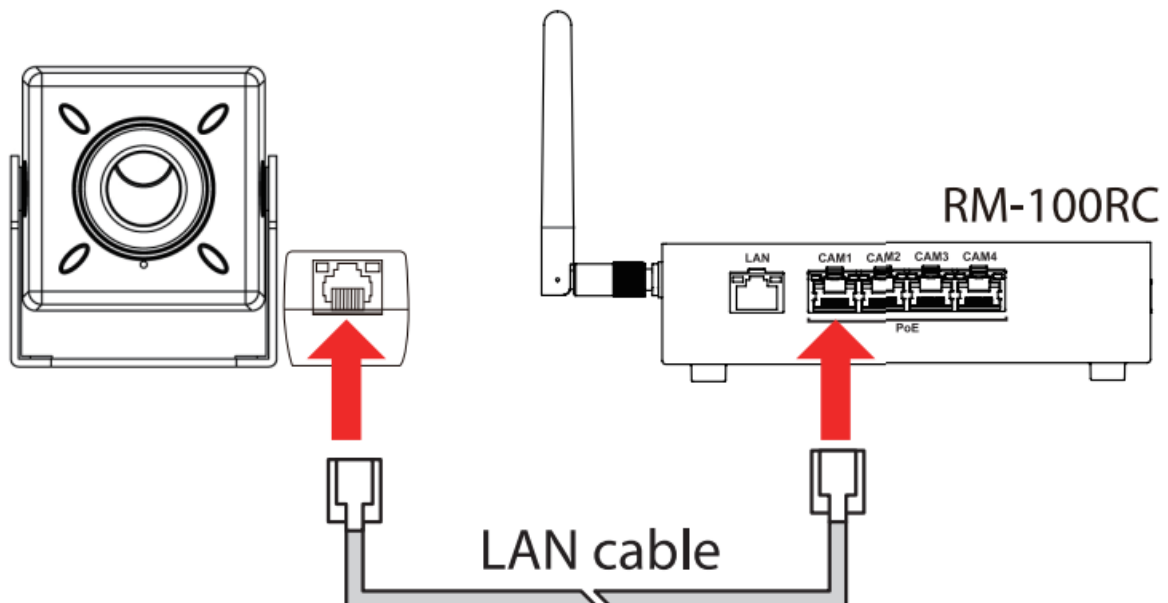

2. Connect the PC and RM-1 00RC ("LAN" port) using a LAN U' cable.

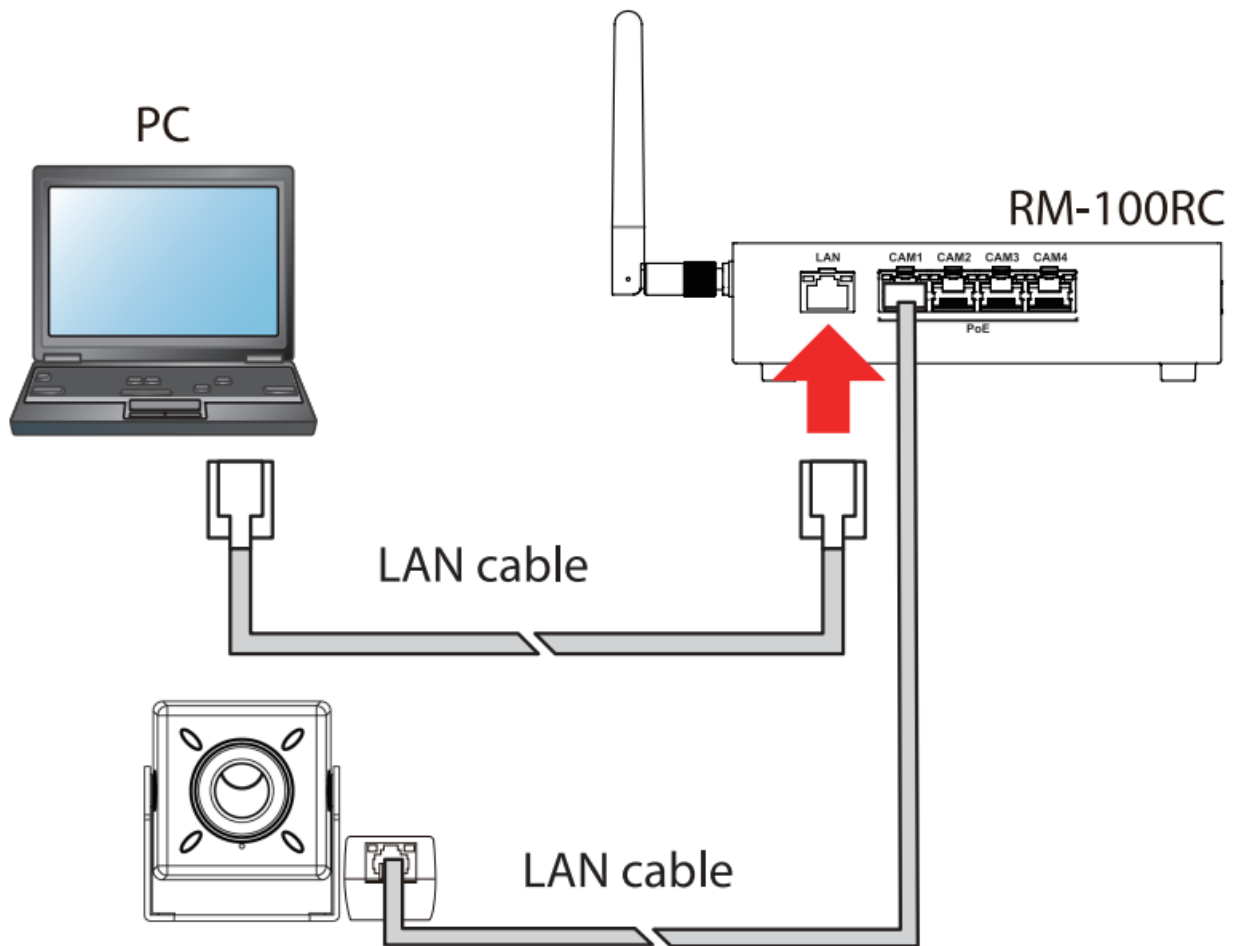

3. Connect the power supply cable to the DC connector of RM-100RC.

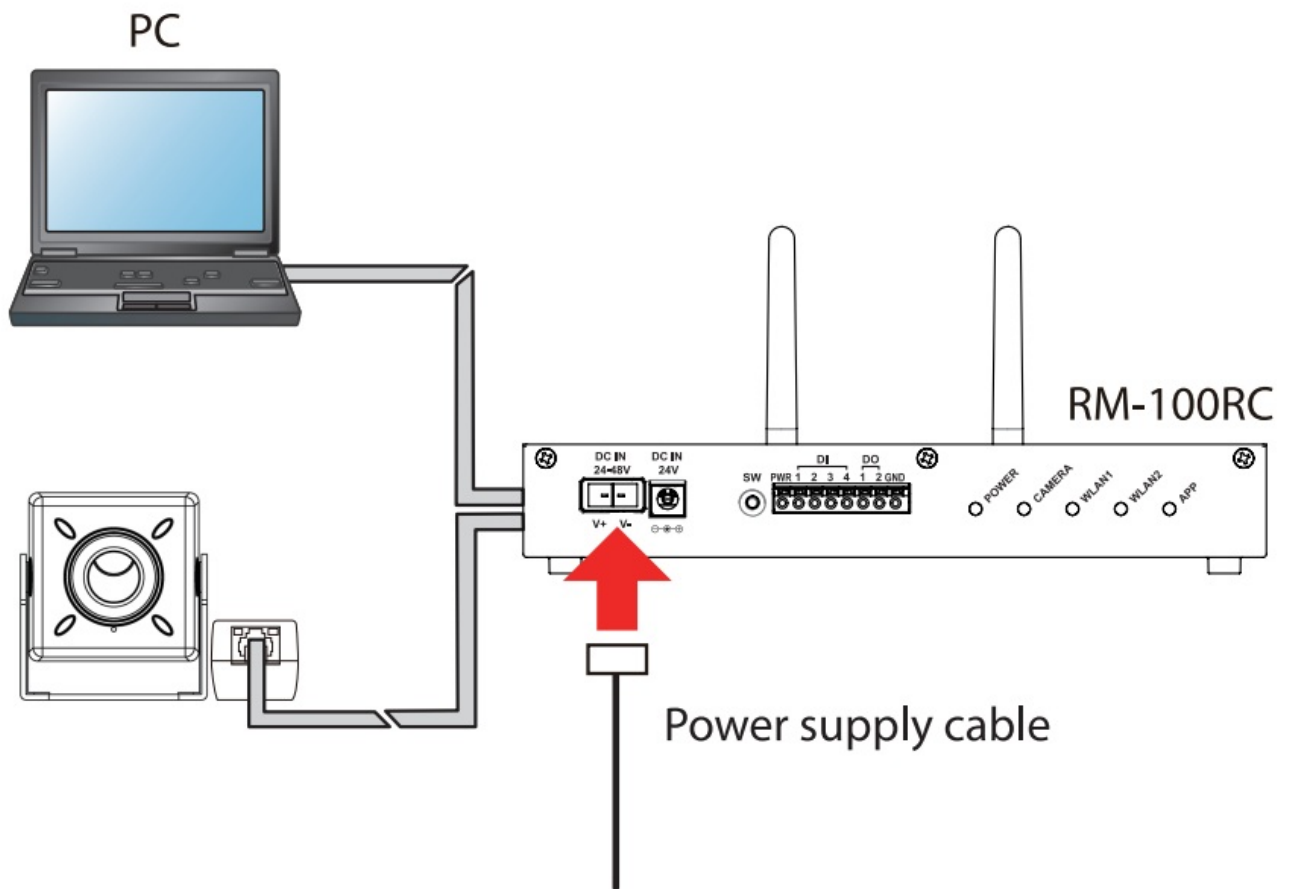

When the optional AC adapter is used, connect it to the DC jack of RM-100RC.

Then, do not use the power supply that supports DC24V to 48V with it.

4. Start the Web browser (Microsoft Edge) on the PC.

Enter the IP address of RM-1 00RC to the address bar and press the Enter key.

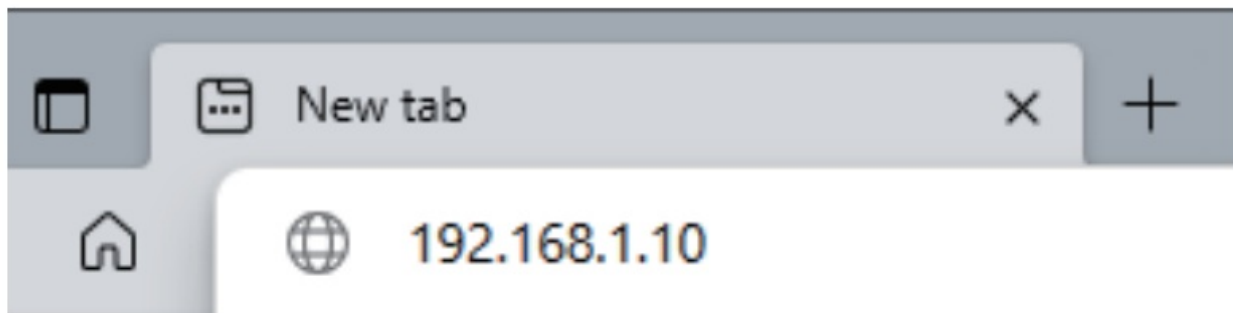

\*The default IP address of RM-100RC is "192.168.1.10".

5. The login password configuration page appears, enter the password 1:1 to configure for RM-1 00RC and click Submit.

A screenshot of a web page titled "RM-100RC" in the top right corner. The main content area is enclosed in a blue border. Inside, there is a red-bordered box containing the text "Please set a password for this unit." Below this text are two input fields: "Password" and "Confirm Password". Below the "Confirm Password" field is the text "1 - 15 Character String(Password)". A "Submit" button is located below the input fields. Below the red-bordered box is a "Select Language" dropdown menu with "English" selected.

6. The login page is displayed.

Enter the login password you have configured and click Login.

RM-100RC

Ver 1.0.0b0

Enter the password, and click [Login].

Password

Login

Select Language English

7. The Web page of RM-100RC is displayed.

Click Required Conf. from the menu.

Streaming Video

Recorded Video

Required Conf. \*

> System

> Wireless LAN

> Camera

> Security

Management

> Status

> Maintenance

Logout

Streaming Video

Camera 1

Camera 2

Camera 3

Camera 4

1

Copyright (C) 2023 silex technology, Inc.

8. The Required Configuration page is displayed.

Check the system time and change it if necessary.

Video

Streaming Video

Recorded Video

Config

Required Conf. \*

Detail Conf.

System

Wireless LAN

Camera

Security

Management

Status

Maintenance

Logout

RM-100RC

Ver 1.0.0.0

Required Configuration \*

Time Configuration

Date

|                           |   |
|---------------------------|---|
| System Time               | 2023/01/01 09:04:20 (GMT +0900)   |
| Manual Time Configuration | <input type="checkbox"/> Use time information below<br>12/07/2023 09:14:23 AM |
| Time Zone                 | +9:00   |

Camera Basic Configuration

Basic Configuration

|               |       |
|---------------|-------|
| Screen Format | Multi |
|---------------|-------|

Continuous Recording Configuration

|                      |   |
|----------------------|---|
| Continuous Recording | <input checked="" type="radio"/> ON <input type="radio"/> OFF |
| Recording Time(sec)  | 120   |
| Auto Delete          | <input checked="" type="radio"/> ON <input type="radio"/> OFF |

Event Recording Configuration

|                            |   |
|----------------------------|---|
| Digital Input Trigger ?    | DISABLE   |
| Before-Trigger Period(sec) | 10  |
| After-Trigger Period(sec)  | 10  |
| Auto Delete                | <input checked="" type="radio"/> ON <input type="radio"/> OFF |

Submit

9. Check the settings at Camera Basic Configuration.

Change the settings if necessary. When no settings need to be changed, you can skip the the following steps.



RM-100RC

Ver 1.0.0.0

Video

Streaming Video

Recorded Video

Config

Required Conf. \*

Detail Conf.

System

Wireless LAN

Camera

Security

Management

Status

Maintenance

Logout

Required Configuration \*

Time Configuration

Date

System Time

2023/01/01 09:04:20 (GMT +0900)

Manual Time Configuration

☐ Use time information below  
12/07/2023 09:14:23 AM

Time Zone

+9:00 ▾

Camera Basic Configuration

Basic Configuration

Screen Format

Multi ▾

Continuous Recording Configuration

Continuous Recording

☒ ON ☐ OFF

Recording Time(sec)

120 ▾

Auto Delete

☒ ON ☐ OFF

Event Recording Configuration

Digital Input Trigger ?

DISABLE ▾

Before-Trigger Period(sec)

10 ▾

After-Trigger Period(sec)

10 ▾

Auto Delete

☒ ON ☐ OFF

Submit

For details on each configuration item, refer to the user's manual.

10. Click Submit at bottom right of the Required Configuration page.

RM-100RC

Ver 1.0.0.0

Video

Streaming Video

Recorded Video

Config

Required Conf. \*

Detail Conf.

System

Wireless LAN

Camera

Security

Management

Status

Maintenance

Logout

Required Configuration \*

Time Configuration

Date

System Time

2023/01/01 09:04:20 (GMT +0900)

Manual Time Configuration

☐ Use time information below  

12/07/2023 09:14:23 AM

Time Zone

+9:00

Camera Basic Configuration

Basic Configuration

Screen Format

Multi

Continuous Recording Configuration

Continuous Recording

☒ ON ☐ OFF

Recording Time(sec)

120

Auto Delete

☒ ON ☐ OFF

Event Recording Configuration

Digital Input Trigger ?

DISABLE

Before-Trigger Period(sec)

10

After-Trigger Period(sec)

10

Auto Delete

☒ ON ☐ OFF

Submit

11. Click Restart at the top of the Required Configuration page or go to Management – Maintenance and click Restart.

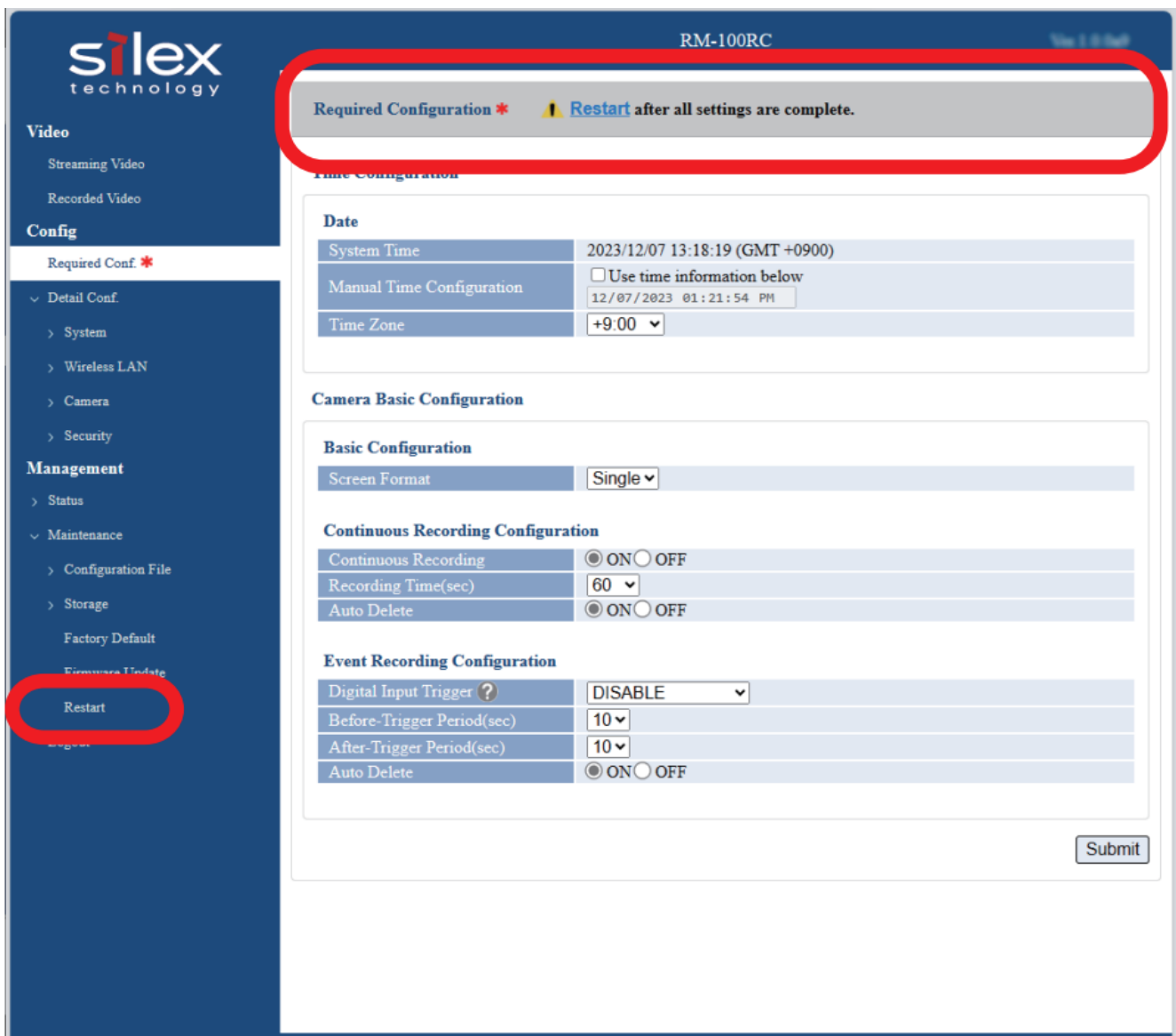

12. When the Restart page is displayed, click Restart.

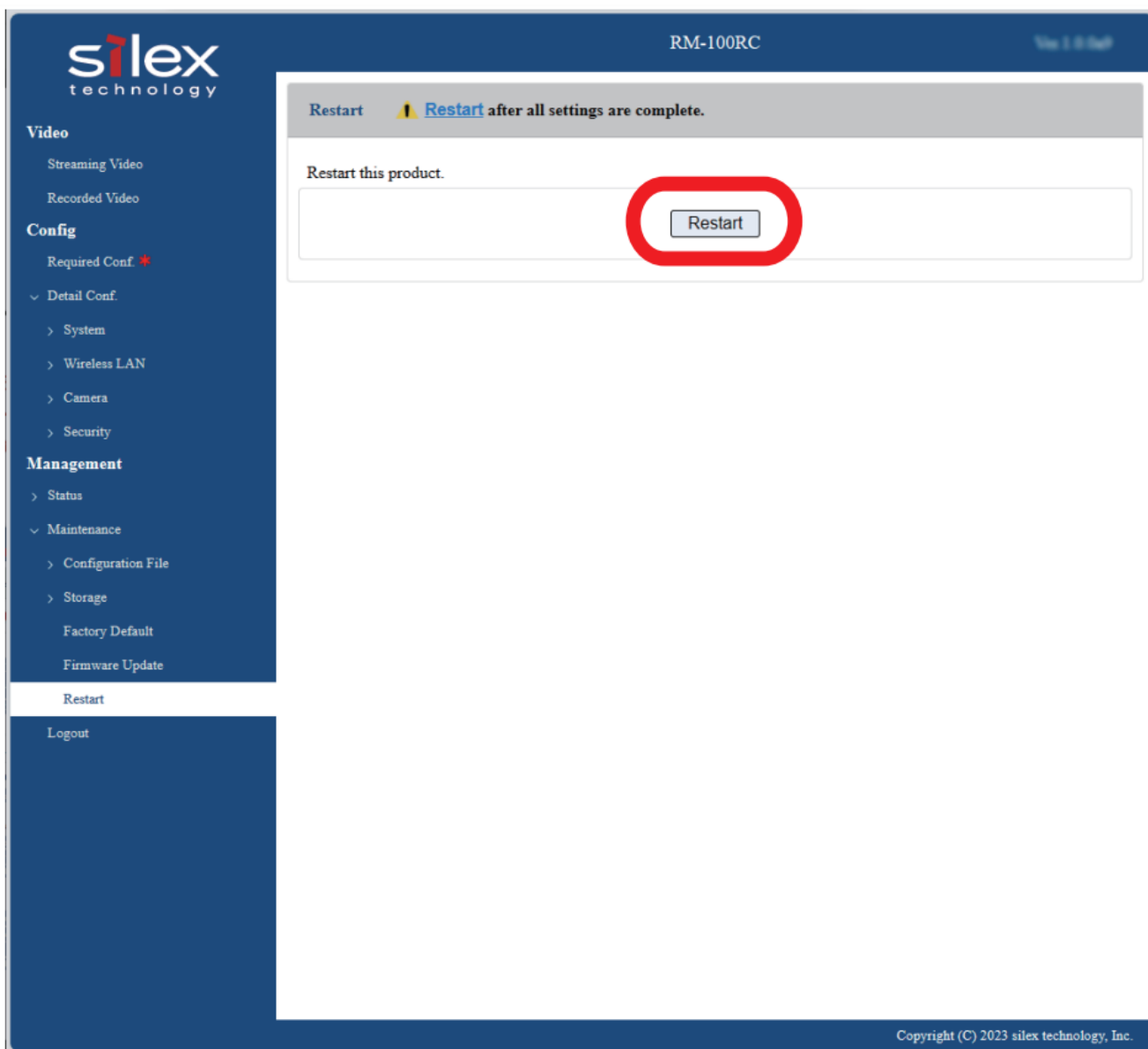

13. RM-100RC will restart.

When the login page is displayed, the restart is completed.

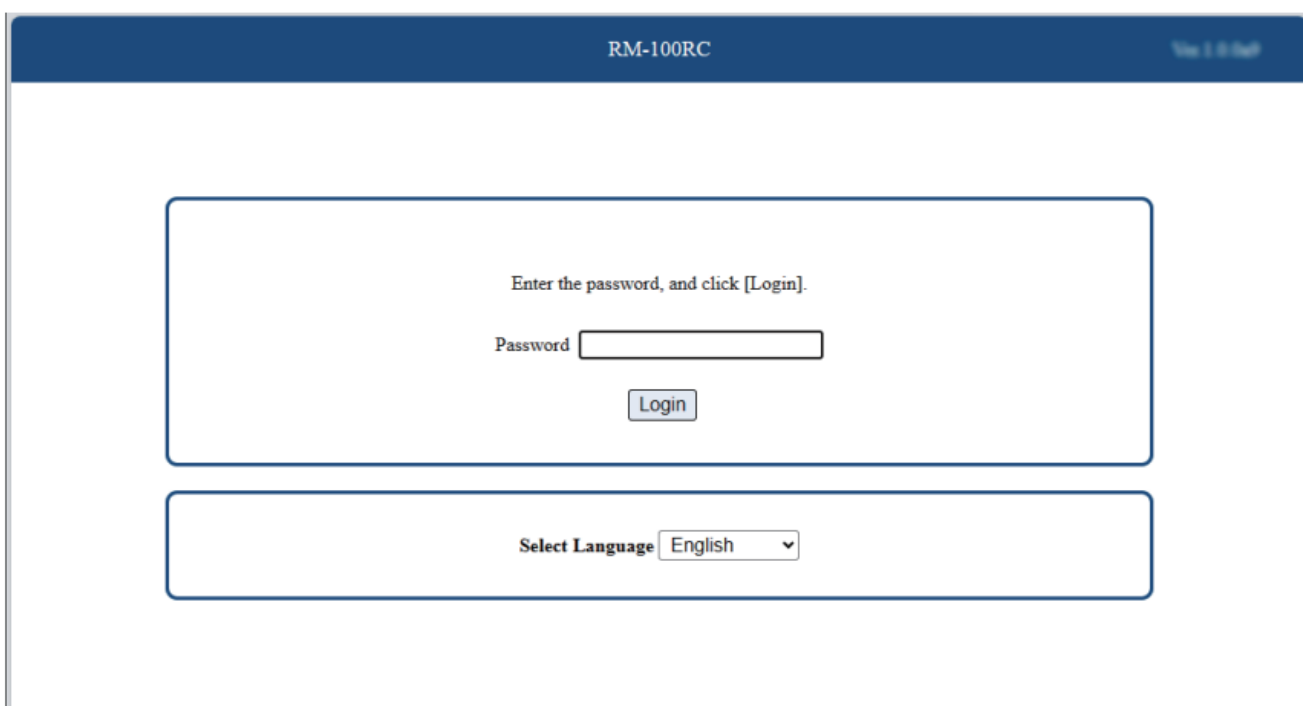

The initial configuration for RM-1 00RC is now completed.  
Go on to the back page for how to check the recorded files.

## Checking the Recorded Files

The following explains how to check the recorded files.

1. Start the Web browser (Microsoft Edge) on the PC.

Enter the IP address of RM-100RC to the address bar and press the Enter key.

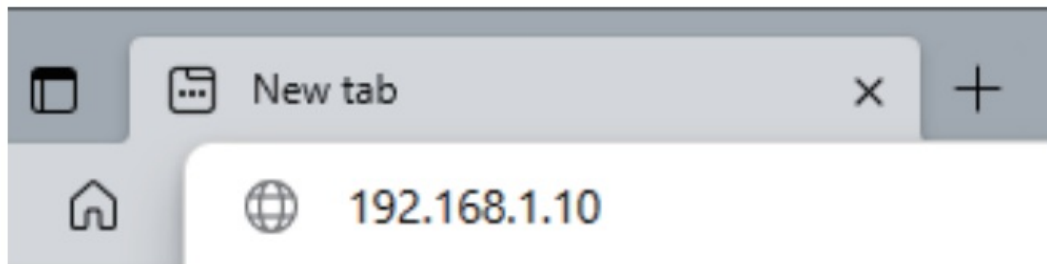

2. The login page is displayed.

Enter the login password you have configured and click Login.

A screenshot of the RM-100RC login page. The page has a dark blue header with "RM-100RC" in the center and "Ver. 1.0.0.0" on the right. The main content area is white. In the center, there is a login form with a red rounded rectangle border. Inside this rectangle, the text "Enter the password, and click [Login]." is displayed above a "Password" label and a text input field. Below the input field is a "Login" button. Below the red rectangle, there is a "Select Language" label followed by a dropdown menu showing "English" with a downward arrow.

3. The Streaming Video page is displayed.

Click Required Conf. from the menu.



4. The Required Configuration page is displayed.

Check the check box of Use time information below, and click Submit.

When the other settings have been changed, RM-100RC needs to be restarted.

5. Confirm that the System Time has been updated as specified, and click Streaming Video from the menu.

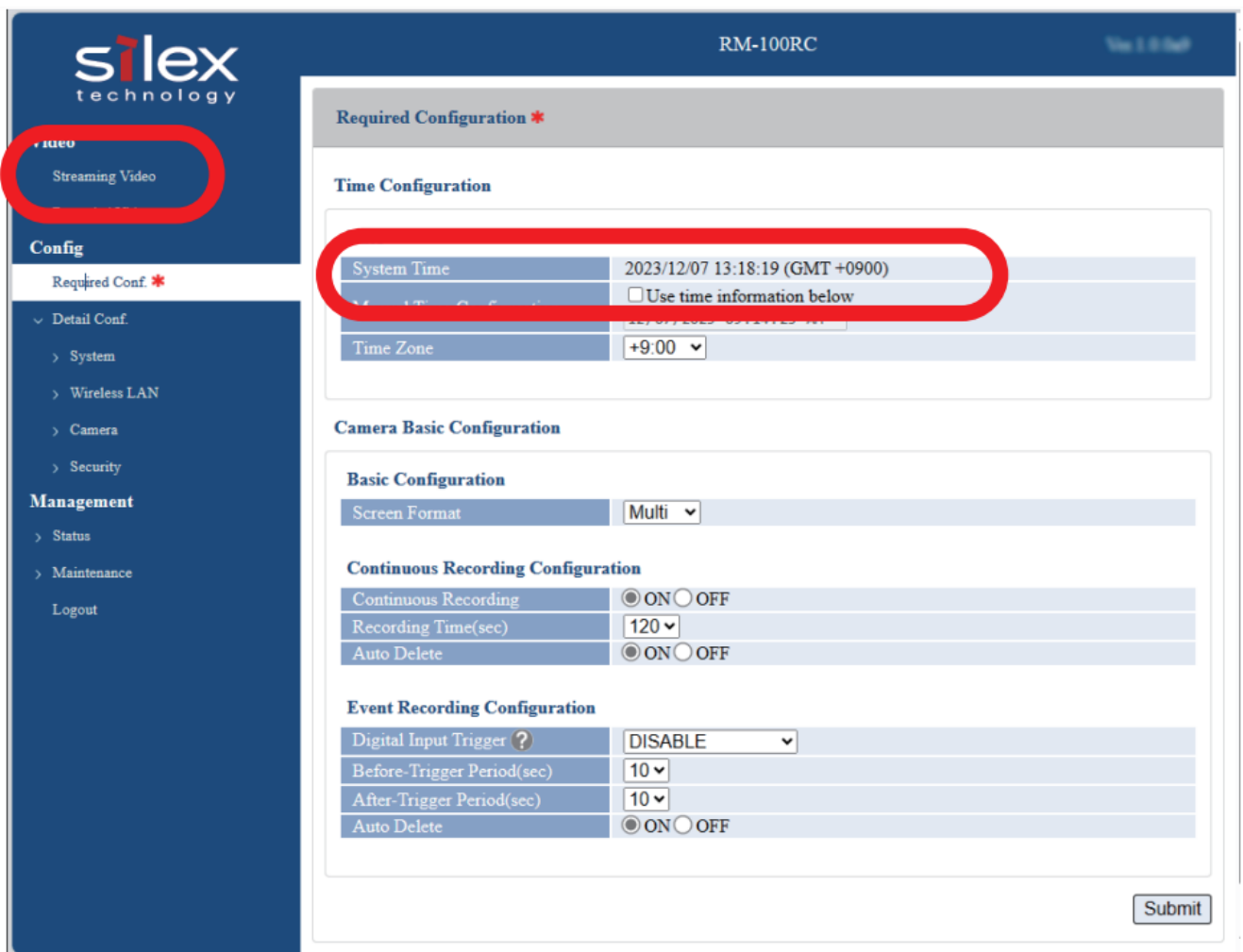

6. The Streaming Video page is displayed.

Check the video of the camera connected to RM-100RC.

When the time of Recording Time (sec) has elapsed, click Recorded Video from the menu.



\* It may take a while until the video of the camera is displayed.

\* If a camera is not connected or an image is not obtained from the camera, that camera area will be black.

7. The Recorded Video page is displayed. Click normal.

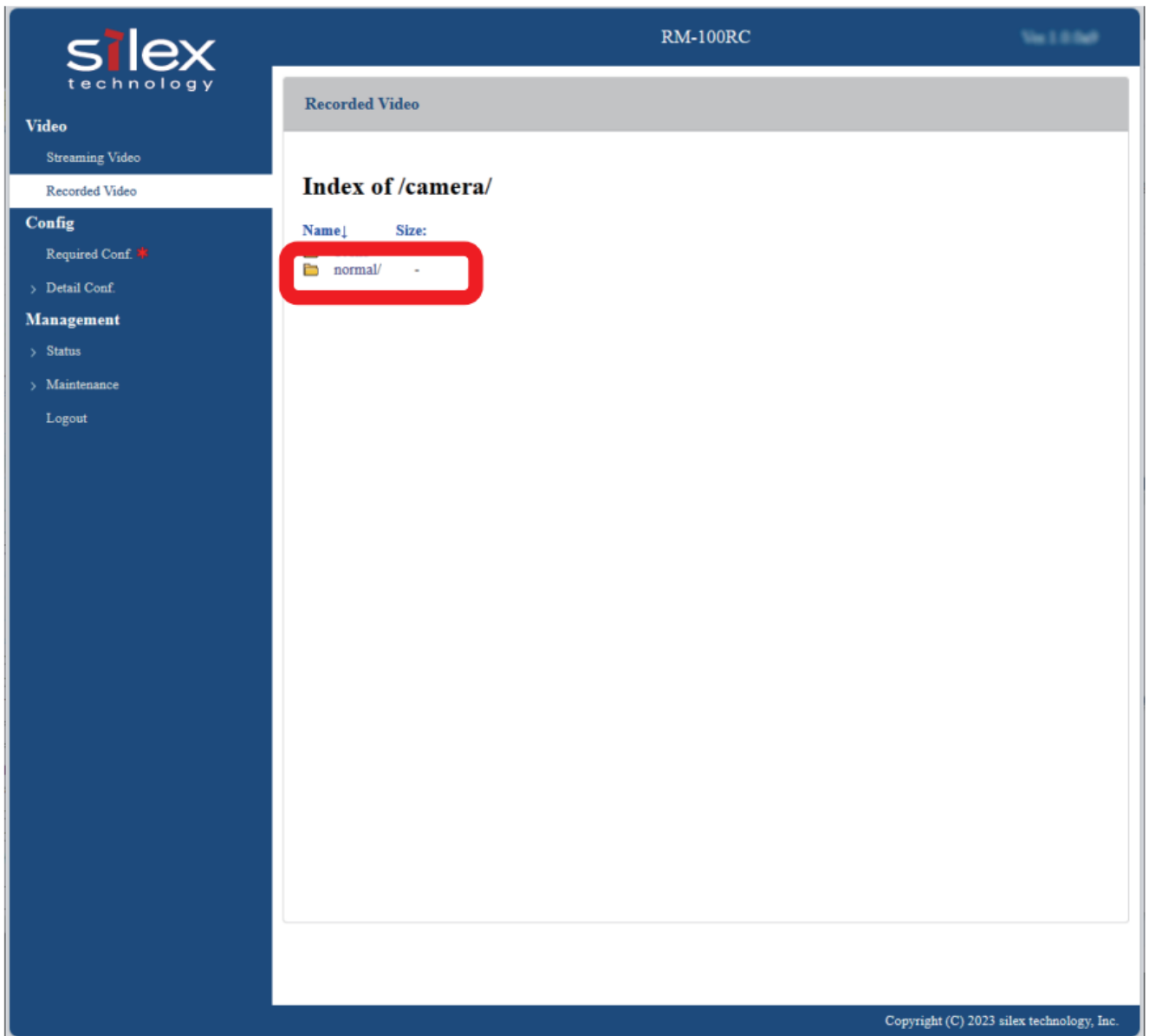

8. The contents of the normal folder are displayed.

Click the folder with the date that the recorded file is created.





RM-100RC

Ver 1.0.0a9

Video

Streaming Video

Recorded Video

Config

Required Conf. 

> Detail Conf.

Management



> Status

> Maintenance

Logout

Recorded Video

Index of /camera/normal/

| Name  | Size |
|---|------|
| ./  | -    |
|  2023-01-01/ | -    |
|  2023-12-07/ | -    |

Copyright (C) 2023 silex technology, Inc.

9. The saved recorded files are listed.
- Click the file to download it, and check the contents of the file.



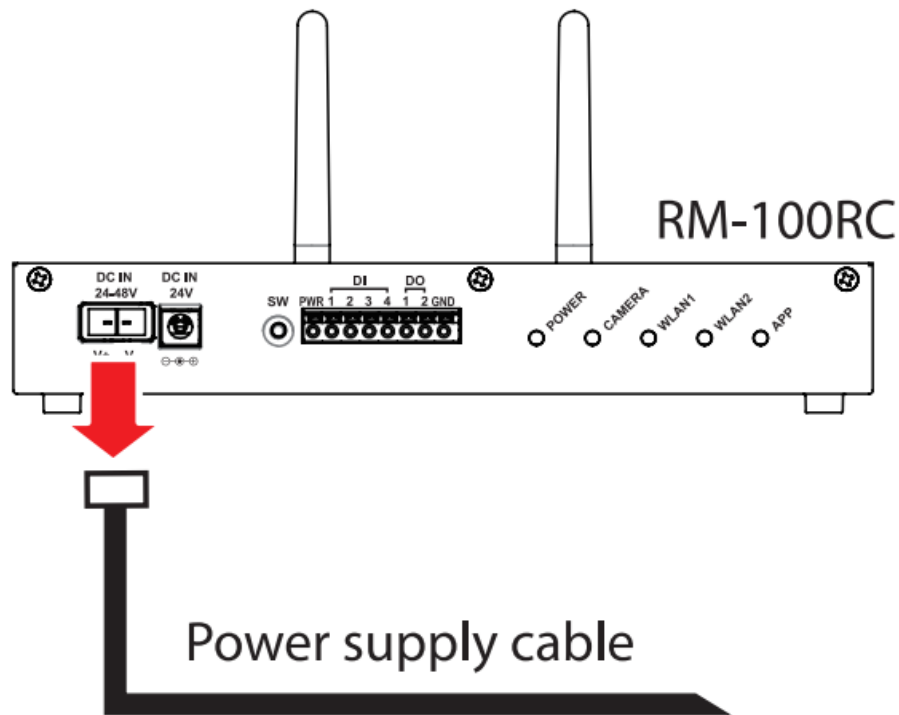

2. Press and hold the push switch of RM-100RC (1) while inserting the power supply cable into the DC connector (2). Keep pressing the push switch.

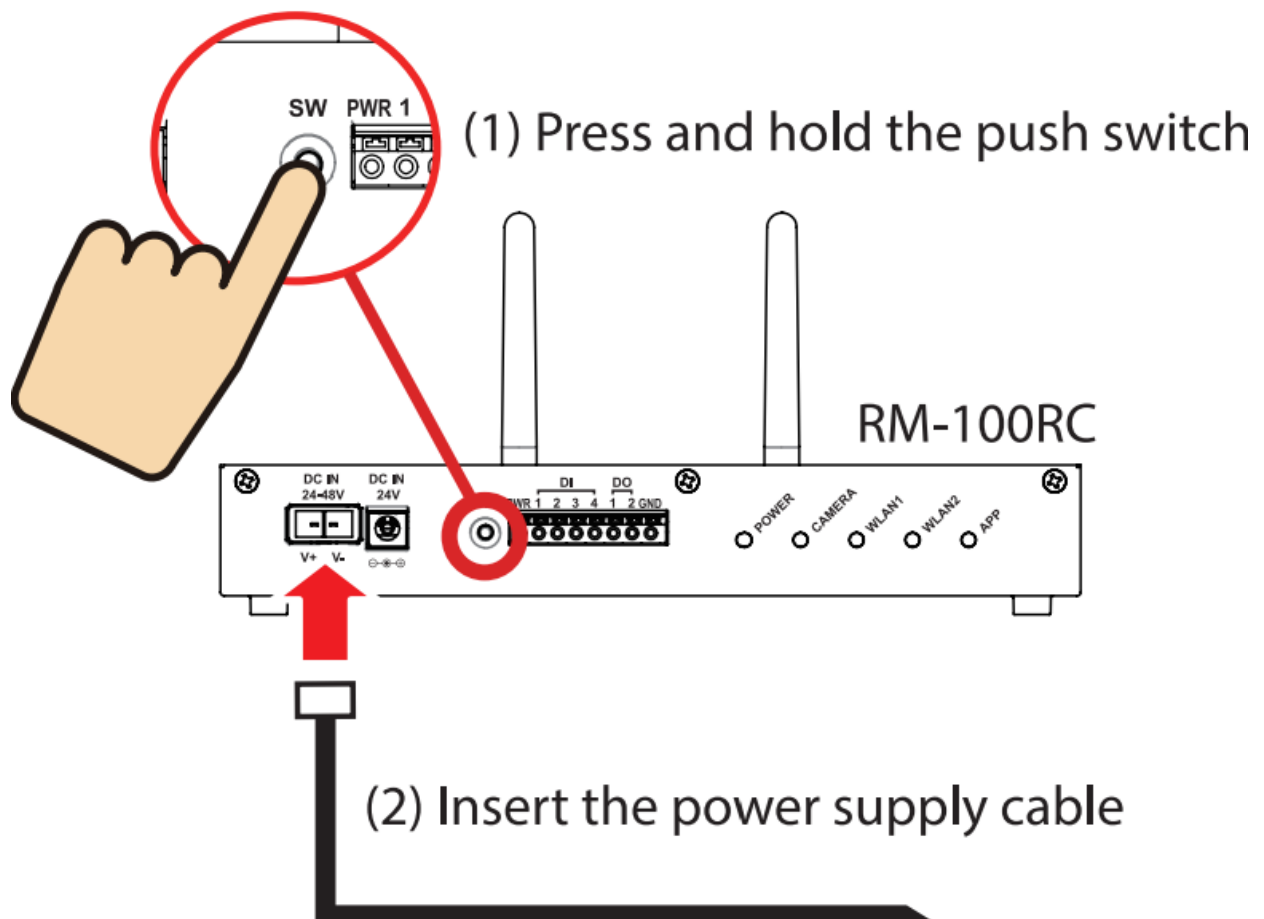

3. The LEDs will turn orange one by one, starting with the POWER LED. When all 5 LEDs turn orange (1), release the push switch (2).

(1) Check that all 5 LEDs turn orange

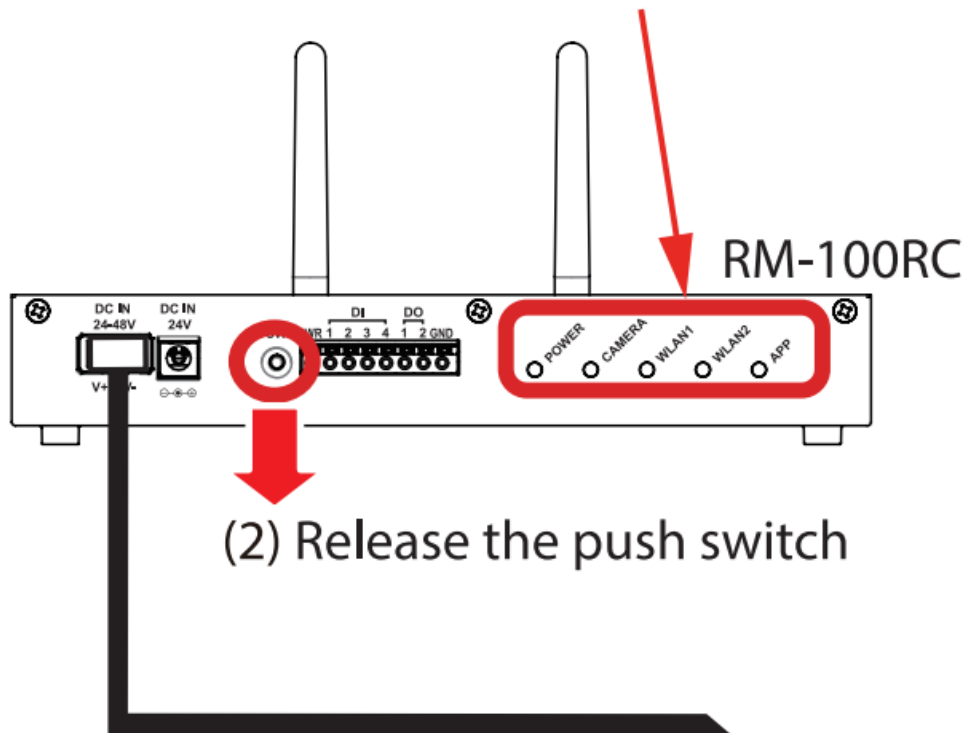

(2) Release the push switch

If the push switch is pressed for 15 sec or longer even after all 5 LEDs turn orange, RM-100RC will start normally without performing the factory default configuration.

4. The factory default configuration begins.

When the POWER LED of RM-100RC turns green or blinks green, the factory default configuration is completed.

Check the POWER LED turns green or blinks green

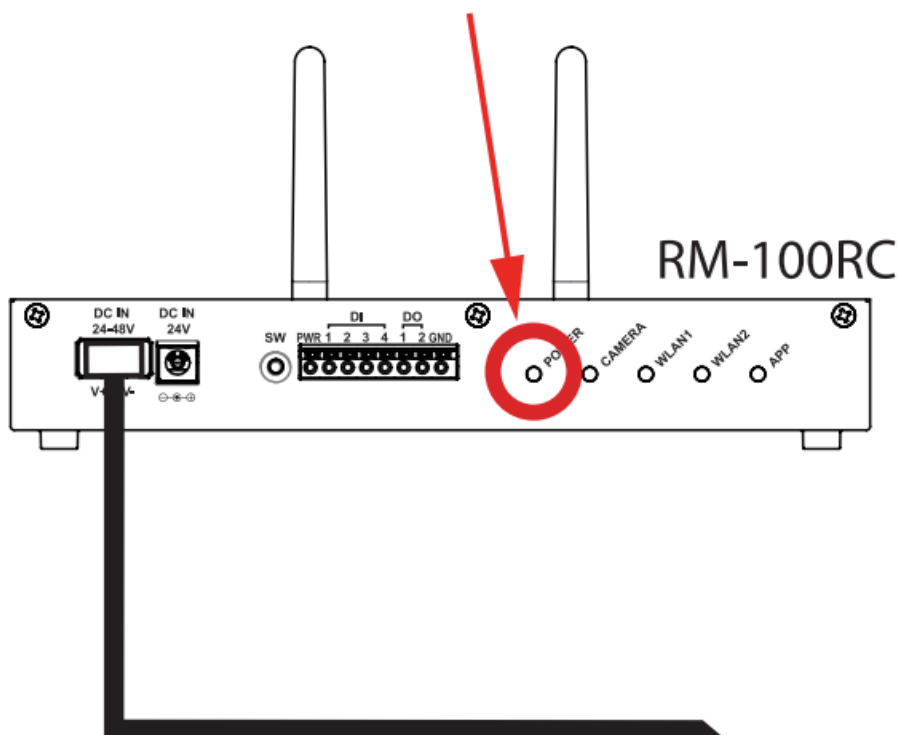

RM-100RC has been reset to the factory defaults.

The name of the recorded file is as follows.

nnnnnnnnn\_YYYYMMDD\_hhmmss\_SN\_T.mp4 nnnnnnnnn: Recorded order

YYYYMMDD: Recording start date (YYYY:year, MM:month, DD:date) hhmmss: Recording start time (hh:hours, mm:minutes, ss:seconds) S: File save method  
M: Multi, S: Single N: Camera number

If the recorded file is from the camera connected to camera port 1, the number will be 1.

If the file save method is Multi, it is fixed to 1.

T: Record type

N: constant recording,

Dn: event recording ('n' represents the digital input number)

If the recorded file is created according to the instructions in this document, the file name will be as below.

000000040\_20231107\_174816\_M1\_N.mp4

You have now finished checking the recorded files.

For details on other functions and settings, refer to the user's manual.

## Downloading User's Manual

The user's manual can be downloaded from the Silex Technology's website. Access the URL below to download it.

<https://www.silextechnology.com/>

1. When the website is displayed, click Support Center in the bottom of the page.
2. Select the product model and download the user's manual.

## ( Trademarks )

- Wi-Fi is a registered trademark of Wi-Fi Alliance.
- Microsoft, Microsoft Edge are registered trademark of Microsoft Corporation in the United States and/or other countries.
- Other company names and product names contained in this document are trademarks or registered trademarks of their respective companies.

## ( Customer Support Center )

If you have any questions, please contact us at the following.

### Customer Support Center information

|        | E-mail   |
|--------|--|
| USA    | <a href="mailto:support@silexamerica.com">support@silexamerica.com</a> |
| Europe | <a href="mailto:support@silexeurope.com">support@silexeurope.com</a>   |

## Documents / Resources



[simx RM-100RC Industrial Multi Camera Drive Recorder](#) [pdf] User Guide  
RM-100RC Industrial Multi Camera Drive Recorder, RM-100RC, Industrial Multi Camera Drive Recorder, Multi Camera Drive Recorder, Camera Drive Recorder

## References

- [User Manual](#)

### Manuals+, Privacy Policy

This website is an independent publication and is neither affiliated with nor endorsed by any of the trademark owners. The "Bluetooth®" word mark and logos are registered trademarks owned by Bluetooth SIG, Inc. The "Wi-Fi®" word mark and logos are registered trademarks owned by the Wi-Fi Alliance. Any use of these marks on this website does not imply any affiliation with or endorsement.