



Strong-Wall Site-Built Portal Frame System Hardware Installation Instructions Manual

[Home](#) » [Simpson](#) » Strong-Wall Site-Built Portal Frame System Hardware Installation Instructions Manual 

Instructions Manual



Single-Wall Portal Frame Kit

- (2) Holdown assemblies
- (2) Orange composite standoff bases*
- (5) Moment connection straps
- (1) Adjustable post base (ABW44Z)
- (33) SDW22300 truss-ply screws
- (8) SD9112 Connector screws
- (1) 6-lobe T40 driver bit
- (1) Installation instructions

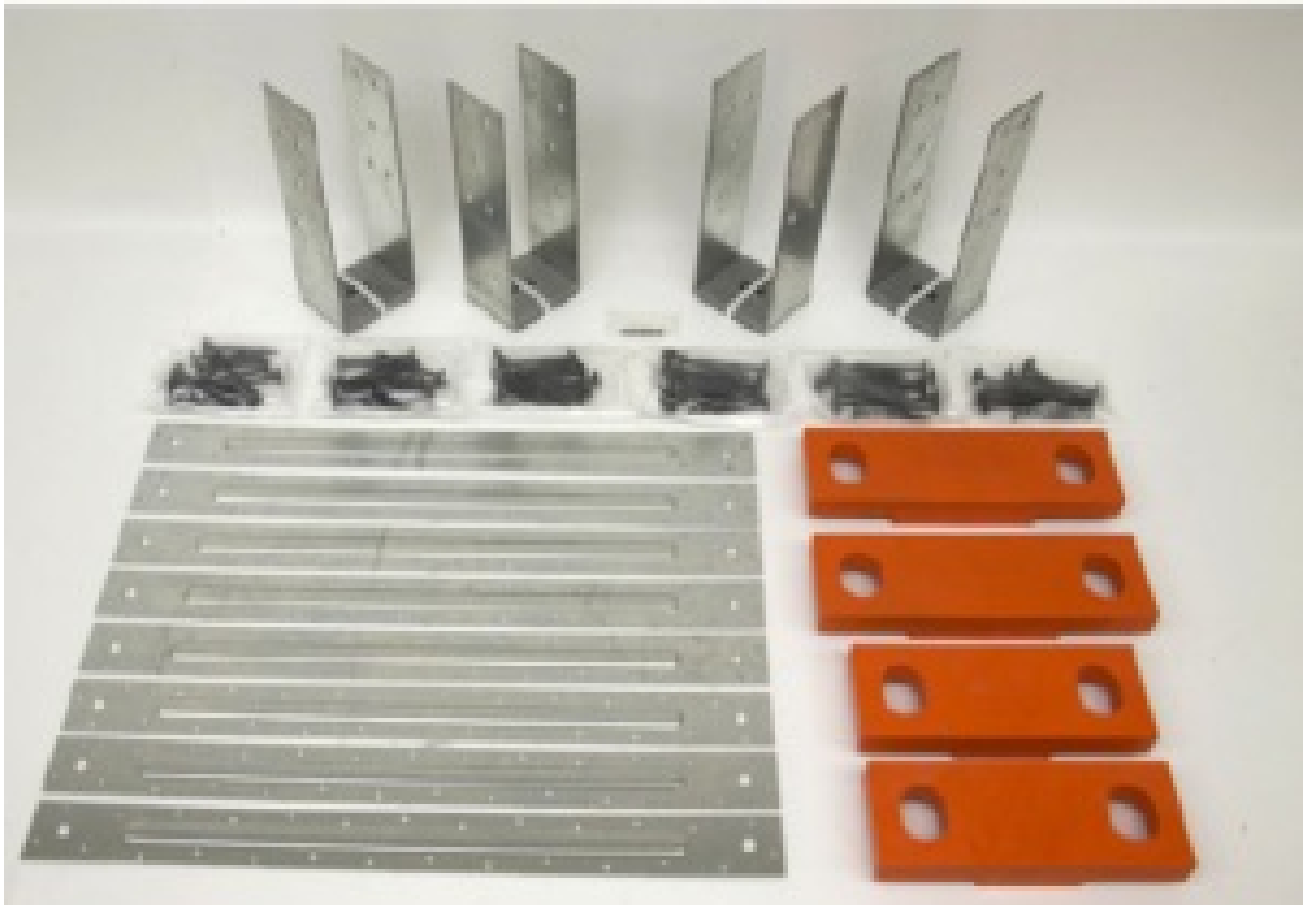

Double-Wall Portal Frame Kit

- (4) Holddown assemblies
- (4) Orange composite standoff bases*
- (8) Moment connection straps
- (66) SDW22300 truss-ply screws
- (1) 6-lobe T40 driver bit
- (1) Installation instructions

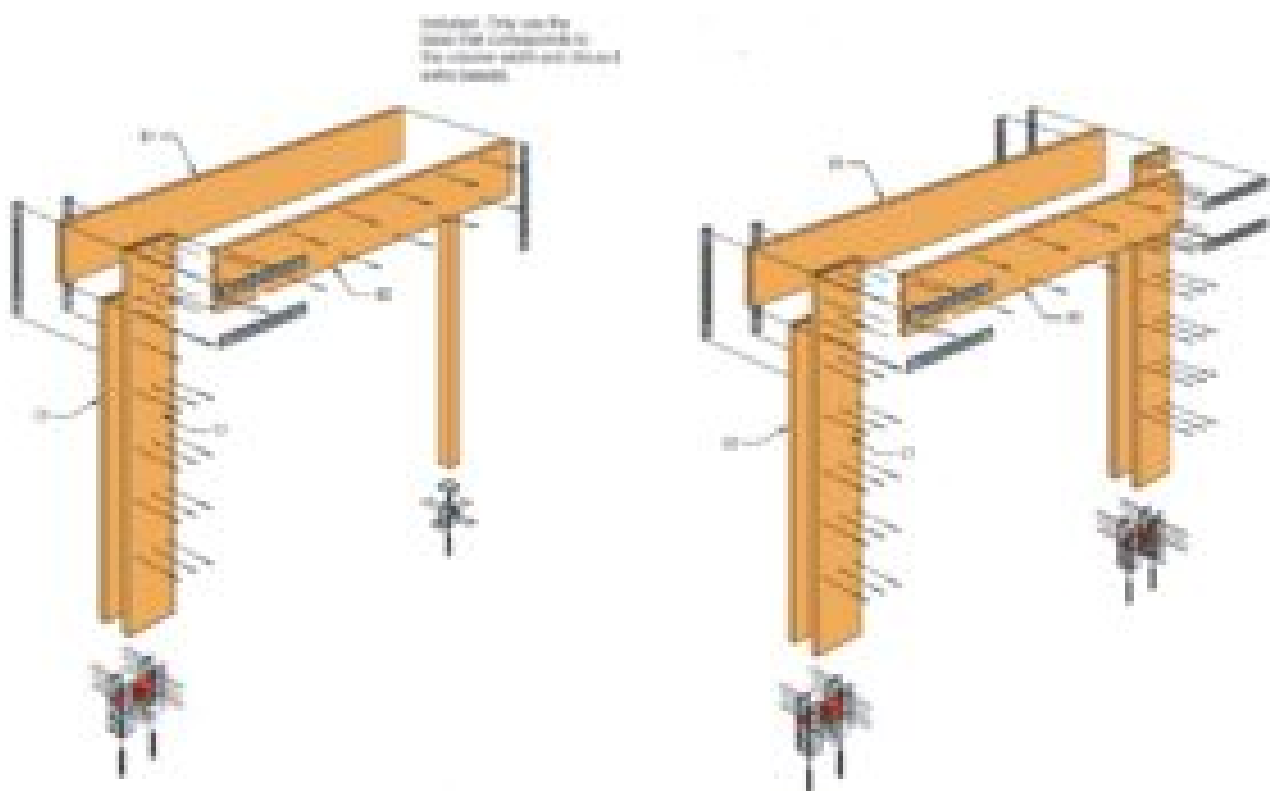

Note: Reference building plan for PFS model and framing material type.

Single-Wall Portal Cut Lengths

Tall column (C1) = $H1 + BD - 35 \text{ mm}$ Short column

(C2) = $H1 - 35 \text{ mm}$

Long beam (B1) = $W1 + CW + PW$

Short beam (B2) = $W1 + PW$

Double-Wall Portal Cut Lengths

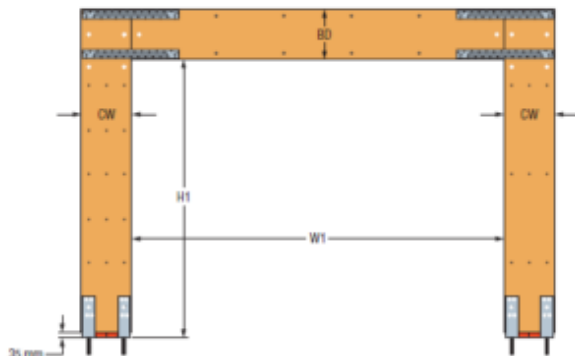

Double-Wall Portal Installation

Tall column (C1) = $H1 + BD - 35 \text{ mm}$

Short column (C2) = $H1 - 35 \text{ mm}$

Long beam (B1) = $W1 + CW + CW$

Short beam (B2) = $W1$

Legend:

BD = Beam Depth

CW = Column Width

PW = Post Width

H1 = Opening Height

W1 = Opening Width

Strong-Wall® Site-Built Portal Frame System Hardware Installation Instructions

Holdown Installation

1. Install holdown assembly on anchor bolts as shown.

2. Tighten nuts on anchor bolts.

Note: Tighten nuts only after adhesive has cured.

Note: Refer to T-L-PFSANAU20 for anchorage installation instructions and details. Reference building plans for anchorage and embedment depth. Additional anchorage information can be found at strongtie.com/au.

Note: Required Fasteners:

SDW22300 SDW Truss-Ply Screw (installation only required from one side)

or use 75mm x 3.75mm nails.

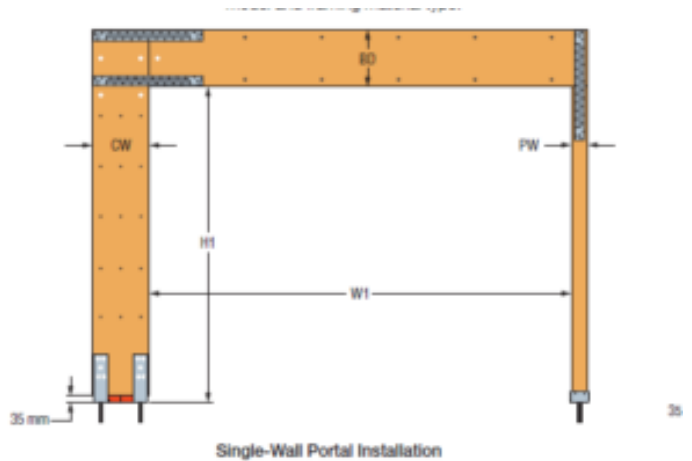

Single-Wall Portal Installation

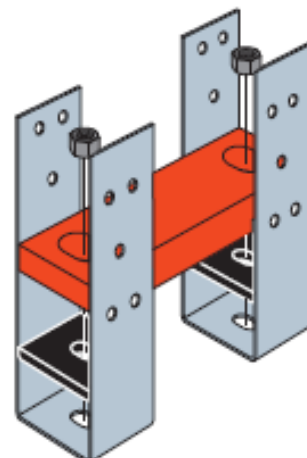

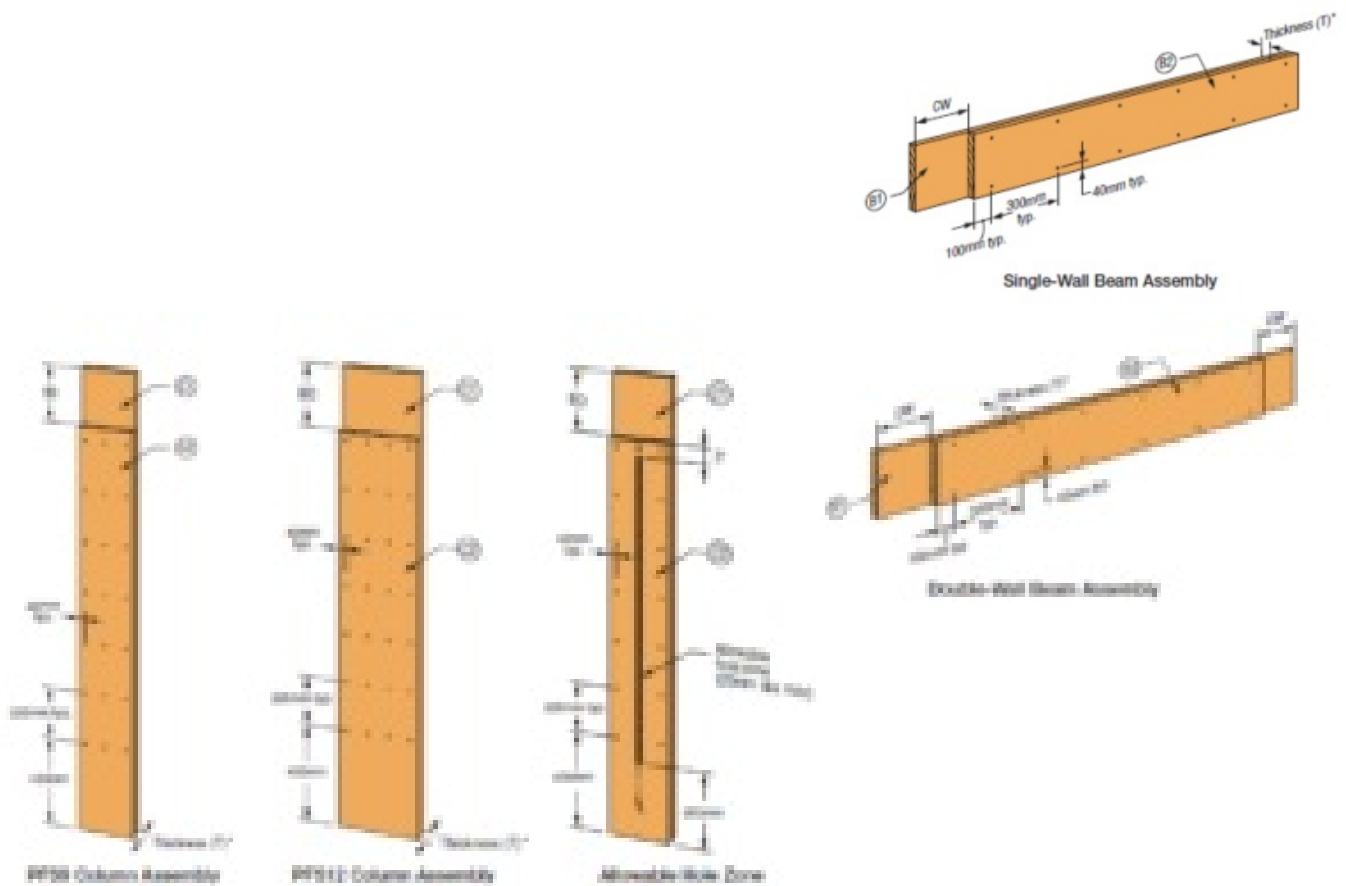

Note: If using nails, every other row is installed on opposite side.

*Note: Required Fasteners:

SDW22300 SDW Truss-Ply Screw (installation only required from one side)

or use 75mm x 3.75mm nails.

Column-to-Beam Moment Connection Installation

1. Connect the beam sub-assembly to the column sub-assembly starting with the SDW screws (provided), as shown.
2. Install the PFS-MCS straps using 3.75mm-diameter nails (64mm minimum length). The straps must be installed horizontally on the tall column (C1) side and vertically on the short column (C2) side, as shown.

Note: Strong-Drive® SD10212 Connector screws (not provided) may be substituted for the nails.



Strong-Wall® Site-Built Portal Frame [Manual Optimized](#)

Strong-Wall® Site-Built Portal Frame [Manual Original](#)

[Manuals+](#).