



Simplified TASP10 Remote Controller User Manual

[Home](#) » [Simplified](#) » Simplified TASP10 Remote Controller User Manual 



TA-SP Remote Controller
Security is just a touch away



User Manual

Contents

- [1 TASP10 Remote Controller](#)
- [2 REMOTE TA-SP](#)
- [3 Button and light illustration](#)
- [4 Add Remote to a lock in APP](#)
- [5 Replace battery](#)
- [6 Limited Warranty](#)
- [7 Contact us](#)
- [8 Documents / Resources](#)
 - [8.1 References](#)

TASP10 Remote Controller



Scan for more help!

REMOTE TA-SP

Model	TA-SP
Dimensions	60.6mm x 29mm x 11.7mm
Material	Plastic
Frequency	2.4GHz
Power supply	CR2032
Voltage	3V
Number of openings	>10000
Idle current	<2uA

Button and light illustration

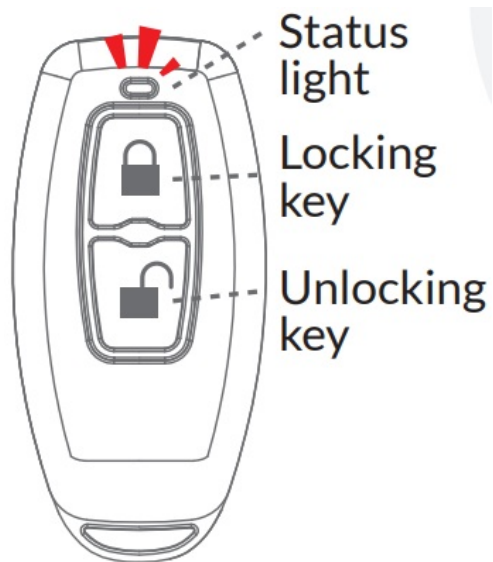

Unlocking: Press the unlocking key to unlock, the status light flickers.
Locking: Press the locking key to lock, the status light flickers.
Low power: The status light flickers slowly on locking/unlocking.

Add Remote to a lock in APP

1. Activate the APP, select the lock you want to add a Remote.

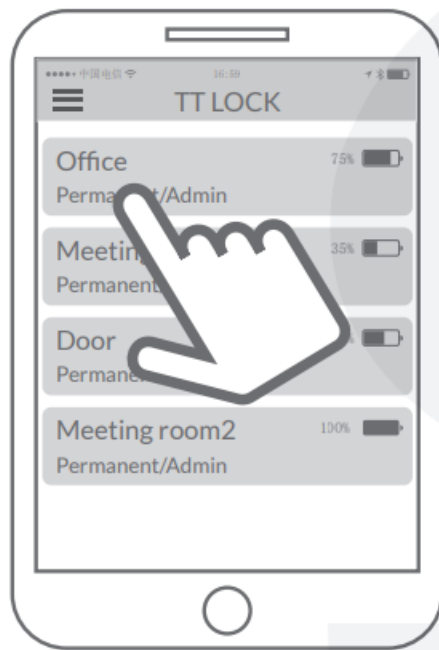

2. Press Wireless Remote.

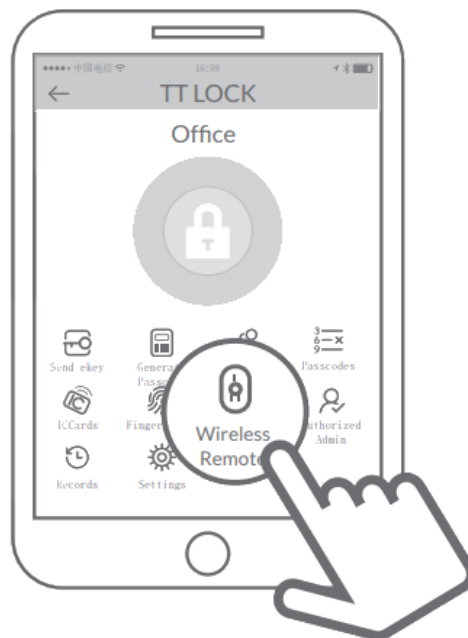

3. Press “Add Remote”



4. Select the time frame, fill in the name and press “Next.”

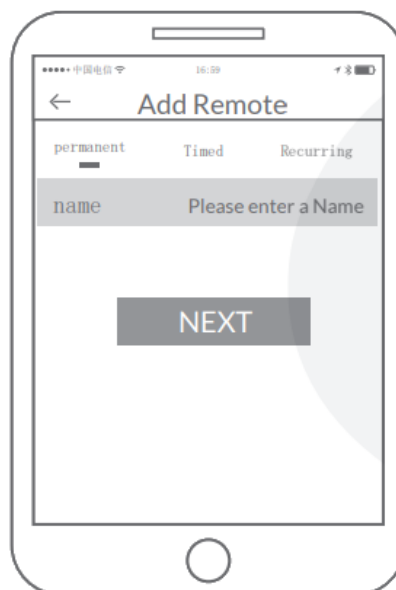

5. Press the device that has an “+” icon to complete.

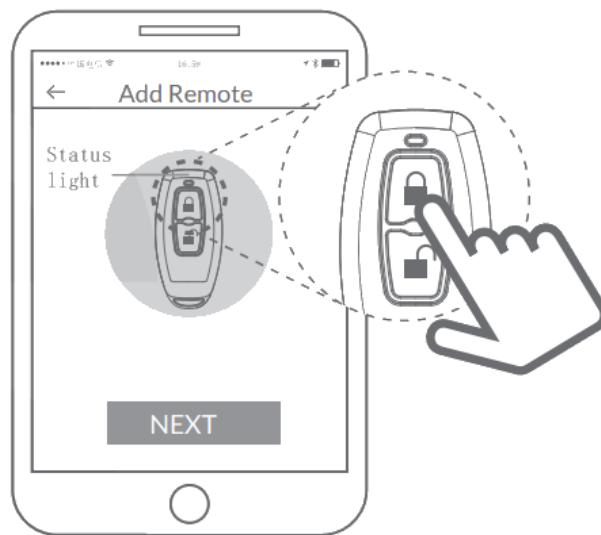

6. Press the device that has an “+” icon to complete.

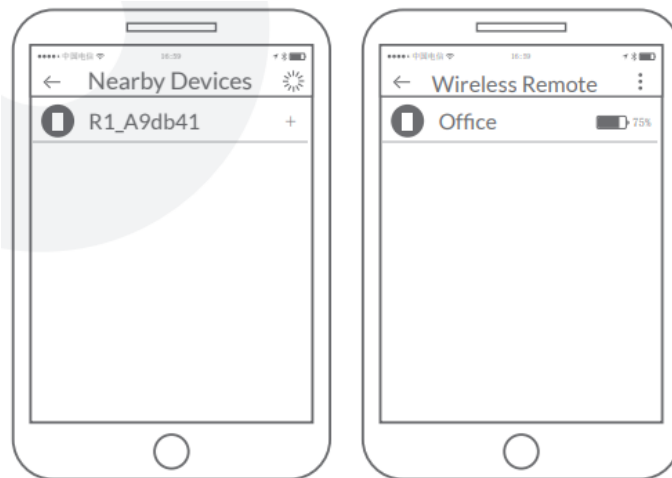

Replace battery

1. Remove the cover of the Remote.

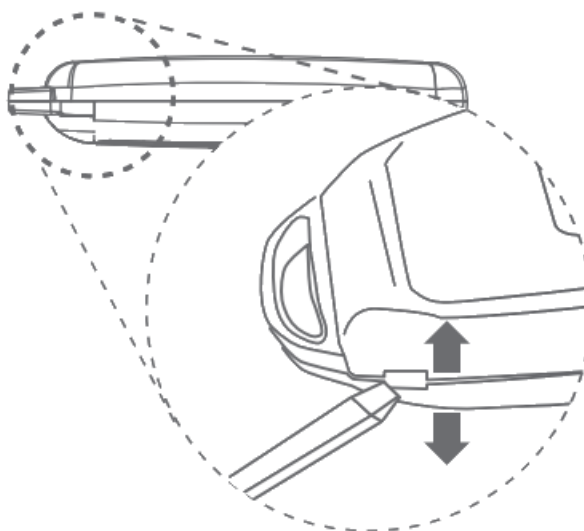

2. Remove the mainboard from the housing.

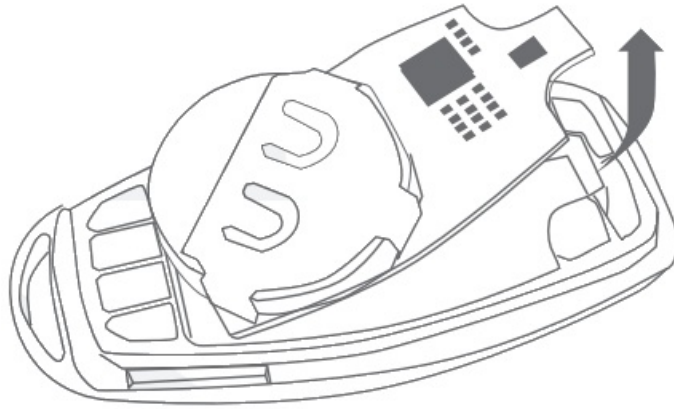

3. Replace the battery and reinstall the cover.

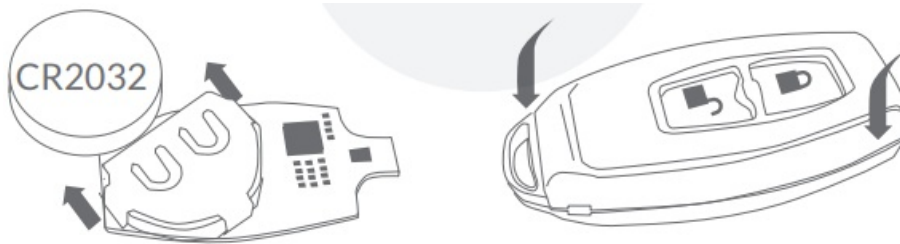

Limited Warranty

1. For any defect in material and workmanship, the original purchaser of the product can:
 - 1) Return or ask for a replacement within 14 invoice days.
 - 2) Ask for free repair in 2 Years.
2. This warranty does not cover defects caused by modification, alteration, misuse or physical abuse of the product.

FCC WARNING

This device complies with part 15 of the FCC Rules. Operation is subject to the following two conditions: (1) this device may not cause harmful interference, and (2) this device must accept any interference received, including interference that may cause undesired operation.

Any changes or modifications not expressly approved by the party responsible for compliance could void the user's authority to operate the equipment.

NOTE: This equipment has been tested and found to comply with the limits for a Class B digital device, pursuant to Part 15 of the FCC Rules. These limits are designed to provide reasonable protection against harmful interference in a residential installation. This equipment generates, uses and can radiate radio frequency energy and, if not installed and used in accordance with the instructions, may cause harmful interference to radio communications.

However, there is no guarantee that interference will not occur in a particular installation.

If this equipment does cause harmful interference to radio or television reception, which can be determined by turning the equipment off and on, the user is encouraged to try to correct the interference by one or more of the following measures:

- Reorient or relocate the receiving antenna.
- Increase the separation between the equipment and receiver.
- Connect the equipment into an outlet on a circuit different from that to which the receiver is connected.
- Consult the dealer or an experienced radio/TV technician for help.

To maintain compliance with FCC's RF Exposure guidelines, This equipment should be installed and operated with minimum distance between 20cm the radiator your body: Use only the supplied antenna.

Disclaimer

We continuously optimize products as new technologies and features are developed. For this reason, we reserve the right to make alterations to the products without prior notice.

Discover our Range of Products:

Simplified is a London-based tech company rolling out innovative IoT devices to elevate the smart home experience. Control your home with a range of smart security devices from Simplified. Whether it's a Smart Door Lock, a Camera Doorbell, Simplified put you in control of your home security.



Want more Accessories? Here is all you want:

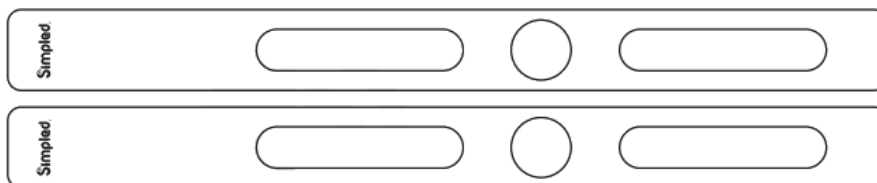

Covering Plates

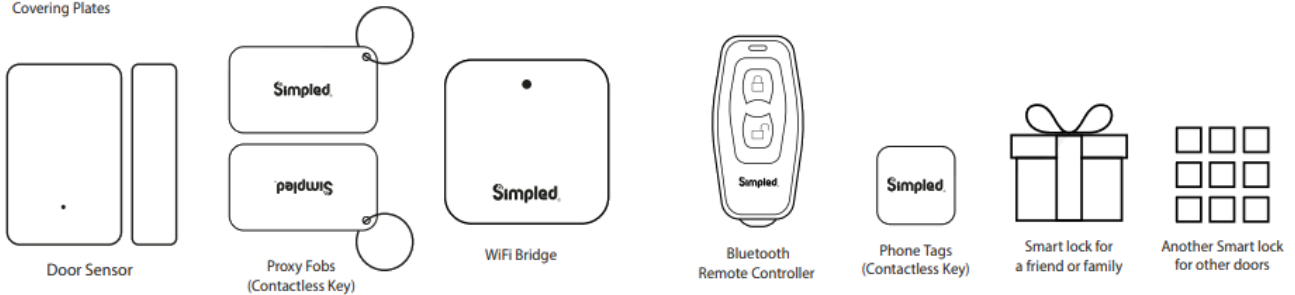

More accessories?
SCAN HERE

<https://simplified.uk/support-ta-sp/>







Note



Easy Amazon Review
Scan me!

<https://simplified.uk/d2ac>

Contact us

 WOW!	We're just happy that you're happy. If you don't know how to express your newfound joy, we've got a few suggestions ...
	Tell your friends and family
	Share your experience by writing a review on Amazon
	Connect with us on simplified.tech Facebook, Twitter and instagram
 MEH.	Our friendly customer service team will work hard to put a smile back on your face. Here's how we can connect:  support@simplified.tech  Simplified.uk/support



Documents / Resources

	Simplified TASP10 Remote Controller [pdf] User Manual TASP10 Remote Controller, TASP10, Remote Controller, Controller
---	--

References

- [User Manual](#)

[Manuals+](#), [Privacy Policy](#)

This website is an independent publication and is neither affiliated with nor endorsed by any of the trademark owners. The "Bluetooth®" word mark and logos are registered trademarks owned by Bluetooth SIG, Inc. The "Wi-Fi®" word mark and logos are registered trademarks owned by the Wi-Fi Alliance. Any use of these marks on this website does not imply any affiliation with or endorsement.