

SIMJOY F10PRO Handheld 3 Axis Gimbal



# SIMJOY F10PRO Handheld 3 Axis Gimbal User Manual

[Home](#) » [SIMJOY](#) » SIMJOY F10PRO Handheld 3 Axis Gimbal User Manual 

## Contents

- [1 SIMJOY F10PRO Handheld 3 Axis Gimbal](#)
- [2 Product Usage Instructions](#)
- [3 Quick start](#)
- [4 Power On/Off](#)
- [5 Instruction for four modes](#)
- [6 Get to know the gimbal](#)
- [7 Switch between horizontal/vertical mode \(Three switching ways\)](#)
- [8 Charging](#)
- [9 Specification](#)
- [10 Storage and maintenance](#)
- [11 FCC](#)
- [12 Documents / Resources](#)
  - [12.1 References](#)

# SIMJOY

**SIMJOY F10PRO Handheld 3 Axis Gimbal**



## **Product Usage Instructions**

### **Connecting the Device**

To connect the device, follow these steps:

1. Identify the appropriate input/output ports on your device.
2. Using the provided cables, connect the device to the corresponding ports on your device.
3. Ensure a secure connection is made between the device and your device.

### **Powering On/Off**

To power on/off the device, use the following steps:

1. Locate the power button on the device.
2. To power on, press and hold the power button for a few seconds until the device powers on.
3. To power off, press and hold the power button again until the device powers off.

### **Adjusting Settings**

The device allows you to adjust various settings to enhance your experience. Follow these steps to access and modify settings:

1. Press the menu button on the device to access the settings menu.
2. Use the navigation buttons to scroll through the available settings options.
3. Select a setting by pressing the enter/select button.
4. Use the navigation buttons to adjust the selected setting.

5. Press the enter/select button to confirm your changes.

## Maintenance and Cleaning

To ensure optimal performance and longevity of the device, follow these maintenance and cleaning guidelines:

- Regularly clean the device using a soft, dry cloth to remove dust and debris.
- Avoid using harsh chemicals or abrasive materials that may damage the device's surface.
- Keep the device away from excessive heat, moisture, and direct sunlight.
- Periodically check for any loose connections or cables and tighten or replace them as needed.

## FAQ

### Q: Can I use the device outdoors?

A: Yes, the device can be used in portable exposure conditions without restriction.

### Q: What should I do if I encounter reception issues?

A: If you experience reception issues, try the following troubleshooting steps:

1. Ensure that the device is properly connected to your device.
2. Check for any obstructions or interference that may affect the signal.
3. Reposition the device to improve signal strength.
4. If the problem persists, consult the dealer or an experienced technician for further assistance.

## Quick start

### Quick start, install the smartphone and adjust balance (don't power on)

1. Remove the smartphone case before installing, and put the smartphone on the phone holder and make the smartphone at the middle of holder.
2. Please put the smartphone in the phone holder, and keep the phone resists the motor as below picture shows, to avoid the vibration while using.

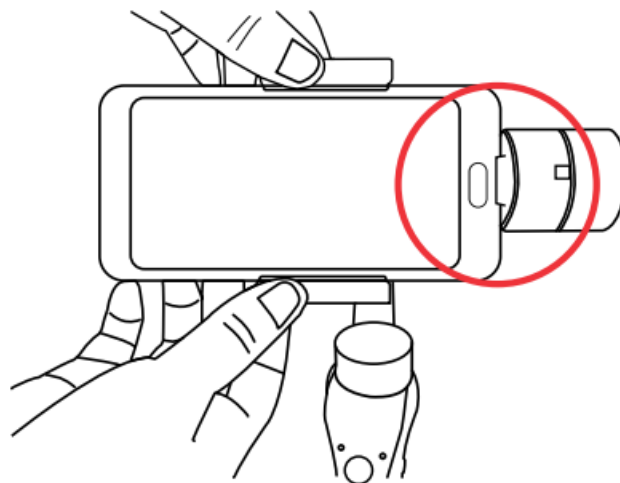

3. Loosen the balance knob, and adjust the balance arm until the smartphone is in nearly balance condition.

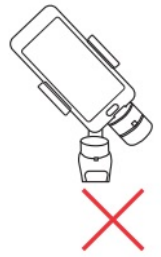
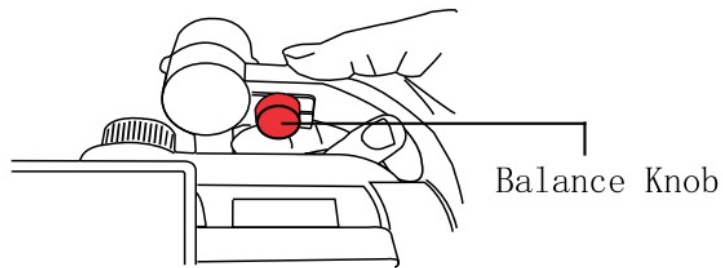

## Power On/Off

### Power on

Press the power button until the indicator lights are on.

Power on/off

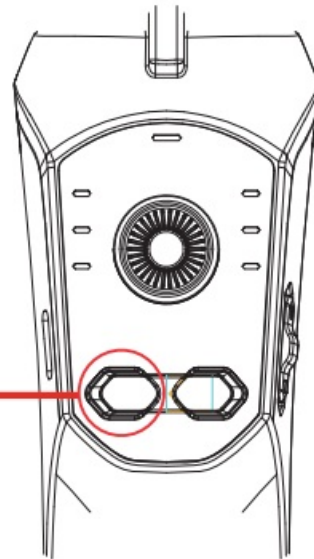

### Power off

Press the power button until the indicator lights are off.

### Connect to the bluetooth by native camera

Power on the gimbal, open the bluetooth on the phone, go into smartphone bluetooth setting page, choose the device name "GP5-xxxx" to connect.

## Instruction for four modes

**All Follow(AF):** The Roll axis is locked, the Pan axis (left/right) and Tilt axis(up/down) will follow the movement of handle.

※ Default mode upon powering on

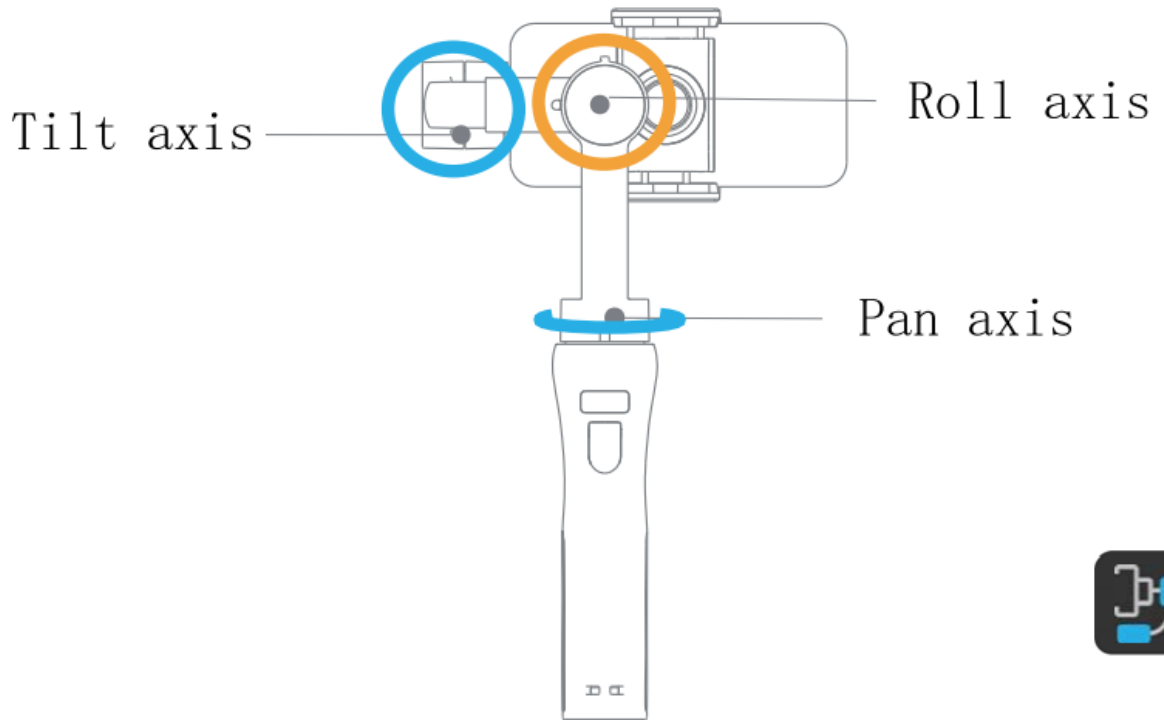

**Half Follow(HF):** Tilt & Roll axis are locked. Pan axis rotates (left/right) smoothly with the handle.

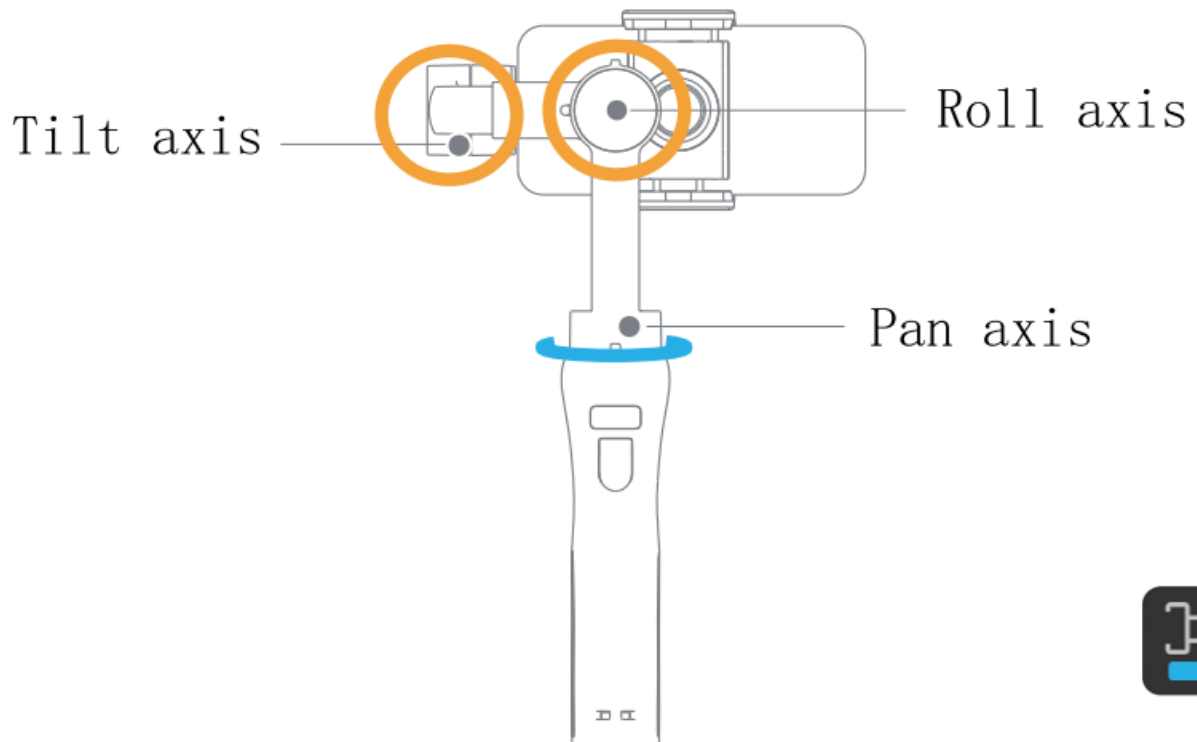

**Lock Full(LF):** Pan, Tilt, Roll axis are all locked. The camera remains still and stable, which means the camera cannot follow the movement of the handle.

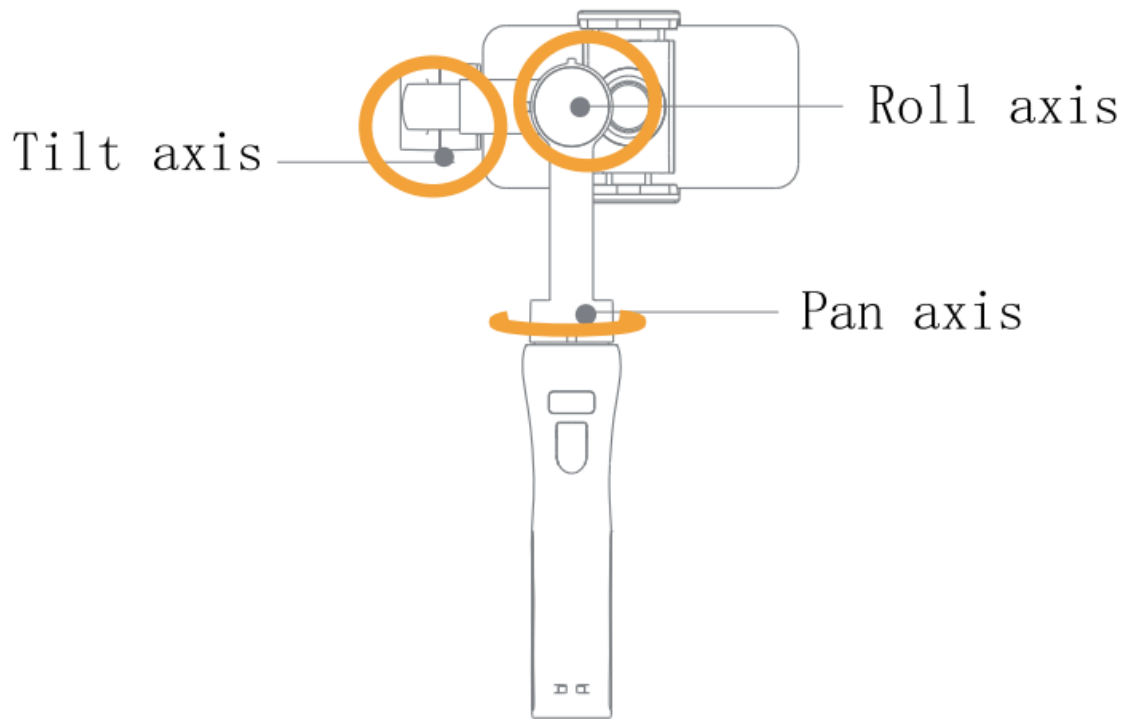

**First person view(FPV):** Pan, Tilt, Roll axis follow the movement of the handle.

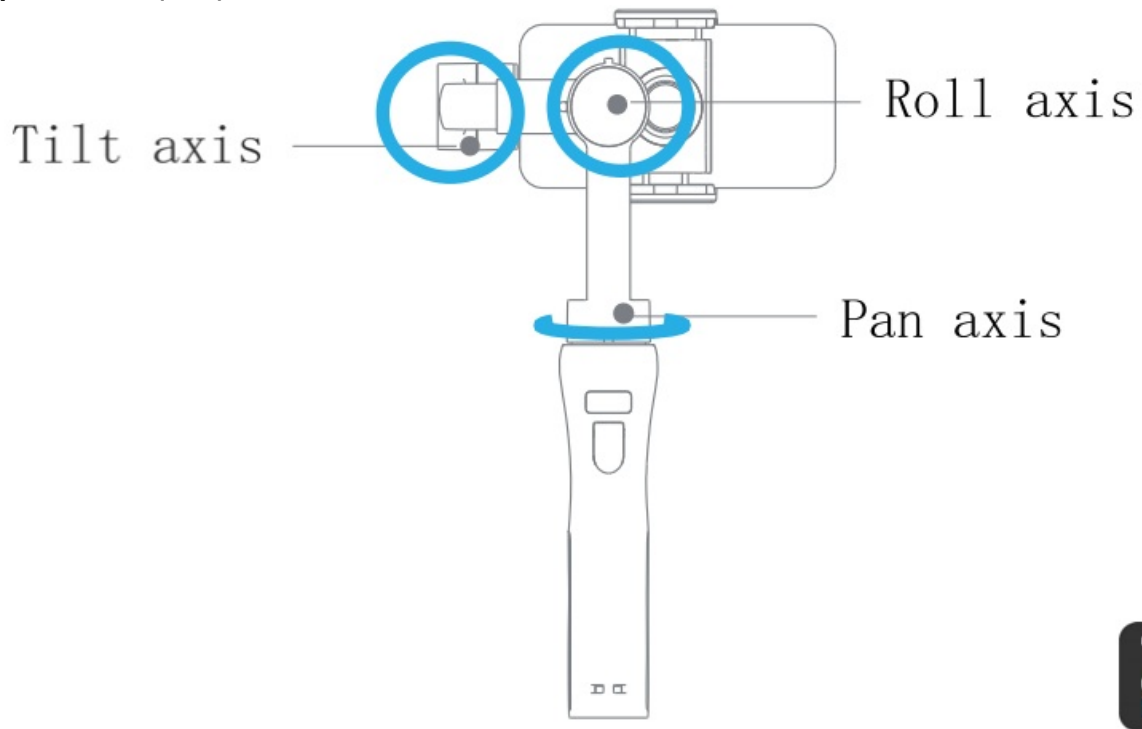

### Phone Go

Long press the shutter button until the AF light is flashing, gimbal go to Phone Go mode, release the shutter button, gimbal will go out of Phone Go mode.

### Get to know the gimbal

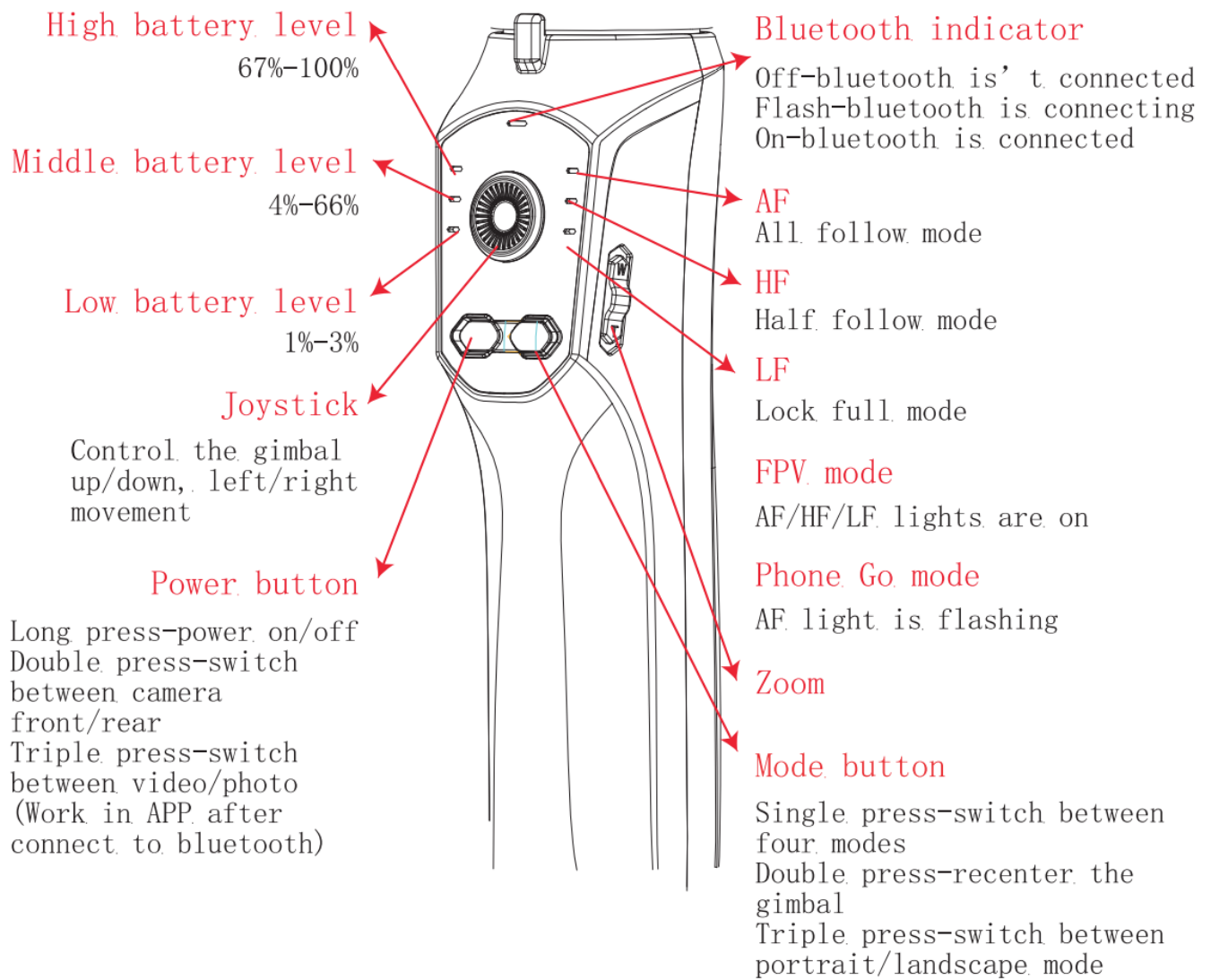

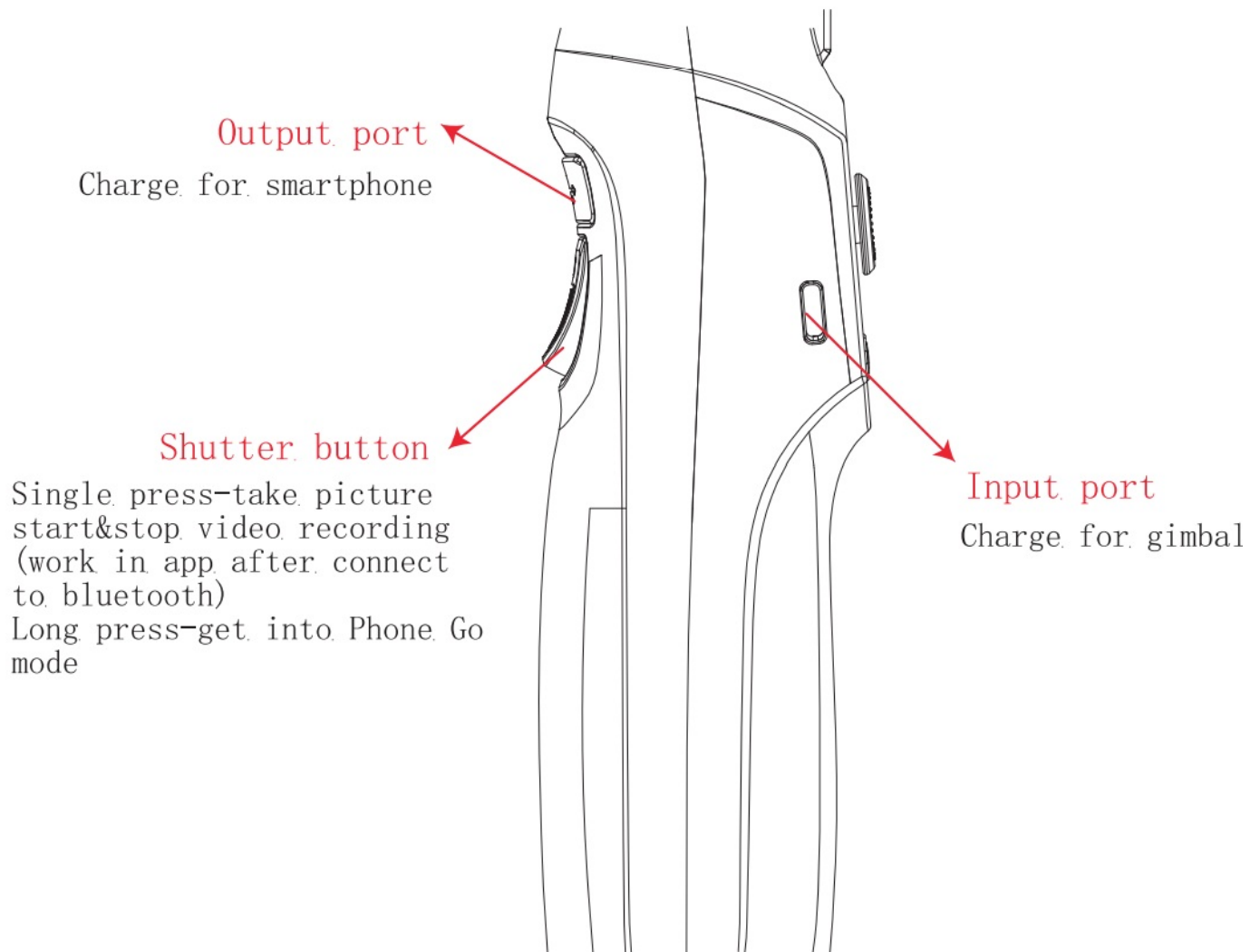

### Switch between horizontal/vertical mode (Three switching ways)

#### Way 1: Press the power button three times

1. Put the gimbal as the below picture shows.
2. Press the power button three times, switch from horizontal mode to vertical mode.
3. Press the power button three times again, switch from vertical back to horizontal mode, or the gimbal will back to horizontal mode automatically when hold the gimbal upright;

**Reminder:** FPV mode doesn't support this operation.





Press the power button three times



### Way 2: Gesture switch

1. Hold the gimbal perpendicular to the ground.
2. Tilt the gimbal left or right with 70°.
3. Gimbal will go to vertical mode automatically.
4. Gimbal will back to horizontal model automatically when holding the gimbal upright.

**Reminder:** FPV mode doesn't support this operation.

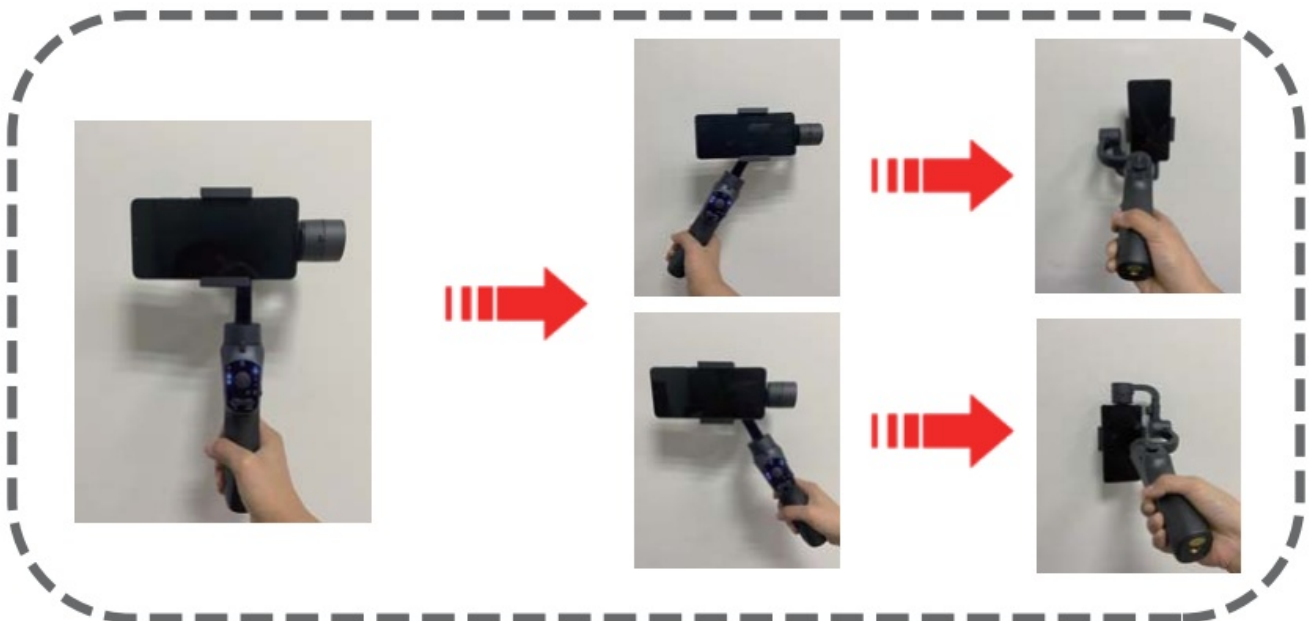

### Way 3: Rotate the smartphone clamp

1. Loosen the clamp knob.
2. Rotate the smartphone clamp with 90°.
3. Tighten the clamp knob.

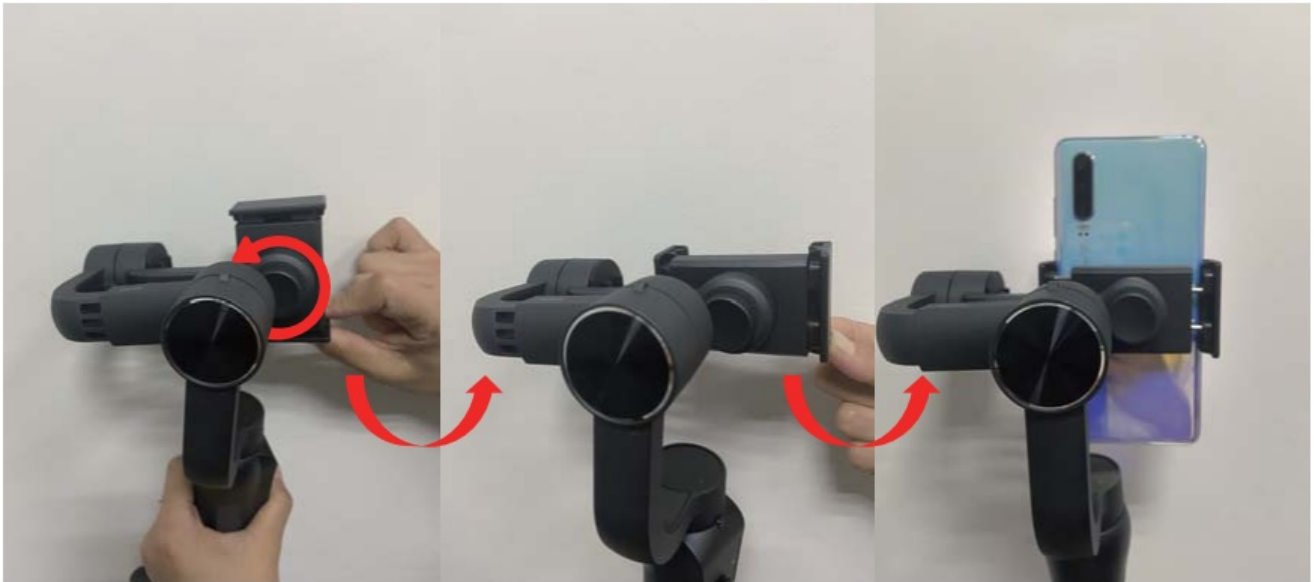

## Charging

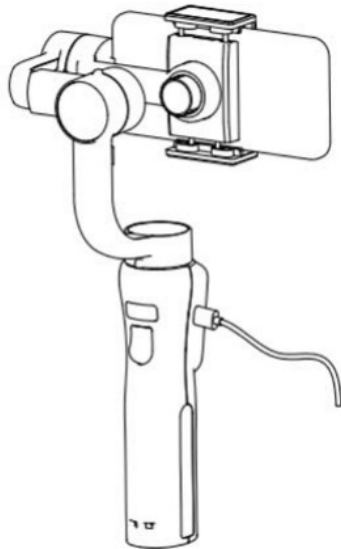

Charge for gimbal

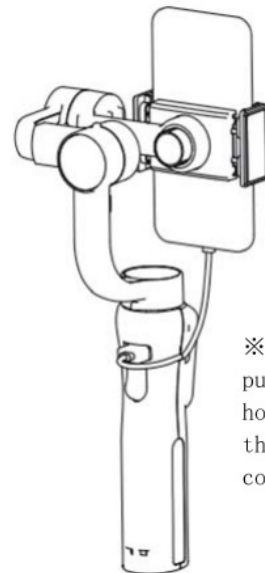

※(when smartphone is put on the clamp horizontally, need use the L-type charging connector)

Charge for smartphone

## About APP

This product supports native camera, can do basic stable shooting without APP with a native camera. If you want to use more functions (such as panoramic, zoom, tracking and time-lapse), need download and use the app.

### Download the Gimbal Pro APP

Scan the QR code or search "Gimbal pro" on the Google play or App store:

- Gimbal Pro requires iOS 12.0 system and later or Android 8.0 system and later.



Support iOS and Android

#### Connect to Gimbal Pro APP

1. Go to setting page on smartphone.
2. Go to Bluetooth setting, find and click the device name "GP5 xxxx".

#### Specification

Pitch(Tilt) Angle	330°
Roll Angle	180°
Panning Angle	330°
Weight	440g
Payload	75-250g
Operating Temperature	0C° - 40C°
Controllable Pitch Angle	+155/-155°
Controllable Roll Angle	+30° /-30°
Controllable Pan Angle	+155/-155°
Operating Voltage	3.4~4.2V (Standard 3.7V)
Compatible Models	1. Smartphone width: 6-8.5cm 2. Smartphone length: no more than 16.5cm 3. Smartphone weight no more than 250g

Operating Current	150~3000mA (Standard 1500mA)
Gimbal Dimensions	10.8*7*28.9cm
Charging Time	4 hours
Usage Time	8-10 hours
Face tracking	Yes
APP	Yes
Zoom	Yes
Output/Input Current	1A
Output/Input Voltage	5V
Arm material	PPA+Nylon
Handle material	ABS+PC

#### Caution

1. Ensure the motor rotation is not blocked by external force during and after the stabilizer is powered on.
2. Please do not contact with sea water or corrosive liquid.
3. Please do not disassemble the stabilizer (except for the detachable accessories in the manual).
4. If the motor works continuously for a long time, the surface temperature of the motor may be too high.
5. It is strictly forbidden to drop or collide with the stabilizer, which may damage it and cause abnormal operation.

#### Storage and maintenance

1. Please keep this product away from children and pets.
2. It is forbidden to put the product near the heat source (furnace or heater, etc.) and in the car at hot weather.
3. Please store the product in a dry environment.
4. Do not overcharge or discharge the battery, otherwise the battery cell will be damaged.
5. Do not use the product in the environment with too high or too low temperature.

#### FCC

This device complies with part 15 of the FCC Rules. Operation is subject to the following two conditions: (1) this device may not cause harmful interference, and (2) this device must accept any interference received, including interference that may cause undesired operation.

Any changes or modifications not expressly approved by the party responsible for compliance could void the user's authority to operate the equipment.

**NOTE:** This equipment has been tested and found to comply with the limits for a Class B digital device, pursuant

to Part 15 of the FCC Rules. These limits are designed to provide reasonable protection against harmful interference in a residential installation. This equipment generates, uses and can radiate radio frequency energy and, if not installed and used in accordance with the instructions, may cause harmful interference to radio communications. However, there is no guarantee that interference will not occur in a particular installation. If this equipment does cause harmful interference to radio or television reception, which can be determined by turning the equipment off and on, the user is encouraged to try to correct the interference by one or more of the following measures:

- Reorient or relocate the receiving antenna.
- Increase the separation between the equipment and receiver.
- Connect the equipment into an outlet on a circuit different from that to which the receiver is connected.
- Consult the dealer or an experienced radio/TV technician for help.

The device has been evaluated to meet general RF exposure requirement. The device can be used in portable exposure condition without restriction



Documents / Resources

	<p><a href="#">SIMJOY F10PRO Handheld 3 Axis Gimbal</a> [pdf] User Manual F10PRO Handheld 3 Axis Gimbal, F10PRO, Handheld 3 Axis Gimbal, 3 Axis Gimbal, Axis Gimbal, Gimbal</p>
---	---

References

- [User Manual](#)

[Manuals+](#), [Privacy Policy](#)

This website is an independent publication and is neither affiliated with nor endorsed by any of the trademark owners. The "Bluetooth®" word mark and logos are registered trademarks owned by Bluetooth SIG, Inc. The "Wi-Fi®" word mark and logos are registered trademarks owned by the Wi-Fi Alliance. Any use of these marks on this website does not imply any affiliation with or endorsement.