



SIM LAB Quad Add-On Quad Monitor Stand Instruction Manual

[Home](#) » [SIM-LAB](#) » SIM LAB Quad Add-On Quad Monitor Stand Instruction Manual 

Contents

- [1 SIM LAB Quad Add-On Quad Monitor Stand](#)
- [2 Product Information](#)
- [3 Product Usage Instructions](#)
- [4 BEFORE YOU START](#)
- [5 Inserting Slot-Nuts](#)
- [6 Tools needed](#)
- [7 Documents / Resources](#)
 - [7.1 References](#)



SIM LAB Quad Add-On Quad Monitor Stand



Product Information

- **Product Name:** Quad Add-On
- **Version:** 1.2
- **Last updated:** 11-10-2023

Description

The Quad Add-On is a product from Sim-Lab that is designed for assembly and installation. It comes with various components and hardware to build a sturdy structure for your equipment.

Product Usage Instructions

1. Before starting the assembly, please check the bill of materials provided on page 10 of the user manual to ensure that all the necessary parts are delivered.
2. **Inserting Slot-Nuts:**

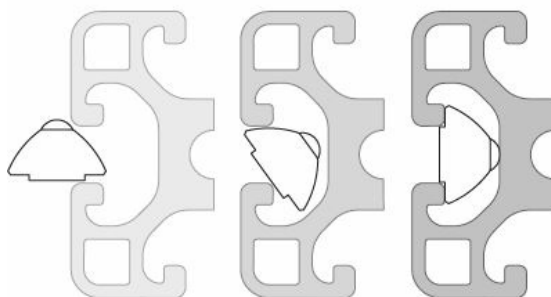

- To insert a Slot-Nut into the slot from the side, refer to the diagram provided in the user manual.
- You can use a smaller Hex wrench to help wiggle the Slot-Nut in place.

3. **Breaking tabs:**

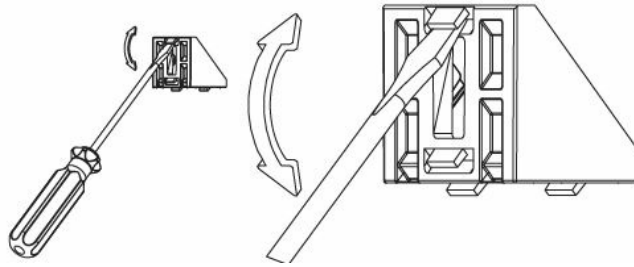

- Sometimes, tabs from corner brackets need to be broken off to fit as instructed.
- To break off the tabs, place a flathead screwdriver behind the tab and tilt upwards.
- Always ensure that you point away from yourself while doing so.

4. Assembly Steps:

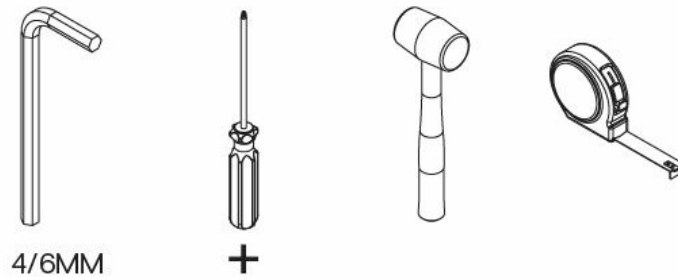

- Refer to the provided diagram and gather the necessary tools: a 4/6MM hex wrench, a 22 | 11 hex wrench, and a 320MM slot-nut M8 slot-nut M6 (A15).

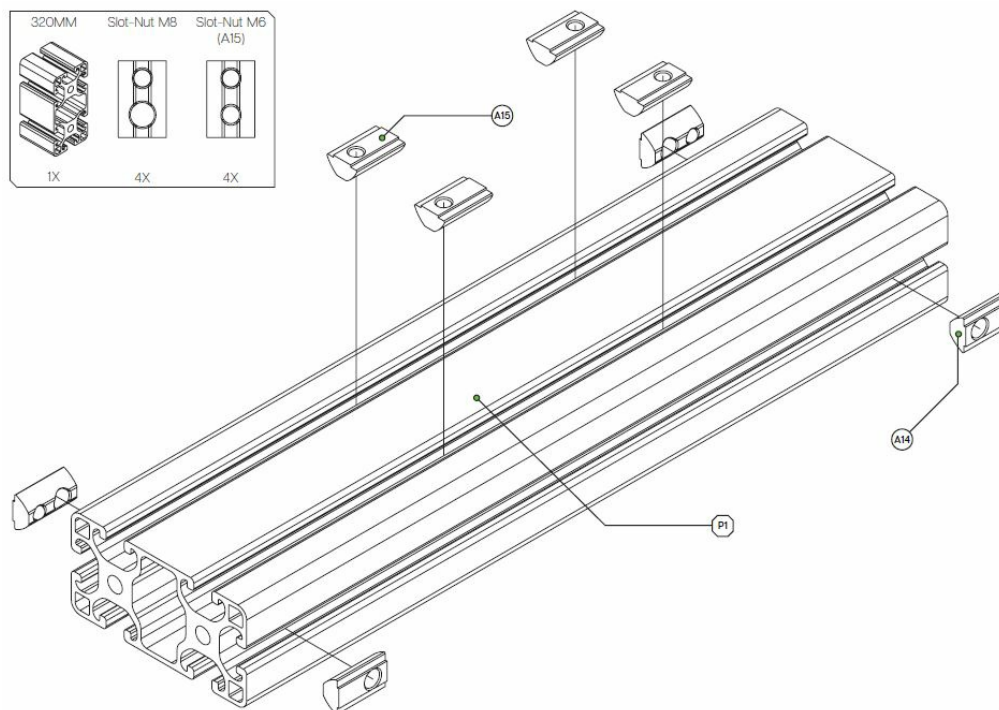

- Follow the instructions for each step, indicated by the corresponding symbols, brackets, and part numbers.

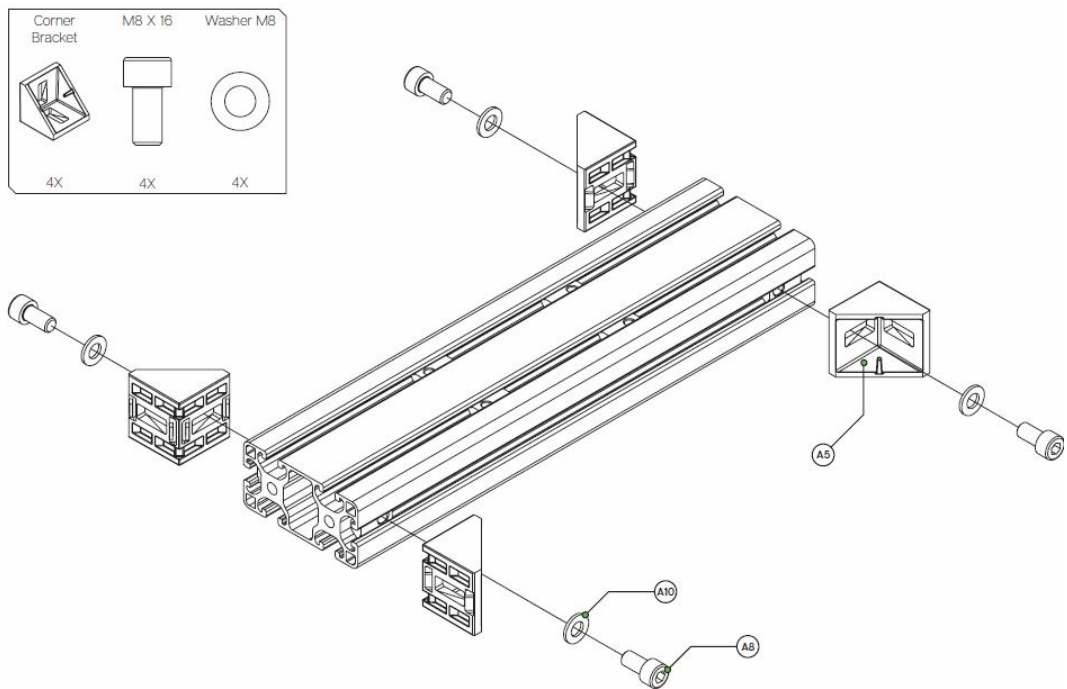

- Use the provided hardware kit components, such as corner brackets, washers, bolts, screws, and slot nuts, as specified in the user manual.

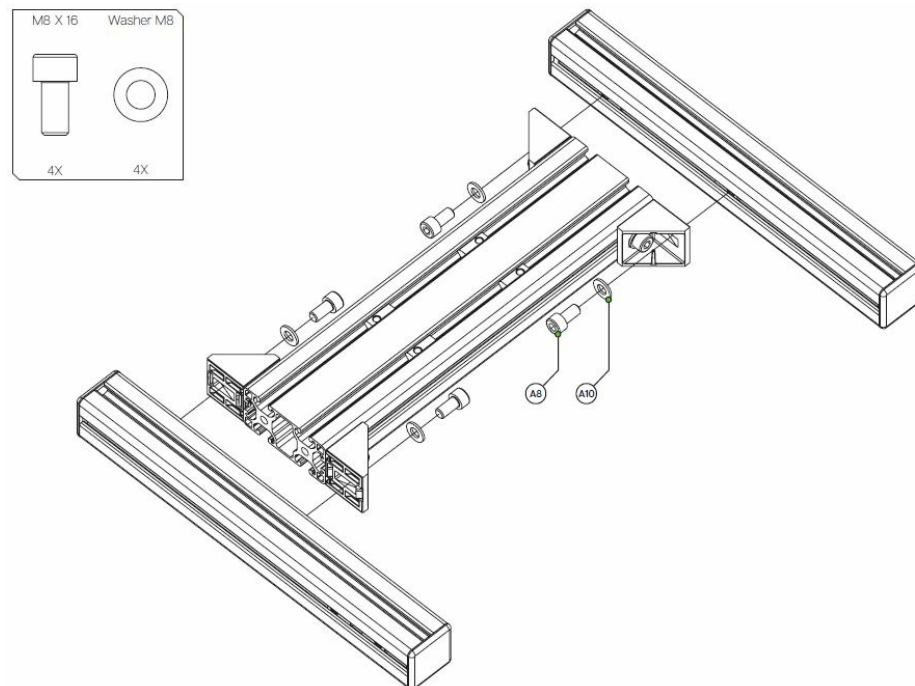

- Repeat the necessary steps to build the desired structure.

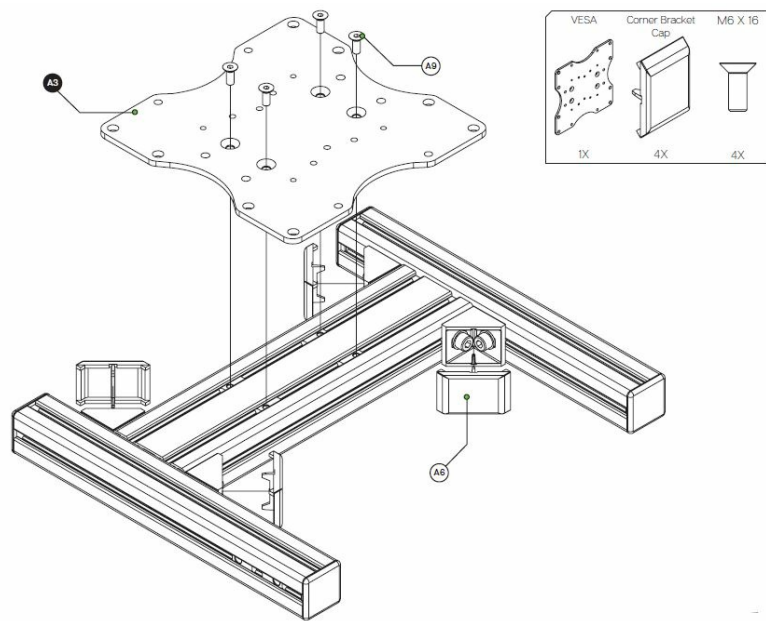

5. If you have any questions or need assistance with the assembly process or the user manual itself, you can contact Sim-Lab's support department at support@sim-lab.eu.

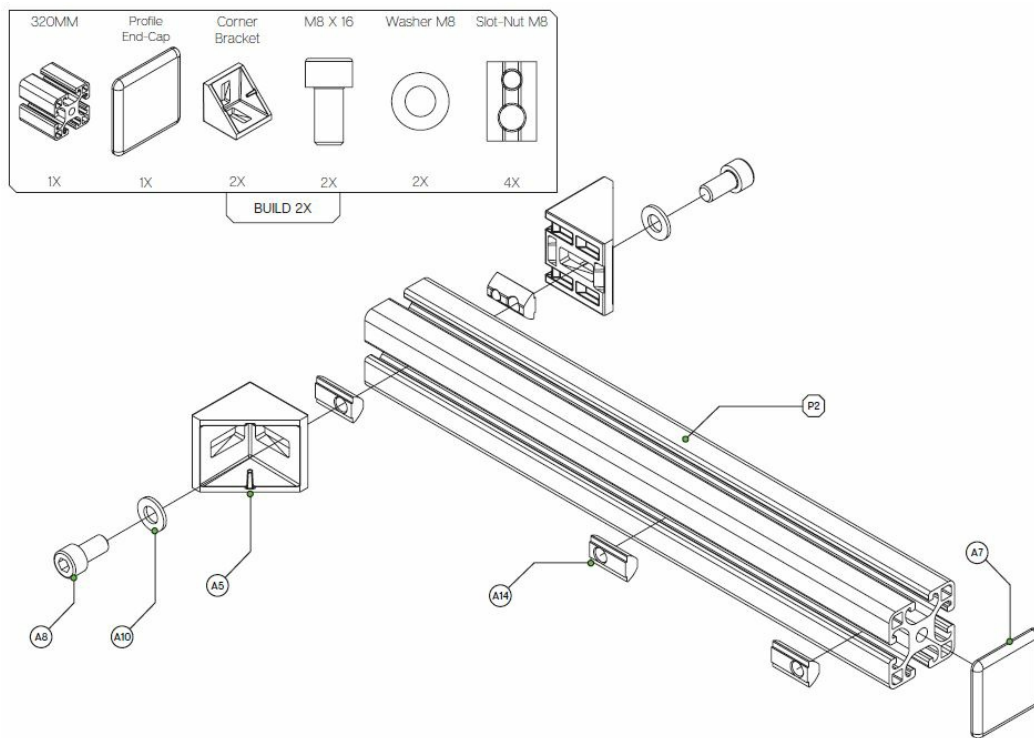

6. Alternatively, you can join Sim-Lab's Discord server where experienced customers can provide assistance. Visit www.sim-lab.eu/discord for more information.

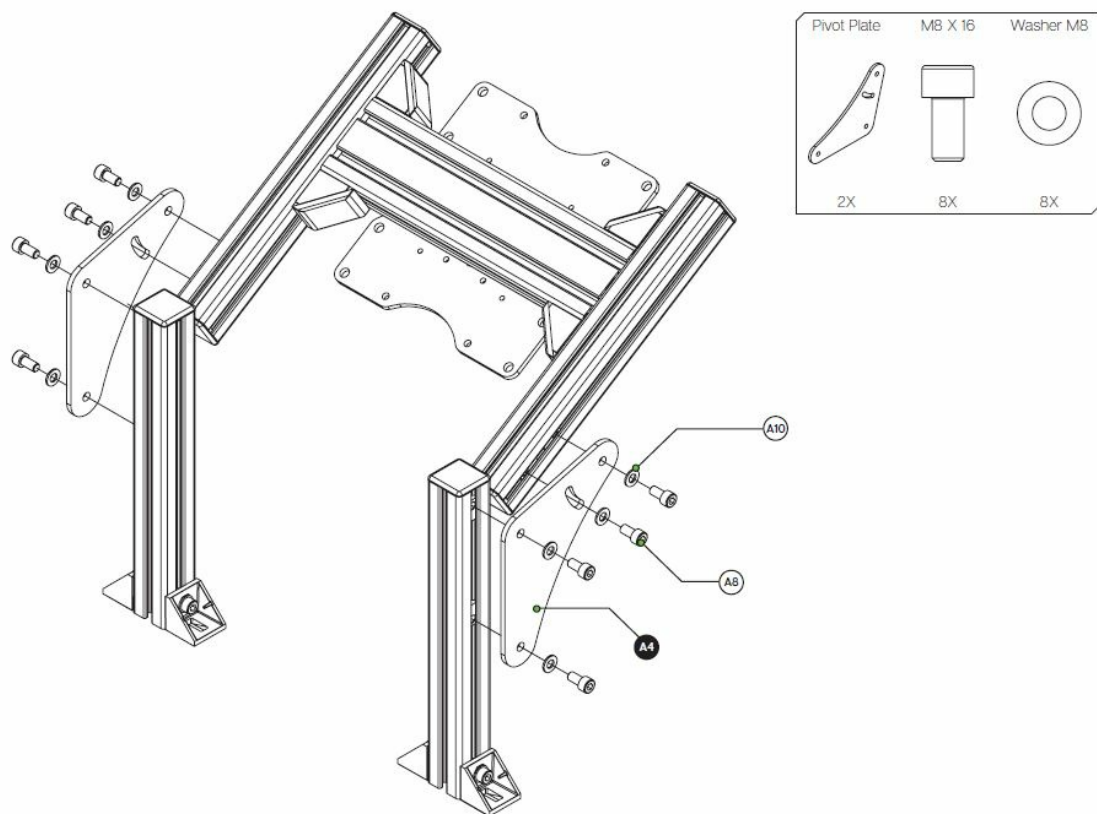

7. For environmental considerations, it is recommended to avoid printing the manual unless necessary. If you choose to print, ensure it is at 100% scale without borders for the best results.

PROFILE KIT			
#	Part	QTY	Note
P1	80X40 Length=320mm	1	
P2	40X40 Length=320mm	4	
HARDWARE KIT			
A3	VESA 200 adapter	1	
A4	Pivot plate	2	
A5	Corner bracket 40×40	8	
A6	Corner bracket 40×40 cap	8	
A7	Profile 40×40 end-cap	6	
A8	Bolt M8 X 16 DIN 912	24	
A9	Bolt M6 X 16 DIN 7991	4	
A10	Washer M8 DIN 125-A	24	
A11	Screw Philips M4 X 16 DIN 7985	4	Extra
A12	Screw Philips M4 X 10 DIN 7985	4	Extra
A13	Spacer male/female M4 X 10	4	Extra
A14	Slot-Nut M8	24	
A15	Slot-Nut M6	4	
<i>Disclaimer: for some entries on this list, we supply more than required as spare materials. Don't worry if you have some leftovers, this is intentional.</i>			

Note

Some spare materials may be included in the package. This is intentional and should not cause concern if there are leftovers.

Product Page

Visit the Sim-Lab website for more information about the product: [product page URL]

BEFORE YOU START

Thank you for purchasing this Sim-Lab product! On the following pages, you will find detailed instructions on assembly. This requires only a set of simple tools and some of your time. Please check the bill of materials before starting (page 10) and make sure all the parts are delivered.

Inserting Slot-Nuts

You got excited, finished the build, and put the caps on, but forgot to install one element. Do not worry. It happens to everyone. In this diagram, you can see how to insert a Slot-Nut directly into the slot from the side. You can also use one of your smaller Hex wrenches to help wiggle the Slot-Nut in place.

Breaking tabs

Sometimes tabs from corner brackets need to be broken off in order to fit as instructed. Place a flathead screwdriver behind the tab and tilt upwards. Always make sure to point away from you while doing so. To know when to do this, we will show the following symbol next to the brackets.

Tools needed

Disclaimer: for some entries on this list, we supply more than required as spare materials. Don't worry if you have some leftovers, this is intentional. If you still have some questions regarding the assembly of this product or about the manual itself, please refer to our support department. They can be reached at support@sim-lab.eu Alternatively, we now have a Discord server where there are quite some experienced Sim-Lab customers hanging out. They might just help you along if you ask them nicely 😊 www.sim-lab.eu/discord If you feel like printing this manual, please consider the environment before doing so. For the best results, make sure you print at 100% scale without borders.



Product page on the Sim-Lab website:

Documents / Resources

	SIM LAB Quad Add-On Quad Monitor Stand [pdf] Instruction Manual Quad Add-On Quad Monitor Stand, Quad Monitor Stand, Monitor Stand, Stand
--	---

References

-  [Sim-Lab](#)
-  [Quad monitor stand add-on](#)