



Contents [[hide](#)]

- [1 Sillbird RX-S2 Robot Building Kit with Remote Control](#)
- [2 MODELS](#)
- [3 R/C PARTS INSTRUCTION](#)
- [4 INSTALLATION INSTRUCTION](#)
- [5 PRODUCT OVERVIEW](#)
- [6 USING INSTRUCTION](#)
- [7 Documents / Resources](#)
 - [7.1 References](#)



Sillbird RX-S2 Robot Building Kit with Remote Control



MODELS





www.sillbird.com

R/C PARTS INSTRUCTION

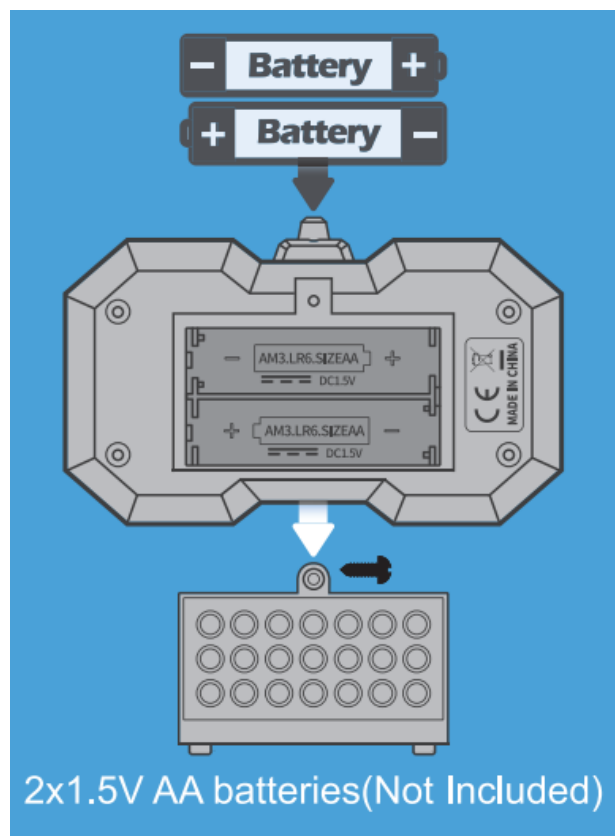

2x1.5V AA batteries(Not Included)

1. Insert batteries (2x1.5 VAA type) into the remote control.
2. Turn on the remote control, the indicator light blinks, the coding starts.

3. Switch the 325 +APP PROGRAMMING CORE BOX power to ON.
 - The indicator light remains lit in blue, the coding is successful, the light of remote control indicator remains lit as well.
 - The indicator light blinks means the coding is failed.
4. Press the lever of remote control test if its function is normal,
5. Charging: Use DC 5V 1 – 2A adapter, with the attached USB cable to charge the master control box.

While charging, the indicator light remains lit in red. The red indicator light gets off when fully charged.
6. Use mobile phone to scan the QR code on the box or instructions, download and install the APP. Follow the instructions to enjoy your manipulation and program- ming.

Further instruction for 2.4G pair coding

1. Each controller can code one Motor Box only. Once coding succeeds, it will not Influence the other Motor Box. It means many items can be played at the same time, and do not influence each other.
2. If the coding over 10 mins fails, or without any operation, after coding succeeds, the Motor box will auto power off.
3. To code the controller with another Motor Box, it needs to turn off the pair of controllers and Motor Box both first and then start coding with another one.

Socket A:Control
forward and backward

Indicator light

Socket B:Control
forward and backward

Reverse switch
of the socket A

Reverse switch
of the socket B

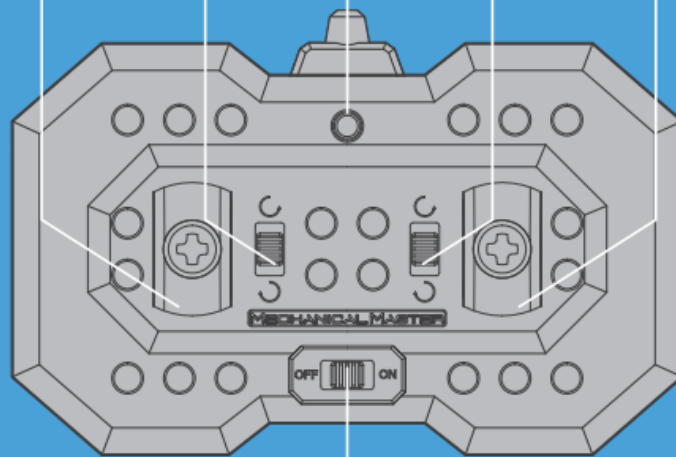

Power switch

134#

2.4G MULTI-FUNCTIONAL
REMOTE CONTROL

Port A: Digital display

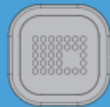
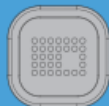

Port B:
Digital
display

Charging
port

Power
switch

Indicator
light

Sound Power
Switch

325#

+APP
PROGRAMMING
CORE BOX

Charger block(Not Included} Power supply:5V 1-2A
(DO NOT suggest power supply higher than this)

INSTALLATION INSTRUCTION

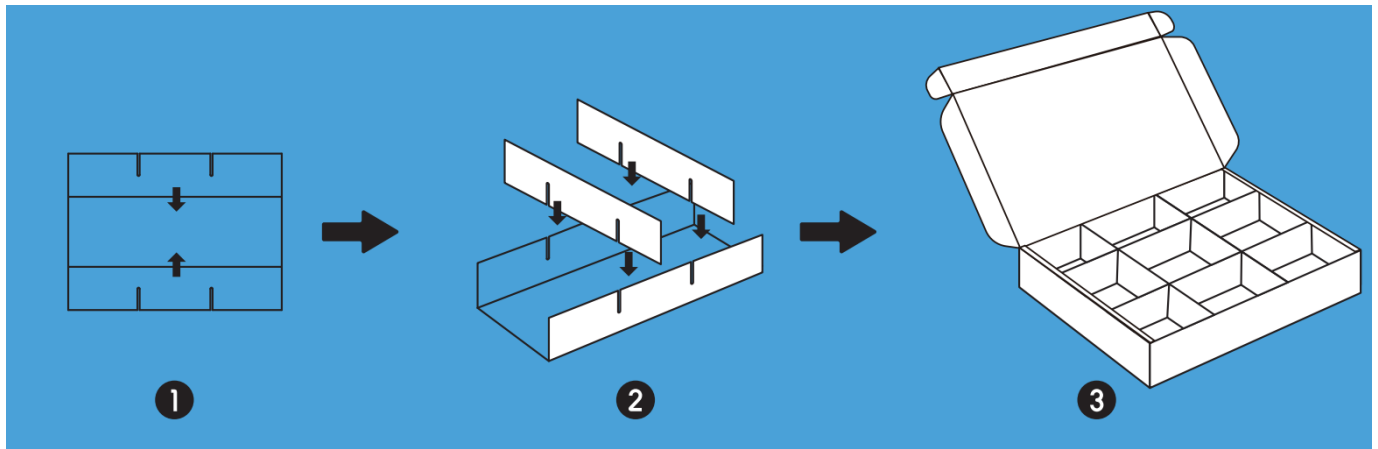

Please note the small differences between the parts.

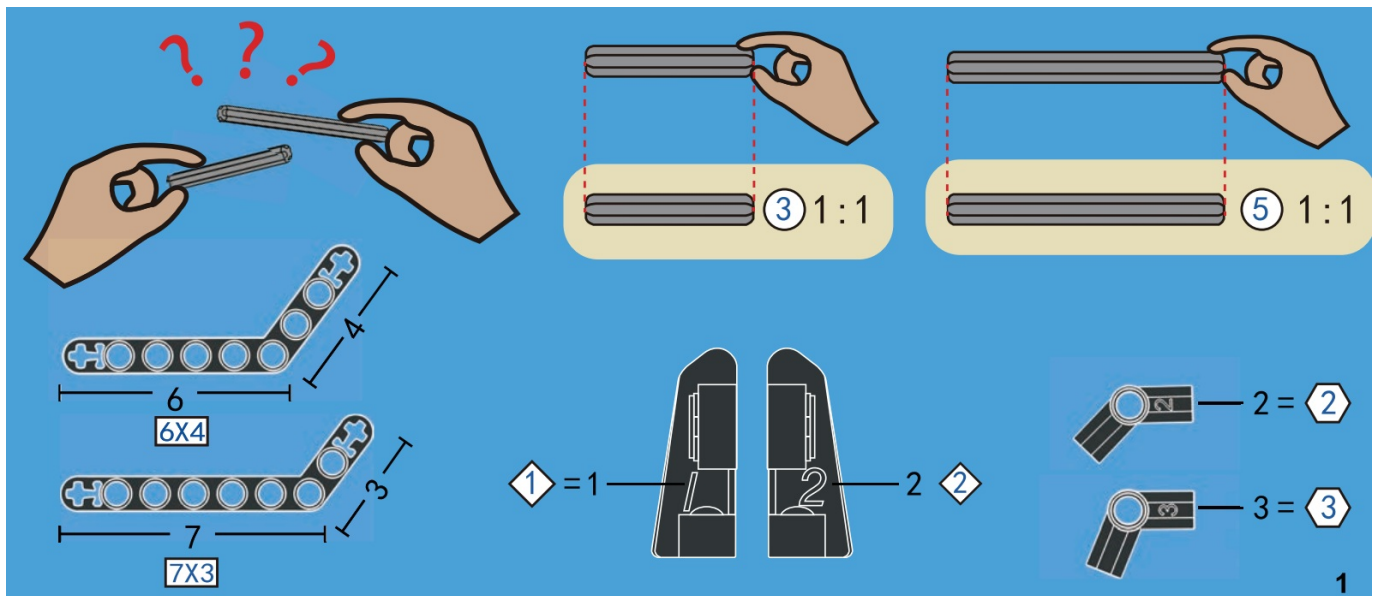

A

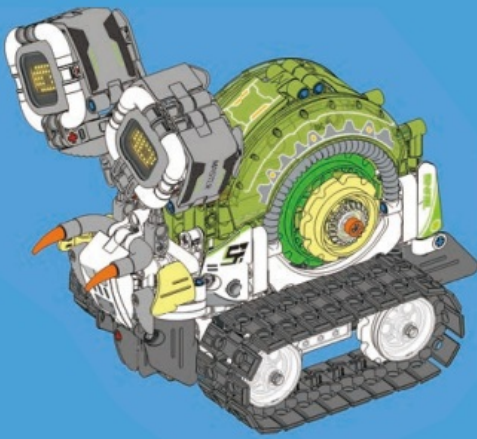

1

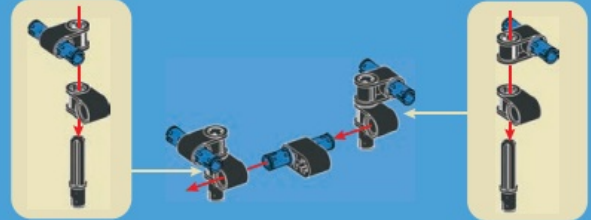

X1

2

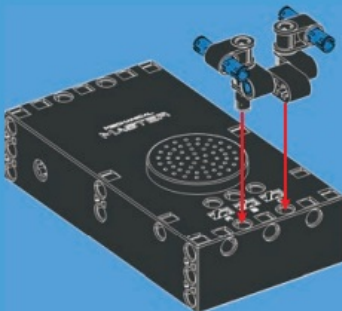

X2

X2

3

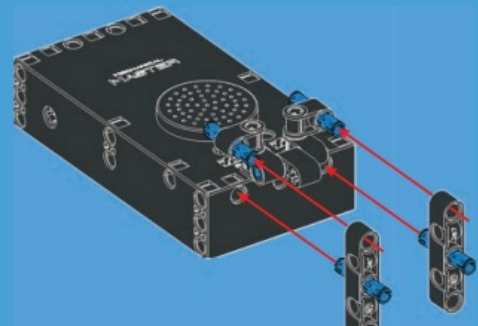



4

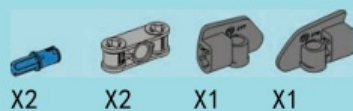

6



7

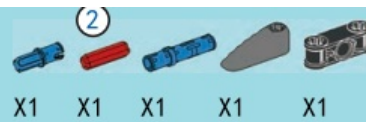
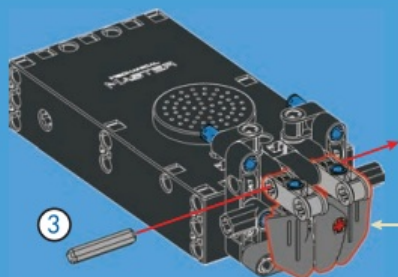

5

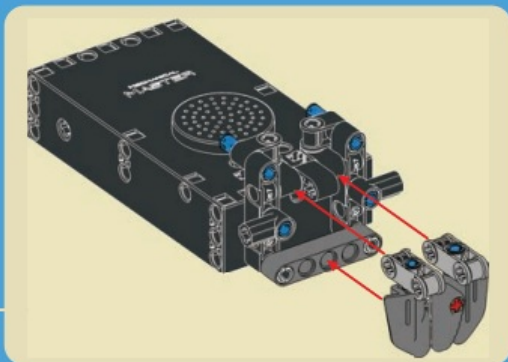
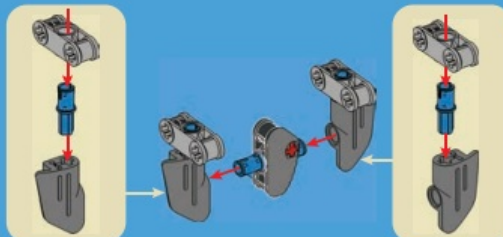
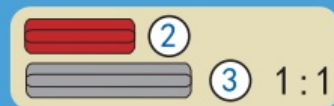
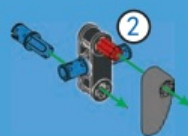

8

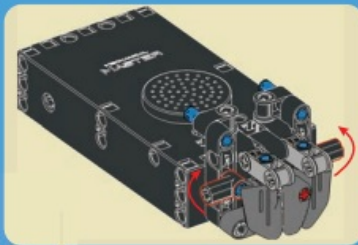
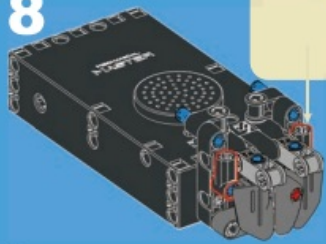

9

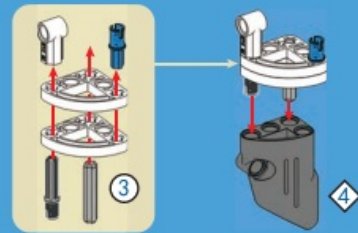

10



11

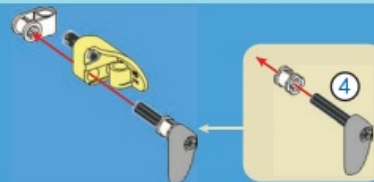
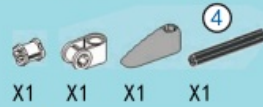

12



4

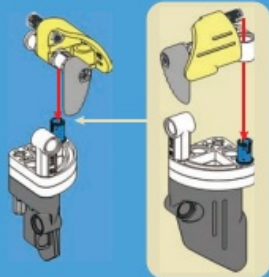

13

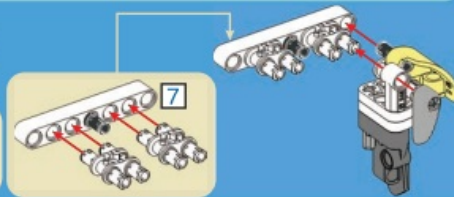
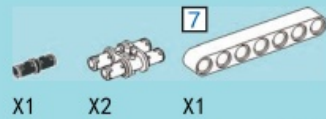



14

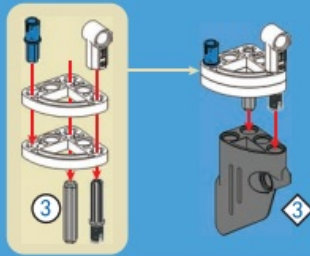

15

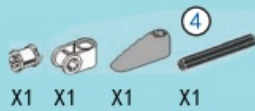
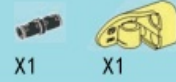

16



17

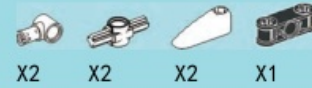

19

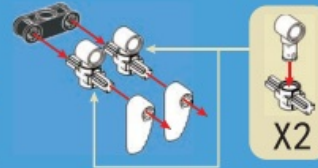

18

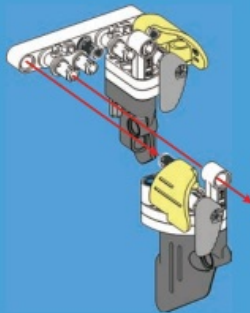

20

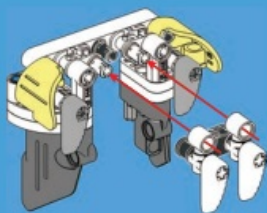

22

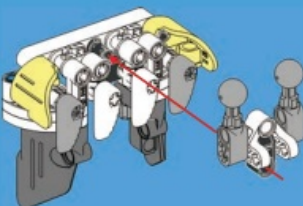

24



21

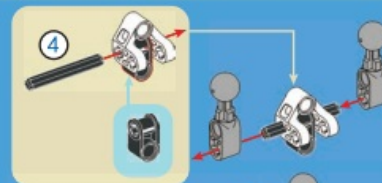
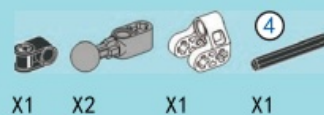

23

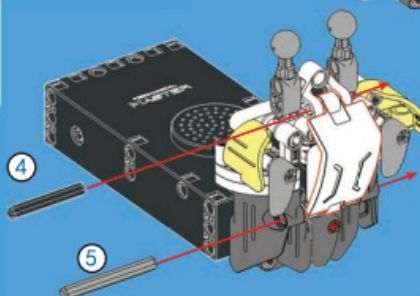
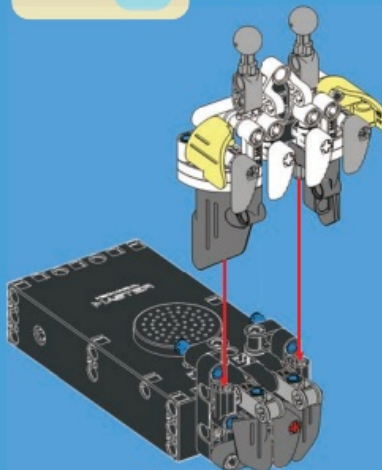



25



26

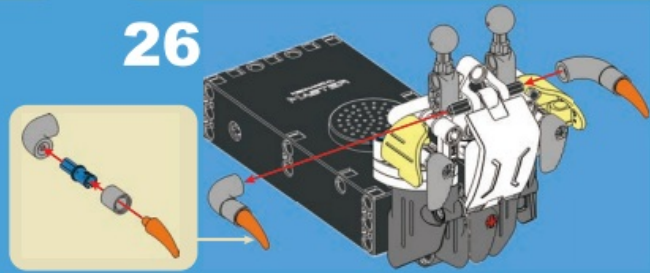

27

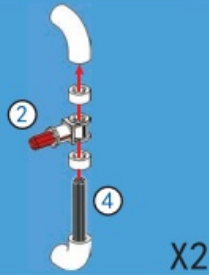

28

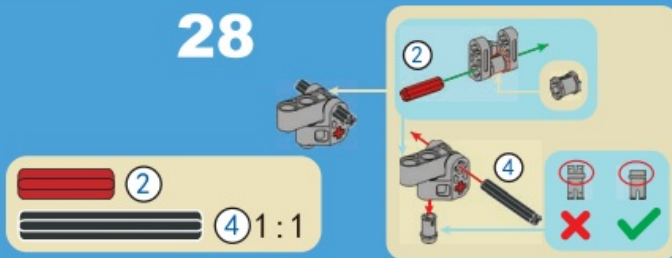

29

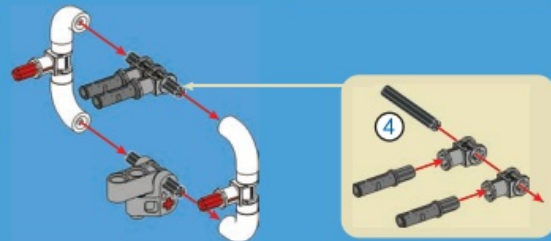



30



31



32



33

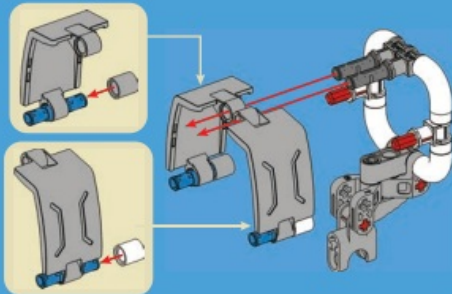

34

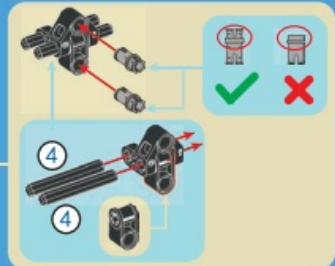



35

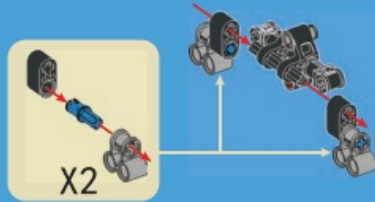

36

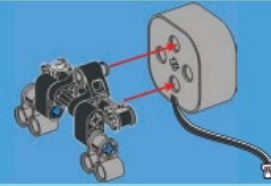

38

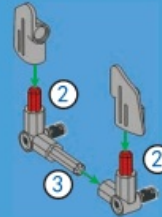

37

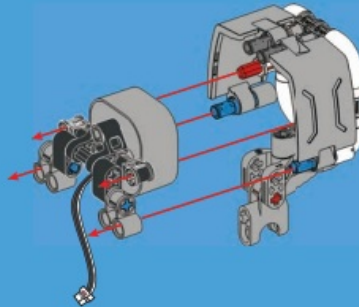

40



39

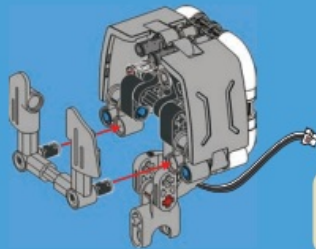

41

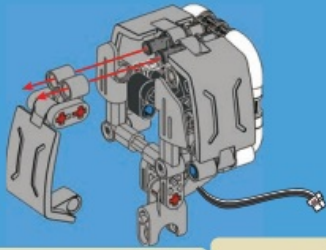

43

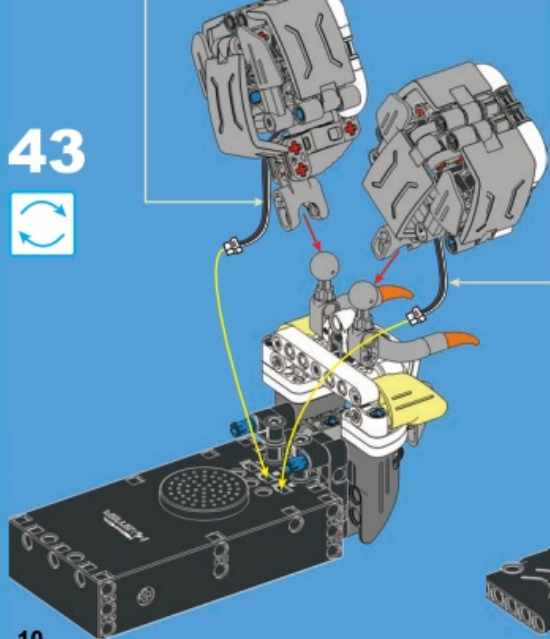

42

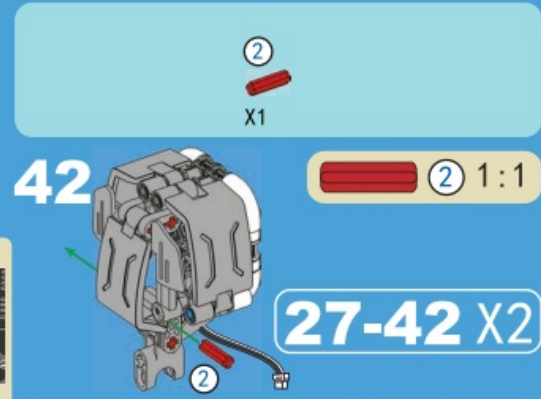

27-42 X2

44

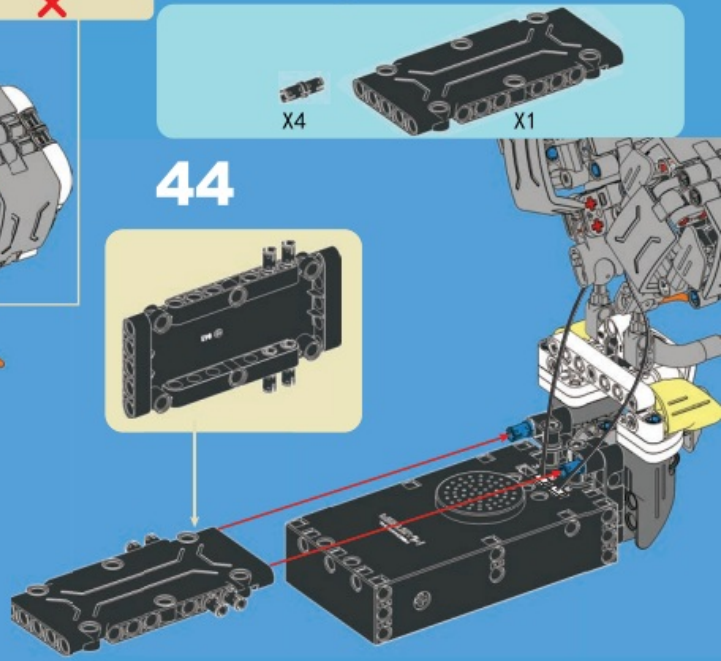

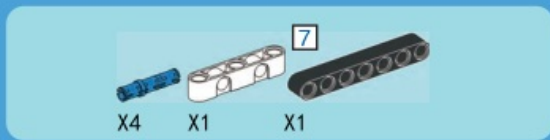

45

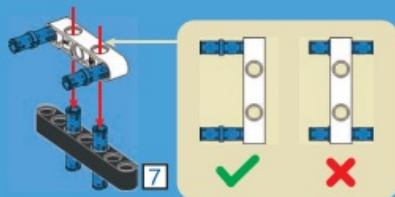

46

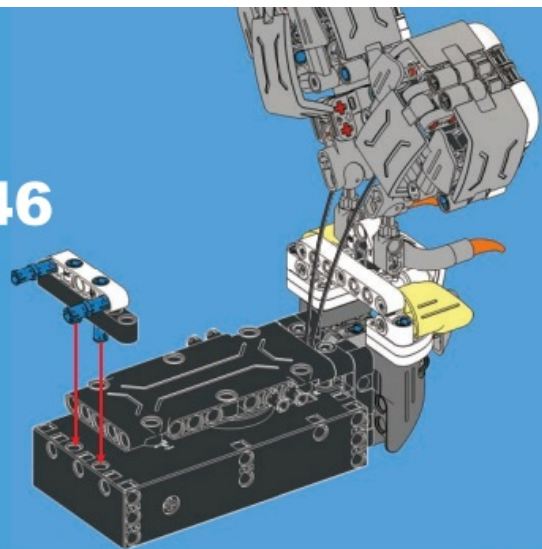

47

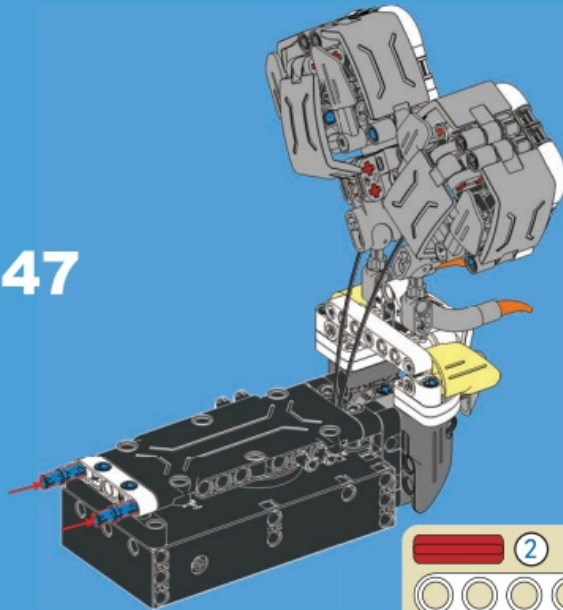

48

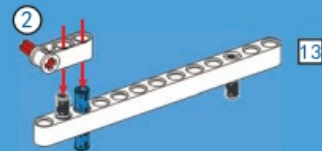

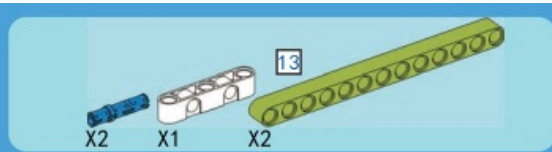

49

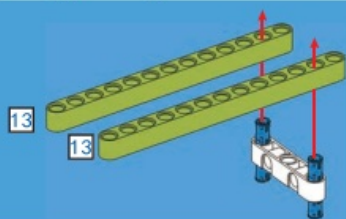

50

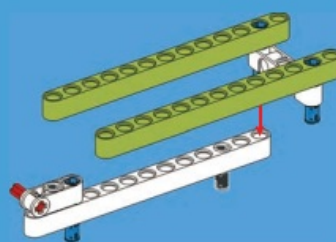

51

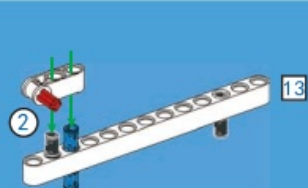

52

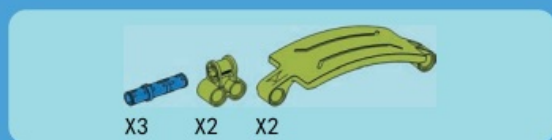
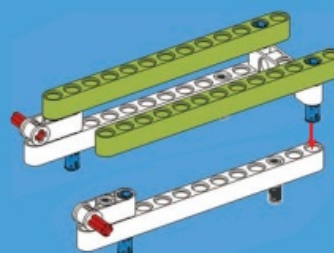

53

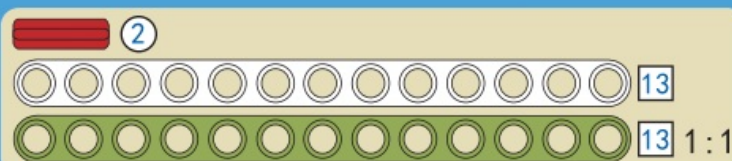
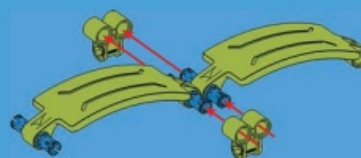

12

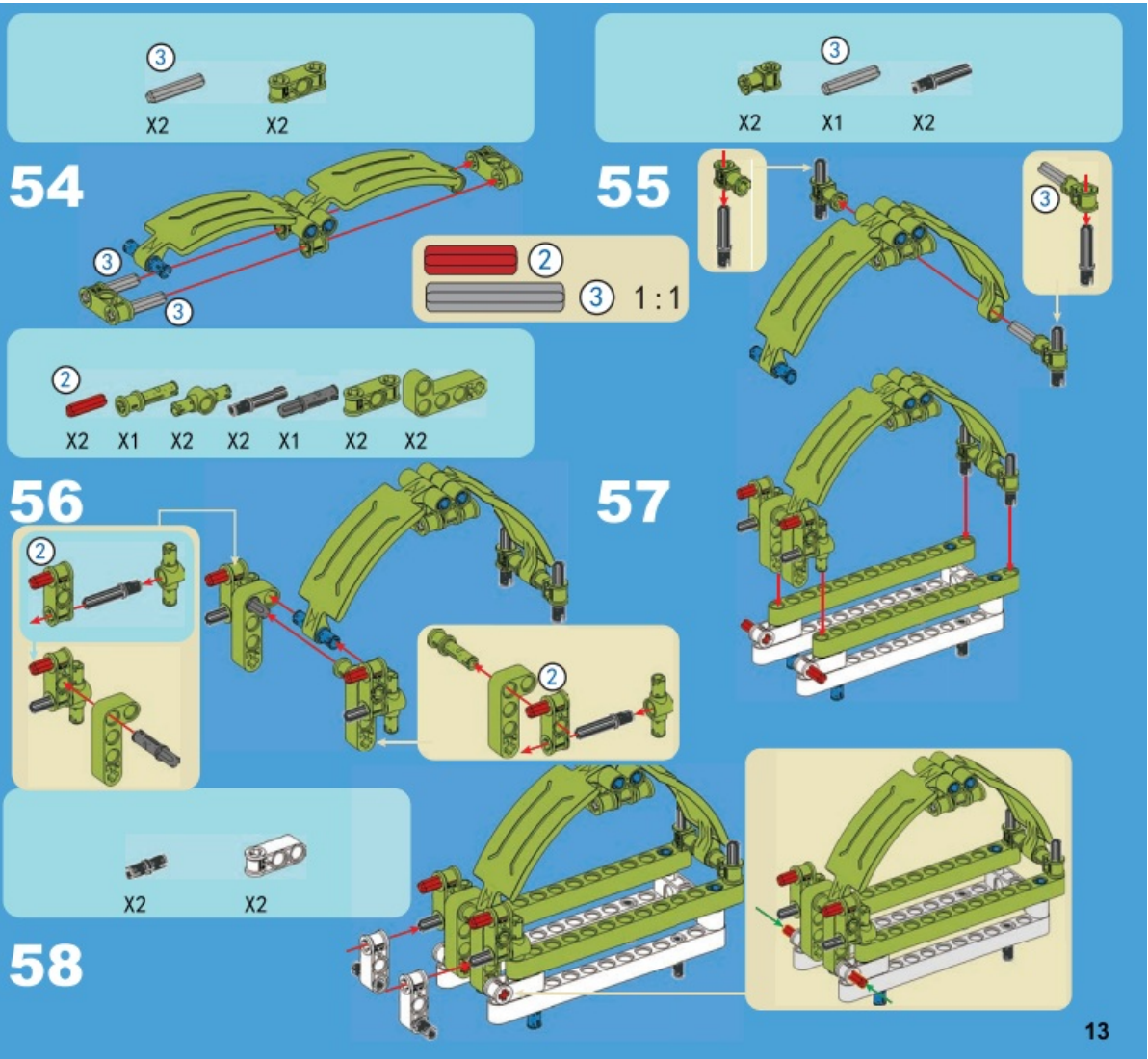

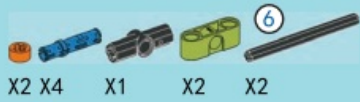

59

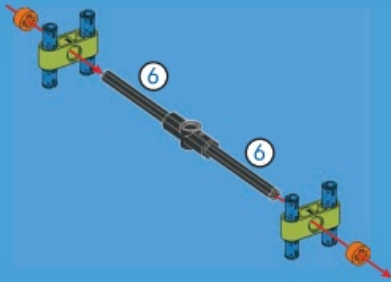

60

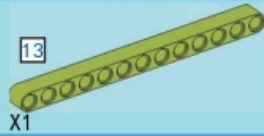
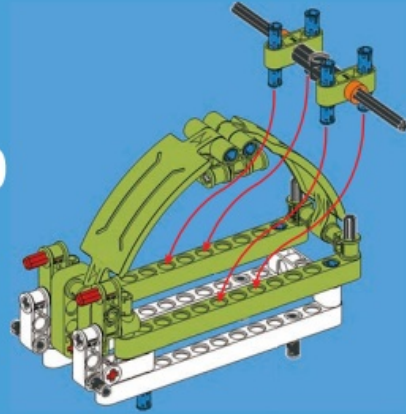

61

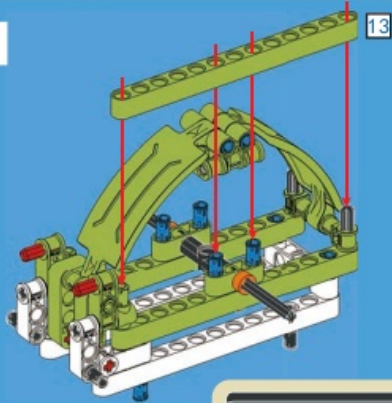

62

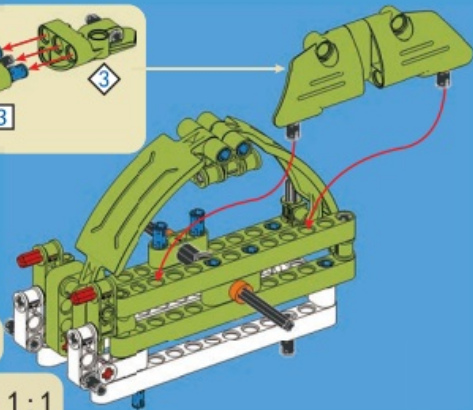
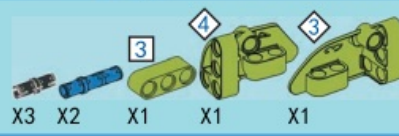
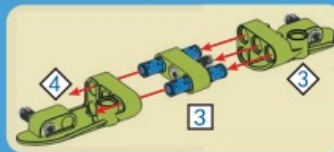

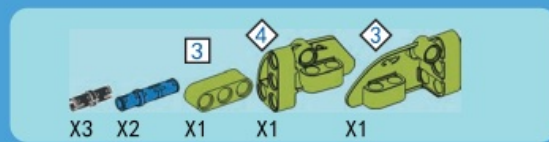

63

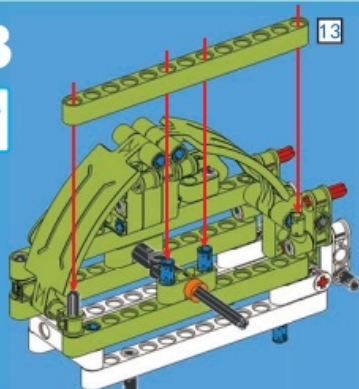

64

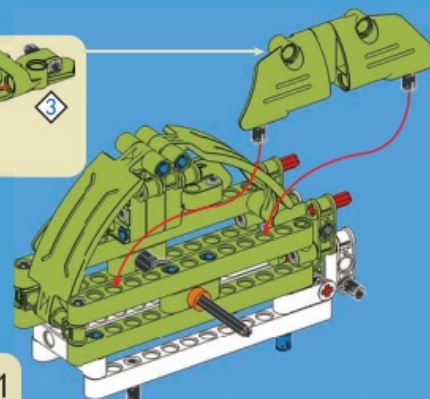
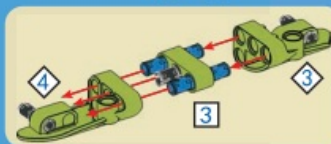

66

65

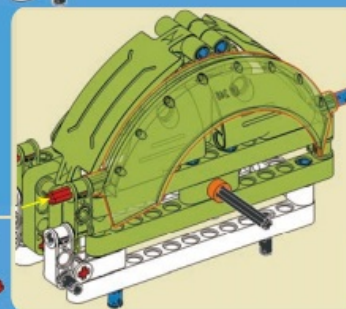
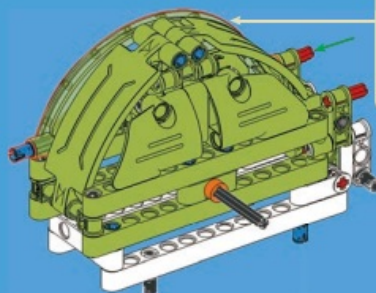



67

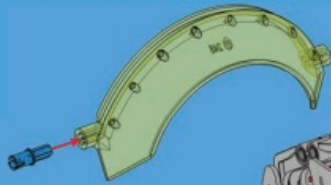

69

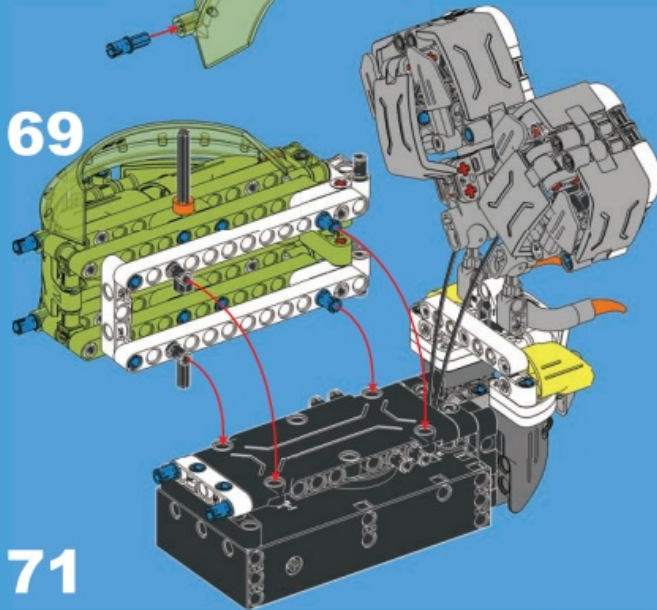

71

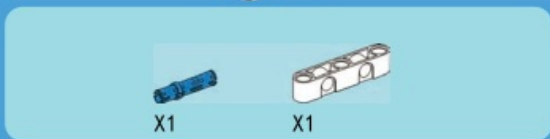

68

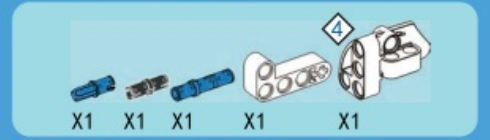

70

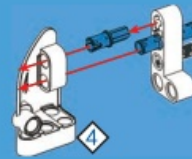

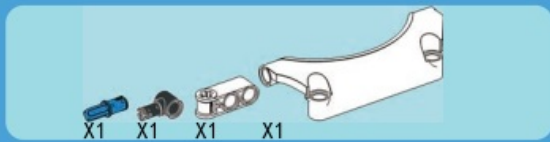

72

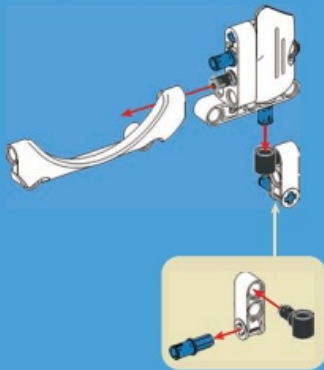

73

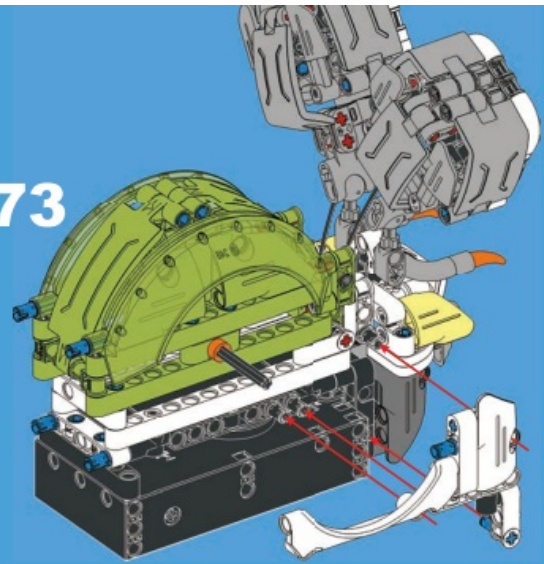

74

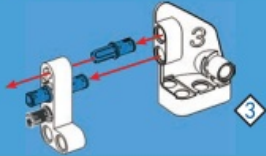

75

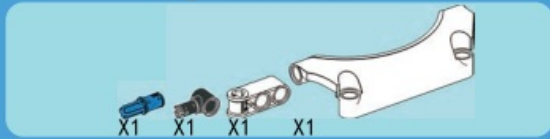
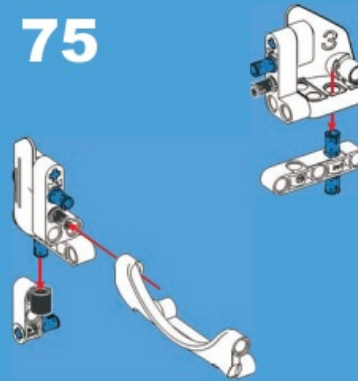

76

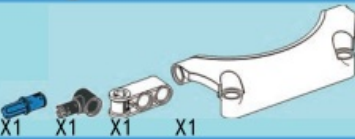

77

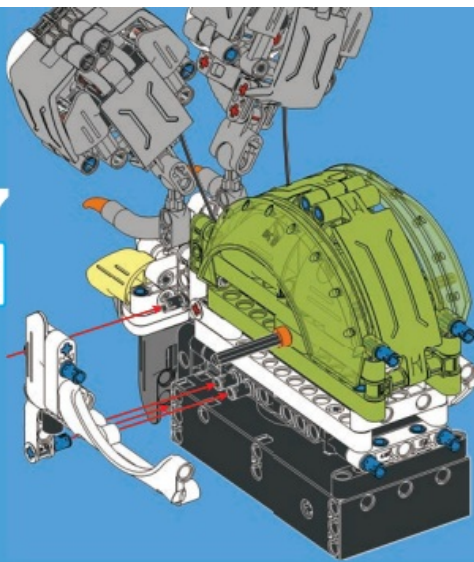

79

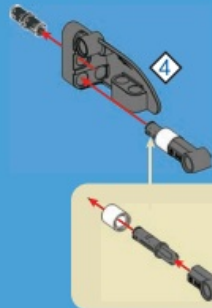

78

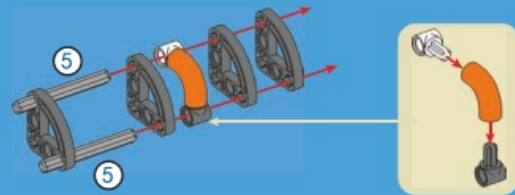

80

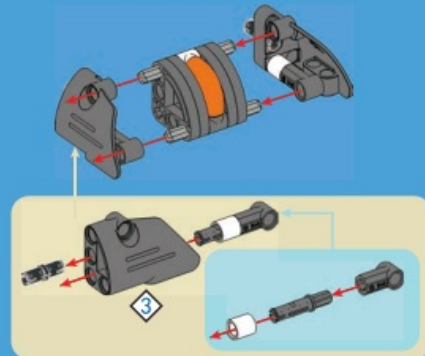

81

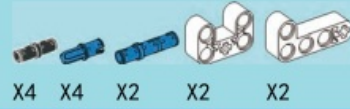
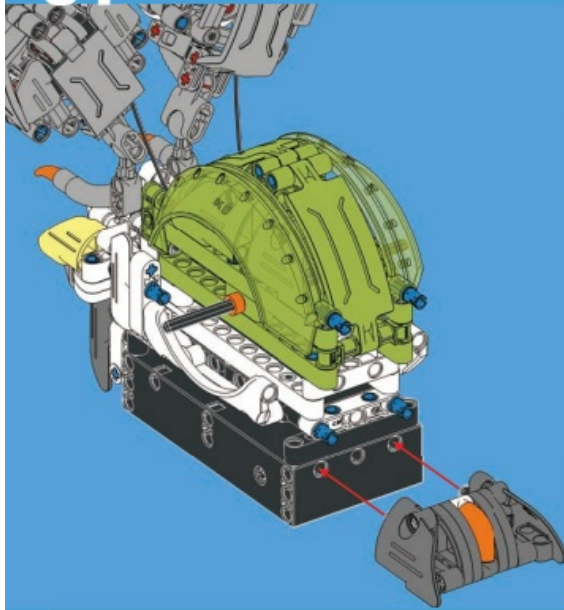

X4 X4 X2 X2 X2

82

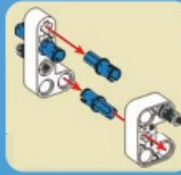
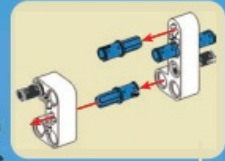
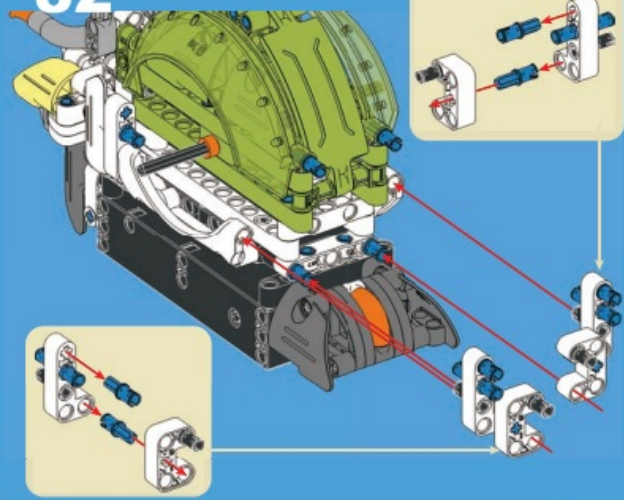

X2 X2 X2 X1

83

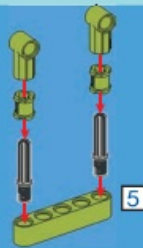

X2 X1

84

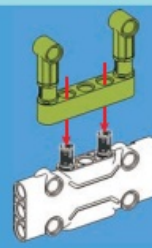

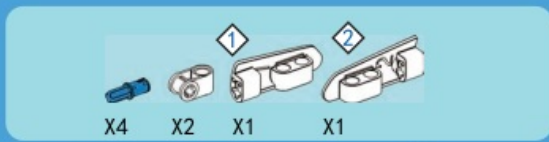

85

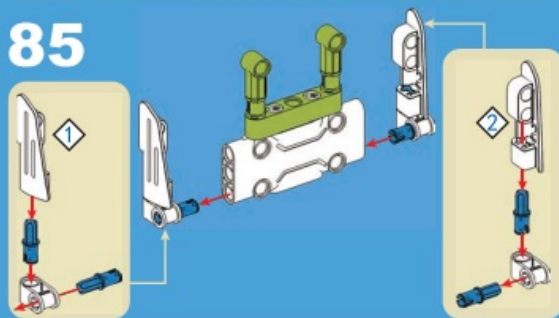

87



86

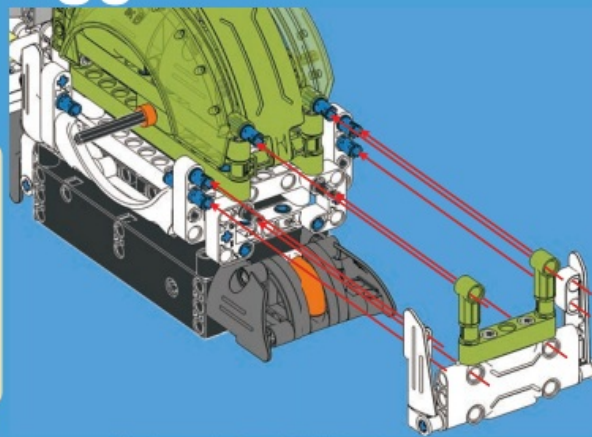

88

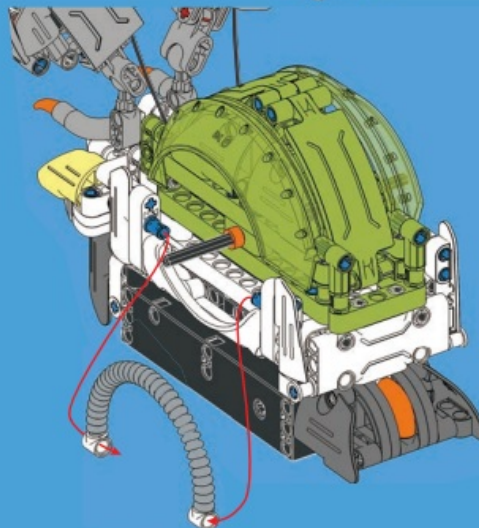

89

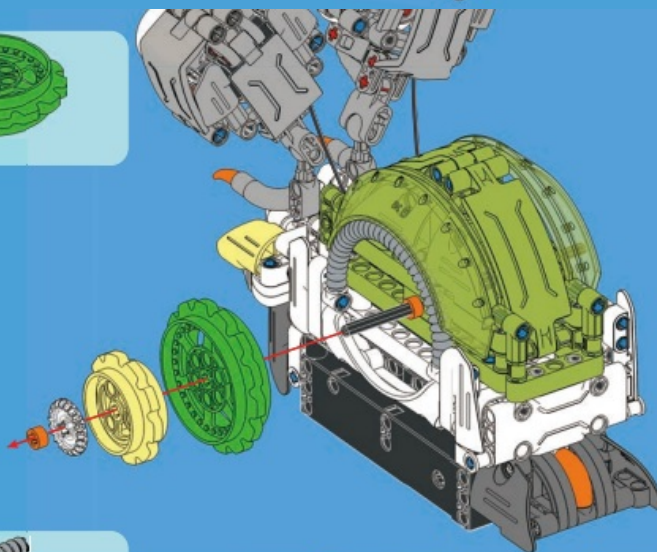

90



91

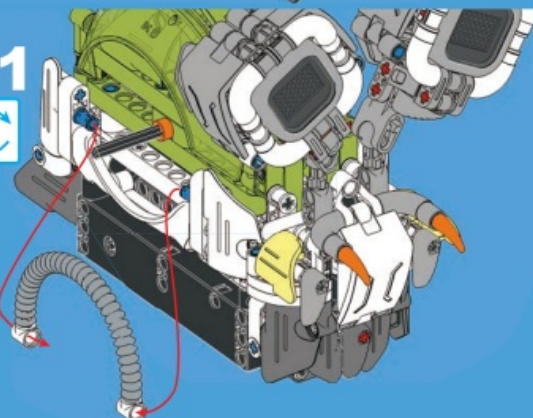

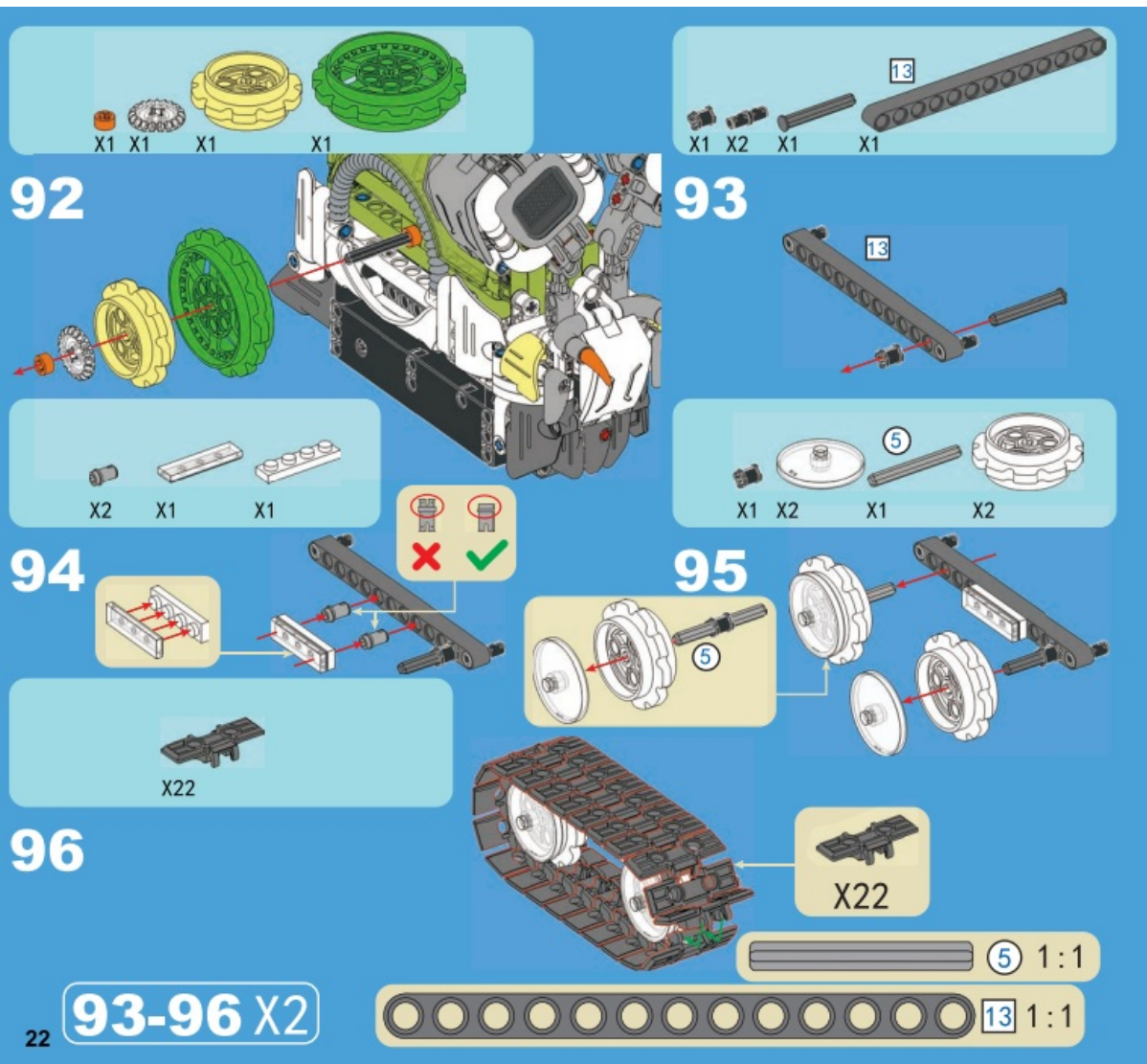

97

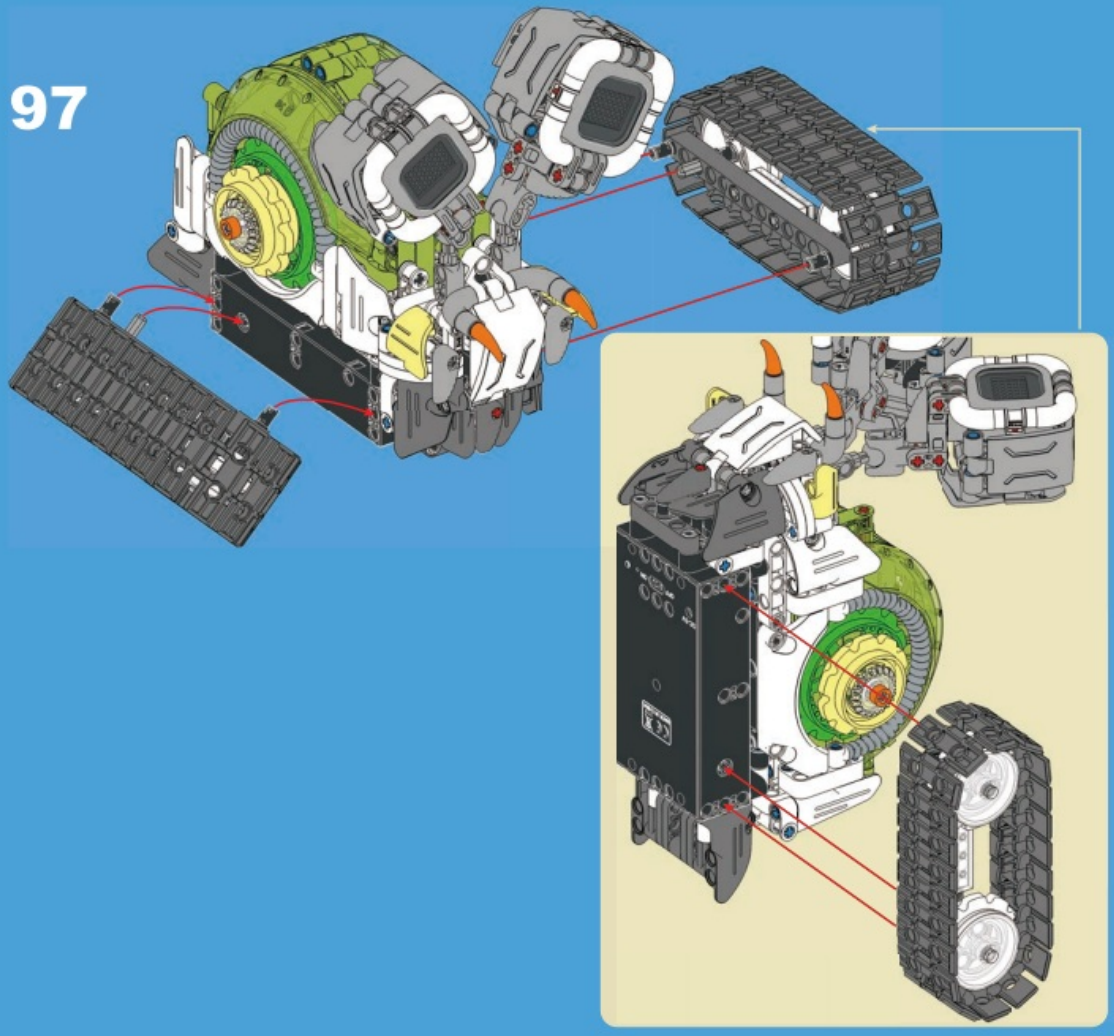

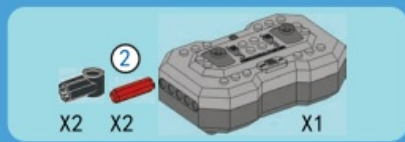

98

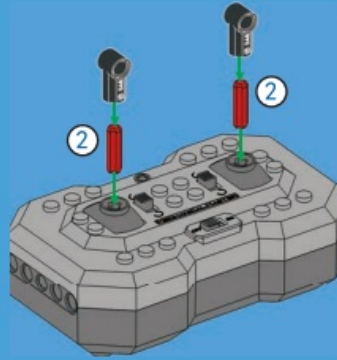

99

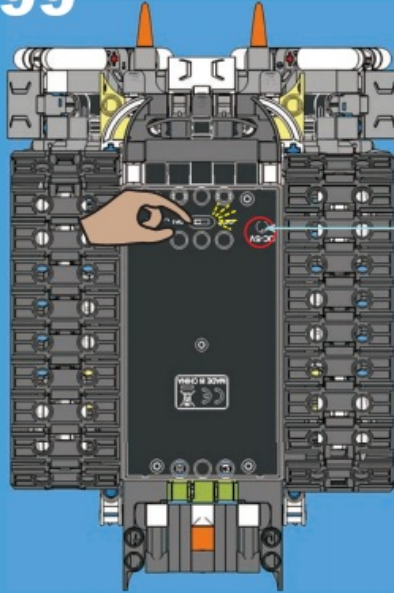

24

2 1:1

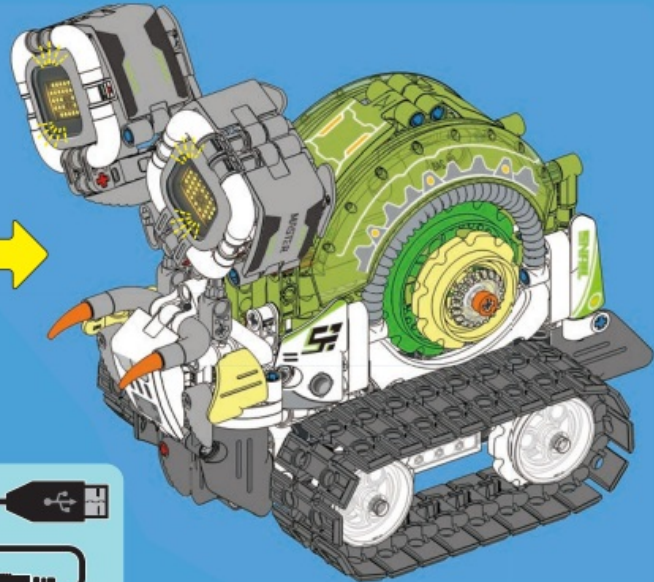
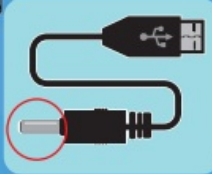

PRODUCT OVERVIEW

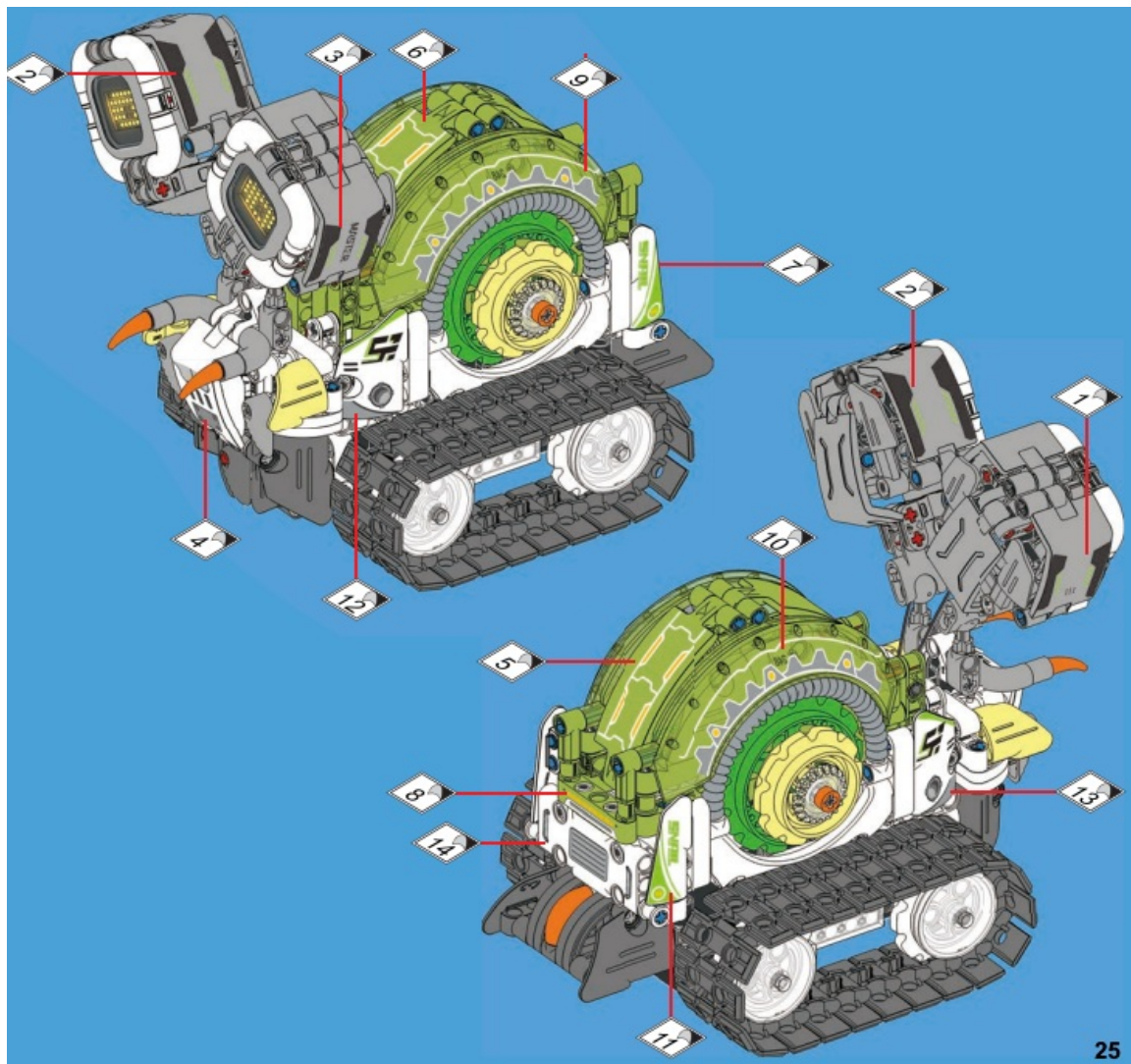

25

USING INSTRUCTION

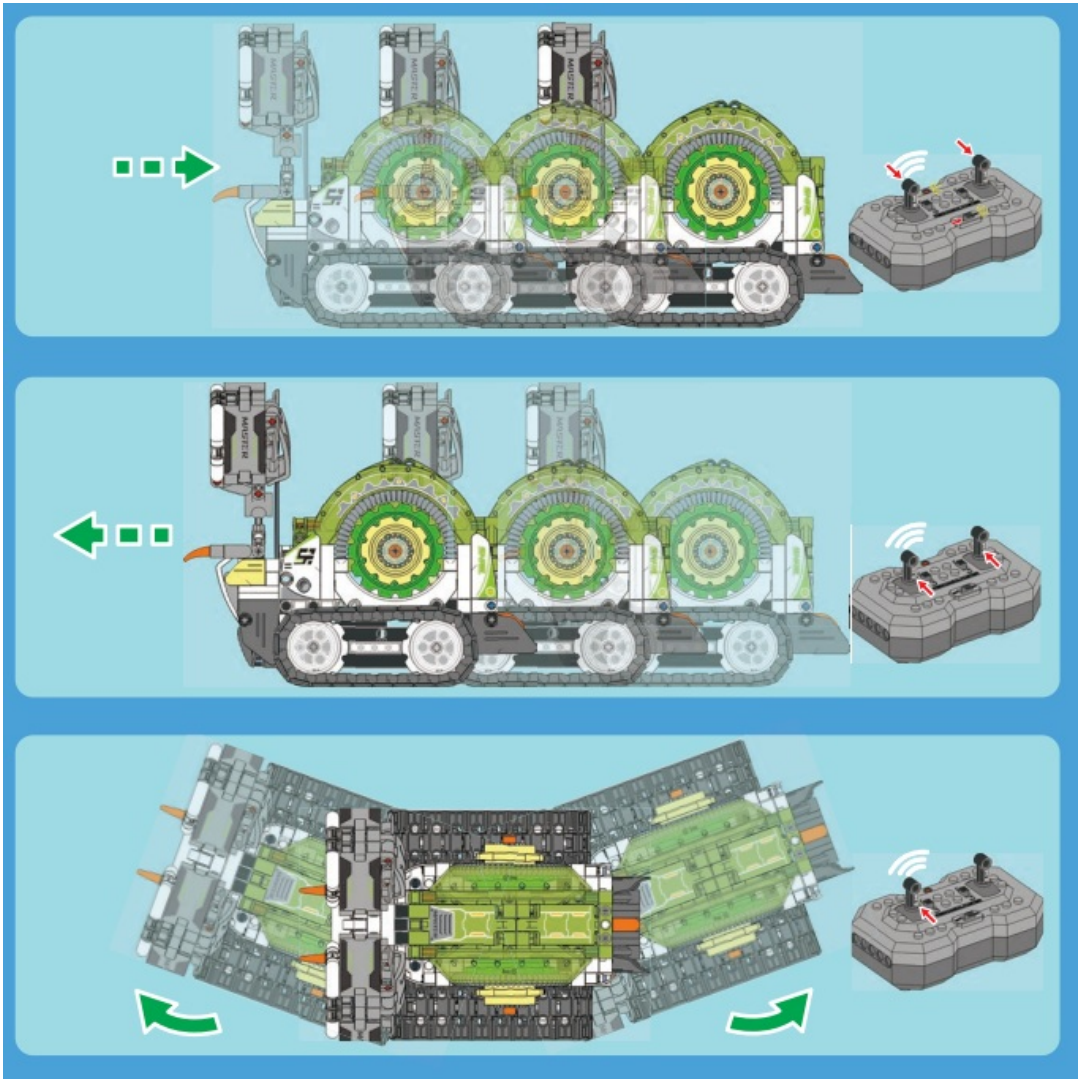

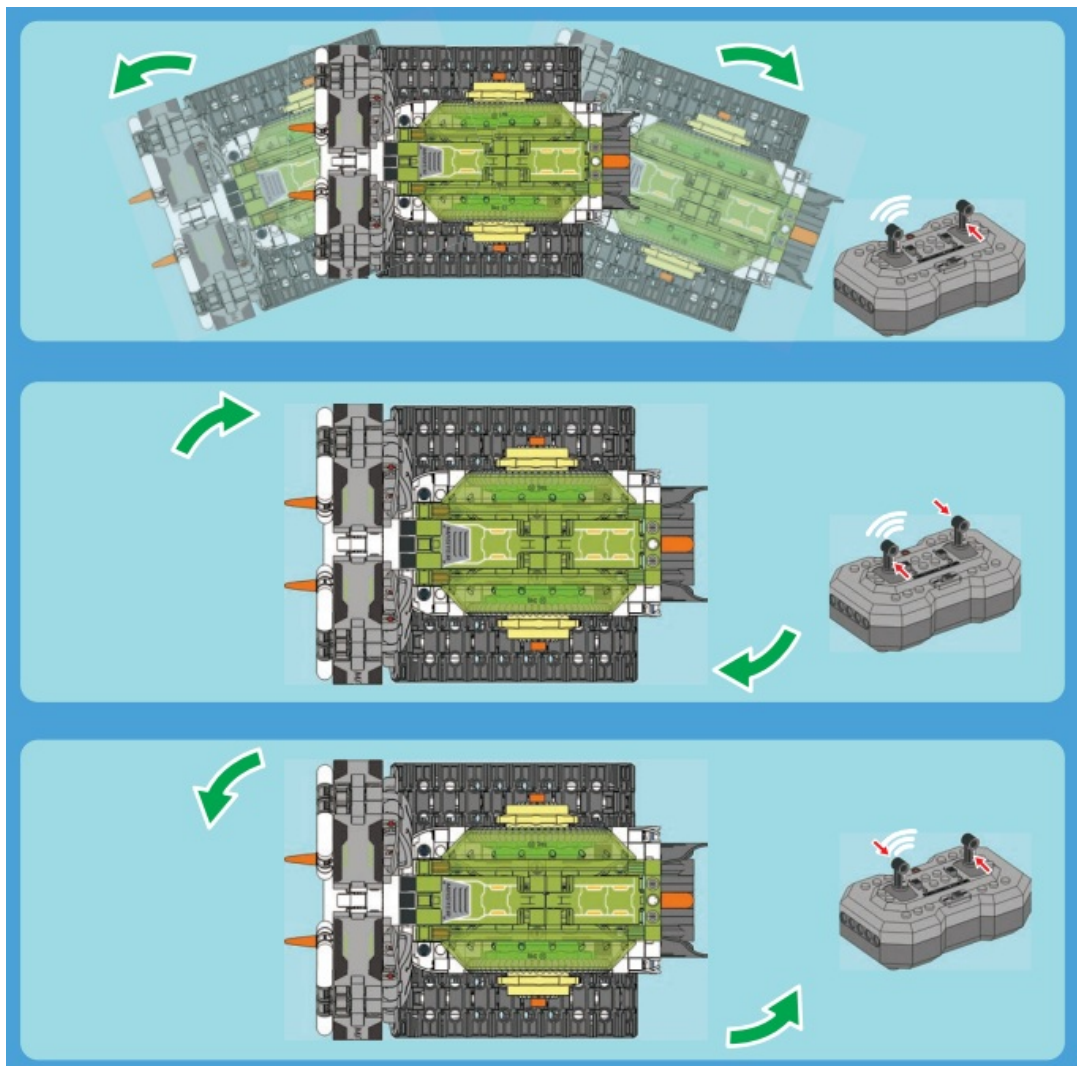

Documents / Resources

	<p>Sillbird RX-S2 Robot Building Kit with Remote Control [pdf] Installation Guide</p> <p>RX-S2 Robot Building Kit with Remote Control, RX-S2, Robot Building Kit with Remote Control, Kit with Remote Control, Remote Control</p>
-------------------------------------------------------------------------------------	---------------------------------------------------------------------------------------------------------------------------------------------------------------------------------------------------------------------------------------------------

References

- [User Manual](#)

■ Sillbird

◆ Kit with Remote Control, Remote Control, Robot Building Kit with Remote Control, RX-S2, RX-S2 Robot Building Kit with Remote Control, Sillbird

Leave a comment

Your email address will not be published. Required fields are marked *

Comment *

Name

Email

Website

☐ Save my name, email, and website in this browser for the next time I comment.

Post Comment

Search:

Search

[Manuals+](#) | [Upload](#) | [Deep Search](#) | [Privacy Policy](#) | [@manuals.plus](#) | [YouTube](#)

This website is an independent publication and is neither affiliated with nor endorsed by any of the trademark owners. The "Bluetooth®" word mark and logos are registered trademarks owned by Bluetooth SIG, Inc. The "Wi-Fi®" word mark and logos are registered trademarks owned by the Wi-Fi Alliance. Any use of these marks on this website does not imply any affiliation with or endorsement.