



SIIG 04-1366B 2×1-4×1 DP 4K KVM USB 3.0 Switch with RC User Manual

[Home](#) » [SIIG](#) » SIIG 04-1366B 2×1-4×1 DP 4K KVM USB 3.0 Switch with RC User Manual 

Contents

- [1 SIIG 04-1366B 2×1-4×1 DP 4K KVM USB 3.0 Switch with Rc](#)
- [2 Features](#)
- [3 Package Contents](#)
- [4 Layout](#)
 - [4.1 Front Panel](#)
 - [4.2 Rear Panel](#)
- [5 Remote Control](#)
- [6 Hotkey Command](#)
- [7 Application](#)
- [8 Documents / Resources](#)
- [9 Related Posts](#)



SIIG 04-1366B 2×1-4×1 DP 4K KVM USB 3.0 Switch with Rc



Features

- Support DisplayPort 1.4 & 1.2
- Support DisplayPort or HDMI video output
- Support HDR
- Display EDID bypass
- Support two USB 2.0 ports for wired mous & keyboard use only
- Support two USB 3.0 SGBps ports, SV/900mA Support 3.5mm jack for Microphone and Speaker extend
- Switch control by front panel, IR remote or hotkeys
- Support auto-switch mode
- Support Windows and Mac systems
- Plug-n-play, no driver installation

Package Contents

- DP 4K KVM USB 3.0 Switch with RC
- Power Adapter SV/3A
- USB 3.0 Type-A to B cable x 2 (CE-KV0C11-S1) USB 3.0 Type-A to B cable x 4 (CE-KV0D11-S1) IR extender cable
- IR remote control
- User manual

Layout

Front Panel

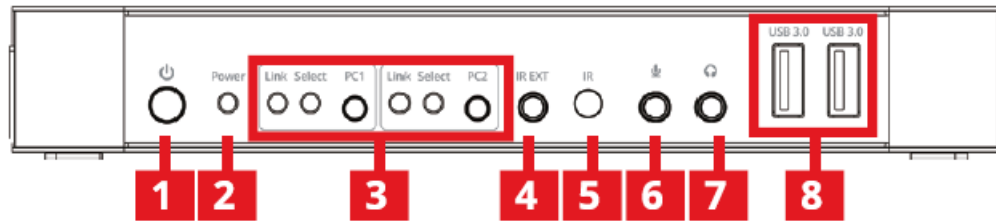

2×1 & 4×1 port define are the same design, the manual use 2×1 layout as example.

1. Power Button: Turn on/off the unit
2. Power Indicator:
3. Input Selection Button:
 “Select” lights up to indicate input selection
 “Link” lights up when the USB-B port is connected.
4. IR EXT: Connect to IR Extender cable
5. IR: For IR signal reception from the remote control
6. Microphone port at console
7. Speaker/Earphone port at console
8. USB 3.0 hub ports at console for peripherals 5Gbps, 5V/900mA

Rear Panel

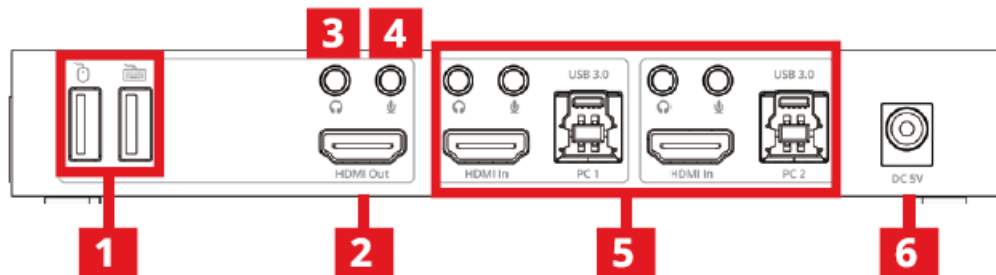

1. USB keyboard & mouse ports at console (for wired keyboard & mouse use only)
2. Video output: Support HDMI or DisplayPort (two ports can't output together)
 HDMI 2.0 & DP 1.2 Resolution up to 4K@60Hz DP 1.4 Resolution up to 8K@30Hz
3. Microphone port at console
4. Speaker/Earphone port at console
5. PC-x input ports:
 Microphone port for PC-x
 Speaker/Earphone port for PC-x
 USB-8 port for PC-x
 DisplayPort input for PC-x
6. Power Jack: DC 5V/3A

Remote Control

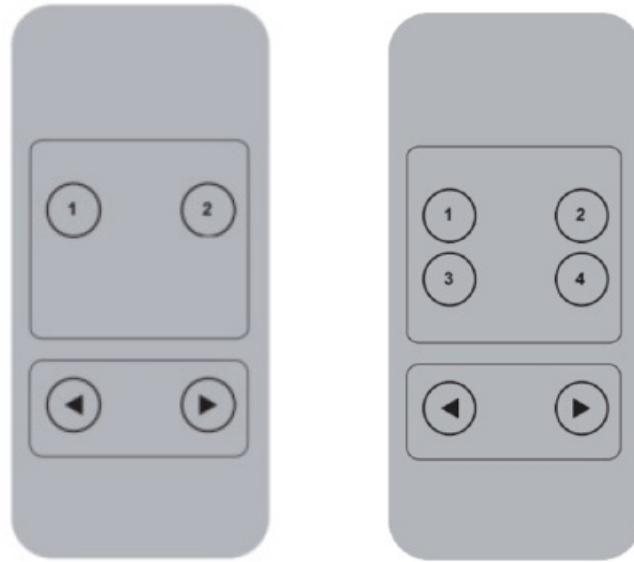

P/N: CE-KV0E11-S1 P/N: CE-KV0F11-S1

P/N: CE-KV0E11-S1 P/N: CE-KV0F11-S1

- 1.2.3.4: Switch to PC 1 or 2 or 3 or 4
- ◀ : Switch to previous PC
- ▶ : Switch to next PC

Notice:

1. Mouse traversal function: place the mouse on the far right side of the display and continue to slide to the right for 2 seconds, the unit will automatically switch to the next port. Switching order is: PC1 → PC2 → PC3 → PC4 → PC1
2. Hotkey function (It doesn't work on functional keyboard and only the 2 USB-A ports on the back panel can get access to this function.)

Hotkey Command

Hotkey Command	Description
[Scroll Lock] + [Scroll Lock] [→ or ↓]	Switch to the next port
[Scroll Lock] + [Scroll Lock] [← or ↑]	Switch to the previous port
[Scroll Lock] + [Scroll Lock] [N] (N=1 or 2)	Switch to PC N
[Scroll Lock] + [Scroll Lock] [S]	Automatic switching function(Default: 15 sec) Press any key of the key- board will stop.
[Scroll Lock] + [Scroll Lock] [I] + [Number] [Enter]	Set the automatic switching interval (10~999 seconds)
[Scroll Lock] + [Scroll Lock] [B] + [1/0]	Buzzer on/off (Default: on)
[Scroll Lock] + [Scroll Lock] [F] + [L] + [A] + [S] + [H] [Enter]	All resume hotkey default mode

Application

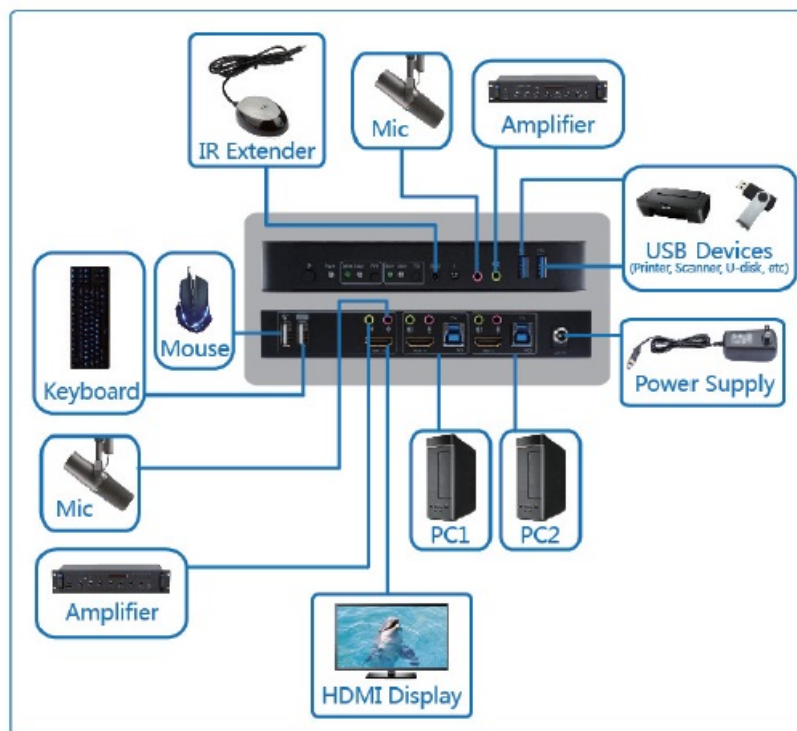

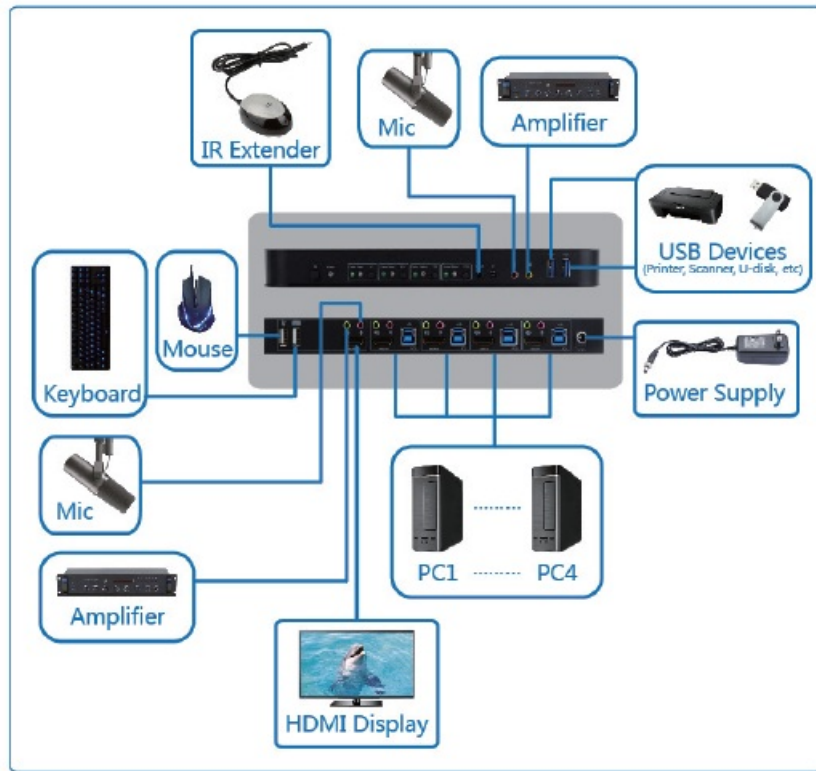

Dear Valued Customer
 WE REALLY APPRECIATE
 YOUR PURCHASE
 -thank you-
 Support

For more info or tech support
<http://www.siig.com/support>

Aug, 2022 Copyright© 2022 by SIIG, Inc. All rights reserved.

Documents / Resources

 <p>SIIG 2x1 / 4x1 DP 4K KVM USB 3.0 Switch with RC User Manual</p> <p>04-1366B PIN: CE-R00011-01 PIN: CE-R00011-01</p>	<p>SIIG 04-1366B 2x1-4x1 DP 4K KVM USB 3.0 Switch with RC [pdf] User Manual</p> <p>04-1366B 2x1-4x1 DP 4K KVM USB 3.0 Switch with RC, 04-1366B, 2x1-4x1 DP 4K KVM USB 3.0 Switch with RC, 2x1-4x1 DP 4K KVM USB 3.0 Switch, DP 4K KVM USB 3.0 Switch, 4K KVM USB 3.0 Switch, USB 3.0 Switch, 3.0 Switch, Switch</p>
--	--