



SIGURO T11SS Toaster Instruction Manual

[Home](#) » [SIGURO](#) » SIGURO T11SS Toaster Instruction Manual 

Contents

- [1 SIGURO T11SS Toaster](#)
- [2 SAFETY INFORMATION](#)
- [3 SPECIFICATIONS](#)
- [4 PARTS](#)
- [5 Before first use](#)
- [6 TIPS FOR TOASTING BREAD](#)
- [7 CLEANING AND MAINTENANCE](#)
- [8 Documents / Resources](#)
- [9 Related Posts](#)

SIGURO

SIGURO T11SS Toaster



Thank you for purchasing a SIGURO appliance. We are grateful for your trust and are pleased to introduce the device to you on the following pages and introduce you to all its functions and uses.

We believe in a fair and responsible company, and therefore we only work with suppliers who meet our strict criteria of protecting the interests of their employees, preventing their abuse and providing fair working conditions. If you need help with extensive maintenance or repair of the product, which requires intervention in its internal parts, our authorized service is available at the email address siguro@alza.cz or operators at the seller's info line. For your convenience in solving any problems with the product, we have unified these contact points and the above contacts can be used in the event of any complaints or post-warranty service.

SAFETY INFORMATION

Please read this manual carefully before use and keep it for future reference. The manufacturer declines any liability for damage caused by improper use or failure to follow the instructions in this manual. Improper use or non-compliance with the instructions will void the warranty.

1. This appliance may be used by children 8 years of age and older and persons with reduced physical, sensory or mental capabilities, or lack of experience and knowledge, provided they have been given supervision or instruction concerning use of the appliance in a safe manner and understand the potential hazards. Children must not play with the device. Cleaning and user maintenance shall not be done by children unless they are 8 years old and under supervision. Children under the age of 8 must be kept out of the reach of the appliance and its power supply.
2. Make sure that the voltage in your outlet corresponds to the voltage indicated on the type plate of the appliance and that the outlet is properly grounded.
3. Do not use the toaster if the power cord is damaged. Have all repairs, including the replacement of the power cord, carried out by a specialist service! Do not remove the protective covers of the device, there is a risk of electric shock!
4. Protect the device from direct contact with water and other liquids to prevent electric shock.
5. The toaster should not be left unattended during operation. Do not touch metal parts or hot surfaces during operation. Only touch the On switch, buttons and control knob to avoid burns.
6. We recommend that you do not leave the toaster with the plugged-in power cord in the outlet unattended.

Unplug the power cord from the AC outlet before maintenance. Do not pull the plug out of the outlet by the cord. Disconnect the cable from the outlet by grasping the plug.

7. Do not use the toaster outdoors or in a humid environment. Do not touch the power cord or toaster with wet hands. There is a risk of electric shock.
8. Take extra care when using the toaster near children.
9. The power cable must not touch hot parts or run over sharp edges.
10. The baked goods can ignite inside the toaster, so do not use the appliance near or under flammable objects (e.g. near curtains). The temperature of the surfaces near the unit may be higher than usual during its operation. Place the toaster out of the reach of other objects so as to ensure free air circulation required for its proper operation. Do not cover the toaster's slot.
11. Do not insert too large slices of bread or slices irregularly cut into the appliance; they could become blocked in the toaster mechanism. If the pastry gets stuck in the toaster, do not use metal kitchen tools to remove it; they could cause a short circuit (spoon, knife ...).
12. Be careful not to scratch or otherwise damage the metal covers of the device with hard objects, or to strike a sharp edge with the device.
13. Do not place the toaster on a hot surface or use it near a heat source (e.g. a stove burner).
14. Do not place slices of bread or baguette directly on the toaster cover or slot, as this could damage the toaster! Do not toast bread or pastries with icing that could flow into the toaster and do not toast small pieces of bread or crumbs that could get stuck in the toaster or catch fire.
15. The toaster cannot be used if it is tilted or turned down on the side.
16. Do not insert your fingers or any metal objects into the toaster slot.
17. Do not immerse the appliance in water or wash it with running water.
18. Do not plug the appliance into outlets with remote switching or timer control.

Surfaces marked in this way can become hot during use!
THE SURFACE REMAINS HOT AFTER USE. DO NOT TOUCH

SPECIFICATIONS

Dimensions	41.2 × 12.7 × 18.2 cm
Weight	1.4 kg
Power	220–240 V / 50–60 Hz
Power consumption	1000 W
Number of toast slots	1
Slot length	246 mm
Slot width	29 mm
Number of toasting levels	7
Toaster functions	toasting, thawing, reheating

PARTS

1. Defrosting button

2. Warming button
3. Rotary toasting level knob
4. End toasting button
5. Power switch
6. Toast insertion slot
7. Baking attachment lever

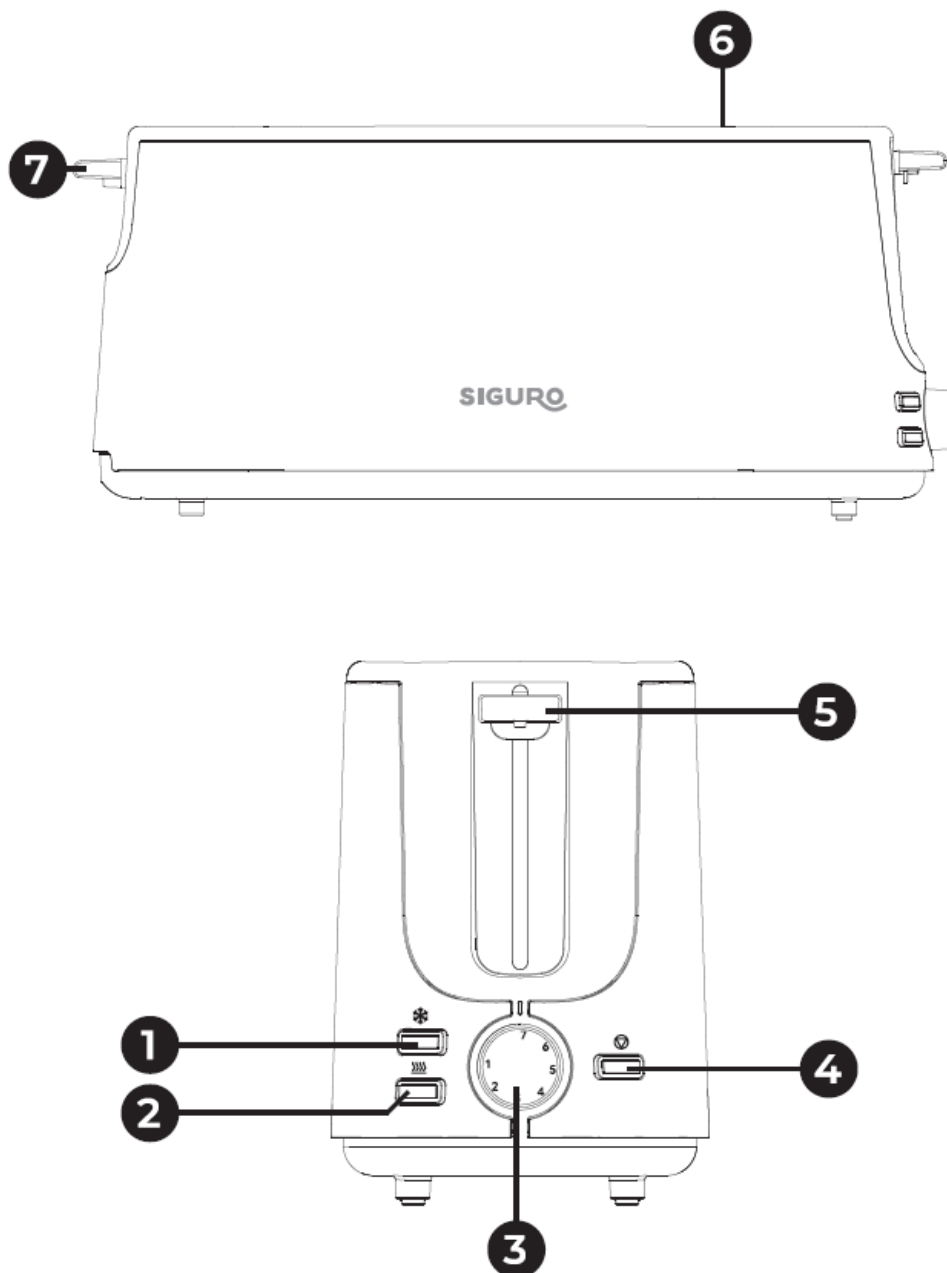

Before first use

The first use of the appliance may be accompanied by a slight odour or smoke. Therefore, we recommend that you let the toaster work at least 4-5 times before using it for the first time without putting bread in it (ventilate the room well during this time).

Toasting bread slices

- After plugging in the appliance select the required degree of browning by turning the knob 3. You can select 7 levels of toasting: 1 = light toasting up to 7 = dark toasting We recommend setting level 3 the first time you use it.

- Insert a slice of bread and push the on switch all the way down so that the slice of bread is inserted into the toaster.
- It is possible to turn the knob to toast a bread slice to add more or less power to toasting during the toaster's operation. The toasting level setting does not change the toasting time. The toaster switches off automatically after the set time has elapsed. The slice of toast slides out of the toaster.

Toasting frozen bread

- If you are toasting frozen bread just taken out of the freezer, insert it into the toaster slot and set the desired level of toasting. Push the power switch down and then press the defrost button 1.

Reheating already toasted bread

- If you are reheating already toasted bread, insert it into the toaster slot and set the desired level of toasting.
- Push the power switch down and press the reheat button 2.

Pausing toasting

- You can use the End toasting 4 button at any time during toasting, e.g. when the toast is too dark or if a problem occurs.

Toasting rolls and buns

- Push the holder lever down to slide out the integrated baking attachment. Select the baking level. Place the rolls or buns on the baking attachment and push down the power switch. To improve the result, turn the baked goods and start another toasting cycle.
- Do not place the baked goods directly on the surface of the toaster. Always use the baking attachment.

TIPS FOR TOASTING BREAD

- Type of bread, its moisture content, age, thickness and number of slices. All this affects the level of toasting. If you are going to toast two slices of bread next to each other, they should be of the same type, the same degree of humidity and the same age (the bread should be kept in a closed container). Always store sliced bread for toasting in a dry place.
- The total thickness of the slices should not exceed 2.5 cm.
- It is possible to use any bread, buns and pastries in the toaster without icing, including frozen. In general, darker types of bread need to be toasted to a higher degree than lighter types. If you want to get an especially soft toast, spray it lightly with water before toasting.
- Very thin slices (thinner than 0.5 cm) will not be automatically centered and should be toasted at the lowest level so that they do not burn on one side.

CLEANING AND MAINTENANCE

- Always unplug the power cord and wait for the toaster to cool completely before cleaning it.

- Pull out and empty the crumb tray. Clean the tray regularly, use a hard brush, for example, to remove burnt crumbs.
- Clean the outer surface of the toaster with a damp cloth. Do not use sharp objects or abrasives to clean the toaster.
- Do not immerse the toaster in water or use a dishwasher to clean it.



The use of the WEEE Symbol indicates that this product should not be treated as household waste. By ensuring this product is disposed of correctly, you will help protect the environment. For more detailed information about the recycling of this product, please contact your local authority, your household waste disposal service provider, or the shop where you purchased the item.

This product meets all of the related basic EU regulation requirements. The EU declaration of conformity is available on www.alzashop.com/doc.

This product sold in the European Union meet the requirements of Directive 2071/65/EU on the restriction of the use of certain hazardous substances in electrical and electronic equipment (RoHS).

www.siguro.net

Documents / Resources

	<p>SIGURO T11SS Toaster [pdf] Instruction Manual</p> <p>T11SS Toaster, T11SS, Toaster</p>
	<p>SIGURO T11SS Toaster [pdf] User Manual</p> <p>T11SS Toaster, T11SS, Toaster</p>