



Signcomplex RL7035 LED Linear Light Instruction Manual

[Home](#) » [Signcomplex](#) » Signcomplex RL7035 LED Linear Light Instruction Manual



**RL7035 LED Linear Light
Instruction Manual**



CRI
≥80

CE

RoHS

Warranty
5years

Contents [[hide](#)]

- [1 Description](#)
- [2 Features](#)
- [3 Application](#)
- [4 Technical parameters](#)
- [5 Dimension: \(mm\)](#)
- [6 Installation Drawing](#)
- [7 The installation and connection drawing of RL7035 spring buckle type](#)
- [8 Wiring diagram](#)
- [9 Product packaging information](#)
- [10 Documents / Resources](#)
 - [10.1 References](#)
- [11 Related Posts](#)

Description

RL7035 linear light is mainly designed for recessed installation or continuous lighting the light body has a simple appearance with soft light continuous connection and it is widely used in shopping malls, offices, and soon.

Features





1. The whole lamp is aluminum alloy+PC materials with surface oxidation silver process.
2. Allowing reliable and solid structure. Good heat dissipation and optical performance.
3. Multiple jointing can realize Via the “+” “L” “T” shape connecting accessories.
4. Adoption of U-shaped support and spring buckle type installation for optional

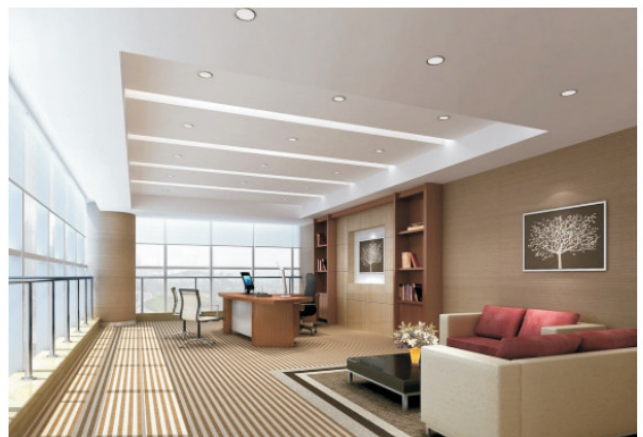
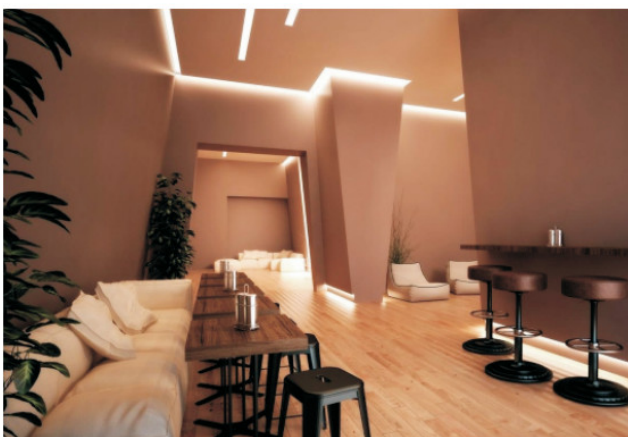

Application

Applicable to department stores, hotels, offices, and other sites.









Technical parameters

Model	CCT	lumen(lm) (±10%)	Power(W) (±10%)	LED type	LED quantity (PCS)	Length (MM)	Section	Voltage(V)	Dimming Optional	CRI	PF
SC-RL7035-020-AW-CW	6000-6500k	1500 lm	20	2835	108	615	 U-shaped bracket type	220-240VAC 50/60HZ	Non-dimming	≥80	≥0.90
SC-RL7035-020-AW-NW	3800-4200k	1500 lm									
SC-RL7035-020-AW-WW	2800-3200k	1300 lm									
SC-RL7035-040-AW-CW	6000-6500k	3000 lm	40	2835	204	1215					
SC-RL7035-040-AW-NW	3800-4200k	3000 lm									
SC-RL7035-040-AW-WW	2800-3200k	2600 lm									
SC-RL7035-050-AW-CW	6000-6500k	3750 lm	50	2835	252	1515					
SC-RL7035-050-AW-NW	3800-4200k	3750 lm									
SC-RL7035-050-AW-WW	2800-3200k	3250 lm									
SC-RL7035-020-AW-01CW	6000-6500k	1500 lm	20	2835	108	615	 Drawing of spring buckle type	220-240VAC 50/60HZ	Non-dimming	≥80	≥0.90
SC-RL7035-020-AW-01NW	3800-4200k	1500 lm									
SC-RL7035-020-AW-01WW	2800-3200k	1300 lm									
SC-RL7035-040-AW-01CW	6000-6500k	3000 lm	40	2835	204	1215					
SC-RL7035-040-AW-01NW	3800-4200k	3000 lm									
SC-RL7035-040-AW-01WW	2800-3200k	2600 lm									
SC-RL7035-050-AW-01CW	6000-6500k	3750 lm	50	2835	252	1515					
SC-RL7035-050-AW-01NW	3800-4200k	3750 lm									
SC-RL7035-050-AW-01WW	2800-3200k	3250 lm									
SC-RL7035-020-AW-A01-CW	6000-6500k	1500 lm	20	2835	108	615	 U-shaped bracket type	220-240VAC 50/60HZ	0-10V dimming	≥80	≥0.90
SC-RL7035-020-AW-A01-NW	3800-4200k	1500 lm									
SC-RL7035-020-AW-A01-WW	2800-3200k	1300 lm									
SC-RL7035-040-AW-A01-CW	6000-6500k	3000 lm	40	2835	204	1215					
SC-RL7035-040-AW-A01-NW	3800-4200k	3000 lm									
SC-RL7035-040-AW-A01-WW	2800-3200k	2600 lm									
SC-RL7035-050-AW-A01-CW	6000-6500k	3750 lm	50	2835	252	1515					
SC-RL7035-050-AW-A01-NW	3800-4200k	3750 lm									
SC-RL7035-050-AW-A01-WW	2800-3200k	3250 lm									
SC-RL7035-020-AW-A01-01CW	6000-6500k	1500 lm	20	2835	108	615	 Drawing of spring buckle type	220-240VAC 50/60HZ	0-10V dimming	≥80	≥0.90
SC-RL7035-020-AW-A01-01NW	3800-4200k	1500 lm									
SC-RL7035-020-AW-A01-01WW	2800-3200k	1300 lm									
SC-RL7035-040-AW-A01-01CW	6000-6500k	3000 lm	40	2835	204	1215					
SC-RL7035-040-AW-A01-01NW	3800-4200k	3000 lm									
SC-RL7035-040-AW-A01-01WW	2800-3200k	2600 lm									
SC-RL7035-050-AW-A01-01CW	6000-6500k	3750 lm	50	2835	252	1515					
SC-RL7035-050-AW-A01-01NW	3800-4200k	3750 lm									
SC-RL7035-050-AW-A01-01WW	2800-3200k	3250 lm									

Model	CCT	lumen(lm) (±10%)	Power(W) (±10%)	LED type	LED quantity (PCS)	Length (MM)	Section	Voltage(V)	Dimming Optional	CRI	PF
SC-RL7035-020-AW-D01-CW	6000-6500k	1500 lm	20	2835	108	615	 U-shaped bracket type	220-240VAC 50/60HZ	Dali dimming	≥80	≥0.90
SC-RL7035-020-AW-D01-NW	3800-4200k	1500 lm									
SC-RL7035-020-AW-D01-WW	2800-3200k	1300 lm									
SC-RL7035-040-AW-D01-CW	6000-6500k	3000 lm	40	2835	204	1215					
SC-RL7035-040-AW-D01-NW	3800-4200k	3000 lm									
SC-RL7035-040-AW-D01-WW	2800-3200k	2600 lm									
SC-RL7035-050-AW-D01-CW	6000-6500k	3750 lm	50	2835	252	1515					
SC-RL7035-050-AW-D01-NW	3800-4200k	3750 lm									
SC-RL7035-050-AW-D01-WW	2800-3200k	3250 lm									
SC-RL7035-020-AW-D01-01CW	6000-6500k	1500 lm	20	2835	108	615	 Drawing of spring buckle type	220-240VAC 50/60HZ	Dali dimming	≥80	≥0.90
SC-RL7035-020-AW-D01-01NW	3800-4200k	1500 lm									
SC-RL7035-020-AW-D01-01WW	2800-3200k	1300 lm									
SC-RL7035-040-AW-D01-01CW	6000-6500k	3000 lm	40	2835	204	1215					
SC-RL7035-040-AW-D01-01NW	3800-4200k	3000 lm									
SC-RL7035-040-AW-D01-01WW	2800-3200k	2600 lm									
SC-RL7035-050-AW-D01-01CW	6000-6500k	3750 lm	50	2835	252	1515					
SC-RL7035-050-AW-D01-01NW	3800-4200k	3750 lm									
SC-RL7035-050-AW-D01-01WW	2800-3200k	3250 lm									

RL7035 Connector parameters

Model	CCT	lumen(lm) (±10%)	Power(W) (±10%)	LED type	LED quantity (PCS)	Picture	Voltage(V)	Dimming Optional	CRI	PF
SC-RL7035L1-008-AW-CW	6000-6500k	680 lm	8	2835	36		220-240VAC 50/60HZ	Non-dimming	≥80	≥0.90
SC-RL7035L1-008-AW-NW	3800-4200k	680 lm								
SC-RL7035L1-008-AW-WW	2800-3200k	680 lm								
SC-RL7035L2-008-AW-CW	6000-6500k	680 lm	8	2835	36					
SC-RL7035L2-008-AW-NW	3800-4200k	680 lm								
SC-RL7035L2-008-AW-WW	2800-3200k	680 lm								
SC-RL7035L3-010-AW-CW	6000-6500k	850 lm	10	2835	48					
SC-RL7035L3-010-AW-NW	3800-4200k	850 lm								
SC-RL7035L3-010-AW-WW	2800-3200k	850 lm								
SC-RL7035T-012-AW-CW	6000-6500k	1020 lm	12	2835	60					
SC-RL7035T-012-AW-NW	3800-4200k	1020 lm								
SC-RL7035T-012-AW-WW	2800-3200k	1020 lm								
SC-RL7035R-016-AW-CW	6000-6500k	1360 lm	16	2835	84					
SC-RL7035R-016-AW-NW	3800-4200k	1360 lm								
SC-RL7035R-016AW-WW	2800-3200k	1360 lm								
SC-RL7035L1-008-AW-A01-CW	6000-6500k	680 lm	8	2835	36		220-240VAC 50/60HZ	0-10V dimming	≥80	≥0.90
SC-RL7035L1-008-AW-A01-NW	3800-4200k	680 lm								
SC-RL7035L1-008-AW-A01-WW	2800-3200k	680 lm								

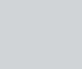
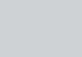
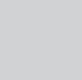
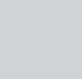
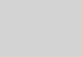
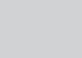
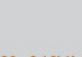
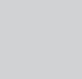
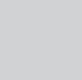
Model	CCT	lumen(lm) (±10%)	Power(W) (±10%)	LED type	LED quantity (PCS)	Voltage(V)	Voltage(V)	Dimming Optional	CRI	PF
SC-RL7035L2-008-AW-A01-CW	6000-6500k	680 lm	8	2835	36		220-240VAC 50/60HZ	0-10V dimming	≥80	≥0.90
SC-RL7035L2-008-AW-A01-NW	3800-4200k	680 lm								
SC-RL7035L2-008-AW-A01-WW	2800-3200k	680 lm								
SC-RL7035L3-010-AW-A01-CW	6000-6500k	850 lm	10	2835	48					
SC-RL7035L3-010-AW-A01-NW	3800-4200k	850 lm								
SC-RL7035L3-010-AW-A01-WW	2800-3200k	850 lm								
SC-RL7035T-012-AW-A01-CW	6000-6500k	1020 lm	12	2835	60					
SC-RL7035T-012-AW-A01-NW	3800-4200k	1020 lm								
SC-RL7035T-012-AW-A01-WW	2800-3200k	1020 lm								
SC-RL7035R-016-AW-A01-CW	6000-6500k	1360 lm	16	2835	84					
SC-RL7035R-016-AW-A01-NW	3800-4200k	1360 lm								
SC-RL7035R-016-AW-A01-WW	2800-3200k	1360 lm								
SC-RL7035L1-008-AW-D01-CW	6000-6500k	680 lm	8	2835	36		220-240VAC 50/60HZ	Dali dimming	≥80	≥0.90
SC-RL7035L1-008-AW-D01-NW	3800-4200k	680 lm								
SC-RL7035L1-008-AW-D01-WW	2800-3200k	680 lm								
SC-RL7035L2-008-AW-D01-CW	6000-6500k	680 lm	8	2835	36					
SC-RL7035L2-008-AW-D01-NW	3800-4200k	680 lm								
SC-RL7035L2-008-AW-D01-WW	2800-3200k	680 lm								
SC-RL7035L3-010-AW-D01-CW	6000-6500k	850 lm	10	2835	48					
SC-RL7035L3-010-AW-D01-NW	3800-4200k	850 lm								
SC-RL7035L3-010-AW-D01-WW	2800-3200k	850 lm								
SC-RL7035T-012-AW-D01-CW	6000-6500k	1020 lm	12	2835	60					
SC-RL7035T-012-AW-D01-NW	3800-4200k	1020 lm								
SC-RL7035T-012-AW-D01-WW	2800-3200k	1020 lm								
SC-RL7035R-016-AW-D01-CW	6000-6500k	1360 lm	16	2835	84					
SC-RL7035R-016-AW-D01-NW	3800-4200k	1360 lm								
SC-RL7035R-016-AW-D01-WW	2800-3200k	1360 lm								

Dimension: (mm)

615



600

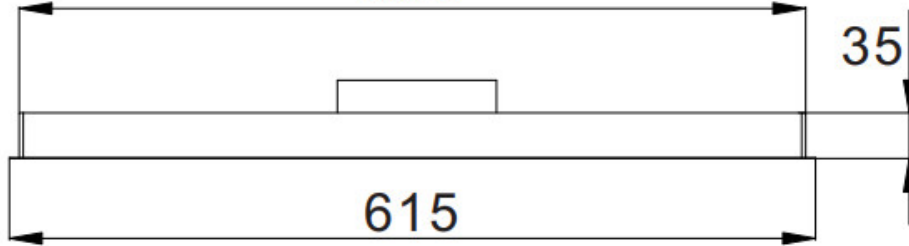

55

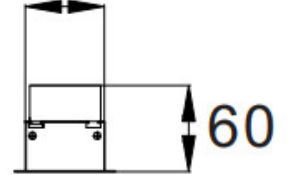

1215



1200

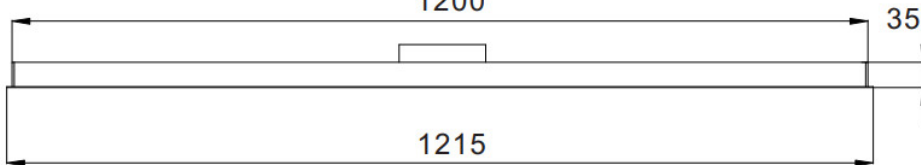

55

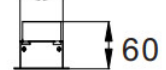

1515



1500

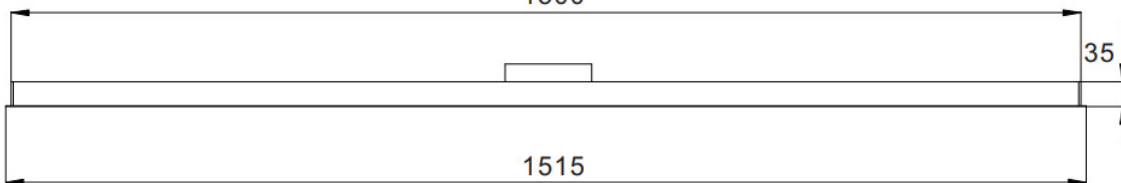

55

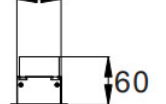

Connector dimension:(mm)

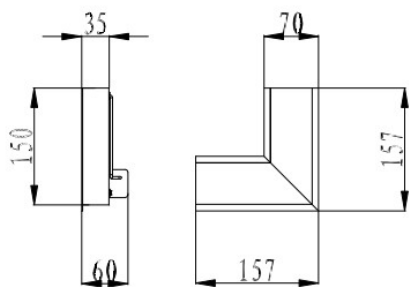

L shape connector-1

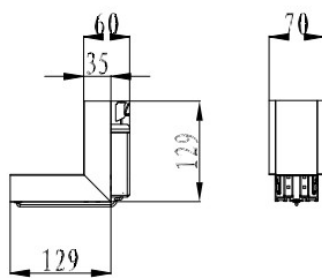

L shape connector-2

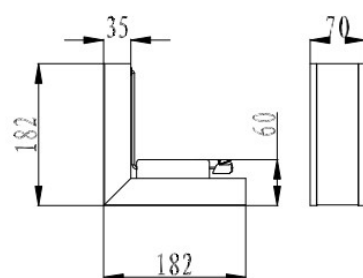

L shape connector-3

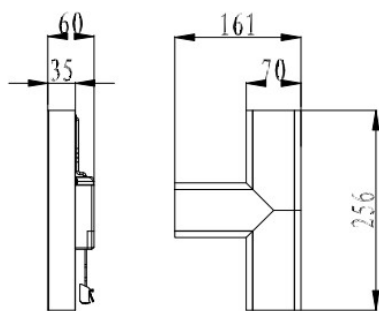

T shape connector

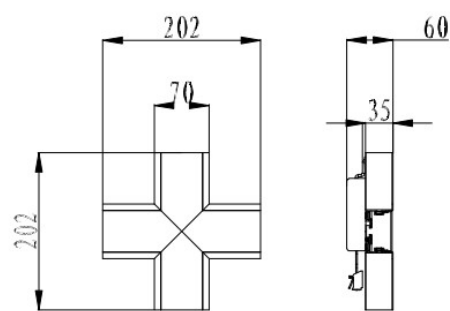

+ shape connector

Installation Drawing

Installation and connection drawing of RL7035 U-shaped bracket type

1. List of light materials

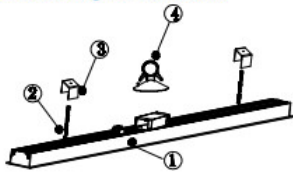

1. Light body 1PC
2. Embedded mounting bracket 2PCS
3. M4*50 threaded rod 2PCS
4. Suckers 1PC

2. Drilling hole

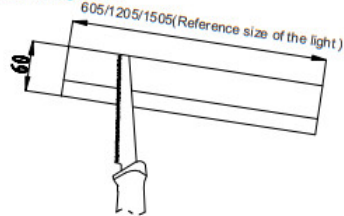

1. Cut the mounting groove on the ceiling according to corresponding size.

3. Dismantle PC cover and the end cap

It does not dismantle the side cover for installation of single light.

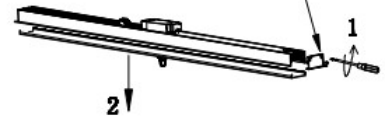

1. Dismantle the end cap.
2. Take off the PC lampshade by sucker tightly.

4. Install U-shaped bracket

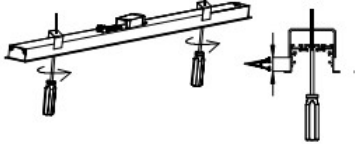

1. Insert two M4 thread rods into two holes on the light body respectively.
2. The thread rods align with the threaded holes on the U-shaped bracket. Rotate the bolts to install the U-shaped bracket onto the thread rod.

* Note: the size at A needs to be larger than the size of ceiling thickness

5. Connect AC wire

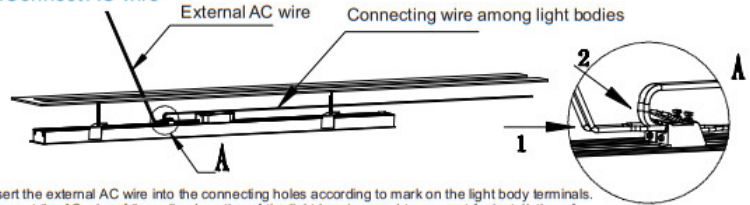

1. Insert the external AC wire into the connecting holes according to mark on the light body terminals.
2. Connect the AC wire of the spliced section of the light body (no need to connect for installation of single light body).

* The wire diameter of AC connecting wire and the connecting wires among light bodies should meet the current requirements of the spliced section.

6. Tighten U-shaped mounting bracket

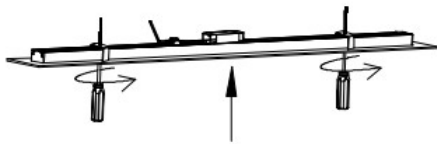

1. Align the light body with the grooves that are opened on the ceiling and install the light into the groove upwards.
2. Push the thread rod upwards to make the thread head cling to the profile of the light body.
3. Use the screwdriver to rotate the thread rod so as to make the U-shape bracket to rotate.
4. Continue to rotate the thread rod until the light body edge clings to the ceiling.

7. The light disposal at the middle spliced section

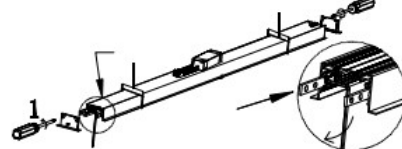

1. Dismantle the side covers at two ends of the light body and PC shade.
2. The slotted connecting parts are inserted into the left and right clamping groove at one end of the light body.
3. Use hexagonal machine screws to lock the slotted connecting parts tightly.
4. Refer to 3 to install the U-shaped brackets.

* Go to the diagram 11 directly for installation of single light.

8. AC wire connecting of the spliced section

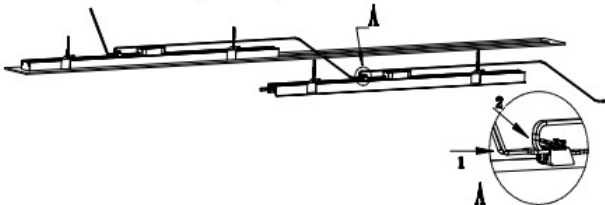

1. Another end of the light body connecting wire, which is connected properly on the previous light body, is connected properly according to the mark on the wiring terminal of the current light.
2. Connect the AC wire of the next light body that needs splicing.

9. The light body installation of the middle spliced section

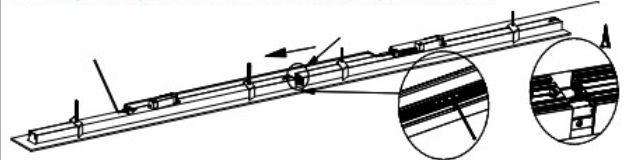

1. The slotted connecting parts, which are installed properly on the light body of the spliced section are inserted into the clamping groove at two sides of the light body of the previous section.
2. The slotted connecting parts inserted into the light body of the previous section are locked tightly with hexagonal machine screws.
3. Refer to 6 to tighten the U-shaped brackets.

10. The light body installation of the spliced tail section

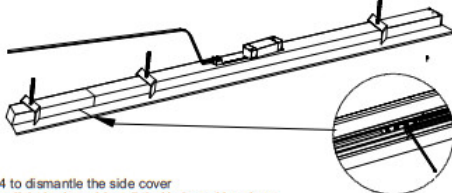

1. Refer to 3 and 4 to dismantle the side cover at one end of the light body and install the U-shaped brackets.
2. The AC connecting section reserved in the previous section light body is inserted into the wiring hole of the wiring terminal of the light body of the tail section.
2. The slotted connecting parts are inserted into the left and right clamping groove at one end of the light body.
3. Use the slotted connecting parts to connect the middle-section light body and tail-section light body. Use hexagonal machine screws to tighten.
4. Refer to 6 to tighten the U-shaped brackets.

11. Install PC cover

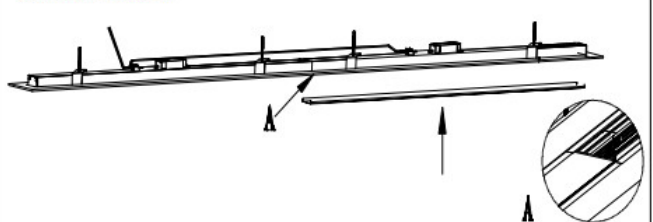

1. Insert two ends of the PC cover into two ends of the light body first.
2. Press the PC cover. After the PC cover clings to the profile, press two ends of the PC cover so that the PC cover is clamped into the clamping groove on the light body.

The installation and connection drawing of RL7035 spring buckle type

1. List of light materials

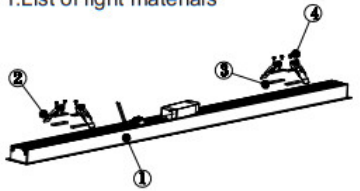

1. Light body
2. Spring buckle
3. Spring buckle fasteners
4. M4 Machine screws

2. Drilling hole

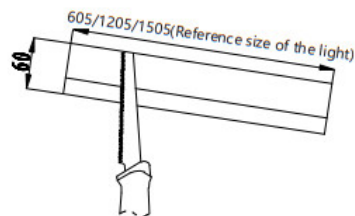

1. Cut the mounting groove on the ceiling according to corresponding size.

3. Install the spring buckle

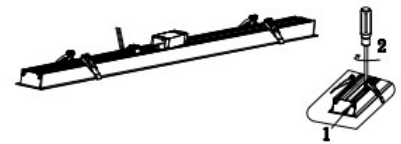

1. The spring buckle fasteners are installed into the clamping groove on the top of light body.
2. Use M4 machine screws to fix the spring buckles on the spring buckle fasteners.

4. Dismantle the side cover and PC cover



It need not dismantle the side cover and PC cover for installation of single light body.

1. Use the screwdriver to remove the fixing screws on side cover of one end of the light body and take down the end cap.
2. Take off the PC cover.

* Go to the next diagram directly for installation of single light body

5. Connect AC wire

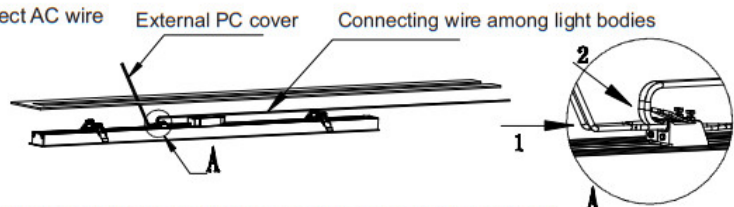

1. Insert the external AC wire into the connecting holes according to mark on the light body terminals.
2. Connect the AC wire of the spliced section light body (no need to connect for installation of single light body).

* The wire diameter of AC connecting wire and the connecting wires among light bodies should meet the current requirements of the spliced section.

6. Install the light into mounting groove in the ceiling



1. Pull the spring buckles upwards as shown in the figure.
2. Align the light body with the grooves that are opened on the ceiling and install the light.



7. The light disposal at the middle spliced section

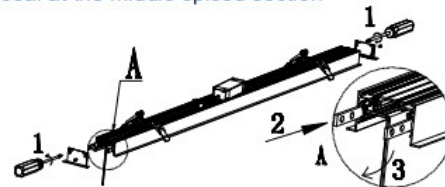

1. Dismantle the side covers at two ends of the light body and PC cover.
2. The slotted connecting parts are inserted into the left and right clamping groove at one end of the light body.
3. Use hexagonal machine screws to lock the slotted connecting parts tightly.
4. Refer to 3 to install the spring buckles.

8. AC wire connecting of the spliced section



1. Another end of the light connecting wire, which is connected properly on the previous light body is connected properly according to the mark on the wiring terminal of the current light.
2. Connect the AC wire of the next light body that needs splicing.

9. The light body installation of the middle spliced section

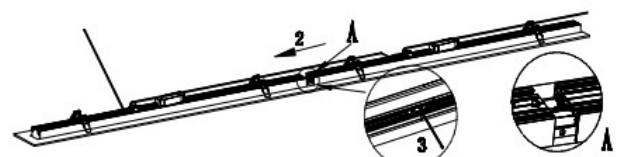

1. Refer to 5 and 6 for installing the middle light body of the spliced section.
2. The slotted connecting parts, which are installed properly on the light body of the spliced section are inserted into the clamping groove at two sides of the light body of the previous section.
3. The slotted connecting parts inserted into the light body of the previous section is locked tightly with hexagonal machine screws.

10. The end-section installation of the light body of the spliced tail-section.

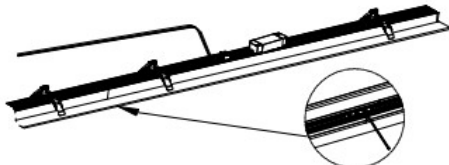

1. Refer to 3 and 4 to dismantle the side cover at one end of the light body and install the buckles.
2. The AC connecting section reserved in the previous section light body is inserted into the wiring hole of the wiring terminal of the light body of the tail section.
2. The slotted connecting parts are inserted into the left and right clamping grooves at one end of the light.
3. Install the light body by referring to 6.
4. Use the slotted connecting parts to connect the middle-section light body and tail-section light body. Use hexagonal machine screws to tighten.

11. Install PC cover

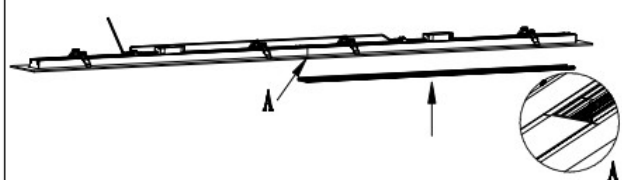

1. Insert two ends of the PC cover into two ends of the light body first.
2. Press the PC cover. After the PC cover clings to the profile, press two ends of the PC cover so that the PC cover is clamped into the clamping groove on the light body.

Installation and connection drawing of U-shaped bracket type

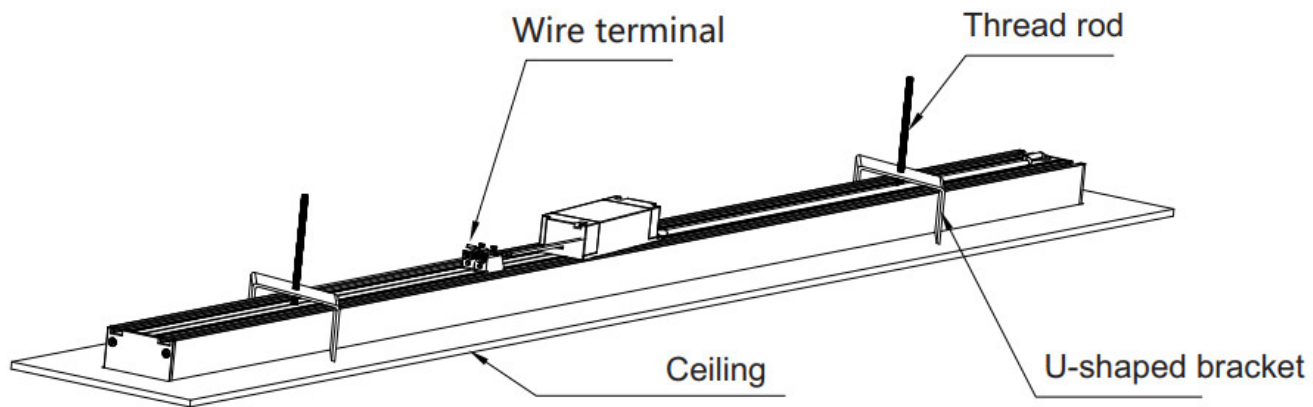

Each lamp is including two jointing connectors to do the continuous connection 

The installation and connection drawing of spring buckle type

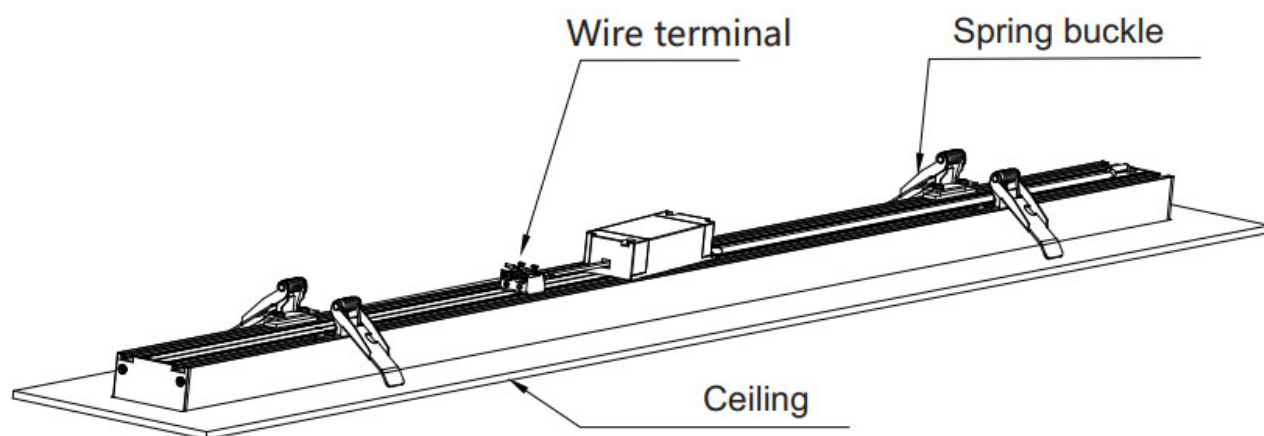

Each lamp is including two jointing connectors to do the continuous connection 

Wiring diagram

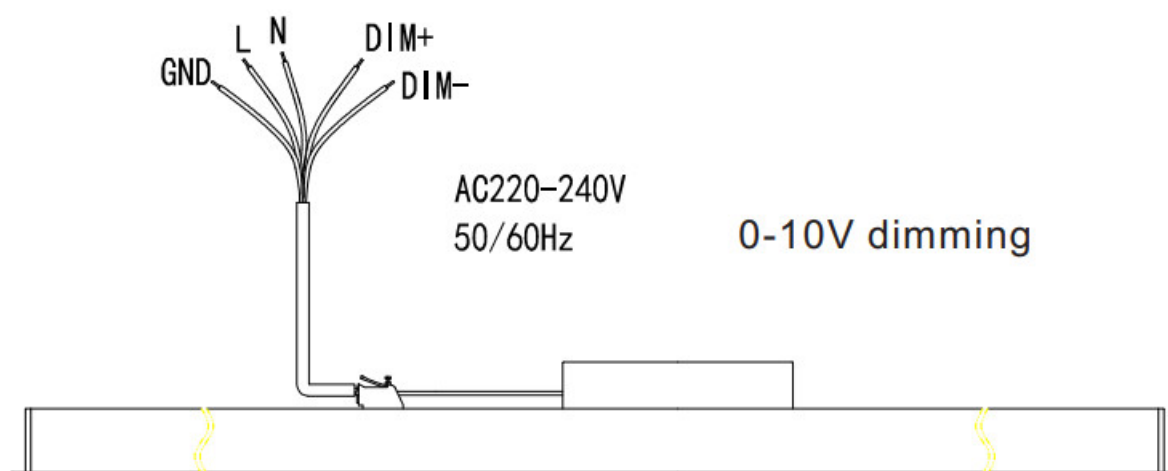
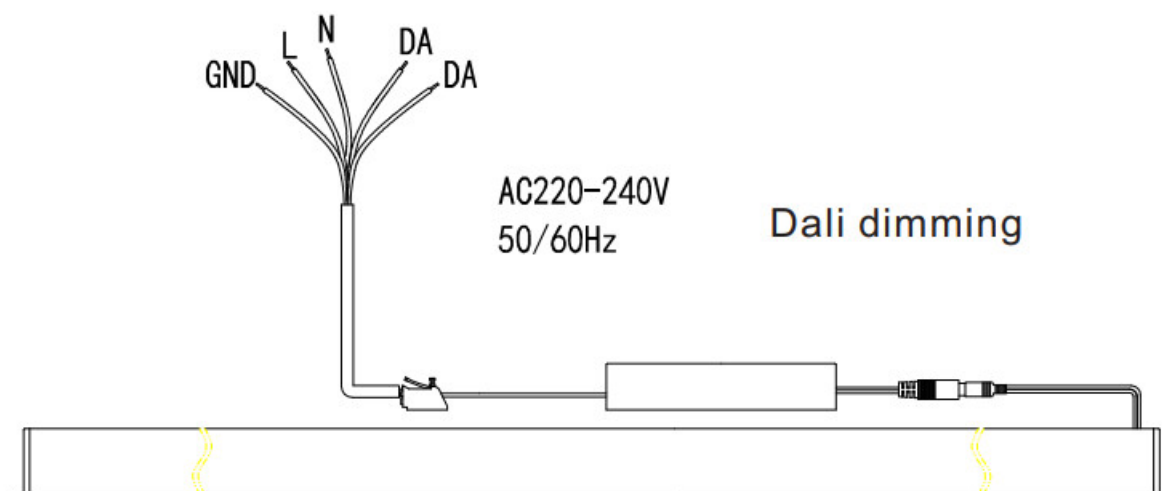
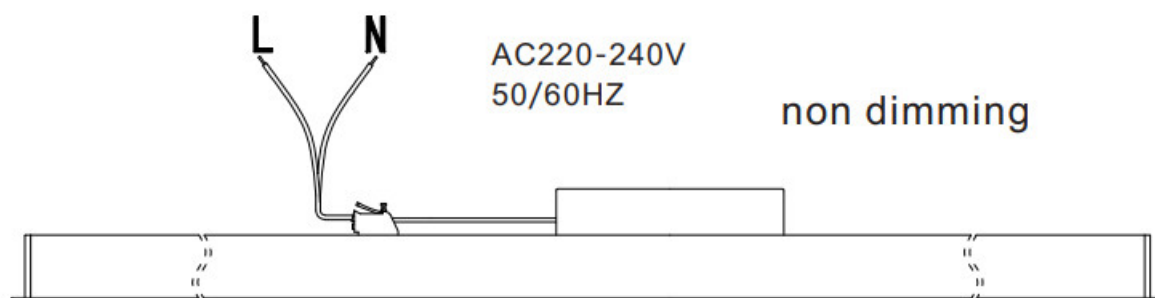

(**Remark:** The max current consumption of our driver to the 0-10V dimmer is 2mA each one)

Product packaging information

0.6M lamp	1.2M lamp	1.5M lamp
<ul style="list-style-type: none"> ● net weight/pc:0.7KG ● gross weight/CTN: 7.06KG ● inner size:642*75*75mm ● carton size:660*170*375mm ● 1pc/inner box,10 inner boxes/carton 	<ul style="list-style-type: none"> ● netweight/pc:1.32KG ● grossweight/CTN:14.3KG ● innersize:1242*75*75mm ● cartonsize:1260*170*375mm ● 1pc/innerbox,10innerboxes/carton 	<ul style="list-style-type: none"> ● netweight/pc:1.65KG ● grossweight/CTN:17.8KG ● innersize:1542*75*75mm ● cartonsize:1560*170*375mm ● 1pc/innerbox,10innerboxes/carton
"L1" lamp	"L2" lamp	"L3" lamp
<ul style="list-style-type: none"> ● net weight/pc:0.81KG ● gross weight/CTN: 18.63KG ● inner size:335*335*92mm ● carton size:450*355*480mm ● 2pcs/inner box,10 inner boxes/carton 	<ul style="list-style-type: none"> ● netweight/pc:0.76KG ● grossweight/CTN:17.48KG ● innersize:335*335*92mm ● cartonsize:450*355*480mm ● 2pcs/inner box,10 inner boxes/carton 	<ul style="list-style-type: none"> ● netweight/pc:0.91KG ● grossweight/CTN:19.35KG ● innersize:335*335*92mm ● cartonsize:450*355*480mm ● 2pcs/inner box,10 inner boxes/carton
"T" lamp	"+" lamp	
<ul style="list-style-type: none"> ● net weight/pc:0.61KG ● gross weight/CTN: 7.25KG ● inner size:335*335*92mm ● carton size:450*355*480mm ● 1pc/inner box,10 inner boxes/carton 	<ul style="list-style-type: none"> ● netweight/pc:0.71KG ● grossweight/CTN:4.5KG ● innersize:335*335*92mm ● cartonsize:355*355*480mm ● 1pc/innerbox,5innerboxes/carton 	



Notice

1. You are asked to read the instruction manual carefully before use to ensure that the use condition meets the use requirement of the product and relevant technical specifications.
2. Forbid hot-line work. Don't touch the lamp unless the power supply is disconnected to avoid electric shock.
3. Please check whether the lamp is damaged during transportation after opening the package or before use. If there is damage, please stop use and inform the suppliers. The product can only be used in intact conditions.
4. In order to ensure safe use of the product, please follow the instruction manual strictly for product installation. The supplier will not undertake any responsibility for any loss caused by the illegal operation.

Tel:+86-755-27608650 Fax:+86-755-27608651 sales@signcomplex.com
Yijia Industrial Park, Fuqian Road, Guanlan Town, Baoan, Shenzhen, Guangdong, China
www.signcomplex.com

Documents / Resources

<p>RL7035 LED Linear Light — Only for recessed installation</p> <p>Signcomplex RL7035 LED Linear Light [pdf] Instruction Manual RL7035, LED Linear Light, RL7035 LED Linear Light</p>	
--	--

References

- [Signcomplex Led Lighting Company, LED Panel Light, Linear Light, LED Downlight, LED Tube and Emergen](#)

