



SIEMENS 200969-4 Reverse Fixings Installation Guide

May 23,
2025

Contents [[hide](#)]

[1 200969-4 Reverse Fixings](#)

[2 Product Specifications](#)

[3 Product Usage Instructions](#)

[3.1 Installation Instructions for Reverse Fixings](#)

[3.2 Fitting Instructions for Fuse Combination Units](#)

[3.3 Installation Procedure](#)

[3.3.1 Terminal Data](#)

[3.3.2 Fuse and Terminal Torque Values](#)

[3.4 Maintenance](#)

[4 Frequently Asked Questions \(FAQ\)](#)

[4.1 Q: Is maintenance required for the switch?](#)

[4.2 Q: What should be done in case of hazardous voltage?](#)

[4.3 Documents / Resources](#)

[4.3.1 References](#)

200969-4 Reverse Fixings

“

Product Specifications

- Brand: Electrium Sales Limited, Siemens Ltd
 - Model: 200969-4 NH SF
 - Country of Origin: England, Ireland
-

Product Usage Instructions

Installation Instructions for Reverse Fixings

1. Remove top and bottom covers.
2. Open door fully and remove hinge fixing screws.
3. Remove door.
4. Remove switch fixing screws and remove switch.
5. Turn box upside down and fit bottom hinge in position as shown using existing M3 countersunk screws (2 off).
6. Fit switch.
7. Fit Neutral.
8. Locate door on bottom hinge pin and open door fully.
9. Fit top hinge with existing M3 countersunk screws (2 off).
10. Fit remaining covers.

Refer to section 3 INSTALLATION PROCEDURE for remaining checks to switch.

Fitting Instructions for Fuse Combination Units

1. Storage prior to installation must be in a clean dry condition.
2. **Safety Warning:** DANGER HAZARDOUS VOLTAGE

Installation Procedure

Installation and operation must be in accordance with published

data, instructions, and diagrams and with any relevant national and local regulations.

Terminal Data

Size	Phase Width	Terminal Width	Bolt Size
20A – 32A	21.5mm	6.5mm	M8

Fuse and Terminal Torque Values

Thread Size	Torque Value
M4	1.35Nm

Maintenance

No maintenance of the switch is required except for the periodic checking of the tightness of the terminals and fuse links.

Maintenance must be carried out by competent personnel with the supply isolated.

Frequently Asked Questions (FAQ)

Q: Is maintenance required for the switch?

A: No, maintenance is not required except for periodic checks of terminal tightness and fuse links.

Q: What should be done in case of hazardous voltage?

A: Exercise caution and follow safety procedures outlined in the manual to avoid any accidents.

[View Fullscreen](#)

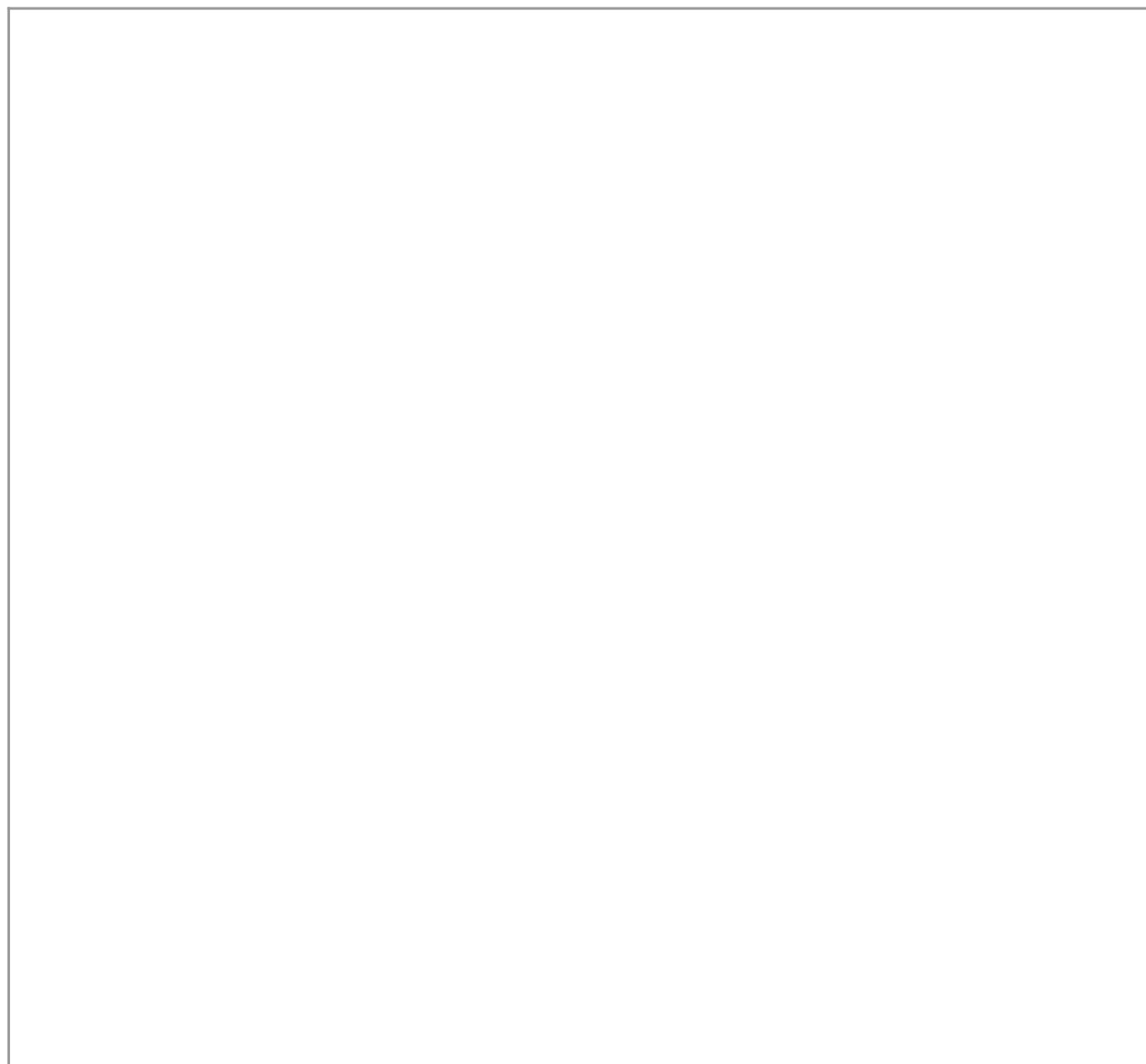

Installation Instructions for Reverse Fixings

Installation and operation must be in accordance with published data, instructions and diagrams and with any relevant national and local regulations.

A) Remove top and bottom covers. B) Open door fully and remove hinge fixing screws. C) Remove door.

D) Remove switch fixing screws and remove switch

E) Turn box upside down and fit bottom hinge in position as shown using existing M3 countersunk screws (2 off)

F) Fit switch G) Fit Neutral

H) Locate door on bottom hinge pin and open door fully. I) Fit top hinge with existing M3 countersunk screws (2 off)

J) Fit remaining covers. K) Refer to section 3 INSTALLATION PROCEDURE for remaining checks to switch.

Electrium Sales Limited, Walkmill Lane, Cannock, WS11 0XE, England

Siemens Ltd, Old Finglas Road, Dublin, Ireland

Tel: 01543 455000

Fax: 01543 455001

200969-4

NH SF

Fitting Instructions for fuse combination units

1) INSPECTION ON RECEIPT, The following are supplied with each switch

Size 20A -32A 63A 100A 125A 200A 315A — 400A 630A 800A

HOUSING C/W SWITCH HOUSING C/W SWITCH HOUSING C/W SWITCH HOUSING C/W SWITCH HOUSING C/W SWITCH

TERMINAL FIXING KIT TERMINAL FIXING KIT TERMINAL FIXING KIT TERMINAL FIXING KIT

EARTH FIXING KIT EARTH FIXING KIT EARTH FIXING KIT EARTH FIXING KIT EARTH FIXING KIT EARTH FIXING KIT

Storage prior to installation must be in clean dry condition. 2) Safety.

DANGER HAZARDOUS VOLTAGE

1

FUSE KIT

FUSE KIT

FUSE KIT FUSE KIT (125A ONLY)

E B

A

F 25.0 70.0

D

G

C

H

Size 20A -32A

63A 100A 125A 160A 200A 250A 400A 630A 800A

AB CDE F GH 220 150 210 140 105 200 130 135 420 320 262 162 105 258.5 183 188
420 320 262 162 105 258.5 183 188 525 425 315 215 105 305 235 240 735 645 420
320 210 305 235 240 850 760 630 430 210 355 285 290

2

3) INSTALLATION PROCEDURE

INSTALLATION AND OPERATION MUST BE IN ACCORDANCE WITH PUBLISHED DATA, INSTRUCTIONS AND DIAGRAMS AND WITH ANY RELEVANT NATIONAL AND LOCAL REGULATIONS.

With the housed switch in the Off position mount as shown on page 2. (for ease of installation the switch can be temporarily removed from the housing) Verify the mechanical operation of the switch. Check the operation of the door interlock (i.e. the door cannot be opened with the switch in the ON position) Fit the required fuse links or isolator links (using the fasteners provided) Check the electrical continuity of the switch. The incoming connection may be made to the terminals at either end of the switch. Terminal shields provided must be fitted after connection to all phases and both sides of the switch.

TERMINAL DATA

Size 20A -32A

63A 100A 125A 160A 200A

250A 315A 400A

630A 800A

Phase Width 21.5mm 32.0mm 36.0mm 36.0mm 60.0mm 66.0mm 80.0mm 80.0mm

Terminal Width 6.5mm 7.0mm 22.0mm 22.0mm 32.0mm 50.0mm 50.0mm 50.0mm

Terminal Hole Size Box Terminals Max 16mm² Box terminals Max 25mm²

M8 M8 M10 M10 M12 4 x M8 or 1 x M14

4) FUSE AND TERMINAL TORQUE VALUES

Thread Size M4 M5 M6

Torque Value 1.35Nm 5.5Nm 9.5Nm

Thread Size M8 M10 M12

Torque Value 17Nm 28Nm 45Nm

5) Maintenance

No maintenance of the switch is required except for the periodic checking of the tightness of the terminals and fuse links. Maintenance must be carried out by competent personnel with the supply isolated.

Current Rating 20A -32A 63A 100A 125A 160A 200A 315A 400A 630A 800A

Fuse Selection Data

BS88 Reference

Lawson

GEC

A1

NIT

NIT

A3, A2

TIS

TIS

A4

TCP

TCP

A4

TFP, TCP

TFP, TCP

A4

TFP, TCP

TFP, TCP

A4

TFP, TCP

TFP, TCP

B3

TKF

TKF

B4,B3,B2,B1

TMF

TMF

C2,C1

TTM

TTM

C3,C2,C1

TLM

TLM

Busman NITD BAO CEO DEO DEO DEO ED ED FF GF

Documents / Resources

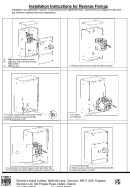

[SIEMENS 200969-4 Reverse Fixings \[pdf\]](#) Installation Guide

200969-4 Reverse Fixings, 200969-4, Reverse Fixings, Fixings

References

- [User Manual](#)

■ SIEMENS ♦ 200969-4, 200969-4 Reverse Fixings, Fixings, Reverse Fixings, SIEMENS

Leave a comment

Your email address will not be published. Required fields are marked *

Comment *

Name

Email

Website

☐ Save my name, email, and website in this browser for the next time I comment.

Post Comment

Search:

e.g. whirlpool wrf535swhz

Search

[Manuals+](#) | [Upload](#) | [Deep Search](#) | [Privacy Policy](#) | [@manuals.plus](#) | [YouTube](#)

This website is an independent publication and is neither affiliated with nor endorsed by any of the trademark owners. The "Bluetooth®" word mark and logos are registered trademarks owned by Bluetooth SIG, Inc. The "Wi-Fi®" word mark and logos are registered trademarks owned by the Wi-Fi Alliance. Any use of these marks on this website does not imply any affiliation with or endorsement.