



[Home](#) » [SICCE](#) » **SICCE Tidal 55 Power Filters Owner's Manual** 

Contents [[hide](#)]

- [1 SICCE Tidal 55 Power Filters](#)
- [2 Product Information](#)
- [3 IMPORTANT SAFETY INSTRUCTIONS](#)
- [4 TECHNICAL SPECIFICATIONS](#)
- [5 INTRODUCTION](#)
- [6 PARTS CHECKLIST](#)
- [7 ASSEMBLY AND STARTUP](#)
- [8 Filling the Filter Media Basket](#)
- [9 STARTING THE FILTER](#)
- [10 MAINTENANCE](#)
- [11 CUSTOMER SERVICE](#)
- [12 FAQ](#)
- [13 Documents / Resources](#)
 - [13.1 References](#)



SICCE Tidal 55 Power Filters

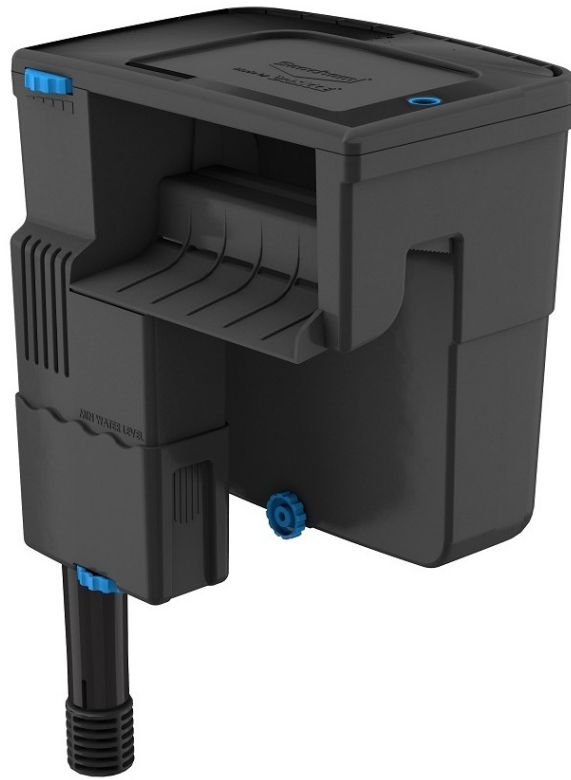

Product Information

Specifications

- **Brand:** Tidal
- **Models:** 55, 75, 110
- **Manufacturer:** Seachem Laboratories, Inc.
- **Address:** 1000 Seachem Drive, Madison, GA 30052 USA

Product Usage Instructions

Maintenance

Before any maintenance on the Tidal™ Filter, make sure to unplug it from the outlet.

Follow these steps for maintenance:

1. Carefully remove and clean the filter media.
2. Check the surface skimmer and clean it if necessary.
3. Replace any worn-out parts as needed.

Filter Replacement

1. Adjust the filter to the desired water level.
2. Replace the filter media with a suitable replacement.
3. Ensure proper alignment and secure fit of the new filter media.

Pump Maintenance

1. Regularly clean the pump and remove any debris or blockages.
2. Check for any signs of wear and tear on the pump components.
3. Replace the pump if necessary with a compatible replacement.

IMPORTANT SAFETY INSTRUCTIONS

WARNING – To guard against injury, basic safety precautions should be observed, including the following:

- **a) READ AND FOLLOW ALL SAFETY INSTRUCTIONS**

b) DANGER: To avoid possible electric shock, special care should be taken since water is employed in the use of aquarium equipment. For each of the following situations, do not attempt repairs by yourself; return the appliance to an authorized service facility for service or discard the appliance:

1. If the appliance falls into the water, DON'T reach for it! First, unplug it and then retrieve it. If electrical components of the appliance get wet, unplug the appliance immediately. (Non-immersible equipment only)
2. If the appliance shows any sign of abnormal water leakage, immediately unplug it from the power source. (Immersible equipment only)
3. Carefully examine the appliance after installation. It should not be plugged in if there is water on parts not intended to be wet.
4. Do not operate any appliance if it has a damaged cord or plug, or if it is malfunctioning or has been dropped or damaged in any manner.
5. To avoid the possibility of the appliance plug or receptacle getting wet, position the aquarium stand and tank or the fountain to one side of a wall-mounted receptacle to prevent water from dripping onto the receptacle or plug. A "drip-loop" shown in the figure below should be arranged by the user for each cord connecting an aquarium appliance to a receptacle. The "drip-loop" is the part of the cord below the level of the

receptacle or the connector if an extension cord is used, to prevent water from traveling along the cord and coming in contact with the receptacle. If the plug or receptacle does get wet, DON'T unplug the cord. Disconnect the fuse or circuit breaker that supplies power to the appliance. Then unplug and examine for the presence of water in the receptacle.

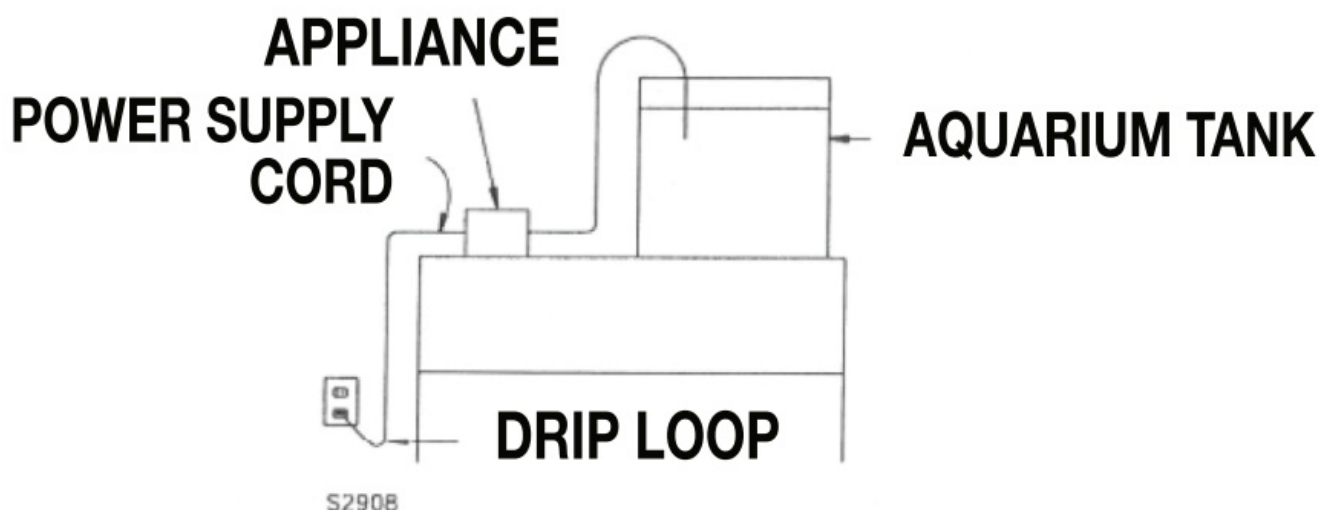

- **c)** Close supervision is necessary when any appliance is used by or near children.
- **d)** To avoid injury, do not contact moving parts or hot parts such as heaters, reflectors, lamp bulbs, and the like.
- **e)** Always unplug an appliance from an outlet when not in use, before putting on or taking off parts, and before cleaning. Never pull the cord to pull the plug from the outlet. Grasp the plug and pull to disconnect.
- **f)** Do not use an appliance for anything other than its intended use. The use of attachments not recommended or sold by the appliance manufacturer may cause an unsafe condition.
- **g)** Do not install or store the appliances where they will be exposed to the weather or to temperatures below freezing.
- **h)** Make sure an appliance mounted on a tank is securely installed before operating it.
- **i)** Read and observe all the important notices of the appliance.
- **j)** If an extension cord is necessary, a cord with a proper rating should be used. A cord rated for fewer amperes or watts than the appliance rating may overheat. Care should be taken to arrange the cord so that it will not be tripped over or pulled
- **K)** This appliance has a polarized plug (one blade is wider than the other). As a

safety feature, this plug will fit in a polarized outlet only one way. If the plug does not fit fully in the outlet, reverse the plug. If it still does not fit, contact a qualified electrician. Never use with an extension cord unless the plug can be fully inserted. Do not attempt to defeat this safety feature.

EXCEPTION: This instruction may be omitted for an appliance that is not provided with a polarized attachment plug.

SAVE THESE INSTRUCTIONS

TIDAL FILTERS are made in conformity with the national and international security laws.

READ AND FOLLOW ALL SAFETY INSTRUCTIONS

1. Check that the current on the pump's label matches the outlet current. The pump has a differential switch (protector) through which the nominal current must be lower than or equal to 30 mA.
2. Never operate the pump without water to avoid damage to the pump motor.
3. Before plugging in the pump, check that the cord and pump are not damaged.
4. The pump has a type Z cable link. The cable and plug cannot be substituted or repaired. In case of damage, replace the entire pump
5. **CAUTION:** Disconnect all submerged electrical products before doing maintenance in the water. In case the plug or electrical outlet is damaged, switch off the circuit breaker before disconnecting the plug from the outlet.
6. The filter can be run in liquids or in any environment with a maximum temperature of 35°C/95 °C F.
7. Do not use the filter for purposes (i.e., in bathroom or similar applications) other than for which it was designed.
8. Avoid filter use with corrosive or abrasive liquids.
9. The filter has not been designed for use by children or mentally challenged individuals. Appropriate adult supervision or persons responsible for personal safety are required.
10. Do not disconnect the filter from an electrical outlet by pulling the cord.
11. The filter can only be used in the above-mentioned applications and is only for indoor use.
12. This appliance has no user-serviceable parts.

INSTRUCTIONS FOR THE CORRECT DISPOSAL OF THE PRODUCT ACCORDING TO EU DIRECTIVE 2002/96/EC

- When used or broken, this product does not have to be disposed of with other waste. It can be delivered to specific electrical waste collection centers or to dealers who provide this service.
- Disposal of electrical products separately avoids negative consequences for the environment and for overall public health and allows the reuse of materials, providing savings of energy and resources.

TECHNICAL SPECIFICATIONS

	Tidal 55		Tidal 75		Tidal 110	
Aquarium Size	Up to 55 US Gal	Up to 200 Liters	Up to 75 US Gal	Up to 300 Liters	Up to 110 US Gal	Up to 400 Liters
Flow Rate	250 US GPH	1000 L/H	350 US GPH	1500 L/H	450 US GPH	2000 L/H
Watts	6	5	8	7	12	10
	(120 v – 60Hz)	(230 v – 50Hz)	(120 v – 60Hz)	(230 v – 50Hz)	(120 v – 60Hz)	(230 v – 50Hz)
Filter Volume	0.32 US Gal	1.2 Liters	0.50 US Gal	1.9 Liters	0.85 US Gal	3.2 Liters

INTRODUCTION

Congratulations on the purchase of your new Seachem Tidal™ hang on power filter. You can be completely confident that you have invested in a well-engineered premium filter that will keep your aquarium clean and healthy with minimal maintenance for years to come. The Seachem Tidal™ range of filters has been designed and made specifically for Seachem by Sicce in Italy to ensure the highest quality and top performance possible.

Features:

1. Low wattage to high flow ratio allows for power savings with excellent circulation
2. Silent operation for even the quietest home or office environment
3. Self-priming pump allows for a reliable, easy start-up
4. Low maintenance for ease of long-term aquarium care
5. Self-cleaning impeller reduces the need for pump maintenance
6. Non-corrosive parts allow for use in freshwater or saltwater aquariums
7. An exceptionally high-capacity filter basket allows for the use of virtually any filter media
8. Included Seachem Matrix™ bio-media completely removes ammonia, nitrite, and nitrate
9. Removable filter basket allows for easy remote cleaning
10. The filter cover doubles as a secure tray for the filter basket to avoid spilling while remote cleaning
11. Ventilation slots allow even airflow and enhanced gas exchange
12. Compressed profile reduces interference with aquarium placement
13. The leveling dial allows for exact positioning on the aquarium wall
14. Surface skimming pulls floating organics and scum from the aquarium surface
15. Adjustable flow rate allows for versatile use in a range of aquarium environments
16. Adjustable intake from surface vs. depth allows for focus on a specific filtered area
17. Telescoping intake allows for intake at any depth
18. The heater holder clip allows for secure and even heat dispersion through the filter's flow
19. Return flow wall offers aeration slots to increase redox and aeration of the aquarium
20. The maintenance monitor shows when the filter basket needs cleaning
 - Simply put, you have purchased the best hang-on filter available. Thank you.

PARTS CHECKLIST

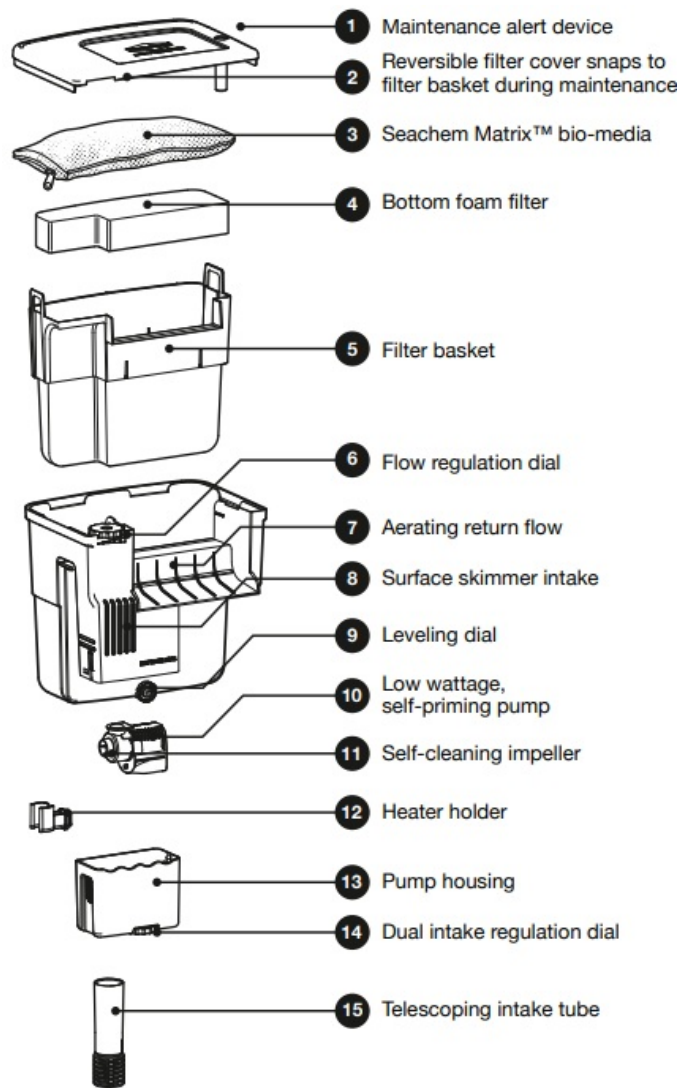

ASSEMBLY AND STARTUP

- Insert the bottom half of the telescoping intake tube into the top half (1). Then, insert the telescoping intake tube in place on the pump case (2). (Figure 1)

Figure 1

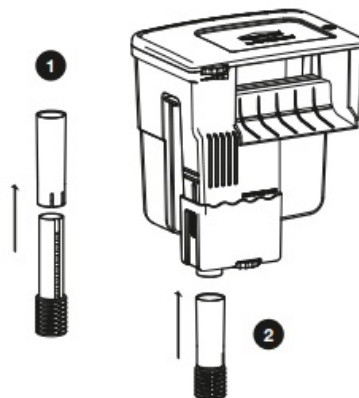

- If you wish to hang a heater on the filter (Figure 2), press the sides of the filter (1), pull down to remove the pump housing (2), and slide in the heater holder to the bottom of the filter housing (3).
- The heater holder can be inserted to face up or down, depending on the desired

position of the heater. Insert the pump's cable into the guides (4) before re-placing the pump's housing (5).

Figure 2

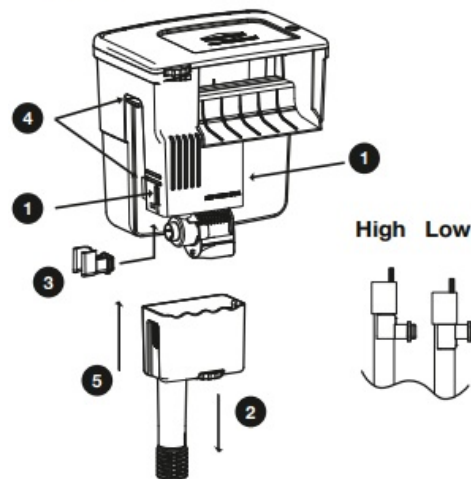

- Screw the filter leveling dial into the bottom of the filter housing to prepare to hang and level the filter.
- Place the filter on the aquarium edge (Figure 4-A) and adjust the leveling dial by screwing or unscrewing it until the filter is level with the aquarium.
- Insert the pump cord into the guides as shown (Figure 4-B) and run the cord to the outlet, making certain to form a drip loop as shown in the Safety Instructions and in Figure 4-B.

Figure 4-A

Figure 4-B

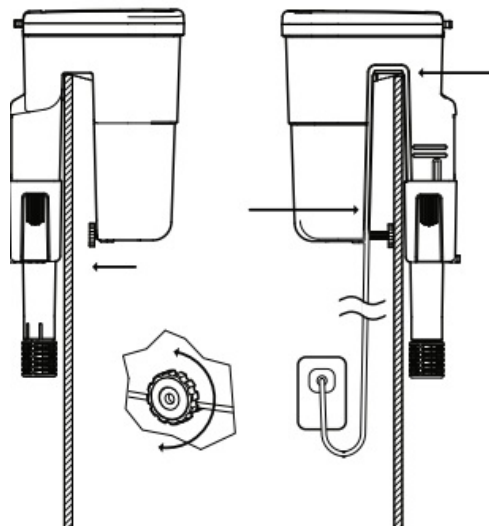

Filling the Filter Media Basket

- Remove all plastic bags containing filtration media before starting the filter. All TidalT™ Filters have been designed to hold any type of filter media.
- In general, there are three types of filtration used in most aquaria – mechanical, chemical, and biological.

- Mechanical filtration includes media that capture waste for removal directly from the filter.
- Chemical filtration includes filtration media, which work to chemically remove dissolved compounds from the water. Biological filtration provides a housing for bacteria to grow and break down organic waste.
- All Tidal™ Filters include a bottom foam filter for mechanical filtration and Matrixim bio media for exceptional biological filtration.
- There are a variety of chemical filtration options available for many differing purposes, given a variety of aquarium environments.
- Seachem MatrixCarbon™ is a preferred option in almost any aquarium setup. MatrixCarbon™ is available pre-bagged for any size Tidal™ Filter.
- Thoroughly rinse the foam filter and all filter media under running water before placing them in the filter basket. Layer the media with the foam filter on the bottom, then any chemical filtration media such as MatrixCarbon™, and lastly the Matrix™ biological media. Do not remove Matrixim from its mesh bag.
- The bag is packaged folded over; lay the mesh bag lengthwise and distribute Matrix™ evenly before placing it in the filter basket.
- To more quickly seed Matrix™ with bacteria, we recommend the addition of Seachem Stability™ to your aquarium. The internal basket prevents water bypass and allows for quick removal and cleaning of the foam filter and any media used.
- To avoid interfering with proper flow through the filter, do not overfill the filter media basket. An indication of this will be activation of the maintenance alert or dripping from the right side of the return flow wall (see Figure 10).

Figure 5: Layering Filtration Media (bottom to top)



STARTING THE FILTER

- After assembly and installation of the Tidal™ Filter on a filled aquarium, connect the power cord to the intended outlet.
- The filter is self-priming and will immediately begin filtering water. Adjust the three possible settings according to preferences or needs (**Figure 6**):
 1. Raise or lower the telescoping intake to the desired depth in the aquarium.

2. Adjust the total amount of flow through the filter. Adjust performance to a specific aquarium volume, type, or provide an environment for fish that prefer more or less water movement or oxygenation. This feature offers up to 80% reduction of maximum flow intake while making continuous full use of the filter motor. When reduced intake flows are selected, the refiltration grid allows for water to re-circulate through the filter media to maximize filtration performance through increased contact time
 3. Adjust the amount of flow intake from the surface vs. the telescoping intake.
- The minimum water level in the aquarium should not fall below the “Minimum Water Level” mark. A lower level might stop the flow of water and cause damage to the pump – do not allow the pump to run dry.
 - There is no maximum water level, although it is recommended that the level not exceed the height of the surface skimmer slots.

Figure 6

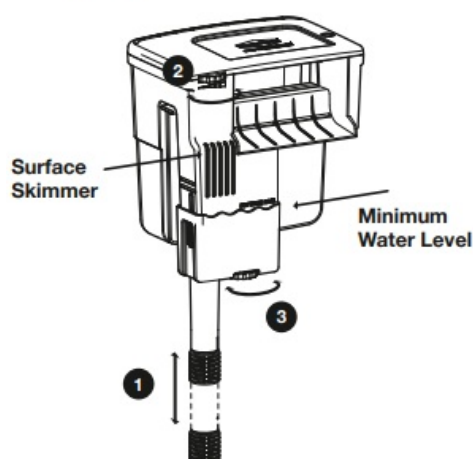

MAINTENANCE

WARNING: Before any maintenance on the Tidal™ Filter, unplug it from the outlet.

- Tidal™ Filters are made to offer excellent function with low maintenance. However, regular maintenance can dramatically aid in the overall health and well-being of your aquarium.
- The maintenance alert device offers an excellent signal to perform routine maintenance on the Tidal™ Filter.
- The maintenance alert device indicates that the flow is unable to move freely through the filter media basket. When the maintenance alert rises above the filter cover to about ½” or 1 cm (Figure 7), it is time to clean the filter.

- To begin cleaning the filter, (see Figure 8) lift the cover (1), slide the blue filter basket lock 2) to the front of the filter, and remove the filter media basket by pulling up on the two side handles (3).

Figure 7

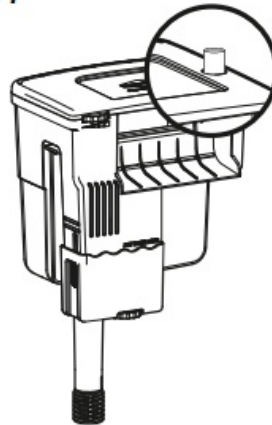

Figure 8



- Turn the cover over (Figure 9-A) and set the filter media basket into the slots on the cover (1). You can now carry the filter media basket to a cleaning area without spilling or dripping water.
- Remove the bag of Matrix™ biological media, any chemical filtration media, and the foam filter (Figure 9-B).
- Rinse the foam filter thoroughly. Do not use any soaps or detergents, as these can harm aquarium inhabitants. Rinse or replace any chemical filtration media as necessary.
- Replacement filtration packs designed specifically for Tidal™ Filter units (Matrix™, MatrixCarbon™, and Zeolite) are sold separately.
- The bag of Matrix™ biological media contains important bacteria for the stability of the

aquarium environment. Do not allow the media to dry out. The media can be rinsed gently in a container with some of the water from the aquarium to remove any slime coating that may build up on the media over time. If the Matrix™ media is replaced, it is advisable to replace no more than half of the media at any time so as to protect the bacteria culture that allows for a stable aquarium environment.

- At this time, we would suggest re-seeding the aquarium with Seachem Stability™. Rinse the filter media basket. Reassemble media and all components in reverse order.

Figure 9-A

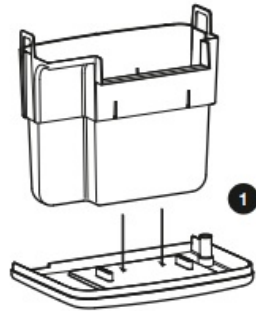
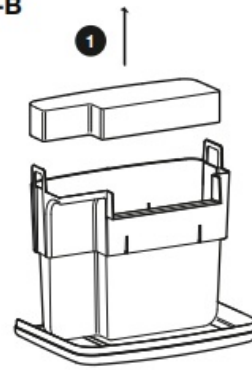
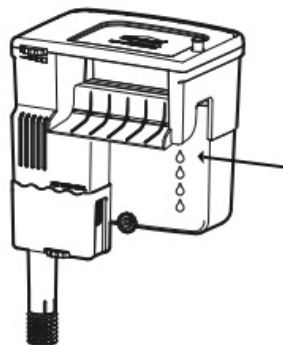

Figure 9-B



- If the filter starts to drip from the right side (Figure 10) of the return flow wall, it indicates that the filter media basket is completely clogged.
- Water in this case is bypassing the filter media, and a thorough cleaning is necessary to maintain the overall health of the aquarium.

Figure 10



- To service the pump, proceed as follows (Figure 11): Press the side of the filter (1), pull down on the pump housing (2), pull the power cord from the filter body, and push the pump to the right until it clicks and releases (3).
- For Tidal 55 units, gently pull the intake cover of the pump (4, Figure 11-B) away. This will reveal the impeller (5).

Figure 11-A

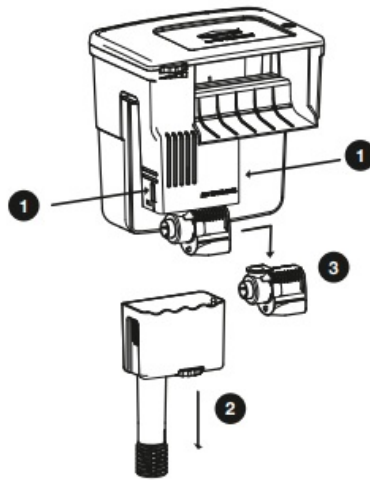
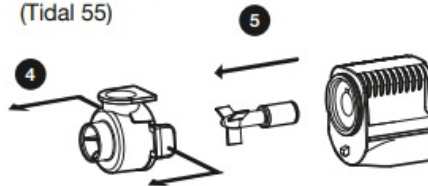
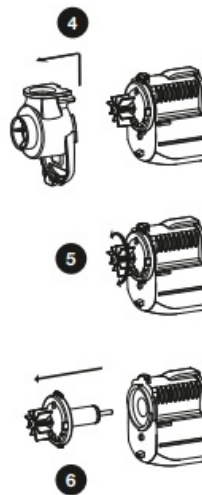

Figure 11-B
(Tidal 55)



- For Tidal 75 and 110 units, pull up and back on the top clip of the impeller cover (4, Figure 11-C). Twist the base of the impeller counter-clockwise to unlock it (5), and then pull it free of its housing (6).

Figure 11-C
(Tidal 75 & 110)



- Wash the impeller thoroughly to remove any slime or scales built up. Do not use soap or detergent. If desired, a dilute solution of vinegar and water can be used to break up any scale or lime buildup.
- After cleaning, replace the impeller, ensuring that it rotates freely around the shaft, and replace the intake cover of the pump. Reassemble remaining components in the reverse order.
- Scale and limestone deposits, and the natural wear-out of components, might cause the silent nature of the pump to diminish.

- However, they do not affect the proper function of the filter. In such a case, it is advisable to replace the impeller to return to silent operation.

CUSTOMER SERVICE

- **Seachem Laboratories, Inc.**
- **Made in Italy by**
- **1000 Seachem Drive**
- **Sicce S.r.l.**
- **Madison, GA 30650, USA**
- **Via V. Emanuele, 115 – 36050 Pozzoleone (VI) – Italy**
- **888-SEACHEM**
- www.seachem.com
- **+390444462826**
- www.sicce.com

FAQ

How often should I clean the filter media?

It is recommended to clean the filter media every month or as needed based on water conditions.

Can I use third-party filter media replacements?

It is advisable to use compatible filter media replacements recommended by the manufacturer to ensure optimal performance.

What should I do if the pump is making unusual noises?

If the pump is making unusual noises, immediately unplug it and inspect for any obstructions or mechanical issues. Contact customer support if problems persist.

Documents / Resources

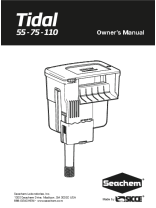
	SICCE Tidal 55 Power Filters [pdf] Owner's Manual 55, 75, 110, Tidal 55 Power Filters, Tidal 55, Power Filters, Filters
---	--

References

- [User Manual](#)

110, 55, 75, Filters, Power Filters, SICCE, Tidal 55, Tidal 55 Power

SICCE Filters

Leave a comment

Your email address will not be published. Required fields are marked *

Comment *

Name

Email

Website

☐ Save my name, email, and website in this browser for the next time I comment.

[Post Comment](#)

Search:

[Search](#)

[Manuals+](#) | [Upload](#) | [Deep Search](#) | [Privacy Policy](#) | [@manuals.plus](#) | [YouTube](#)

This website is an independent publication and is neither affiliated with nor endorsed by any of the trademark owners. The "Bluetooth®" word mark and logos are registered trademarks owned by Bluetooth SIG, Inc. The "Wi-Fi®" word mark and logos are registered trademarks owned by the Wi-Fi Alliance. Any use of these marks on this website does not imply any affiliation with or endorsement.