



SICCE Shark Pro Internal Filter Instruction Manual

[Home](#) » [SICCE](#) » SICCE Shark Pro Internal Filter Instruction Manual 



SHARK PRO INTERNAL FILTER



INSTRUCTION MANUAL

Shark PRO

Contents

- 1 Shark Pro Internal Filter
- 2 TECHNICAL PERFORMANCES & RANGE
- 3 IMPORTANT SAFETY INSTRUCTIONS
- 4 SPARE PARTS
- 5 GENERAL SAFETY INSTRUCTION
- 6 FILTER MEDIA INCLUDED
- 7 MAIN FEATURES
- 8 MAINTENANCE
- 9 FILTER MEDIA REPLACEMENTS
SYSTEM
- 10 WARRANTY
- 11 Documents / Resources
 - 11.1 References
- 12 Related Posts





Shark Pro Internal Filter

SEAL AND SIGNATURE OF RESALE DEALER
DATE OF PURCHASE

____ / ____ / ____
day month year

TECHNICAL PERFORMANCES & RANGE

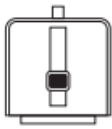

SHARK PRO		500	700	900
 Aquarium capacity	220 – 240 V 50 Hz	40 – 140 L	120 – 200 L	180 – 260 L
	110 – 120 V 60 Hz	11-37 US gal	32-53 US gal	48-70 US gal
 Filter volume	220 – 240 V 50 Hz	310 cm ³	620 cm ³	930 cm ³
	110 – 120 V 60 Hz	19 cubic in.	38 cubic in.	57 cubic in.
 FOAM filtration surface	220 – 240 V 50 Hz	100 cm ²	200 cm ²	300 cm ²
	110 – 120 V 60 Hz	16 square in.	32 square in.	48 square in.
 Watt	220 – 240 V 50 Hz	4	7	10
	110 – 120 V 60 Hz	4	7	10
 Pump output	220 – 240 V 50 Hz	500 l/h	700 l/h	900 l/h
	110 – 120 V 60 Hz	140 US gph	190 US gph	240 US gph
Cable length		2,2 m / 7.5 ft		

IMPORTANT SAFETY INSTRUCTIONS

WARNING – To guard against injury, basic safety precautions should be observed, including the following.

READ AND FOLLOW

ALL SAFETY INSTRUCTIONS

WARNING: To avoid possible electric shock, special care should be taken since water is employed in the use of aquarium equipment. For each of the following situations, do not attempt repairs by yourself. Return the appliance to an authorized service facility for service or discard the appliance.

1. **CAUTION:** If the appliance shows any sign of abnormal water leakage, immediately unplug it from the power source.
2. Carefully examine the appliance after installation. It should not be plugged in if there is water on parts not intended to be wet.
3. Do not operate any appliance if it has a damaged cord or plug, or if it doesn't work properly or has been dropped or damaged in any manner.
4. To avoid the possibility of the appliance plug or receptacle getting wet, position aquarium stand and tank or the fountain to one side of a wall-mounted receptacle to prevent water from dripping onto the receptacle or plug. A "drip-loop" (fig. 1) should be arranged by the user for each cord connecting an aquarium appliance to a receptacle. The "drip-loop" is the part of the cord below the level of the receptacle or the connector if an extension cord is used, which prevents water travelling along the cord and coming in contact with the receptacle.

If the plug or socket does get wet, DON'T unplug the cord. Disconnect the fuse or circuit breaker that supplies power to appliance. Then unplug and examine for presence of water in the receptacle.

5. Close supervision is necessary when any appliance is used by near children.
6. To avoid injury, do not contact moving parts or hot parts such as heaters, reflectors, lamp bulbs and similar.
7. Always unplug an appliance from an outlet when not in use, before putting on or taking off parts and before cleaning. Never yank cord to pull plug from outlet.
Grasp the plug and pull to disconnect.
8. Do not use an appliance for other than intended use. The use of attachments, not recommended or sold by the manufacturer of the appliance, may cause an unsafe condition.
9. Do not install or store the appliances where it will be exposed to the weather or to temperatures below freezing.
10. Make sure an appliance mounted on a tank is securely installed before operating it.
11. Read and observe all the important notices of the appliance.
12. If an extension cord is necessary, a cord with a proper rating should be used. A cord rated for less amperes or watts than the appliance rating may overheat. Care should be taken to arrange the cord so that it will not be tripped over or pulled.
13. This appliance has a polarized plug (one blade is wider than other). As a safety feature, this plug will fit in a polarized outlet only one way. If the plug does not fit fully in the outlet, reverse the plug. If it still does not fit, contact a qualified electrician.
Never use with an extension cord unless plug can be fully inserted. Do no attempt to defeat this safety feature.

WARNING: To reduce the risk of electric shock, use only on portable self-contained fountains no larger than 5 feet in any dimension.

CAUTION: The appliance is to be connected to a circuit that is protected by a Ground Fault Circuit Interrupter.

SAVE THESE INSTRUCTIONS

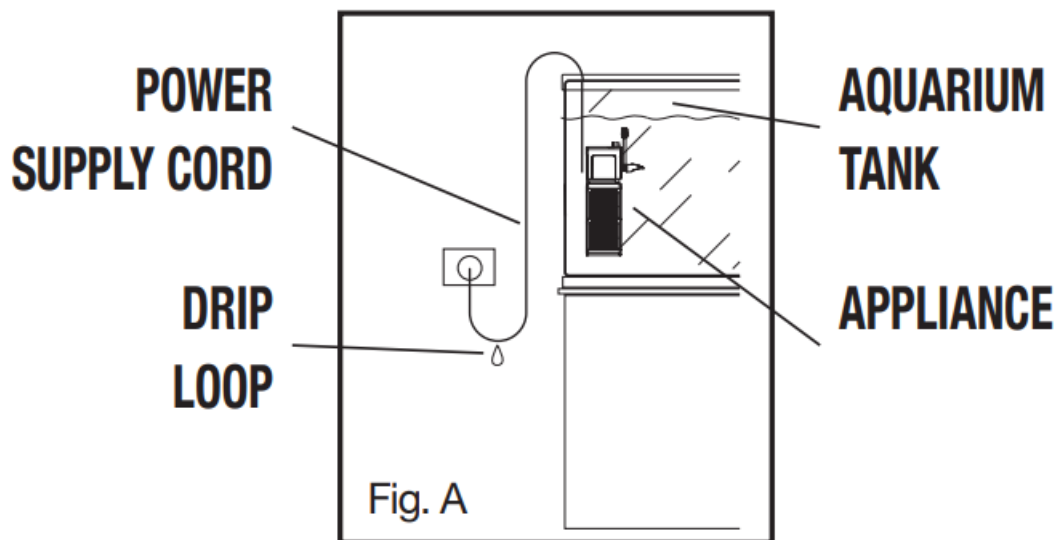

Before doing any maintenance in the water unplug the power plug

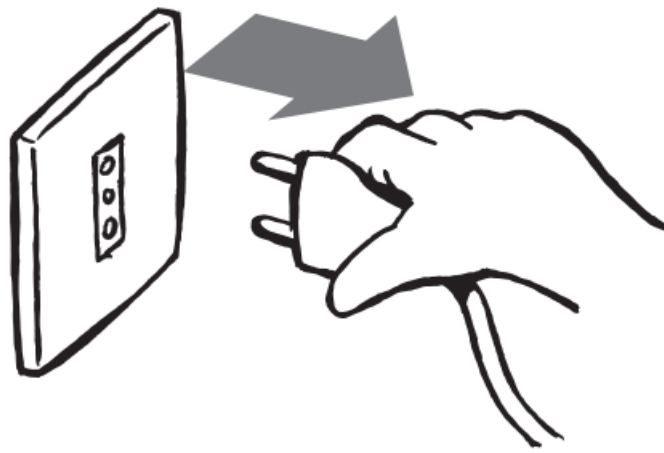

SPARE PARTS

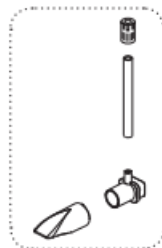

STR0044

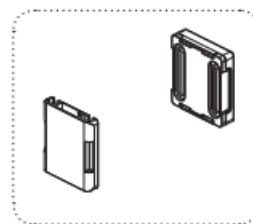

SPL0123



220-240 / 50hz

SGR0256 - 500

SGR0258 - 700

SGR0259 - 900

110-120 / 60hz

SGR0257

SGR0256

SGR0258

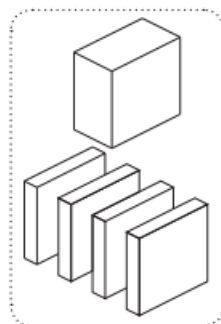

SSP0040

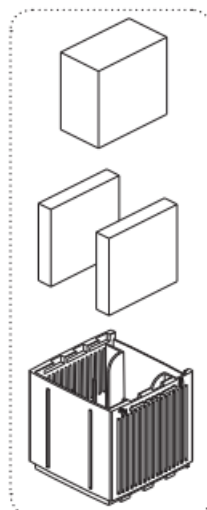

SKT0306

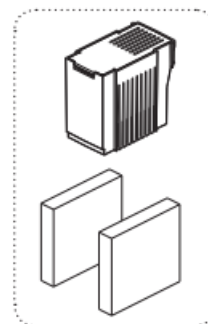

SVA0020 - Active Carbon

SVA0019 - Zerophos

SVA0018 - Biopearl

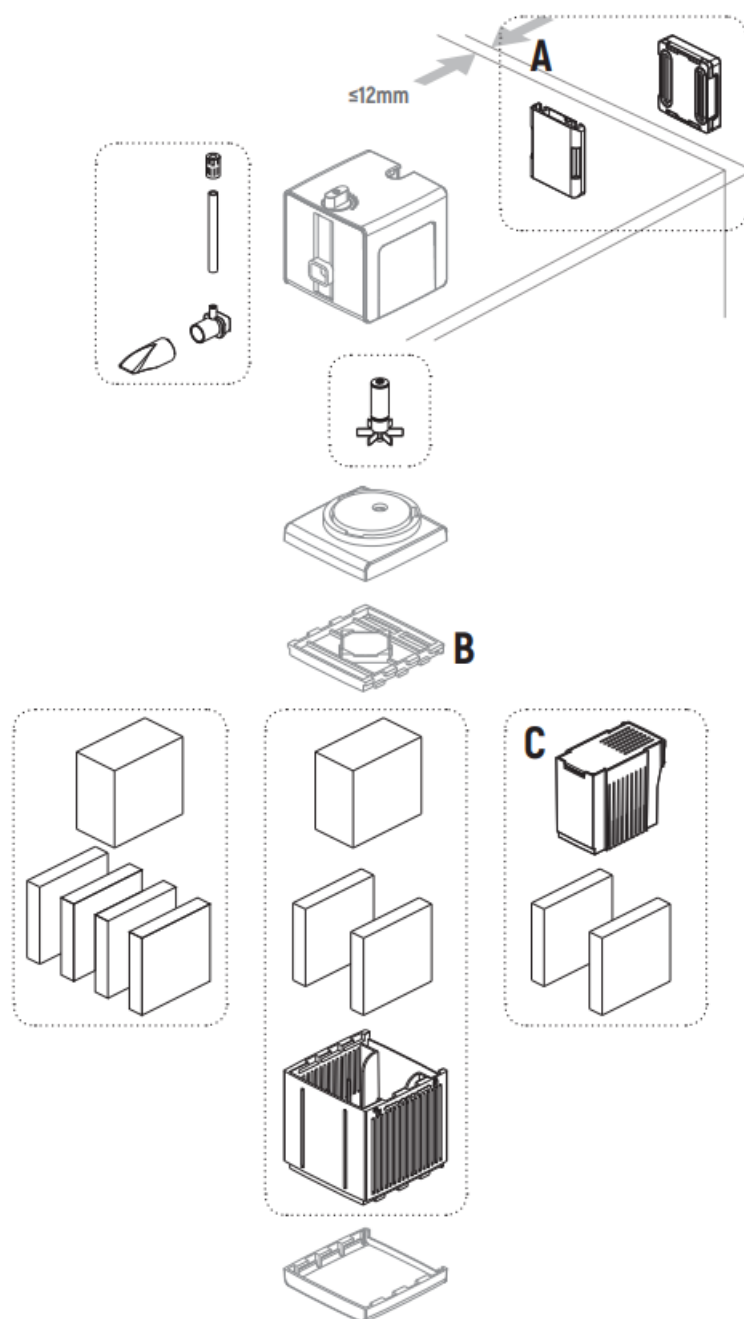

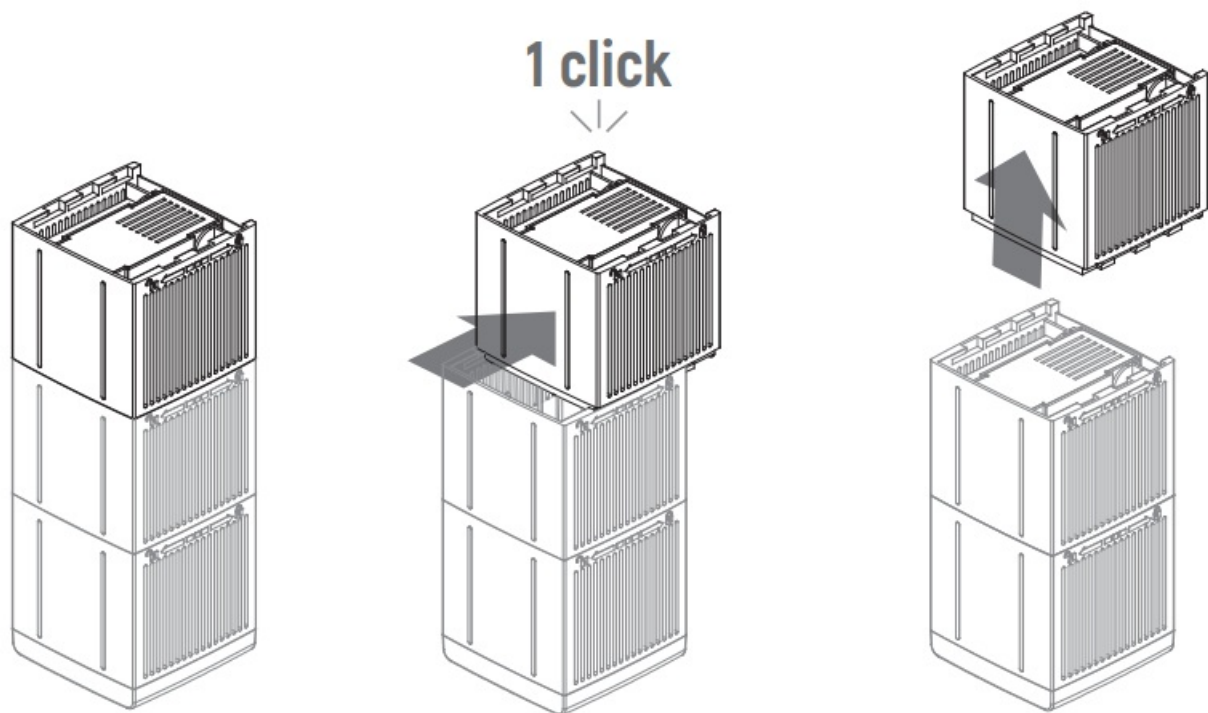

3

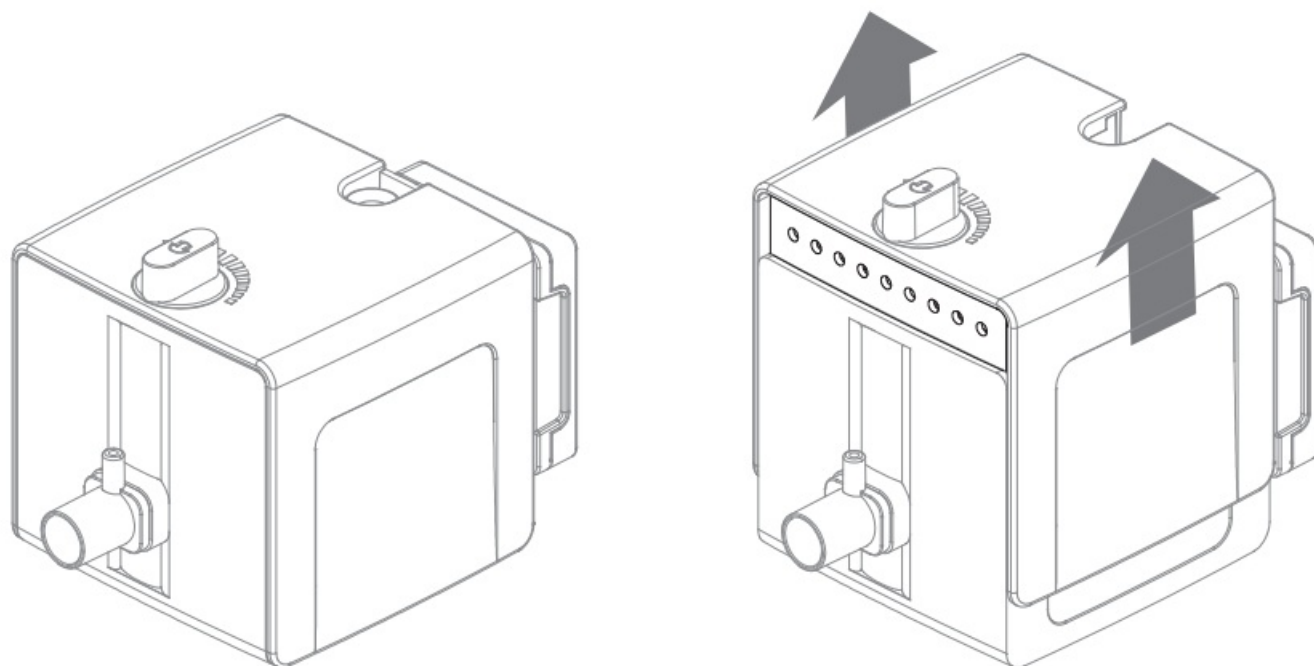

4

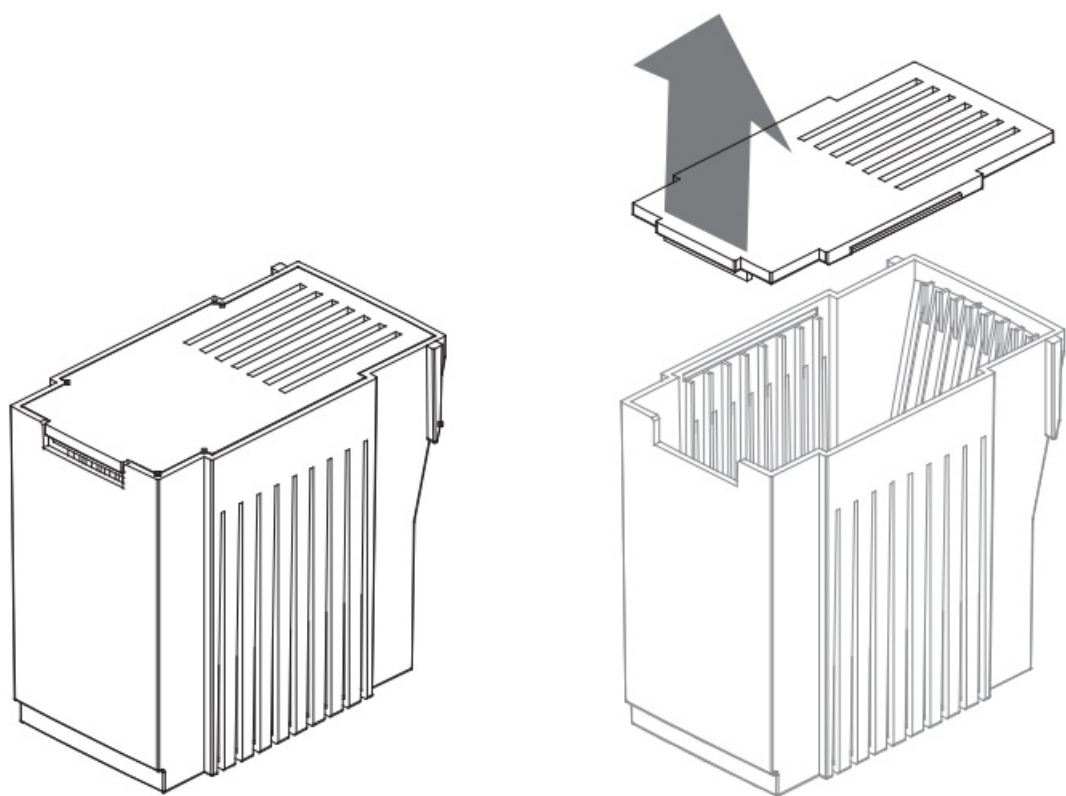

5

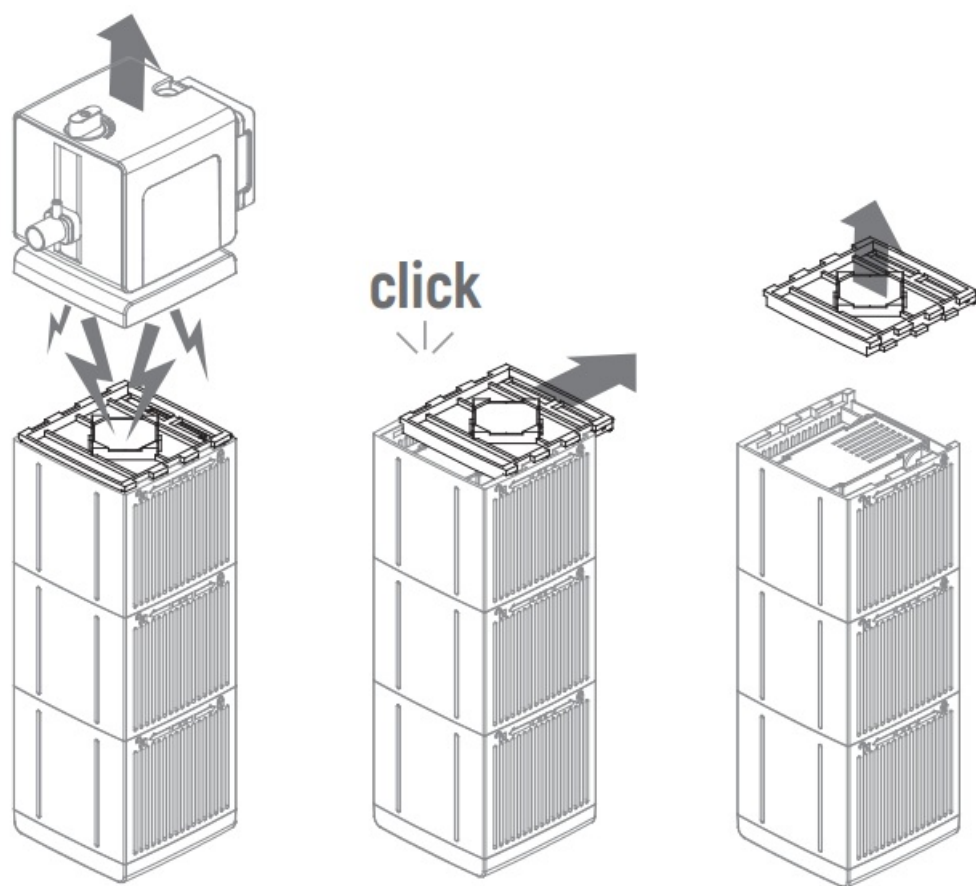

6

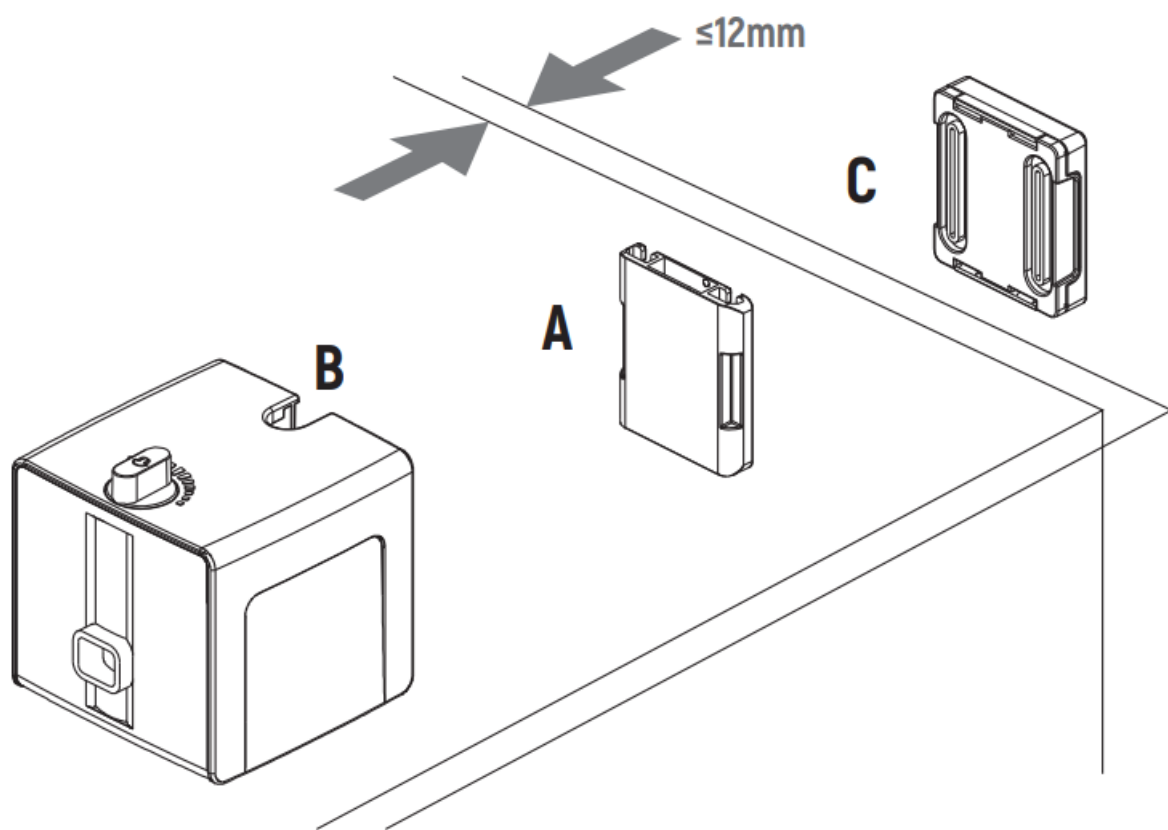

7

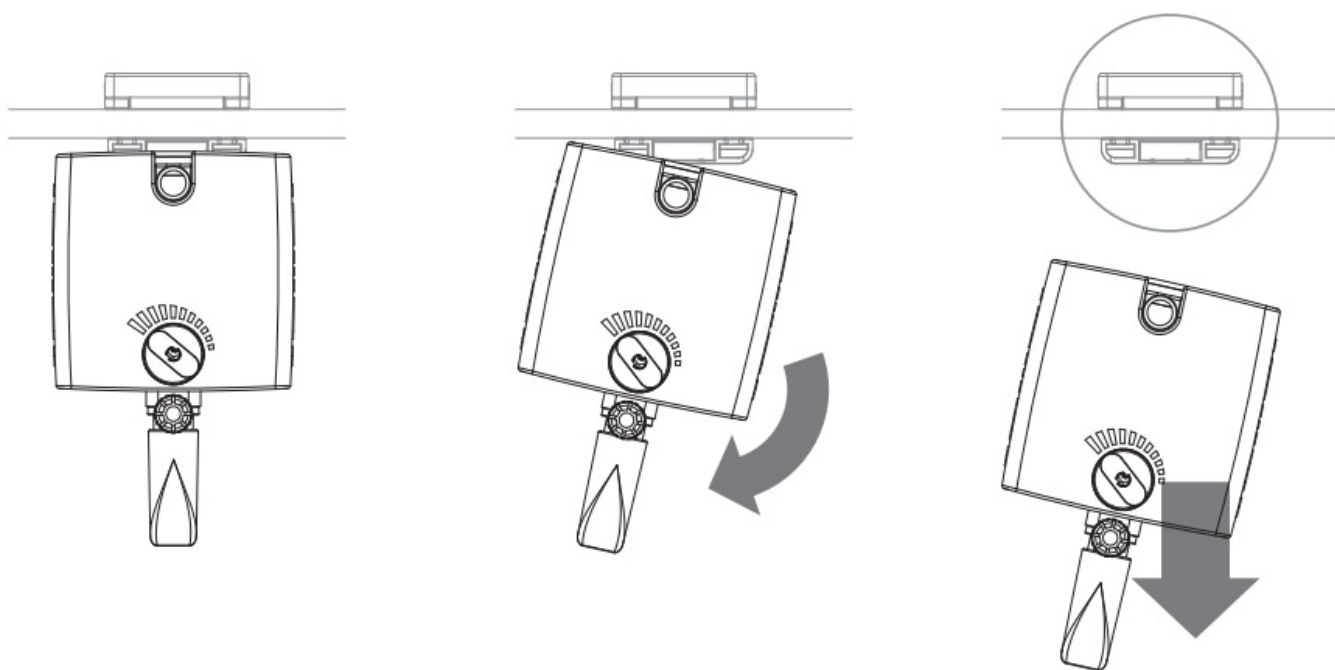

8

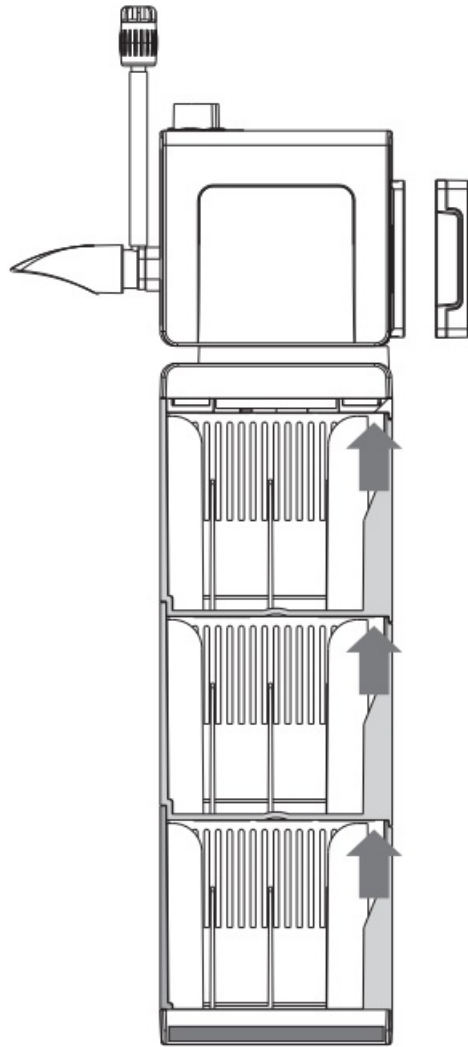

9

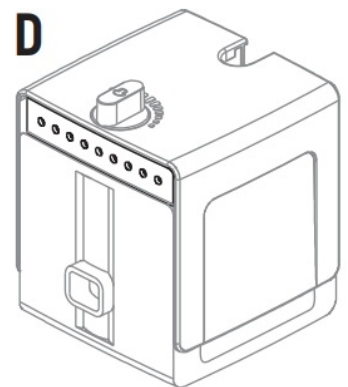
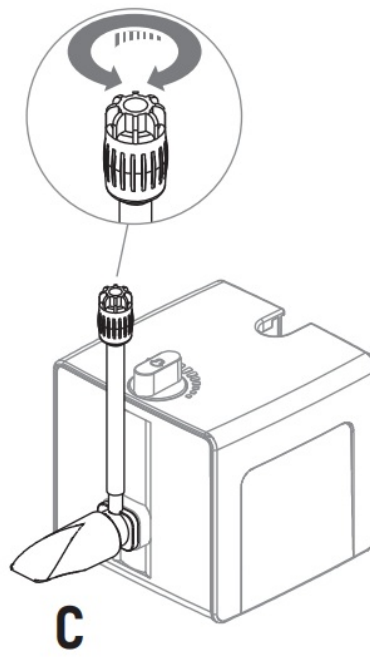
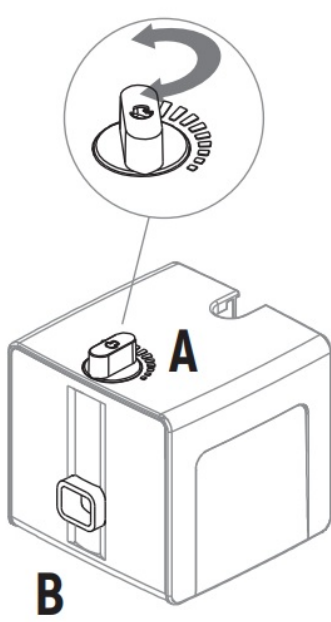

10

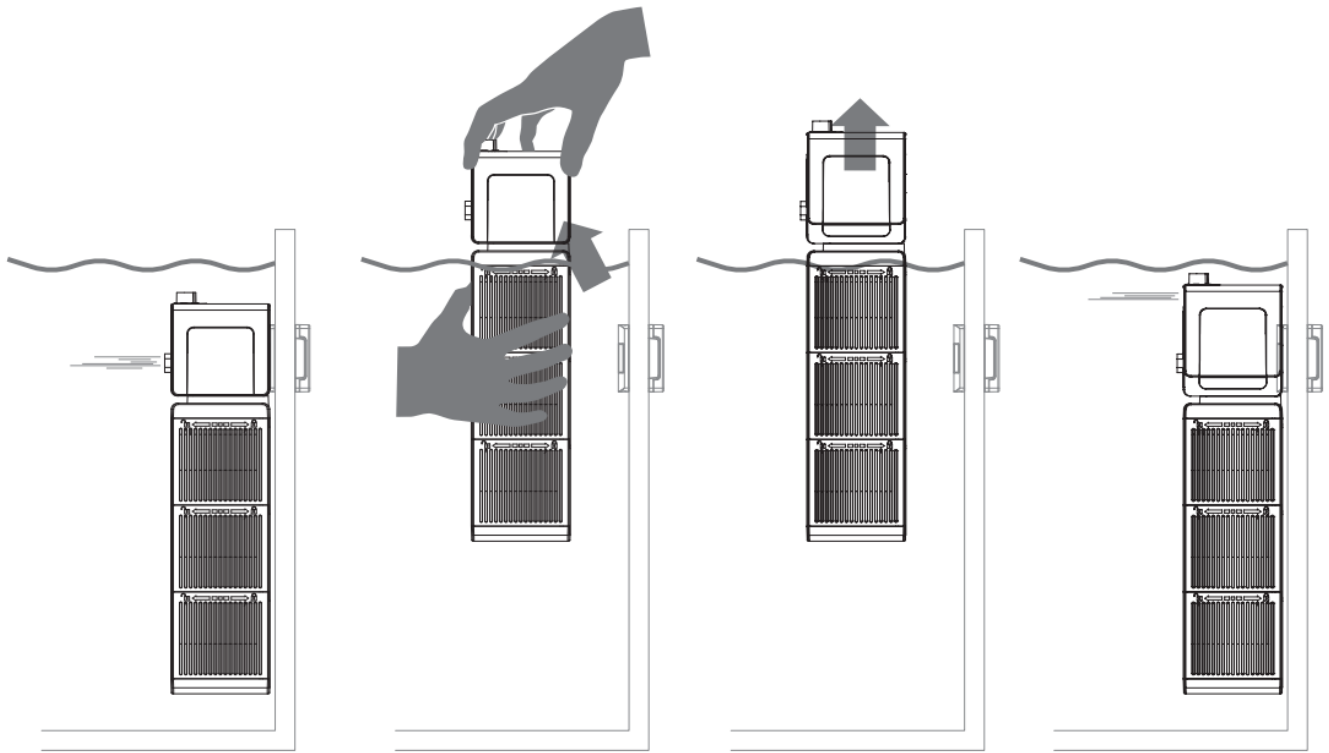

11



**Eco 100%
Biodegradable**

12

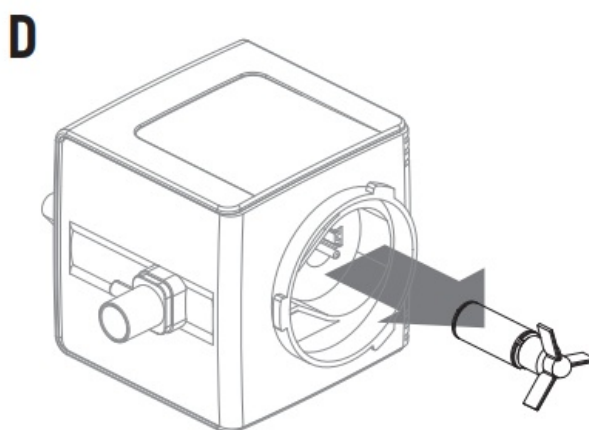
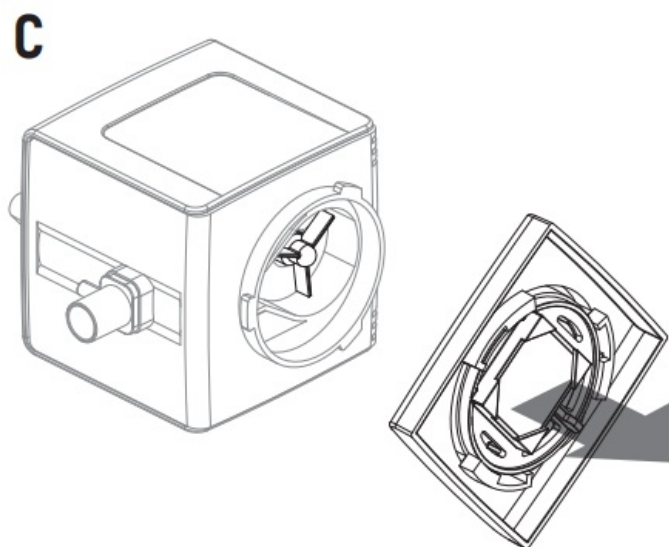
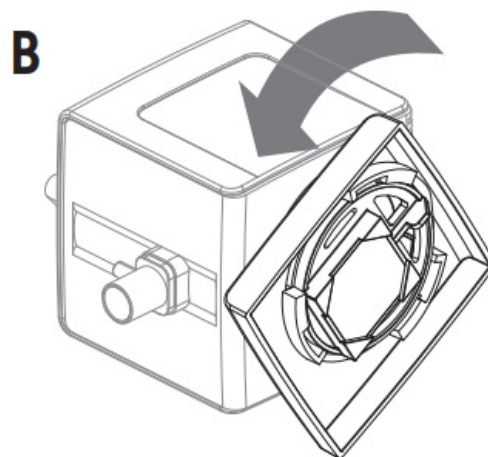
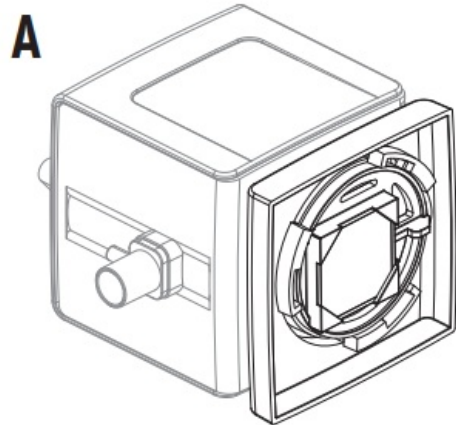

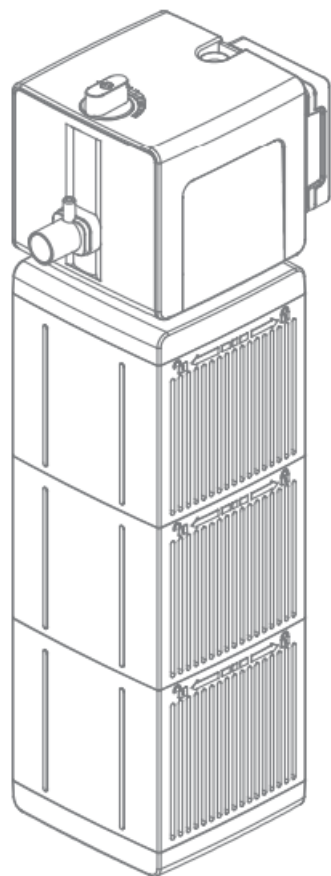

+1

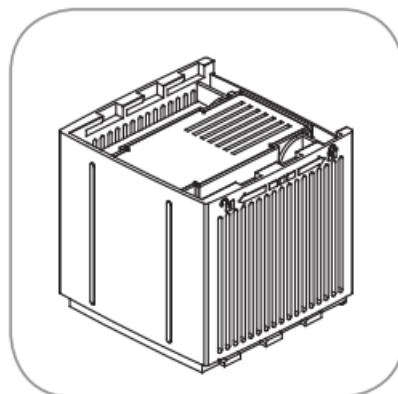

14

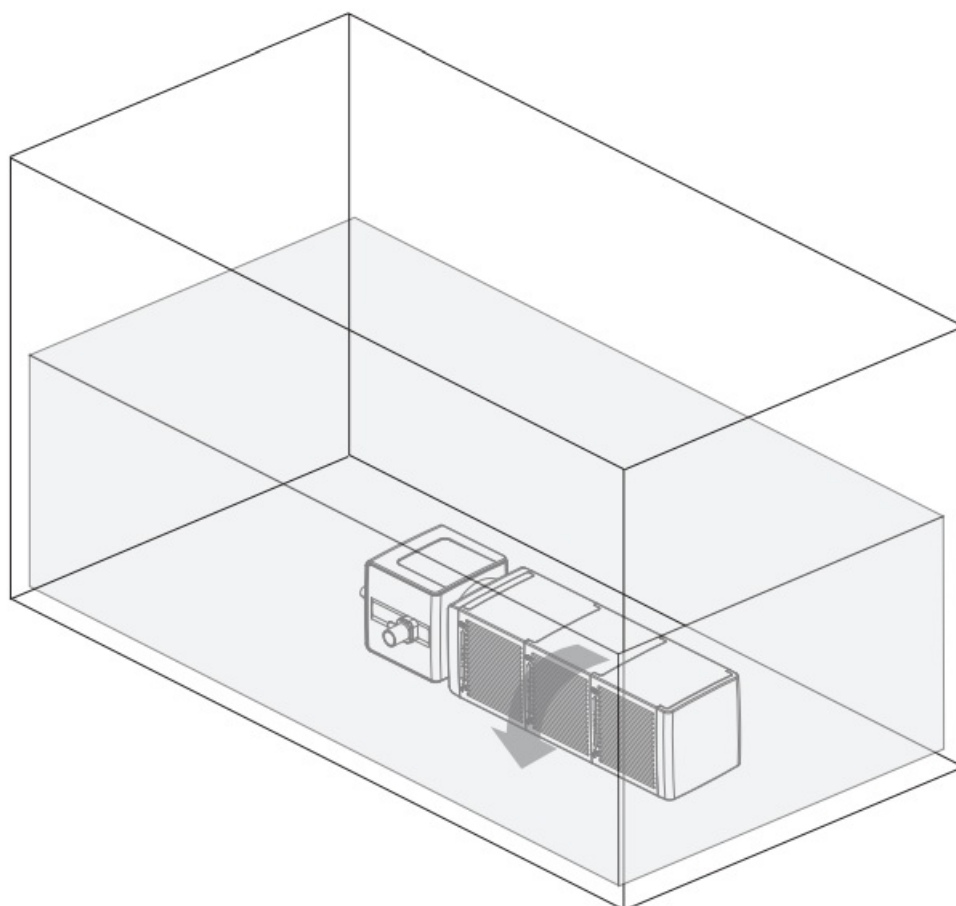

The NEW SHARK PRO internal filters are designed to reach in short time an efficient aquarium filtration and

crystal water using a versatile combination of mechanical ,biological and chemical media which are included. A large selection of other SICCE filter media are available to perform many of the advanced filter tasks needed for plants aquaria – aquascaping and special water treatments.

GENERAL SAFETY INSTRUCTION

SHARK PRO is made in conformity with the national and international security laws.

1. Check that the tension on the filter's label matches the network tension. The filter has to be supplied by a differential switch (protector), through which the nominal current is lower or equal to 30mA.
2. This filter can be used only submersed in water.
3. Before connecting the filter to the electric network, check that the cable and the filter are not damaged.
4. The filter has a type Z cable link. The cable and the plug cannot be substituted or repaired; in case of damages substitute the entire filter.
5. **CAUTION:** disconnect all the submersed electrical products before doing any maintenance in the water; in case the plug or the electric outlet are damaged, disconnect the general switch before disconnecting the electric supply cable.
6. The filter must not work without water to avoid damages to the motor.
7. The filter can be used in liquids or in environment with a temperature not higher than 35° C / 95° F.
8. Do not use the filter for uses different to those for which it has been designed as, i.e. in bathroom or similar applications.
9. Do not use the filter with corrosive and abrasive liquids.
10. Individuals with special needs and children should be supervised when using this product.
11. To prevent accidental drips from wetting the plug or the socket, make a loop with the cord under the socket level (Pic. A).
12. Avoid moving the filter by the cord during the installation or maintenance.
13. The filter can be used only in the above mentioned applications and it is only for internal use.

FILTER MEDIA INCLUDED

SHARK PRO 500 = 2 X 20ppi LATERAL Foams + 1 x 30ppi Foam- MECHANICAL FILTRATION

SHARK PRO 700 = 2 X 20ppi LATERAL Foams + 1 x 30ppi Foam- MECHANICAL

FILTRATION + 2 X 20ppi LATERAL Foams + 1 CARTRIDGE filled with BIOPEARL- BIOLOGICAL FILTRATION

SHARK PRO 900 = 2 X 20ppi LATERAL Foams + 1 x 30ppi Foam- MECHANICAL

FILTRATION +2 X 20ppi LATERAL Foams + 1 CARTRIDGE filled with BIOPEARL-

BIOLOGICAL FILTRATION + 2 X 20ppi LATERAL Foams + 1 CARTRIDGE filled with ZEROPHOS – CHEMICAL FILTRATION

The Inner cartridge can be refilled using Sicce Filter Media (recommended) or any other.

MAIN FEATURES

Components & Spare Parts

1. MAGNETIC HOLDER for glass thickness up to 12mm – 1/2" . (Pic.1A)
2. MAGNETIC CONNECTION from Filter head and Filter body for easy removal and cleaning operations. (Pic. 1B)
3. OPENING DRAWER of the filter modules. (Pic. 2)
4. 30% LARGER FILTER SURFACE fastening a crystal water process and a winning filtration system

5. SPRAYBAR with a discrete design which preserve the view of the aquarium improving constantly the oxygenation of the water. (Pic.3)
6. RECHARGEABLE cartridge with a large capacity to contain different filter media. (Pic.4)

Filter Assembling System (Pic.5)

Filter 's head Sicce Magnetic Connection System

Modular Filter Case The magnetic grid can be removed sliding it with only 1 click Magnetic Grid

How To Hang On The Filter To The Glass (Pic.6)

Fix component A into the square groove B which is on the back side of the filter's head. Then position component C to the glass and hang on the filter. The magnetic force will keep it steady.

TIPS: Once the filter has been positioned there is no need to remove the magnet mount A+C to remove the filter from the aquarium. You can simply remove SHARK PRO leaving the magnet mount fixed on the glass. (Pic.7)

Water Flow Modes (Pic.8-9)

Separate and individual entries on each module let the water flow system work in the most efficient way preventing clogging and allows the water to maintain consistent movement through the filter.

REGULATION ON THE TOP from Min to Max (Pic.9A) UNIDIRECTIONAL (Pic.9B)

DEFLECTOR WITH SILENCER – Oxygen enrichment (Pic.9C) SPRAYBAR (PIC.9D)

To avoid accidental water splash on the floor we recommend to unplug the filter before switching from Unidirectional mode to Spraybar mode. (Pic.10) To reach the best performance and oxygen enrichment, re-position the filter fully submersed. Excessive oxygenation could dispersed too much CO₂, which is helpful for healthy plants and to prevent the raise of PH.

SprayBar Holes

It is advisable to keep the holes always free from small filament or algae which could reduce the flow.

MAINTENANCE

Deep cleaning – use SICCE PUMPCLEAN (Pic.11)

It's important to keep your Sicce Filter in prime operating condition to ensure longlife and efficient operation. Over time, natural mineral deposits will form in the filter surface and rotor, and if untreated, may cause undesirable operation or even failure. Sicce PUMPCLEAN is a super-concentrated, yet completely safe solution to remove these deposits and keep your filter in tip-top shape.

Key Components To Be Cleaned To Return Your Filter To Optimal Condition. (Pic.12)

– Rotor

Turn this component , located below the filter's head, from right to the left, to raise the filter's head. The rotor is in the middle of the module and will be easily removable For perfect cleaning leave it submerged in water + Sicce PumpClean for about 30 minutes, then rinse it using a soft brush to remove stubborn deposits. Re-assemble the filter as per previous operations.

– Filter modules grid

It is advisable to keep the grid always free from small filament or algae which could block the holes and reduce the flow

It is not necessary to remove the filter media and cleaning can be done from the external face of the filter.

FILTER MEDIA REPLACEMENTS SYSTEM

Biological and Chemical Filtration

The inner cartridge can be totally replaced by purchasing new Ones available in store and ready to use OR can be open and refilled with the recommended Sicce Filter media or any other available in the market. Cartridge or Filter media should be replaced every 4-6 weeks. Mechanical Filtration Rinse the foams regularly and replace them in about 6-8 weeks to preserve a crystal water aquarium.

UPGRADE (Pic.13)

SHARK PRO Filter can be upgraded by adding extra Unit (available as spare part) . You can add as many as necessary for temporary water treatments or to improve the Filtration module.

SHARK PRO can be used VERTICALLY & HORIZONTALLY for Turtles Kit and Paludarium (Pic.14)

The Filter can be positioned horizontally or vertically and the filter's modules can be rotated thanks to a double fitting of the base.

When used with low water level, as per turtles kit or paludarium, the filter will base on the bottom of the aquarium in horizontal way. In this case, we recommend to use heavier filter media as the filter's buoyancy, not necessary in this specific application, could become an issue.

INSTRUCTIONS FOR THE CORRECT DISCHARGE OF THE PRODUCT ACCORDING TO EU DIRECTIVE 2002/96/EC

When used or broken, the product does not have to be discharged with the other waste. It can be delivered to the specific electric waste collection centers or to dealers who give this service. Discharge separately an electric tool avoid negative consequences for the environment and for the Health and allows to regenerate the materials so to have a great saving of energy and resources.

WARRANTY

LIMITED WARRANTY "SICCE guarantees this product (see Exclusions below) to the original purchaser against defects of materials and workmanship for a period of three (3) years from the date of original purchase, except for the pump's impeller, which is guaranteed for a period of six (6) months. This warranty is limited to repair or replacement (at Sicce's option) of defective product only and does not cover loss of aquarium life, personal injury, property loss, or damage arising from the use of the product. We recommend to keep the original proof of purchase to validate the warranty. Warranty claims must be submitted to the retailer where you purchased the product. Failure to present proof of purchase attached to the claim will invalidate the right to the guarantee. By connecting to the website www.sicce.com, in the appropriate session, you can request assistance if it has not been possible to contact the dealer. Also in this case the proof of purchase will be a fundamental requirement for the correct execution of the return procedure. Any warranty herein shall run concurrently with, and not in addition to, any minimum warranty periods established by applicable law. The claimant must obtain a "Return Merchandise Authorization" at the time of filing before sending any product for warranty or technical service. The purchaser bears the cost of shipping to and from the service center or repair station. EXCLUSIONS. This warranty does not cover the following:

*Damage resulting from accident, misuse, abuse, lack of reasonable care, use of the product that is other than normal or ordinary, using the project in abnormal working conditions or any other failures not resulting from defects in materials or workmanship.

*Damage resulting from modification, tampering with or attempted repair by anyone other than Sicce or its designee.

* Transfer of the product to someone other than the original purchaser.

* Subjecting the product to electrical service not specified in the packaging; the original purchaser is responsible for providing adequate electrical facilities."

FIND OUT HOW TO GET YOUR PRODUCT GUARANTEED FOR 5 YEARS.

To improve our service and our customers' satisfaction, Sicce offers the possibility of adding a 2 year extension (5 years total) to the warranty by simply registering your product on our website www.sicce.com in "Support/ Product Registration" Fill-in the form and upload the product's purchase receipt. After having correctly inserted all your data, complete the warranty extension request. Thanks for preference given & enjoy your new SHARK PRO !



SICCE S.r.l.

Via V. Emanuele, 115 – 36050 Pozzoleone (VI) – Italy
Tel. +39 0444 462826 – Fax +39 0444 462828 – P. IVA / VAT 02883090249

info@sicce.com · www.sicce.com

SICCE US Inc.

infous@sicce.com · www.sicce-us.com

SICCE AUSTRALIA Pty Ltd

info@sicce.com.au · www.sicce.com.au



Documents / Resources

A small image of the Sicce Shark Pro Internal Filter, showing the product and its packaging. The text 'SHARK PRO INTERNAL FILTER' is visible on the packaging.	<p>SICCE Shark Pro Internal Filter [pdf] Instruction Manual Shark Pro Internal Filter, Shark Pro, Internal Filter, Filter</p>
--	---

References

-  [Sicce Corporate](#)
-  [Sicce Corporate](#)
-  [Sicce Corporate](#)
-  [Sicce Corporate](#)

Manuals+.