



## SHX05FW450 520 W Frost Monitor Instruction Manual

[Home](#) » [SHX](#) » SHX05FW450 520 W Frost Monitor Instruction Manual 

### SHX05FW450 520 W Frost Monitor Instruction Manual



## Contents

- 1 CONGRATULATIONS!
- 2 Intended Use
- 3 IMPORTANT INFORMATION ON SAFETY, STANDARDS AND ELECTRICAL CONNECTIONS
- 4 Symbol markings on the appliance
- 5 Recycling, disposal and Declaration of Conformity
- 6 Scope of delivery
- 7 Description of the appliance
- 8 Before assembly
- 9 Wall mounting
- 10 Floor-standing position
- 11 Starting up and functions
- 12 Safety features
- 13 Cleaning and maintenance
- 14 TECHNICAL INFORMATION
- 15 Required data for single-room electrical heating devices
- 16 WARRANTY
- 17 Documents / Resources
  - 17.1 References
- 18 Related Posts

## CONGRATULATIONS!

THANK YOU FOR PURCHASING THIS SHX PRODUCT.





This product is intended for use in well-insulated areas and for occasional use only

PLEASE READ THE OPERATING MANUAL CAREFULLY BEFORE BEGINNING ASSEMBLY,, INSTALLATION, OPERATION OR MAINTENANCE. PROTECT YOURSELF AND OTHERS BY FOLLOWING THE SAFETY INSTRUCTIONS. FAILURE TO COMPLY WITH THESE INSTRUCTIONS MAY RESULT IN PERSONAL INJURY AND/OR PROPERTY DAMAGE AND/OR LOSS OF CLAIMS UNDER WARRANTY.

## Intended Use

This appliance is intended exclusively for the heating of domestic living spaces and may not be used for any other purpose.

## IMPORTANT INFORMATION ON SAFETY, STANDARDS AND ELECTRICAL CONNECTIONS

1.    Use this appliance **only in accordance with the guidelines in this operating manual**. Any other use not recommended by the manufacturer may result in fire, electrical shock or personal injury.
2. This appliance is **intended exclusively for the heating of domestic living spaces** and may not be used for any other purpose.
3. Remove the packaging and check that the appliance is not damaged. If you are in doubt, do not use the appliance and contact your dealer.
4. Before connecting to the mains power supply, **check that the mains voltage and type matches the information provided on the type plate of the appliance**.
5. The electrical socket to which you connect the appliance must not be defective or loose, must be suitable for

the current load required, and above all must be reliably earthed.

6. Avoid using an extension cable, because this could overheat and cause a fire.
7. If the power supply cable is damaged, it must be replaced by the manufacturer or an authorised service centre to avoid all possible risks. Do not twist, kink or sharply bend the power supply cable.
8. Do not situate the appliance directly beneath a wall socket. In case of doubt, have your electrical installation checked by a qualified electrician.
9. It is forbidden to adapt or modify the properties of this appliance in any way. Use only replacement parts and accessories recommended by the manufacturer (failure to do so may result in loss of warranty cover).
10. Do not use this heater if it shows visible signs of damage.
11. For any repairs to the appliance, the power plug or the cable, always contact the customer services authorised by the manufacturer.
12. This appliance is for use by adults only.
13. Children over 3 and under 8 years may only switch the appliance on or off under supervision or if they have been instructed in its safe use and understand the resultant dangers, on the condition that the appliance is positioned or installed in its normal place of use. Children over 3 and under 8 years must not be allowed to insert the plug into the socket, alter the settings, clean the appliance or perform user maintenance on the appliance.
14. Do not operate the appliance unattended. Whenever you leave the room, always switch off the appliance.
15. Do not use the appliance in small rooms where people are present who are unable to leave the room by themselves, unless they are under constant supervision.
16. Do not allow children to play with the appliance.
17. Keep children under 3 years away from the appliance unless they are under constant supervision.
18. Keep children away from the packaging materials.  
If swallowed, these pose a risk of suffocation.
19. This appliance is not equipped with a thermostat for controlling the room temperature.
20. The appliance is not suitable for continuous or highprecision operation.
21. Do not use this heater if it has previously been dropped.
22. This appliance is for use in dry indoor spaces only.
23. Do not use the appliance near water or high humidity, e.g. in damp cellars, or near swimming pools, baths or showers. Make sure that water cannot get into the appliance.
24. Do not use the appliance in close proximity to petrol, gas, oil, alcohol or other explosive or flammable liquids or gases.
25. **To minimise the risk of fire, ensure a distance of at least one metre between the air outlet of the appliance and any flammable materials such as:**
  - **a.** Pressurised containers (e.g. spray cans)
  - **b.** Furniture
  - **c.** Textiles of any kind
26. This heater should be operated on a level, stable surface or attached to a wall if necessary.
27. Never cover the appliance while it is in operation or while cooling down after use.
28. Ensure that no objects come between the appliance and the mounting wall that could touch the heating surface.
29. Always switch the appliance off before unplugging it.
30. **Caution:** certain parts of this appliance may become very hot and cause burns. Take particular care if children or vulnerable persons are present. Always allow the appliance to cool down before cleaning it or removing it

from its mounting.

31. Unplug the appliance when you are not using it and before cleaning it or performing any maintenance.

Do not allow children to clean or perform user maintenance on the appliance without supervision.

32. To avoid electric shocks, do not touch the plug with wet hands.

**WARNING:** Do not use this heater if it has previously been dropped.



**WARNING:** Do not use this heater if it shows visible signs of damage.

**WARNING:** This heater should be operated on a level, stable surface or attached to a wall if necessary.

**WARNING:** Keep children under 3 years away from the appliance unless they are under constant supervision.

**WARNING:** Children over 3 and under 8 years may only switch the appliance on or off under supervision or if they have been instructed in its safe use and understand the resultant dangers, on the condition that the appliance is positioned or installed in its normal place of use. Children over 3 and under 8 years must not be allowed to insert the plug into the socket, alter the settings, clean the appliance or perform user maintenance on the appliance.

**WARNING:** Do not allow children to clean or perform user maintenance on the appliance without supervision.

 <b>ATTENTION</b>	<p><b><u>RISK OF INJURY</u></b></p> <p><b>This appliance becomes hot during use.</b></p> <p>Never touch the appliance while it is in use à this may result in severe BURNS.</p>
 <b>ATTENTION</b>	<p><b><u>RISK OF FIRE</u></b></p> <p><b>Do not cover the appliance while it is in use.</b></p>
 <b>ATTENTION</b>	<p><b><u>SAFE DISTANCE</u></b></p> <p>Maintain a safe distance of at least one metre from flammable items such as furniture, curtains, paper and similar.</p> <p><b><u>PLACE OF USE</u></b></p> <p>Position the appliance in such a way that air can flow in and out without hindrance.</p> <p><b><u>RISK OF BURNS</u></b></p> <p>This appliance becomes very hot during use and can cause burns. Take particular care if children or vulnerable persons are present.</p> <p><b><u>RISK OF OVERHEATING</u></b></p> <p>Do not use the appliance in rooms with a volume less than 4m<sup>3</sup>.</p>

## Symbol markings on the appliance



### Symbol: Meaning:

Attention! Do not cover The symbol on the device indicates that it is not permitted to suspend any item (e.g. towels, clothing etc.) above the appliance or directly in front of it. To prevent overheating and the risk of fire, the heater must not be covered.

## Recycling, disposal and Declaration of Conformity

♻	<p style="text-align: center;"><b><u>RECYCLING</u></b></p> <p>The packaging materials can be recycled. It is recommended that you dispose of them in separated waste.</p>
☒	<p style="text-align: center;"><b><u>DISPOSAL</u></b></p> <p>The pictogram with the crossed out dustbin indicates that electrical and electronic appliances must be disposed of separately from household waste (WEEE). Electrical and electronic appliances can contain harmful and environmentally hazardous materials. Do not dispose of them in unsorted residual waste, but at a registered collection centre for waste electrical and electronic equipment. By doing so, you will help to conserve resources and protect the environment. For further information please consult your dealer or your local authorities. Directive 2012/19/EU</p>
CE	<p style="text-align: center;"><b><u>DECLARATION OF CONFORMITY</u></b></p> <p>We hereby confirm that this article complies with the essential requirements, regulations and guidelines of the EU. The detailed declaration of conformity can be viewed at any time via following link: <a href="https://www.schuss-home.at/downloads">https://www.schuss-home.at/downloads</a></p>

**Errata and technical changes reserved.**

## Scope of delivery

- Frost monitor
- Wall mounting accessories
- Feet incl. bolts
- Operating manual

## Description of the appliance

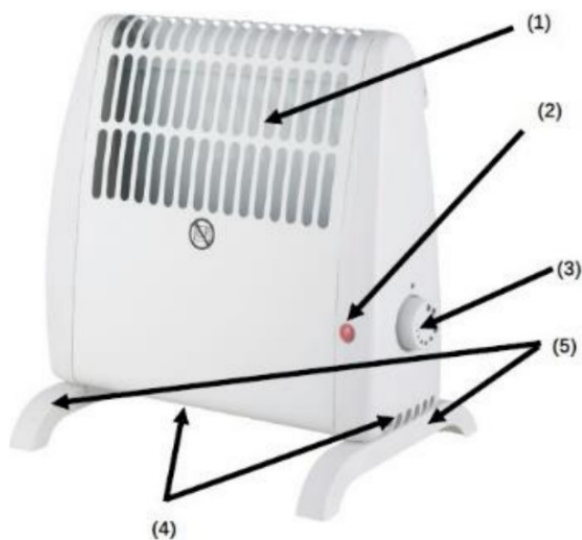

1. Air outlet grille
2. Control lamp
3. Thermostat adjustment
4. Air inlet grille
5. Feet

This frost monitor is an electric convector heater fitted with a thermostat and is protected against overheating.

The display lights up when the frost monitor is in operation.

The frost monitor is designed to keep small rooms in a domestic or similar environment free of frost and at a stable temperature. The appliance must always be used upright – never lying on its side – and only for the purpose for which it is designed.

### Before assembly

1. Open the carton and take out the appliance.
2. Remove all packaging from the appliance.
3. Next, check the appliance for any damage.
4. Carefully unwind the power cable and check this also for damage.

### **ATTENTION**

Please follow the information on assembling the appliance provided in the safety information section very carefully.

### Wall mounting

1. Select a suitable mounting position on a vertical wall. Ensure sufficient distance to other objects, furniture etc.

**See illustration:**

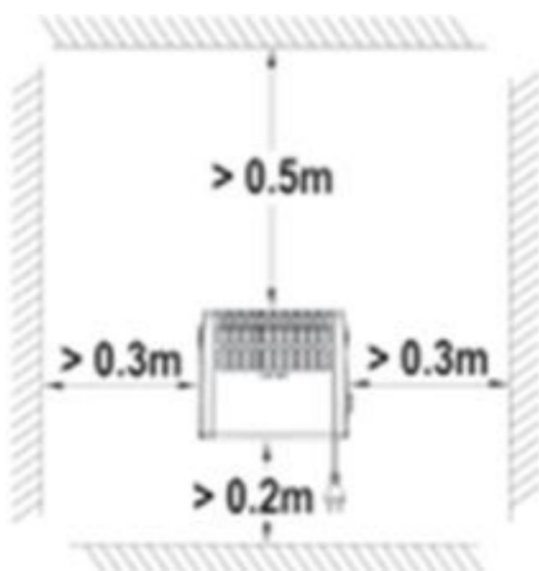

- Above, min. 50 cm
- To the sides, min. 30 cm
- Below, min. 20 cm

### **ATTENTION**

The heater must not be used directly below a wall power socket.

2. The frost monitor can be mounted using the bracket on the back. First, undo the nuts and bolts to left and right that attach the bracket to the frost monitor.

Having removed the nuts and bolts, pull the bracket carefully downwards and out.

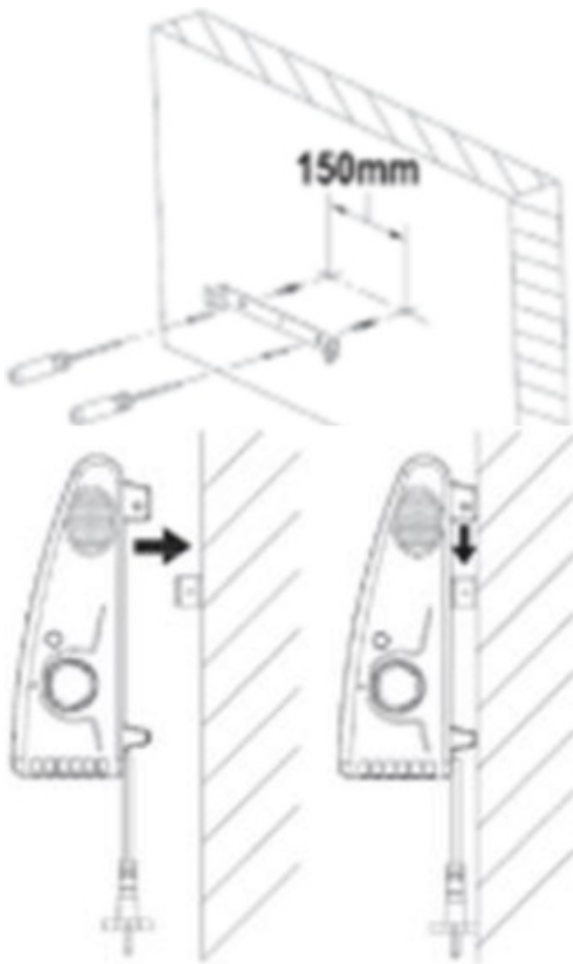

3. Fix the bracket to the wall with two screws. Using the holes in the bracket, mark the appropriate hole positions on the wall.

Use appropriate screws and plugs to suit the type of wall for the mounting. When drilling and inserting screws, take care that no cables or other lines are damaged.

4. Place the frost monitor on the bracket and secure with the nuts and bolts that were removed at the start.

### **Floor-standing position**

1. Attach the two feet to the bottom of the heater using 2 screws.
2. Stand the heater on a smooth, level surface, at least 30 cm from any obstacles.

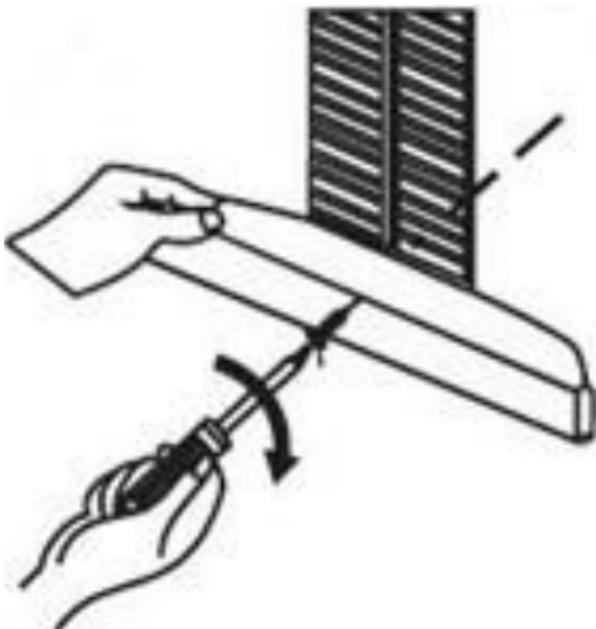



## ATTENTION

The heater must not be placed directly below a wall power socket.

## Starting up and functions

The frost monitor is now ready for operation. Insert the plug into a suitable 220 240V ~50Hz earthed socket to start operation. Only connect the appliance to a socket that is earthed.

- To set the desired temperature, turn the thermostat controller to maximum (turn clockwise up to the limit stop, with the largest dot marking). Now wait until the desired temperature is reached, then turn the controller gradually down until the control lamp goes out. You have now set the desired temperature. If the room temperature falls lower, the appliance switches itself on and the control lamp lights again. To set the temperature higher or lower, simply rotate the thermostat controller either towards maximum (the largest point marking) or towards minimum (the smallest point marking).
- When you set the thermostat controller to minimum (the smallest point marking), the frost monitor will keep the room frost free – provided it is not too large or too cold.
- Even at this lowest setting, the appliance can still switch itself on. To switch it off altogether, pull the mains plug from the socket.

## Safety features

Overheating protection causes the appliance to cut out if its interior becomes too hot. This can occur if the appliance cannot fully expel all its heat or if too little fresh air is available for it to draw in.

The usual cause of this is that something is covering or partly covering the appliance or that the air inlet or outlet is blocked or clogged; other causes are the presence of dirt or a positioning of the unit too close e.g. to a wall.

If the appliance overheats, switch off, remove the plug from the socket and allow to cool. Once you have removed the cause of overheating, you can start the appliance up normally.

If you cannot identify the cause and overheating recurs, stop using the appliance and contact your dealer.

Following a cut-out due to overheating and subsequent cooling, the appliance may begin operating normally again; this does not mean that the cause has been resolved. If the appliance repeatedly overheats, cuts out and starts up again, it can pose a fire risk. Do not allow this situation to occur.

## Cleaning and maintenance

Keep the frost monitor clean. The build-up of dust and dirt in the appliance is one of the commonest causes of overheating. You should therefore remove such dirt regularly. Before cleaning or performing maintenance, switch the frost monitor off, remove the plug from the socket and allow to cool.

- Clean the outside of the appliance regularly with a dry or very slightly moistened cloth. Do not use any abrasive soap, spray, detergents or scouring agents, wax, glazing agents or other chemical solutions.
- Use a vacuum cleaner to carefully remove dirt and dust from the grilles and check that the air inlets and outlets are clean. When cleaning these, take care not to touch or damage any internal parts.



- The frost monitor does not contain any other components that require maintenance.
- When the heating season ends, carefully pack the frost monitor away, where possible in its original packaging. Store it upright in a cool, dry and dusty-free place.
- When the appliance reaches the end of its useful life, do not dispose of it in the domestic waste. Take it instead to a local collection point for electrical equipment. Care will then be taken to recycle any re-usable materials.

## TECHNICAL INFORMATION

<b>Article number:</b>	SHX05FW450
<b>Input voltage:</b>	220-240 V~
<b>Frequency:</b>	50-60 Hz
<b>Rated power consumption:</b>	450 W – 520 W
<b>Controllable parameters:</b>	Temperature
<b>Thermostat:</b>	Yes
<b>Weight:</b>	0.9 kg
<b>Dimensions:</b>	27,5 x 18 x 27,8 cm
<b>Contact address for further information:</b>	Schuss Home Electronic GmbH Scheringgasse 3, A-1140 <b>Wren Service line:</b> +43 (1) 97 0 21 <a href="http://www.schuss-home.at">www.schuss-home.at</a> <b>FB-Nr:</b> 236974 t / <b>FB-Gericht:</b> Wren

## Required data for single-room electrical heating devices

Article number SHX05FW450					
Information	Symbol	Value	Unit	Information	Unit
Heat output				Single-room electric storage heaters only: Method of heat transfer control	
Nominal heat output	P <sub>nom</sub>	0.45-0,52	kW	Manual control of heat transfer with integrated thermostat	N/A
Minimum heat output (guideline)	P <sub>min</sub>	N/A	kW	Manual control of heat transfer with feedback of room and/or outside temperature	N/A
Maximum continuous heat output	P <sub>max,c</sub>	0.52	kW	Electronic control of heat transfer with feedback of room and/or outside temperature	N/A
Auxiliary current consumption				Fan-assisted heat outlet	N/A
At Nominal heat output	el <sub>max</sub>	0.000	kW	Type of heat output/room temperature control	
At Minimum heat output	el <sub>min</sub>	0.000	kW	Single heat output level, no room temperature control	No
In standby mode	el <sub>sB</sub>	0.000	kW	Two or more manually settable output levels, no room temperature control	No
				Room temperature control with mechanical thermostat	Yes
				With electronic room temperature control	No
				Electronic room temperature control and timed control through the day	No
				Electronic room temperature control and timed control through the week	No
				Other control options	
				Room temperature control with presence detection	No
				Room temperature control with detection of open windows	No
				With remote control option (WiFi)	No
				With adaptive start-up control	No
				With operating time limiter	No
				With ball-type sensor	No
Contact information:	Schuss Home Electronic GmbH Scheringgasse 3, 1140 Wien <a href="https://www.schuss-home.at/">https://www.schuss-home.at/</a>				

## WARRANTY

By purchasing this SHX quality product, it means you have decided to place trust in durability, reliability and innovation.

For this SHX appliance, we grant a warranty period of 2 years from the date of purchase valid in Austria and Germany!

If, contrary to expectations, service work on your appliance is still necessary during this period, we hereby guarantee either free repairs (spare parts and working time) or (at the discretion of Schuss) that we will replace the product. If it is not possible to either repair or exchange the product for economic reasons, we reserve the right to create a time value credit.

In any case, please contact the customer hotline as a first step (see the operating manual – ‘contact addresses for further information and service line’).

We would like to point out that repair work that has not been performed by authorised contract workshops will immediately terminate the validity of this warranty.

**This warranty does not cover:**

- Damage due to non-adherence to the operating manual
- Repair or replacement of parts due to normal wear and tear
- Appliances that are used commercially, even in part
- Appliances mechanically damaged due to external influence (any fall(s), impact(s), breakage(s), improper use, etc.) as well as signs of wear and tear of an aesthetic nature
- Appliances that have been improperly treated
- Appliances that have not been opened by our authorised service workshop
- Unfulfilled consumer expectations
- Damage caused by force majeure, water, lightning and over voltage
- Appliances that have had their type designation and/or serial number on the appliance changed, deleted, made illegible or removed
- Defects due to extreme contamination
- Services outside our contract workshops, the transport costs to either an authorised workshop or to us and back, and the associated risks

We would like to expressly point out that a fixed amount of €60 (indexed basis CPI 2015, June 2020) will be charged within the warranty period in the event of operating errors or if no error has been detected.

The provision of a warranty service (repairs or replacement of the appliance) does not extend the absolute warranty period of 2 years from the date of purchase.

The 2-year warranty is only valid upon presentation of the proof of purchase (name and address of the dealer as well as the complete appliance designation must be included) and the corresponding warranty certificate, on which the appliance type and the serial number (on the box and on both the back and underside of the appliance) are to be noted! Without presenting the warranty certificate, only the legal warranty applies!

We would like to expressly point out that the statutory warranty rights are unaffected by this warranty and continue unabated.

A liability for damage on the part of Schuss Home Electronic GmbH and its vicarious agents only exists in the event of gross negligence or intent. In any event, liability for lost profits, expected but not occurred savings, consequential damage and damage arising from claims of third parties is excluded.

The contact address of the respective service workshop is available on our homepage [www.schuss-home.at](http://www.schuss-home.at). Congratulations on making your choice. We wish you a lot of pleasure with the SHX appliance!

**ADDRESS**

SHX Retriever

Schuss Home Electronic GmbH

A-1140 Vienna (Austria), Scheringgasse 3

**Tel.:** +43 (0)1/ 970 2

**Type designation:.....**

Serial number:.....



## Documents / Resources

 <p><b>BEDIENUNGSANLEITUNG</b> Frostwächter 520 Watt SHX05FW450</p> <p>BEFOLGEN SIE ALLE ANWEISUNGEN VIELLEICHT DANKEN SIE SICH SÜNDEN BEI DER PRODUKTION DASS SIE SICH NICHT BEWUSST SIND</p> <p>Dieses Produkt ist nur für den Einsatz in Räumen oder für den geplanten Einsatz geeignet.</p>	<p><a href="#">SHX SHX05FW450 520 W Frost Monitor</a> [pdf] Instruction Manual SHX05FW450, SHX05FW450 520 W Frost Monitor, SHX05FW450, 520 W Frost Monitor, Frost Monitor, Monitor</p>
--	--

## References

- [🌐 Welcome to Your New Home Page!](#)
- [🏠 Home » Schuss Home Electronic](#)
- [📖 User Manual](#)

[Manuals+](#), [Privacy Policy](#)

This website is an independent publication and is neither affiliated with nor endorsed by any of the trademark owners. The "Bluetooth®" word mark and logos are registered trademarks owned by Bluetooth SIG, Inc. The "Wi-Fi®" word mark and logos are registered trademarks owned by the Wi-Fi Alliance. Any use of these marks on this website does not imply any affiliation with or endorsement.