



ShoppoHub HP30 Projector User Manual

[Home](#) » [ShoppoHub](#) » ShoppoHub HP30 Projector User Manual 

Shoppo Hub

USER'S MANUAL

Thanks for reading!

Enjoy your time with this projector!



Contents

- [1 Packing list](#)
- [2 Projector component and functions](#)
- [3 Common external devices](#)
- [4 Safety notice](#)
- [5 Remote control](#)
- [6 Documents / Resources](#)
 - [6.1 References](#)

Packing list

*PS: Thank you very much for purchasing our company's products.

Please check the products you have received, Whether the physical object is consistent with the list; If the

products and accessories you receive do not match the list, please Contact the purchasing platform promptly.



projector

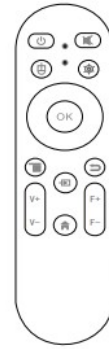

remote control

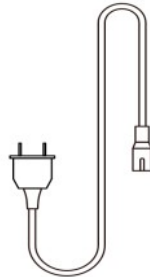

power line

*PS:Due to different model versions, there may be certain differences in appearance and functionality. Please refer to the actual product for accuracy.

Projector component and functions

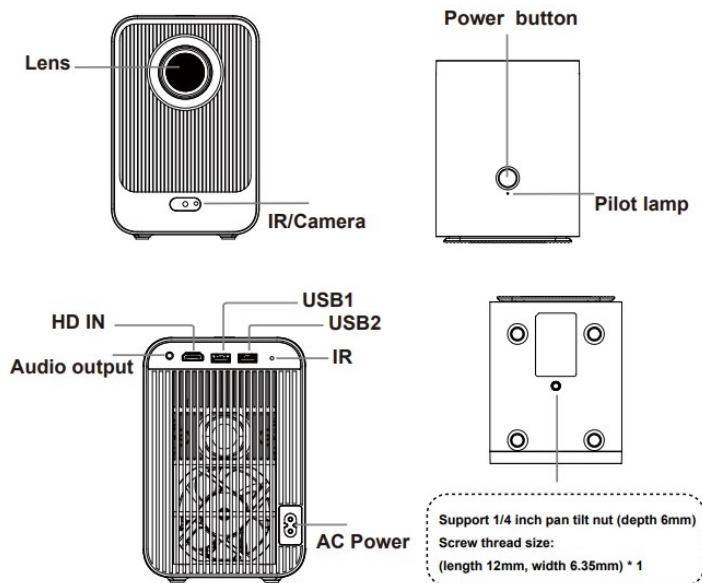

*PS

- Do not place objects within 20cm near the heat dissipation holes.
- If lifting, please use screws of the specified specifications and choose a suitable bracket.
- Please do not look directly at the lens.

Common external devices

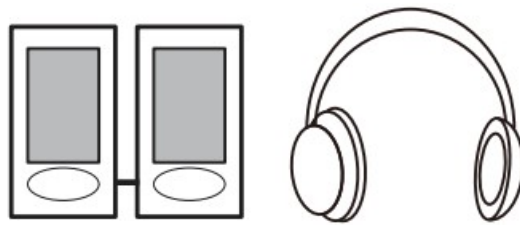

3.5mm headphone jack: speaker, headphone

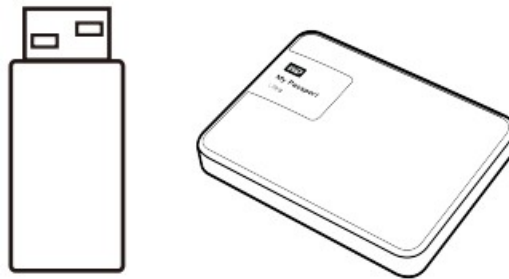

USB interface: USB flash drive, 2.5-inch portable hard drive

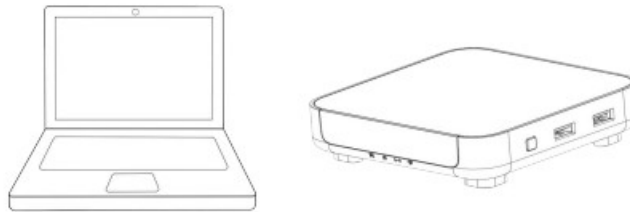

HD IN: computer/laptop, TV box

⚠ Warning:

Running this device in a residential environment may cause radio interference.

Safety notice

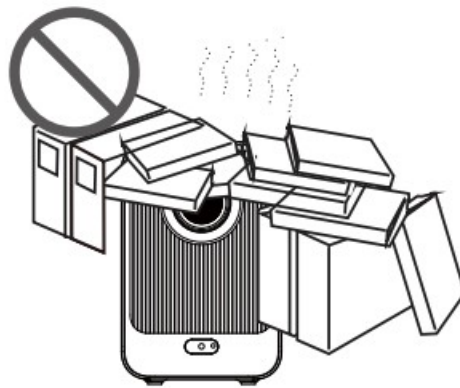

Do not install in non ventilated places.



Do not install in high temperature or humid places.



Do not block the ventilation holes (intake or exhaust)



Do not install in dusty or smoky places.

Remote control

PS:

Please pair the Bluetooth remote control first to facilitate the use of the remote control and mouse functions.

1. After turning on the machine, press the V- and F- buttons on the remote control at the same time, and the remote control indicator light will enter a flashing state.
2. Use the remote control to operate the projector to enter the setting interface and enter the Bluetooth interface to search.
3. Search for the name: BT Keyboard, and click Connect. It can be used after the connection is successful.
4. If you cannot search for the relevant name, please repeat steps 1 and 2.

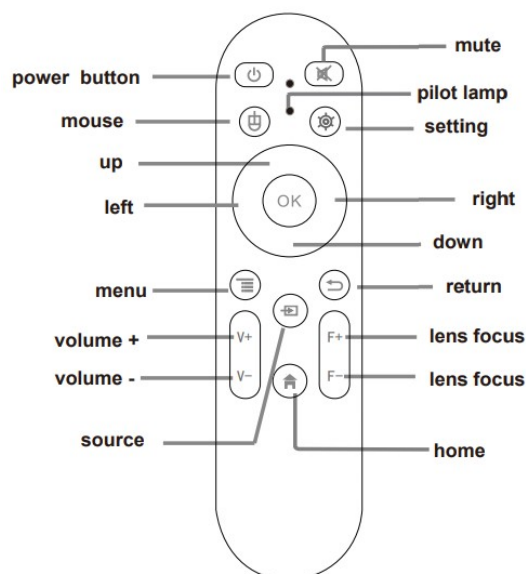

Warning tatement

This device complies with part 15 of the FCC Rules. Operation is subject to the following two conditions: (1) This

device may not cause harmful interference, and (2) this device must accept any interference received , including interference that may cause undesired operation.

Any Changes or modifications not expressly approved by the party responsible for compliance could void the user's authority to operate the equipment.

Note: This equipment has been tested and found to comply with the limits for a Class B digital device, pursuant to part 15 of the FCC Rules. These limits are designed to provide reasonable protection against harmful interference in a residential installation.

This equipment generates uses and can radiate radio frequency energy and, if not installed and used in accordance with the instructions, may cause harmful interference to radio communications. However, there is no guarantee that interference will not occur in a particular installation. If this equipment does cause harmful interference to radio or television reception, which can be determined by turning the equipment off and on, the user is encouraged to try to correct the interference by one or more of the following measures:

- Reorient or relocate the receiving antenna.
- Increase the separation between the equipment and receiver.
- Connect the equipment into an outlet on a circuit different from that to which the receiver is connected.
- Consult the dealer or an experienced radio/TV technician for help.

This equipment complies with FCC radiation exposure limits set forth for an uncontrolled environment. This equipment should be installed and operated with minimum distance 20cm between the radiator & your body.

Shoppo Hub

Documents / Resources

	ShoppoHub HP30 Projector [pdf] User Manual 2BKAI-HP30, 2BKAIHP30, hp30, HP30 Projector, HP30, Projector
---	--

References

- [User Manual](#)

[Manuals+](#), [Privacy Policy](#)

This website is an independent publication and is neither affiliated with nor endorsed by any of the trademark owners. The "Bluetooth®" word mark and logos are registered trademarks owned by Bluetooth SIG, Inc. The "Wi-Fi®" word mark and logos are registered trademarks owned by the Wi-Fi Alliance. Any use of these marks on this website does not imply any affiliation with or endorsement.