

Shopper S+ Smart App User Guide

[Home](#) » [Shopper](#) » Shopper S+ Smart App User Guide 

Contents

- 1 Shopper S+ Smart App
- 2 Install S+ Smart APP
- 3 Register an Account
- 4 Create A Home
- 5 Adding Devices
- 6 Control Your Lighting
- 7 Amazon Alexa Setup
- 8 Disposal
- 9 Documents / Resources
- 10 Related Posts



Shopper S+ Smart App

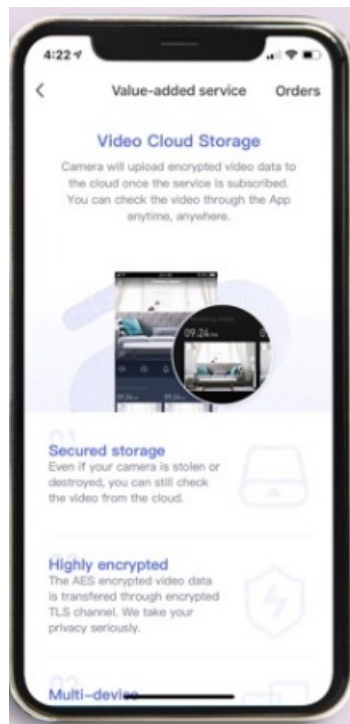

Install S+ Smart APP



- Download and install the S+ Smart APP via iOS App store or Google Play Store.
- Search for “S+ Smart”.
- Or use your phone to scan the QR code to download “S+ Smart”.

Register an Account

Enter the email address and press Get Verification Code, then enter the Verification Code that has been sent to your email, the next step is Set Password and press Done.

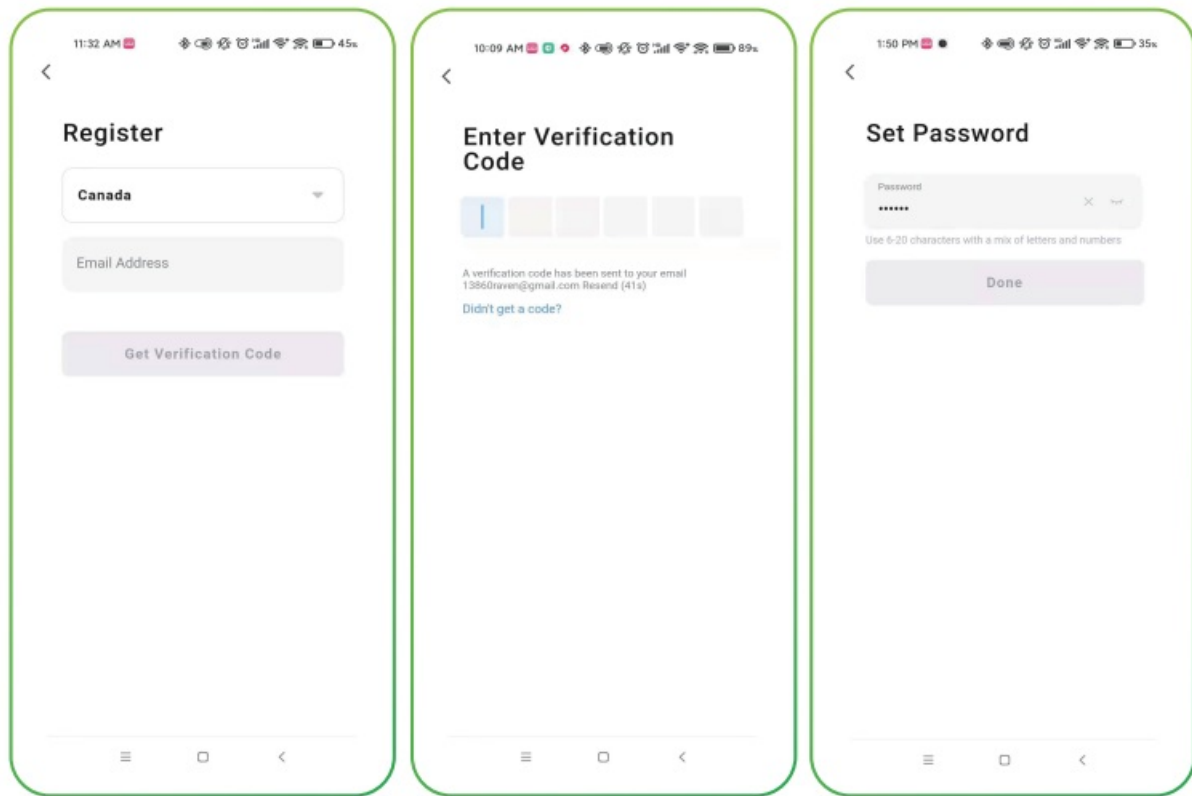

Create A Home

Home Management can be found in the “Me” tab at the bottom of the home screen. Add Home Name and Location then select rooms where smart bulbs will be located

Adding Devices

Easy Pairing Mode (Recommended)

1. Make sure the lights are turned on.

(4)

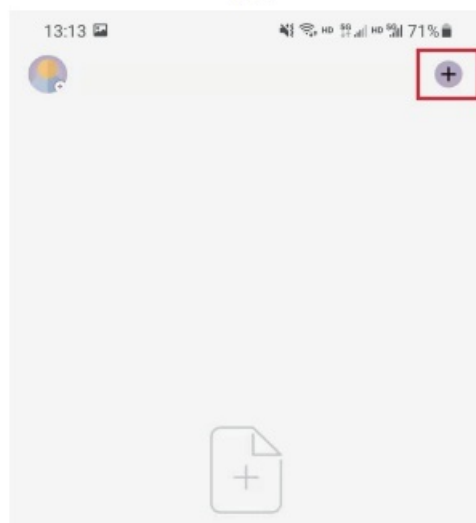

2. Turn on the WiFi and Bluetooth of the cell phones or tablets.
3. Confirm the lights are blinking rapidly; If not blinking rapidly, then turn light off-on-off-on and it will blink rapidly.
4. Open the “S+ Smart” APP and click “Add device” or the “+” in the top right corner.
5. The devices will be showed up on the page automatically and then click “Go to add”

(5)

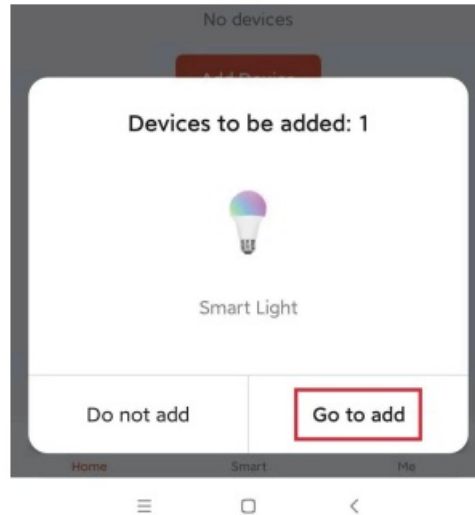

6. It will take a few seconds to finish the pairing process and then we could start to control the light via app.

Manual Pairing Mode(Optional)

1. Turn on the lights for 5 seconds.

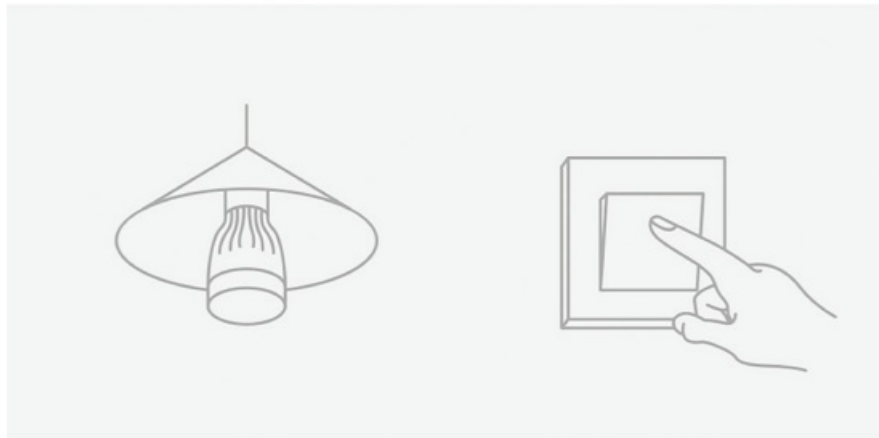

2. Open the APP while ensure the Bluetooth and WiFi are activated on the cellphones or tablets. Click "+" or "Add Device" on the top right corner of the home page. Select "Lighting" and then "Light Source(BLE + WIFI)" from the list of devices. Tap "Next" once we confirm the lights are blinking rapidly.

Note: If not blinking rapidly, turn lights off-on-off-on and it will blink rapidly.

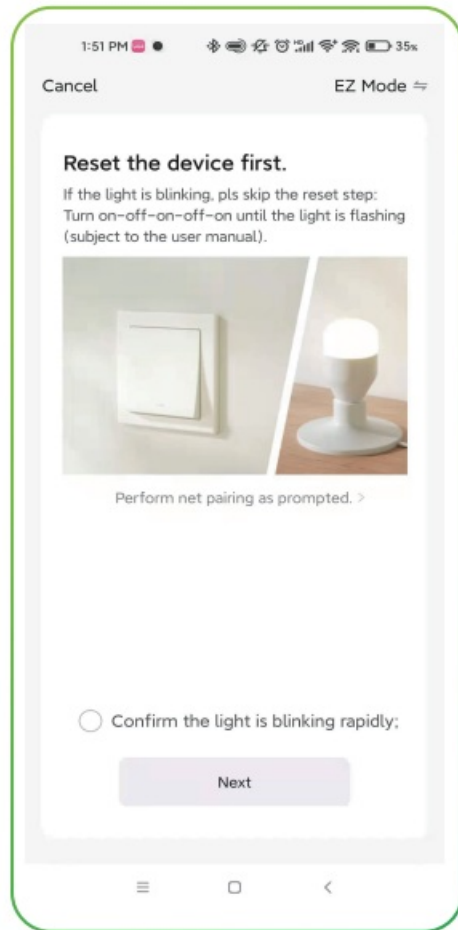
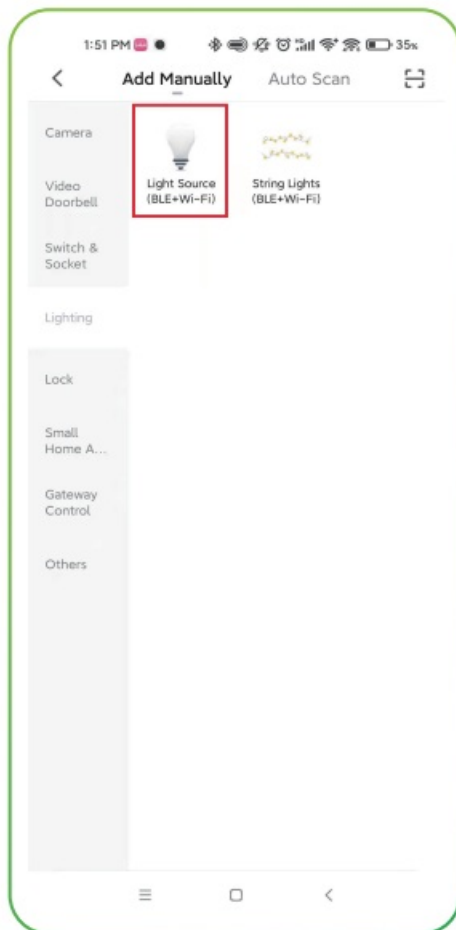

3. Select the WiFi to which the smart device has already connected, input the WiFi password, and then click "Next" to wait a few seconds for the pairing process to be completed.

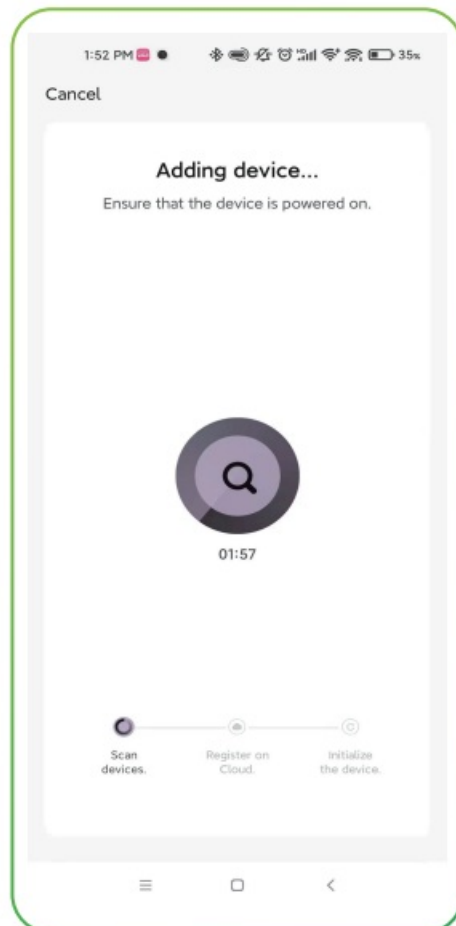
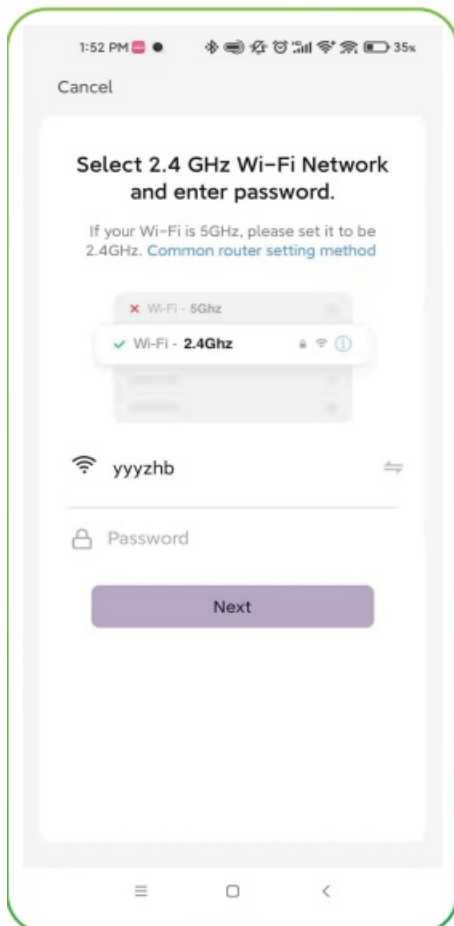

You can rename the lights and share them with family members in the S+ Smart App, so they can control the

lights as well.

Control Your Lighting

Click on the bulb you want to control to change the color, adjust brightness, choose a scene, or set a schedule. Alternatively, you can create a group of bulbs to change settings for more than one bulb at a time. See “Create Groups”. Select the bulb and click the settings in the top right to check the network status, add it to a group of bulbs to control together, or share it with other members of the household.

- **Tunable White and Adjustable Brightness**

You can change the light bulb from Warm White 2700K to Daylight 6500K and adjust the brightness level from 10% to 100%.

- **Choose From Over 16 Million Colors**

Choose from any hue in the rainbow and change the color of your bulbs within seconds. Adjust the brightness and coolness to suit your mood.

- **Set The Scene**

Choose from a variety of scenes or create your own. You can create a scene for movie night, a party scene with colorful light, or even a candlelit scene with warm, low lighting

- **Create Schedules**

Create schedules based on your preferences and daily needs. Set up different action for each bulb, or same action for a group of bulbs. Support repetitive schedules for specified days, e.g. Repeat on weekdays.

- **Music Sync**

Choose Music Sync to match color changes to the beat of the music playing on your speakers.

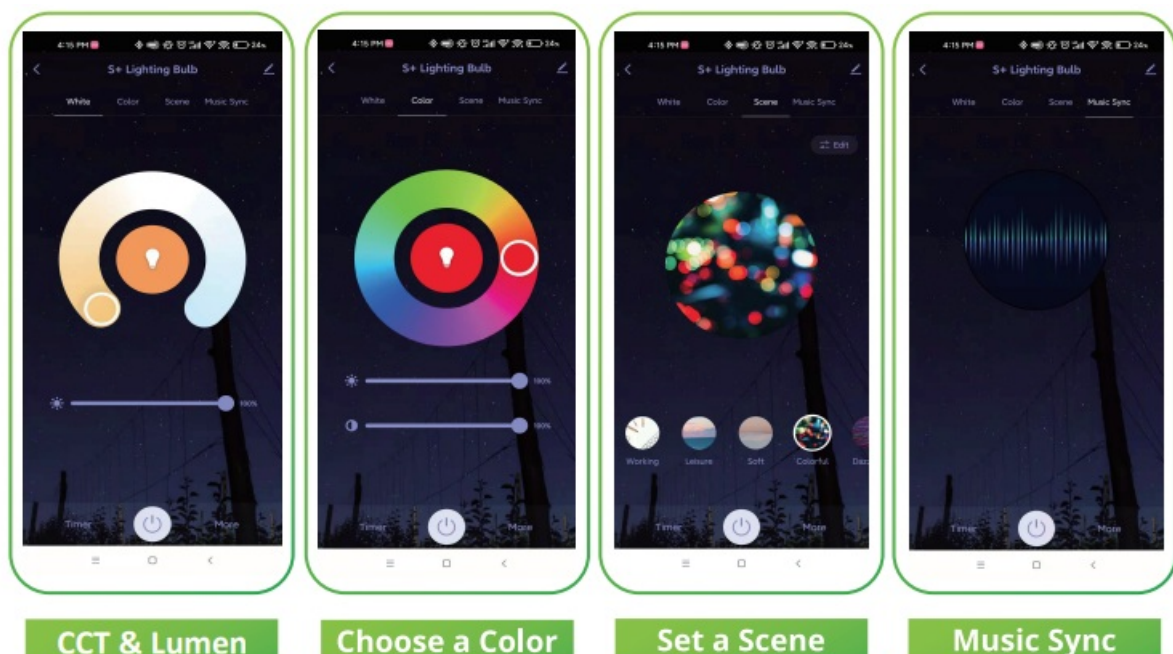

Create Groups

1. Click on the bulb you would like to add into a group. Select settings by clicking Pen icon in the top right of your screen.
2. Select CREATE GROUP.

3. Select the smart bulbs you would like to be part of a group.
4. Click SAVE and enter a name for the group. You can control all bulbs which are in the same group at the same time, by changing color, changing a scene or setting a schedule, etc. For example, turn on all lights downstairs by the time of sunset.

Bulb Settings

Click on the Pen icon at the upper right corner to control settings for each bulb. From here you can change the device name, check the Wi-Fi network status, share the bulb with other household members, create a group, etc.

Please note: The settings can't be changed once it's shared with multi-users.

Please connect to the bulb directly using the quick connection to access all the settings.

Voice Control using Google Home

1. Open the Google Home app and click on "+", then click on "Set up device" and then "Works with Google".
2. Find "S+ Smart" on the list. In the new window, select your "S+ Smart" account's region, enter your current "S+ Smart" account and password, then tap "Agree to link". After the bulb is linked, it will be listed in the Home Control Page of Google Home.
3. Now your smart bulbs are successfully linked to Google Home, and you can also assign the location to each bulb, like bedroom, living room, etc.

Take bedroom light as an example. The supported voice commands are as follows:

- "Ok Google, turn on/off bedroom light"
- "Ok Google, set bedroom light to 50 percent"
- "Ok Google, brighten bedroom light"
- "Ok Google, dim bedroom light"
- "Ok Google, set bedroom light to red"

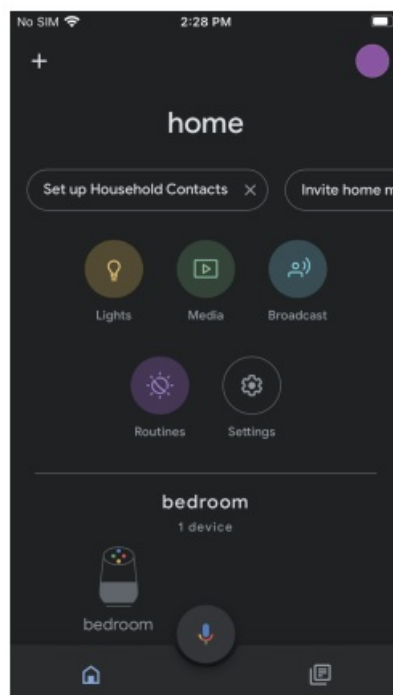

Amazon Alexa Setup

Choose “Skills & Games” in the options bar and then search “S+ Smart” in the search box. Select “S+ Smart” in the search results, and then click “Enable To use”. Then input the current user name and password. Your smart devices will be listed in the “Devices” tab at the bottom of the home screen. Adding devices to a room enables commands like “turn on the livingroom lights”. You can control the bulbs by commands as below:

- “Echo(or Alexa), turn on bedroom light”
- “Echo(or Alexa), turn off bedroom light”
- “Echo(or Alexa), set bedroom light to 50 percent”
- “Echo(or Alexa), increase bedroom light to 50 percent”
- “Echo(or Alexa), decrease bedroom light to 50 percent”

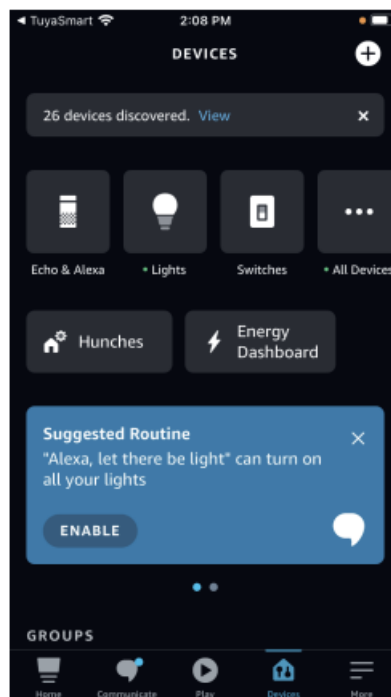

Disposal

Do not dispose of this product as unsorted municipal waste. Collection of such waste must be handled separately as special treatment is necessary. Please check your Municipal Recycling Guideline before disposal.

Support

For any further support or help, please contact us at 1-866-979-7463.

Documents / Resources



[Shopper S+ Smart App](#) [pdf] User Guide
S Smart App, S Smart, App