



# SHIFTCAM PG0001 ProGrip Starter Kit User Guide

[Home](#) » [SHIFTCAM](#) » SHIFTCAM PG0001 ProGrip Starter Kit User Guide 

## Contents

- [1 SHIFTCAM PG0001 ProGrip Starter Kit](#)
- [2 ProGrip Components](#)
- [3 Safety Instructions](#)
- [4 Charging ProGrip](#)
- [5 ShiftCam ProGrip](#)
- [6 Documents / Resources](#)
  - [6.1 References](#)
- [7 Related Posts](#)



## SHIFTCAM PG0001 ProGrip Starter Kit



### ProGrip Components

Front View

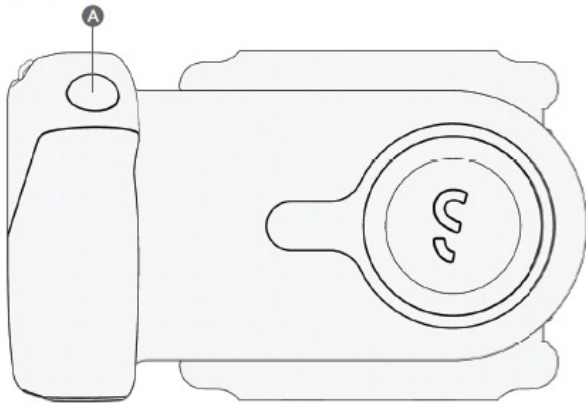

Back View

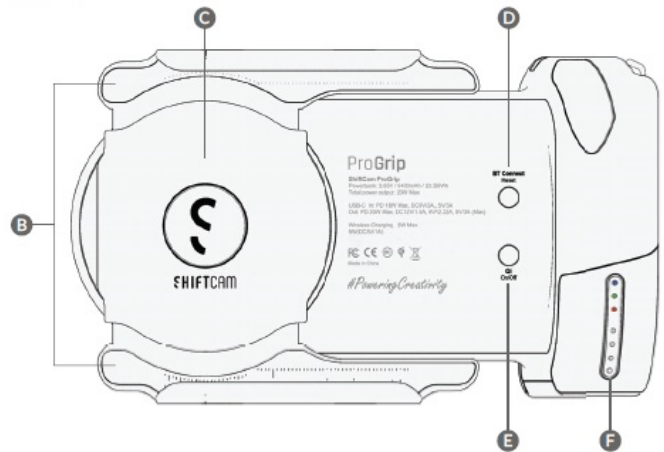

- Shutter Button
- Universal Clamp Wireless
- Charging Plate
- Bluetooth Button
- Charging Button
- LED Panel
- Cold Shoe Slot
- Hand Strap Loop
- 1/4" Tripod Screw

- USB-C Port

### Shift Cam Warranty

We offer a 2-Year Warranty that covers your products from any manufacturing flaws or defects. Warranty does not cover damages from accidents or misuse. 2 Simple Steps to Get Your ProGrip Covered:

1. Scan the QR code and complete the warranty registration process.
2. In case of service required, please reach out to [cs@shiftcam.com](mailto:cs@shiftcam.com) and send this warranty card along with your ProGrip back to us. We will get it fixed.

### Safety Instructions

- Keep away from moisture and liquids. If ProGrip has been exposed to liquids, dry immediately with dry cloth or tissue
- Do not open, remove, crush, puncture, or short-circuit ProGrip
- Do not use if visible defects are observed on ProGrip.
- Do not attempt to service or disassemble Using ProGrip for long periods of time will result in production of heat radiating from the device. It is a normal condition.
- If you believe your ProGrip may be overly heated please turn off the device immediately

### Battery and Power

Battery Specifications

- Battery: 18650 Lithium Ion Battery Cell x2 pcs
- Capacity: 3.65V / 6400mAh / 23.36Wh Total power output: 20W Max
- USB-C In: PD 18W Max, DC9V/2A, 5V/3A
- USB-C Out: PD 20W Max,
- DC12V/1.5A, 9V/2.22A, 5V/3A (Max) Wireless Charging: 5W

### Charging ProGrip

1. Connect the USB-C cable included in the packaging to a power adapter plugged into a power outlet
2. Insert the USB-C cable to the USB-C port on the bottom of ProGrip

### Wireless Charging

Turn on wireless charging function:

1. Press the Charging Button
2. A green LED light indicates the wireless charging function has been activated and entered into auto-detection mode
3. Attach your smartphone onto ProGrip securely, while aligning your smartphone centered to the wireless charging plate
4. ProGrip will auto-detect your smartphone once it is in place and begin charging. If fast charge mode is on, a red LED light will turn on simultaneously
5. Please double check your smartphone's battery indicator to ensure it is actively charging

## USB-C Charging

1. Connect your accessory or smartphone to ProGrip using the USB-C cable
2. Plug in cable to USB-C port on ProGrip on one end, and connect the other end to your accessory or smartphone's power port
3. White LED lights will turn on, indicating that charging is active. Please double check your smartphone or accessory's battery indicator to ensure it is actively charging.
  - Slide and attach accessories of your choice.

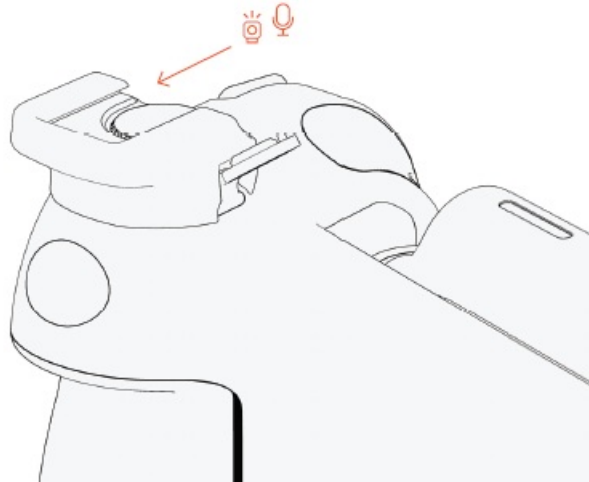

- Cold Shoe Mount Adapter If you want to adjust the angle the accessories face, add-on the rotatable Cold Shoe Mount Adapter.

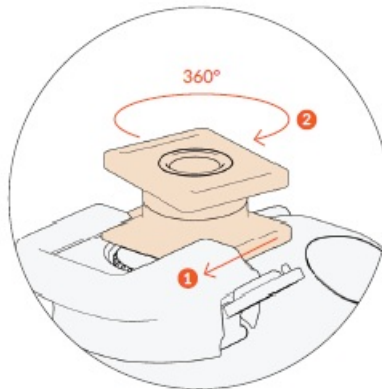

## LED Panel

LED feedback indicator

Top View

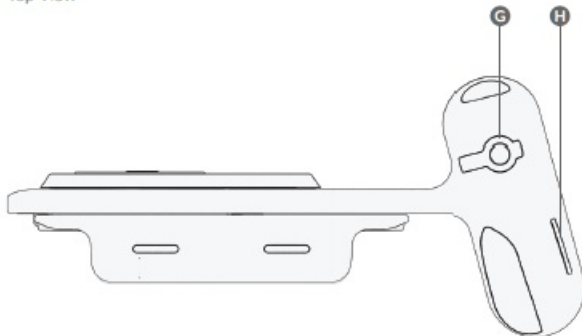

Bottom View

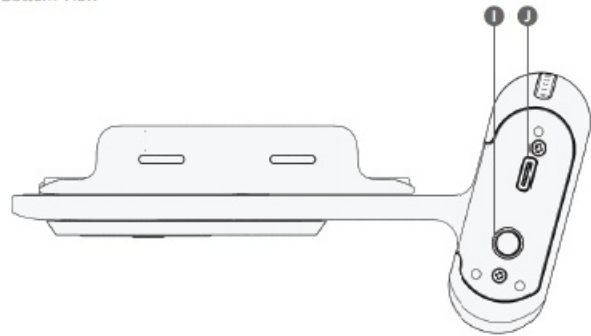

## Charging ProGrip

Connect to power source through USB-C cable to charge.

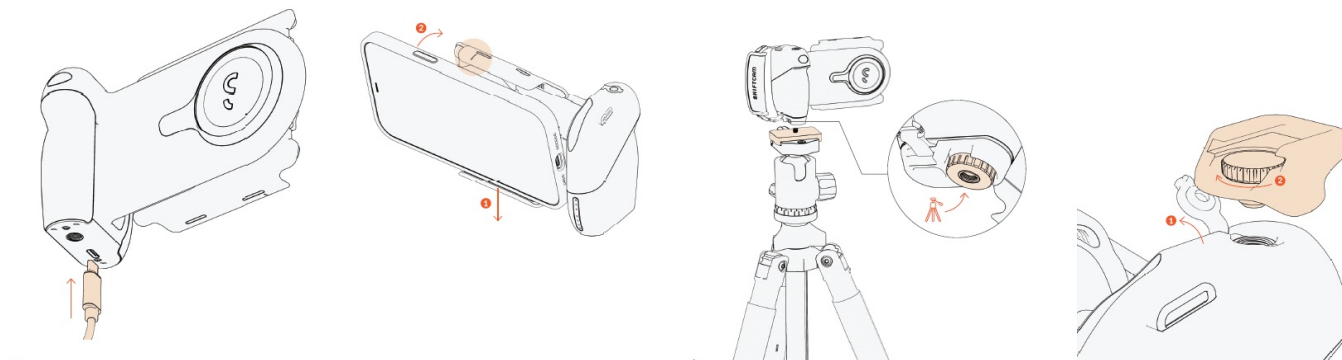

### Attaching ProGrip to Phone

Align your smartphone to the center of the clamp, push down the lower arm with your smartphone to open up clamp. Push your smartphone into the top arm and release to secure.

### 1/4" Tripod Screw

Screw in accessories of your choice into the screw thread on the bottom.

### Cold Shoe Mount

Open flap and place Cold Shoe Mount on opening. Screw in knob to secure.

### Hand Strap

Feed Hand Strap through loop and adjust length by pulling against the buckles. Screw in knob to secure.

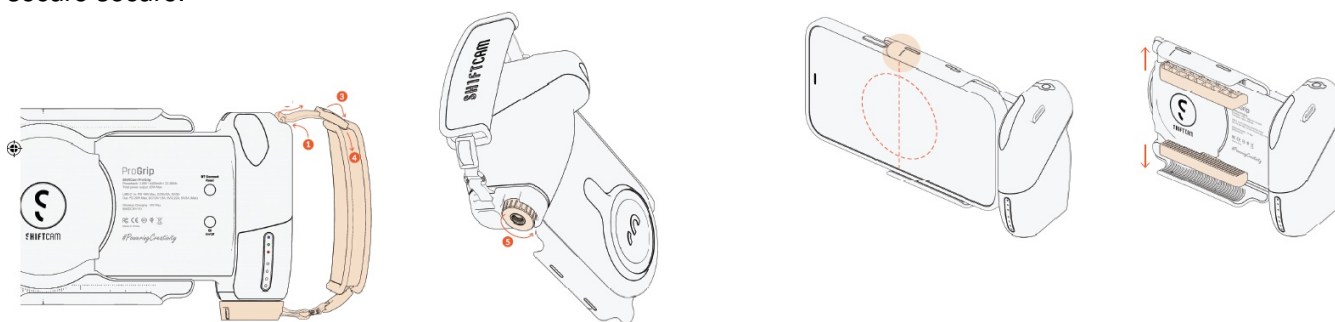

Ensure your smartphone is properly aligned to the center of the wireless charging plate for optimal charging capabilities.

### For Smaller Phone Models

If your phone's width is <75mm, add rubber in-lay attachments onto the inside of the clamp to secure.

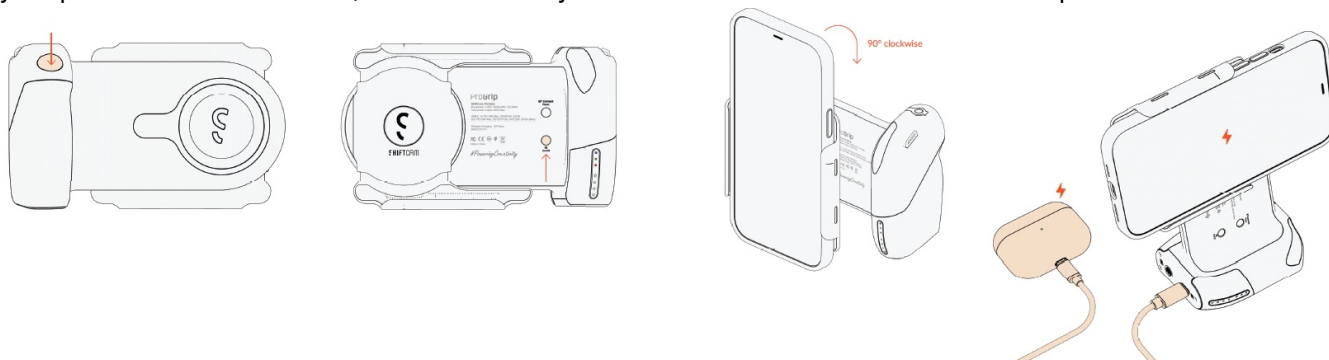

### Connecting to Bluetooth Shutter

Press the shutter button and select "Shift Cam ProGrip" on your smartphone to pair. Short press to take photo, long press to take burst/video.

### Wireless Charging

Press the Charging Button and attach your smartphone onto the ProGrip securely.

### Power Bank

Charge other devices simultaneously with ProGrip using USB-C cable.

## ShiftCam ProGrip

### Regulator Compliance

We Shift Cam Limited, declare under our sole responsibility that the product PG0001 to which this declaration relates, complies with Part 15 of the FCC Rules. Operation is subject to the following two conditions: this device may not cause harmful interference, and (this device must accept any interference received, including interference that may cause undesired operation)

### Federal Communication Commission Interference Statement

This equipment has been tested and found to comply with the limits for a Class B digital device, pursuant to Part 15 of the FCC rules. These limits are designed to provide reasonable protection against harmful interference in a residential installation. This equipment generates, uses, and can radiate radio frequency energy, and if not installed and used in accordance with the instructions, may cause harmful interference to radio communications. However, there is no guarantee that interference will not occur in a particular installation. If this equipment does cause harmful interference to radio or television reception, which can be determined by turning the equipment off and on, the user is encouraged to try and correct the interference by one or more of the following measures:

- Reorient or relocate the receiving antenna
- Increase the distance between the equipment and the receiver
- Connect the equipment to an outlet on a circuit different from that to which the receiver is connected
- Consult the dealer or an experienced radio/TV technician for help

### FCC Caution

Any changes or modifications not expressly approved by the party responsible for compliance could void the user's authority to operate this equipment. Radiation Exposure Statement The device has been evaluated to meet general RF exposure requirement. The device can be used in portable exposure condition without restriction.

### EU Compliance Statement

Shift Cam Limited hereby declares that this product is in compliance with the essential requirements and other relevant provisions of the R&TTE Directive and Radio Equipment Directive 2014/53/EU, and all other applicable EU directive requirements.

### Qi BPP certified and compatible with EPP

The WEEE symbol indicates that this product must not be disposed of with normal household waste. When you dispose of this product you must do so in accordance with local environmental laws and guidelines. For more information how to dispose of this product please contact your local authority, disposal service, or Shift Cam Limited directly.

## Documents / Resources

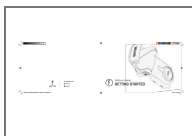

[SHIFTCAM PG0001 ProGrip Starter Kit](#) [pdf] User Guide

PG0001, 2A7IM-PG0001, 2A7IMPG0001, PG0001 ProGrip Starter Kit, PG0001, ProGrip Starter Kit

## References

-  [cam.com - Web Cam Video Chat](#)

Manuals+.