



# Shenzhenshi Shenzhijia Electronic SW001 Wireless Controller for N-SL User Guide

[Home](#) » [Shenzhenshi Shenzhijia Electronic](#) » Shenzhenshi Shenzhijia Electronic SW001 Wireless Controller for N-SL User Guide 

## Shenzhenshi Shenzhijia Electronic SW001 Wireless Controller for N-SL User Guide



### Contents

- [1 Product Description](#)
- [2 Produt Parameter](#)
- [3 Pairing and Connecting](#)
- [4 Motor Vibration Function](#)
- [5 Power Off/Charge/Reconnect/Reset/Low Battery Alarm](#)
- [6 Package](#)
- [7 Documents / Resources](#)
- [8 Related Posts](#)

## Product Description

This product is a wireless Bluetooth gamepad, which belongs to the wireless blue control gamepad (using

wireless Bluetooth technology). It can be remotely controlled and easy to operate. It can be used for the N SL console. It also supports PC x-input PC games.

## Produt Parameter

**Voltage:** DC 5 V  
**Working Current:** <20mA  
**Sleep Current:** 9uA  
**Battery Capacity:** 550mAh  
**Use time:** About 10 hours  
**Charging time:** About 3.5 hours  
**Vibration Current:** 70-120mA  
**Charging Current:** About 180mA  
**USB length:** 70 cm/2.30 ft  
**Bluetooth Transmission Distance:** <10m

## Pairing and Connecting

### Bluetooth Connection in console mode

**Step 1:** Turn on the console, click the settings menu button on the main page interface (Figure), enter the next menu option, click the Airplane Mode option (Figure @), and then click the Controller Connection (Bluetooth) (Figure) option Turn on its Bluetooth function (Figure @).

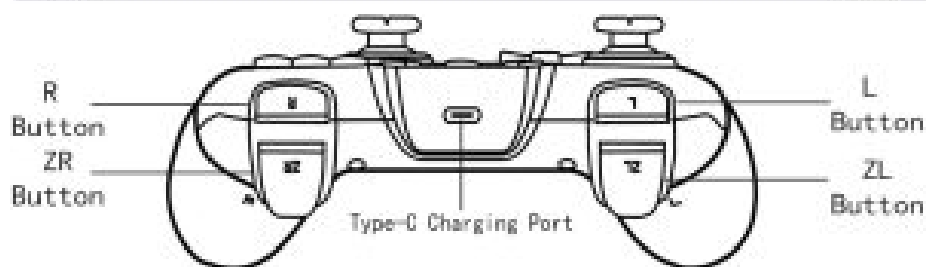
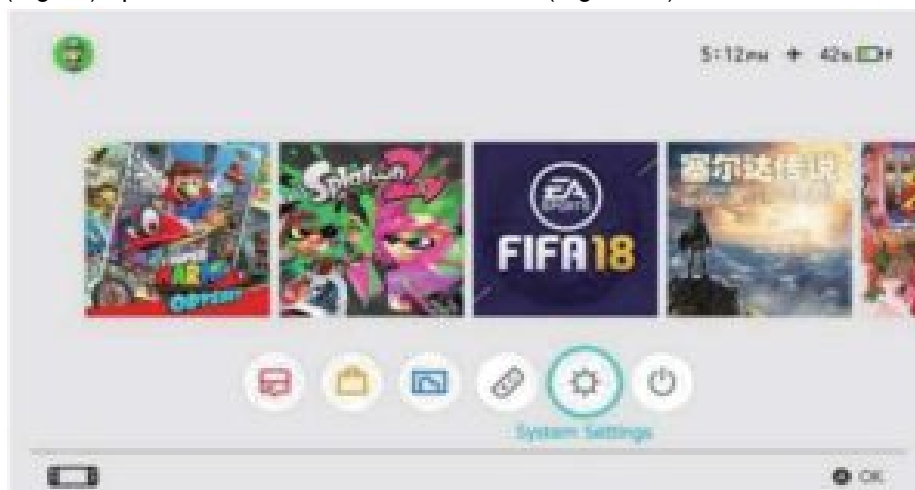

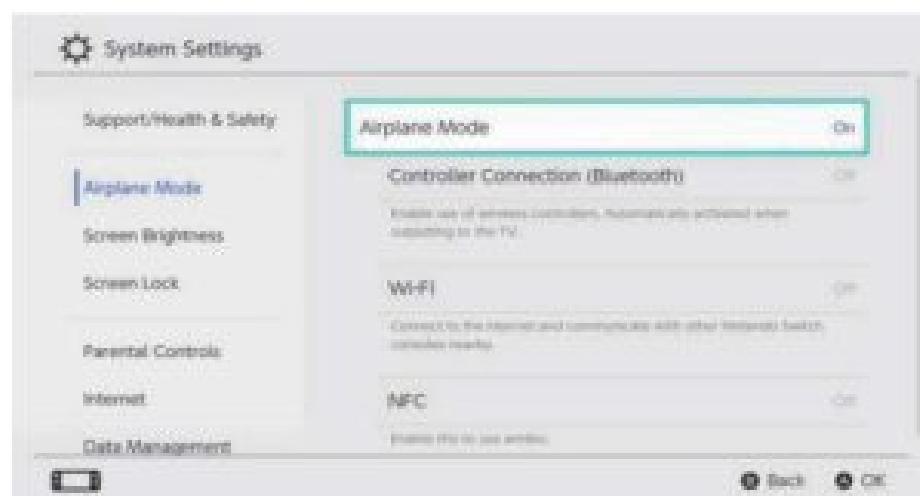
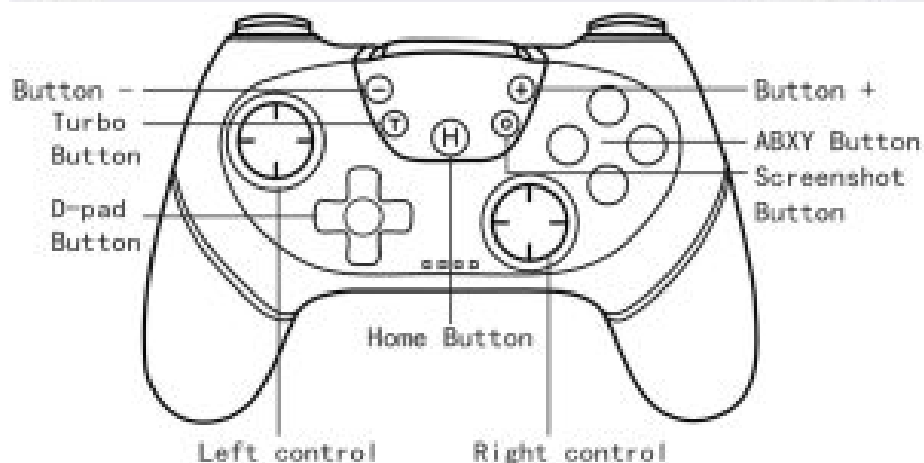
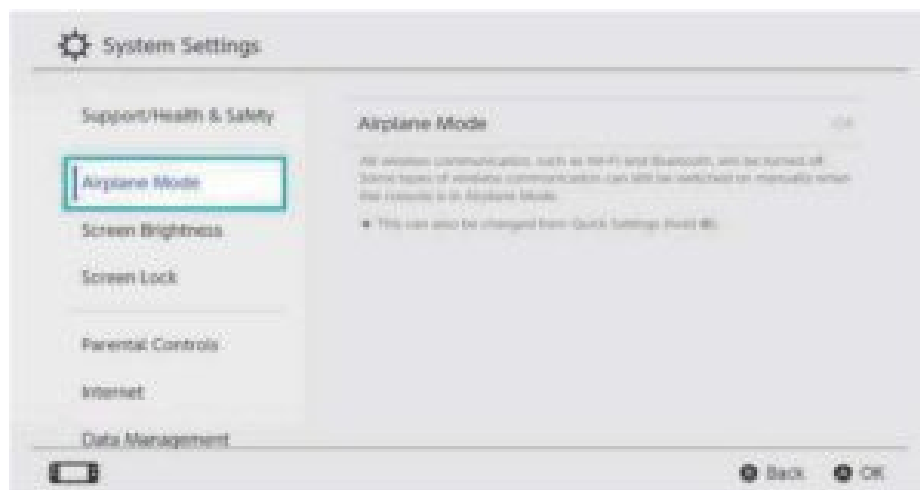

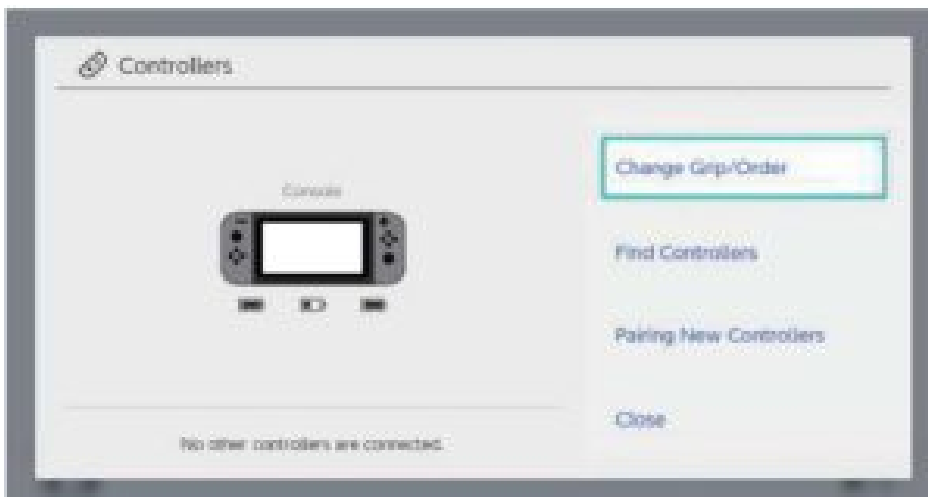
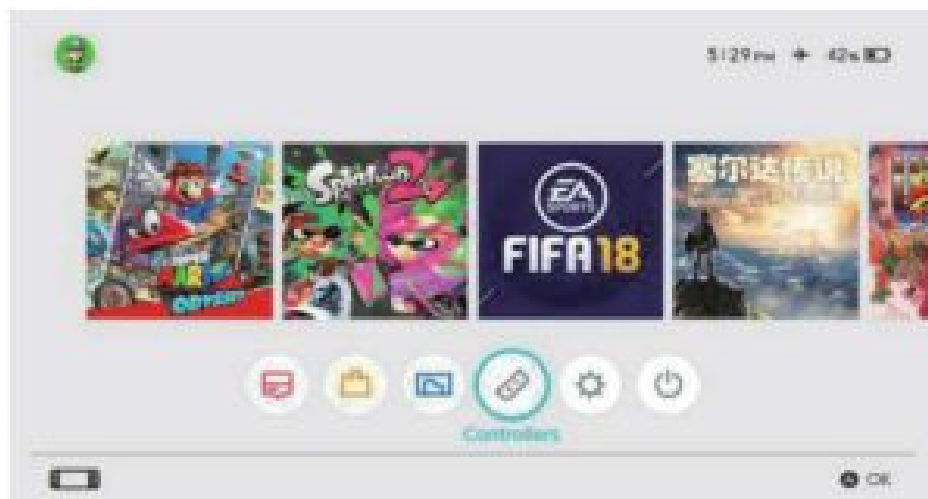

**Step 3:** Press and hold the HOME button for 3-5 seconds to enter the Bluetooth search pairing mode, LED1-LED4 marquee flashes quickly. After the controller is successfully connected to the console, it vibrates and automatically assigns the corresponding channel indicator of the controller to be steady on.





- **Console mode wired connection**

Turn on the wired connection option of the PRO controller on the console, put the console into the console base, and then connect the controller via the data cable, the controller will automatically connect to the console, after the data cable is pulled out, the controller will automatically connect back to the console console via Bluetooth.

- **Wired connection in N-SL mode**

Turn on the wired connection option of PRO handle on the N-SL host, put the console into the base, and then connect the handle through the data cable. pressing any button (A/B/X/Y/ZL/ZR/R/L) of the handle will automatically connect the console and pull out the data cable, then the handle will automatically connect back to the console host through bluetooth.

- **Windows (PC260) mode:**

When the controller is turned off, connect to the PC via a USB cable, and the PC will automatically install the driver. The LED2 on the controller is long on to indicate a successful connection.

The display name: Xbox 360 controller for windows .(wired connection)

## **TURBO Function Setting**

- The controller has the TURBO function, hold down the TURBO button and then press the corresponding button to set the In N-SL mode, A, B, X, Y, L1, R1, L2, R2 can be set In XINPUT mode, you can set A, B, X, Y, L1, R1, L2, R2

## **Adjust Turbo speed**

- Turbo + right 3d up, the frequency increases by one gear Turbo + Right 3d down the frequency by one gear The power-on default is 12Hz; there are three levels (5 times per second — 12 times per second — 20 times per second). When the Turbo combo is executed, the Turbo combo speed LED1 flashes accordingly as the Turbo indicator.

## **Motor Vibration Function**

- The controller has a motor function; it uses a pressure-sensitive motor; the console can manually turn on or off the controller motor vibration. ON/OFF Motor intensity can be adjusted under N-SL platform

- Adjust the motor intensity: turbo+ left 3d up, the intensity increases by one gear turbo+ left 3d down, the intensity is reduced by one gear A total of 4 levels: 100% strength, 70% strength, 30% strength, 0% strength, Power-on default 100%

## Power Off/Charge/Reconnect/Reset/Low Battery Alarm

status	Description
power off	When the controller is turned on, press and hold the HOME button for 5S to turn off the controller.
	When the controller is in the back-connecting state, it will automatically shut down when it cannot be connected after 30 seconds.
power off	When the controller is in the state of code matching, it will enter back connection when the code cannot be matched after 60 seconds, and it will automatically shut down
	When the controller is connected to the machine, it will automatically shut down when there is no button operation within 5 minutes
Reconnect	The console wakes up and reconnects: After the controller is connected to the console, the console is in sleep state, the controller connection indicator is oP, short press the controller HOME button, the indicator light flashes slowly and the marquee flashes back to wake up the console. The console wakes up in about 3-10 seconds on. (The console wake-up state can only be effective by pressing the HOME key)
	Reconnect when the console is powered on: When the console is powered on, press HOME key on the controller to reconnect.
reset	When the controller is abnormal, such as button disorder, crash, failure to connect, etc., you can try to restart the controller. Reset method: Insert a slender object into the Reset hole on the back of the controller, and press the Reset button to reset the controller state.
Low battery alarm	When the controller battery voltage is lower than 3.6V (according to the principle of battery characteristics), the light of the corresponding channel flashes slowly, indicating that the controller is low and needs to be charged. 3.45V low power shutdown.

## Package

- 1 X Controller
- 1 X USB Charging Cable
- 1 X User Instruction

## Documents / Resources

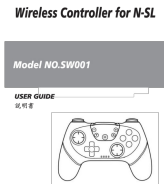
	<a href="#">Shenzhenshi Shenzhijia Electronic SW001 Wireless Controller for N-SL</a> [pdf] User Guide SW001, 2A2T3-SW001, 2A2T3SW001, SW001 Wireless Controller for N-SL, Wireless Controller for N-SL
---	--

