



Shenzhen YZC-06 multi-platform wireless reciever controllep Instruction Manual

[Home](#) » [Shenzhen](#) » Shenzhen YZC-06 multi-platform wireless reciever controllep Instruction Manual 

Contents

- [1 Shenzhen YZC-06 multi-platform wireless reciever controllep](#)
- [2 Product Features](#)
- [3 Introduction to buttons](#)
 - [3.1 Handle battery display](#)
- [4 Specifications](#)
- [5 FCC](#)
- [6 Documents / Resources](#)
- [7 Related Posts](#)

Shenzhen

Shenzhen YZC-06 multi-platform wireless reciever controllep



Product Features

1. The handle is mainly X-360 host, but also supports Windows computer and P3 host.
2. The handle supports dual motor vibration function.
3. Wireless 2.4G connection, strong anti-interference ability, stable connection signal, and free control.
4. There is no need to load any drivers, the handle is connected to the 360 host/P3 host / PC computer be usable.
5. The PC can be switched to X-input or D-input at will without loading any drivers.
6. When the handle is charged, the game can also be played normally.
 1. The handle (receiver) can be upgraded with updated software by connecting to a computer.

Warm Tips: The wireless receiver only can compatible with this controller, it can't work with the original X-360 controller.

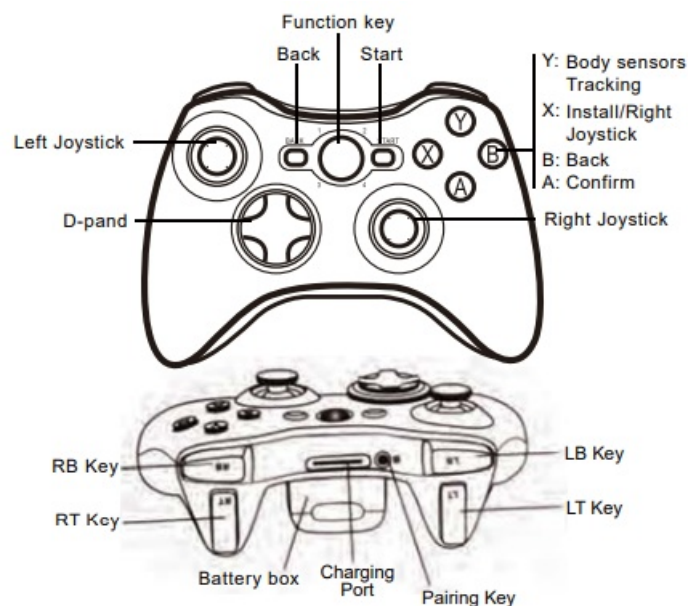

Introduction to buttons

Handle end:

1. X-360 key*1: Turn on the handle or execute commands from the host, and switch between X-Input and D-input.
2. Direction keys*1 group: up, down, left, right.
3. Function control keys *10: A, B, Y, X, LB, RB, LT, RT, BACK, START
4. Left and right joysticks*2: 3D joysticks, including joystick buttons.
5. Reset button *1: Press this button to turn off the power of the handle, and disconnect the handle from the receiver (reset).

Second, even machine guidance

1. Connect to the 360 host via 2.4G wireless

When the 360 host is turned on, connect the receiver's USB connector to the 360 host. At this time, the receiver's LED light starts to flash to enter the pairing mode, and then press the X-360 button on the handle to wake up the handle, and the handle LED1~LED4 flashes for pairing, pairing After success, the receiver LED is always on, and the handle channel light is always on to operate.

2. Connect to P3 host via 2.4G wireless

When the host is turned on, connect the USB connector of the receiver to the P3 host. At this time, the receiver's LED light starts to flash to enter the pairing mode, and then press the X-360 button on the handle to wake up the handle, and the handle LED1~LED4 flashes for pairing, the pairing is successful After the receiver LED is always on, and the handle channel light is always on, the operation can be performed.

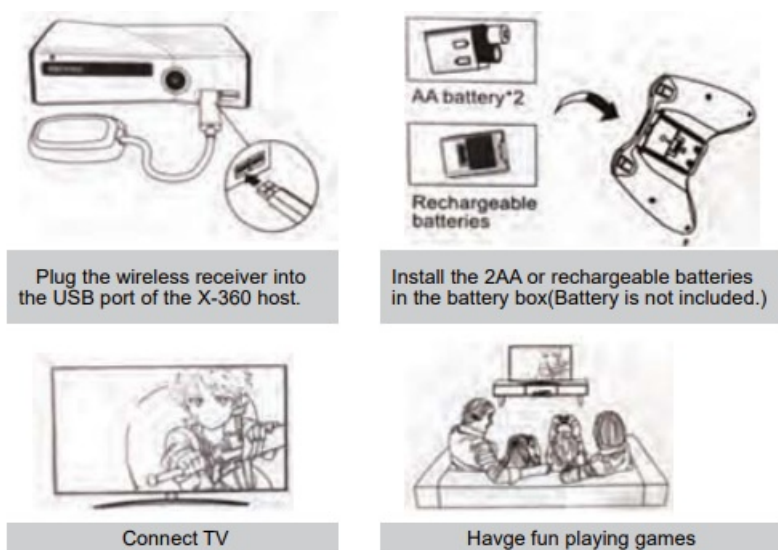

Note:

In P3 host/PC computer mode, there is no vibration function.

3. Connect to PC computer wirelessly via 2.4G

When the PC computer is turned on, connect the USB connector of the receiver to the PC computer. At this time, the receiver LED light starts to flash to enter the pairing mode, and then press the X-360 button on the handle to wake up the handle, and the handle LED1~LED4 flashes for pairing, the pairing is successful After the receiver LED is always on, the handle LED2 is always on to operate, and the PC computer is connected to the X-input mode by default; long press the handle X-360 button for 5 seconds, it will switch to D-input mode, at this time the LED1 on the handle, LED2 is always on, and the handle is in PC digital mode at this time.

Short press the X-360 key to switch the cross key mode, when LED1 is on, it is the PC simulation mode. Remark 1: In PC mode, there is no vibration function.

Handle battery display

1. When the handle is connected to the X-360 dedicated charging cable for charging, the red LED on the charging cable lights up, indicating that the handle is charging. When the light on the X-360 dedicated charging cable turns green, it indicates that the hand is now fully charged and the handle The battery pack is fully charged.
2. The handle can work normally and vibrate when the battery power is greater than 2.2V, but the handle will be disconnected when the power is too low when the battery power is lower than 2.1V. At this time, replace the battery (dry battery) or charge the battery (battery pack).

Note: When the handle uses 1.5V dry batteries, do not charge the handle to avoid danger! !

Specifications

Connection Way:	2.4GWireless (Include receiver)
working voltage :	3.0V
Working current :	25mA(motor doesn't vibrate) 180mA(motor vibrate)
Range:	8~10m
Size:	152*105*58mm
Weight:	249g
Color:	Black / White
Applications:	X-360 Console,PC,P3

FCC

This device complies with part 15 of the FCC Rules. Operation is subject to the following two conditions: (1) this device may not cause harmful interference, and (2) this device must accept any interference received, including interference that may cause undesired operation.

Any changes or modifications not expressly approved by the party responsible for compliance could void the user's authority to operate the equipment.

NOTE: This equipment has been tested and found to comply with the limits for a Class B digital device, pursuant to Part 15 of the FCC Rules. These limits are designed to provide reasonable protection against harmful interference in a residential installation. This equipment generates, uses and can radiate radio frequency energy and, if not installed and used in accordance with the instructions, may cause harmful interference to radio communications. However, there is no guarantee that interference will not occur in a particular installation.

If this equipment does cause harmful interference to radio or television reception, which can be determined by turning the equipment off and on, the user is encouraged to try to correct the interference by one or more of the following measures:

- Reorient or relocate the receiving antenna.
- Increase the separation between the equipment and receiver.
- Connect the equipment into an outlet on a circuit different from that to which the receiver is connected.
- Consult the dealer or an experienced radio/TV technician for help.

The device has been evaluated to meet general RF exposure requirement. The device can be used in portable

exposure condition without restriction

Documents / Resources

	<p>Shenzhen YZC-06 multi-platform wireless reciever controllep [pdf] Instruction Manual YZC-06 multi-platform wireless reciever controller, multi-platform wireless reciever controller, re ciever controller</p>
---	---