



SHENZHEN



**Temperature & Humidity
Sensor Parameter
User Start Guide**

Contents [[hide](#)]

- [1 WL-TH6R Temperature Humidity Sensor Parameter](#)
- [2 Packing List](#)
- [3 Product Introduction](#)
- [4 Specification](#)
- [5 Installation Method](#)
- [6 Documents / Resources](#)
 - [6.1 References](#)

WL-TH6R Temperature Humidity Sensor Parameter

Warnings

1. This product is NOT a toy. Please keep children away from this product.
2. This product is designed for indoor use only. Do NOT use in humid environments or outdoors.
3. Beware of moisture, do NOT spill water or other liquids onto the product.
4. Do NOT attempt to repair this product by yourself. All repairs should be performed by an authorized professional.
5. This product is only suitable for improving the entertainment, convenience of your home life and reminding you about the device status. It should NOT be used as security equipment for home, building, warehouse or any other places. If a user violates the product use instructions, the manufacturer will NOT be liable for any risks and property losses.

Packing List



Product Introduction



Specification

Temperature & Humidity Sensor Parameter

Battery type	1.5V DC (2*AAA)
Temperature detection range	-20°C ~ 60°C/(4°F~140°F)
Humidity detection range	0%-99% RH
Wireless distance	≤100m (open area)
Wireless protocol	433 MHz RF
Max transmit power	13dBm
Temperature accuracy	±0.3°C/± 0.54°F
Humidity accuracy	±3% RH
Weight	19.5g
Size (H*W*D)	72*25*20 mm

Installation Method

* To ensure stable wireless communication, please avoid installing on metal surfaces.

Extra Sensors: Use adhesive to stick the sensor to the wall, or use a lanyard to hang the sensor in an appropriate position.

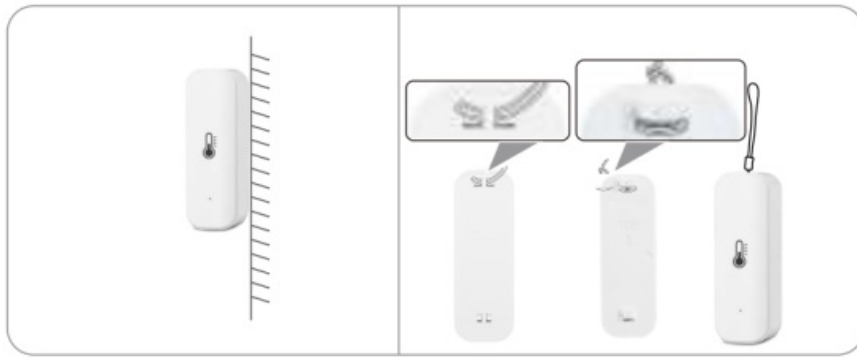

* Please ensure that the surface of the attachment location is clean and dry.

This device complies with part 15 of the FCC Rules. Operation is subject to the following two conditions: (1) This device may not cause harmful interference, and (2) this device must accept any interference received, including interference that may cause undesired operation.

Any Changes or modifications not expressly approved by the party responsible for compliance could void the user's authority to operate the equipment.

Note: This equipment has been tested and found to comply with the limits for a Class B digital device, pursuant to part 15 of the FCC Rules. These limits are designed to provide reasonable protection against harmful interference in a residential installation. This equipment generates uses and can radiate radio frequency energy and, if not installed and used in accordance with the instructions, may cause harmful interference to radio communications. However, there is no guarantee that interference will not occur in a particular installation. If this equipment does cause harmful interference to radio or television reception, which can be determined by tuning the equipment off and on, the user is encouraged to try to correct the interference by one or more of the following measures:

- Reorient or relocate the receiving antenna.
- Increase the separation between the equipment and receiver.
- Connect the equipment into an outlet on a circuit different from that to which the receiver is connected.
- Consult the dealer or an experienced radio TV technician for help.

FCC Radiation Exposure statement

The device has been evaluatec to meel general RF exposure requirement. The device can be used in portable exposure condition without restriction.

SHENZHEN

Power a Sustainable and Smart Life



Only suitable for safe use in non-tropical climates



Documents / Resources

	<p>SHENZHEN WL-TH6R Temperature Humidity Sensor Parameter [pdf] User Guide</p> <p>2A2X7-WL-TH6R, 2A2X7WLTH6R, wl th6r, WL-TH6R Temperature Humidity Sensor Parameter, WL-TH6R, Temperature Humidity Sensor Parameter, Humidity Sensor Parameter, Sensor Parameter, Parameter</p>
---	--

References

- [User Manual](#)

Shenzhen

2A2X7-WL-TH6R, 2A2X7WLTH6R, Humidity Sensor Parameter, PARAMETER, Sensor Parameter, Shenzhen, Temperature Humidity Sensor Parameter, wl th6r, WL-TH6R Temperature Humidity Sensor Parameter

—Previous Post

[Shenzhen C3, C5 Wireless Earbuds User Manual](#)

Next Post—

[Shenzhen TWS5.3 Bluetooth Headset User Manual](#)

Leave a comment

Your email address will not be published. Required fields are marked *

Comment *

Name

Email

Website

☐ Save my name, email, and website in this browser for the next time I comment.

Post Comment

Search:

e.g. whirlpool wrf535swhz

Search

[Manuals+](#) | [Upload](#) | [Deep Search](#) | [Privacy Policy](#) | [@manuals.plus](#) | [YouTube](#)

This website is an independent publication and is neither affiliated with nor endorsed by any of the trademark owners. The "Bluetooth®" word mark and logos are registered trademarks owned by Bluetooth SIG, Inc. The "Wi-Fi®" word mark and logos are registered trademarks owned by the Wi-Fi Alliance. Any use of these marks on this website does not imply any affiliation with or endorsement.