



Shenzhen WIFI703 SMART WiFi PIR Motion Sensor User Manual

[Home](#) » [Shenzhen](#) » Shenzhen WIFI703 SMART WiFi PIR Motion Sensor User Manual 

Contents

- [1 Shenzhen WIFI703 SMART WiFi PIR Motion Sensor](#)
- [2 Product Description](#)
- [3 Function Description](#)
- [4 Installation and Test](#)
- [5 Precautions](#)
- [6 APP instruction](#)
- [7 Smart Link mode](#)
- [8 AP mode](#)
- [9 Delete device](#)
- [10 PIR detection alarm](#)
- [11 Detection area](#)
- [12 FCC STATEMENT](#)
- [13 Documents / Resources](#)
 - [13.1 References](#)
- [14 Related Posts](#)



SHENZHEN

Shenzhen WIFI703 SMART WiFi PIR Motion Sensor



Product Description

- The core component of the smart motion sensor is the infrared sensor (PIR sensor), which works through the cooperation of the optical system to detect the thermal radiation in a certain area. When someone moves in the detection area, the infrared thermal radiation of the detector will change.
- The detector uses a fully digital CPU processor, adopting automatic temperature compensation technology to prevent low sensitivity caused by temperature variation. It adopts the IoT Wi-Fi technology to connect the infrared detector to the cloud platform, make users to receive alarm information in the first time.

Applicable Place

Suitable for residential, shopping malls, warehouses, restaurants, parking lots, libraries, schools, hospitals, etc.

Function Description

1. Imported passive infrared sensor with higher precision.
2. Customized Fresnel lens, more stable and reliable.
3. Specialized detection angle design.
4. Support alarm light signal, and network indicator.
5. Support on-site alarm (LED flashing) and remote alarm (push to mobile APP via Wi-Fi connection cloud platform).
6. Long-life power supply design, the battery can work for 1 year after being fully charged.
7. Support low power detection and daily inspection.

Electrical Specifications

- **Operating voltage:** 3.7V 500mA lithium battery (5V/1A micro USB charging port)
- **Detecting distance:** ≤ 9 meters

- **Detecting angle:** 115°
- **Power consumption:** max current ≤ 90mA, standby current: ≤ 20JA.
- **Wi-Fi:** 2.4G frequency support
- **Working temperature:** -20~50 °C
- **Working humidity:** 10%~95% RH
- **Installation way:** wall-mounted / ceiling-mounted
- **Anti-white light interference:** ≥8000LUX
- **Application environment:** indoor

Installation and Test

Note:

Make sure the APP configuration is completed before installation.

1. Choose the right installation position, usually at the building entrance, corridor, etc.
2. The best installation height is from 1.8 to 2.2 meters to avoid alarms caused by small animals' movements.
3. Turn on the switch by pushing the button of the device to the "on" status, the red LED will be on and the sensor warns for 30 seconds until the LED goes out. Configure the Wi-Fi network, the red LED will be on for 1 second after triggering the alarm, the APP interface will display alarm information at the same time. It needs to wait for 30 seconds to be triggered again. If the Wi-Fi configuration fails, the infrared triggering interval is 8 seconds.
4. Install the motion sensor on the wall, the angle is adjustable.
5. When the battery power is low, the APP interface will display a low battery, please charge it in time. When the blue indicator is off, the charging is finished.

Precautions

1. It is not advisable to install it by facing the glass doors and windows, to prevent white light interference;
2. It is not advisable to install it face to large objects that move frequently, it will cause changes in the infrared rays and lead to false alarms.
3. It is not advisable to install it face to the hot and cold vents, as it will cause changes in the infrared rays and lead to false alarms;
4. The detection area should not have any obstacles.

APP instruction

1. Download "Smart Life" APP

Search "smart life" in the application market to download and install the App

2. Registration

Click the APP and register an account according to the wizard.



3. Add or delete devices

Click the APP and log in, click Add Device -> Security Sensor -> Sensor (Wi-Fi)

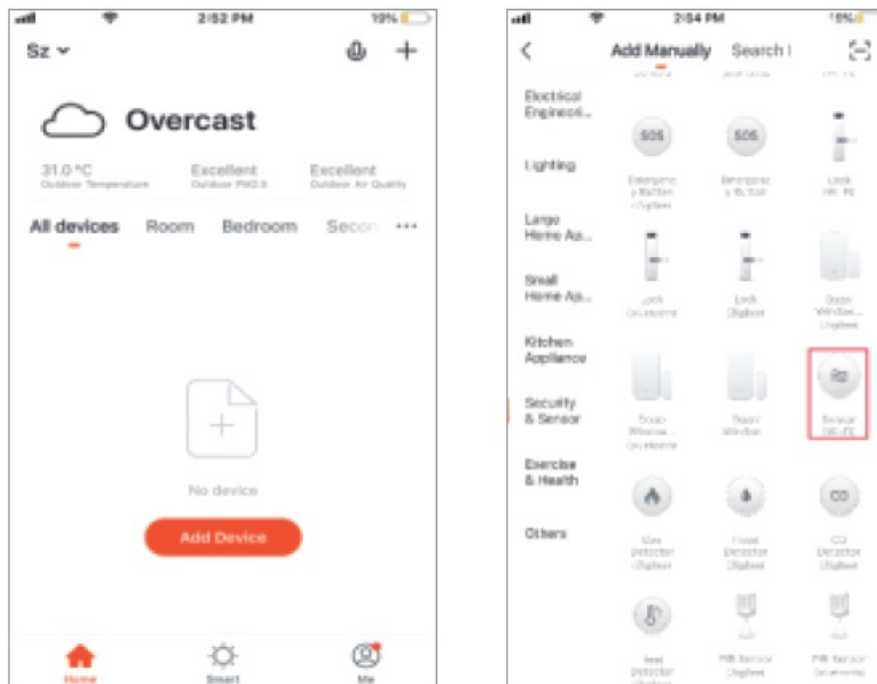

Turn on the battery switch, press the “RESET” button side of the base of the device, and hold on for 5 seconds to enter into the Wi-Fi configuration state (the red indicator on the front flashes fast indicating that it is in the smart link configuration mode. If the indicator light flashes slowly, it indicates the AP configuration mode). The APP interface displays two modes which can be switched to each other before the configuration starts. As below:

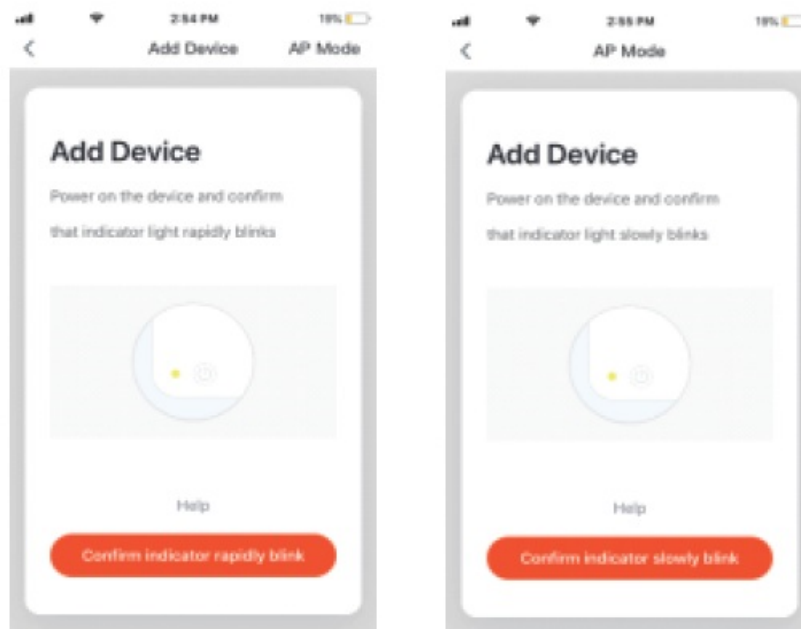

Input the Wi-Fi SSID and password according to the APP prompt and start a connection, wait about 60 seconds to complete the device's network configuration and its connection to the Tuya cloud server, synchronization with the APP. It will jump to the APP operation and monitoring interface directly when the device is added completely. You can modify the device name or share the device with other people on the APP directly. The device operation interface can see its status, alarm, offline and alarm release, etc., check history records, and other setting options.

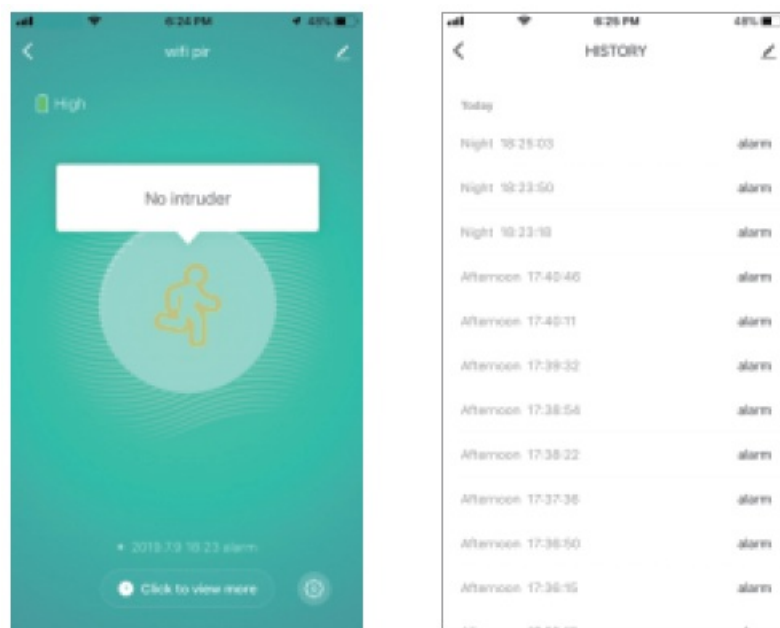

Remarks:

- Ensure the device and APP work under the same Wi-Fi network to make sure the validity of the device which is set through SMART LINK or AP mode, then the device information recognized by the APP is valid.
- When the SMART LINK mode does not work due to Wi-Fi network configuration, use AP mode to configure the device and APP.

Smart Link mode

When configuring in SMART LINK mode, make sure that the Wi-Fi network connects to the Internet normally, then ensure the APP and the device work in the same Wi-Fi network. Input the SSID and password to connect the device with the cloud server to accomplish the configuration. If need a different Wi-Fi network, use “Change network” through the APP.

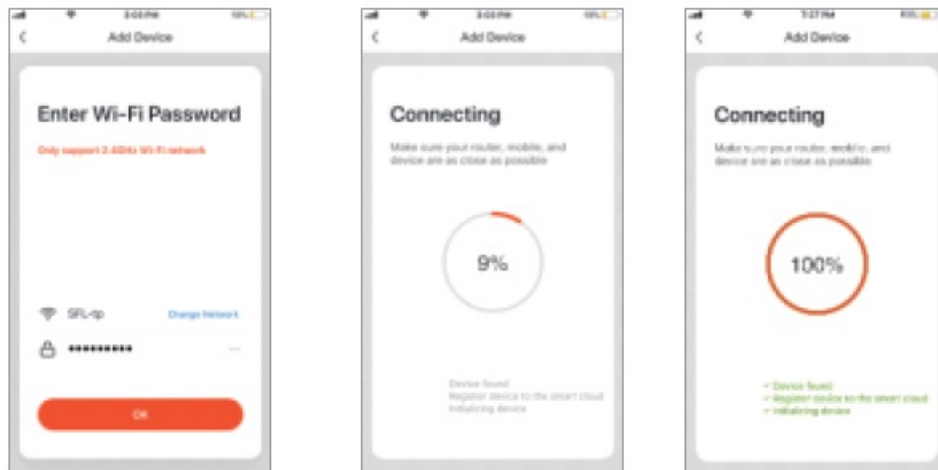

AP mode

When configuring in AP mode, make sure that the Wi-Fi network is connected to the Internet normally, then ensure the APP and the device work in the same Wi-Fi network. Input the SSID and password to run the APP (mobile or tablet) by connecting to the Wi-Fi network “SmartLife-xxxx” in the AP mode “(select by the Wi-Fi Network list), and return to the APP when connected successfully, it will complete the configuration automatically

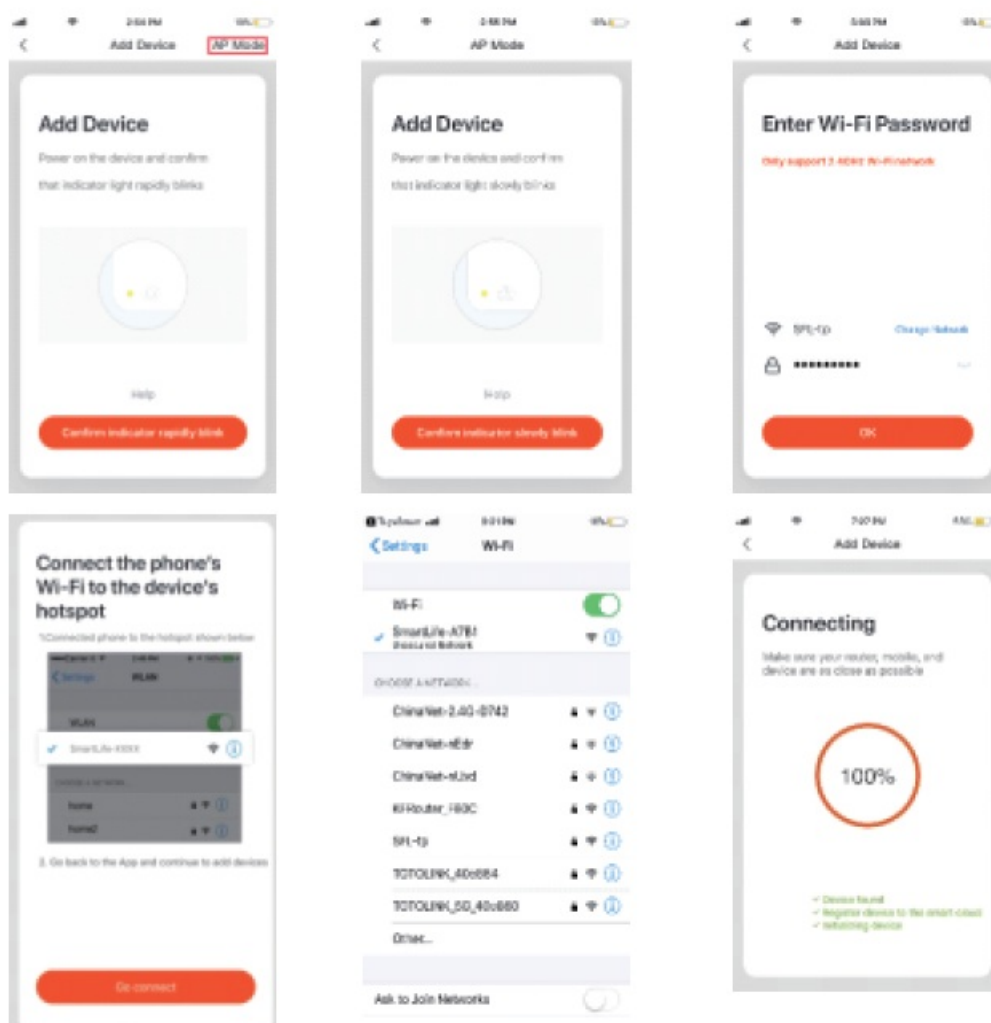

When the device is added to the Tuya smart user account, the indicating light will be off, the APP will jump to the operation interface, indicating that the device is added successfully. If not succeed, repeat the steps until it is added successfully.

Delete device

Select the “Edit” icon to enter into the operation interface of the device. Click “Remove device” to delete it.

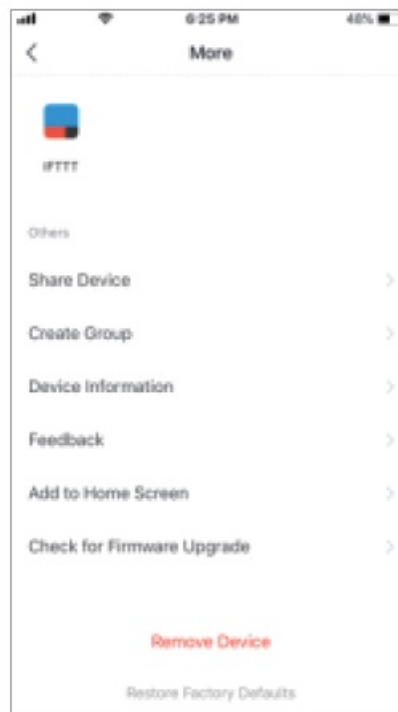
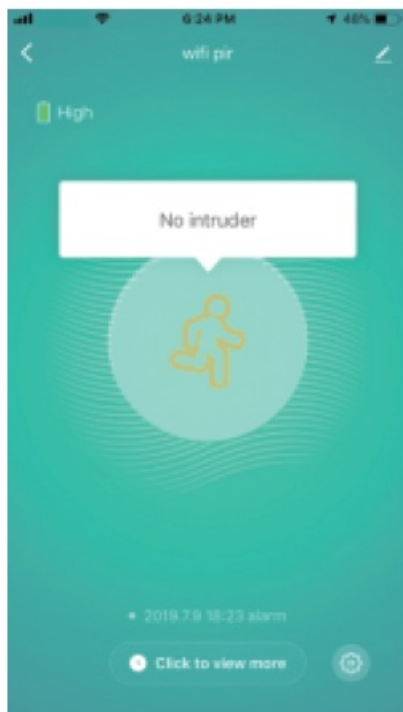

PIR detection alarm

When the PIR sensor is triggered, the alarm data will be delivered to the cloud server, the cloud server will transmit the alarm information to the APP simultaneously. The APP interface displays as below:

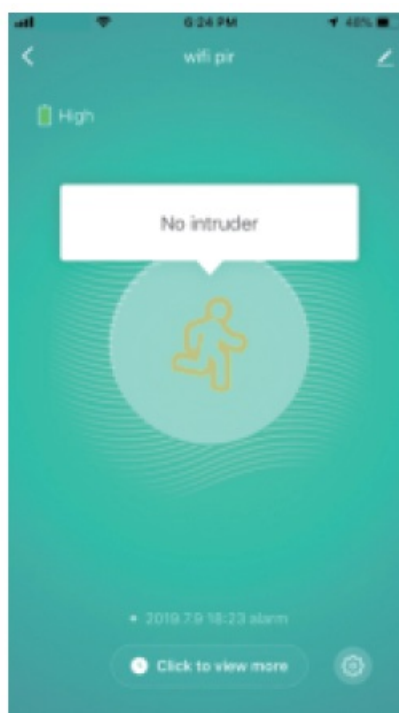
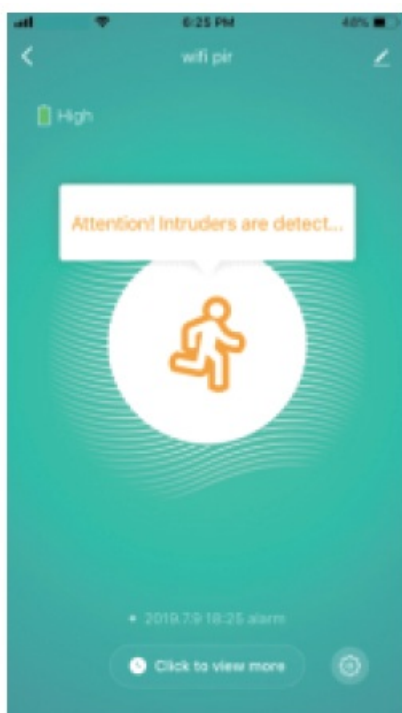

Other operations

For other operations of the device and APP, please pay attention to the design and updates of the APP and the device.

Detection area

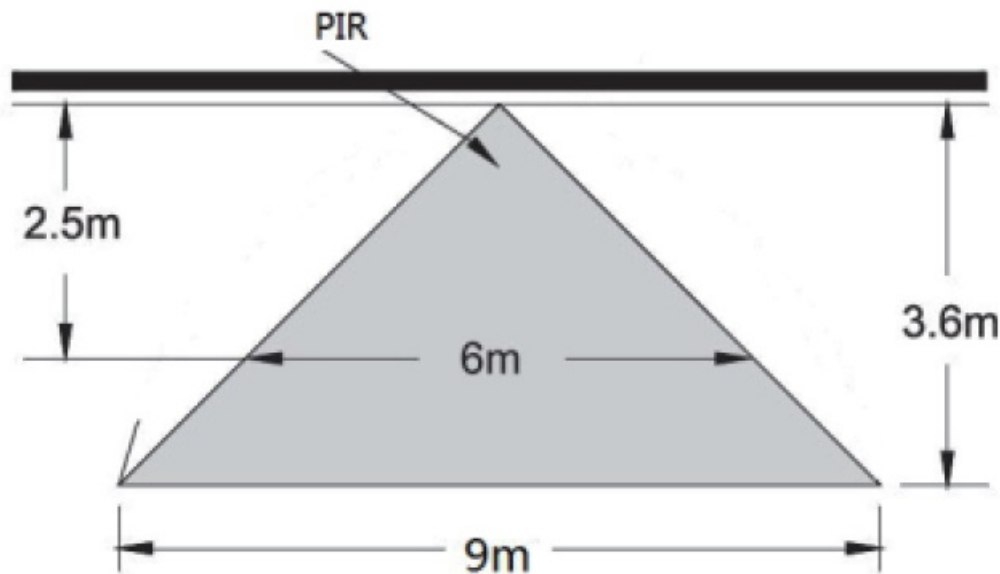

FCC STATEMENT

This device complies with part 15 of the FCC Rules. Operation is subject to the following two conditions:

1. This device may not cause harmful interference, and
2. This device must accept any interference received, including interference that may cause undesired operation.

Any Changes or modifications not expressly approved by the party responsible for compliance could void the user's authority to operate the equipment.

Note:

This equipment has been tested and found to comply with the limits for a Class B digital device, under part 15 of the FCC Rules. These limits are designed to provide reasonable protection against harmful interference in a residential installation. This equipment generates uses and can radiate radio frequency energy and, if not installed and used per the instructions, may cause harmful interference to radio communications.

However, there is no guarantee that interference will not occur in a particular installation. If this equipment does cause harmful interference to radio or television reception, which can be determined by turning the equipment off and on, the user is encouraged to try to correct the interference by one or more of the following measures:

- Reorient or relocate the receiving antenna.
- Increase the separation between the equipment and the receiver.
- Connect the equipment to an outlet on a circuit different from that to which the receiver is connected.
- Consult the dealer or an experienced radio/TV technician for help.

This equipment complies with FCC radiation exposure limits set forth for an uncontrolled environment. This equipment should be installed and operated with a minimum distance of 20cm between the radiator & your body.

Documents / Resources

	<p>Shenzhen WIFI703 SMART WiFi PIR Motion Sensor [pdf] User Manual</p> <p>WIFI703 SMART WiFi PIR Motion Sensor, WIFI703, SMART WiFi PIR Motion Sensor, WiFi PIR Motion Sensor, PIR Motion Sensor, Motion Sensor, Sensor</p>
---	---

References

- [User Manual](#)