



SHENZHEN

## **S01 Computer Element Bluetooth Speaker**



# **Shenzhen S01 Computer Element Bluetooth Speaker User Manual**

[Home](#) » [Shenzhen](#) » Shenzhen S01 Computer Element Bluetooth Speaker User Manual 

### **Contents**

- [1 Shenzhen S01 Computer Element Bluetooth Speaker](#)
- [2 Product Specifications](#)
- [3 Product Usage Instructions](#)
- [4 Frequently Asked Questions \(FAQ\)](#)
- [5 PRODUCT OVERVIEW](#)
- [6 Warranty](#)
- [7 Product parameters](#)
- [8 FCC Caution.](#)
- [9 Documents / Resources](#)
  - [9.1 References](#)
- [10 Related Posts](#)



SHENZHEN

**Shenzhen S01 Computer Element Bluetooth Speaker**



## Product Specifications

- **Product Name:** Computer Element Bluetooth Speaker
- **Product Model:** S01
- **Bluetooth Name:** S01
- **Battery Capacity:** 1500mAh
- **Input:** 5V 0.8A
- **Power:** 4W
- **Bluetooth Version:** 5.3
- **Product Size:** 71mm x 75mm x 96mm
- **Product Weight:** 203g
- **Manufacturer:** Shenzhen Blue Square Technology Co., Ltd
- **Address:** Room 1104, Building 4, Phase III, Jindi Kaixuan Plaza, Nanlian Community, Longgang Street, Longgang District, Shenzhen

## Product Usage Instructions

### Power and Playback Controls:

- **Power Button:** Long press to turn on or off the speaker.
- **Pause/Play Button:** Press to pause while playing music, then press again to resume play.
- **Volume Reduction/Previous Song:** Press once to decrease the volume or twice to play the previous song.
- **Volume Up/Next Song:** Press once to increase the volume or twice to play the next song.

### Lighting Display Controls:

- **Display Screen Lighting Control Button:** Press to change lighting effects between default breathing color, music rhythm effect, and off.
- **Type-C Charging Indicator Light:** Red light stays on during charging and turns off when fully charged.

### Bluetooth Pairing:

Could you pair the speaker with Bluetooth model S01 by following the instructions for your specific device?

### Microphone Communication Port:

Use the microphone communication port for voice calls or other communication needs.

### Horn:

The speaker is equipped with a horn for clear sound output.

## Frequently Asked Questions (FAQ)

### • How do I charge the Bluetooth speaker?

To charge the speaker, connect the Type-C charging cable to the appropriate port on the speaker and plug the other end into a power source.

### • How do I know when the speaker is fully charged?

The red charging indicator light will stay on during charging and turn off once the speaker is fully charged.

### • How can I switch between different lighting effects?

Press the display screen lighting control button to cycle between default breathing color effect, music rhythm effect, and turning off the lights.

## PRODUCT OVERVIEW

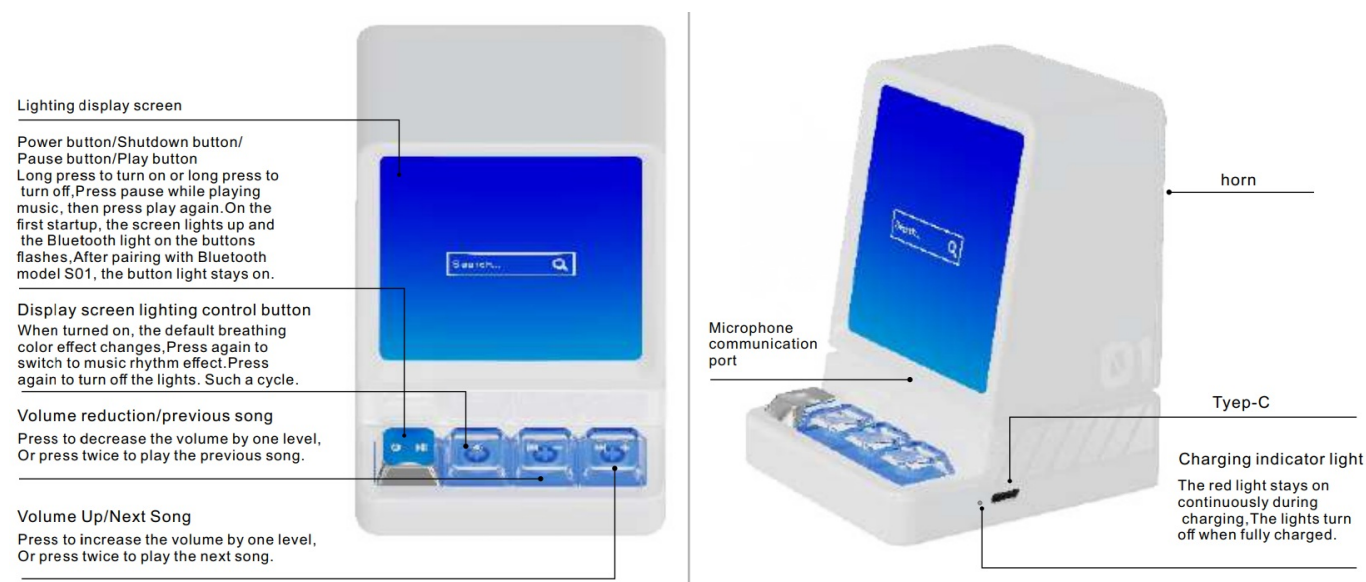

### Note:

1. Make sure to read the product manual in detail and operate it correctly according to the instructions. It is recommended to fully charge the product when it is firstly used.
2. Self-removal: This product is not installed with any self-removal/ Spare parts for maintenance.
3. It is strictly forbidden to let the product continue to contact heat sources, put this product into fire, water or

flammable or wet places. It is strictly forbidden to charge the product in an environment below 0°C.

4. Please do not move, knock or attack this product with great force. If the product is accidentally bumped by a strong force or squeezed hardly or dropped from a height of more than 1 meter, and the casing is deformed or bulged, please stop using this product.
5. Once the product becomes abnormally hot or there is liquid leakage, please stop using it immediately. If liquid splashes into your eyes, please do not rub your eyes. Wash your eyes with clean water immediately, and seek medical attention immediately if it is serious.
6. To avoid abnormalities with this product, it is recommended to use charging cables, adapters, power adapters and others that have obtained "CCC" certification and meet standard requirements.
7. Please dispose of discarded electrical products and equipment in accordance with national environmental protection regulations. The substance name and content of the harmful substance contained:

## Warranty

Warranty repair (Warranty scope is limited to the host machine, excluding accessories and gifts)

1. Users who purchase this product will enjoy "three guarantees" services in accordance with relevant national regulations.
2. If The product itself has quality problems, has not been artificially damaged, has not been dismantled and repaired, and is intact, it can be replaced in 15 days.
3. Those who purchase this product receive free repair service for one year.
4. In the following situations, the free warranty will be invalid and maintenance services will be provided, but corresponding accessories and labor repair fees will be charged during maintenance:
  - Damage caused by human factors, including damage caused by use in abnormal working environment and failure to follow the instruction manual.
  - The user disassembles the machine without permission, repairs or modifies it, or has it repaired by a non-company maintenance department or an unauthorized organization.
  - Damage caused by force majeure.
  - There is no product warranty card and valid purchase voucher (invoice), and the user information file cannot be checked.
  - The product barcode and production date are torn (outer packaging), and the warranty period has expired.

## Product parameters

- **Product Name:** Computer Element Bluetooth Speaker
- **Product model:** S01
- **Bluetooth name:** S01
- **Battery capacity:** 1500mAh
- **Input:** 5V 0.8A
- **Power:** 4W
- **Bluetooth version:** 5.3
- **Product size:** 71mm X75mm X96mm
- **Product weight:** 203g

- **Manufacturer:** Shenzhen Blue Square Technology Co.,
- **LtdAddress:** Room 1104, Building 4, Phase III, Jindi Kaixuan Plaza, Nanlian Community, Longgang Street, Longgang District, Shenzhen

## FCC Caution.

### 15.19 Labelling requirements.

This device complies with part 15 of the FCC Rules. Operation is subject to the following two conditions:

1. This device may not cause harmful interference
2. this device must accept any interference received, including interference that may cause undesired operation.

### 15.21 Changes or modification warning

Any Changes or modifications not expressly approved by the party responsible for compliance could void the user's authority to operate the equipment.

### 15.105 Information to the user.

**Note:** This equipment has been tested and found to comply with the limits for a Class B digital device, pursuant to part 15 of the FCC Rules. These limits are designed to provide reasonable protection against harmful interference in a residential installation. This equipment generates uses and can radiate radio frequency energy and, if not installed and used in accordance with the instructions, may cause harmful interference to radio communications. However, there is no guarantee that interference will not occur in a particular installation. If this equipment does cause harmful interference to radio or television reception, which can be determined by turning the equipment off and on, the user is encouraged to try to correct the interference by one or more of the following measures:

- Reorient or relocate the receiving antenna.
- Increase the separation between the equipment and receiver.
- Connect the equipment into an outlet on a circuit different from that to which the receiver is connected.
- Consult the dealer or an experienced radio/TV technician for help.

## Documents / Resources

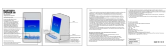
	<p><a href="#">Shenzhen S01 Computer Element Bluetooth Speaker</a> [pdf] User Manual 2BKF8-S01, 2BKF8S01, S01 Computer Element Bluetooth Speaker, S01, Computer Element Bluetooth Speaker, Element Bluetooth Speaker, Bluetooth Speaker, Speaker</p>
---	--

## References

- [User Manual](#)

[Manuals+.](#) [Privacy Policy](#)

This website is an independent publication and is neither affiliated with nor endorsed by any of the trademark owners. The "Bluetooth®" word mark and logos are registered trademarks owned by Bluetooth SIG, Inc. The "Wi-Fi®" word mark and logos are registered trademarks owned by the Wi-Fi Alliance. Any use of these marks on this website does not imply any affiliation with or endorsement.