

Shenzhen
**BB01 LED
String
Light**



Shenzhen BB01 LED String Light User Manual

[Home](#) » [Shenzhen](#) » Shenzhen BB01 LED String Light User Manual 

Contents

- 1 [Shenzhen BB01 LED String Light User](#)
- 2 [FAQs](#)
- 3 [PACKING LIST](#)
- 4 [OVERVIEW](#)
- 5 [SPECIFICATION](#)
- 6 [OPERATION](#)
- 7 [FCC](#)
- 8 [Documents / Resources](#)
 - 8.1 [References](#)
- 9 [Related Posts](#)

Shenzhen

Shenzhen BB01 LED String Light User



FAQs

Q: Can the string lights be used outdoors?

A: Yes, the string lights are waterproof with an IP65 rating, suitable for outdoor use.

Q: How many spare bulbs are provided?

A: The 54FT set includes 2 spare bulbs, and the 104FT set includes 4 spare bulbs.

Q: What should I do if a bulb goes out?

A: Replace the bulb with one of the provided spare bulbs. If you need additional assistance, please contact customer support.

PACKING LIST

	54FT	104FT
String Light	1	1
User Manual	1	1
Spare bulb	2	4
Zip ties	20	40

OVERVIEW

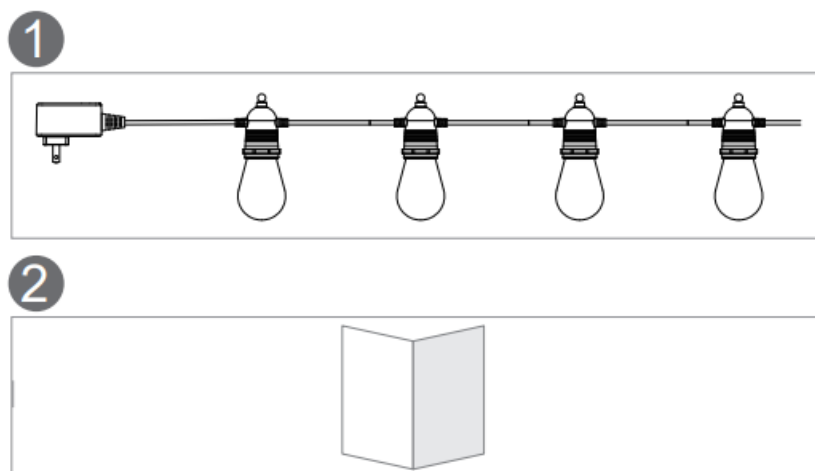

SPECIFICATION

Power	16W	32W
Waterproof Level	IP65	IP65
String Length	54FT	104FT
Color Temperature	2700 \pm 270K	2700 \pm 270K
Quantity Of Bulbs	16pcs+2 spare bulb	32pcs+4 spare bulb
Lamp Spacing	3.2FT	3.2FT
Bulb Type	LED	LED
Material	ABS+PET	ABS+PET
Power Per Bulb	1 W	1 W

OPERATION

Note

1. The power adapter should not be exposed in rainy environments.
2. It is recommended that the installation position of the power supply should not be too high to avoid difficulties in plugging and unplugging.
3. Bulbs should not be installed upside down or immersed in water, and each bulb should be tightened.

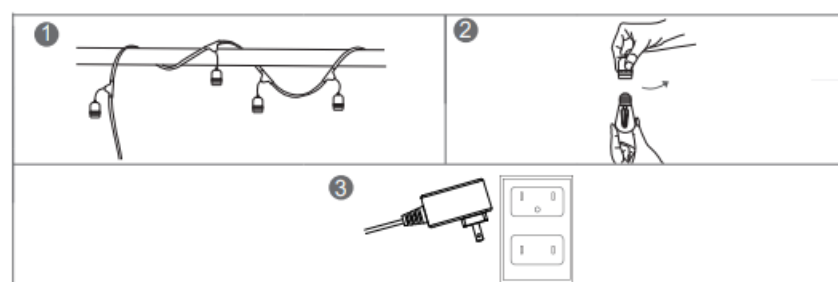

QUALITY ASSURANCE

- All of our string lights provide a 3-year warranty. If you are not 100%

- satisfied with it, please feel free to contact us. Email: amzsupport@yeah.net



For outdoor use, install in a waterproof socket!

FCC

This device complies with part 15 of the FCC Rules. Operation is subject to the following two conditions: (1) this device may not cause harmful interference, and (2) this device must accept any interference received, including interference that may cause undesired operation. Any changes or modifications not expressly approved by the party responsible for compliance could void the user's authority to operate the equipment. NOTE: This equipment has been tested and found to comply with the limits for a Class B digital device, pursuant to Part 15 of the FCC Rules. These limits are designed to provide reasonable protection against harmful interference in a residential installation. This equipment generates, uses, and can radiate radio frequency energy and, if not installed and used in accordance with the instructions, may cause harmful interference to radio communications. However, there is no guarantee that interference will not occur in a particular installation. If this equipment does cause harmful interference to radio or television reception, which can be determined by turning the equipment off and on, the user is encouraged to try to correct the interference by one or more of the following measures:

- Reorient or relocate the receiving antenna.
- Increase the separation between the equipment and the receiver.
- Connect the equipment into an outlet on a circuit different from that to which the receiver is connected.
- Consult the dealer or an experienced radio/TV technician for help.

To maintain compliance with FCC's RF Exposure guidelines, This equipment should be installed and operated with a minimum distance between 20cm the radiator your body: Use only the supplied antenna

Documents / Resources

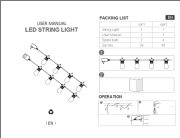
	<p>Shenzhen BB01 LED String Light [pdf] User Manual 2A985-BB01, 2A985BB01, BB01 LED String Light, BB01, LED String Light, String Light, Light</p>
---	---

References

- [User Manual](#)

[Manuals+.](#) [Privacy Policy](#)

This website is an independent publication and is neither affiliated with nor endorsed by any of the trademark owners. The "Bluetooth®" word mark and logos are registered trademarks owned by Bluetooth SIG, Inc. The "Wi-Fi®" word mark and logos are registered trademarks owned by the Wi-Fi Alliance. Any use of these marks on this website does not imply any affiliation with or endorsement.