

Shenzhen Yinshijie Technology R12 Open Wearable Stereo Earbuds



Shenzhen Yinshijie Technology R12 Open Wearable Stereo Earbuds Instruction Manual

[Home](#) » [Shenzhen Yinshijie Technology](#) » Shenzhen Yinshijie Technology R12 Open Wearable Stereo Earbuds Instruction Manual 

Contents

- 1 [Shenzhen Yinshijie Technology R12 Open Wearable Stereo Earbuds](#)
- 2 [Headset connection](#)
- 3 [Multipoint connection](#)
- 4 [Basic functions of the charging case](#)
- 5 [Documents / Resources](#)
 - 5.1 [References](#)
- 6 [Related Posts](#)



SHENZHEN YISHIDA TECHNOLOGY CO., LTD

Shenzhen Yinshijie Technology R12 Open Wearable Stereo Earbuds



Headset connection

First Connection

- **Turn on bluetooth**

Open the earphone box and approach the unlocked mobilephone Search, for a bluetooth device and click on the link

- **Second Connection**

Open the headphone box and the headphones will automatically connect to the phone

Function

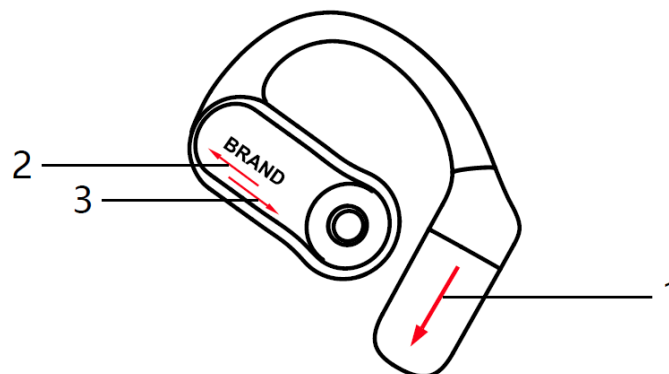

1. In this direction, the battery can be unplugged and replaced
2. Swipe in this direction on the face cover, and you can hear two “clicks, clicks” to increase the volume
3. Slide in this direction on the face cover, and hear two “clicks, clicks” to reduce the volume

Multipoint connection

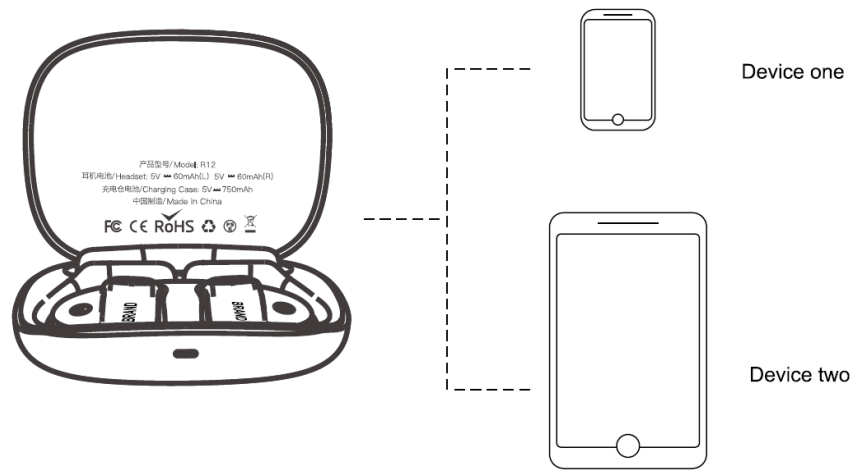

Enable multipoint connection: After the first device is connected, turn off the Bluetooth function of the first device, and the second device can search for connections; After connecting the second device, turn on the Bluetooth function of the first device, and the earbuds will automatically reconnect with the first device.

Factory Reset

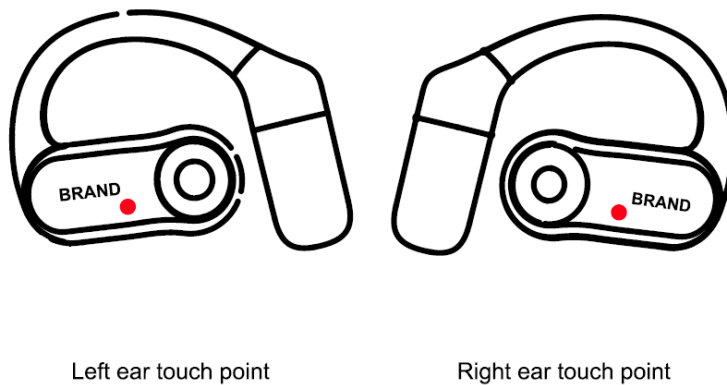

1. Touching either side of the left and right earbuds 6 times in a row will erase all pairing history of Bluetooth and complete the factory reset.
2. Touch the right ear twice to enter the Bluetooth pairing mode, and the Bluetooth can be searched for connection.

Note: Do not use one ear to operate this function, if you touch this function by mistake, please restore the other earphone to factory settings as well, Then touch the right earbud twice to enter pairing mode and reconnect the device.

Headset function operation

Function	Use in both ears	Use in one ear
Pause, play	Touch any earbud once	Touch it
Voice assistant	Press and hold any earbud for three seconds	Press and hold the earphones for three seconds
Previous song	Double-touch any earphone	Touch twice
Next song	Touch any earphone three times	Touch three times
Volume up	Swipe up on the left/right ear touch area	Swipe up on the earphone touch area
Volume down	Swipe down on the left/right ear touch area	The earphone touch area slides down
Factory reset	Touch any earphone six times	
Answer the call	Touch any earbud once	Touch it
Hang up	Double-touch any earphone	Touch twice
Reject a call	Double-touch any earphone	Touch twice
Manual shutdown	Press and hold any earphone for five seconds (the left and right earphones power off at the same time)	Press and hold the earbuds for five seconds
Manual shutdown	Press and hold the left and right earphones for 5 seconds (both the left and right earphones need to be operated)	Press and hold the earbuds for five seconds

The headphones are lit up

Mode	White light	Green light	Remark
charge	Solid on	Not lit	
Fully charged	Not lit	Not lit	
Power on and wait for pairing	The white and green lights flash alternately		
Left and right after pairing	Left and right earphone breathing lights	Not lit	
Once your phone is connected	The left and right earphones flash slowly 5 times	Not lit	
When a call comes in	Solid on	Not lit	
On a call	Flash 1 time in 5 seconds	Not lit	
Low power	Flash 1 time every 1 minute	Not lit	
bootable	Not lit	Bright for 2 seconds	
Shutdown	Bright for 2 seconds	Not lit	
Factory reset	Not lit	Bright for 2 seconds	
warehousing	Not lit	Flash slowly once	

The charging compartment is lit up

Mode		White light	green light	Orange light
charge		Not lit	Not lit	Solid on
Fully charged		Not lit	Solid on	Not lit
Headphones are warehoused		Not lit	Take 1 breath	Not lit
The headset is out of storage		Not lit	Not lit	Not lit
Charge the earbuds and spare batteries		Not lit	Solid on	Not lit
Fully charge the headphones		Breathe 3 times	Not lit	Not lit
Spare batteries are in storage		Take 1 breath	Not lit	Not lit
Spare batteries are out of storage		Not lit	Not lit	Not lit
open close fill electricity granary	Electricity: 75%-100%	Not lit	Breathe 4 times	Not lit
	Electricity: 50%-75%	Not lit	Breathe 3 times	Not lit
	Electricity: 25%-50%	Not lit	Breathe 2 times	Not lit
	Electricity: 10%-25%	Not lit	Take 1 breath	Not lit
	Electricity: 10% <	Not lit	Not lit	Take 1 breath

Description of the feature definition

- **Power on:** The charging compartment is automatically turned on and automatically paired after opening the cover. Shutdown put into the charging compartment and close the cover, the headset automatically shuts d
- **Single ear use:** Turn on the charging compartment to start automatic pairing, connect Bluetooth successfully, take out the single ear, cover the charging compartment to use the single ear function.
- **Automatic back connection:** the headset pair name is not deleted when the phone is connected, and the cover can be automatically connected back

Basic functions of the charging case

- **TWS automatic matching:** the earphone is put into the charging compartment, open the upper cover of the charging compartment, and pair the ear successfully
- **Headphone version:** 5.4
- **Transmission frequency:** 2.4GHZ-2.4835GHZ ISM Band
- **Mi sensitivity:** -42÷3dB
- **Support Protocols:** AVRCP/A2DP/HSP/HFP

Precautions for use

The earphones should be stored in a dry and ventilated environment, to avoid oil, water; moisture and dust affecting product performance. Avoid using stimulus, organic solvents or items containing these ingredients to clean the earphones. The use of earphones should be correct as per the specification, and pay attention to the influence of the environment on the earphones. In order to ensure the smooth connection, it's recommended that the distance between the earphones and phones with in 10 meters. If the earphones fail to connect or with poor connection, pls do not take apart the earphones or the accessories on your own. Otherwise, no warranty.

Regarding charging earphones.

Pls use the standard us cable orpointed charging cable from our company to charge the earphones

Warn

This device complies with part 15 of the FCC Rules.

Operation is subject to the following two conditions:

1. this device may not cause harmful interference, and
2. this device must accept any interference received, including interference that may cause undesired operation.

Any changes or modifications not expressly approved by the party responsible for compliance could void the user's authority to operate the equipment.

NOTE: This equipment has been tested and found to comply with the limits for a Class B digital device, pursuant to Part 15 of the FCC Rules.

These limits are designed to provide reasonable protection against harmful interference in a residential installation. This equipment generates, uses and can radiate radio frequency energy and, if not installed and used in accordance with the instructions, may cause harmful interference to radio communications. However, there is no guarantee that interference will not occur in a particular installation.

If this equipment does cause harmful interference to radio or television reception, which can be determined by turning the equipment off and on, the user is encouraged to try to correct the interference by one or more of the following measures:

- Reorient or relocate the receiving antenna.
- Increase the separation between the equipment and receiver.
- Connect the equipment into an outlet on a circuit different from that to which the receiver is connected.
- Consult the dealer or an experienced radio/TV technician for help.

The device has been evaluated to meet general RF exposure requirement. The device can be used in portable exposure condition without restriction

Warranty Card

1. If the product has any functional problems, you can enjoy the warranty service, the warranty period is 3 m
2. Man-made damage, broken, artificially scratched, no warranty card is not covered by the warranty.
3. Customers must submit all necessary information (customer name, address, phone number, date of purchase, etc.)
4. Warranty service requires a warranty card and can be operated as required, otherwise is no warranty.

- **Product model:**
- **Customer's name:**
- **Contact number:**
- **Customer's address:**
- **Date of purchase:**

Documents / Resources

	Shenzhen Yinshijie Technology R12 Open Wearable Stereo Earbuds [pdf] Instruction Manual R12 Open Wearable Stereo Earbuds, R12, Open Wearable Stereo Earbuds, Wearable Stereo Earbuds, Stereo Earbuds, Earbuds
---	--

References

- [User Manual](#)

[Manuals+](#), [Privacy Policy](#)

This website is an independent publication and is neither affiliated with nor endorsed by any of the trademark owners. The "Bluetooth®" word mark and logos are registered trademarks owned by Bluetooth SIG, Inc. The "Wi-Fi®" word mark and logos are registered trademarks owned by the Wi-Fi Alliance. Any use of these marks on this website does not imply any affiliation with or endorsement.