



Shenzhen Mifang Network Technology T23 Wireless Earbuds User Manual

[Home](#) » [Shenzhen Mifang Network Technology](#) » [Shenzhen Mifang Network Technology T23 Wireless Earbuds User Manual](#) 

Contents

- [1 Shenzhen Mifang Network Technology T23 Wireless Earbuds](#)
- [2 Package Contents](#)
- [3 At a Glance](#)
- [4 Earbuds LED Indicator Guide](#)
- [5 Charging Case LED Indicator Guide](#)
- [6 Wearing the Earbuds](#)
- [7 Using the Earbuds](#)
- [8 Earbuds functions](#)
- [9 Cleaning the Earbuds and Charging Case](#)
- [10 Trouble Shooting](#)
- [11 Specifications](#)
- [12 SAFETY AND WARRANTY](#)
- [13 Federal Communications Commission \(FCC\) Statement](#)
- [14 Documents / Resources](#)
- [15 Related Posts](#)

Shenzhen

Shenzhen Mifang Network Technology T23 Wireless Earbuds



Thank you for purchasing our products. This manual addresses the safety guidelines, warranty and operating instructions. Please review this manual thoroughly before operating your device.

Package Contents

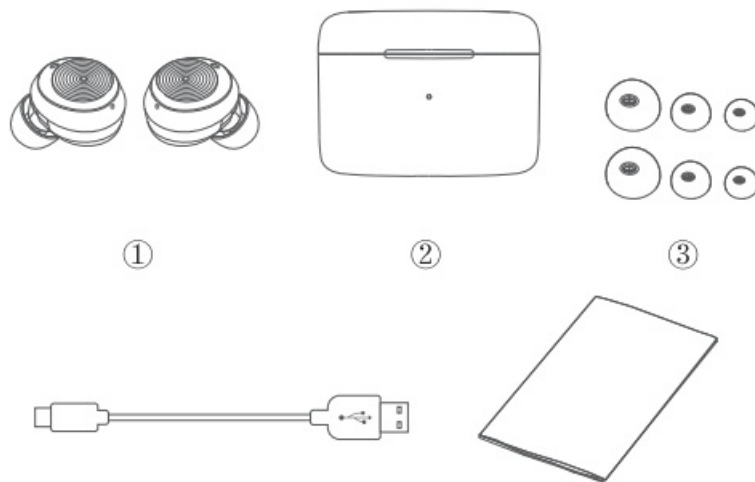

1. Wireless earbuds x 1 pair (LIR)
2. Charging case x 1
3. Eartips x 3 pairs (S/M/L; M size eartips pre-installed)
4. USB-C charging cable x 1
5. User manual x 1

At a Glance

Charging Case

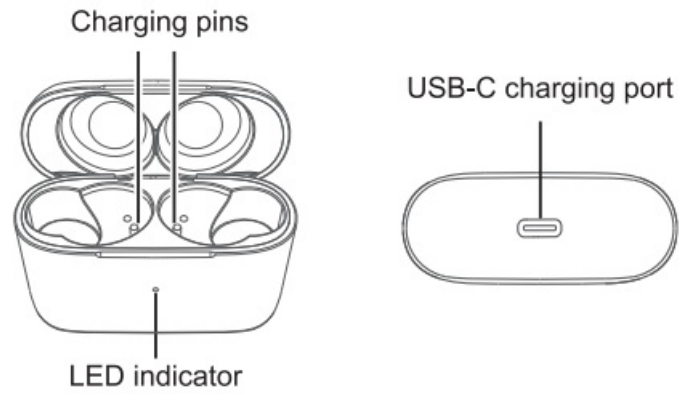

Earbuds

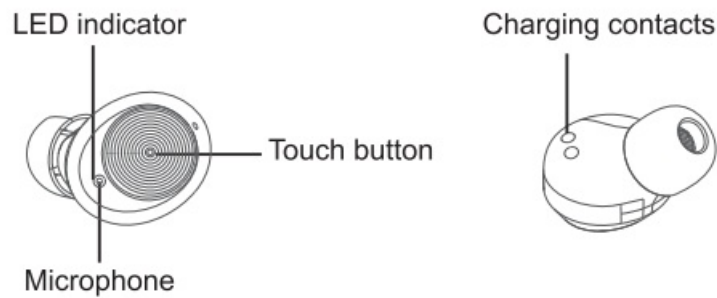

Earbuds LED Indicator Guide

System State	Indicator Activity
Power on	The indicator stays red and white for one second
Power off	The indicator stays red for one second
Pairing	The indicator flashes red and white alternately
Connected	The indicator flashes white once every 5 seconds
Being charged	The indicator stays red
Fully charged	The indicator goes off

Charging Case LED Indicator Guide

You can take an earbud out of the case and then put it back to check the charging case battery level.

Indicator State	Battery Level
The indicator flashes white once	70%-100% battery
The indicator flashes white twice	25%-70% battery
The indicator flashes red three times	1%-25% battery

Note

The indicator flashes red when the charging case is being charged and turns white when fully charged.

Wearing the Earbuds

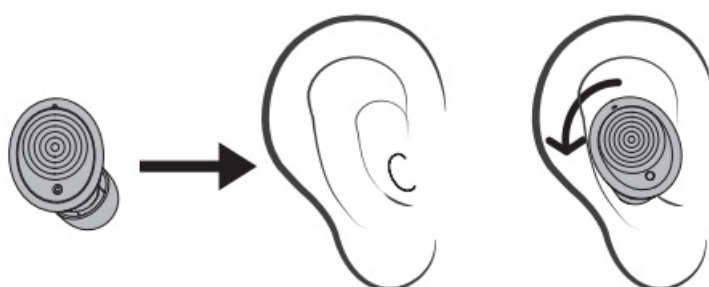

Insert the earbud into your ear and rotate to fit comfortably. Ensure the microphone is pointing towards your mouth. To determine the best fit, you may need to try all sizes of ear tips.

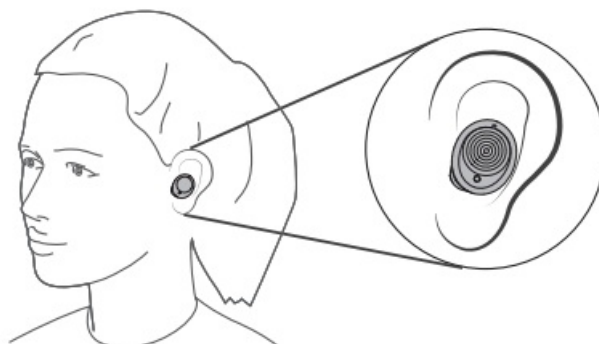

Using the Earbuds

When you use the earbuds for the first time, remove the insulating films on the charging contacts of the earbuds
Charge the earbudss

1. Align the charging contacts on the right earbud with the charging pins on the right side of the case.
2. Repeat step 1 and to charge the left earbud.
3. Close the case.

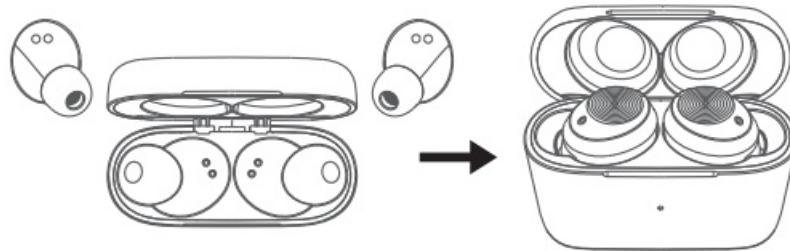

Charge the charging case

1. Plug the small end of the USB-C cable into the USB-C port of the charging case.
2. Plug the other end into a USB wall charger or Computer (DC 5V that is powered on).

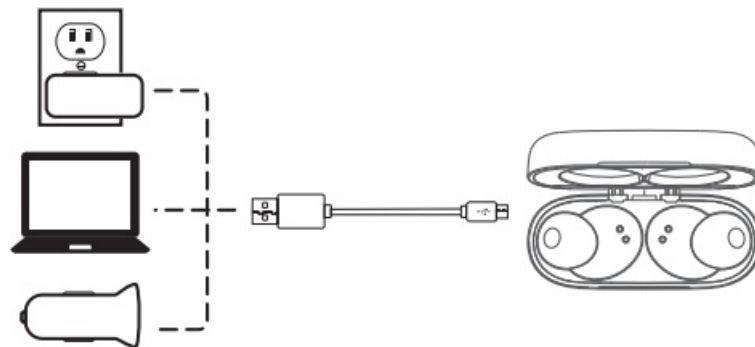

Notes:

- It takes approximately 1 hour to fully recharge the earbuds.
- Fully charge both the earbuds and the charging case before the first-time using.
- The earbuds and the charging case charge simultaneously. The charging case can be used as a standalone charger.

Power on/ off

Automatic operation

- Power on: Open the charging case and take the earbud(s) out.
- Power off: Put the earbud(s) back into the charging case and close the case.

Manual operation

- Power on: Tap and hold the touch button on the left/ right earbud for 2 seconds.
- Power off: Tap and hold the touch button on the left / right earbud for 4 seconds.

Note

When the earbuds are being charged in the charging case and the case is out of power, the earbuds will turn on automatically.

Pair

1. Make sure the earbuds and your Bluetooth device are next to each other or within 3 feet and there are no obstacles between.

2. Turn on the Bluetooth of your Bluetooth device.
3. Turn on the earbuds and the earbuds enter pairing mode.
4. In the list of found Bluetooth devices in your Bluetooth device, choose "T23" to pair.

Notes:

The earbuds will directly enter pairing mode the first time you turn them on. Each time you turn on your earbuds, they will automatically connect to your last successfully connected device if available within the Bluetooth range.

- When the earbuds are on but not paired with a Bluetooth device, they will be automatically off in 5 minutes.
- Mono mode: When Bluetooth connected, you can use either one of the earbuds only by putting the other one back into the charging case and closing the cover.

Earbuds functions

Function	What to do
Play / Pause	Tap the touch button of the left or right earbud.
Previous / Next track	Double-tap the touch button of the left / right earbud.

Call functions

Function	What to do
Answer / end a call	Tap the touch button of the left or right earbud.
Reject a call	Tap and hold the touch button for one second.
Activate Siri or other voice assistant software	Triple-tap the touch button of the left or right earbud.

Reset the earbuds/ clear all pairing information on the earbuds

Turn off the earbuds and hold the touch buttons of the left and right earbuds for 10 seconds.

Cleaning the Earbuds and Charging Case

The earbuds and charging case may require periodic cleaning.

Earbud nozzles	Clean only with a dry, soft cotton swab or equivalent. Note: Never insert any cleaning tool into the nozzle.
Charging pins (on earbuds and case)	To prevent rusting, regularly clean with a dry, soft cotton swab or equivalent.
Charging case	Clean only with a dry, soft cotton swab or equivalent.

Trouble Shooting

• Q: Pairing fails.

- A: 1) Put the earbuds back to the charging case and make sure that they are off.
- 2) Take the earbuds out of the case and earbuds enter pairing mode.
- 3) Choose “T23” in your phone to pair.

If the pairing still fails, check the following points:

- Make sure the earbuds and your Bluetooth device are next to each other or within 33 feet or 10 meters and there are no obstacles between.
- There are no signal interferences nearby (check the question “Connection is not stable” for signal interference conditions).
- Try to reboot your Bluetooth device.Q:I paired the earbuds with my phone before, but I failed to pair them with my phone again. A: Turn on the Bluetooth of your phone and in “MY DEVICES”, choose “T23” and tap “OD”. “Forget This Device”.Then pair the earbuds with your phone again.
- Q: Connection is not stable.
A: Bluetooth signal is transmitted wirelessly and signals can be affected, which results in intermittent sound of earbuds, in the following conditions:
 - The distance between the earbuds and your Bluetooth device is at the edge of the Bluetooth pairable distance.
 - Transmitted signals encounter obstacles or human body blockage.
 - There are high-power electronic devices nearby. There are other Bluetooth devices and are being turned on / off nearby.

Specifications

SAFETY AND WARRANTY

Important safety instructions

- Use of earbuds will impair your ability to hear other sounds. Use caution while using your earbuds when you are engaging in any activity that requires your full attention. If you have a pacemaker or other electrical medical

devices, you should consult your physician before using this product.

- This package contains small parts that may be hazardous to children and should be kept out of reach from children. This product is not a toy – never allow children to play with this product. Always store the product out of reach from children. The bags themselves or the many small parts they contain may cause choking if ingested.
- Never try to dismantle the product yourself, or push objects of any kind into the products, as this may cause short circuits which could result in a fire or electric shock.
- None of the components can be replaced or repaired by users. Only authorized dealers or service centers may open the product. If any parts of your product require replacement for any reason, including normal wear and tear or breakage, please contact us.
- Avoid exposing your product to heat and humidity to protect against damage to the product or injury to you.
- Keep all products, cords, and cables away from operating machinery.
- If the product overheats, if the product has been dropped or damaged, if the product has a damaged cord or plug, or if the product has been dropped in a liquid, discontinue use and contact us.
- Do NOT use in areas where there are explosive hazards.
- Do NOT submerge the earbuds in water. Do NOT expose the earbuds to moving water (e.g., from a faucet, etc.).
- Do NOT wear the earbuds while showering or bathing, or when participating in water sports, e.g., Swimming, waterskiing, surfing, etc.
- This product contains magnetic material. Consult your physician on whether this might affect your implantable medical device.
- Leaving the product in hot or cold places, such as in a closed car in the summer and winter conditions, will reduce the capacity and lifetime of the earbuds.
- Dispose of the product according to local standards and regulations.
- Remember: Always drive safely, avoid distractions and follow local laws!
- Using the earbuds while operating a motor vehicle, motorcycle, watercraft or bicycle may be dangerous, and is illegal in some jurisdictions, just as use of the earbuds with both ears covered while driving is not permitted in certain jurisdictions. Check your local laws. Use caution while using your earbuds when you are engaging in any activity that requires your full attention. While engaging in any such activity, removing the earbuds from your ear or turning off your earbuds will keep you from being distracted, so as to avoid accident or injury. Do not take notes or read documents while driving.
- When using and charging this product, basic precautions should always be followed, including the following:
 - Read all the instructions before using the charging case.
 - To reduce the risk of injury, close supervision is necessary when the charging case is used near children.
 - Do not expose charging case to water, rain, liquids or snow.
 - Use of a power supply or charger that is not recommended or sold by power pack manufacturer may result in a risk of fire or injury.
 - Do not use the charging case in excess of its output range.
 - Do not use a charging case that is damaged or modified. Damaged or modified batteries may exhibit unpredictable behavior resulting in fire, explosion or risk of injury.
 - Do not disassemble the charging case. Incorrect reassembly may result in risk of fire or injury.
 - Do not open, crush or expose a charging case to fire or excessive temperature. Exposure to fire or extreme temperature may cause explosion.

Have servicing performed by a qualified repair person using only identical replacement parts.

Warranty

We strive to build our products with the highest attention to detail and craftsmanship. However, sometimes there are occurrences of defect. We are happy to offer a one-year hassle-free warranty to all our products as we continue to make amazing products. Please contact us if you have any questions about our devices.

Federal Communications Commission (FCC) Statement

This device complies with part 15 of the FCC Rules. Operation is subject to the following two conditions: (1) This device may not cause harmful interference, and (2) this device must accept any interference received, including interference that may cause undesired operation. Note: This equipment has been tested and found to comply with the limits for a Class B digital device, pursuant to part 15 of the FCC Rules. These limits are designed to provide reasonable protection against harmful interference in a residential installation. This equipment generates, uses and can radiate radio frequency energy and, if not installed and used in accordance with the instructions, may cause harmful interference to radio communications. However, there is no guarantee that interference will not occur in a particular installation. If this equipment does cause harmful interference to radio or television reception, which can be determined by turning the equipment off and on, the user is encouraged to try to correct the interference by one or more of the following measures:

- Reorient or relocate the receiving antenna.
- Increase the separation between the equipment and receiver.
- Connect the equipment into an outlet on a circuit different from that to which the receiver is connected.
- Consult the dealer or an experienced radio/TV technician for help.

Warning: Changes or modifications made to this device not expressly approved by SHENZHEN MIFANG NETWORK TECHNOLOGY co., LTD. may void the FCC authorization to operate this device.

Note: The manufacturer is not responsible for any radio or TV interference caused by unauthorized modifications to this equipment. Such modifications could void the user's authority to operate the equipment.

Documents / Resources

	Shenzhen Mifang Network Technology T23 Wireless Earbuds [pdf] User Manual T23, 2AR5E-T23, 2AR5ET23, T23 Wireless Earbuds, T23, Wireless Earbuds
---	--