



SHENZHEN LORD WAY TECHNOLOGY W6203 Wireless Keyboard and Mouse Combo User Manual

[Home](#) » [Shenzhen Lord Way Technology](#) » SHENZHEN LORD WAY TECHNOLOGY W6203 Wireless Keyboard and Mouse Combo User Manual 

Contents

- [1 W6203 Wireless Keyboard and Mouse Combo](#)
- [2 Product Specification](#)
- [3 How to set up](#)
- [4 FAQ:](#)
- [5 Warranty](#)
- [6 Contact Information](#)
- [7 Documents / Resources](#)
- [8 Related Posts](#)



SHENZHEN



2.4G Wireless Keyboard and Mouse Combo Manual

W6203 Wireless Keyboard and Mouse Combo

Thank you for choosing 6203/K203,W6203/M906
Please read this manual carefully before use.

Product Specification

Model Number

Wireless Connection: 2.4GHz

Working Distance: Up to 10 meters

Compatible Operation System: Windows

Mouse DPI : 1200>1600>800

Keyboard Dimension: 456*162.2*20.4mm (L*W*H)

Mouse Dimension: 111.8*62*36.1mm (L*W*H)

Receiver Dimension : 18.5*14.2*6.35mm (L*W*H)

Main Material:ABS

Keyboard Weight: 498g

Mouse Weight: 60g

Receiver Weight: 1.5g

Batteries: 2*AAA

Working Voltage: DC 3.7V

Working Current: 4-5mA

Working Time: 575 hrs

Sleep mode: Without using the keyboard, the keyboard will change to sleep mode within 10 minutes

Sleep Current: 40uA

Standby Time: 345 days

Sleep wake-up Mode: Press any button to wake up the keyboard

How to set up

1

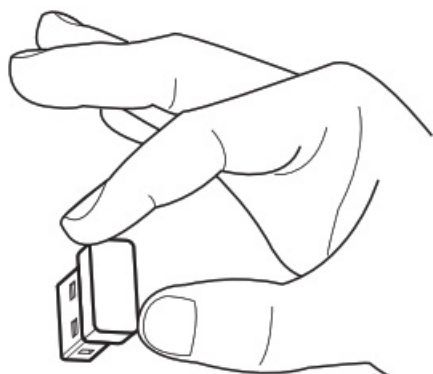

2

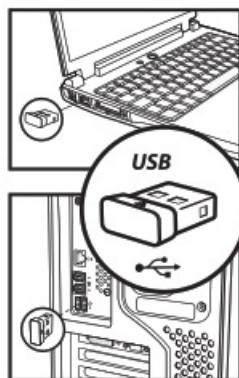

3

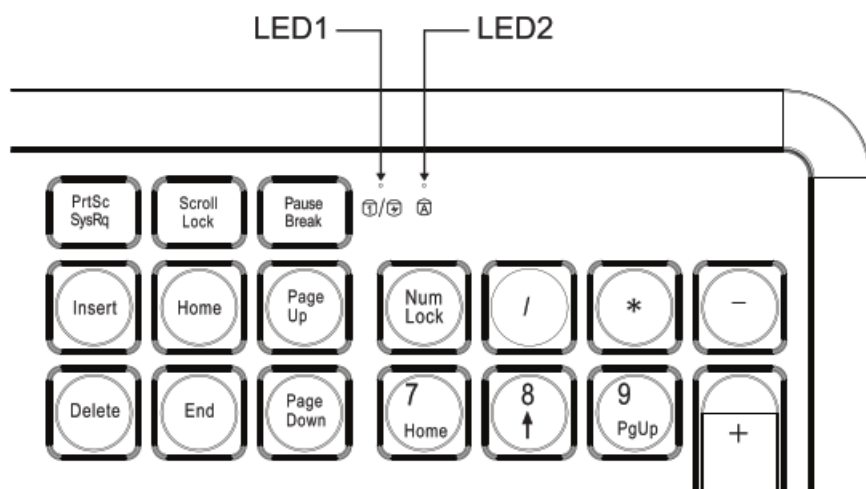
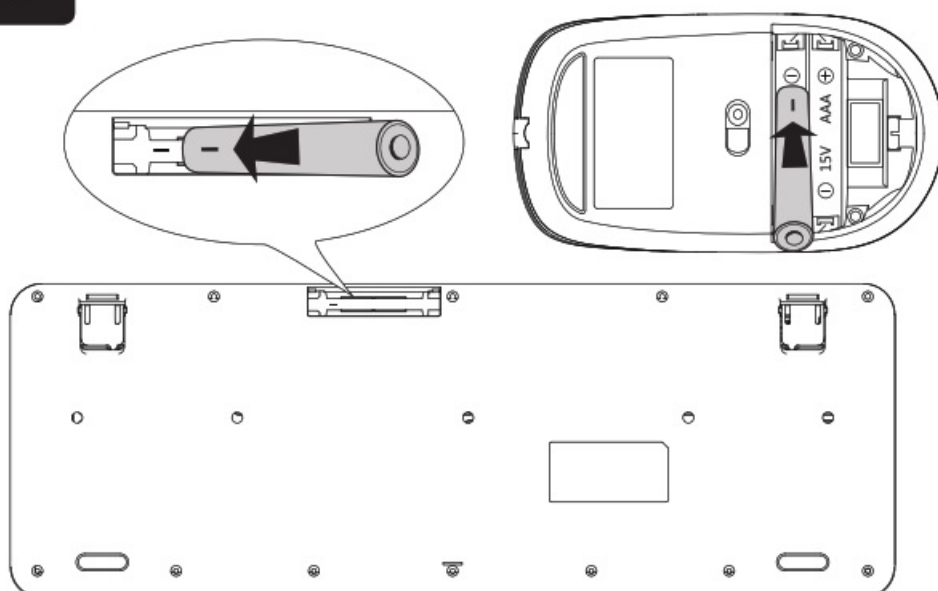

FAQ:

Q1: What should I do if the keyboard become sticky after a period of usage?

– A1: This usually happens due to low power. Please replace the battery on the keyboard and try again. If this issue repeats, please contact us.

Q2: The keyboard LED1 and mouse LED are bright, but still do not work, what should I do?

– A2: Firstly please remove the 2.4G receiver from the computer and remove the keyboard and mouse battery. Secondly, plug the 2.4G receiver into the computer. Thirdly install the keyboard and mouse battery, put the keyboard close to the 2.4G receiver. Wait until the keyboard LED1 lights up, indicating that the connection is successful.

Q3: What should I do if the keyboard is delayed or the mouse is stuck?

– A3: Bluetooth keyboard or 2.4G keyboard will be affected by WiFi or electromagnetic waves. If there is keyboard typing delay or mouse stuck, please unplug the 2.4G receiver from the computer and plug it in.

Warranty

30-day unconditional money-back guarantee. If you are not completely satisfied with this product for any reason, BA .Eprocat will gladly refund your purchase price within 30 days of purchase (from the date of retail purchase).

1-year limited warranty. ONE(1) YEAR from the date of retail purchase.

If a hardware defect arises (not due to personal alterations or attempted repairs) and a valid claim is received within the Warranty Period, BA.Eprocat will either:

1. repair the product at no charge.
2. Exchange the product with a product that is new or which has been manufactured from serviceable used parts and is at least functionally equivalent to the original product.
3. refund the purchase price of the product .

BA .Eprocat may request that you send the product back to our address for the replacement/refund. The location will change according to your area of residence. Please contact our customer service for confirmation.

BA .Eprocat WILL NOT cover the shipping cost.

BA .Eprocat only offers warranty service for our official Amazon store and distributors. We need the order information, for example the Amazon order number to verify your order.

Contact Information

Please contact our customer support if you have any question or suggestion. We do our best to help you.



SHENZHEN

Documents / Resources



[SHENZHEN LORD WAY TECHNOLOGY W6203 Wireless Keyboard and Mouse Combo](#) [pdf]
f] User Manual
XW6906, 2ACKHXW6906, W6203, K203, W6203, M906, W6203 Wireless Keyboard and Mouse Combo, W6203, Wireless Keyboard and Mouse Combo, Wireless Keyboard and Mouse, Mouse, Keyboard