



Shenzhen Kerui Smart Technology D015 Wireless Door Chime User Manual

[Home](#) » [Shenzhen Kerui Smart Technology](#) » **Shenzhen Kerui Smart Technology D015 Wireless Door Chime User Manual** 

Contents

- [1 Shenzhen Kerui Smart Technology D015 Wireless Door Door Chime Features](#)
- [2 Operating Instructions](#)
- [3 Select the Ringtone](#)
- [4 Setting the Volume](#)
- [5 Pairing Additional Transmitters/Accessories](#)
- [6 Return to Default Ringtone \(Ding Dong\)](#)
- [7 Clear All Settings – Unpair all transmitters/ accessories from receiver](#)
- [8 Opening Detector Information](#)
- [9 Battery Replacement](#)
- [10 Technical Parameters](#)
- [11 What's in the Box](#)
- [12 Precautions](#)
- [13 Warranty](#)
- [14 FCC Warning](#)
- [15 Documents / Resources](#)
- [16 Related Posts](#)



Shenzhen Kerui Smart Technology D015 Wireless Door



Door Chime

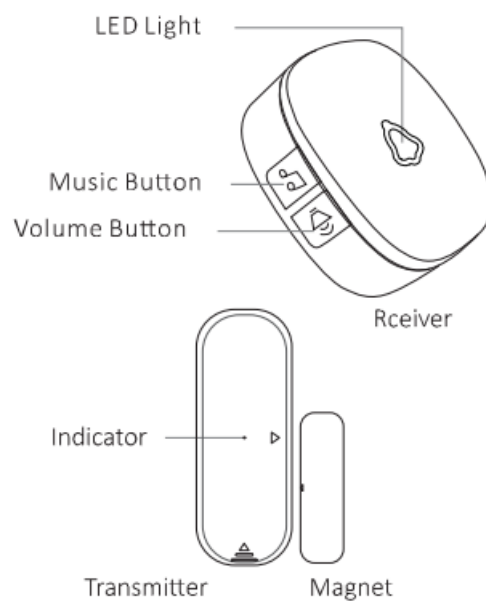

Features

- 32 tones available
- 5 adjustable volume levels from 0 to 120dB (Including Mute Mode with light flashing only).
- Memory function allows to retain settings when receivers are unplugged or off.
- Different tones can be set for different train sitters.

Operating Instructions

Button operation mode is divided into

Press: Press the for less than 3 seconds.

Long Press: Press the BUtton for more than 3 seconds.

Plug the doorbell receiver into the AC outlet, the receiver will beep once and an LED light flash in each color ariy to indicate ready

Select the Ringtone

- Short press to cycle FORWARD through the tones
- Long press until you hear a short beep. the short press to click REVERSE the tones.



Setting the Volume



Short press to cycle through 5 volume

Note: the volume! changes to the loud automatically every time the receiver is powered on).

Pairing Additional Transmitters/Accessories

There are two options in pairing your receivers and transmitters/ accessories: VARIABLE mode and FIXED mode.

Note: doorbells have been paired and set to default chime (Ding Dong).

VARIABLE MODE: Adding a transmitter/accessory with a VARIABLE receiver ringtone:

1. First, press and hold (C9] button 5 seconds on the plugged-in receiver. The doorbell receiver will beep once and the LED ight will be lit up- this indicates the receiver is in pairing mode and ready to pair with a transmitter or accessory.



2. Next, short press the button to pair and trigger a transmitter to send a signal to the doorbell receiver. And you will hear and see:

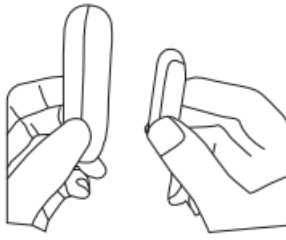

- The receiver beeps twice and the LED light flashes twice, showing the transmitter is added successfully.
- The receiver beeps once and the LED light flashes once, showing the transmitter has been added before.
- The receiver beep three times and the LED light flashes three times, indicating no transmitters can be added any more.

(NOTE: There is a limit of up to 20 transmitters/accessories that can be paired to a receiver).

3. Next, press the button to exit out of pairing mode. (NOTE: The doorbell receiver will automatically exit the pairing status of adding transmitters if no action is taken in the 20s)
4. Finally, choose a variable chime/ringtone by following above operating instruction (Select the ring tone Finally, trigger transmitter/accessory to confirm the desired tone.

FIXED MODE: Adding a transmitter/accessory with FIXED receiver ringtone:

1. Select a tone by following above operating instruction (Select the ring tone.)
2. Press and hold a) and [CD] buttons simultaneously on the plugged-in receiver. The doorbell receiver will beep once and the LED light will light up- this indicates the receiver is in pairing mode and ready to pair with a transmitter/accessory.



3. Short press the button to pair and trigger a transmitter to send a signal to the doorbell receiver. And you will hear and see:

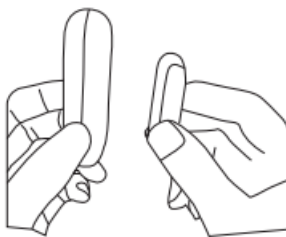

- The receiver beeps twice and the LED light flashes twice, showing the transmitter is added successfully.
- The receiver beeps once and the LED light flash once, showing the transmitter has been added before.
- The receiver beeps three times and the LED light flash three times, indicating no transmitters can be added anymore. (NOTE: There is a limit of up to 20 transmitters/accessories that can be paired to the

receiver).

4. Press the receiver button to exit out of pairing mode. (NOTE: The doorbell receiver will automatically exit the pairing status of adding transmitters if no action is taken in the 20s).
5. The ringtone is now FIXED. Now even if you change the receiver ting-tones, you will always have the desired ringtone with the transmitter.

Return to Default Ringtone (Ding Dong)

1. Unplug the Receiver
2. Press and hold I al button then plug in the outlet.



3. Keep on pressing and holding the II button while the receiver is plugged in you will start to hear continuous beeping and the LED light will flash 5 times.

The receiver is now reset to the first “Ding Dong” ringtone and the volume will be reset to the largest volume.



Clear All Settings – Unpair all transmitters/ accessories from receiver

1. Unplug the receiver.
2. Press and hold the I I button then plug in the outlet.
3. Keep on pressing and holding the I (button while the receiver is plugged in- you will start to hear continuous beeping and the LED light will flash 10 times.
4. Keep on pressing and holding the [Q]1 button until the doorbell receiver gives a series of fast beeps and the LED light will give fast flashes as well.

When there is no more beep or flash, the receiver and transmitters are now all reset. All transmitters and accessories are now unpaired.



Opening Detector Information

1. Transmitter and magnet alignment The magnet has two small holes. When installing, make sure to align the back cover of the transmitter
2. Maximum distance between the transmitter and the magnet When installing the two elements, the distance between the transmitter and the magnet should not exceed cm.

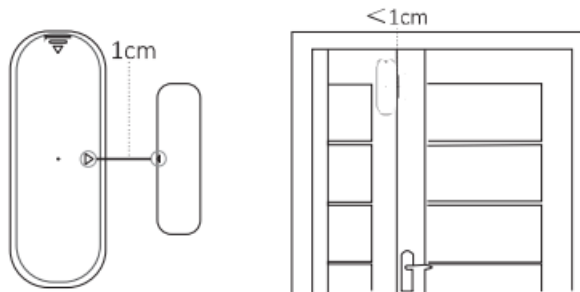

3. Fixing with double-side adhesive The surface (door or window) where the detector is to be installed must be clean and dry in order to ensure that the double-sided tape supplied adheres properly.

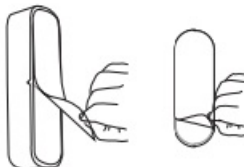

4. Fixing with Screws If the support allows it (e.g. wooden door), you can use screws to fix the transmitter and its magnet.

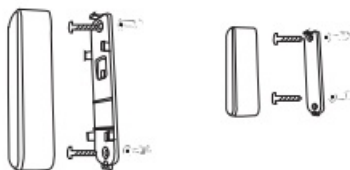

Battery Replacement

When the transmitter light stays on continuously, it indicates that you need to replace the battery.

1. Slide the back of the transmitter down to access the battery compartment.
2. Remove the used battery and replace it with an equipment model (12Volt 23A Alkaline) observing the polarity.
3. Replace the back of the transmitter by sliding the cover-up.

Technical Parameters

- Power: 100 240V 50/60Hz AC
- Standby Current: <3 mA (220V AC)
- Working Current: <11 mA (220V AC)
- Radio Frequency: 433.92MHz
- Operating Range: 500 feet (in open area)
- Working Temperature: -20°C+60°C
- Working Humidity: ≤85%

What's in the Box

- Receiver(s)
- Transmitter(s)
- Screws
- Anchors
- Adhesive Stickers

Precautions

1. Do not operate a product with a damaged core or plug.
2. Do not operate the product if it has been damaged in any way.
3. Do not throw or shake the product.
4. Keep the product away from fire or explosions may occur.
5. Before using the product, read all instructions and caution markings on the product, accessories, and devices using our product.
6. Operating range will become shorter and the indicator quick flashes several times if the battery in the transmitter is at low power.

Please try to change the transmitter battery. Battery type is CR2032 battery.

Warranty

1. Our company provides 18 months of free warranty and lifetime maintenance services for the products and guarantees 24-hour online service. Within 18 months from the date of purchase, damages caused by poor material or design defects of the product can be replaced or repaired free of charge. Repairs and replacements performed after 18 months will be charged the product cost.
2. Information to be provided when contacting the seller for warranty:
 - Product name
 - Order number
 - Fault description

Manufacturer: SHENZHEN KERUI SMART TECHNOLOGY Co., Ltd. Address: 15F, T2, Jinlitong Building, Bao'an District Shenzhen China

FCC Warning

This device complies with part 15 of the FCC Rules. Operation is subject to the following two conditions: (1) This device may not cause harmful interference, and (2) this device must accept any interference received, including interference that may cause undesired operation.

Any Changes or modifications not expressly approved by the party responsible for compliance could void the user's authority to operate the equipment.

Note: This equipment has been tested and found to comply with the limits for a Class B digital device, pursuant to part 15 of the FCC Rules. These limits are designed to provide reasonable protection against harmful interference in a residential installation. This equipment generates uses and can radiate radio frequency energy and, if not installed and used in accordance with the instructions, may cause harmful interference to radio communications. However, there is no guarantee that interference will not occur in a particular installation. If this equipment does cause harmful interference to radio or television reception, which can be determined by turning the equipment off and on, the user is encouraged to try to correct the interference by one or more of the following measures:

- Reorient or relocate the receiving antenna.
- Increase the separation between the equipment and receiver.
- Connect the equipment into an outlet on a circuit different from that to which the receiver is connected.
- Consult the dealer or an experienced radio/TV technician for help.

The device has been evaluated to meet general RF exposure requirement. The device can be used in portable exposure condition without restriction.

Documents / Resources

	<p>Shenzhen Kerui Smart Technology D015 Wireless Door Chime [pdf] User Manual D015, 2AZI3-D015, 2AZI3D015, D015 Wireless Door Chime, Wireless Door Chime</p>
---	--