



Shenzhen Kafulle Electronics KF-9010B Desktop Stand Wireless Charging Instruction Manual

[Home](#) » [Shenzhen Kafulle Electronics](#) » Shenzhen Kafulle Electronics KF-9010B Desktop Stand Wireless Charging Instruction Manual 

KF-9010B
Desktop stand wireless charging



INSTRUCTION MANUAL
PLEASE READ ALL INSTRUCTIONS CAREFULLY
AND RETAIN FOR FUTURE USE

Contents

- [1 Getting started](#)
- [2 Package Contents](#)
- [3 Key Features](#)
- [4 Safety Instructions](#)
- [5 Description of Parts](#)
- [6 Instruction for use](#)
- [7 Care and Maintenance](#)
- [8 Specifications](#)
- [9 FCC Warning](#)
- [10 Limited Warranty](#)
- [11 Documents / Resources](#)
- [12 Related Posts](#)

Getting started

- Remove the product from the box.
- Please retain all packaging after you have checked and counted all the parts and the contents against the list.

Package Contents

- 3-In-1 Charging Stand
- USB Charging Cable
- Instruction Manual

Key Features

- Wireless charge Up To 5W
- Charges Phone In Both Portrait & Landscape Positions
- Simply Place Your Phone & Begin Charging Instantly
- Powered By Micro USB Cable (Included)
- Suitable For All Qi-Enabled Mobile Phones

Safety Instructions

- Keep the unit away from heat sources, direct sunlight, humidity, water and any other liquids.
- Do not operate the unit if it has been exposed to water, moisture or any other liquids to prevent electric shock, explosion and/or injury to yourself and damage to the unit.
- Do not use the unit if it has been dropped or damaged in any way.
- Repairs to electrical equipment should only be performed by a qualified electrician. Improper repairs may place the user at serious risk.
- Do not use the unit with wet hands.
- Do not put objects into any of the openings.
- Keep the unit free from dust, lint etc.
- Do not use this unit for anything other than its intended use.

- Keep the unit out of reach of children.
- This product is not a toy.

Description of Parts

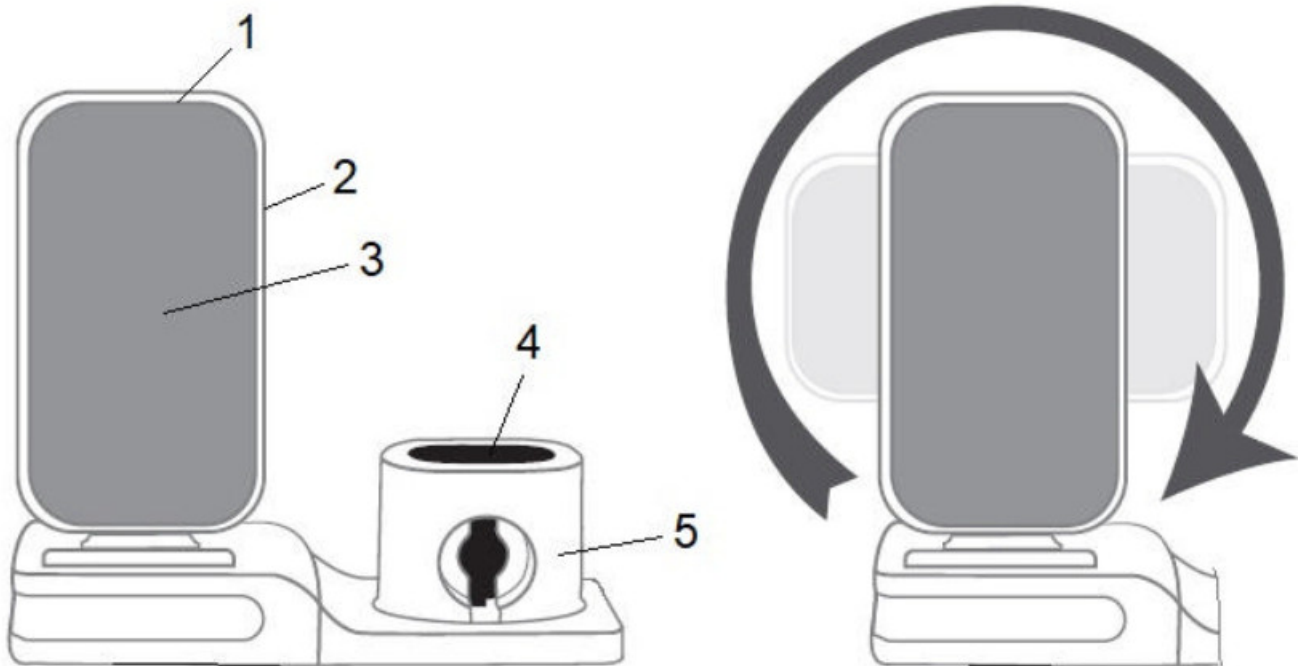

| | |
|---|------------------------------------|
| 1 | Micro USB input port (at the back) |
| 2 | The light around the unit |
| 3 | Wireless charging pad |
| 4 | Airpods station |
| 5 | Apple Watch station |

Instruction for use

1. Swing the wireless charging pad in landscape or portrait location. Connect the Micro USB input port of the unit with the USB charging cable (Included) and another end of the cable to the output of a QC 2.0/3.0 Quick Charger (with output rating DC 5V/2A, – NOT INCLUDED). The red light around the unit will turn on.
2. A) Smart Phone: Place your Qi-enabled smartphone on the wireless charging pad, and wireless charging of the phone will start immediately with blue light around the unit.
B) Airpods or Apple Watch: Connect an official Apple-certified cable (Not included) through the Airpods or Apple Watch station of the stand. Use a standard wall adapter or USB port to charge your devices.

REMARK:

- a. Some phone cases do not support Wireless Charging due to their thickness and design. If your Phone model is compatible with Wireless Charging and you're unable to charge it wirelessly, please remove your phone case and retry.
- b. Placement of some smartphones on the wireless charger might need to be adjusted, in order for their internal components to make contact appropriately and begin wireless charging.
- c. While charging your phone wirelessly, please keep any metal or magnetic object away from your phone by a

minimum of 6cm.

d. The lower ambient temperature, the faster-charging speed. The charging speed in winter is faster than in summer.

e. To avoid damaging internal circuits, don't charge in humid environments.

f. Please keep the unit out of the reach of children and infants.

Care and Maintenance

Read the following recommendations before using the unit. Following these, you will be able to enjoy the product for many years.

- Don't expose the unit to liquid, moisture or humidity to avoid damage to internal circuits.
- Don't use abrasive cleaning solvents to clean the unit.
- Don't dispose of the unit in a fire as it will result in an explosion.
- Don't expose the device to contact with sharp objects as this will cause scratches and damage.
- Don't let the device fall on the floor. The internal circuit might get damaged.
- Don't attempt to disassemble the device. No user-serviceable parts.

Specifications

Input: 5V/2A

Output for iPhone: up to 5W

Dimension (for mounting the phone vertically): 7.06" L x 2.31" W x 6.06" H

Weight (not including USB charging cable): ~5.3 oz

FCC Warning

This device complies with part 15 of the FCC Rules. Operation is subject to the following two conditions:(1) This device may not cause harmful interference, and (2) this device must accept any interference received, including interference that may cause undesired operation.

Any changes or modifications not expressly approved by the party responsible for compliance could void the user's authority to operate the equipment.

This equipment has been tested and found to comply with the limits for a Class B digital device, pursuant to part 15 of the FCC Rules. These limits are designed to provide reasonable protection against harmful interference in a residential installation. This equipment generates uses and can radiate radio frequency energy and, if not installed and used in accordance with the instructions, may cause harmful interference to radio communications. However, there is no guarantee that interference will not occur in a particular installation. If this equipment does cause harmful interference to radio or television reception, which can be determined by turning the equipment off and on, the user is encouraged to try to correct the interference by one or more of the following measures:

- Reorient or relocate the receiving antenna.
- Increase the separation between the equipment and receiver.
- Connect the equipment into an outlet on a circuit different from that to which the receiver is connected.
- Consult the dealer or an experienced radio/TV technician for help.

FCC RF exposure statement:

The equipment complies with FCC radiation exposure limits set forth for an uncontrolled environment. During the operation of the device, a distance of 15 cm surrounding the device and 20 cm above the top surface of the device must be respected.

FCC ID 2AV8F-KF-9010B

Limited Warranty

This manufacturer’s product warranty extends to the original consumer purchaser of the product. Neither the retailer nor any other company involved in the sale or promotion of this product is a co-warrantor of this manufacturer warranty.

WARRANTY DURATION: All materials and workmanship are warranted to the original consumer purchaser for a period of ninety (90) days from the original purchase date.

WARRANTY COVERAGE: This product is warranted against defective materials or workmanship. This warranty is void if the product has been damaged by accident, in shipment, unreasonable use, misuse, neglect, improper service, commercial use, repairs by unauthorized personnel or other causes not arising out of defects in materials or workmanship. This warranty is effective only if the product is purchased and operated in the USA and does not extend to any units which have been used in violation of written instructions furnished by the manufacturer or to units that have been altered or modified or, to damaged products or parts thereof which have had the serial number removed, altered, defaced or rendered illegible.

WARRANTY DISCLAIMERS: This warranty is in lieu of all warranties expressed or implied and no representative or person is authorized to assume for manufacturer any other liability in connection with the sale of our products. There shall be no claims for defects or failure under any theory of tort, contract or commercial law including but not limited to, negligence, gross negligence, strict liability, breach of warranty and breach of contract. Under no circumstances will Manufacturer’s / Distributor’s maximum liability exceed the retail value of the product.

WARRANTY PERFORMANCE: During the above 90-day warranty period, a product with a defect will be either repaired or replaced with a reconditioned comparable model (at manufacturer’s option). The repaired or replacement product will be in warranty for the balance of the 90-day warranty period and an additional one-month period. No charge will be applicable for such repair or replacement.

SERVICE AND REPAIR: If service is required for this product, you should first contact Midwest Trading Group Customer Service at info@mtradinggroup.com or by calling 1 (866) 815-4714, Monday to Friday 10 am to 6 pm EST.

NOTE: Manufacturers cannot assume responsibility for loss or damage during incoming shipment. As a precautionary measure, carefully package the product for shipment, and insure it with the carrier. Be sure to enclose the following details with the product: your full name, return address and daytime phone number, a note describing the problem you experienced, a copy of your sales receipt or other proof of purchase to determine warranty status. C.O.D. shipments cannot be accepted.

Documents / Resources

| | |
|---|---|
| <div><div><div>KF-9010B</div><div>Desktop stand wireless charging</div><div></div><div>INSTRUCTION MANUAL PLEASE READ ALL INSTRUCTIONS CAREFULLY AND RETAIN FOR FUTURE USE</div></div></div> | <div>Shenzhen Kafulle Electronics KF-9010B Desktop Stand Wireless Charging [pdf] Instruction Manual</div> <div>KF-9010B, KF9010B, 2AV8F-KF-9010B, 2AV8FKF9010B, KF-9010B Desktop Stand Wireless Charging, Desktop Stand Wireless Charging</div> |
|---|---|