



## Shenzhen Huang Wei Technology H5 WiFi Camera Instructions

[Home](#) » [Shenzhen Huang Wei Technology](#) » Shenzhen Huang Wei Technology H5 WiFi Camera Instructions 



# SHENZHEN

Camera Setup  
Instruction



App: HDCameraPro

<http://xyx.365uj.com/>

### Contents

- [1 Set up your camera Android System](#)
- [2 Camera Interface and Setting](#)
- [3 Setting](#)
- [4 FAQs](#)
- [5 Documents / Resources](#)
- [6 Related Posts](#)

## Set up your camera Android System

### 1. Step One – Camera setup a.Charge your camera by connecting with

- a USB power adapter. This camera doesn't have to charge an indicator light while charging. Charging a battery to 100% = 5 hours of charging time when using a charging adapter.
- b.Insert a Micro SD card into the device. Recommend using SanDisk brand.
- c.Turn on the camera and wait for the indicator light to be on.

### 2. Step Two – Phone application download and installation

- a. Download and install the application called "HDCameraPro" on Google Play Store for Android or App Store for Los.
- b.You may scan the QR code on the first page of the manual as well.
- c. Enable "Run in background" and Trust this app.

### 3. Step Three – Add the camera as a new device

- a. Turn on the camera and wait for the green indicator light is flash slowly.
- b.Open the WLAN phone settings from your phone. c.Connect to WLAN name starting "HW-XXXX" This is your camera hotspot.

**Note:** If you use the IOS system when your phone connects to the camera hotspot, please wait a moment, connect to the camera hotspot, please wait a moment, until the Wi-Fi icon is shown on the phone status bar.  
d.Warning window may pop up saying that "Internet unavailable" Ignore the message and keep on the current network.

e.Open the Application "HDCameraPro" .

f. You will see that the camera is now online.

g•You can tap the camera button to see live video at a short distance without Wi-Fi. (If asked, the default password is 123456. You may not need to enter this default password.)

**Note:** Since the camera is not connected to home Wi-Fi, the camera will disappear once you disconnect your phone from the camera under the WLAN setting.

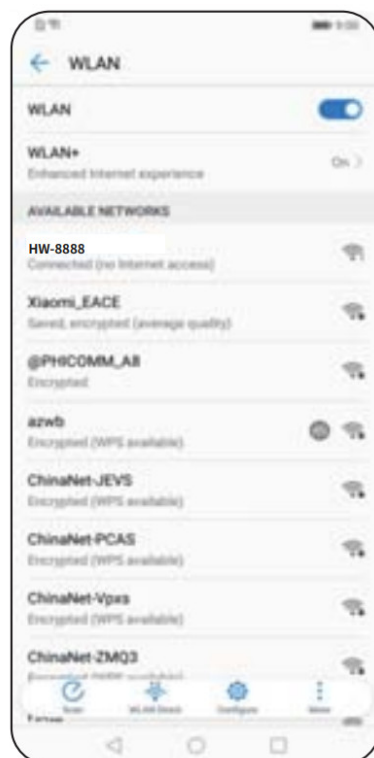

### 4. Step Four – Connect your camera to Wi-Fi

a. Tap the “+” on the upper right corner of the screen on the main home screen.

b. Tap the “Equipment AP distribution network” button. >> Tap the “START CONNECTING ” button. >> Tap “NEXT” button. >> Select the Wi-Fi that you want to connect. Enter the Wi-Fi password and tap the “CONFIGURE WI-FI” button.

(Passwords are case-sensitive, so note which letters you capitalize.) >> Wait for a moment, then the camera will connect to the router via Wi-Fi.

Done! Now you have successfully configured the wireless settings for your cameras on the HDCameraPro app. You can monitor your home from anywhere, anytime. When you enter the live streaming interface, you should enter a password. Please remember it.

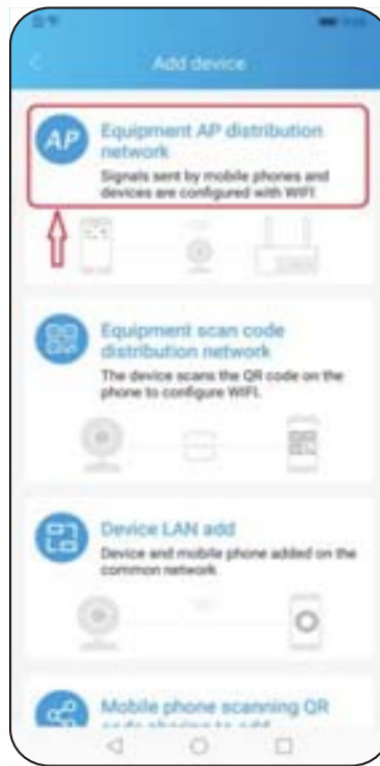

## Camera Interface and Setting

### Camera Interface

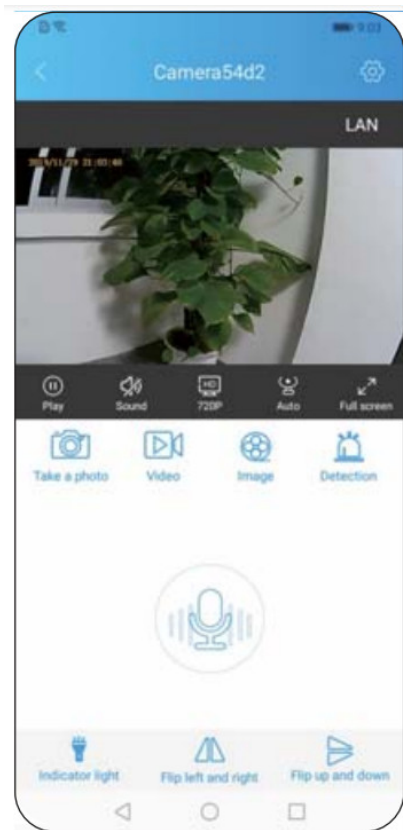

- a. This camera doesn't support two-way talk, you can only listen on the app.
- b. The night vision of the camera will be auto-turned on/off depending on the light.
- c. Tap the "Image" button, you can preview the snapshot and recorded videos.

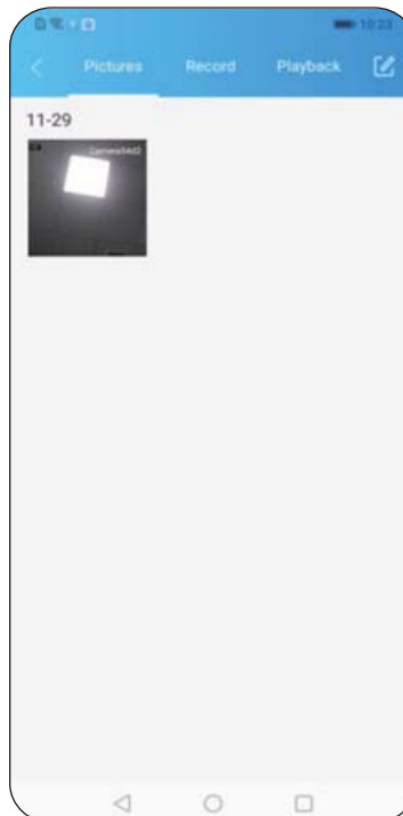

- Please tap the "Playback" button to view, download and delete video files from Micro SD card
- d. Tap the "Detection" button to view the snapshot when the motion is detected.
- e. Tap the "indicator light" button total on/off the device indicator light

## Setting

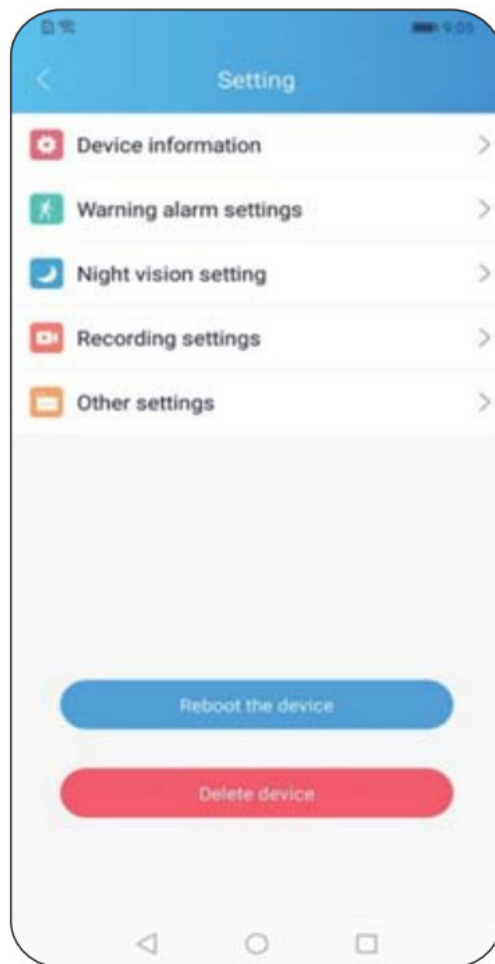

- **Device information**

- Modify the device name
- Modify the device password.

- **Warning alarm settings**

- Motion detection setting such as off, low, medium, and high
- Push frequency such as 1,3,5,10,30 minutes
- Message push: When you enable this function, it will send a push notification to your phone when a motion is detected.

- **Night vision setting such as Turn off night vision, Auto night vision, Forced night vision.**

- **Recording settings**

- Recording mode such as Full-time recording, Warning alarm recording, and Timed recording.
- Video length such as 5,10,15,30 minutes.

**Note:** 1. If you enable warning alarm recording, you need to turn on the motion detection under Warning alarm settings first.

- **Other settings**

- 24-hour format: If you want a 12-hour format, please disable this function.
- Synchronize phone time: If the clock time is not correct, please tap this button to fix the current time.
- SD card: If you already inserted an SD card into the device, but the app detects “unplugged card”, Please turn off the device and unplug the SD card from the device, next plug the SD card into the device again, and turn on the device. You can also use another SD card to try again.

## FAQs

## 1. How to record video and snapshots on the app?

Tap your camera button to view the interface. Tap the Video button to record videos. Recorded video files are saved to App. Please tap Image next tap the Record button to preview the recorded video.

**Note:** When you exit the view interface, the record will be stopped automatically.

You can also tap the Take a photo button to take photos. Snapshots are also saved to App. Please tap the Image button, next tap Picture preview the recorded video.

## 2. How to record videos to Micro SD card and playback videos from Micro SD card?

please turns off the device first. Insert Micro SD card into the device. Turn on the device again. You should be able to see it if the device detects a Micro SD card under Other settings. If not, you may unplug SD card from the device and plug the SD card into the device again or change the new SD card into the device. Please tap the Image button, next tap button to preview the recorded video from the Micro SD card.

## 3. How to set a motion detection record?

Go to Warning alarm settings and tap the detection button to select motion sensitivity.(Low/Medium/High). Then go to Recording settings and tap Recording mode. select Warningalarm recording

**Note:** The device will record a 30s video to a Micro SD card. A push notification will be sent to your phone with a snapshot picture when any motion is detected.

If you enable motion detection, but you select Full-time recording or Timed recording on the Recording settings option, the device only sends a push notification to your phone and takes a photo to the app.

## 4. How do other users add to the device?

1. Make sure another user download app.
2. Enter settings>>Tap Device information button >>Tap Device UI D button to get a QR code.
3. Open the app on another phone>> Tap add a device. >> Tap Mobile phone scanning QR code sharing to add.

## 5. How to reset the device?

Please press and hold the reset button for 10s. When the device is reset successfully, the green indicator light will flash slowly. This device complies with part 15 of the FCC

This device complies with part 15 of the FCC RulesRules. Operation is subject to the following two conditions: (1) this device may not cause harmful interference, and (2) this device must accept any interference received, including interference that may cause undesired operation. Any changes or modifications not expressly approved by the party responsible for compliance could void the user's authority to operate the equipment.

**NOTE:** This equipment has been tested and found to comply with the limits for a Class B digital device, pursuant to Part 15 of the FCC Rules. These limits are designed to provide reasonable protection against harmful interference in a residential installation. This equipment generates, uses, and can radiate radio frequency energy and, if not installed and used in accordance with the instructions, may cause harmful interference to radio communications. However, there is no guarantee that interference will not occur in a particular installation. If this equipment does cause harmful interference to radio or television reception, which can be determined by turning the equipment off and on, the user is encouraged to try to correct the interference by one or more of the following measures:

- Reorient or relocate the receiving antenna.
- Increase the separation between the equipment and receiver.
- Connect the equipment into an outlet on a circuit different from that to which the receiver is connected.
- Consult the dealer or an experienced radio/TV technician for help.

The device has been evaluated to meet general RF exposure requirements. The device can be used in portable exposure conditions without restriction

## Documents / Resources



无线智能摄像机  
使用说明

[Shenzhen Huang Wei Technology H5 WiFi Camera](#) [pdf] Instructions  
H5, 2A5FR-H5, 2A5FRH5, H5 WiFi Camera, WiFi Camera