



Shenzhen Forever Young Technology TH06 HVCWi-Fi Temperature and Humidity Sensor with Screen User Manual

[Home](#) » [Shenzhen Forever Young Technology](#) » Shenzhen Forever Young Technology TH06 HVCWi-Fi Temperature and Humidity Sensor with Screen User Manual 



SHENZHEN

Forever Young Technology
TH06 HVCWi-Fi Temperature and Humidity Sensor with Screen
User Manual

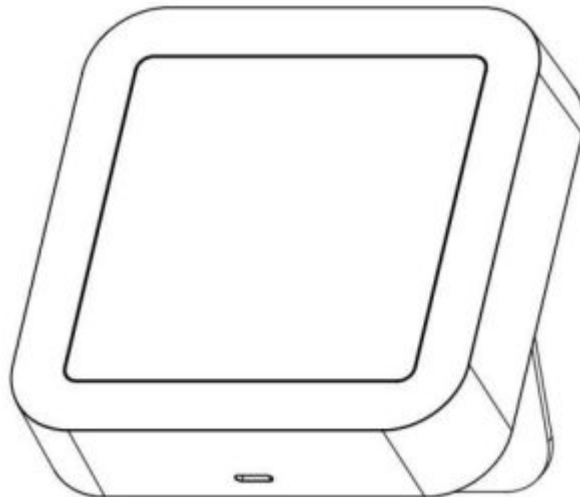

Thanks for choosing our product!
You can real-time monitor the temperature and humidity on the screen directly.
Please kindly read the user manual carefully before usage and keep it for future reference.

Contents

- [1 Product Presentation:](#)
- [2 Specification](#)
- [3 Checklist before using the device:](#)
- [4 How to set up:](#)
- [5 Functions](#)
- [6 FCC Statement](#)
- [7 Documents / Resources](#)
- [8 Related Posts](#)

Product Presentation:

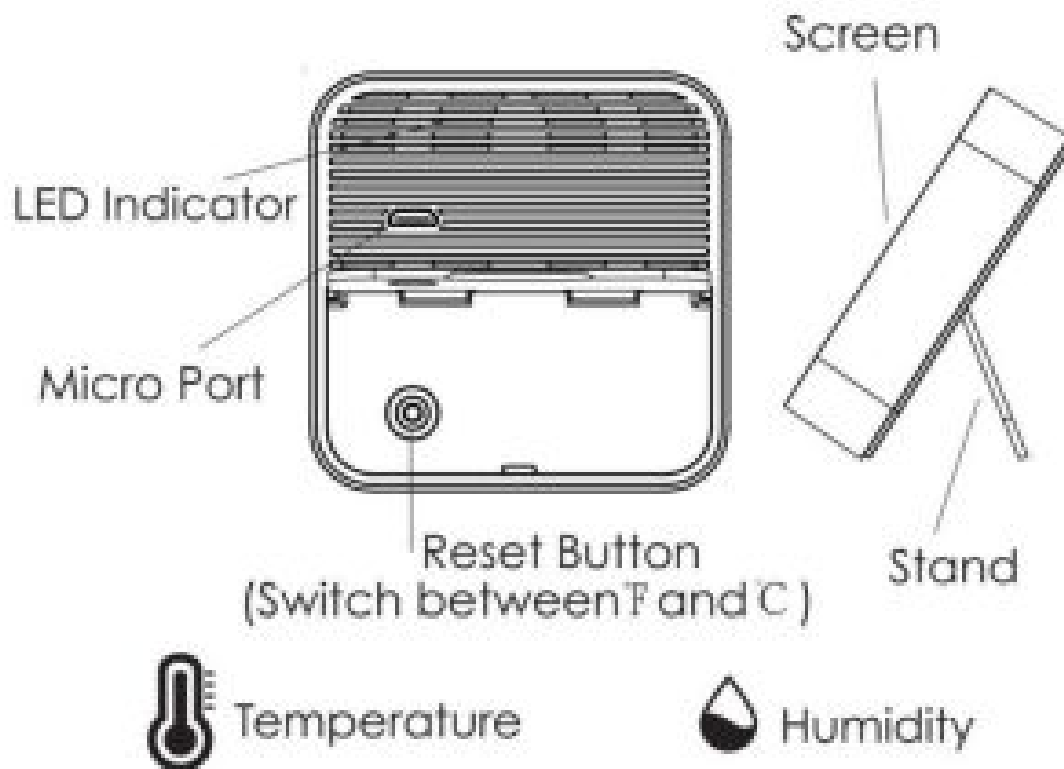

Specification

Size: 65*65*17mm
Micro Input: DC 5V/1A
LED Indicator: Blue
Wi-Fi Protocol: 2.4GHz
Wi-Fi Standard: IEEE 802.11 b/g/n
Temperature Measure Range: 0 C – 60 C
Temperature Accuracy: + 1
Humidity Measure Range: 0% RH-99% RH
Humidity Accuracy: $\pm 5\%$ RH

Checklist before using the device:

- a. Your smartphone has connected to a 2.4GHz Wi-Fi network.
- b. You have input the correct Wi-Fi password.
- c. Your smartphone must be Android 4.4 + or iOS 8.0 +.
- d. Your Wi-Fi router is MAC-open.

e. If the numbers of devices connected to the Wi-Fi router reach the limit, you can try to disable a device to cavate the channel or try with another Wi-H router.

How to set up:

1. Use your smartphone to scan QR code, or search the “Smart Life” app in Google Play Store or APP Store to download and install.



2. Create an account with your mobile number and authentication code.

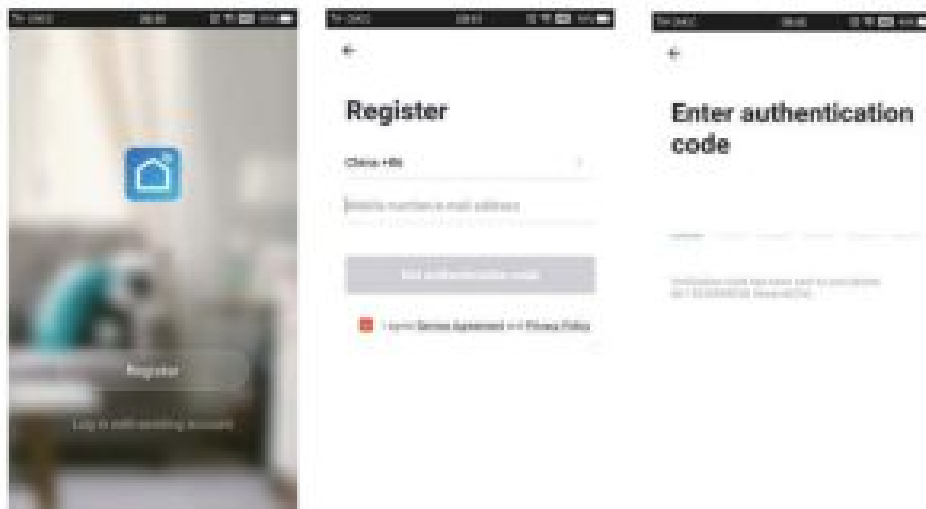

3. Connect your mobile to your Wi-Fi router, supply power to the sensor with the supplied Micro charging cable, click “+” in the upper right corner of the homepage or click “Add Device”.

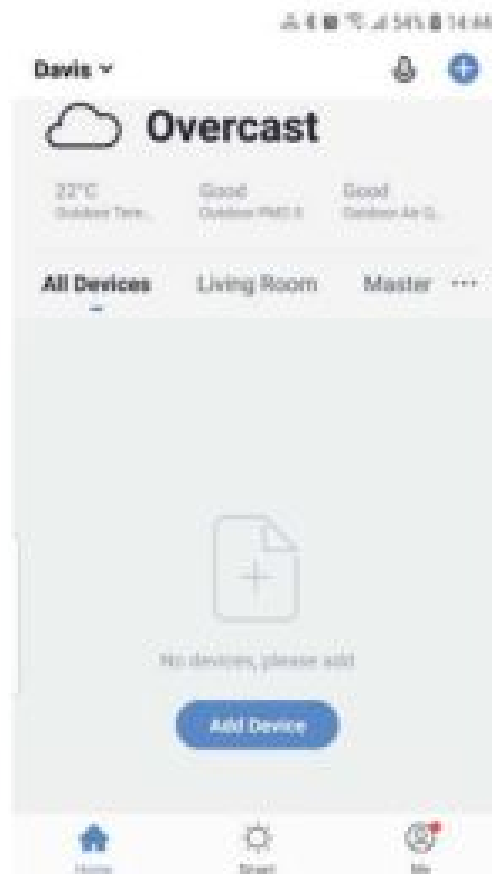

4. 1) Turn on the Bluetooth in mobile: The app will advise you to turn on Bluetooth in your mobile, then you choose the device to add. Enter your Wi-Fi name and Wi-Fi password, it will connect to the Wi-Fi network automatically.



2) Do not turn on the Bluetooth: Select “Temperature and Humidity Sensor(Wi-Fi)” from “Sensors”, enter into the Wi-Fi password, make sure the LED indicator is blinking rapidly, if not, please open the stand at the back, hold the reset button for about 5s till LED indicator blink rapidly. it will connect.

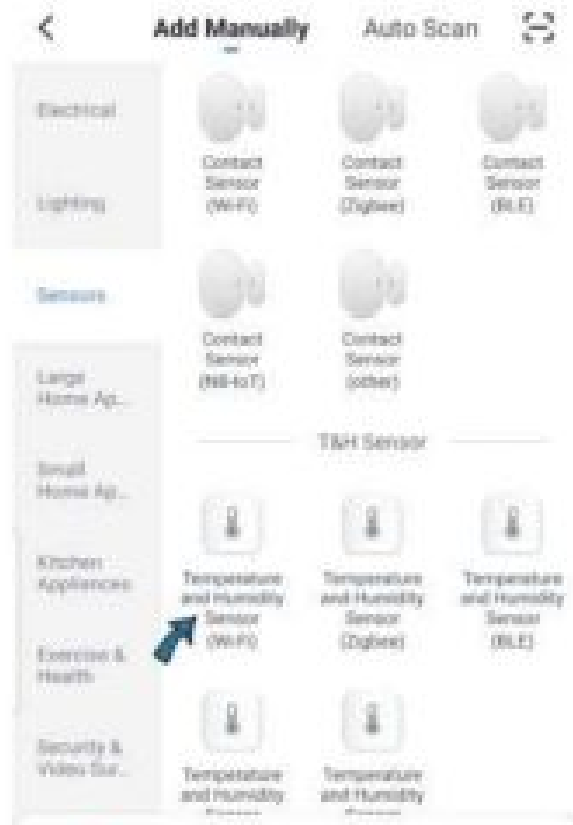

You are advised to enable Blueto...
Enable Bluetooth to add some Wi-Fi d...



3) If your Wi-Fi router opens both 2.4GHz and 5GHz with the same name, enter a Wi-Fi password, please select “AP Mode”, hold the reset button for about 5 seconds till the LED indicator blink slowly, connect your mobile to the device's hotspot: “SmartLife-XXXX”, then click to return to App interface, it will connect to Wi-Fi automatically, configuration complete.

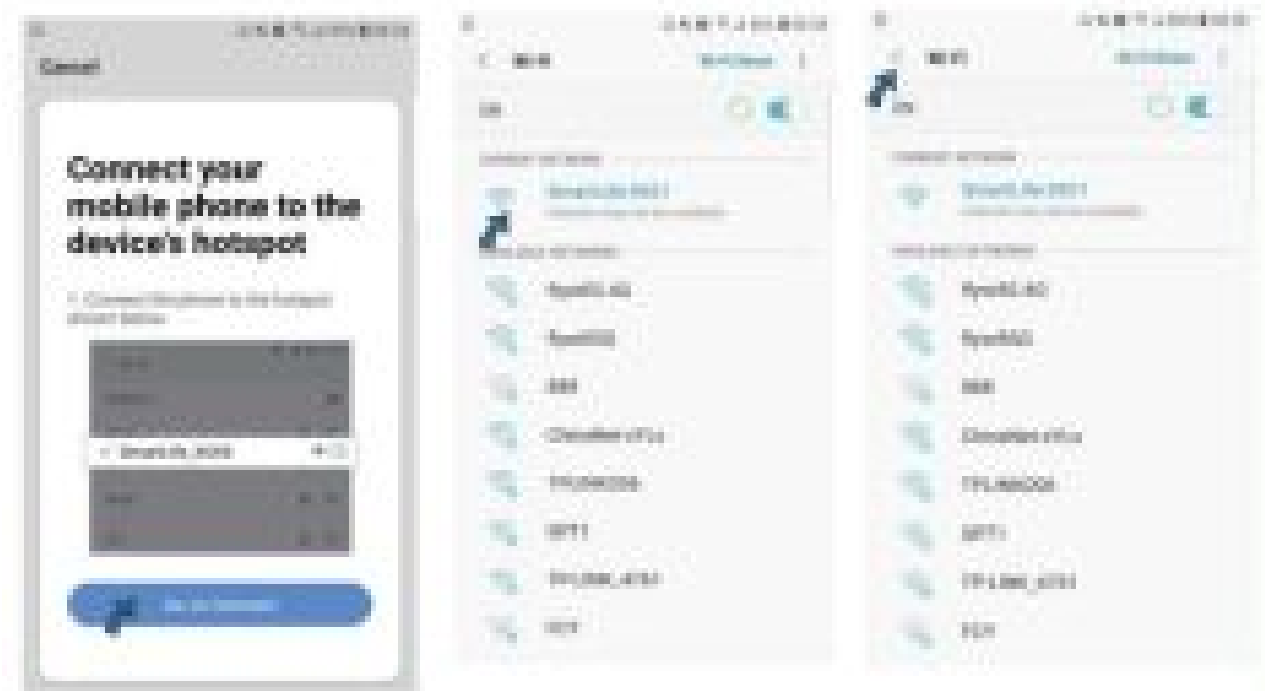
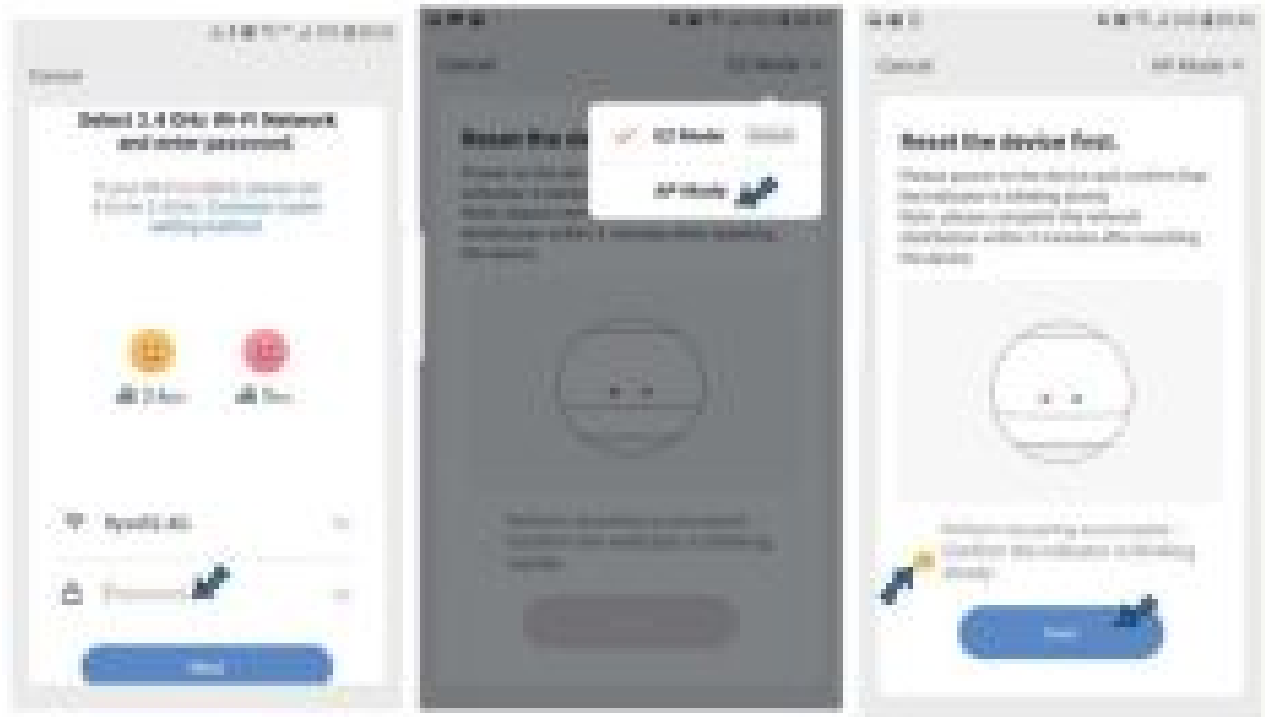

Functions

1. Intelligent Linkage

When the ambient environment change, you can execute intelligent linkage. For example, when the room temperature surpasses 35C, the air-conditioner will open automatically, or when the humidity is lower than 20% RH, the humidifier will spray.

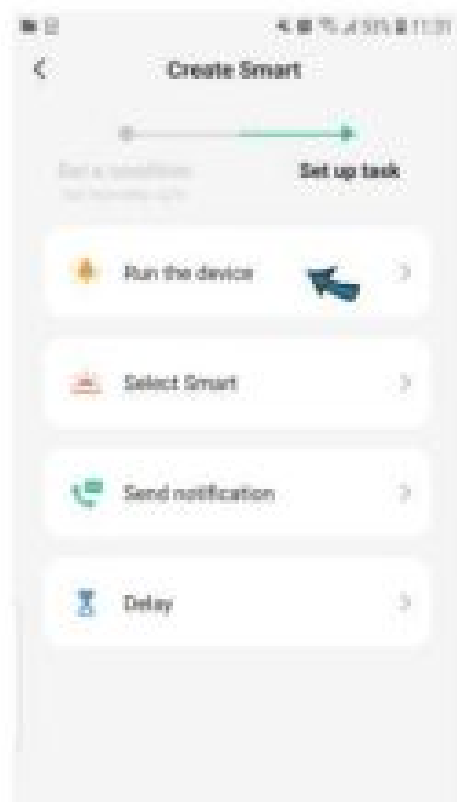
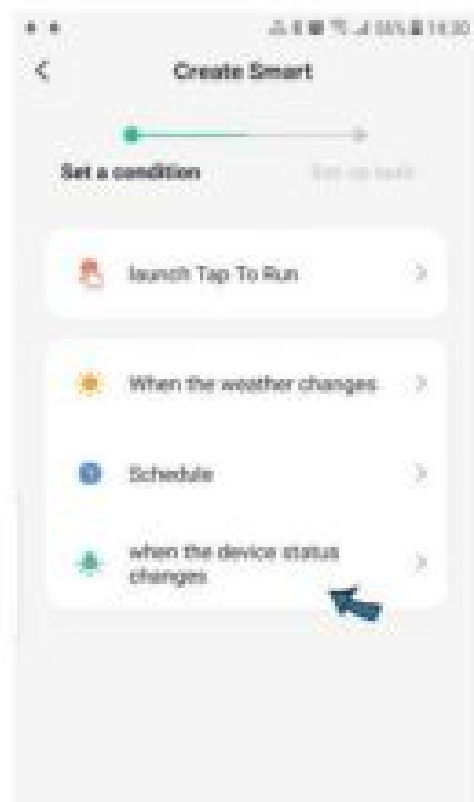
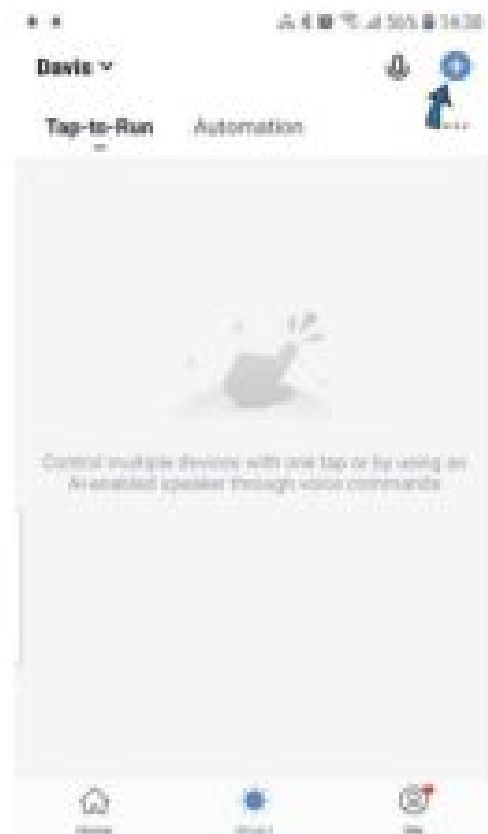
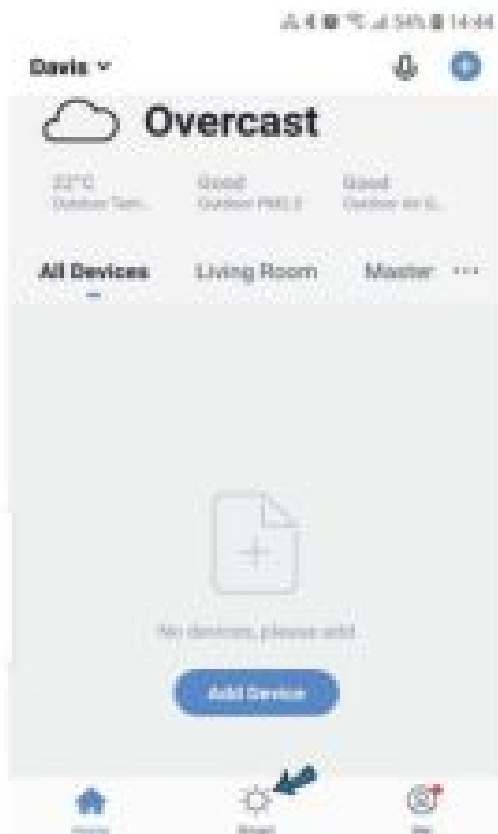

2. Share devises

You can share your added devices with your family members, so they can also monitor the ambient environment.

3. Display on Screen

You can real-time monitor the temperature and humidity on the screen directly.

4. Temperature Unit Switch

You can switch the temperature unit between F and C through the press of the reset button one time.

5. Third-party Voice Control

Works with Amazon Alexa, google assistant.

FCC Statement

This equipment has been tested and found to comply with the limits for a Class B digital device, pursuant to part 15 of the FCC rules. These limits are designed to provide reasonable protection against harmful interference in a residential installation. This equipment generates, uses, and can radiate radio frequency energy and, if not installed and used in accordance with the instructions, may cause harmful interference to radio communications. However, there is no guarantee that interference will not occur in a particular installation. If this equipment does cause harmful interference to radio or television reception, which can be determined by turning the equipment off and on, the user is encouraged to try to correct the interference by one or more of the following measures:

- Reorient or relocate the receiving antenna.
- Increase the separation between the equipment and receiver.
- Connect the equipment into an outlet on a circuit different from that to which the receiver is connected.
- Consult the dealer or an experienced radio/TV technician for help. To assure continued compliance, any changes or modifications not expressly approved by the party.

Responsible for compliance could void the user's authority to operate this equipment. (Example- use only shielded interface cables when connecting to computer or peripheral devices).

This equipment complies with Part 15 of the FCC Rules. Operation is subject to the following two conditions:

1. This device may not cause harmful interference, and
2. This device must accept any interference received, including interference that may cause undesired operation.

FCC Radiation Exposure Statement: The equipment complies with FCC radiation exposure limits set forth for uncontrolled environments. This equipment should be installed and operated with a minimum distance of 20cm between the radiator and your body.

Documents / Resources

	<p>Shenzhen Forever Young Technology TH06 HVCWi-Fi Temperature and Humidity Sensor with Screen [pdf] User Manual</p> <p>TH06, 2ANK8-TH06, 2ANK8TH06, TH06 HVCWi-Fi Temperature and Humidity Sensor with Screen, HVCWi-Fi Temperature and Humidity Sensor with Screen</p>
---	--