



Shenzhen Farmar Science Technology Development BR36 Bluetooth Remote Shutter User Manual

[Home](#) » [Shenzhen Farmar Science Technology Development](#) » Shenzhen Farmar Science Technology Development BR36 Bluetooth Remote Shutter User Manual 

Contents

- [1 Shenzhen Farmar Science Technology Development BR36 Bluetooth Remote Shutter](#)
- [2 Bluetooth Pairing](#)
- [3 Battery Replacement](#)
- [4 FCC WARNING](#)
- [5 Documents / Resources](#)
- [6 Related Posts](#)

Shenzhen Farmar Science Technology

Shenzhen Farmar Science Technology Development BR36 Bluetooth Remote Shutter



Bluetooth Pairing

Turn the button to “ON”, the Bluetooth mode is ready once blue light flashes, Open the mobile phone, enter the option-“setting”, Search and connect with “WONEW-BR36”. Once the connection is successful, the blue light off

Battery Replacement

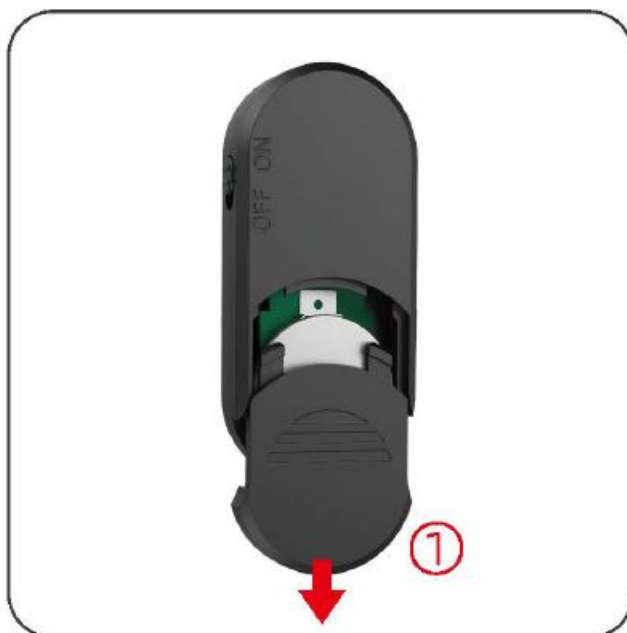

1. Slide down to take the battery cover out

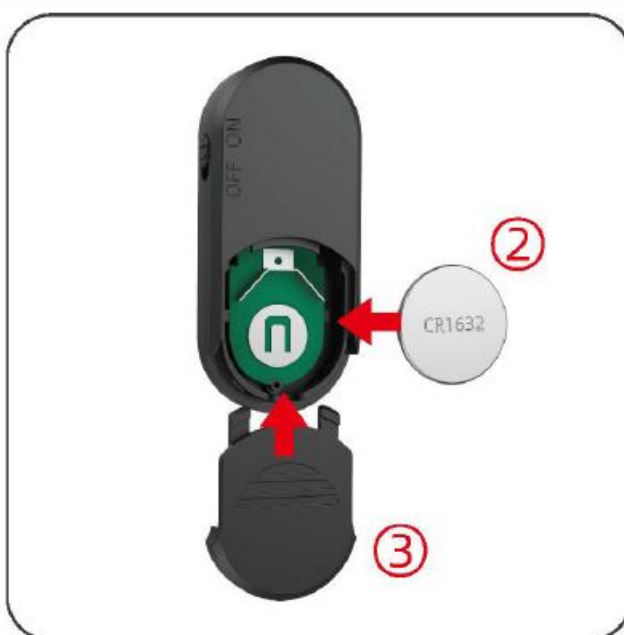

2. Replace with a new battery
3. Slide up the battery cover

FCC WARNING

This device complies with part 15 of the FCC Rules. Operation is subject to the following two conditions: (1) this device may not cause harmful interference, and (2) this device must accept any interference received, including interference that may cause undesired operation. Any changes or modifications not expressly approved by the party responsible for compliance could void the user's authority to operate the equipment.

NOTE: This equipment has been tested and found to comply with the limits for a Class B digital device, pursuant to Part 15 of the FCC Rules. These limits are designed to provide reasonable protection against harmful interference in a residential installation. This equipment generates, uses and can radiate radio frequency energy and, if not installed and used in accordance with the instructions, may cause harmful interference to radio communications. However, there is no guarantee that interference will not occur in a particular installation. If this equipment does cause harmful interference to radio or television reception, which can be determined by turning the equipment off and on, the user is encouraged to try to correct the interference by one or more of the following measures:

- Reorient or relocate the receiving antenna.
- Increase the separation between the equipment and receiver.
- Connect the equipment into an outlet on a circuit different from that to which the receiver is connected.
- Consult the dealer or an experienced radio/TV technician for help. The device has been evaluated to meet general RF exposure requirements. The device can be used in portable exposure conditions without restriction.

FCC ID:2AXJ2-BR36

Warning: Changes or modifications to this unit not expressly approved by the part responsible for compliance could void the user’s authority to operate the equipment

Documents / Resources

<div><p>User Manual</p><p>Bluetooth Pairing</p><p>For the Bluetooth™ BT module, please refer to the user manual of the Bluetooth module. The Bluetooth module is not included in the scope of this manual. Please refer to the user manual of the Bluetooth module for more details.</p><p>Battery Replacement</p></div>	<p>Shenzhen Farmar Science Technology Development BR36 Bluetooth Remote Shutter [pdf]</p> <p>f] User Manual</p> <p>BR36, 2AXJ2-BR36, 2AXJ2BR36, BR36 Bluetooth Remote Shutter, Bluetooth Remote Shutter, Remote Shutter</p>
-------------------------------------------------------------------------------------------------------------------------------------------------------------------------------------------------------------------------------------------------------------------------------------------------------------------------------------------------------------------------------------------------------------	---------------------------------------------------------------------------------------------------------------------------------------------------------------------------------------------------------------------------------------------