



Shenzhen Ejiale Digital Technology T1 Portable Projector User Manual

[Home](#) » [Shenzhen Ejiale Digital Technology](#) » Shenzhen Ejiale Digital Technology T1 Portable Projector User Manual 

Contents

- 1 [Shenzhen Ejiale Digital Technology T1 Portable Projector User Manual](#)
- 2 [IMPORTANT SAFETY PRECAUTION:](#)
- 3 [PACKING LIST](#)
- 4 [MAINFRAME INTRODUCTION](#)
- 5 [REMOTE CONTROL INTRODUCTION](#)
- 6 [INSTALLATION AND DEBUGGING](#)
- 7 [WIRELESS PROJECTION](#)
 - 7.1 [Phone Projection Setting Note Due to copyright issues Neillix /](#)
- 8 [MENU SETTING](#)
- 9 [DEVICE CONNECTION](#)
- 10 [ORRECT DISPOSALT: OF THIS PRODUC](#)
- 11 [Read More About This Manual & Download PDF:](#)
- 12 [Documents / Resources](#)
 - 12.1 [References](#)
- 13 [Related Posts](#)

Shenzhen Ejiale Digital Technology T1 Portable Projector User Manual

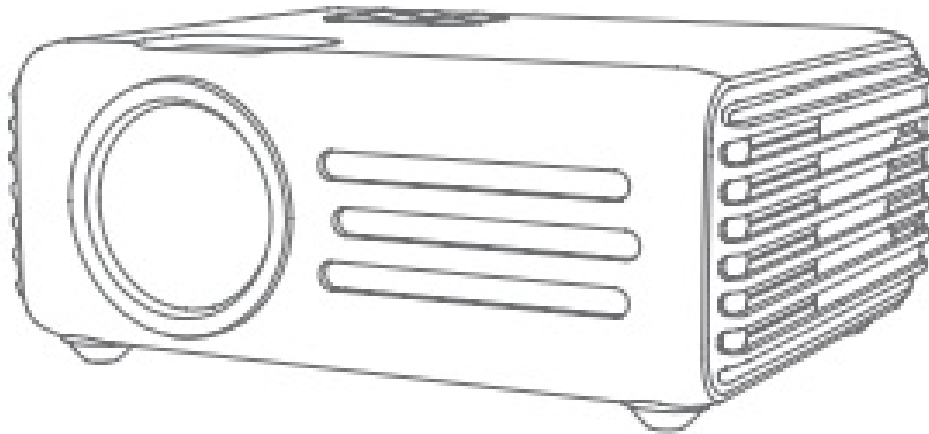

IMPORTANT SAFETY PRECAUTION:

Important In order to get the best viewing effect, it is suggested that you use the product in a dark room. Warning: Following safety instructions can sustain products lifespan and prevent it from firing or electric shock, so please read them carefully and pay attention to all warnings • Do not install it in a place with poor ventilation • Do not install it in a hot or damp place.

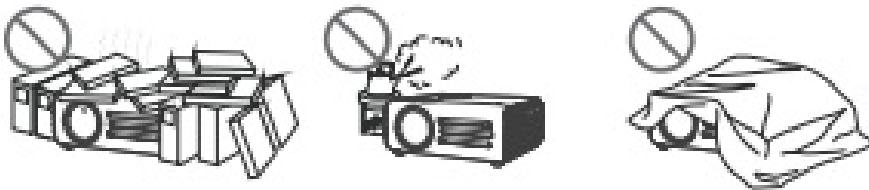

Note In order to maintain the performance and reliability of projector, please leave at least 30cm of space around the projector. Note The projector's light is very bright so please do not look at it directly or point its light to your eyes in case of causing visual damage.

- Do not block its ventilation holes (Intake or Exhaust).
 - Do not install it in a dusty or smoky place.
 - Do not install it near to the temperature/smoke sensor, since it might make the sensor fail to work.
- Do not install it in a position directly blown by air condition, otherwise it might be malfunctioned because of the water & vapour condensation or high temperature.

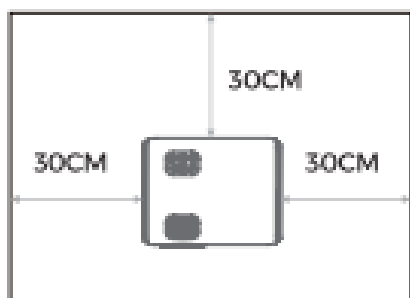
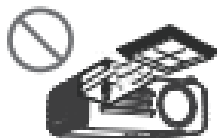
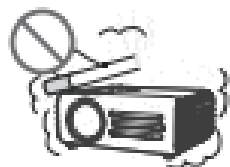

PACKING LIST

NOtt Please check whether the aoaassories are complete after opening the package. if it's not com-plete. please contact customer service for a replacement.



Mainframe

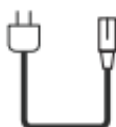

Power Cable



Remote Control



HDMI Cable

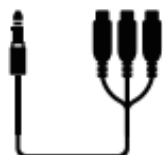

AV Cable

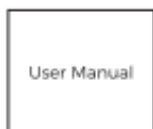

User Manual



Projection Screen



FAQ

MAINFRAME INTRODUCTION

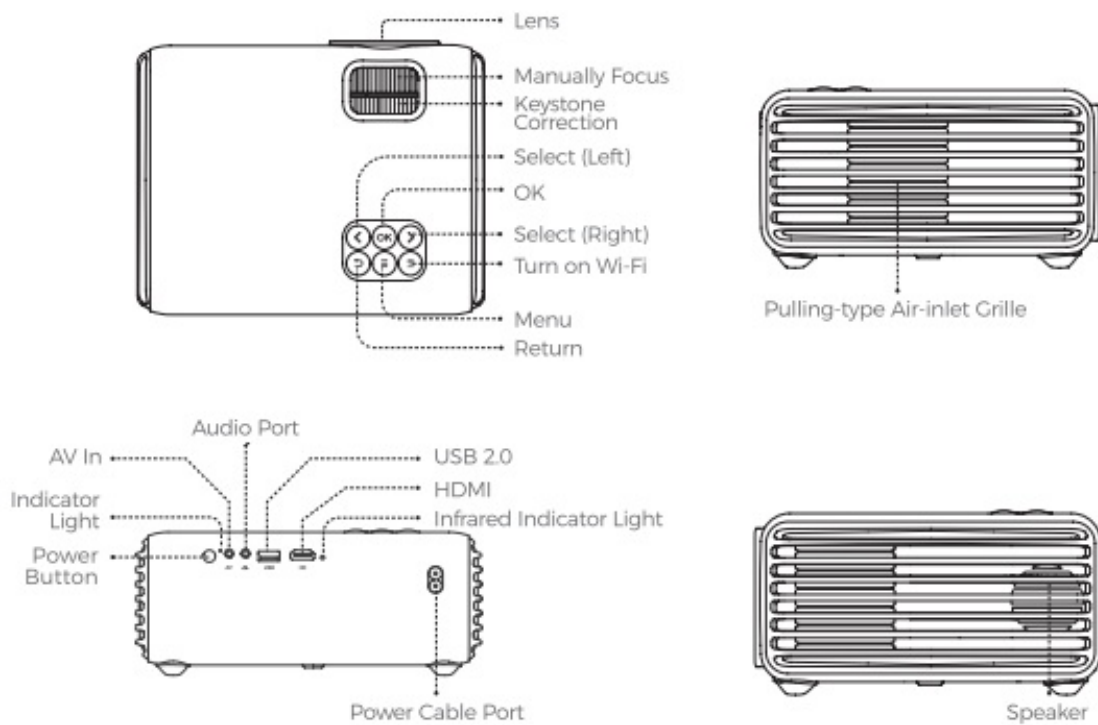

REMOTE CONTROL INTRODUCTION

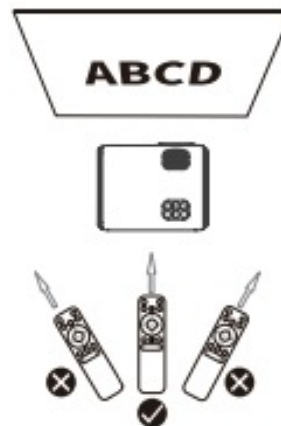
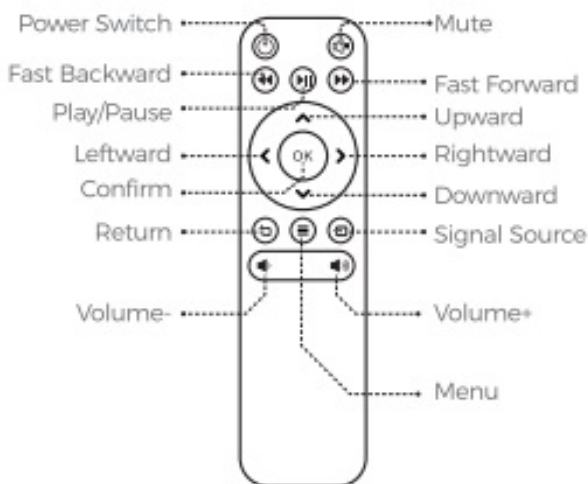

Note: Due to the design improvement the appearance/screen printing/characters of the remote con-trol might be somewhat different from the real product please in kind prevail.

NOTES Be cautious when using the remote control. Do not expose the remote control under not drop It trample on It. or spill any liquid into sunlight. its body. Do not put the remote control in a damp place. Do not put the remote control near to any heat source.

INSTALLATION AND DEBUGGING

Method 1: Put it horizontally

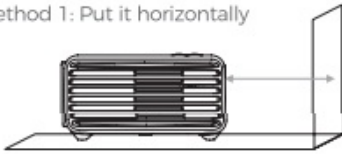

Method 2: Hang it with Mount

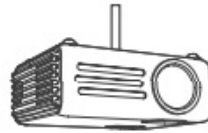

Instructions (Corresponding to Method 1)

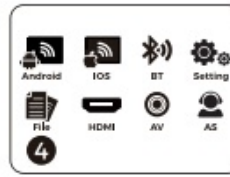
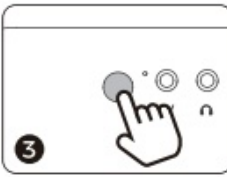
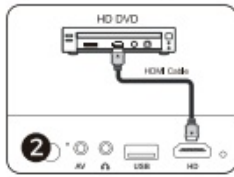
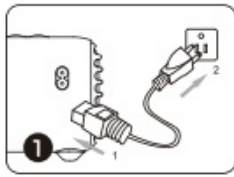

Recommended projection distance is 2-3m (6.5-9 ft)

5

Referential Projection Distance

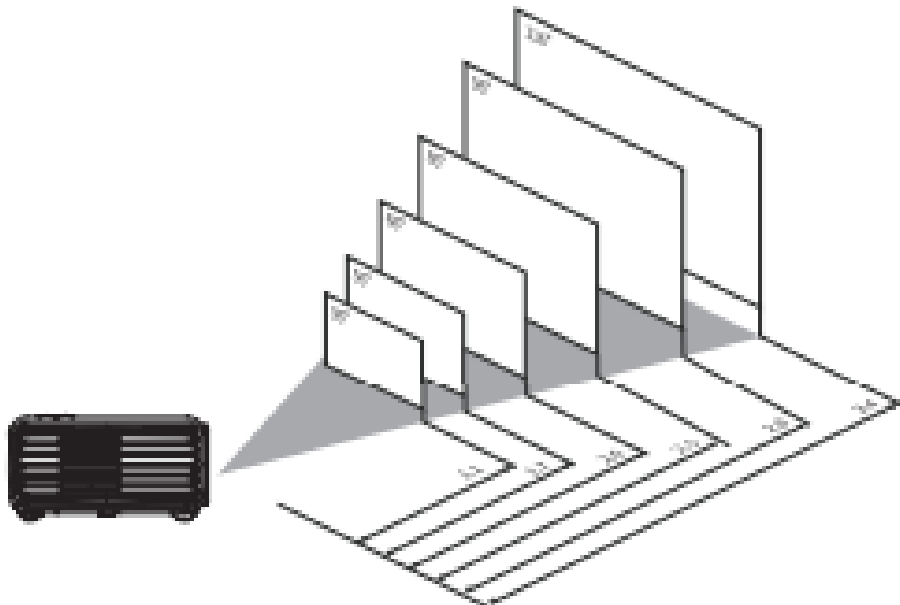

Turn On and Off Short press the power buttons of projector or remote control to turn it on or off. Note. Do not unplug its power to turn it Off directly otherwise It might shorten products lifespan.

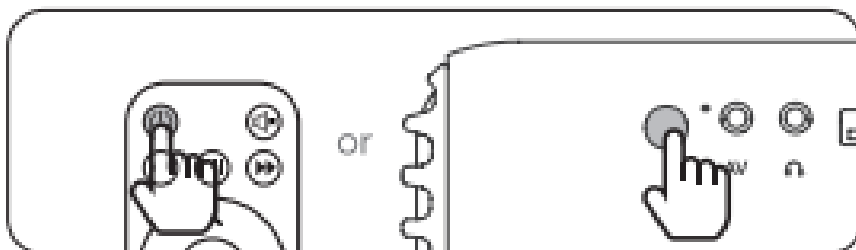

PRODUCT SPECIFICATIONS

Product Name	Video Projector (Home Use)
Product Size	225×178×85(mm)
Display Technology	LCD
Light Source	LED
Focusing Method	Manually Focus
Keystone Correction	Manually Adjust (±15°)
Screen Ratio	4:3/16:9
LED Lifespan	100,000 hours
Native Resolution	1920x1080 Pixel
Input Resolution	800×480P/ 1280×720P/ 1920×1080P
Contrast Ratio	10000:1
Input Ports	HDMI/USB 2.0/AV/AUX
Projection Size	40-250 inch
Best Projection Distance	2m
Speaker	1 x (3W/4Ω) Box
Total Power	80W
Power Voltage	100V-240V- 50Hz-60Hz

WIRELESS PROJECTION

Phone Projection Setting Note Due to copyright issues Neillix /

Ar 1..\$2011 Prime Video/ Hulu prohibits playing movies from the projector. You can use a TV Stick. Roku Stick Computer. and laptop to connect the projector to watch.
 NOT support Dolbys sound. If there is no sound when playing videos like Neill ix. turn off Dolby sound. (Settings > Display & Sounds > Audio > Dolby Digital Output > and then turn Dolby Digital Plus OFF) Android

1. Systerr(Samsunghtuawei/Ximorni/Sony/One Plus. etc-) I. Select “Android-on projector’s interface
2. Turn on WiFi on your Android device and connect it to the network
3. Enter into phone settings and select ‘Screen-sharing% click it and find the device to connect

Note. For different phone brand& the names of ‘screen-sharing’ are different



Step 1

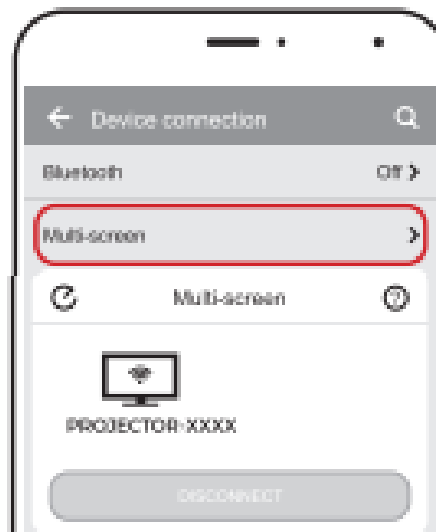

Step 2

IOS System SPhone) 1 Connect projector to your home network according to following steps Select -105— Select WIRELESS’ —Select *Wi-Fi Setting’ —Select your home WI-F BH665—Connect the Wi-Fi 2 Turn on your iOS dance and connect it to the same Wi-Fi the projector. Then turn on Phones Scieen Minoring. and choose the PROJECTOR-7’0(XX and connect it

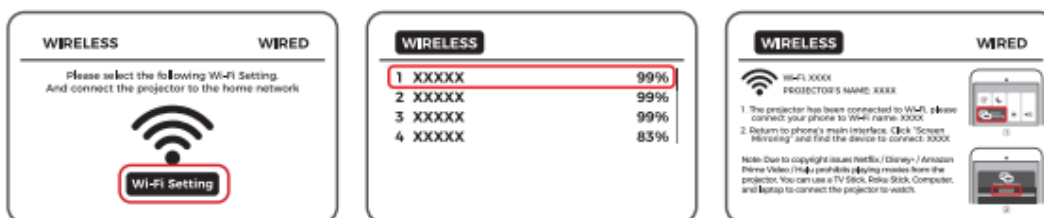
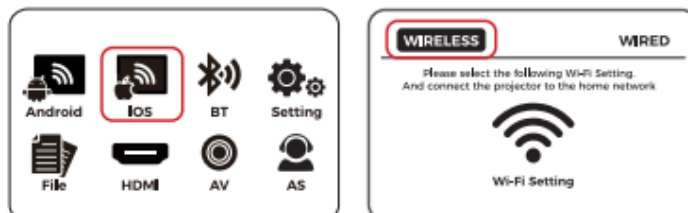

MENU SETTING

Get the best viewing effect with the most appropriate settings. YOU could set some relative Pararne. ters

according to tenoning step& 1. Enter into 'Setting' on main interface of the projector. 2. You could set the Time and "Option" and the parameter of the Picture and 'Sound'".

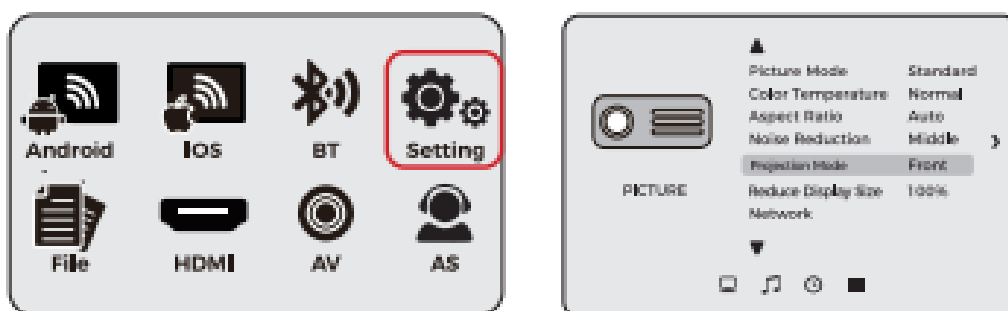

DEVICE CONNECTION

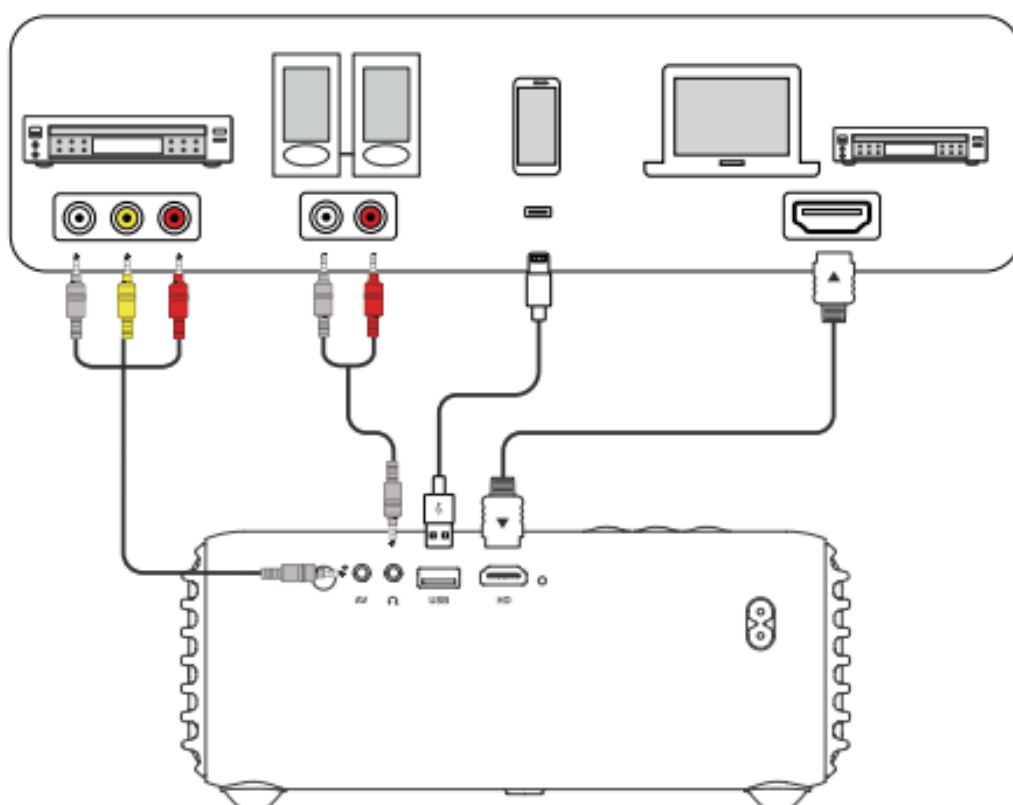

ORRECT DISPOSALT: OF THIS PRODUC

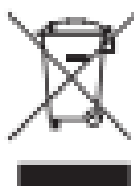

Waste Electrical& Electronic Equipment | This Marking shown on the product or its literature, indicate that it should not be disposed with other household wastes at the end of its working life. To prevent possible harm to the environment or human health from uncontrolled waste disposal, please separate this from other types of wastes and recycle it responsibly to promote the sustainable reuse of material resources Household user should contact either the retailer where they purchased this product, or their local government office, for details of where and how they can take this item for environmentally safe recycling. Business users should contact their supplier

and check the terms and conditions of the purchase contact This product should not be mixed with other commercial wastes for disposal.

Read More About This Manual & Download PDF:

Documents / Resources

	Shenzhen Ejiale Digital Technology T1 Portable Projector [pdf] User Manual T1, 2A64G-T1, 2A64GT1, T1 Portable Projector, Portable Projector
---	--

References

- [User Manual](#)

[Manuals+](#), [Privacy Policy](#)

This website is an independent publication and is neither affiliated with nor endorsed by any of the trademark owners. The "Bluetooth®" word mark and logos are registered trademarks owned by Bluetooth SIG, Inc. The "Wi-Fi®" word mark and logos are registered trademarks owned by the Wi-Fi Alliance. Any use of these marks on this website does not imply any affiliation with or endorsement.