



Shenzhen Dwason Technology KB319+MC219 2.4G Wireless Keyboard and Mouse Combo User Manual

[Home](#) » [Shenzhen Dwason Technology](#) » Shenzhen Dwason Technology KB319+MC219 2.4G Wireless Keyboard and Mouse Combo User Manual 

Contents

- [1 Shenzhen Dwason Technology KB319+MC219 2.4G Wireless Keyboard and Mouse Combo](#)
- [2 Product Specification](#)
- [3 You will receive](#)
- [4 How to setup](#)
- [5 How To repair the keyboard the USB reciver](#)
- [6 Note](#)
- [7 Documents / Resources](#)
- [8 Related Posts](#)

Shenzhen Dwason Technology

Shenzhen Dwason Technology KB319+MC219 2.4G Wireless Keyboard and Mouse Combo



Product Specification

Product Specification

Keyboard parameters:

Dimensions: 443*136*30mm

Weight: 555±5g

Connection: 2.4G Wireless Connection

Receiver type: USB Nano Receiver

Battery Capacity: 1500mAh

Working Current (without backlight): 2mA

Working Time (without backlight): 750 hours

Working Current (with the brightest backlight on): 40 mA

Working Time (with the brightest backlight on): 35 hours

Standby Current: 50uA

Standby Time: 365 days

Backlight Sleep Mode: 2 minutes without use (Press any key to activate the backlight)

Keyboard Sleep mode: 30 minutes without use (Press any key to activate the key board)

Mouse parameters:

Mouse Battery Capacity: 650mAh

Mouse DPI: 800-1200-1600

Power Saving: Enter sleep mode after 1.5 minutes without action.

Charging Time of Mouse: 3h

Charging Time of Keyboard: 3h

Working Current (with Backlight): 15mA

Working Time (with backlight): 44 hours

Working Current (without backlight): 3mA

Working Time (without backlight): 200 hours

You will receive

You will receive

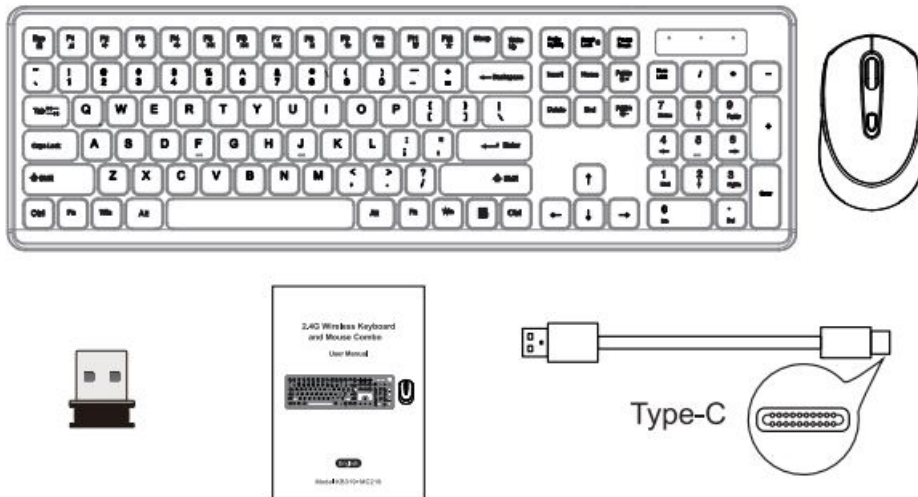

How to setup

How to set up

1

Step 1: Plug the USB dongle into your computer.

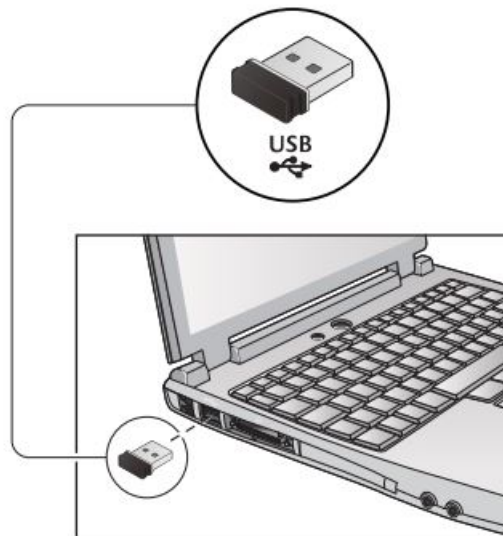

2

Step 2: Turn on the keyboard and mouse

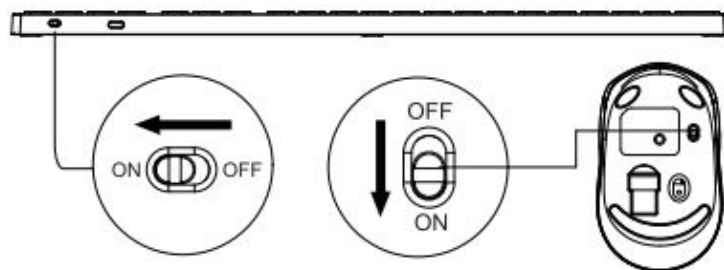

Step 3: The keyboard and mouse will automatically connect to the computer, no driver needed.

Instruction of the keyboard backlight

- Press and Hold **Fn** key , then press **ScrIk** key to turn on/ turn off backlight
- Press and Hold **Fn** key ,then press **PgUp** key to increase backlight brightness, low-mid-high-off
- Press and Hold **Fn** key ,then press **PgDn** key to decrease backlight brightness



Lighting Switch

Press the button for 3 seconds to turn on/off the lighting.

Click the LED Switch Button to switch 15 different lighting effects



English

Thank you for purchasing our products. If you have any question with this product, please contact us

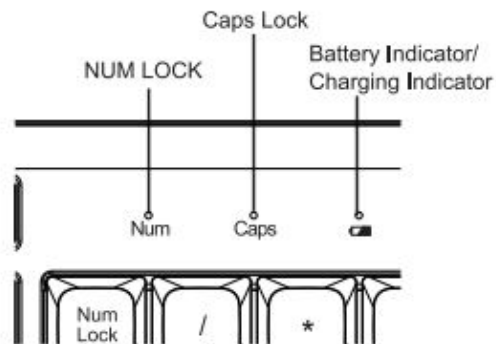

LED Indicator of the Keyboard

Low Battery: the led red light will flash

Charging: the led red light will be on

Fully Charged: the led red light will turn off

LED Indicator of the Mouse

Charging: the led red light will be on

Fully Charged: the led red light will turn off

If the battery is low, please charge the mouse so that it will work properly.

LED indicator for charging



How To repair the keyboard the USB reciver

How to repair the keyboard to the USB receiver

Step 1: Unplug the USB dongle

Step2: Turn on the keyboard

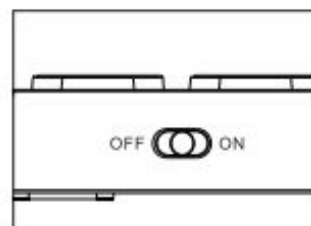

Step 3: Press and hold the "ESC" and the "=" key together for 3-5 seconds.

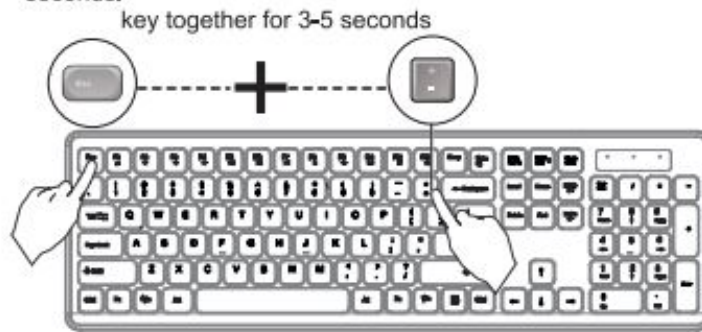

Step 4: LED indicator for low battery / connection
Lights constantly.

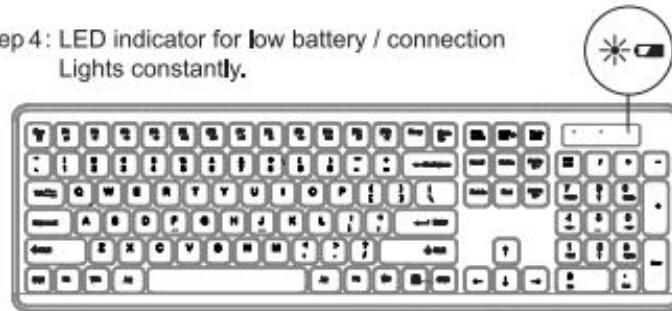

Step 5: Plug in the USB receiver and place the keyboard as close as possible to the USB receiver.

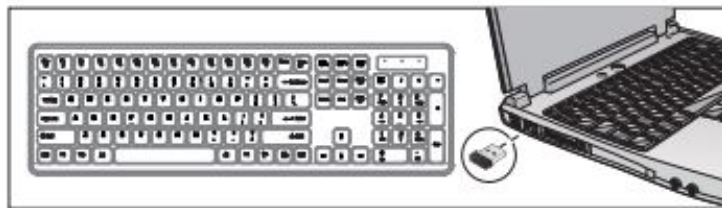

Step 6: When the LED Indicator for low battery / connection turns off, the keyboard is successfully connected.

How to repair the mouse to the USB receiver

Step 1: Pull out the USB receiver from your computer.



Step 2: Turn off the mouse.

Step 3: Plug the receiver to the USB port of the computer, turn on the mouse and waiting for 5s.

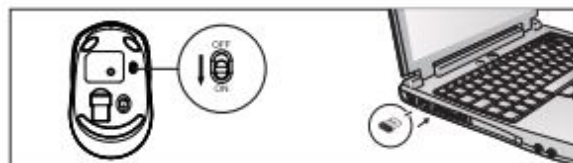

Step 4: The mouse will connect.

Note

Note

The multimedia keys are for Win 8 and Win 10, for other systems, there may be no function for some combined keys.

This equipment has been tested and found to comply with the limits for a Class B digital device, pursuant to part 15 of the FCC Rules. These limits are designed to provide reasonable protection against harmful interference in a residential installation. This equipment generates uses and can radiate radio frequency energy and, if not installed and used in accordance with the instructions, may cause harmful interference to radio communications. However, there is no guarantee that interference will not occur in a particular installation. If this equipment does cause harmful interference to radio or television reception, which can be determined by turning the equipment off and on, the user is encouraged to try to correct the interference by one or more of the following measures:

- Reorient or relocate the receiving antenna.
 - Increase the separation between the equipment and receiver.
 - Connect the equipment into an outlet on a circuit different from that to which the receiver is connected.
 - Consult the dealer or an experienced radio/TV technician for help
- Changes or modifications not expressly approved by the party responsible for compliance could void the user's authority to operate the equipment.

This device complies with Part 15 of the FCC Rules. Operation is subject to the following two conditions:

- (1)This device may not cause harmful interference
- (2)This device must accept any interference received, including interference that may cause undesired operation.

The device has been evaluated to meet general RF exposure requirement. The device can be used in portable exposure condition without restriction.

Documents / Resources

	<p>Shenzhen Dwason Technology KB319+MC219 2.4G Wireless Keyboard and Mouse Combo [pdf] User Manual</p> <p>KB319, 2AYJU-KB319, 2AYJUKB319, MC219, 2AYJU-MC219, 2AYJUMC219, KB319 MC219 2.4G Wireless Keyboard and Mouse Combo, 2.4G Wireless Keyboard and Mouse Combo, Keyboard and Mouse Combo, Mouse Combo</p>
---	---