



# Shenzhen Divoom Technology DIT00 Ditoo Plus Retro Pixel Art Game Bluetooth Speaker User Manual

[Home](#) » [Shenzhen Divoom Technology](#) » Shenzhen Divoom Technology DIT00 Ditoo Plus Retro Pixel Art Game Bluetooth Speaker User Manual 

## Contents

- [1 Shenzhen Divoom Technology DIT00 Ditoo Plus Retro Pixel Art Game Bluetooth Speaker](#)
- [2 WHAT'S INCLUDED?](#)
- [3 PRODUCT DETAILS](#)
- [4 HOW TO OPERATE THE DITOOMIC KARAOKE FUNCTION?](#)
- [5 HOW TO OPERATE DITOOMic ON-SCREEN MENU?](#)
- [6 HOW TO CONNECT THE SPEAKER?](#)
- [7 HOW TO SET UP A MANUAL ALARM?](#)
- [8 HOW TO PLAY THE TF CARD AUDIO?](#)
- [9 HOW TO USE THE UAC USB Audio Card?](#)
- [10 HOW TO CHARGE?](#)
- [11 PRODUCT SPECIFICATION](#)
- [12 MICROPHONE SPECIFICATION](#)
- [13 SAFETY GUIDE](#)
- [14 DECLARATION OF CONFORMITY](#)
- [15 PRODUCT WARRANTY CARD](#)
- [16 WARRANTY INFORMATION](#)
- [17 WARRANTY INFORMATION](#)
- [18 FCC Statment](#)
- [19 Documents / Resources](#)
  - [19.1 References](#)
- [20 Related Posts](#)

# SHENZHEN

Shenzhen Divoom Technology DIT00 Ditoo Plus Retro Pixel Art Game Bluetooth Speaker



## NICE TO MEET YOU!

Thank you for purchasing the DitooMic, the best desktop gadget from Divoom. With DitooMic & its companion APP, you can create pixel art designs and interact with the largest pixel art community, as well as to enjoy its great audio and its karaoke function. Let's take your entertainment to a whole new level!

## WHAT'S INCLUDED?

- **DitooMic**
- **Microphone**
- **User manual**
- **USB Type-C charging cable**



**DitooMic**

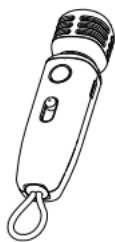

**Microphone**



**User manual**

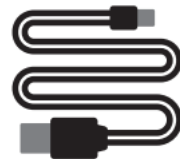

**USB Type-C charging cable**

Thank you for purchasing a Divoom product! Please read this manual carefully. You can also visit [www.divoom.com](http://www.divoom.com) to learn more about our other products. Due to the nature of the technology product, the information on this manual is subject to change without prior notice. If you have any questions, please contact Divoom customer support.

## PRODUCT DETAILS

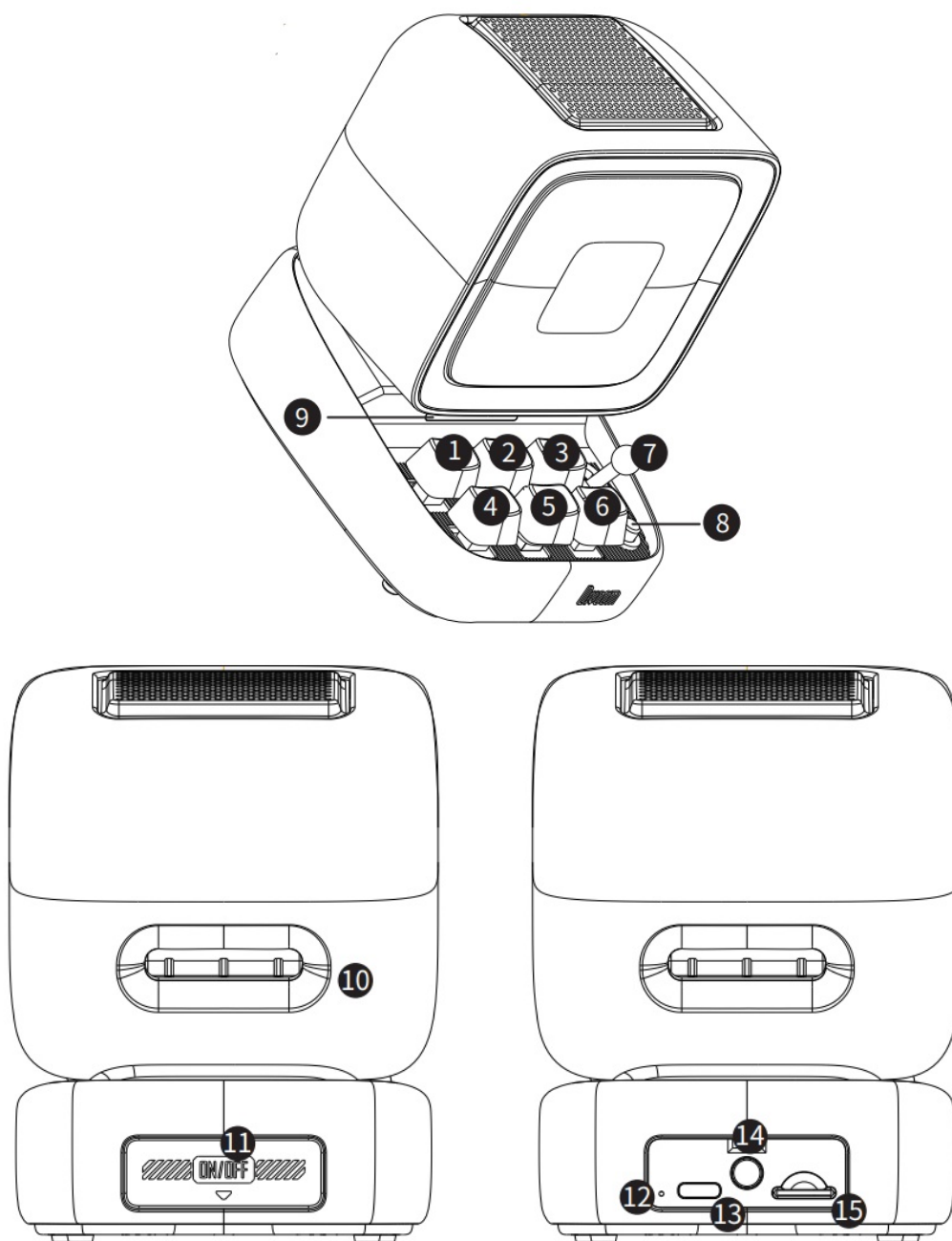

### 1. ' . m 'button

**Press:** Enter/Exit menu system

**Hold:** Turn On/Off the keyboard backlight

### 2. ' . + 'button

**Press:** Increase volume

**Hold:** Increase brightness

### 3. ' ⚙ 'Lighting button

**Press:** Change the light function

**Hold:** Change light effects

### 4. ' ← 'button

**Press:** Previous song

**Hold:** Last light effect

### 5. ' — 'button

**Press:** Decrease volume

**Hold:** Lower brightness

6. → **'button**

**Press:** Next song

**Hold:** Next light effect

7. **Lever**

**Short pull:** Play/Pause/Answer/End call

**Long pull:** Start voice memo recording/Reject call

8. **Karaoke button**

**Press:** Activate/Exit karaoke mode (Light=active / No light=inactive)

**Hold:** Under karaoke mode with SD card inserted, start recording to the SD card. Not under karaoke mode with an SD card inserted, start to playback the recording.

9. **Battery**

Press any button to check the battery status

10. **Bass port**

11. **Rear port flap**

12. **Reset pinhole**

13. **USB-C charging port**

14. **ON/OFF button**

**Press:** Change audio modes (Bluetooth/USB audio/TF card)

**Double press:** Disconnect Bluetooth connection

**Hold:** Power ON/OFF speaker

15. **TF card slot**

Playback music from TF card

## **HOW TO OPERATE THE DITOOMIC KARAOKE FUNCTION?**

Hold the power button on the microphone to power it ON, and activate the karaoke function on the DitooMic by pressing the karaoke button. When the karaoke button on the speaker stops flashing (and remains solid), that means you are ready to sing karaoke!

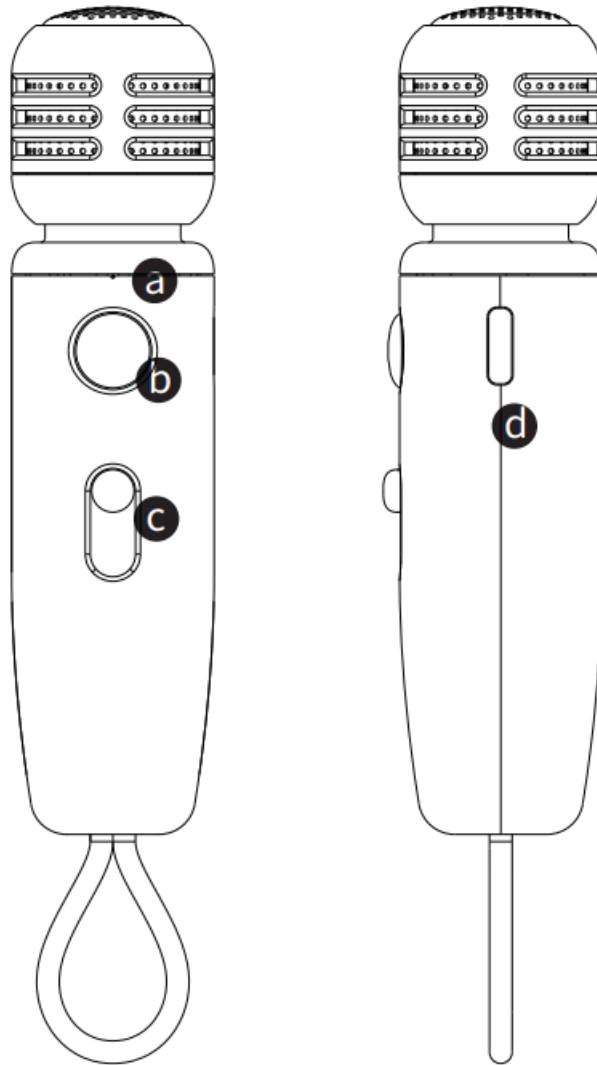

- **Charging indicator**

**Red:** Charging (OFF when fully charged)

**Slow blink (red):** Low battery

**Blue:** blink=pairing / solid=connected

- The press power button will cause the indicator to flash once

- **Power button**

**Hold:** Power ON/OFF microphone

**Press:** Change voice profiles

**Double press:**

Stream mode (DitooMic must connect to a computer via USB cord)

- **Volume slider (microphone)**

- **TYPE-C charging port**

## HOW TO OPERATE DITOOmic ON-SCREEN MENU?

1. Press the “m” button to activate the menu system.
2. Press the arrow buttons to switch between the menu functions.
3. Pull the lever to confirm selection, and press the “m” button to exit the current menu.

## HOW TO CONNECT THE SPEAKER?

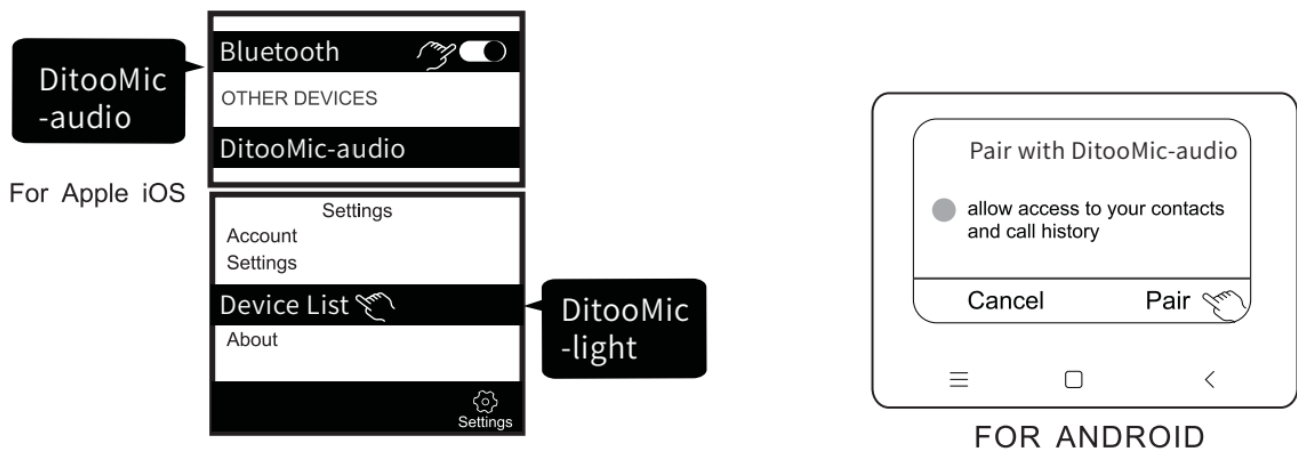

### Download mobile application

Search 'Divoom' application for both iOS and Android systems. Please grant all privilege requests prompted by the APP.

#### For Apple iOS system

Search and connect the 'DitooMic-audio' in Bluetooth settings, then search and connect the \*DitooMic-light in the Divoom APP.

#### For Android system

Search and connect the 'DitooMic-light' or 'DitooMic-audio' in APP or Settings



Download the Divoom  
from *the App Store*  
and Google Play™

### HOW TO SET UP A MANUAL ALARM?

1. Press the "m" button and switch to the alarm setting menu.
2. Pull the lever to confirm and enter alarm settings.
3. Press "+/ —" to change the time value, and pull the lever to confirm settings.
4. Pull the lever to confirm/activate the alarm, and hold the lever to delete and exit the alarm menu Only one

manual alarm is available. For more alarm options, please use the mobile APP.

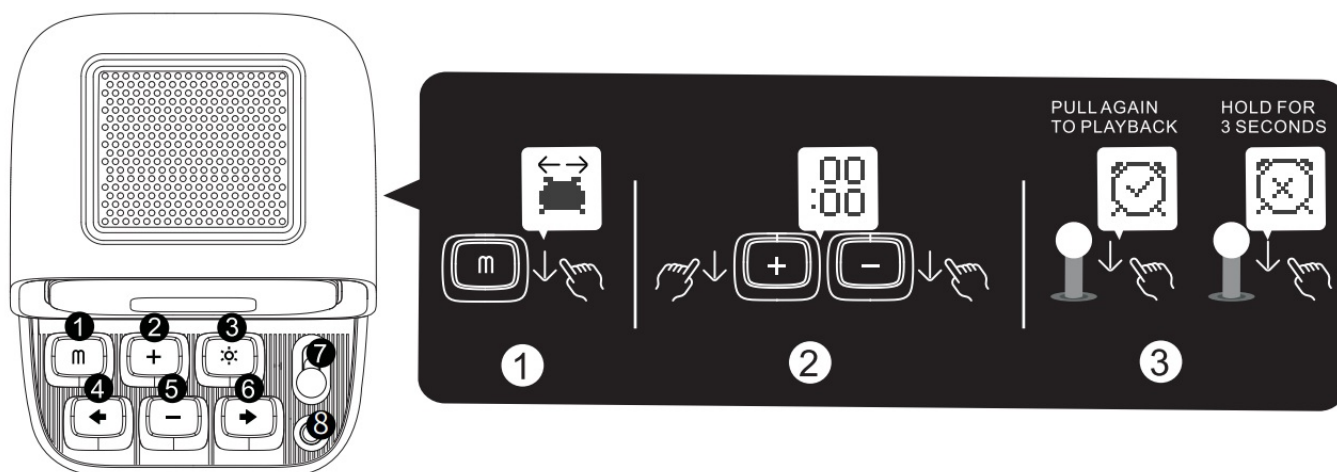

## HOW TO PLAY THE TF CARD AUDIO?

1. Insert the TF card, and the audio should start to play automatically.
2. Press the power button and change to the TF card audio option. or use the on-screen menu function. Press the 'm' button to enter the menu function.
3. Find the music icon, and pull the lever to enter.
4. Switch to the 'SD card' with the arrow keys, and pull the lever to confirm the selection
5. Play the audio via the keyboard (play/pause/volumes/change songs) MP3/WAV/FLAC are the only supported file formats. The maximum supported capacity is 64GB

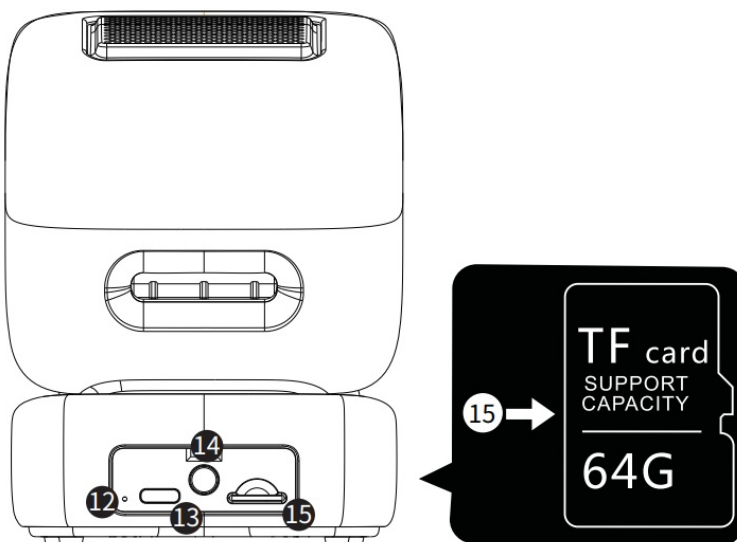

## HOW TO USE THE UAC USB Audio Card?

1. Connect the USB-C cable to the speaker.
2. Use the power button(or on-screen menu) to change the DitooMic to the UAC mode.
3. In the Mac OSX/Windows systems, go to sound output to the USB audio source. Windows will install a generic driver
4. The computer will start to play its audio through the DitooMic.

## HOW TO CHARGE?

1. Insert the USB Type-C cable into the speaker.
  2. Press the any button to check the battery percentage. When charging, the indicator light will lit. Upon 100% charged, the indicator will be fully lit.
- Please use a 5V 2A charger, and do not use a higher voltage charger.

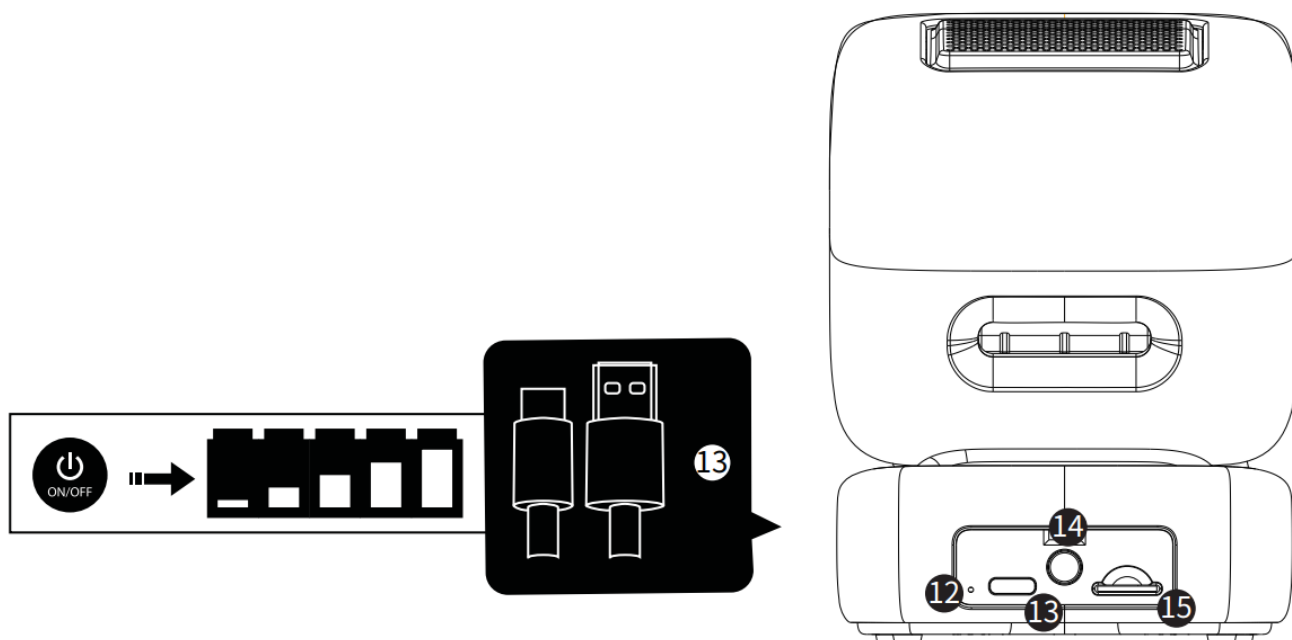

## PRODUCT SPECIFICATION

- **Dimension:** 114.2 x 90 x 121.2mm
- **Weight:** 524g
- **Speaker size:** 48mm
- **Output power:** 15W
- **Frequency response:** 80-20KHz
- **Signal-to-noise ratio:** 72dB
- **Playback time:** 8hrs
- **Battery capacity:** 5000mAh
- **Battery voltage:** 3.6V
- **Battery charge time:** 4hrs
- **Charge:** 5V 2A
- **Wireless range:** 10M/33ft
- **Bluetooth compliant:** 5.0

## MICROPHONE SPECIFICATION

- **Dimension:** 22.6 x 22.6 x 116.8mm
- **Battery capacity:** 350mAh
- **Weight:** 32g



- **Battery voltage:** 3.7V
- **Frequency response:** 50-15kHz
- **Battery charge time:** 2.5-3hrs
- **Sensitivity:** -50 ±3 dB
- **Charge:** 5V 1A
- **Playback time:** ≥5hrs
- **Wireless range:** ≥5m
- **Transmitter signal:** 10mW
- **UHF Bands:** 470-960Mhz(different by country)

## SAFETY GUIDE

Please read the following instructions carefully:

1. Please follow our product installation about operation instructions.
2. Always place the speaker on a smooth and stable surface.
3. Please place the speaker in an open area for the best sound quality. Do not block the surroundings of the speaker.
4. Do not push any objects into speaker vents or slots. Do not apply any great force on the speaker.
5. Please keep the speaker at a room temperature environment. Do not place the speaker near any heat sources (such as radiators, heat registers, stoves, fireplaces, or direct sunlight). Do not place the speaker near any open flame source.
6. Do not attempt to service the speaker by yourself. Always refer to the instructions by qualified service personnel.
7. To avoid the risk of electrical hazards, do not expose this speaker to a wet surface.

## DECLARATION OF CONFORMITY

This device meets the essential requirements of the following Directive 2014/53/EU of the European parliament of the council of 16 April 2014. The waste container symbol with the X through it on the device indicates that the device must be disposed of separately from normal domestic waste at an appropriate waste disposal facility at the end of its useful service life. Please dispose of used batteries properly following local regulations. Do NOT Incinerate. Removal of the rechargeable lithium-ion battery. In this product should be conducted only by a qualified professional. ROHS This product is in compliance with Directive 2011/65/EU of the European Parliament and of the Council of 8 June 2011 on the restriction of the use of certain hazardous substances in electrical and electric equipment.

This device complies with Part 15 of the FCC Rules. Operation is subject to the following two conditions:

1. this device may not cause harmful interference
2. this device must accept any interference received, including interference that may cause undesired operation, changes or modifications not expressly approved by the party responsible for

compliance could void the user's warranty to operate the equipment.

**NOTE:** This equipment has been tested and found to comply with the limits for a Class B digital device, pursuant to Part 15 of the FCC Rules. These limits are designed to provide reasonable protection against harmful interference in a residential installation. This equipment generates uses and can radiate radio frequency energy and, if not installed and used in accordance with the instructions, may cause harmful interference to radio communications. However, there is no guarantee that interference will not occur in a particular installation. If this

equipment does cause harmful interference to radio or television reception, which it can be determined by turning the equipment off and on, the user is encouraged to try to correct the interference by one or more of the following measures:

- Reorient or relocate the receiving antenna.
- Increase the separation between the equipment and receiver.
- Connect the equipment into an outlet on a circuit different from that to which the receiver is connected.
- Consult the dealer or an experienced radio ATV technician for help.

## PRODUCT WARRANTY CARD

Product name		Serial number	
purchasing store		Purchasing date	
Owner name		Contact Email	
owner address			

**Divoom official website:** [www.divoom.com](http://www.divoom.com) / [www.divoom-gz.com](http://www.divoom-gz.com)

**Divoom warranty Information:** <http://www.divoom.com/article/detail/id/60.html>

**Divoom product FAQ:** <http://www.divoom.com/artiele/detail/id/59.Minl>

**Divoom support Email:** [support@divoom.com](mailto:support@divoom.com)

**Divoom support contact number:** 0755-29494509

**Divoom repair & return address:** Shenzhen Divoom Technology Limited Corporation 1st Floor, 5th Building, XinLianHe Industrial Complex Shajing Town, Baoan District Shenzhen City, Guangdong Provinces 518000 The people's republic of China

## WARRANTY INFORMATION

- If you believe your product is defective within the warranty period, please bring the product back to where the product was initially purchased. Alternatively, or within any other questions or concerns, please call customer support at +0755 86290767, or contact us via email at [info@divoom.com](mailto:info@divoom.com).
  - If within 12 (24 if required by local law) months of purchase this device or any part thereof is proven to be defective by reason of faulty workmanship or defects in materials, we will at our option repair or replace the same free of charge of labor or materials on conditions that similar to the product's current condition.
1. The sales invoice or receipt with the date and source of purchase must be presented together with the defective unit. We cannot validate the product warranty information without an invoice.
  2. The warranty does not cover product failures that have been caused by the use of accessories other peripheral devices which are not Divoom branded original accessories intended for use with the product
  3. The warranty does not cover product failures caused by: modification, repair, and disassembly by any person who is not authorized by the manufacturer.
  4. The warranty is nontransferable. Any defective unit or part shall become the property of the manufacturer.
  5. Warranty does not cover any damage caused by misuse, drop, hit, or negligence.
  6. The customer is responsible for the return shipping charges.

Please" disposal of used luttarlas properly following local regulation!. Do NOT Indnarata. Removal of the

rechargeable lithium-ion battery in this product should be conducted only by a qualified professional.

WARRANTY INFORMATION

This product Is covered by a limited warranty from Divoom. For complete warranty details, visit the This product is In compliance with Dlractlva 2011/65/EU of the European Parliament and of the Council of B June 2011 on thE restriction of the use of certain hazardous substances in electrical and electronic equipment.  
**Eurocode information:** Prolinx GmbH Brehmstr.56,40239 Duesseldorf Germany Jie Xue 0049 211 3105 4698 eu@eulinx.eu

FCC Statment

This device complies with part 15 of the FCC Rules. Operation is subject to the following two conditions:

- 1. This device may not cause harmful interference, and
  - 2. this device must accept any interference received, including interference that may cause undesired operation.
- Any changes or modifications not expressly approved by the party responsible for compliance could void the user’s authority to operate the equipment.

**Note:** This equipment has been tested and found to comply with the limits for a Class B digital device, pursuant to part 15 of the FCC Rules. These limits are designed to provide reasonable protection against harmful interference in a residential installation. This equipment generates uses and can radiate radio frequency energy and, if not installed and used in accordance with the instructions, may cause harmful interference to radio communications. However, there is no guarantee that interference will not occur in a particular installation. If this equipment does cause harmful interference to radio or television reception, which can be determined by turning the equipment off and on, the user is encouraged to try to correct the interference by one or more of the following measures:

- Reorient or relocate the receiving antenna.
- Increase the separation between the equipment and receiver.
- Connect the equipment into an outlet on a circuit different from that to which the receiver is connected.
- Consult the dealer or an experienced radio/TV technician for help. This equipment complies with FCC radiation exposure limits set forth for an uncontrolled environment. This equipment should be installed and operated with a minimum distance of 20cm between the radiator &your body.

Documents / Resources

	<a href="#">Shenzhen Divoom Technology DIT00 Ditoo Plus Retro Pixel Art Game Bluetooth Speaker [pdf] User Manual</a> DITOOMIC, A8I-DITOOMIC, A8IDITOOMIC, DIT00 Ditoo Plus Retro Pixel Art Game Bluetooth Speaker, Ditoo Plus Retro Pixel Art Game Bluetooth Speaker
--	---

References

- [D Divoom](#)
- [D Divoom Pixel Art Game Led Bluetooth Speaker & Led Pixel Display](#)