



# Shenzhen Delux Industry M520DB Multi-Mode Wireless Mouse User Manual

[Home](#) » [Shenzhen Delux Industry](#) » Shenzhen Delux Industry M520DB Multi-Mode Wireless Mouse User Manual



## SHENZHEN

Multi-mode wireless mouse



User Manual

Thank you for choosing this wireless office mouse. Please read the user manual carefully when using this product.

## **Contents**

- [1 Contents:](#)
- [2 Button Function:](#)
- [3 Features](#)
- [4 Installation](#)
- [5 Specification](#)
- [6 Receiver Connection](#)
- [7 Debugging Tips](#)
- [8 FCC Caution](#)
- [9 Documents / Resources](#)
- [10 Related Posts](#)

## **Contents:**

- Wireless office mouse X1
- User manual X1
- USB nano receiver X1
- AA battery (Optional) X1
- Removable textile cover (Optional) X1

## **Button Function:**

1. Left click
2. Scroll wheel
3. Right click
4. DPI cycle
5. Forward
6. Backward
7. Indicator light
8. Mode switch
9. ON/OFF switch
10. AA battery
11. USB nano receiver

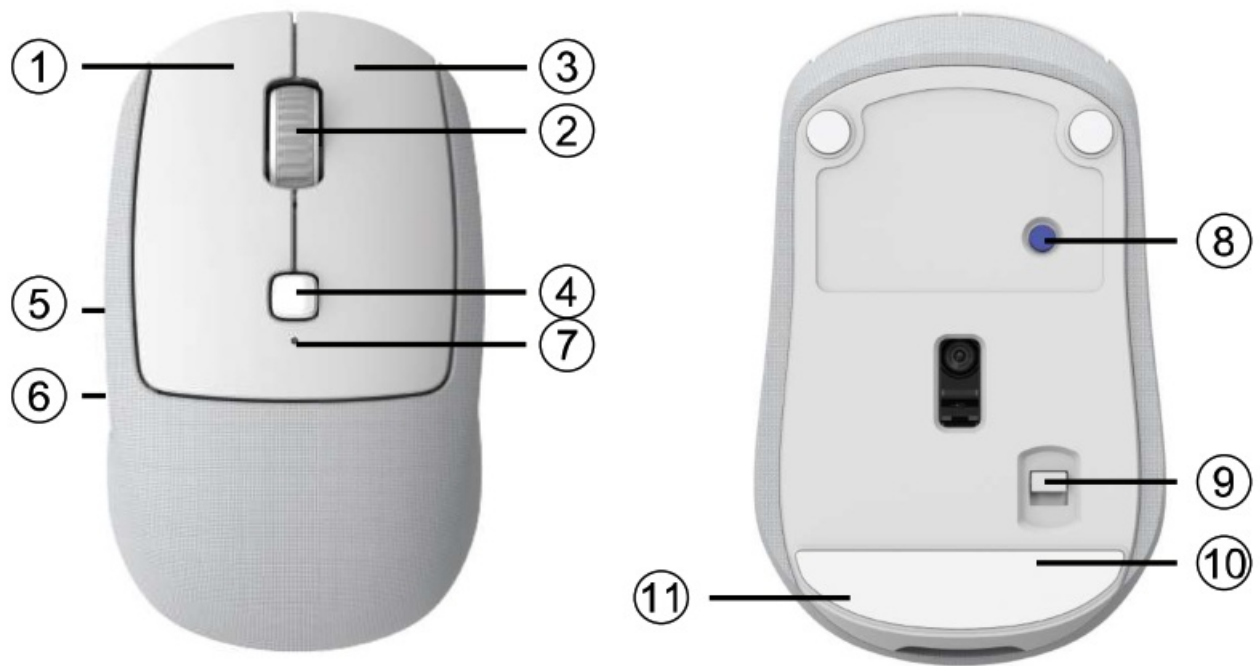

## Features

- Multi-mode connection: 2.4G
- Multiple colors available
- Removable textile cover

## Installation

### 2.4G:

Equip the mouse with battery, switch to the 2.4G mode, and press the left button, middle button, and the right button at the same time for 3 seconds. The blue indicator light will flash rapidly. Then insert the 1.1813 nano receiver into the U813. port and keep the mouse and nano receiver within 10cm. Then the connection will be built automatically.

If you want to switch devices, you can press mode switch again and repeat the above actions, the current device will be disconnected automatically. The indicator light will flash once, twice, and three times respectively when shifting the DPI.

## Specification

DPI	1000/1600(default)/2400
Polling rate	250Hz
Working voltage	1.5V
Working current	≤15mA
Compatible system	Windows 8/10/mac OS

## Receiver Connection

Equipping the mouse with a battery, insert the nano receiver to the USB port of your computer, push the ON button on the bottom of the mouse, and the receiver will detect the device automatically, plug and play.

### ► Rebuilding up the Connection between Mouse and Receiver

If your mouse cannot work normally, you can try to build up the connection again between mouse and receiver, as following steps:

1. Take out the nano receiver from the computer and insert it again, it will detect automatically for about 15 seconds.
2. Keep the mouse in ON mode and with the battery in the correct direction.
3. Keep the effective distance within 10CM between the mouse and receiver.
4. Press the left button, middle button (scroll wheel), and right button at the same time for about 1-3 seconds, then release it The connection is being built for about 10 seconds.
5. If you cannot build up the connection in 10 seconds, please repeat the above steps.

### Debugging Tips

- Check the receiver it is connected to the USB port,
- Check the ON/OFF button if in ON mode.
- Check the effective distance between the mouse and the receiver, and shorten it.
- Rebuild up the connection between the mouse and receiver.

### FCC Caution

This device complies with part 15 of the FCC Rules. Operation is subject to the following two conditions: (1) This device may not cause harmful interference, and (2) this device must accept any interference received, including interference that may cause undesired operation.

Any changes or modifications not expressly approved by the party responsible for compliance could void the user's authority to operate the equipment.

**Note:** This equipment has been tested and found to comply with the limits for a Class B digital device, pursuant to part 15 of the FCC Rules. These limits are designed to provide reasonable protection against harmful interference in a residential installation. This equipment generates uses and can radiate radio frequency energy and, if not installed and used in accordance with the instructions, may cause harmful interference to radio communications. However, there is no guarantee that interference will not occur in a particular installation. If this equipment does cause harmful interference to radio or television reception, which can be determined by turning the equipment off and on, the user is encouraged to try to correct the interference by one or more of the following measures:

- -Reorient or relocate the receiving antenna.
- Increase the separation between the equipment and receiver.
- Connect the equipment into an outlet on a circuit different from that to which the receiver is connected.
- Consult the dealer or an experienced radio/TV technician for help.

The device has been evaluated to meet general RF exposure requirements. The device can be used in portable exposure conditions without restriction.



### Documents / Resources



[Shenzhen Delux Industry M520DB Multi-Mode Wireless Mouse](#) [pdf] User Manual  
M520DB, SGP-M520DB, SGPM520DB, M520DB Multi-Mode Wireless Mouse, M520DB, Multi-Mode Wireless Mouse