



Shenzhen Deftun Technology A3 Smart Door Lock Instruction Manual

[Home](#) » [Shenzhen Deftun Technology](#) » Shenzhen Deftun Technology A3 Smart Door Lock Instruction Manual



SHENZHEN

Deft Technology A3 Smart Door Lock
Instruction Manual

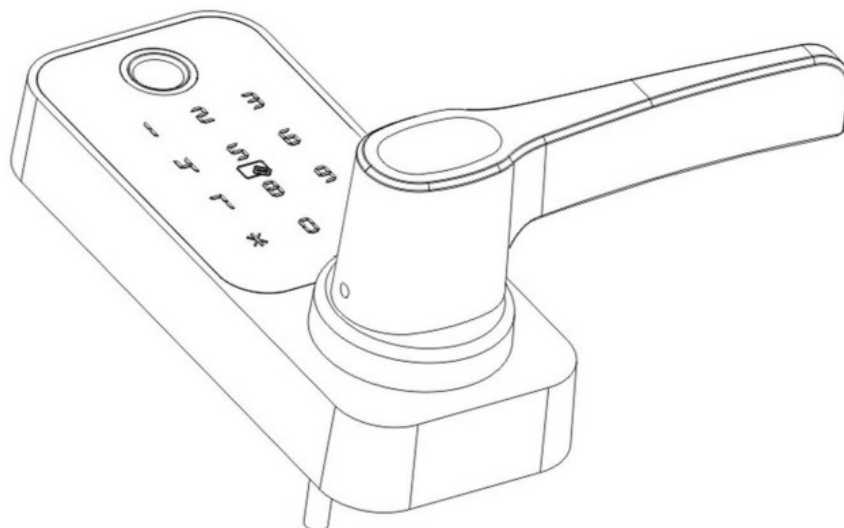

Contents

- [1 Product Introduction](#)
- [2 Features](#)
- [3 Packing List](#)
- [4 Operation instructions](#)
- [5 FCC Statement](#)
- [6 Documents / Resources](#)
- [7 Related Posts](#)

Product Introduction

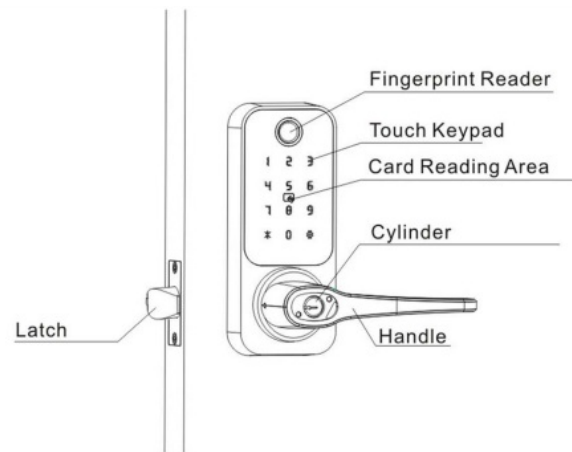

A32B

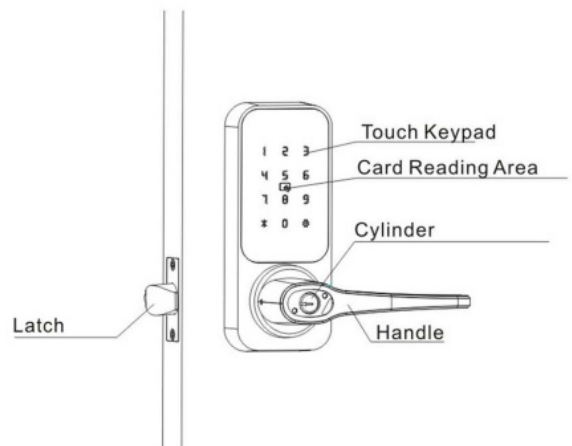

A31B

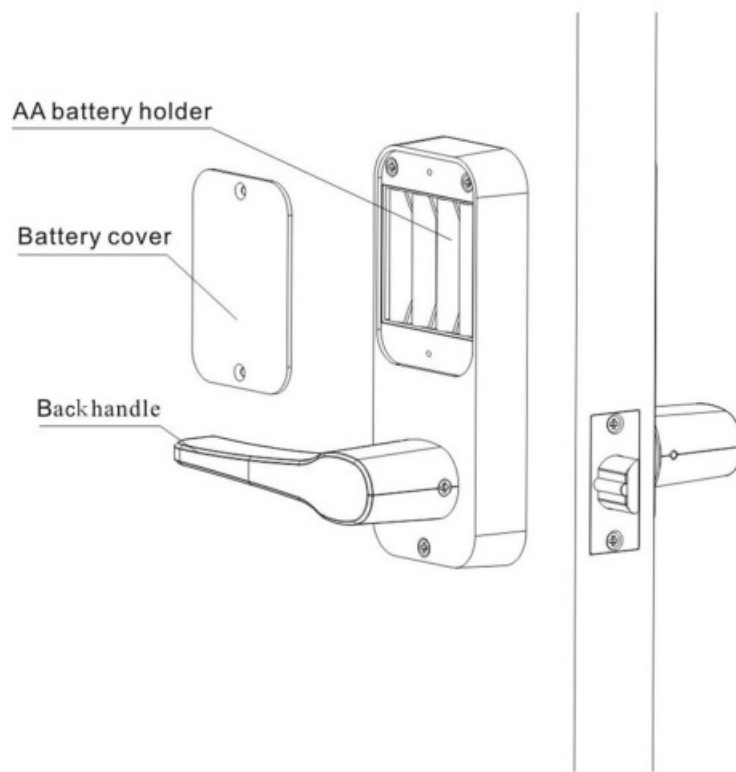

Back Panel

Notes:(1) Some models may have differences in configuration and the appearances are slightly different. (2) The picture is for reference only. Please consult the manufacturer for more details.

1, Packing list

| | | | |
|--------------|---|--------------------|---|
| Front Panel | 1 | Back Panel | 1 |
| Front Handle | 1 | Back Handle | 1 |
| Metal Key | 2 | RFID Card | 2 |
| Single Bolt | 1 | Casing Pipe | 1 |
| User Manual | 1 | Trepanning Drawing | 1 |
| Logo | 1 | Kits | 1 |

Kits list

| | | | | | | |
|-------|---------|---|-----------------|---|-------------------|---|
| | M4x8mm | 8 | Spring | 1 | Side buckle plate | 1 |
| Screw | M4x24mm | 4 | Spindle | 1 | | |
| | | | | | | |
| | M4x30mm | 3 | Casing pipe | 3 | | |
| | M4x40mm | 3 | Side buckle box | 1 | | |

Features

1. APP: by 'Tiny Lode. download It free from "App Store" or 'Gavle Play
2. Fit home and office interior doors. Nol is suitable for outdoor use (not waterproof).
3. Door lock thickness: 1.38' – 2.17' (35- 55 mm). If the door size succeeds or fails to reach this scope. It will cause the square shaft to be too sheet or too long. leading to failure in locking the door.
4. Reversible Lever: fit tell-handed and right-handed doors
5. Code 1 admen and 100 guests max.
6. RFID Card: I admin and 100guests max.
7. Fingerprint. 1 admin and 100 guests max.
8. MeastitnerMieasternoatkincightheAlmorninum alloy Panel. Tempered glass- Power Supply. 4. AA
9. Battery: 4 X AA ballades(not inbox, please purchase It separately) The AA batteries last around 10- 12 months.
10. Low Battery Alarm The groan light flashes 8 times, and this buzzer gives 5 short beeps.
11. The glean light turns off after two flashes, and the buzzer does not sound. In case of consecutively len wrong entries. such entry will be locked for one minute. during which no entry is allowed.

Packing List



Front Panel



Back Panel



Front Seal Plate



Back Handle



Front Handle



Single Bolt
60/70mm



Spindle
8x8x70mm



Side Buckle Plate



Mechanical
Key-2pcs

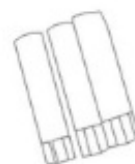

Casing Pipe



1:1

4x24mm self-tapping screw-4pcs



1:1

M4x30mm countersunk screw-3pcs



1:1

M4x8mm countersunk screw-8pcs



Handle Cover



Side Buckle Box



User Manual



Trepanning Drawing



RFID Card-2pcs

Direction Instruction for installing left-hand or right-hand door

The right-handed door direction determines the installation direction of the latch bolt and handle

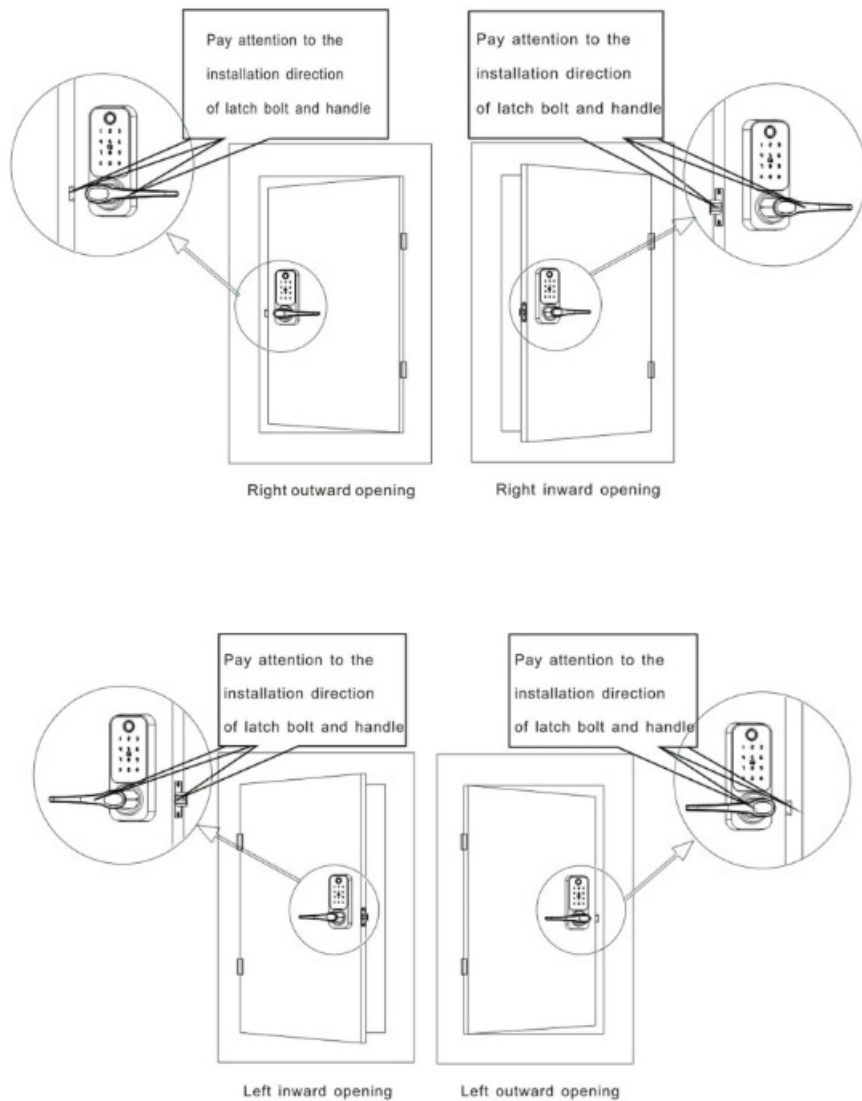

The left-handed door direction determines the installation direction of the latch bolt and handle

Operation instructions

Fingerprint unlocking

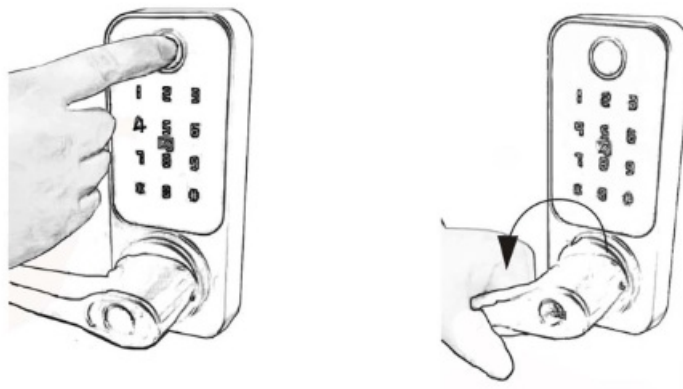

1. Press the fingerprint to unlock the door
2. Press down the handle to unlock the door

Password unlocking

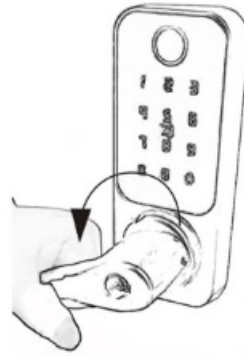

1. Enter the password to unlock the door
2. Press down the handle to unlock the door

Metal Key unlocking

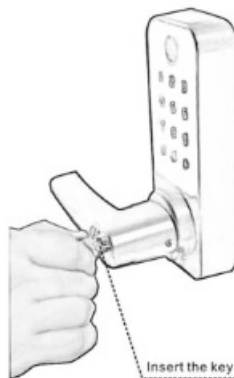

Insert the key (Turn the key by 90 degrees)

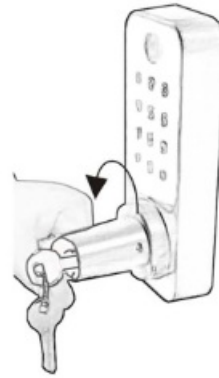

1. Insert the key (Turn the key by 90°)
2. Press down the handle to unlock the door

Card unlocking

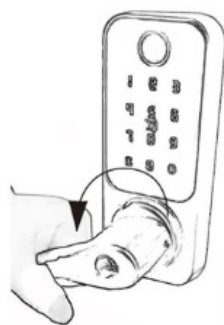

1. Swipe Card to unlock
2. Press down the handle to unlock the door

Instructions for inserting or replacing batteries at the rear pane

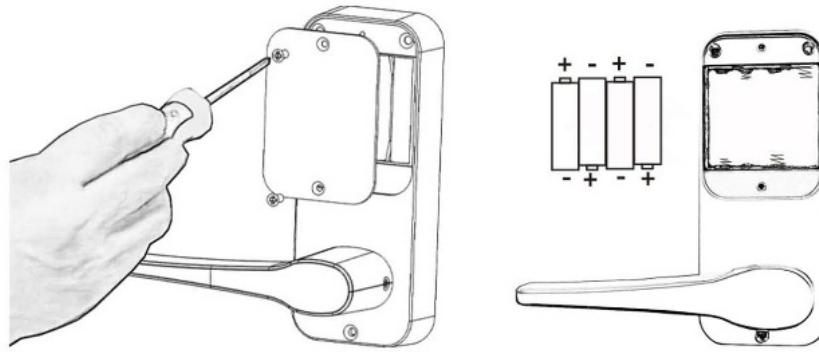

1. Pay attention to “+” end when you bend. The end with spring is negative (-), while the other end is positive, (+).
2. After all the 4 batteries are loaded, put on the battery cover, and then tighten the screw.

FCC Statement

This equipment has been tested and found to comply with the limits for a Class B digital device, pursuant to part 15 of the FCC Rules. These limits are designed to provide reasonable protection against harmful interference in a residential installation. This equipment generates, uses, and can radiate radio frequency energy and, if not installed and used in accordance with the instructions, may cause harmful interference to radio communications. However, there is no guarantee that interference will not occur in a particular installation. If this equipment does cause harmful interference to radio or television reception, which can be determined by turning the equipment off and on, the user is encouraged to try to correct the interference by one or more of the following measures:

- Reorient or relocate the receiving antenna.
- Increase the separation between the equipment and receiver.
- Connect the equipment into an outlet on a circuit different from that to which the receiver is connected.
- Consult the dealer or an experienced radio/TV technician for help.

Caution: Any changes or modifications to this device not explicitly approved by the manufacturer could void your authority to operate this equipment. This device complies with part 15 of the FCC Rules.

Operation is subject to the following two conditions: (1) This device may not cause harmful interference, and (2) this device must accept any interference received, including interference that may cause undesired operation.

RF Exposure Information The device has been evaluated to meet general RF exposure requirements. The device can be used in portable exposure conditions without restriction.

Installation Notes of the front panel

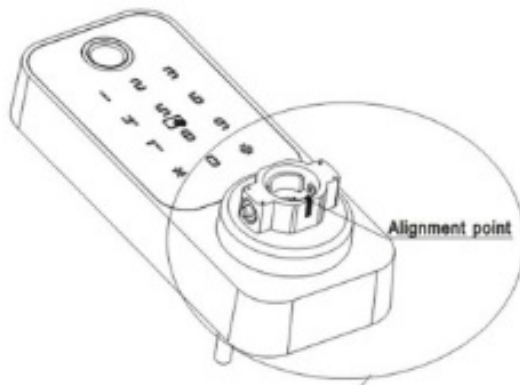

Step 1: Align at the alignment point

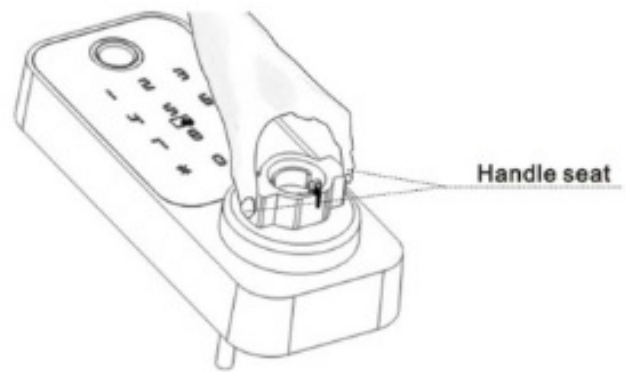

Step 2: Pinch the pins at both ends

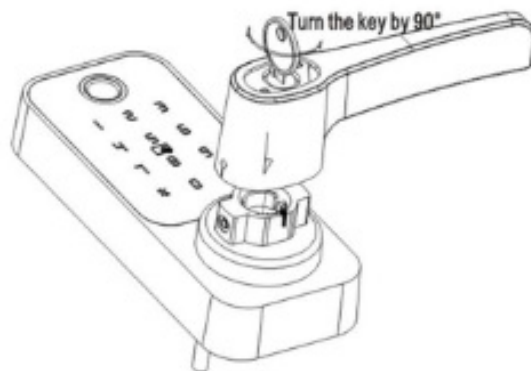
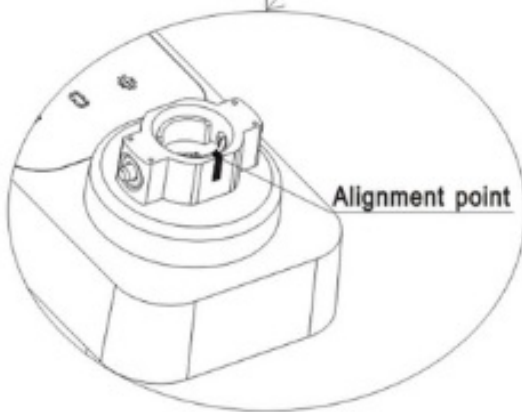

Step 3: Turn the key by 90 degrees



Step 4: Put on the handle seat

Assembly of the Lock Handle on the back panel

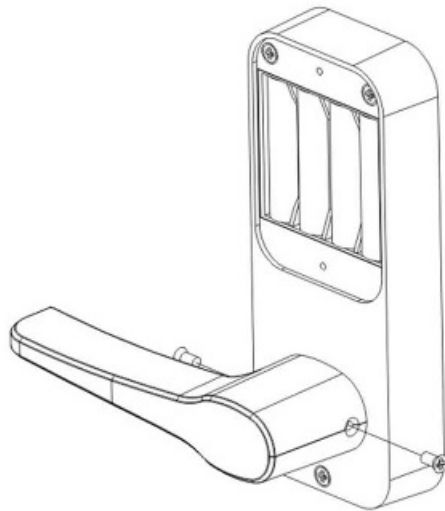

1:1

M4x8mm 2pcs

Step 2: Assembly of the Lock Handle on the Rear Panel 1. Mount the rear lock handle according to the door-opening direction. Firstly, put the rear lock handle in the rear handle seat, and then fix it with M4 screws on both sides.

Steps of replacing and installing the left internal lock and out-opening lock

Stop 1. Remove the old back-locking module and the original little lock.

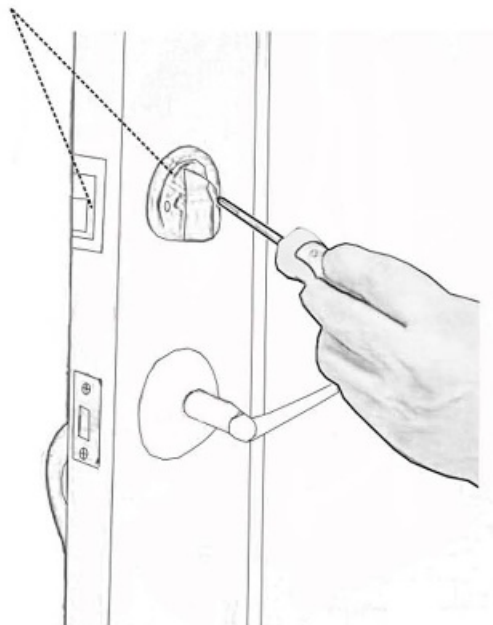

Step 1 Attach the Trepanning Drawn

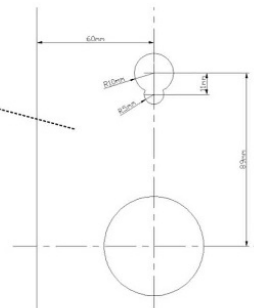
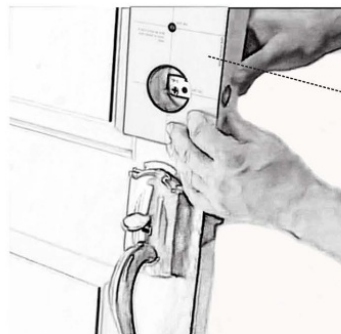

Trepanning Drawin

Step 3: Drill a hole.

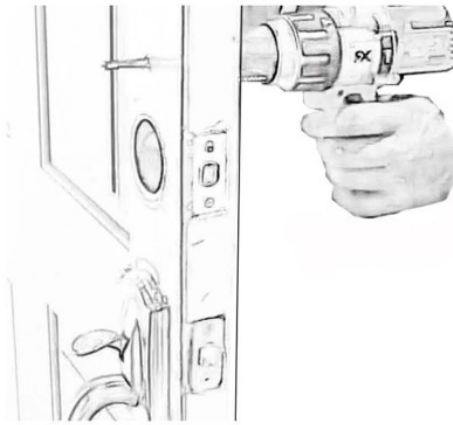

Step 4: Install the lock.

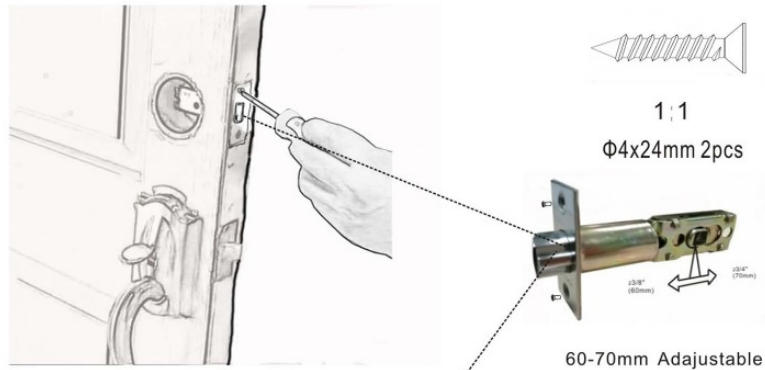

Notes: Please refer to the direction of the latch bolt of the original little lock when install the lock.

Step S. Mount the front panel on the door. Screw down the two thread sleeves. Aim the front panel assembly at the door opening, press it close to the door, and then thread it.

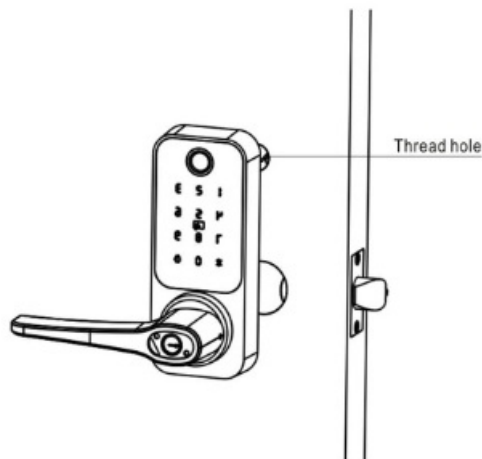

Step 6. Installation of the front Seal Plate. Thread the front seal plate, aim it at the screw hole and then fix it with three M4 countersunk screws.

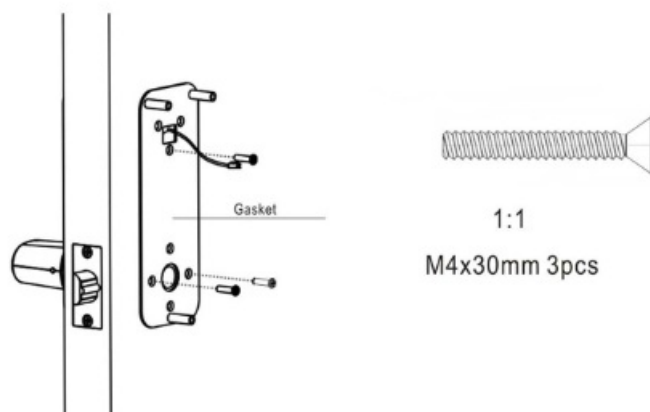

Step 7. Installation of back Panel

Assembly Coined the back panel assembly with the Ice plug to panel assembly. Corneal elective third in the rear panel (Note. Do not block the screw hole), and then ha it with three 144 countersunk screws. Audry batteries to test it.

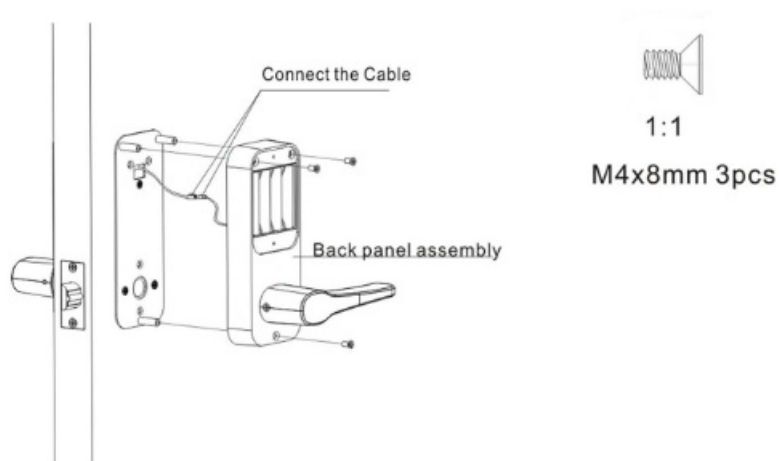

Stop 8; Insert the batteries

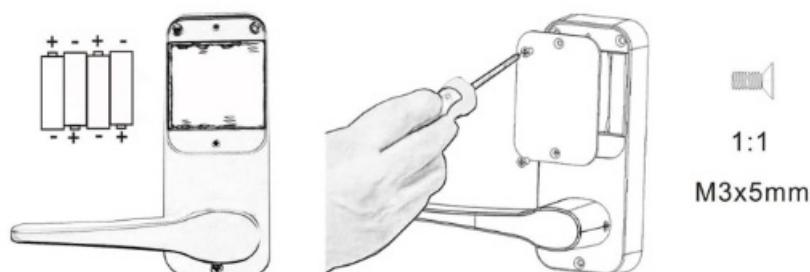

1. Pay attention to (+) and (-) when Mewl the batteries The and with spring is negative (-). white the other and is positive (-)
2. After all the 4 batteries are inserted. put on the battery Cover. end then tighten the screw.

Access door functions management

Change the managed code'

Note, Original Management Coda: 123456

For security. please ensure to change the default management code before use

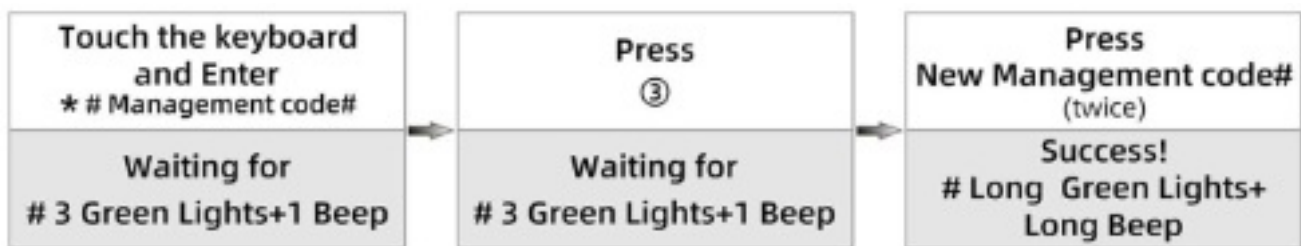

Add user codes *



Delete use codes*

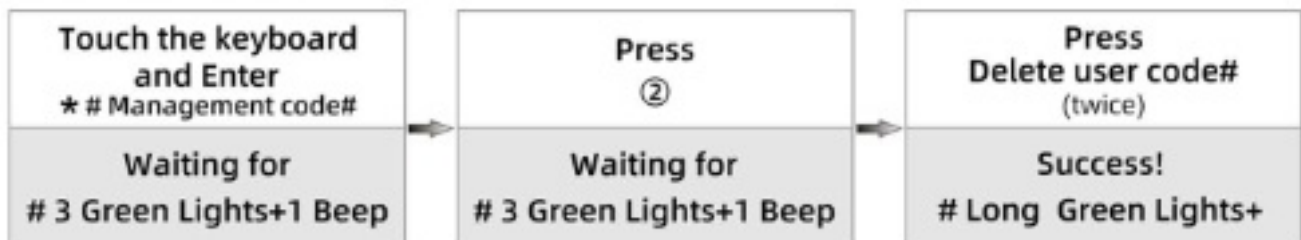

Delete all user codes*



Add user cards*

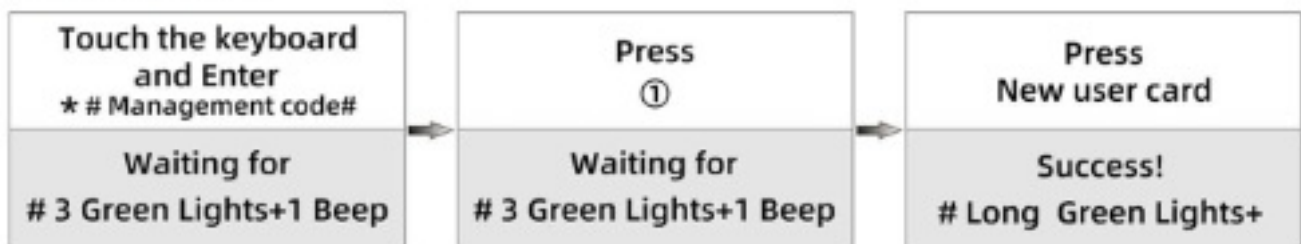

Delete a user card*

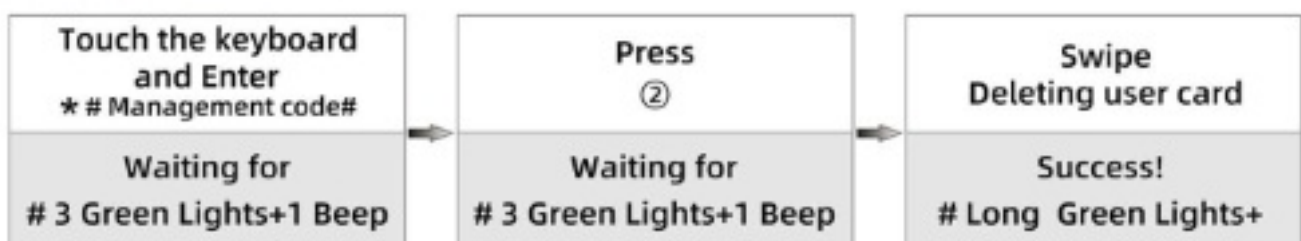

Delete all user cards*



Add user fingerprints* (A32B)



Delete a user fingerprint* (A32B)



Delete all user fingerprints* (A32B)



Delete all codes & cards & fingerprints*



APP Configuration

1. **Sign Up:** Turn on the Bluetooth switch to enter the app's 'T, Locke Interface. Then register an account with your e-mail account, like what is shown below.

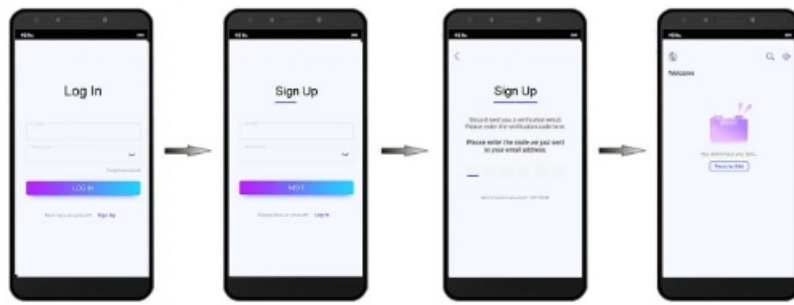

2. **Add Account:** Click 'Door Lock'. and then touch the lock panel to activate the lock. The device name is 'lock-AA. in blue font. Click the device name to connect it. Set admin code(13- 10 digits), like what is shown below.

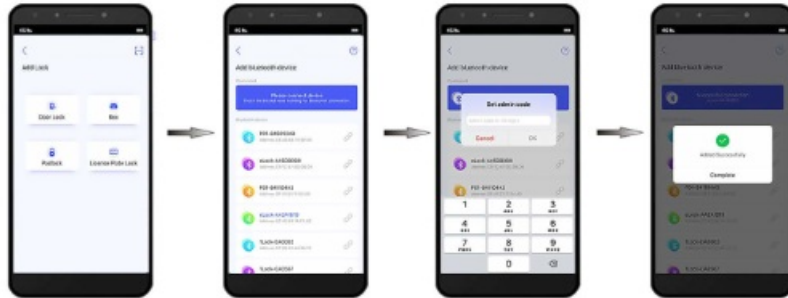

3. **Add Code:** Click 'Codes' On the home page of APP. to set Code (6.10 digits). As the code is visible In APP. please keep it, progeny. like what Is shown below.

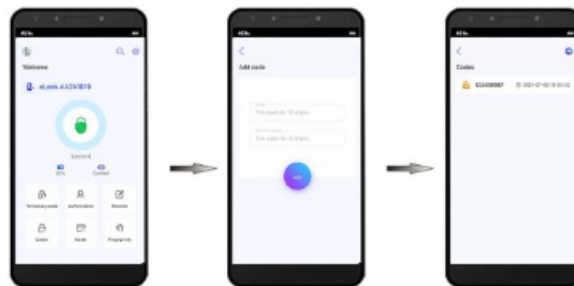

4. **Add RFID Card** Click 'Cards' on the home page of APP. and then get RFID Card close to the induction zone of the lock to have it successfully added, like what is shown below



5. **Add Fingerprint** (Only for A32B) Click 'Fingerprints' on the home page of the APP, and then press the rings: agent three times continuously in the fingerprint zone of the lock to have the fingerprint successfully added. like what is shown below

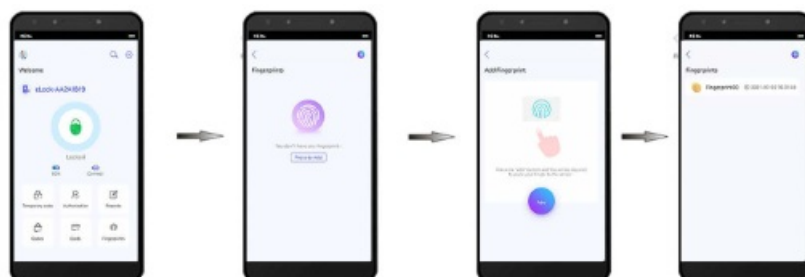

6. **Add Temporary Code** Click 'Temporary Code' on the home page of the APP. Once Code: Click "Generate" to generate a one-time code. Limited Code: Set a starting time. and I then click "Generate" to generate a valid

temporary code

7. **Authorization Click** 'Authorization' in the APP interface if you want to authorize other accounts to manage the device. Based on your authorization demand, you can choose a long-term authorization or the authorization of a valid period to manage the lock.
8. **Record Click** 'Record' On the home page of APP, and then you can see all the unlocking records.
9. One APP can manage many locks.
Enable the APP, and click the upper left corner of the page (account avatar)
Click 'My Locks'.
Click '4' at the upper right corner of Wade devices.

Reset Instructions

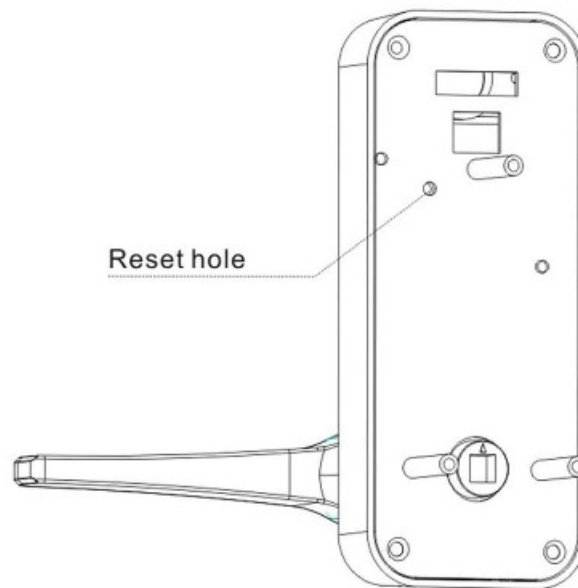

Please refer Press the reset key for three seconds, and then the screen flashes three times. As to the Instruction for details, ' See P9) the blazer gives a long whistle, the lock will be restored to the factory state.

Q&A:

1. Are you able to open the door without inputting the password after Installation?

A: 1.1 Troubleshooting 1: The positioning chreChon of the clutch is not aligned.

2. troubleshooting 2: Take out the battery, and then load the battery again after 4 to S seconds.

3. Are you not able to open the door by Inputting the password after Installation?

A: Check whether spring is put before installing the rear panel or whether the length of the square shaft is long enough.

4. Can I connect two locks of the same model to the same APP?

A. Yes, you can see the details on page 19.

5. Can it be used for outdoor purposes?

A: It is advised to be used indoors, since el is daily waterproof.

6. What will happen If It runs out of battery?

A: In case of low battery, the door will give a low-battery warning. At this time, the door can Moll be unlocked dozens of times, so please replace the battery before the lock is completely power-off, or unlock the door by

using a mechanical key. In addition, you are advised not to put all mechanical keys at home. You can keep them separate. so as to avoid the occurrence of failure indoor unlocking.

7. The lock has been installed by following all steps. but the door cannot be locked, why?

A: Plena check whether the red line positron at the front panel handle Is aligned?

Documents / Resources

| | |
|---|--|
|  | Shenzhen Deftun Technology A3 Smart Door Lock [pdf] Instruction Manual A3, 2A4YX-A3, 2A4YXA3, A3 Smart Door Lock, Smart Door Lock |
|---|--|

[Manuals+](#).