



Shenzhen C D RF485B Remote Control Transmitter Instruction Manual

[Home](#) » [Shenzhen C D](#) » Shenzhen C D RF485B Remote Control Transmitter Instruction Manual 

Shenzhen C D RF485B Remote Control Transmitter



Contents

- [1 General Information](#)
- [2 Process Description](#)
- [3 Electrical parameter](#)
- [4 Operating instruction](#)
- [5 Warning](#)
- [6 Documents / Resources](#)
- [7 Related Posts](#)

General Information

ATransmitter	Customer no.	TBD
	Model NO	RF485B
	Frequency	433.92MHz±50kHz
	Number of buttons	5key
	Colour upper part	Black
	Colour lower part	Black
	painting	N
	Backlight	No
	Logo	Yes
	Certification	FCC/ID
	Software version	TBD
	Testing instruction PCBA	TBD
	Size	116*42*14mm

	Label product	35*5mm
	Label white box	No
	Manual/Issue date	No
	Magnet or Metal plate	No
	Key press force	160g±20g

Process Description



NO.	A1	A2	A3	A4
Component	Keypad	Top cover	Bottom cover	Battery cover
Material	ABS	ABS	ABS	ABS
Process	Injection	Injection	Injection	Injection
Surface effect	Matte+Silk screen	Matte+Silk screen	Matte	Matte
Color	Injection: Pantone Black C Silk screen: Pantone 383C Pantone Red 032C Pantone Red 803C Pantone Red 0821C 	Injection: Pantone Black Silk screen: Pantone 4X3C	Injection: Pantone Black C	Injection: Pantone Black C

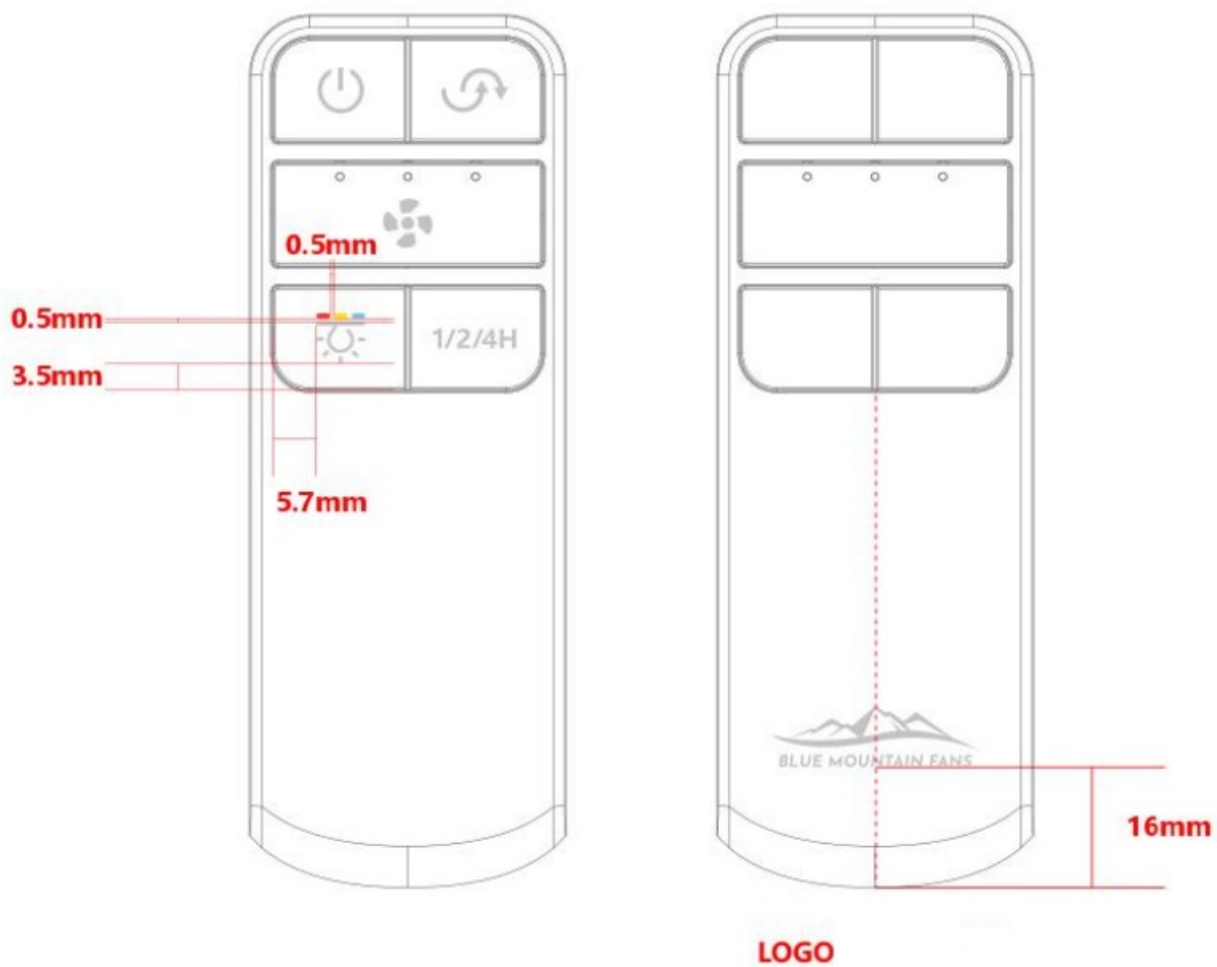

SHENZHEN C AND D ELECTRONICS CO.,LTD

Client model No		Version No.	
C and D Model No.	RF485A	Scale	1:1
Design by.		Date	2022.04.27

Electrical parameter

SN	Test Item	Requirement
----	-----------	-------------

3.1	Control Distance(RF)	$\geq 10\text{m}$ for Key operation $\geq 10\text{m}$ for Voice Control
3.2	Operation Power Supply Range	DC 3.0V ~ 3.3V
3.3	Current Consumption in Power models	w 40uA (typical) @ Connected Idle (TV Session) w 7mA (typical) @ Voice Operation
3.4	Current Consumption in Sleep Standby with host off	$\leq 5\mu\text{A}$
3.5	IR Operating Distance: Transmission Level	Follow Amazon's Spec.:
		1. $\geq 35\mu\text{W}/\text{cm}^3$ OR $>10\text{m}$ 3. $\geq 15\mu\text{W}/\text{cm}^3$ OR $>3.0\text{m}$
		3. $\geq 15\mu\text{W}/\text{cm}^3$ $>3.0\text{m}$
3.6	Contact Resistance	$\leq 3\text{K}\Omega$ (between Input and Output ports of MCU.)
3.7	Battery type / Battery Lifetime	3 AAA alkaline (replaceable) / More than 13months
3.8	Calibrated Tx Power from SOC Conducted Tx power Radiated Tx power	4,143dBm
3.9	Initial Frequency error tolerance (f_0)	$-75\text{KHz} \leq f_0 \leq 75\text{KHz}$
3.10	Conducted RX Sensitivity / Radiated RX sensitivity	$\leq -90\text{dBm}$ @BER=0.1%
3.12	Voice Sensitivity@1KHz	$\geq -30\text{dB}$
3.13	Voice S/N@1KHz	$\geq -30\text{dB}$
3.14	HD@1kHz	
		$\leq 5\%$

3.16	Device control	Yes
3.17	RGB Tricolor LED	Yes (one)
3.18	DC-DC Booster	Yes
3.19	Voice	Single Analog Mic + Nearfield (push to talk)
3.20	Certification	CE, BT sig, FCA, WPS, CA Prop 65 (WW certification is needed)

Operating instruction

The master switch of transmitter realizes fan and light control (Mark 1) :

- the factory default state for fan status. When the lights are turned on again, the brightness and color temperature are the state before the lights are turned off.
- boot 30 seconds, long press this button for 3 seconds, to complete the remote control code. When the code is successfully matched, the light flashes. Before the code is matched, the light is on: light off for 1second->light on for 1 second -> light off; Before code alignment, light off state: light on for 1 second, light off.
- in fan respectively in high/medium/low, light work mode. Press key once. Within 30 seconds, the fan stops running and shuts down. How to press the key twice in succession, the fan should run in high speed gear with in 30 seconds while the light shines.
- the fan at the stop, light work mode. Press key once. Within 30 seconds, the fan stops running and shuts down. Press the button twice in a row, the fan needs to run in high speed within 30 seconds, and the light will glow.
- in fan stops, the lights work mode. At this time, press the key once. With in 30 seconds, the fan should be running at the high level and the lamp should glow white. Press the key twice. With in 30 seconds, the fan stops running and the lamp must be turned off.
- in fan respectively in high/medium/low-grade, working mode, the lights went out at this point according tot he national health 1, 30 seconds, fan stop running and lights. Press the key 3 times continuously, the fan runs in high speed, and the light shines.

Note: The color temperature may change if the light switch is too fast.

Fan Gear Control (Mark 3)

- is divided into high, medium and low third gear, could wind speed buttons on the transmitter. After receiving the transmitting signal, the receiver controls the output of the AC motor to realize the fan speed of different gears.
- each file conversion time in less than 6 S.
- ask fan speed in the range of 10% of the set speed. Speed can overshoot.
- hold can be directly to the keys can directly control the fan fan gear, and don't need to push the fan switch must

first.

(Speed/current/power matrix table)

Fan level	slow	medium	High
Rotate speed RPM	39	95	160
Drive current (A)	0.17	0.33	0.53
Power	6.6	33.7	63.4

Lighting Control (Mark 3)

- only under the conditions of open LED lamp, can adjust the brightness.
- from the dark to the light or the brightest to the dark, need long keys 7 seconds.
- long key defines the longest (the remote control can be 10 seconds), brightness will change,
- control law:
- Gradually change light -> Brightest -> Gradually change dark -> darkest -> Gradually change light->... During the gradient process, press the main switch for 10 seconds and no longer adjust the brightness.
- can also many times short key, brightness will gradually change according to the rule.
- power 3.6 W when minimum brightness, high power 30 W + A1 brightness. (Power of the board when the fan is not turned on) The minimum brightness power is 3.0W, and the maximum brightness power is 33.1W.
- the factory default brightness is the brightest (power 31.1 W).

Color temperature adjustment (Mark 4)

- six color temperature, color temperature adjustment by the launch button.
- only open the LED lights, that can adjust the color temperature.
- each press buttons, color temperature will change again.

Warning

This device complies with part 15 of the FCC Rules. Operation is subject to the following two conditions: (1) This device may not cause harmful interference, and (3) this device must accept any interference received, including interference that may cause undesired operation. NOTE 1: This equipment has been tested and found to comply with the limits for a Class B digital device, pursuant to part 15 of the FCC Rules. These limits are designed to provide reasonable protection against harmful interference in a residential installation. This equipment generates, uses and can radiate radio frequency energy and, if not installed and used in accordance with the instructions, may cause harmful interference to radio communications. However, there is no guarantee that interference will not occur in a particular installation. If this equipment does cause harmful interference to radio or television reception, which can be determined by turning the equipment off and on, the user is encouraged to try to correct the interference by one or more of the following measures:

- Reorient or relocate the receiving antenna.
- Increase the separation between the equipment and receiver.
- Connect the equipment into an outlet on a circuit different from that to which the receiver is connected.
- Consult the dealer or an experienced radio/TV technician for help.

NOTE 3: Any changes or modifications not expressly approved by the party responsible for compliance could void the user’s authority to operate the equipment.

Documents / Resources

Model No.

RF485B

1. General Information

Model No.	RF485B
Manufacturer	Shenzhen C D
Product Name	RF485B Remote Control Transmitter
Product Type	Remote Control Transmitter
Product Code	RF485B
Product Description	RF485B Remote Control Transmitter
Product Features	RF485B Remote Control Transmitter
Product Specifications	RF485B Remote Control Transmitter
Product Dimensions	RF485B Remote Control Transmitter
Product Weight	RF485B Remote Control Transmitter
Product Material	RF485B Remote Control Transmitter
Product Color	RF485B Remote Control Transmitter
Product Usage	RF485B Remote Control Transmitter
Product Warranty	RF485B Remote Control Transmitter
Product Price	RF485B Remote Control Transmitter
Product Availability	RF485B Remote Control Transmitter
Product Status	RF485B Remote Control Transmitter
Product Version	RF485B Remote Control Transmitter
Product Release Date	RF485B Remote Control Transmitter
Product End Date	RF485B Remote Control Transmitter
Product Support	RF485B Remote Control Transmitter
Product Contact	RF485B Remote Control Transmitter
Product Feedback	RF485B Remote Control Transmitter
Product Comments	RF485B Remote Control Transmitter

[Shenzhen C D RF485B Remote Control Transmitter](#) [pdf] Instruction Manual

2A9T3-RF485B, 2A9T3RF485B, RF485B, RF485B Remote Control Transmitter, Remote Contr ol Transmitter, Transmitter