



Shenzhen Bason Electronics Technology E824B LED Bluetooth Controller Instruction Manual

[Home](#) » [Shenzhen Bason Electronics Technology](#) » Shenzhen Bason Electronics Technology E824B LED Bluetooth Controller Instruction Manual 



SHENZHEN



Instruction Manual

Contents

- 1 Instructions
 - 1.1 APP installation instructions:
- 2 FCC Statement
- 3 Disclaimer
 - 3.1 Installation Description
- 4 Disposal
- 5 Service
- 6 Tips for music function
- 7 Solution:
- 8 Installation diagram:
- 9 Feature
- 10 Documents / Resources
- 11 Related Posts

Instructions

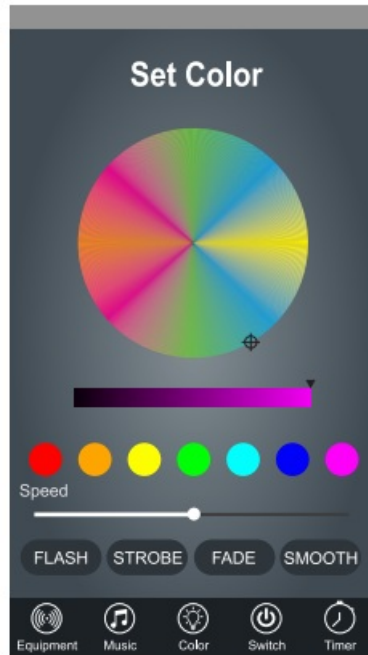

APP installation instructions:



Search "HomePlus Light" in APP Store or Google Play Store.

4



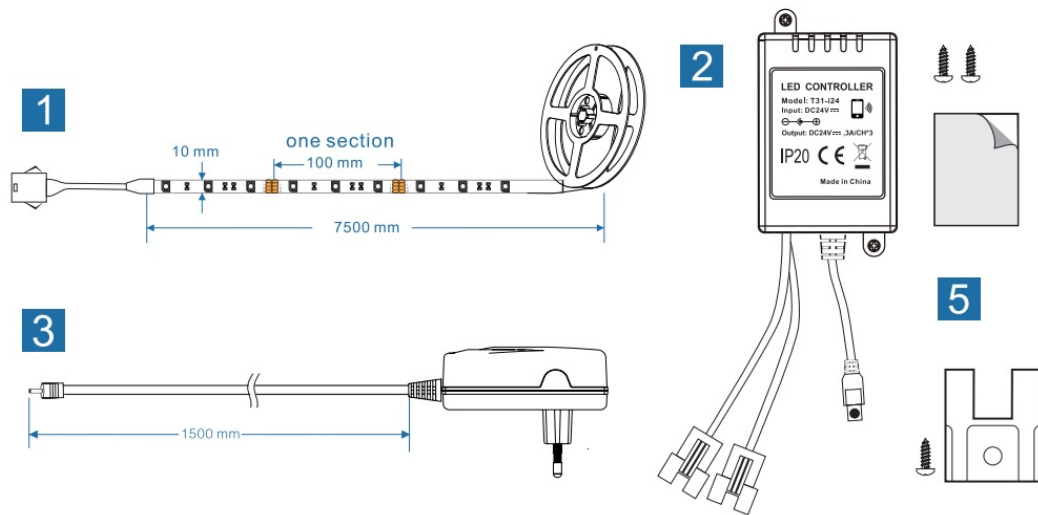

1. 7.5M LED Strip x
2. controller (Screw x 2 + Adhesive tap x 1)
3. 24V 2A Power Supply
4. Remote control x 1 (Cr2025 battery inserted)
5. Fixed Buckle x 10 Screw x 10



: Increase light intensity in 8 steps



: Reduce light intensity in 8 steps



: DIY color adjustment

: After selecting DIY, adjust the color and save it automatically



select per-mixed colors



: 3colors flash



: 7colors flash



: 3colors fade

: 7colors fade



: All-flash mode loops



: White light flashes



: 12 level speed increase



: 12 level speed reduction

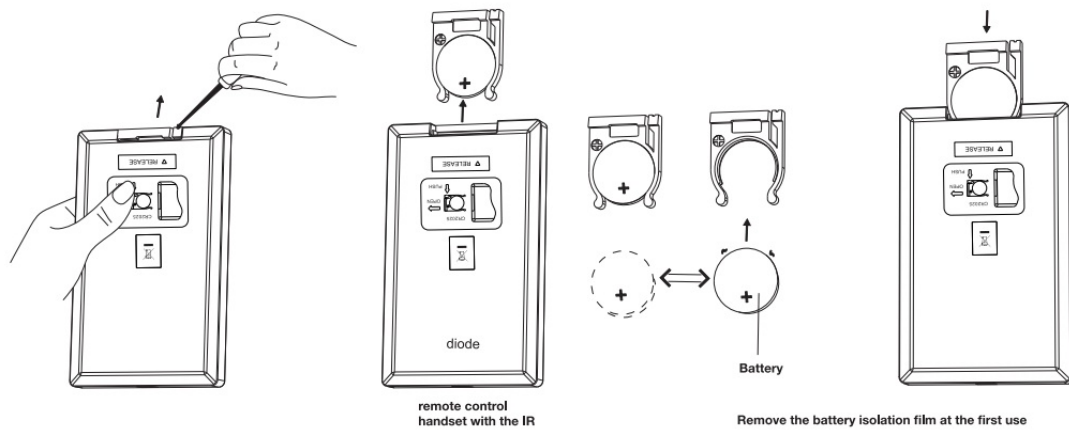

FCC Statement

changes or modifications not expressly approved by the party responsible for compliance could void the user's authority to operate the equipment. This device complies with Part 15 of the FCC Rules. Operation is subject to the following two conditions: (1) this device may not cause harmful interference, and (2) this device must accept any interference received, including interference that may cause undesired operation. This equipment has been tested and found to comply with the limits for a Class B digital device, pursuant to Part 15 of the FCC Rules. These limits are designed to provide reasonable protection against harmful interference in a residential installation. This equipment generates, uses, and can radiate radio frequency energy and, if not installed and used in accordance with the instructions, may cause harmful interference to radio communications. However, there is no guarantee that interference will not occur in a particular installation. If this equipment does cause harmful interference to radio or television reception, which can be determined by turning the equipment off and on, the user is encouraged to try to correct the interference by one or more of the following measures:

- Reorient or relocate the receiving antenna.
- Increase the separation between the equipment and receiver.
- Connect the equipment into an outlet on a circuit different from that to which the receiver is connected.
- Consult the dealer or an experienced radio/TV technician for help.

This equipment complies with FCC radiation exposure limits set forth for an uncontrolled environment. This equipment should be installed and operated with a minimum distance of 20cm between the radiator and your body.

Please use the buckles provided to ensure a much stronger fixing, especially when attaching to a wall. (Although it is not always necessary, this is our recommendation)

Peel the blue paper from the strip, install the strip and fix it with a snap after 10 minutes.

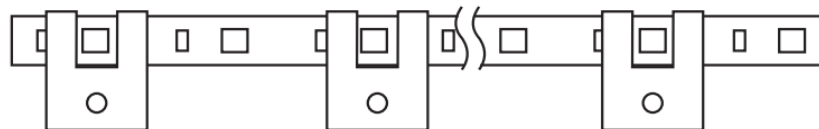

Disclaimer

Attention: Please read the installation and warning carefully, and make sure you use the product properly and safely.

1. Please keep the product away from flammable, explosive gases, liquid, and solid material.
2. Ensure that the wire is connected correctly and properly to avoid short-circuit damage and fire hazard.
3. Before using this product, please check the DC power and voltage meet the product's technical requirements.

4. Please don't plug the adaptor into the socket before you connect the whole set together.
5. Please ensure the controller is not be covered when installing.
6. If any problems don't make unauthorized repairs, Any doubts please contact us.
7. Do not use the rope light when covered or recessed into a surface
8. The light source of this luminaire is not replaceable; when the light source reaches its end the whole luminaire shall be replaced.

The warranty of this product is two years, in this period we guarantee repairing or replacement service with no charge if it is normally used according to the instruction.

if the customer does not follow the instructions and following provisions in this manual, which results in product damage, the supplier is not responsible for any problems arising, even in the warranty period, maintenance costs borne by the customer.

1. Damage caused by misuse, such as not being in accordance with the instructions.
2. Damages caused by unauthorized removal, repair, modification of the circuit; incorrect connection, and replacement of the chips.
3. Damage caused by transportation, shock, falling after purchase.
4. Damage caused by earthquake, fire, flood, lightning, and abnormal voltage.
5. Damage caused by negligence or improper maintenance, such as storage at high temperature and humid environment, vicinity of hazardous chemical substances

Installation Description

- There are two options to install the strip light, please choose the one you prefer.
- LED lights can be stuck with adhesive tape (on the back of strips). Please do not install it with mechanical stresses, which may damage the lights.
- carefully clean the area where to install the lights, make sure no dust, dirt, or grease. otherwise, the strip will fall off.

Disposal



The packaging material is recyclable. Dispose of the packaging in an environmentally-friendly manner and make it available to the collection service for recyclable materials.



Dispose of the product in an environmentally friendly manner. The product does not belong in the household garbage. Dispose of it at a recycling center for old electric and electronic equipment. For more information, please contact the administration in your community.

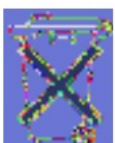

Batteries and rechargeable batteries must be removed and disposed of separately before disposing of the product. To protect the environment, batteries and rechargeable batteries may not be disposed of together with normal household waste. Instead, they must be turned in at appropriate collection points. Please also observe applicable statutory provisions regulating the disposal of batteries.



Service

Procedure If you have any problem or get a defective product, we will reply within 24 hours. Email: poppy-service@outlook.com

You can:

1. Return it back without any reason within 30 days after receipt of goods.
2. Get a refund or replacement without shipping rate within 30 days.
3. Get free replacement parts (need to cover shipping rate) within 365 days.

Tips for music function

Q: Why does APP music function can't play music?(as shown)

A: no downloaded music in phone storage or SD card.

Solution:

10S: Download music from your computer's iTunes to your phone storage.

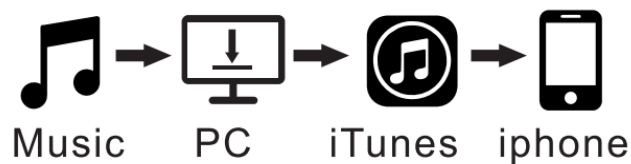

Android: Download music to phone storage.



Installation diagram:

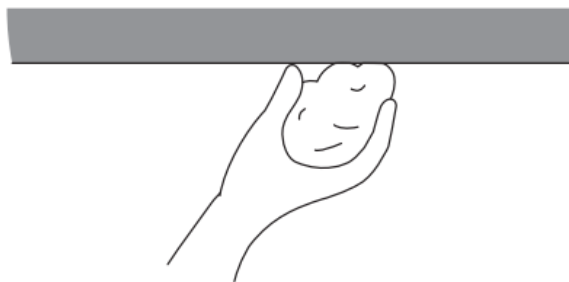

1. Clean the installation site, keep it clean and dry

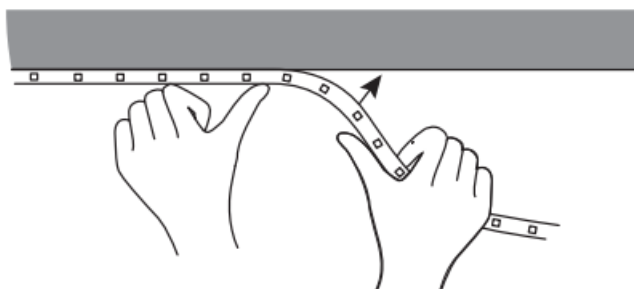

2. After tearing off the adhesive, stick the strip light to the cleaned position and gently press it down.

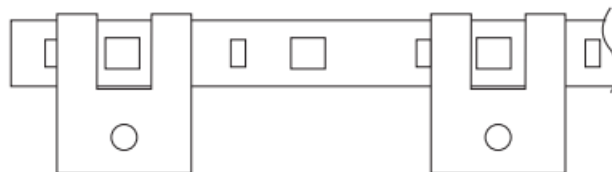

3. Use the buckle to fix the light belt again to prevent it from falling off (the wooden surface can be fixed with screws)

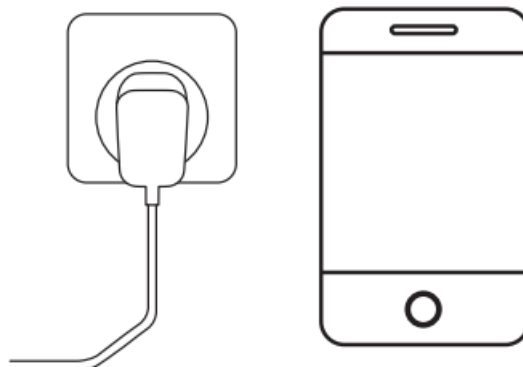

4. After the product is powered on. control the light strip with the app or remote control

Feature

APP: HomePlus Light

Language: Chinese / English / German

Operation Platform: Android 4.0 or IOS 9.0 or higher

Input Voltage: DC 24V

Max Output Power: 48W

IP Rating: Ip20

FCC ID: 2AYVG-E824B

Working Temperature: 20-55°C

Color: 16 kinds of colors, dimmable&4 flash modes.

LED strip: 7.5M Strip x 2, 450pcs SMD 505ORGB

Control distance: 8 meters.

Documents / Resources

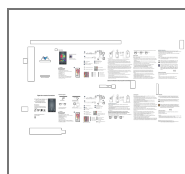

[Shenzhen Bason Electronics Technology E824B LED Bluetooth Controller](#) [pdf]

Instruction Manual

E824B, 2AYVG-E824B, 2AYVGE824B, E824B LED Bluetooth Controller, LED Bluetooth Controller