



# Shenzhen Andysom Lighting SSL-CWS1450 Smart LED String Light User Manual

[Home](#) » [Shenzhen Andysom Lighting](#) » Shenzhen Andysom Lighting SSL-CWS1450 Smart LED String Light User Manual

## Contents [ [hide](#) ]

- [1 Shenzhen Andysom Lighting SSL-CWS1450 Smart LED String Light](#)
- [2 Package Lists](#)
- [3 Specifications](#)
- [4 Operation Instructions](#)
- [5 WIFI and BLE Connection](#)
- [6 APP FUNCTION FOR YOU](#)
- [7 Other functions](#)
- [8 Link LITSHEEN Smart String Lights to Alexa/Google Assistant](#)
- [9 Caution and Warnings](#)
- [10 Documents / Resources](#)
- [11 Related Posts](#)

# Shenzhen Andysom

Shenzhen Andysom Lighting SSL-CWS1450 Smart LED String Light



### Three in One connection mode



WiFi



Button Control



Bluetooth

Thank you for purchasing Smart LED String Light, please read this user manual carefully first, we will introduce some of the important features and operation procedures of this product, please keep this manual in a safe place for future reference.

### Package Lists

- 1 × LED String Light
- 1 × DC12V 1A Adapter
- 1 × Remote controller
- 1 × User manual

### Specifications

Voltage	AC100-240V 50/60Hz
LED Bulb	12V 0.5W/pcs LED
Light Source	LED
String Length	50FT
Bulb Qty	25pcs+1spare
Color Temperature	2700K
Adapter	DC12V 1A
Connectable	2pcs
	WIFI + Bluetooth (Three
Usage Method	Can support Alexa and Google assistant voice control

## Operation Instructions

1. Plug and play.
2. Just insert the adapter into an appropriate power socket to turn on the string light and unplug it to turn off the light, no need to install bulbs.

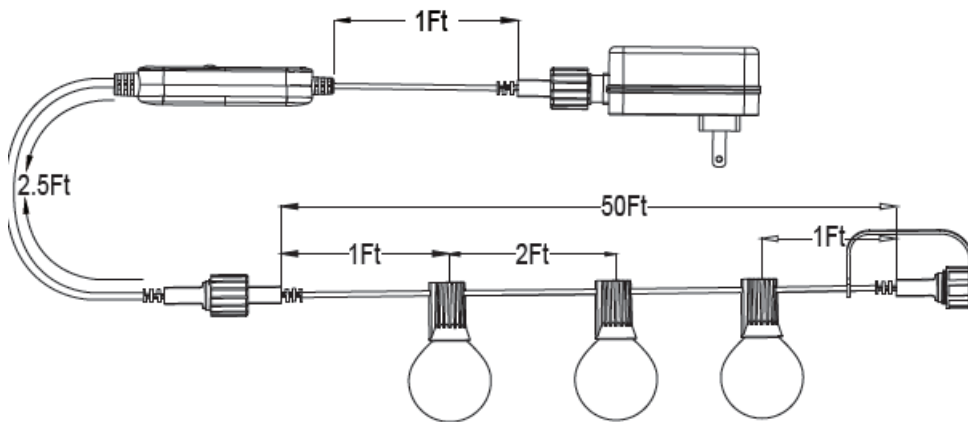

## WIFI and BLE Connection

### 1. APP Download

Download the “Tuya” or “Smart Life” APP from APP store (for IOS) and Google play store (for Android), or scan the below QR code t are, and register with phone number/ email/social media account.



### 2. How to link APP to string lights

To enter the Internet, please turn on the Bluetooth and WIFI of the mobile phone first.

**Step 1.** Plug in the adapter into the socket and the bulbs will blink rapidly, then go directly to step 2.

If the string light always on after plugging in the adapter, please long press the “on/off” button 5 seconds until the light bulbs suddenly don’t light up, then stop pressing the “on/off” button almost at the same time. Or power off 5 times until the string light to quickly blink status. Go to step 2...

**Step 2.** Open App—press “Add Device”—select “Lighting”—press “Lighting Source (BLE+Wi-Fi)”. device is added to the APP successfully.

**Step 2.** Open App—press “Add Device”—select “Lighting”—press “Lighting Source (BLE+Wi-Fi)”.

**Step 3.** Confirm the light is blinking status, then press the next step, until confirming device is added to the APP successfully.

**Step 4.** Follow the App instructions, select 2.4G Wi-Fi network and enter password.

**Note:** Please make sure these steps are done within 2 minutes, if over time, the string light will stop blinking, please restart step 1-4 then finish the connection.

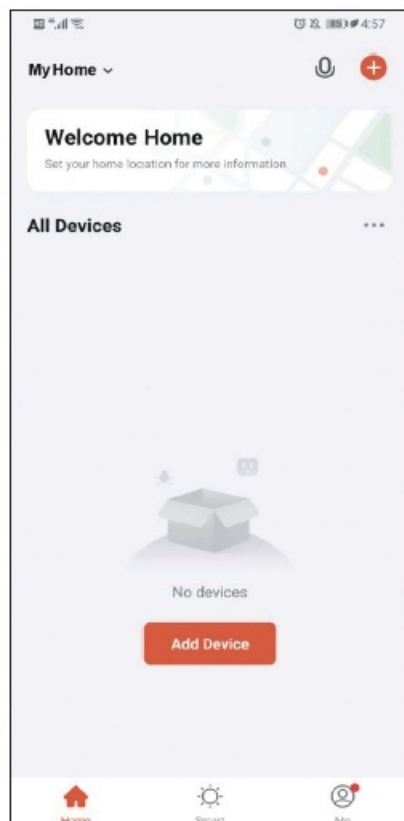

1



2

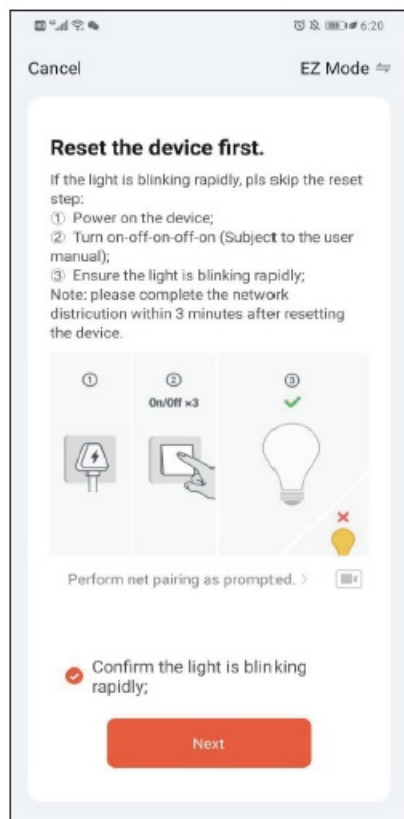

3

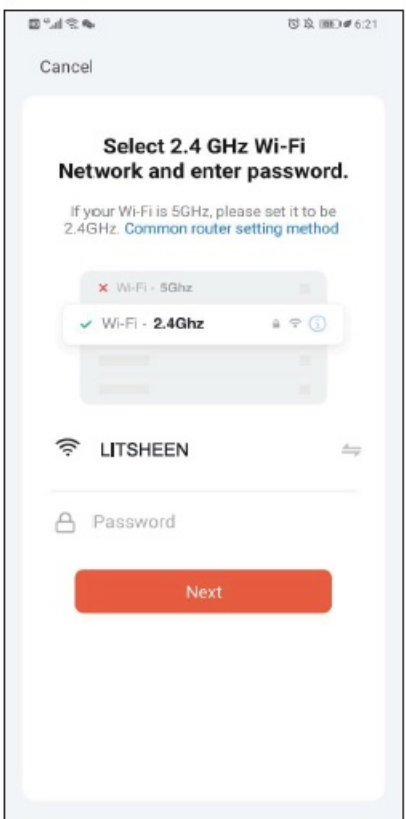

4

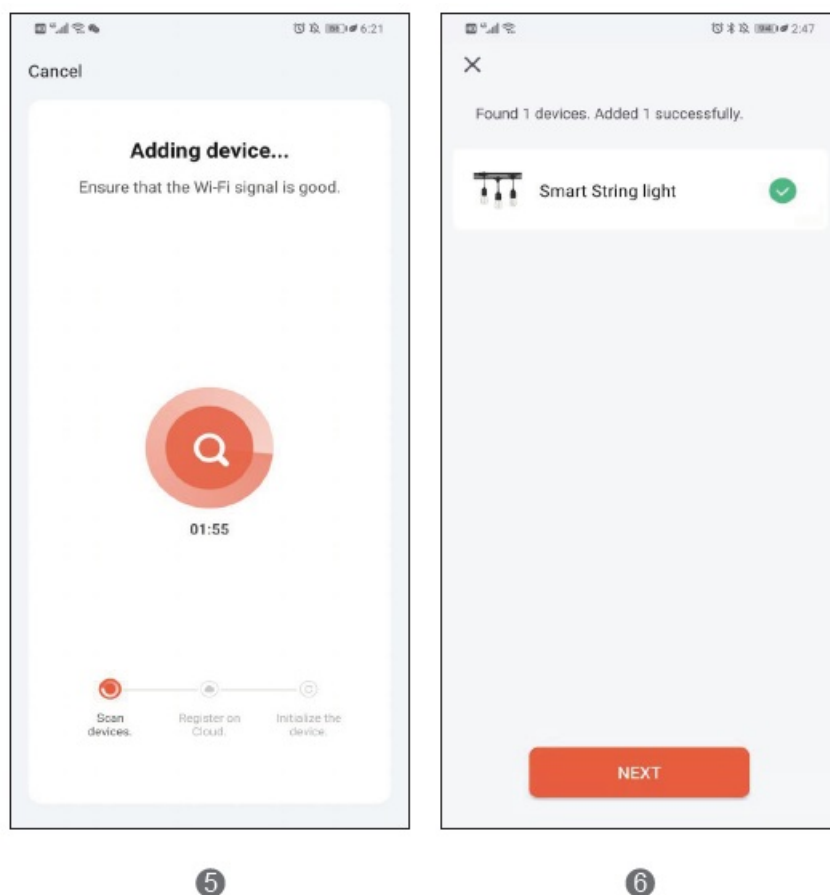

5

6

## 2.2 Hot Spot connection (AP mode slowly blink connection)

Plug in the adapter into the socket and the bulbs will blink rapidly, please long press the “on/off” button 5 seconds to turn the string light to slowly blink status. Go to step 2...

If the string light always on after plugging in the adapter, please long press the “on/off” button 5 seconds until the light bulbs suddenly don’t light up, then stop pressing the “on/off” button almost at the same time. Or power off 5 times until the string light to quickly blink status. Go to step 2...

Open App—press “Add Device”—select “Lighting”—press “Lighting Source (BLE+Wi-Fi)”.  
confirm the light is blinking slowly.

**Step 3.** Click the right top corner of APP, choose AP mode (hot-spot connection),  
confirm the light is blinking slowly.

**Step 4.** Follow the App instructions, select 2.4G Wi-Fi network and enter password.

**Step 5.** Connect your mobile phone to the device’s hotspot.

**Step 6.** Go back to your phone’s WLAN set, choose virtual router "SmartLife-XXXX".

**Step 7.** Go Back to APP, Continue to add device, until confirming device is added to the APP successfully.

**Note:** 1. Please make sure these steps are done within 2 minutes, if over time,  
the string light will stop blinking, please restart step 1-7 then finish the connection.

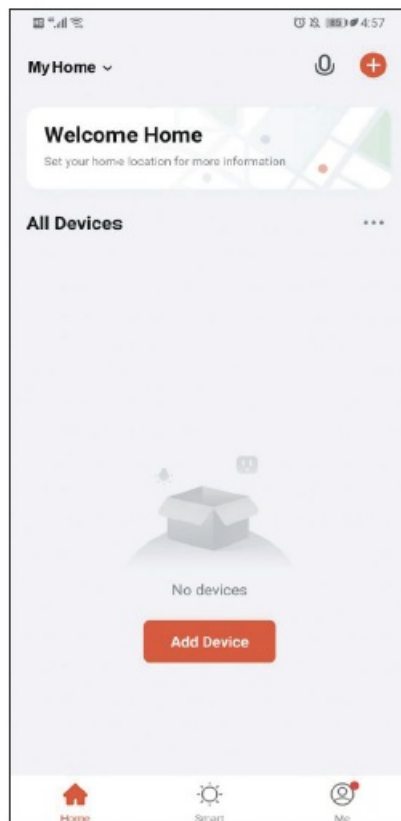

1

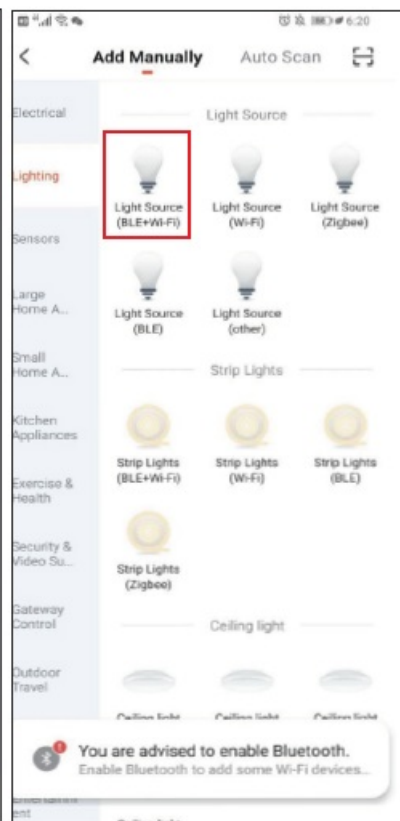

2

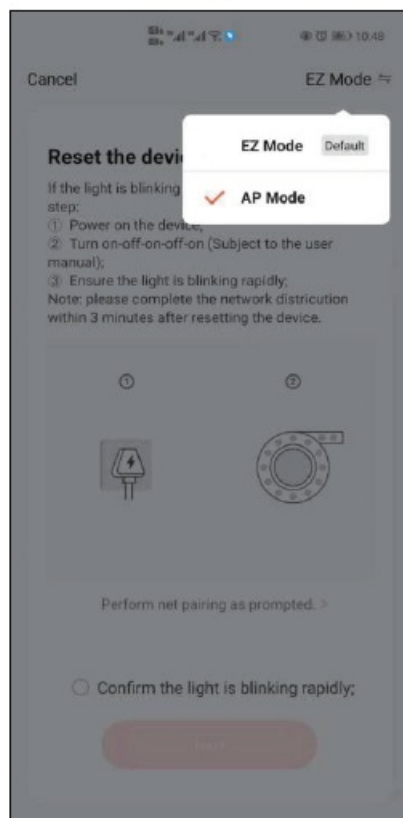

3

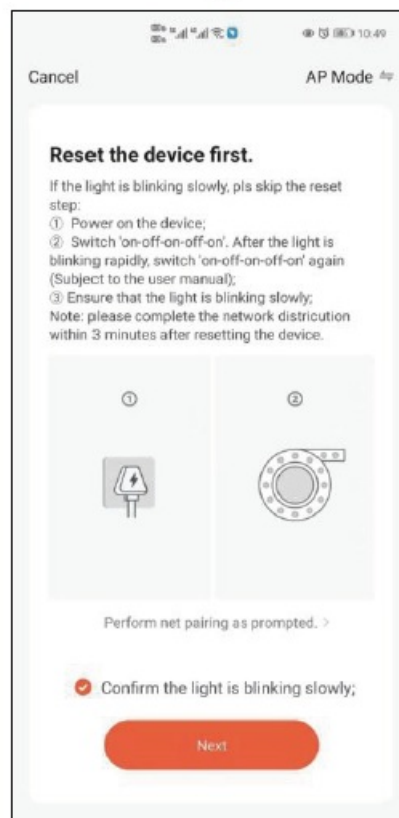

4

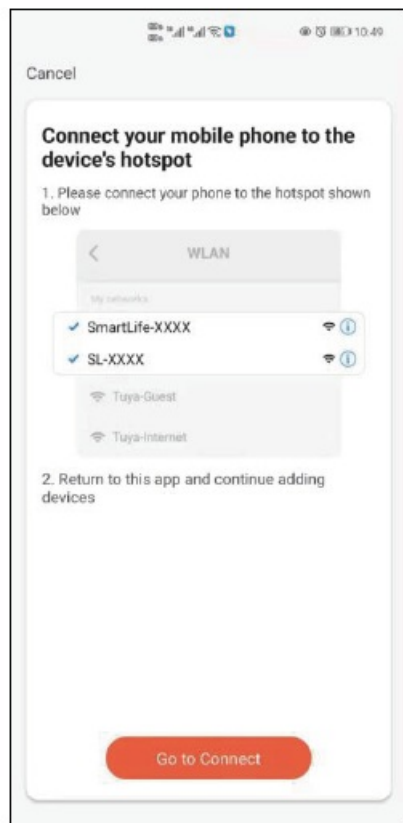

5

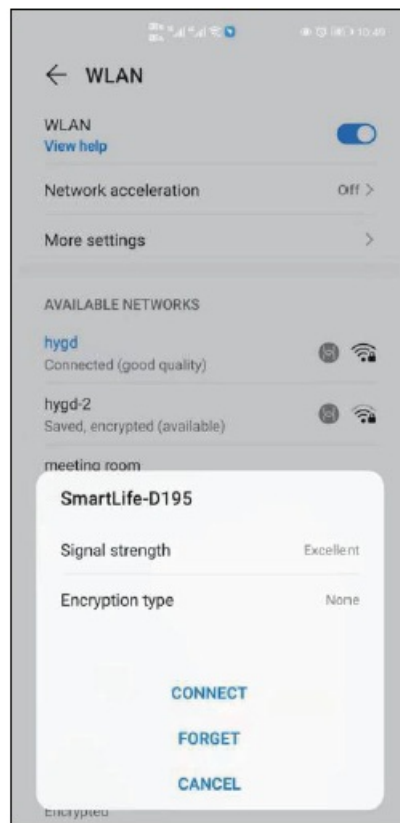

6

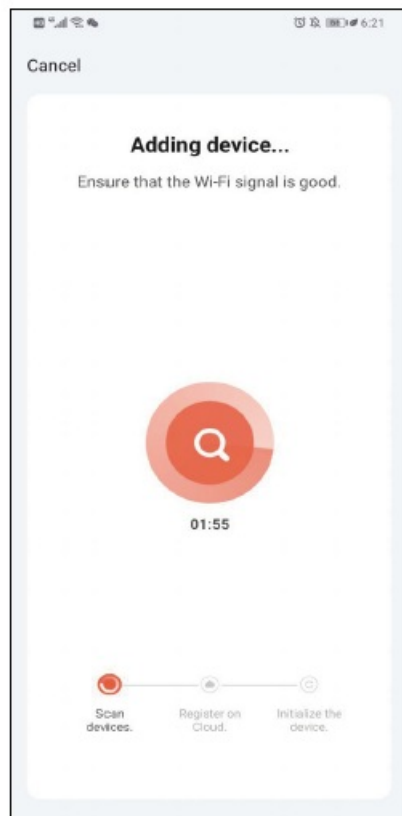

7

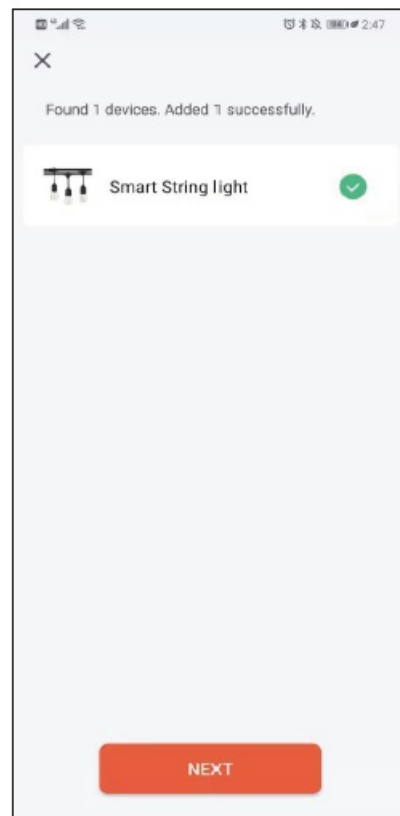

8

### Bluetooth mode quickly blink connection.

The following operation based on the phone is already the second time to connect the light string.

**Step 1.** Please turn on the bluetooth on your phone.

**Step 2.** Plug in adapter to the socket, and the string light enters to quickly blink status. Go to step 3...

If the string light always on after plugging in the adapter, please long press the "on/off" button 5 seconds until the light bulbs suddenly don't light up, then stop pressing the "on/off" button almost at the same time. Or power off 5

times until the string light to quickly blink status. Go to step 3...

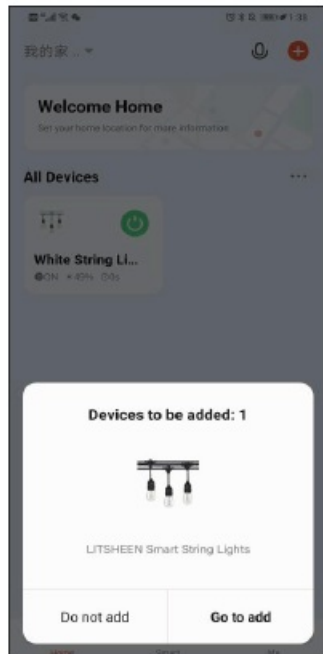

1

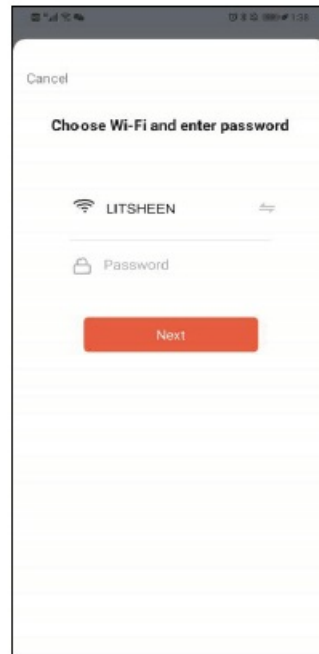

2

**Step 3.** Confirm the window of devices adding pops up, and then click “Go to add”

**Step 4.** Follow the App instructions, select 2.4G Wi-Fi network and enter password, then press the next step, until confirming device is added to the APP successfully.

## APP FUNCTION FOR YOU

When you enter the APP, you can see three sections: white, Scene and Music Sync. Detailed function description please check below:

**White:** this is the brightness change, left and right sliding brightness axis can easily change brightness from 1%-100% .

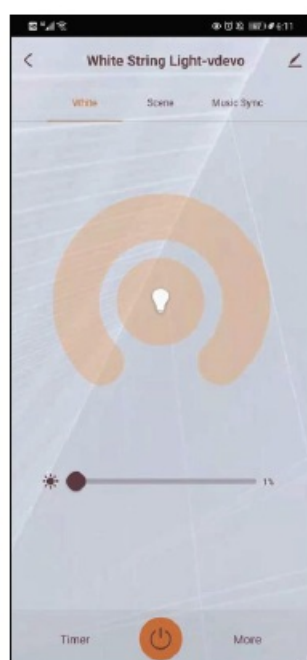

1

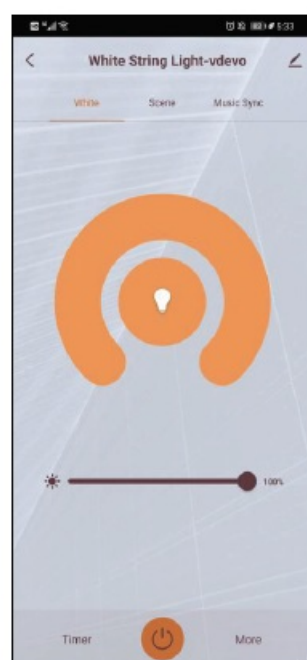

2

**Scence:** APP preset four scenes, such as Night, Read, Working, Leisure.



The preset sciences are not fixed; you can reset them by pressing the “Edit” button in the upper right corner.  
(Details in P14-P15)

For more sciences, you can click in the lower right corner “Add Scene” to design. And then follow P14-P15 again.

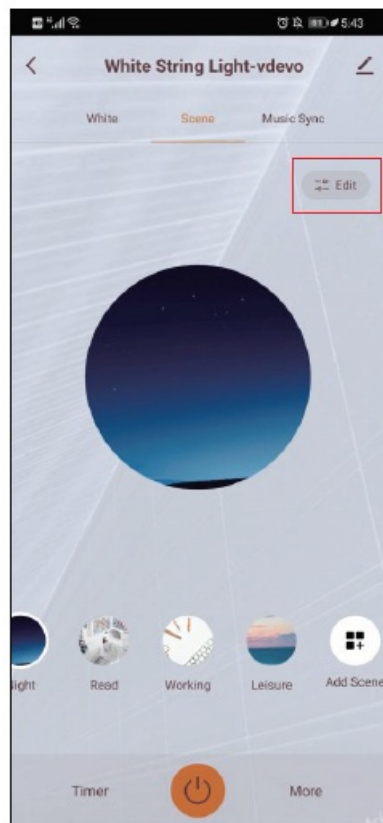

3

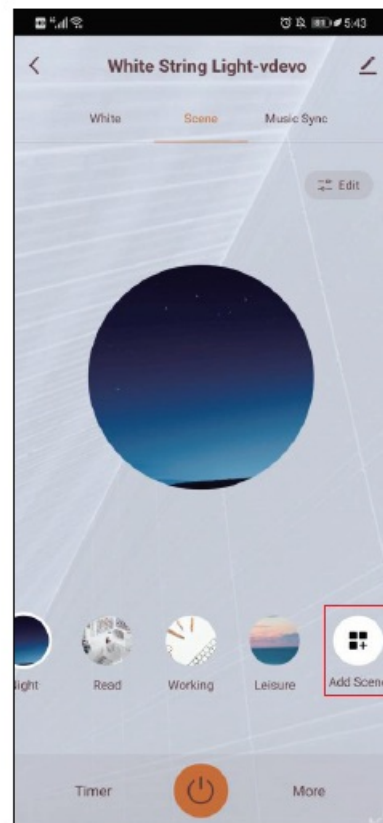

4

**Scence Flash Mode: StaTICc/Flash/Breath are opTional.**

4Scence color: Static mode displays a brightness circle, adjustable brightness; 4.2.Breath and Flash: most add 8 brightness circles to change the brightness; the brightness changes in a loop from le to right.

Colour Flash Speed: Static no speed choice, in breath and flash can Adjust the speed.

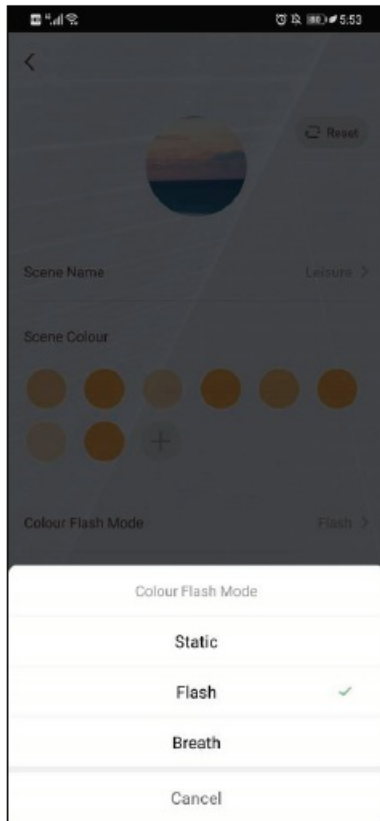

5

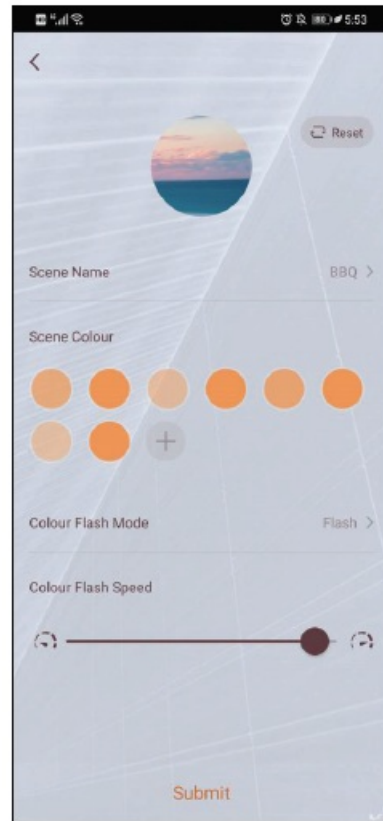

6

**Music rhythm: When you turn on the music rhythm mode, the light string will rhythm with the following two situations.**

Open the music APP of the mobile phone that controls the light string, click to play music, and the light string will rhythm with the music.

When the mobile phone connected to the light string is not playing music, the mobile phone will receive other sounds and follow the rhythm.

**Tip:** If you leave the music rhythm mode, the rhythm will stop.

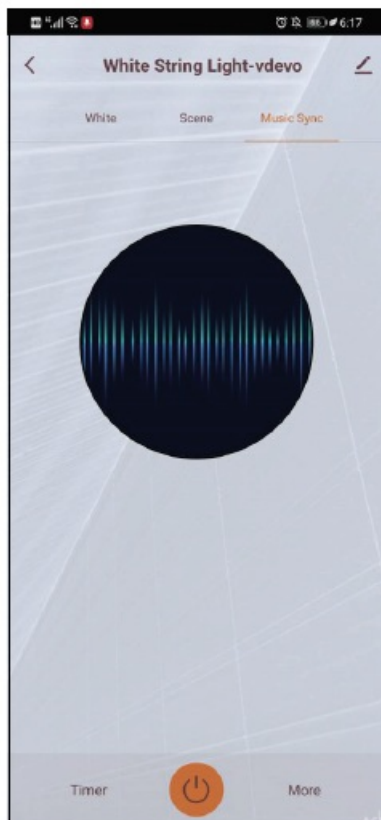

7

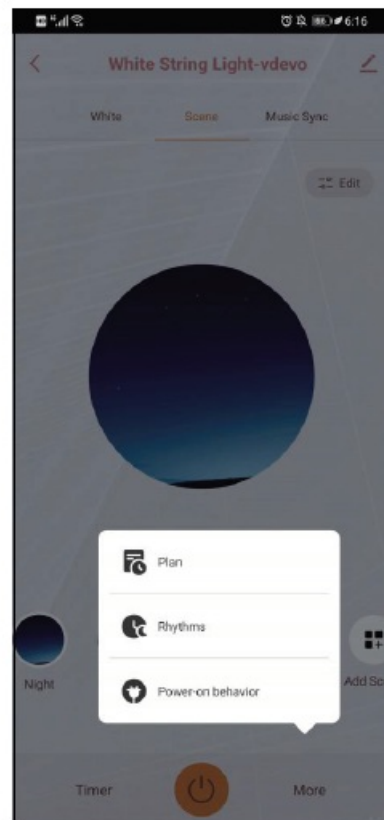

8

## Other functions

Timer: preset me for the light string to automatically turn off

Plan: The owner can freely set the on/off time of the light string every day, and click “Custom” to adjust the brightness.

.Rhythms: Design brightness changes for different time periods of the day. The brightness change mode can be “Linear 1—direct change” or “Linear 2—gradual change”.

Power-on behavior: mainly includes Do Not Disturb, Initial mode and Restore memory, or you can customized light status after power on.

Do not disturb mode: is a sudden power outage protection. When power is restored again, the string light will not automatically turned on to protect the sleeping person. You need to click the switch to turn it on again.

Share device: Control the string lights with different device. Open the APP, enter any mode page, click “ ” in the upper right corner, find “share Device” in Other, click “Add Sharing”, and then choose the way you like to share.

## Link LITSHEEN Smart String Lights to Alexa/Google Assistant

Go To Tuya/Smart Life App > Click to “Me” > More for instructions to link Alexa/Google Assistant.

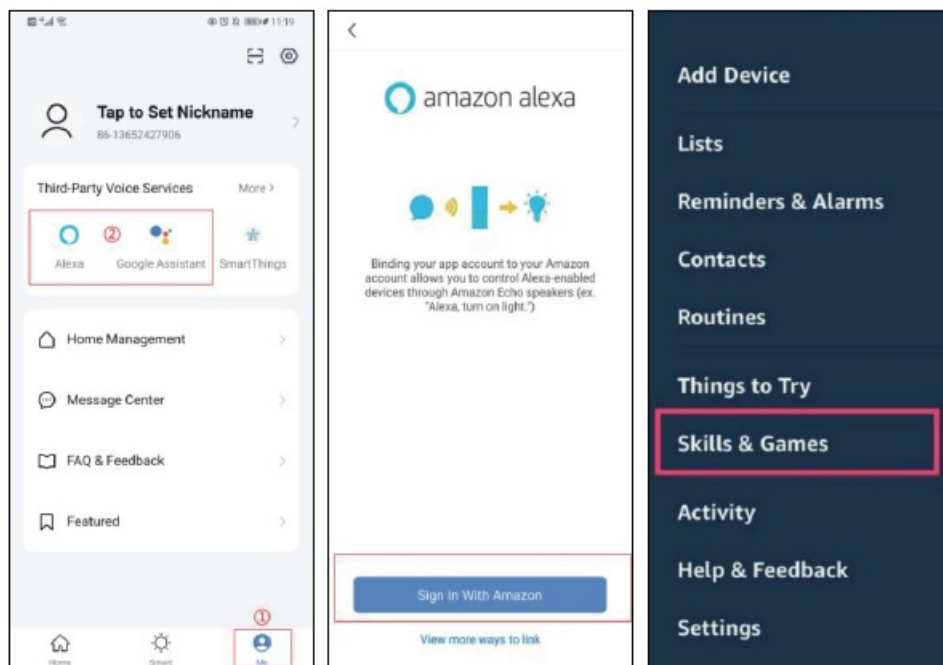

Note: If you choose “View more ways to link”, click “Link with ACCOUNT Passwords”, then follow the instruction video or the corresponding operation steps to complete the connection.

## Key Steps to Link the Alexa Skill

- Sign in With Amazon, tap on “Skills & Games” in the Alexa menu;
- Search for the “Smart Life/Tuya”, and tap “Enable” to enable the Skill.
- Enter the Smart Life/Tuya APP account and password, then tap “Link Now” to link your Smart Life/Tuya account to enable the Skill.

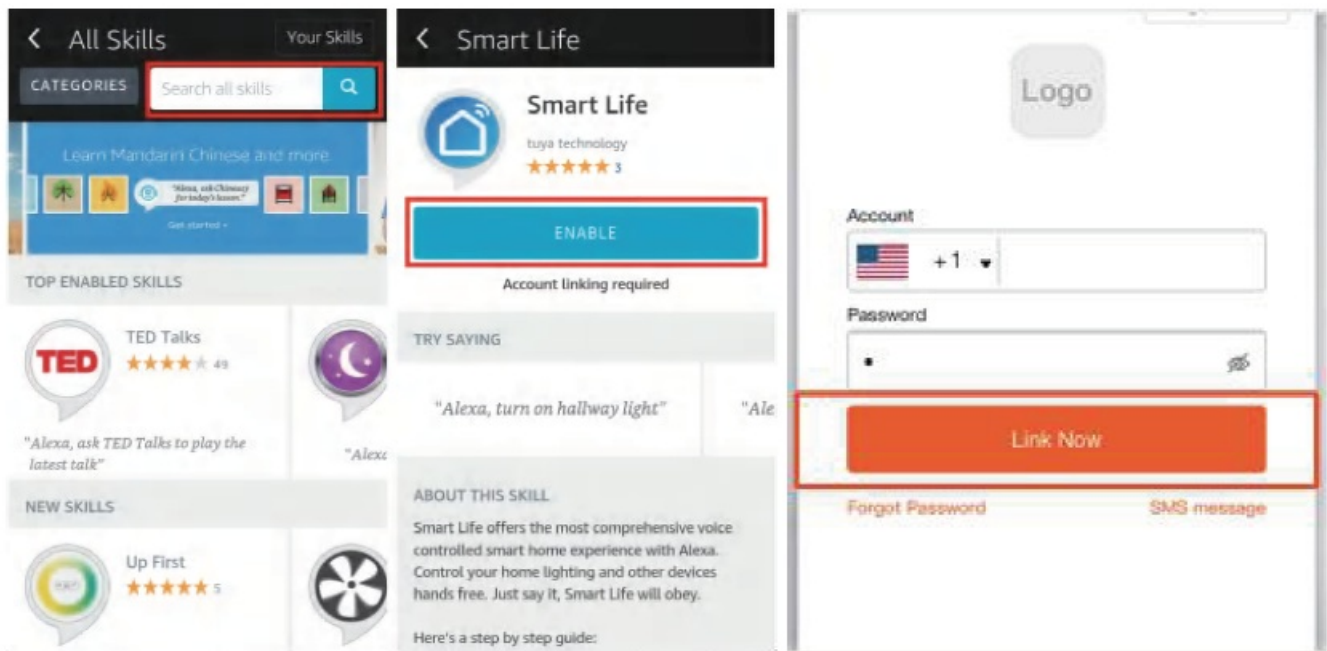

**Note:** If you can't use the voice control correctly, try to disable the skill from Alexa APP then re-enable it again. Or reconnect the string lights to Smart Life/Tuya App (Search APP name on the Apple APP Store /Google Play to download the APP).

## Caution and Warnings

1. The second phone try to connect the network and the operation is successful, the device of the original mobile phone will be automatically removed.
2. Do not repair, disassemble, or modify the product without approval.
3. Do not place the light near any heat sources.
4. Please keep it away from children.
5. Please keep the light dry and clean.
6. Please do not hang anything from the string lights as the extra weight may break the light wire and cause potent e hazard.
7. Although our lights are built with safety measures, we do not recommend leaving the light una ended or turning on permanently.
8. Please cut off the power before installing the bulb.
9. If you want to connect more sets string lights, need to change a bigger power adapter.

## Correct Disposal of This Product

This marking shown on the product, or its literature, indicates that it should not be disposed with other household wastes at the end of it is working life.

To prevent possible harm to the environment or human health from uncontrolled waste disposal, please separate this from other types of wastes and recycle it responsibly to promote the sustainable reuse of material resources. Household users should contact either the retailer where they purchasing this product or their local government office, for details of there and how they can take this item for environmentally safe recycling.

Business users should contact their supplier check the terms and c purchase contacts, this product should not be mixed with other commercial waste for disposal.

### FCC STATEMENT :

This device complies with Part 15 of the FCC Rules. Operation is subject to the following two conditions:

This device may not cause harmful interference, and This device must accept any interference received, including

interference that may cause undesired operation.

**Warning:** Changes or modifications not expressly approved by the party responsible for compliance could void the user’s authority to operate the equipment.

**NOTE:** This equipment has been tested and found to comply with the limits for a Class B digital device, pursuant to Part 15 of the FCC Rules. These limits are designed to provide reasonable protection against harmful interference in a residential installation. This equipment generates uses and can radiate radio frequency energy and, if not installed and used in accordance with the instructions, may cause harmful interference to radio communications. However, there is no guarantee that interference will not occur in a particular installation. If this equipment does cause harmful interference to radio or television reception, which can be determined by turning the equipment off and on, the user is encouraged to try to correct the interference by one or more of the following measures:

- Reorient or relocate the receiving antenna.
- Increase the separation between the equipment and receiver.
- Connect the equipment into an outlet on a circuit different from that to which the receiver is connected.
- Consult the dealer or an experienced radio/TV technician for help.

**FCC Radiation Exposure Statement:**

This equipment complies with FCC radiation exposure limits set forth for an uncontrolled environment. This equipment should be installed and operated with minimum distance 20cm between the radiator & your body.

**Documents / Resources**

	<a href="#">Shenzhen Andysom Lighting SSL-CWS1450 Smart LED String Light</a> [pdf] User Manual SSL, 2AVB5-SSL, 2AVB5SSL, SSL-CWS1450 Smart LED String Light, Smart LED String Light, String Light, Light
---	---