



Shelly Plus HandT WiFi Humidity and Temperature Sensor User Guide

[Home](#) » [Shelly](#) » Shelly Plus HandT WiFi Humidity and Temperature Sensor User Guide 



USER AND SAFETY GUIDE Wi-Fi Humidity and Temperature Sensor

Contents

- [1 Plus HandT WiFi Humidity and Temperature Sensor](#)
- [2 Product Description](#)
- [3 Installation instruction](#)
- [4 Display](#)
- [5 Specification](#)
- [6 Declaration of conformity](#)
- [7 Documents / Resources](#)
 - [7.1 References](#)

Plus HandT WiFi Humidity and Temperature Sensor

Read before use

This document contains important technical and safety information about the device, its safety use and installation. **⚠ CAUTION!** Before you start the installation, read carefully and entirely this guide and any other documents accompanying the device. Failure to follow the installation procedures can lead to malfunction, danger to your health and life, violation of law, or refusal of legal and commercial guarantees (if any). Shelly Europe Ltd. is not responsible for any loss or damage in case of incorrect installation or improper operation of this device due to failure to follow the user and safety instructions in this guide.

Product Description

Shelly Plus H&T (the Device) is a Wi-Fi smart humidity and temperature sensor.

The Device can be accessed, controlled, and monitored remotely from any place where the User has internet connectivity, as long as the device is connected to a Wi-Fi router and the Internet.

The Device has an embedded Web Interface that you can use to monitor, control, and adjust its settings.

⚠ **NOTICE:** The Device comes with factory-installed firmware. To keep it up-to-date and secure, Shelly Europe Ltd. provides the latest firmware updates free of charge.

You can access the updates through either the embedded web interface or the Shelly Smart Control mobile application, where you can find details about the latest firmware version. The choice to install or not the firmware updates is the user's sole responsibility. Shelly Europe Ltd. shall not be liable for any lack of conformity of the Device caused by the failure of the user to install the available updates in a timely manner.

Installation instruction

⚠ **CAUTION!** Do not use the Device if it shows any sign of damage or defect.

⚠ **CAUTION!** Do not attempt to service or repair the Device yourself.

1. Power supply

Shelly Plus H&T can be powered by 4 AA (LR6) 1.5 V batteries or a USB Type-C power supply adapter.

⚠ **CAUTION!** Use the Device only with batteries or USB Type-C power supply adapters that comply with all applicable regulations.

Inappropriate batteries or power supply adapters may damage the Device and cause fire.

A. Batteries Remove the Device back cover using a flat screwdriver as shown in Fig. 1, insert the bottom row batteries as shown in Fig. 3 and the top row batteries as shown in Fig. 4.

⚠ **CAUTION!** Make sure the batteries + and – signs correspond to the marking on the Device battery compartment (Fig. 2 A)

B. USB Type-C power supply adapter Insert the USB Type-C power supply adapter cable into the Device USB Type-C port (Fig. 2 C)

⚠ **CAUTION!** Do not connect the adapter to the Device if the adapter or the cable are damaged.

⚠ **CAUTION!** Unplug the USB cable before removing or placing the back cover.

⚠ **IMPORTANT!** The Device cannot be used to charge rechargeable batteries.

2. Starting

When initially powered the Device will be put in Setup mode and the display will show SEt instead of the temperature. By default the Device access point is enabled, which is indicated by AP in the bottom right corner of the display.

If it is not enabled, press and hold the Reset button (Fig. 2 B) for 5 seconds to enable it.

⚠ **IMPORTANT!** To save the batteries the Device stays in Setup mode for 3 minutes and then goes to Sleep mode and the display will show the measured temperature. Press briefly the Reset button to bring it back to Setup mode. Pressing the Reset button briefly while the Device is in Setup mode will put the Device in Sleep mode.

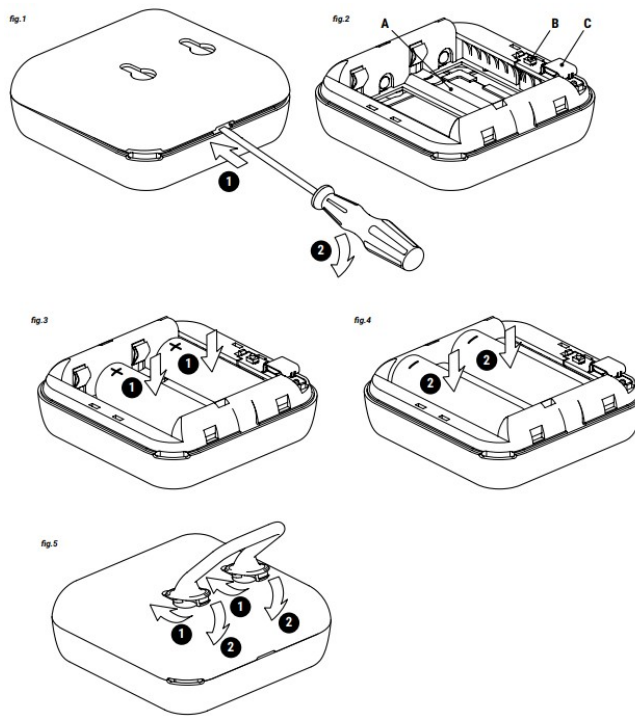

3. Inclusion to Shelly Cloud

The Device can be monitored, controlled, and set up through our Shelly Cloud home automation service. You can use the service through either an Android or iOS mobile application or through any internet browser at <https://control.shelly.cloud/>.

The Shelly mobile application and Shelly Cloud service are not conditions for the Device to function properly. This Device can be used standalone or with various other home automation platforms and protocols.

If you choose to use the application and cloud service, you can find instructions on how to connect the Device in the mobile application guide: <https://shelly.link/app-guide>

4. Manually connecting to a local Wi-Fi network

Shelly Plus H&T can be managed and controlled through its embedded web interface. Make sure the Device is in Setup mode, its access point (AP) is enabled and you are connected to it using a Wi-Fi-enabled device. From a web browser open the Device Web Interface by navigating to 192.168.33.1. Select Settings from the main menu and then Wi-Fi under Network settings. Enable Wi-Fi 1 and/or Wi-Fi 2 (backup network) by checking the Enable Wi-Fi network checkbox. Select the Wi-Fi network name (SSID) from the NETWORKS dropdown. Enter the Wi-Fi network password(s) and select Save settings.

The URL appears in blue at the top of the Wi-Fi section, when the Device is successfully connected to the Wi-Fi network.

△RECOMMENDATION! For security reasons, we recommend disabling the AP, after the Device successful connection to the local Wi-Fi network. Select Settings from the main menu and then Access Point under Network settings. Disable the AP by unchecking Enable AP network checkbox.

When you complete the Device inclusion to the Shelly cloud or another service, place the back cover.

△CAUTION! Unplug the USB cable before removing or placing the back cover.

5. Attaching the stand

If you want to place the Device on your desk, on a shelf or any other horizontal surface, attach the stand as shown on Fig. 5.

6. Wall mounting

If you want to mount the Device on a wall or any other vertical surface, use the back cover to mark the wall where you want to mount the Device.

⚠ **CAUTION!** Do not drill through the back cover.

Use screws with head diameters between 5 and 7 mm and max 3 mm thread diameter to fix the Device to a wall or another vertical surface.

Another option to mount the Device is using a double sided foam sticker.

⚠ **CAUTION!** The Device is intended for indoor use only.

⚠ **CAUTION!** Protect the Device from dirt and moisture.

⚠ **CAUTION!** Do not use the Device in a damp environment, and avoid water splashing.

Reset button actions

The Reset button is shown on Fig.2 B.

- Press briefly:
 - If the Device is in Sleep mode, puts it in Setup mode.
 - If the Device is in Setup mode, puts it in Sleep mode.
- Press and hold for 5 sec: If the Device is in Setup mode, enables its access point.
- Press and hold for 10 sec: If the Device is in Setup mode, factory resets the Device.

Display

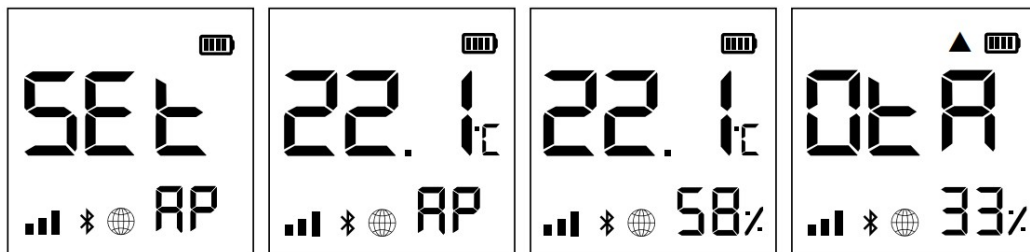

⚠ **NOTICE:** The quality of the internet connection may influence the accuracy of the displayed time.

- SEt The Device is in Setup mode.
- AP The Device access point is enabled
- 58% Humidity
- 0.1 The Device is receiving over-the-air updates. Shows the progress in percents instead of the humidity.
- 🌐 The Device has reported current readings to the Cloud. If missing, the current readings on the display are not yet reported. In this case, the readings on the display may differ from the ones in the Cloud.
- 📶 Wi-Fi signal strength indicator
- 🔋 Indicates battery level. Shows an empty battery when USB- powered.
- 📶 Bluetooth connectivity is enabled. Bluetooth is used for inclusion. It can be disabled from the Shelly app or the Device local web interface.
- ▲ Error while updating the Device firmware.

Specification

- Dimensions (HxWxD):
 - without stand: 70x70x26 mm / 2.76x2.76x1.02 in

- with stand: 70x70x45 mm / 2.76x2.76x1.77 in
- Ambient temperature: 0 °C to 40 °C / 32 °F to 104 °F
- Humidity: 30 % to 70 % RH
- Power supply:
 - Batteries: 4 AA (LR6) 1.5 V (batteries not included)
 - USB power supply: Type-C (cable not included)
- Estimated battery life: Up to 12 months
- Electrical consumption:
 - Sleep mode $\leq 32\mu\text{A}$
 - Setup mode $\leq 76\text{mA}$
- RF band: 2400 – 2495 MHz
- Max. RF power: < 20 dBm
- Wi-Fi protocol: 802.11 b/g/n
- Wi-Fi operational range (depending on local conditions):
 - up to 50 m / 160 ft outdoors
 - up to 30 m / 100 ft indoors
- Bluetooth protocol: 4.2
- Bluetooth operational range (depending on local conditions):
 - up to 30 m / 100 ft outdoors
 - up to 10 m / 33 ft indoors
- CPU: ESP32
- Flash: 4MB
- Webhooks (URL actions): 10 with 2 URLs per hook
- MQTT: Yes
- REST API: Yes

Declaration of conformity

Hereby, Shelly Europe Ltd. (former Allterco Robotics EOOD) declares that the radio equipment type for Shelly Plus H&T is in compliance with Directive 2014/53/EU, 2014/35/EU, 2014/30/EU, 2011/65/EU. The full text of the EU declaration of conformity is available at the following internet address: https://shelly.link/Plus-HT_DoC

Manufacturer: Shelly Europe Ltd.

Address: 103 Cherni vrah Blvd., 1407 Sofia, Bulgaria

Tel.: +359 2 988 7435

E-mail: support@shelly.cloud

Official website: <https://www.shelly.com>

Changes in the contact information data are published by the Manufacturer on the official website. <https://www.shelly.com>

All rights to the trademark Shelly® and other intellectual rights associated with this Device belong to Shelly Europe Ltd.





[Shelly Plus HandT WiFi Humidity and Temperature Sensor](#) [pdf] User Guide
591551, Plus HandT WiFi Humidity and Temperature Sensor, Plus HandT, Plus HandT Sensor,
WiFi Humidity and Temperature Sensor, WiFi Humidity Sensor, WiFi Temperature Sensor, Humi
dity Sensor, Temperature Sensor

References

- [🌐 Shelly Control](#)
- [🔗 Shelly Smart Control Guide](#)
- [User Manual](#)

[Manuals+](#), [Privacy Policy](#)

This website is an independent publication and is neither affiliated with nor endorsed by any of the trademark owners. The "Bluetooth®" word mark and logos are registered trademarks owned by Bluetooth SIG, Inc. The "Wi-Fi®" word mark and logos are registered trademarks owned by the Wi-Fi Alliance. Any use of these marks on this website does not imply any affiliation with or endorsement.