

Shelly  
Shelly CEE 7-3  
Wall Display  
Stand



# Shelly CEE 7-3 Wall Display Stand User Guide

[Home](#) » [Shelly](#) » Shelly CEE 7-3 Wall Display Stand User Guide 

## Contents

- [1 Shelly CEE 7-3 Wall Display Stand](#)
- [2 User and safety guide](#)
- [3 Safety information](#)
- [4 Installation instructions](#)
- [5 Specifications](#)
- [6 Environmental](#)
- [7 Troubleshooting](#)
- [8 FAQ](#)
- [9 Documents / Resources](#)
  - [9.1 References](#)
- [10 Related Posts](#)

# Shelly

**Shelly CEE 7-3 Wall Display Stand**



## User and safety guide

Shelly Socket for Wall Display

### Stand

A CEE 7/3 (Type F / Schuko) electrical socket, which can be installed on a Shelly Wall Display Stand. Referred to in this document as “The Device”, “Shelly Socket”, and “socket”.

This sign indicates safety information.

This sign indicates an important note.

## Safety information

For safe and proper use, read this guide, and any other documents accompanying this product. Keep them for future reference. Failure to follow the installation procedures can lead to malfunction, danger to health and life, violation of law, and/or refusal of legal and commercial guarantees (if any). Shelly Europe Ltd. is not responsible for any loss or damage in case of incorrect installation or improper operation of this device due to failure to follow the user and safety instructions in this guide.

- **WARNING!** The connection of the Shelly Socket to the Shelly Wall Display Stand must be performed carefully by a qualified electrician.
- **WARNING!** Do not plug the Shelly Wall Display Stand into the electrical grid until you have completely installed the Shelly Socket.
- **WARNING!** Before making any changes to the connections, unplug the Device.
- **CAUTION!** Connect the Device only to a power grid and appliances that comply with all applicable regulations. A short circuit in the power grid or any appliance connected to the Device can cause fire, property damage, and electric shock.
- **WARNING!** Appliances exceeding the specified maximum electric load should not be plugged into the Shelly Socket.
- **CAUTION!** Connect the Device only in the way shown in these instructions. Any other method could cause damage and/or injury.
- **CAUTION!** Do not use the Device if it shows any sign of damage or defect.
- **CAUTION!** Do not attempt to repair the Device yourself.
- **CAUTION!** The Device is intended only for indoor use.
- **CAUTION!** Keep the Device away from dirt and moisture.

## Installation instructions

1. Remove the cap at the back of the tabletop stand (Fig. 1) and pull out the wires.
2. Connect the Live wire (red) to the socket's L terminal, the Neutral wire (blue) to the N terminal, and the Ground wire (yellow- green) to the terminal (Fig. 2).
3. Insert the socket with the wires into the tabletop stand and press until it clicks (Fig. 3).

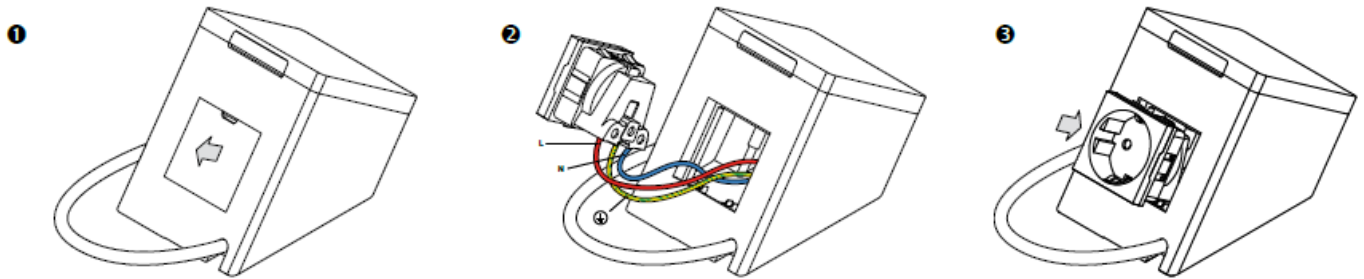

## Specifications

### Physical

- Size (HxWxD): 45x45x45 mm / 17.72×17.72×17.72 in
- Weight: 38 g / 0.04 oz
- Shell material: Plastic
- Shell color:
  - White
  - Black

### Environmental

- Ambient working temperature: -20°C to 40°C / -5°F to 105°F
- Humidity: 30% to 70% RH

### Electrical

- Voltage: 230 V~ 50/60 Hz
- Max. current 5 A / 230 V~

## Troubleshooting

In case you encounter problems with the installation or operation of the Device, check its knowledge base page: [https://shelly.link/EU\\_socket](https://shelly.link/EU_socket)

### Declaration of Conformity

Hereby, Shelly Europe Ltd. declares that the Shelly Wall Display Stand is in compliance with Directive 2014/35/EU, 2011/65/EU. The full text of the EU declaration of conformity is available at the following internet address: [https://shelly.link/socket\\_Wdisplay\\_stand\\_DoC](https://shelly.link/socket_Wdisplay_stand_DoC)

### Disposal and recycling



■ This refers to the waste of electrical and electronic equipment. It is applicable in the EU, US and other countries to collect waste separately.

This symbol on the Device or in the accompanying literature indicates that it should not be disposed of in the daily waste. The Device must be recycled to avoid possible damage to the environment or human health from uncontrolled waste disposal and to promote the reuse of materials and resources.

It is your responsibility to dispose of the Device separately from general household waste when it is already unusable. Manufacturer: Shelly Europe Ltd.

- Address: 103 Cherni Vrah Blvd., 1407 Sofia, Bulgaria
- Tel.: +359 2 988 7435
- E-mail: [support@shelly.cloud](mailto:support@shelly.cloud)

Official website: <https://www.shelly.com> Changes in contact information are published by the Manufacturer on the official website.

All rights to the trademark Shelly® and other intellectual rights associated with this Device belong to Shelly Europe Ltd.

For UP PSTI Act Statement of Compliance scan the QR code



## FAQ

**Q: Where can I find the Declaration of Conformity for the product?**

A: The Declaration of Conformity can be accessed online at [here](#).

## Documents / Resources



[Shelly CEE 7-3 Wall Display Stand](#) [pdf] User Guide

CEE 7-3 Type F - Schuko, CEE 7-3 Wall Display Stand, CEE 7-3, Wall Display Stand, Display Stand, Stand

## References

- [User Manual](#)

[Manuals+.](#) [Privacy Policy](#)

This website is an independent publication and is neither affiliated with nor endorsed by any of the trademark owners. The "Bluetooth®" word mark and logos are registered trademarks owned by Bluetooth SIG, Inc. The "Wi-Fi®" word mark and logos are registered trademarks owned by the Wi-Fi Alliance. Any use of these marks on this website does not imply any affiliation with or endorsement.