



Shelly Blu Motion Detector Bluetooth User Manual

[Home](#) » [Shelly](#) » Shelly Blu Motion Detector Bluetooth User Manual 

Shelly Blu Motion Detector Bluetooth



Contents

- 1 Legend
- 2 USER AND SAFETY GUIDE SHELLYBLU MOTION
- 3 Product Introduction
- 4 Installation Instructions
- 5 First steps
- 6 Using ShellyBLU Motion
- 7 Initial Inclusion
- 8 Replacing the battery
- 9 Troubleshooting
- 10 Specifications
- 11 Declaration of conformity
- 12 Documents / Resources
 - 12.1 References
- 13 Related Posts

Legend

- **A:** Motion sensor lens (light sensor and LED indicator behind the lens)
- **B:** Control button (behind the back cover)

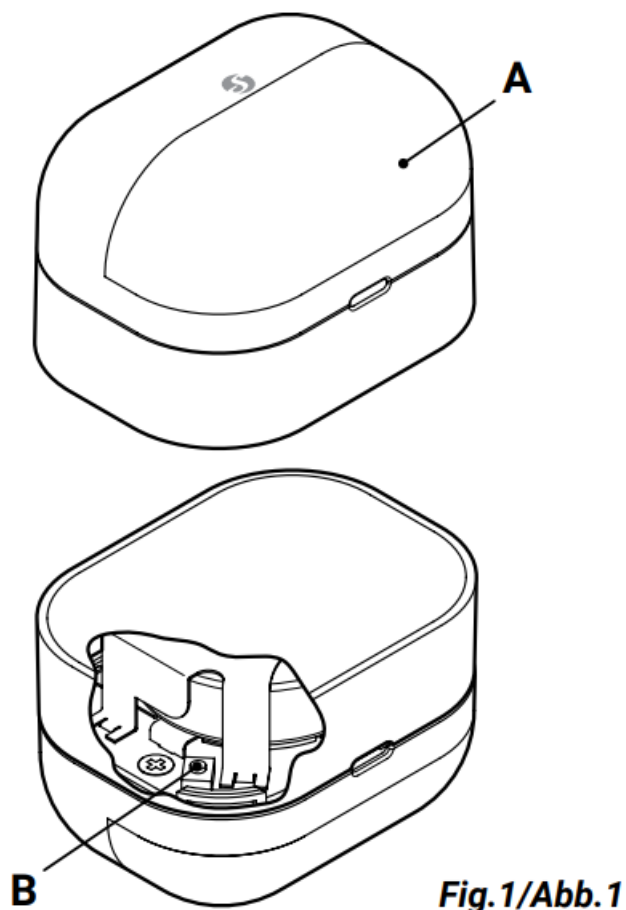

USER AND SAFETY GUIDE SHELLYBLU MOTION

Read before use

This document contains important technical and safety information about the device, its safe use and installation.



CAUTION! Before beginning the installation, please read carefully and entirely this guide and any other documents accompanying the device. Failure to follow the installation procedures could lead to malfunction, danger to your health and life, violation of law or refusal of legal and/or commercial guarantee (if any). Shelly Europe Ltd is not responsible for any loss or damage in case of incorrect installation or improper operation of this device due to failure of following the user and safety instructions in this guide.

Shelly® devices are delivered with factory-installed firmware. If firmware updates are necessary to keep the devices in conformity, including security updates, Shelly Europe Ltd will provide the updates free of charge through the device Embedded Web Interface or the Shelly mobile application, where the information about the current firmware version is available. The choice to install or not the device firmware updates is the user's sole responsibility. Shelly Europe Ltd shall not be liable for any lack of conformity of the device caused by failure of the user to install the provided updates in a timely manner.

Product Introduction

ShellyBLU Motion (the Device) is a smart Bluetooth motion detection sensor featuring a lux meter. (fig.1)

Installation Instructions

⚠ **CAUTION!** The Device is intended for indoor use only!

⚠ **CAUTION!** Keep the Device away from liquids and moisture. The Device shouldn't be used in places with high humidity.

⚠ **CAUTION!** Do not use it if the Device has been damaged!

⚠ **CAUTION!** Do not attempt to service or repair the Device yourself!

⚠ **CAUTION!** The Device may be connected wirelessly and may control electric circuits and appliances. Proceed with caution! Irresponsible use of the Device may lead to malfunction, danger to your life or violation of the law.

First steps

ShellyBLU Motion comes ready to use with the battery installed.

However, you might need to insert a battery if you do not see the LED indicator behind the motion sensor lens flashing red when you move in front of it.

See the Replacing the battery section.

Using ShellyBLU Motion

If motion is detected the LED indicator will flash red briefly and the Device will broadcast information about the event, the illumination, and the battery status at the time of the motion detection. The Device will not broadcast for a minute (user configurable), although motion detection will cause the LED indicator to flash red.

⚠ **NOTICE!** The LED indication can be disabled in the Device settings.

If no motion is detected within the next minute, it will broadcast information about the lack of motion, the illumination, and the battery status at the time of broadcasting.

If the Device is with beacon mode enabled, it will broadcast information about the current motion detection, the illumination, and the battery status every 30 seconds.

To pair ShellyBLU Motion with another Bluetooth device press and hold the control button for 10 sec. You have to

open the Device to access the control button.

See the Replacing the battery section.

The Device will await connection for the next minute. The available Bluetooth characteristics are described in the official Shelly API documentation at <https://shelly.link/ble>

Active pairing mode is indicated by brief blue flashes.

To restore the device configuration to factory settings, press and hold the control button for 30 seconds shortly after inserting the battery.

If you want to check the motion detection range or the communication with the Device, double-press the control button to set the.

Device in test mode. For a minute, the Device will broadcast every motion detection, indicating it by a red flash. Find the best location for the Device and use the supplied double-sided foam stickers to affix it.

Initial Inclusion

⚠NOTICE! If you choose to use the Device with the Shelly Smart Control mobile application, you must have at least one permanently powered Shelly Wi-Fi and Bluetooth (Gen2 or following) device, which during installation should be referred to as a Bluetooth gateway. You can find instructions on how to connect the Device to the Cloud and control it through the Shelly Smart Control app in the mobile application guide.

The Shelly mobile application and Shelly Cloud service are not conditions for the Device to function properly. This Device can be used standalone or with various other home automation platforms which support BT Home protocol.

For more information visit bthome.io

Replacing the battery

⚠CAUTION! Use only 3 V CR2477 or a compatible battery! Pay attention to the battery polarity!

1. Insert a 3 to 5 mm wide flat blade screwdriver in the slot, as shown in Fig. 2.
2. Carefully turn the screwdriver to pop open the back cover of the Device.
3. Extract the exhausted battery by pushing it out of its holder.
4. Slide in a new battery.
5. Replace the back cover by pressing it against the main body of the Device until you hear a clicking sound.

⚠CAUTION! Make sure the small cutout on the back cover is on the same side as the matching cutout on the main body as shown in Fig. 2!

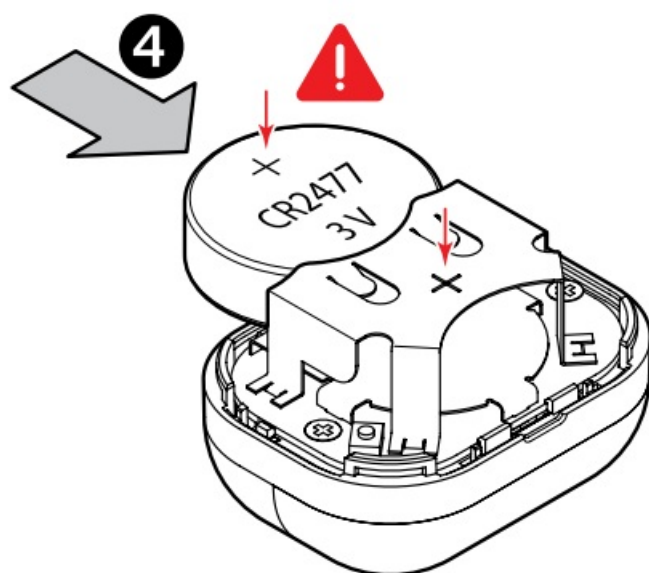
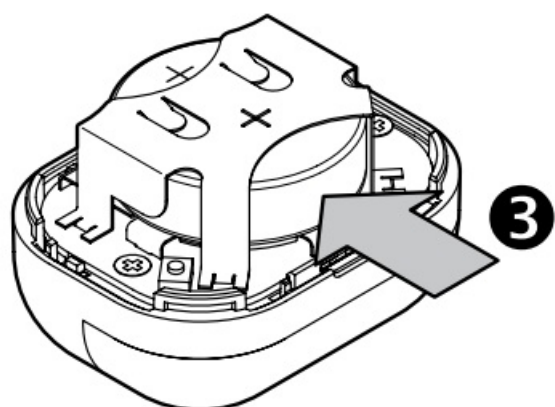
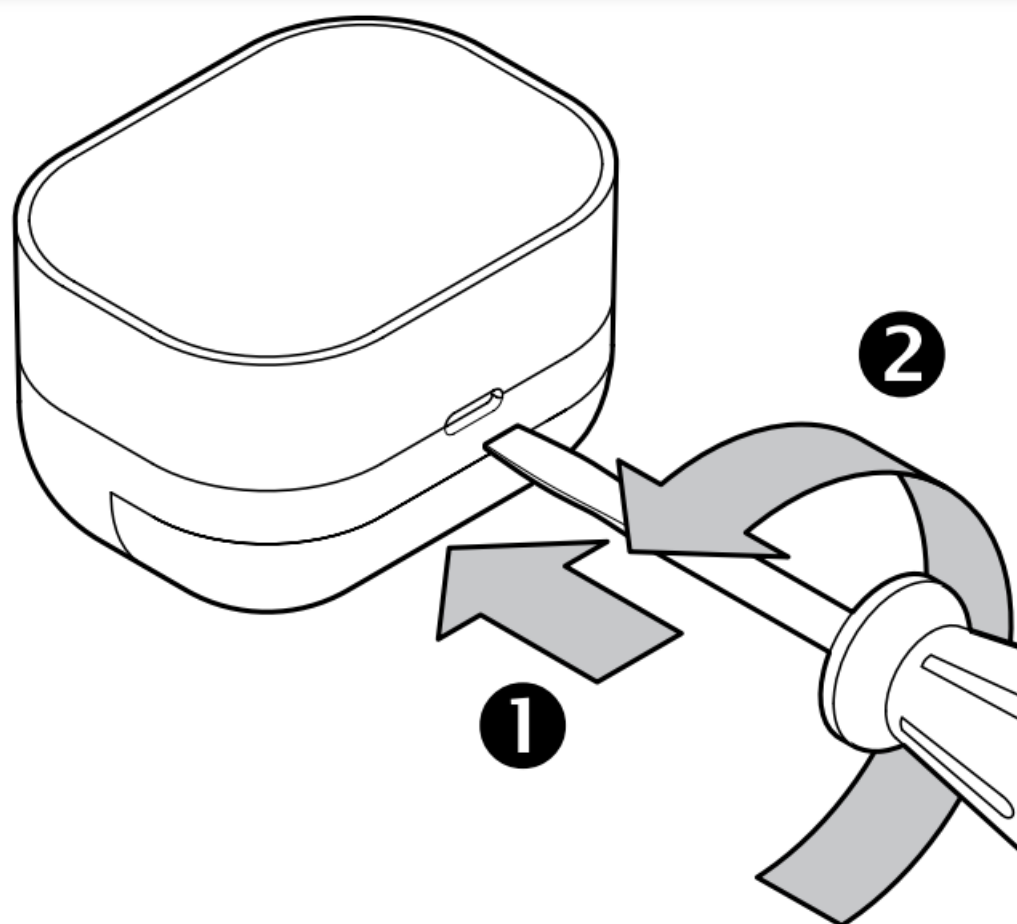

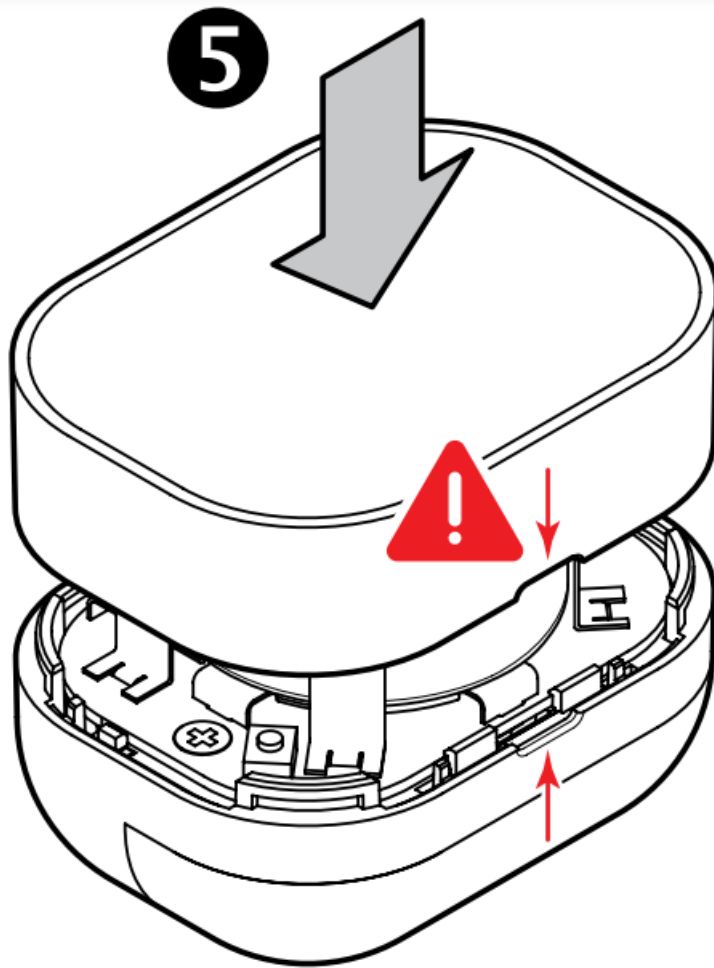

Fig.2/Abb.2

Troubleshooting

In case you encounter problems with the installation or operation of ShellyBLU Motion, please check its knowledge base page: https://shelly.link/blu-motion_kb

Specifications

- Dimensions (WxHxD): 32x42x27 mm / 1.26x1.65x1.06 in
- Weight: 26 g / 0.92 oz (with battery)
- Ambient temperature: from -20 °C to 40 °C / from -5 °F to 105 °F
- Humidity 30 % to 70 % RH
- Power supply: 1x 3 V CR2477 battery (included)
- Battery life: 5 years
- Radio protocol: Bluetooth
- RF band: 2400 – 2483.5 MHz
- Max. RF power: 4 dBm
- Beacon function: Yes
- Encryption: AES encryption (CCM mode)
- Operational range (depending on local conditions):
 - up to 30 m outdoors
 - up to 10 m indoors

Declaration of conformity

Hereby, Shelly Europe Ltd. (former Allterco Robotics EOOD) declares that the radio equipment type ShellyBLU Motion is in compliance with Directive 2014/53/EU, 2014/35/ EU, 2014/30/EU, 2011/65/EU. The full text of the EU declaration of conformity is available at the following internet address: <https://shelly.link/blu-motion-DoC>

Manufacturer: Shelly Europe Ltd.

Address: 103 Cherni vrah Blvd., 1407 Sofia,

Bulgaria

Tel.: +359 2 988 7435

E-mail: support@shelly.com

Official website: <https://www.shelly.com> Changes in the contact information data are published by the Manufacturer on the official website.

<https://www.shelly.com>

All rights to the trademark Shelly® and other intellectual rights associated with this Device belong to Shelly Europe Ltd.



Documents / Resources

	<p>Shelly Blu Motion Detector Bluetooth [pdf] User Manual Blu Motion Detector Bluetooth, Blu, Motion Detector Bluetooth, Detector Bluetooth, Bluetooth</p>
---	--

References

- [BTHome: Open standard for broadcasting sensor data over Bluetooth LE](#)
- [Shelly BLE devices](#)