

Sheif and CO CLOS-IT 2 Drawer Component



# Sheif and CO CLOS-IT 2 Drawer Component Installation Guide

[Home](#) » [Sheif and CO](#) » Sheif and CO CLOS-IT 2 Drawer Component Installation Guide 

## Contents

- 1 [Sheif and CO CLOS-IT 2 Drawer Component](#)
- 2 [Product Usage Instructions](#)
- 3 [ASSEMBLY INSTRUCTION](#)
- 4 [TOOLS](#)
- 5 [MATERIALS](#)
- 6 [ASSEMBLE THE DRAWER](#)
- 7 [ASSEMBLE THE FRAME](#)
- 8 [INSTALL THE FRAME](#)
- 9 [INSTALL THE DRAWERS](#)
- 10 [Documents / Resources](#)
  - 10.1 [References](#)
- 11 [Related Posts](#)

**Shelf**&co

**Sheif and CO CLOS-IT 2 Drawer Component**



## Specifications

- **Dimensions:** 13.4 in x [insert width] x [insert height]
- **Material:** [insert material type]
- **Components:** 2 Drawers, Drawer Front, Top Surface, Bottom Panel, Side Panels, Back Panel

## Product Usage Instructions

### Assemble the Drawer

1. Identify the components: Sides of Drawers, Drawer Front, Bottom of Drawer, and Side Panels.
2. Attach the Side Panels to the Drawer Front and Bottom of the Drawer.
3. Connect Side Panel 1 (D1) and Side Panel 2 (D2) to form the drawer structure.

### Assemble the Frame

1. Gather all frame components: Side Panels, Bottom Panel, Back Panel.
2. Connect the Side Panels to the Bottom Panel using the provided screws.
3. Attach the Back Panel to complete the frame assembly.

### Install the Frame

1. Position the assembled frame in the desired location.
2. Secure the frame to the designated area using appropriate hardware.

### Install the Drawers

1. Slide the assembled drawers into the designated slots within the frame.
2. Ensure that the drawers glide smoothly and securely fit into place.

FAQ

- **Q: What tools are required for assembly?**
  - **A:** The assembly requires a screwdriver and the provided screws for connecting components.
- **Q: Can the drawers be installed in any orientation?**
  - **A:** The drawers should be installed according to the specified orientation to ensure proper functionality.



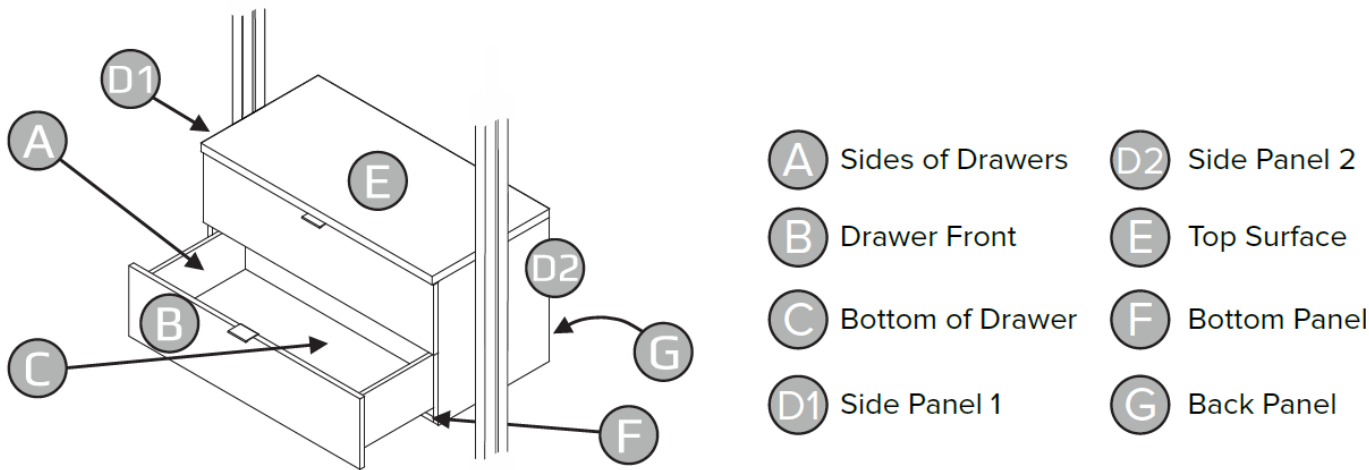



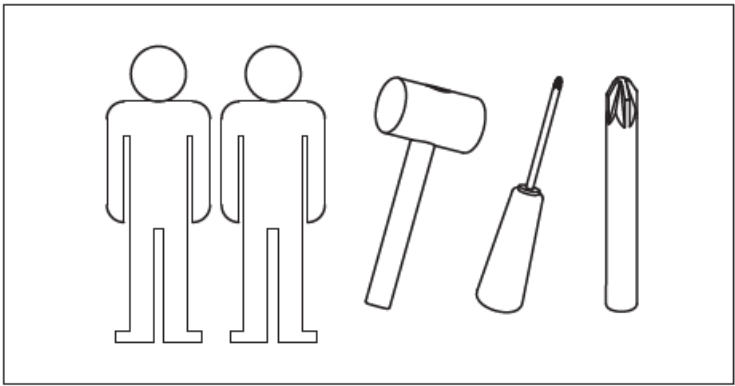

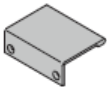

ASSEMBLY INSTRUCTION

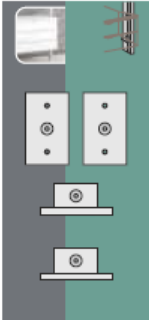

TOOLS

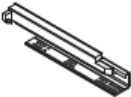

MATERIALS

		 3,0 x 12			
1x	2x	4x	8x	8x	
			 6,3 x 11		
8x	2x	2x	8x	4x	

ASSEMBLE THE DRAWER

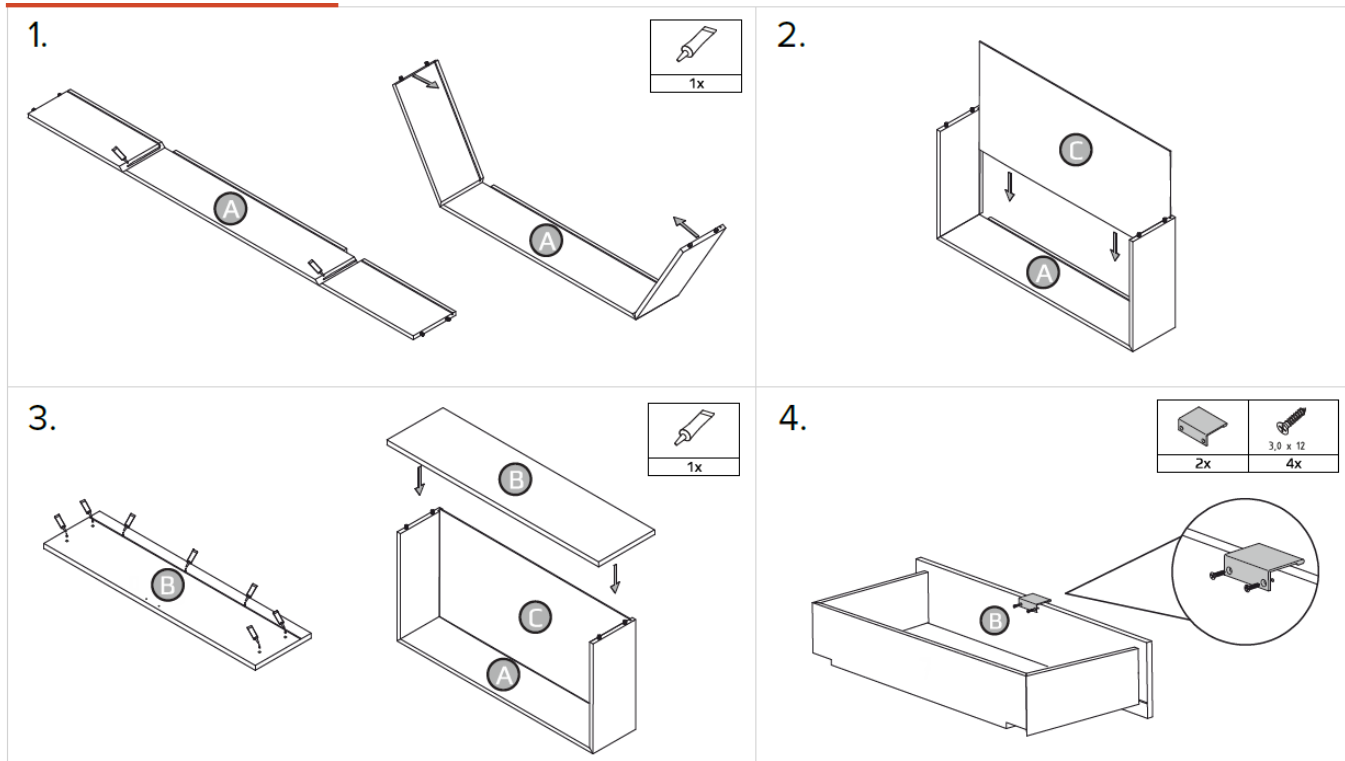

## ASSEMBLE THE FRAME

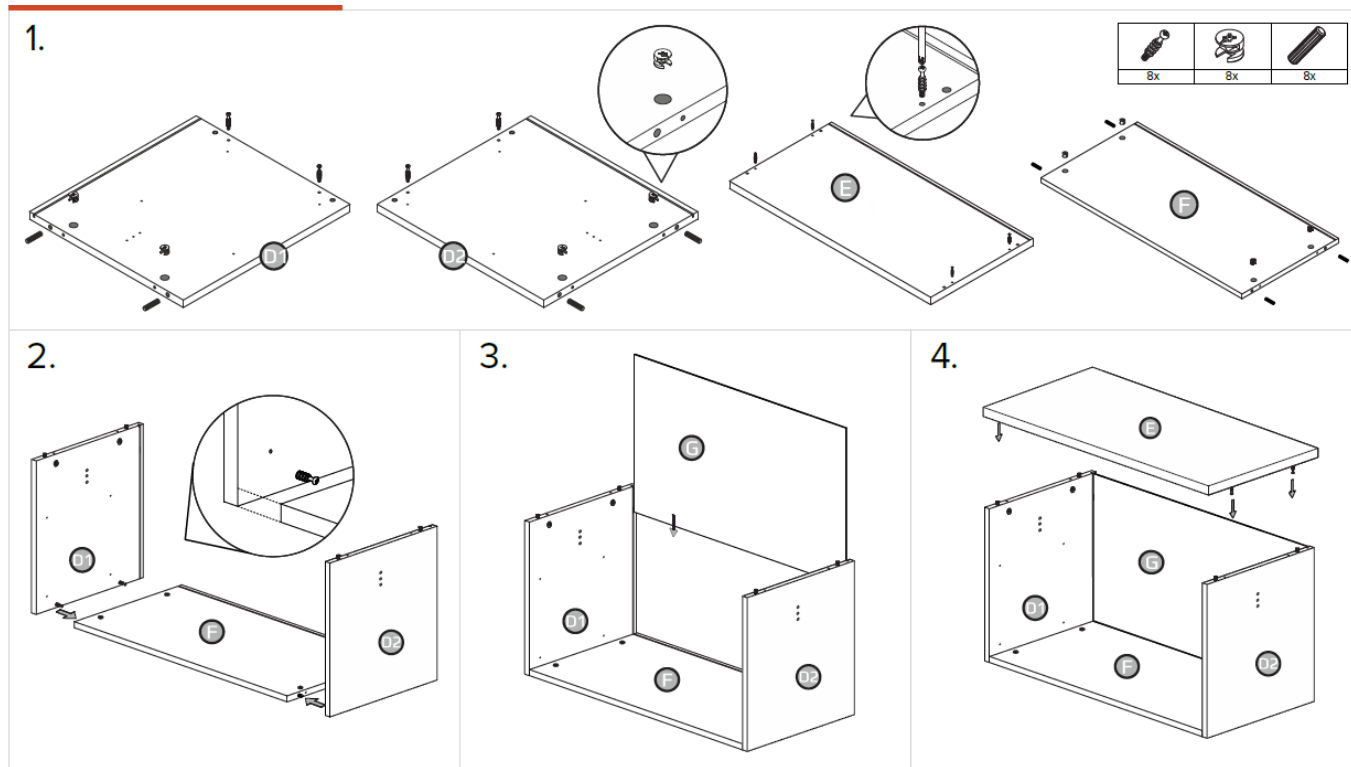

## INSTALL THE FRAME

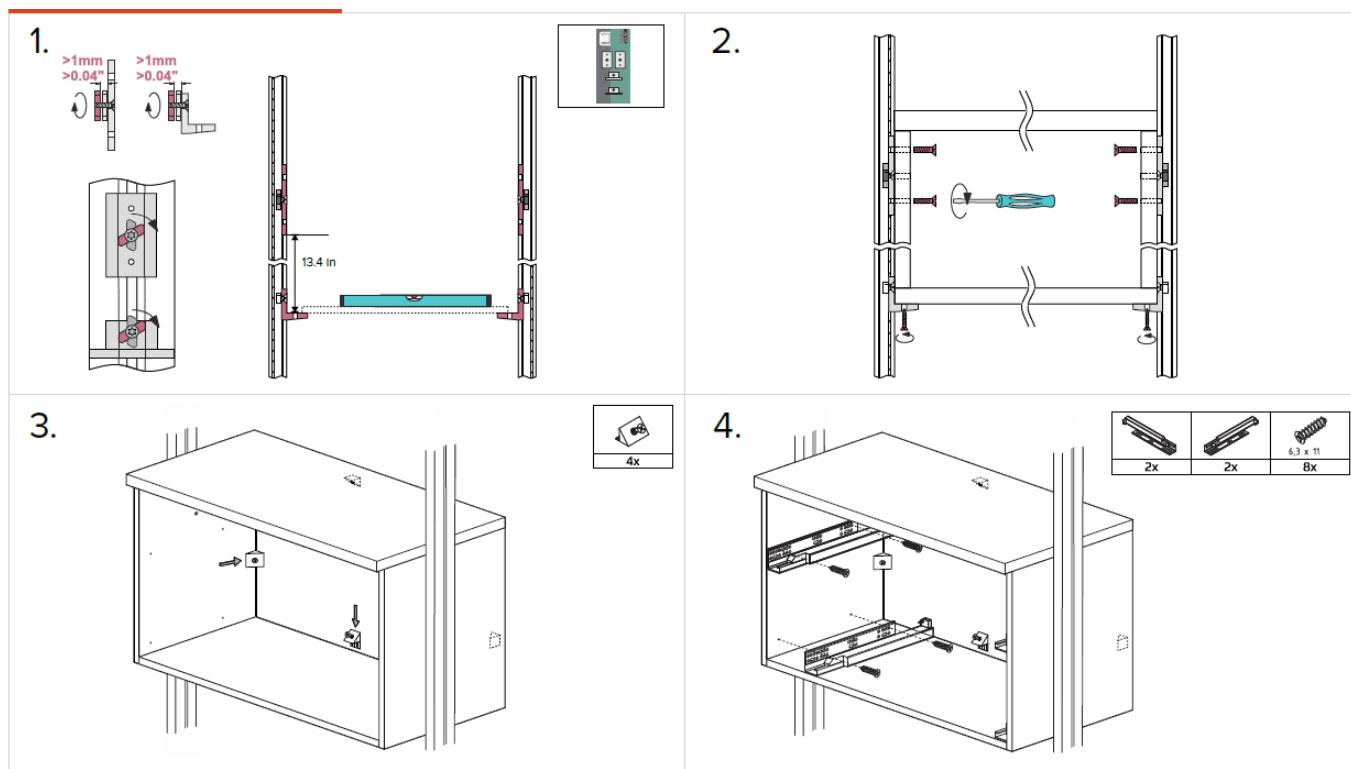

## INSTALL THE DRAWERS

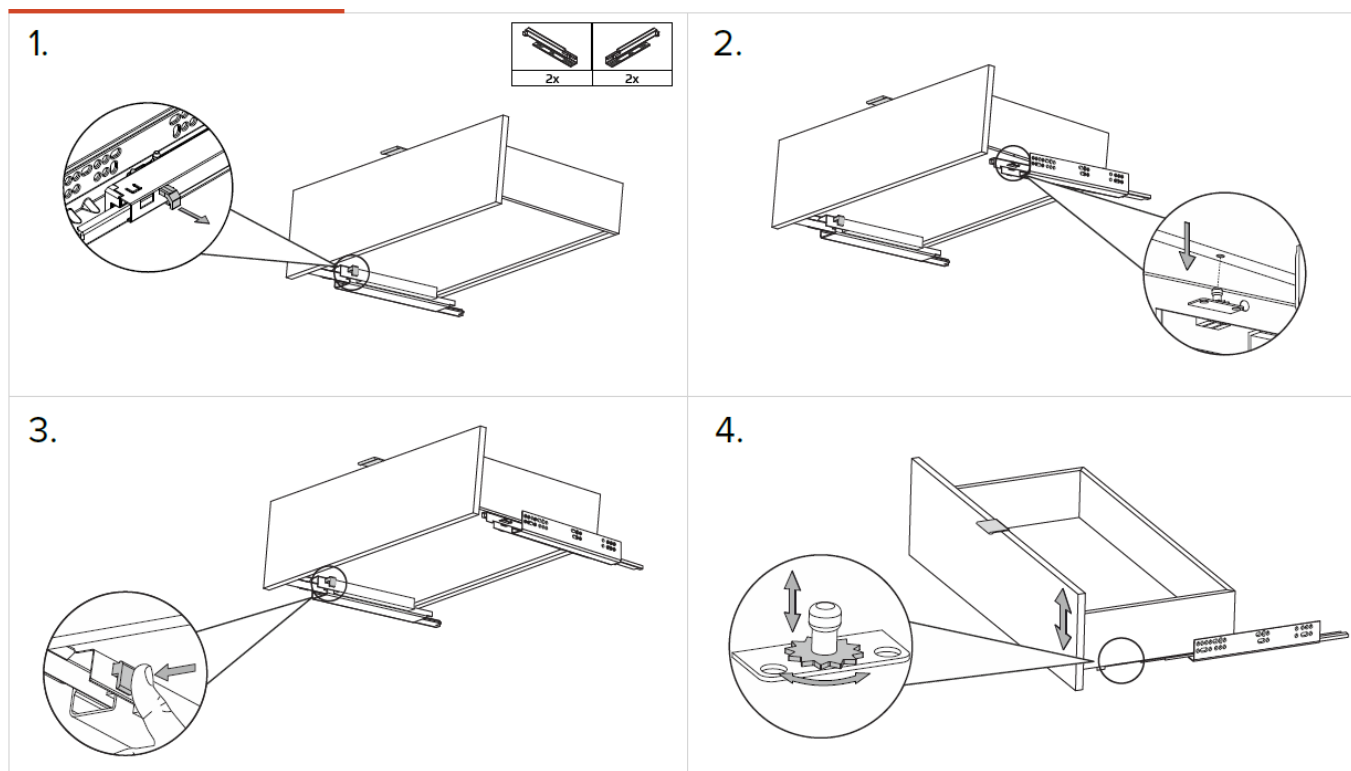

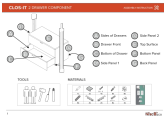

[Sheif and CO CLOS-IT 2 Drawer Component](#) [pdf] Installation Guide  
CLOS-IT 2 Drawer Component, CLOS-IT, 2 Drawer Component, Component

References

- [User Manual](#)

[Manuals+](#), [Privacy Policy](#)

This website is an independent publication and is neither affiliated with nor endorsed by any of the trademark owners. The "Bluetooth®" word mark and logos are registered trademarks owned by Bluetooth SIG, Inc. The "Wi-Fi®" word mark and logos are registered trademarks owned by the Wi-Fi Alliance. Any use of these marks on this website does not imply any affiliation with or endorsement.